

PixArm™

Articulating Arm Mount for your VESA, Cinema and Studio Displays

Installation and Usage Information for Marathon PixArm

Use in conjunction with Marathon's Wallmounts for Cinema and Studio Display:

15"/17" Studio Display MON-885

20"/23" Cinema Display MON-203

22" Cinema Display MON-308

Parts List



One 10-32 x 3/8" Philips Pan head screw



One Tilter Washer



Four M4-12 Philips Pan Head Screw



Four 10-32 x 3/8" Philips Flat Head Pan Screws



One 7/32" Allen Wrench



One 3/32" Allen Wrench



One Cast Column



One 100mm Mounting Plate



One L Base Plate

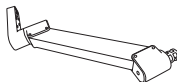

One Armmount



One Base Plate



One 3/8-16 x 7/8" Button Head Socket Cap Screw

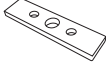

One 3" x 3/4" x 1/4" Rectangular Spacer



One 3/8-16 Nylon Stop Nut



One 75mm mounting plate



One Cable Tie



One Velcro strip

Your PixArm package should include the parts illustrated here.

If any of the parts shown here seem to be missing, contact Marathon...

· by phone: 800-832-6326
· or by email:
info@marathoncomputer.com

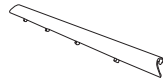

One Cable Trough



One Endcap Bumper



One Forearm Cap



One 3/8-16 x 2 1/2" Hex Head Bolt

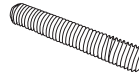

One 1/2-13 x 3" Socket Set Screw



One Small "L" Bracket



One VESA mount



One 3/8-16 x 7/8" Flat Head Socket Cap Screw



One 3/8-16 x 1 1/4" Flat Head Socket Cap Screw

Clamp Desk Mounting

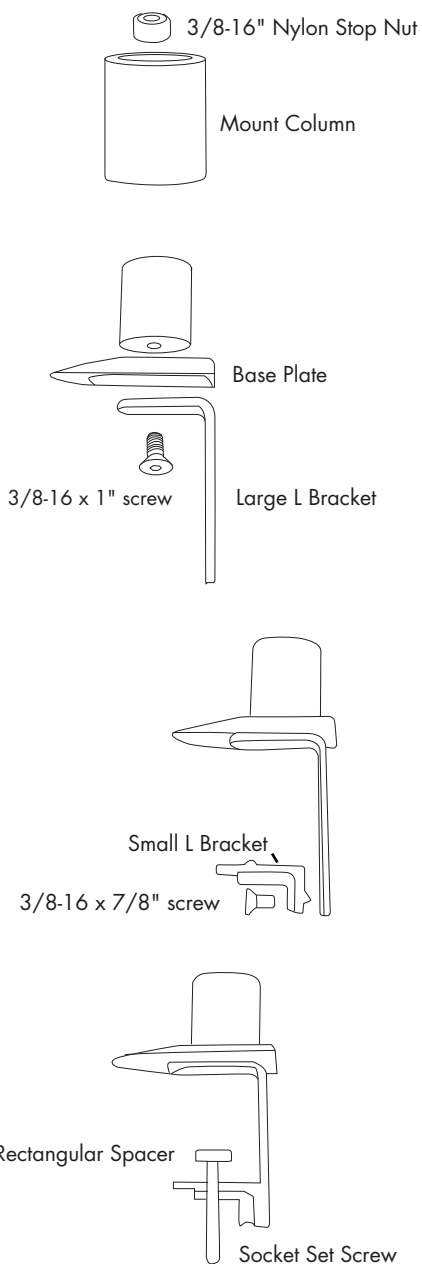

You have several different options for mounting your PixArm to a desk.

Drop the nylon stopnut into the impression on the inside of the metal mount column. The rounded top of the nylon stopnut should be facing upward.

Position the mount cup, base plate and the large L bracket so that the center holes are aligned as shown in the picture at left.

To screw the three parts together use the 3/8-16 x 1" flat head socket cap screw and the 7/23" allen wrench. Insert the 3/8-16 x 1" screw through the counter sunk hole in the large L bracket so that it engages the nylon stopnut.

Tip: Use your finger to hold the stopnut in place. Tighten with the 7/32" allen wrench. The assembly is secure when the 3/8" screw no longer turns.

Align the small L bracket with the holes on the side of the large L and attach with 3/8-16" x 7/8" flat head socket cap screw.

Line up the center hole on the spacer with the hole in the small L bracket; insert the male end of the 3" screw and begin turning it until the spacer touches the bottom of the surface of the desk.

Note: You will get more leverage by inserting the shorter end of the wrench into the various screws and using the longer end as a handle.

Through Desk Mount

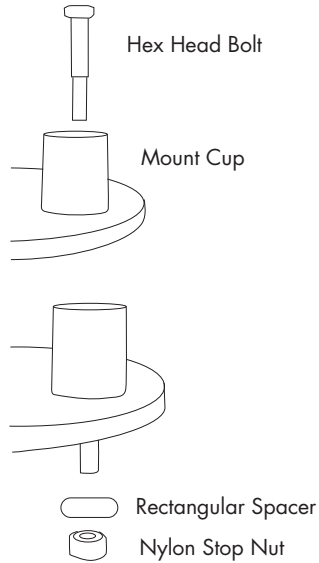

Drill a 3/8" hole into your desk or mounting surface, at least one and one-half to two inches in from edge of the desk.

Position the mount cup over the hole and drop the 2.5" threaded bolt into the mount cup and through the desk.

Under the desk, slide the rectangular spacer onto the 3/8 - 16 x 2 1/2" hex head bolt. Attach the nut to the bolt and tighten until the mount is secured to the desk.

Note: The rounded part of the nylon stopnut should be facing downward.

Wall Mount



Secure the large L bracket to a stud in your wall using wood screws. *Appropriate mounting screws are not provided.*

Drop the nylon stopnut into the impression on the inside of the cast mount cup. The rounded top of the nylon stopnut should be facing upward.

Note: Due to the nylon in the nut, the screw will feel tight all the way in.

Align the mount cup over the short end of the large L bracket so you can screw the two components together using the 3/8-16 X 7/8 button head socket cap screw and tighten using the 7/23" allen wrench. The mount is secure when the 3/8" screw no longer turns.

Assembly of the PixArm

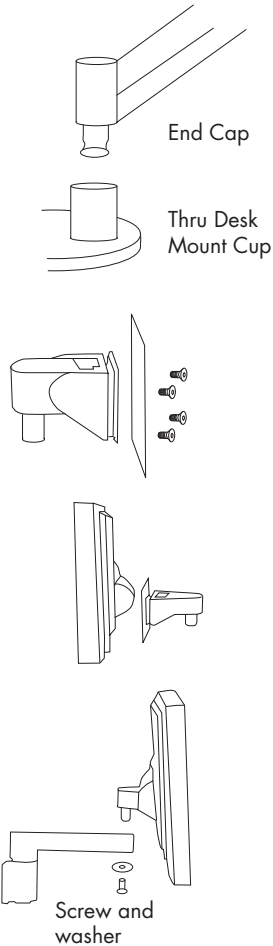

Once the mount is securely fastened, insert the shaft of the arm into the mount cup.

For mounting PC monitors: If necessary, remove the base from the monitor to expose the 100mm or 75mm VESA mounting surface. (See your monitor's user guide.)

75mm and 100mm adapter brackets are provided in your PixArm package. Align the hole pattern of the bracket with the hole pattern on the back of the monitor to determine which one you will need.

Attach the tilter mechanism to the adapter plate using four (4) #10-32 x 3/8" flat head Phillips screws.

Note: If neither of the brackets lines up with your monitor, please contact our customer service department.

Line up the tilter and adapter plate with the hole pattern on the back of the flat panel monitor. Use the four M4-12 Phillips screws to attach the plate to the back of the monitor.

After securing the adapter, insert the shaft of the tilter into the forearm. Fasten them using the 10-32" Phillips Pan Head screw and washer.

Adjusting the PixArm

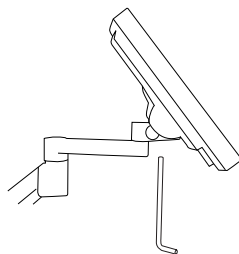

Tilt the monitor so it faces up and locate the set screw under the tilter. Insert the 7/32" allen wrench into the set screw to adjust the tilt friction. To tighten, lightly turn the wrench to the right. To loosen, lightly turn the wrench to the left.

Note: Do not over-tighten.

Adjusting the Counterbalance

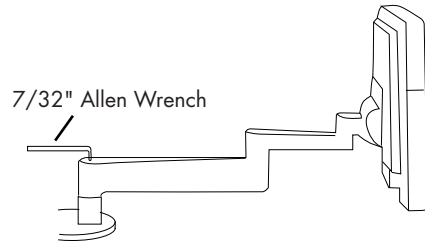

It is important that the arm is held in a horizontal position before beginning the counterbalance adjustments.

Insert the 7/32" allen wrench into the top of the end cap. Turn the allen wrench counter-clockwise (left) to tighten, and clockwise (right) to loosen the arm.

Final Adjustments

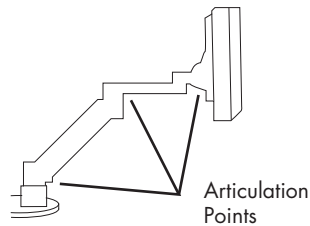

Now that the setup is complete, the arm may need final adjusting.

Use the 3/32" allen wrench to tighten the friction joints found at the three articulation points until you get the right "feel." The feel depends on how you would like your monitor to move.

Cable Management for VESA Monitors

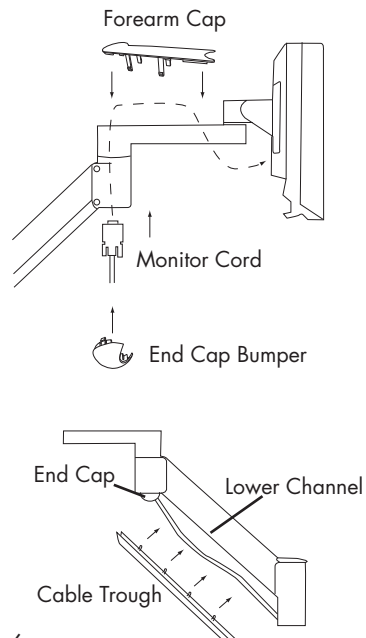

Feed the monitor cord through the bottom of the endcap and through the opening in the other end of the forearm. Align the forearm cap over the forearm and snap into place. Align the endcap bumper over the bottom of the endcap and snap into place.

Tuck the monitor cable through the opening slot of the lower channel of the arm. Once the slack of the cable is inserted, snap the plastic cable trough into place.

Note: Be sure to leave enough slack in the cables to allow freedom of movement around the mount.

Preparing Your Cinema Display

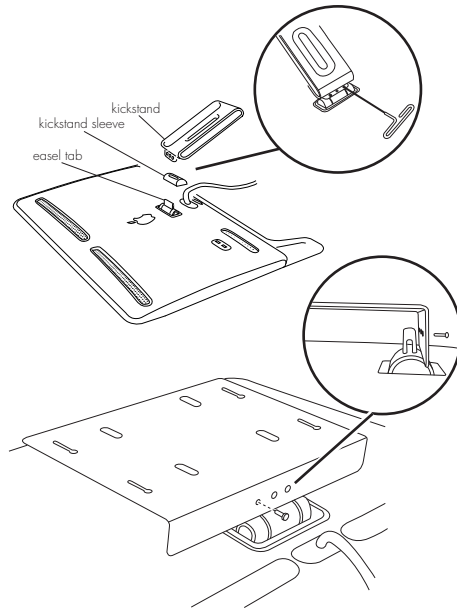

Lay your Cinema Display face down on the non-scratching work surface of your choice. Using the enclosed 2.5mm hex wrench (AKA "Nifty Tool"), remove the three screws to detach the plastic easel from the easel tab. Lift away the kickstand and kickstand sleeve, exposing the easel tab.

Attach the monitor plate of your Wallmount to the easel tab using the screws provided. Refer to the manual included with your Wallmount for correct attachment procedure, as it varies among 20", 22", and 23" Cinema Displays.

Attaching your Wallmount to the PixArm

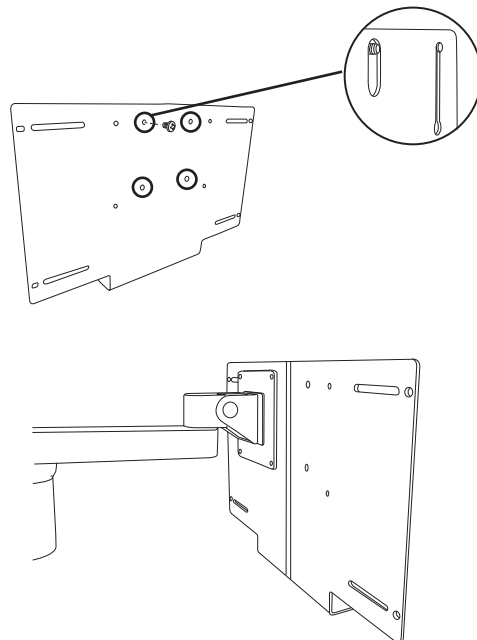

Using the VESA mount positions, attach the Wallmount's wall plate to the PixArm. Mate the monitor to the PixArm by sliding the Wallmount's keyhole slots onto the standoffs. The Display should rest in the padded saddle.

A cable tie is provided with your PixArm for cable management.

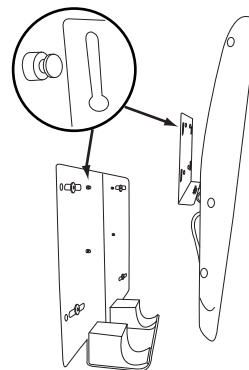

PixArm Installation Instructions v 1.0
Part Number: PUBS-1923

PixArm is a trademark of Marathon Computer, Inc. Apple, the Apple logo, Mac, Macintosh, Cinema Display and Studio Display are trademarks of Apple Computer, Inc. VESA is a reference to the Video Electronics Standards Association. Most everything else has been trademarked by either Microsoft or AOL/Time-Warner by now, but any trademarks left over are property of their respective owners. The swoosh still belongs to Nike.

Limited Warranty

Marathon Computer, Inc., (otherwise "Marathon") warrants this Product, Marathon PixArm, against defects in material and workmanship as follows:

Labor—For period of one year from the date of purchaser, if the Product is determined to be defective, Marathon will repair or replace the Product with a new or refurbished Product at no charge. After the Warranty Period, customer must pay for the labor and shipping charges.

Parts—Marathon will supply new or refurbished parts in exchange for defective parts for a period of one year after date of purchase. After the Warranty Period, customer must pay for all part costs.

To obtain Warranty Service, the Product must be delivered, freight prepaid, in its original packaging to a Marathon Service Center. This Warranty does not cover units that have been altered, repaired, or serviced by anyone other than a Marathon Service Center. This Warranty does not cover cosmetic damage, damage due to connection to improper power source, or damage due to improper operation, maintenance, or mounting. This Warranty does not cover units sold "as is" or "with all faults." Proof of purchase by original purchaser in the form of a dated bill of sale or dated receipted invoice may be required for Warranty Service. Repair or replacement as provided under this Warranty is the exclusive remedy of the Consumer at Marathon's discretion.

Marathon shall not be liable for any incidental or consequential damages for breach of any expressed or implied warranty on this product.

© Copyright 2003, Marathon Computer, Inc., all rights reserved. No part of this publication may be reproduced without prior written consent by Marathon Computer Inc. But, then, why would you want to?