

10" 2565

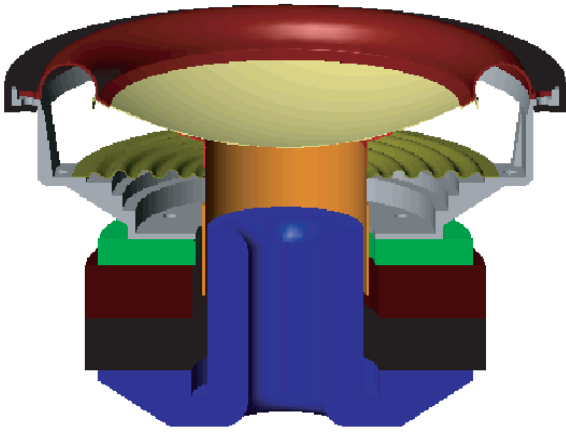

Our TC9 woofers have an exceptionally high $(BL)^2/Re$ of 140! The TC9 drivers also have an extremely high power handling of 500 watts continuous on 4 hours EIA 426B test. Additionally, these drivers have exemplary linearity that can be seen in both the suspension and the motor. Many options such as single or dual spider and various spider compliances can be used to fine-tune a driver for your application.

These drivers can be used in extremely small enclosures with very high power amplifiers of 1000-1500 watt rating and yet, have very low power compression.

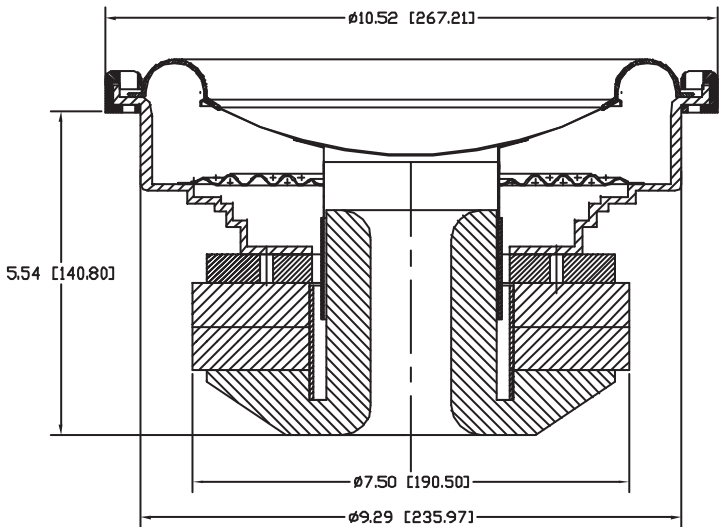

Thiel-Small Parameters & DUMAX		
Fs	=	25.17 Hz
Qe	=	0.25
Qm	=	2.96
Qts	=	0.23
Vas	=	37.96 ltr
Sd	=	0.0317 m ²
Re	=	2.95Ω
Mmd	=	145.78 g
Cms	=	0.0003 m/N 0.268453 mm/N
Rms	=	7.96Ω m
Bl	=	16.80 N/A
Xmag	=	20.0 mm
Xsus	=	19.6 mm
Xmax	=	19.3 mm
Mag Maximum	=	2.6 mm
Sus Minimum	=	-2.2 mm

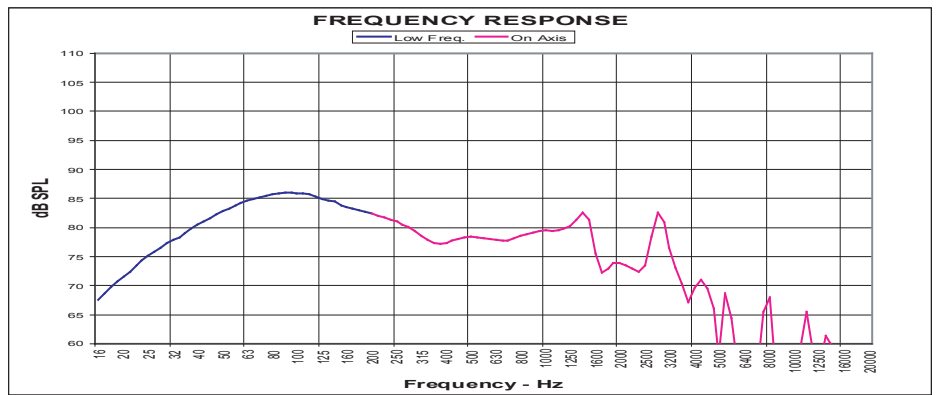

1.0 Volt input 0.5 Meter distance
Average Sensitivity 200 Hz to 2000 Hz = 78.6

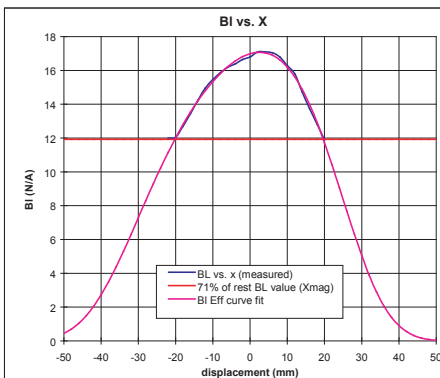

Bl fit between
-20 mm and 20 mm

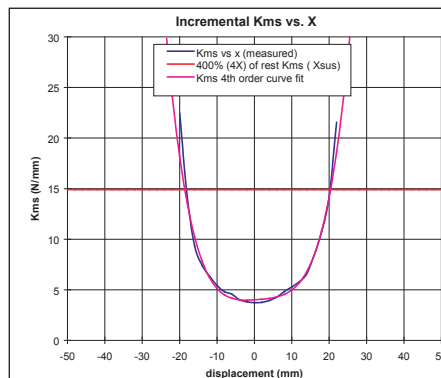

Kms fit between
-18 mm and 20 mm

