

## WATER PUMP COMPONENTS

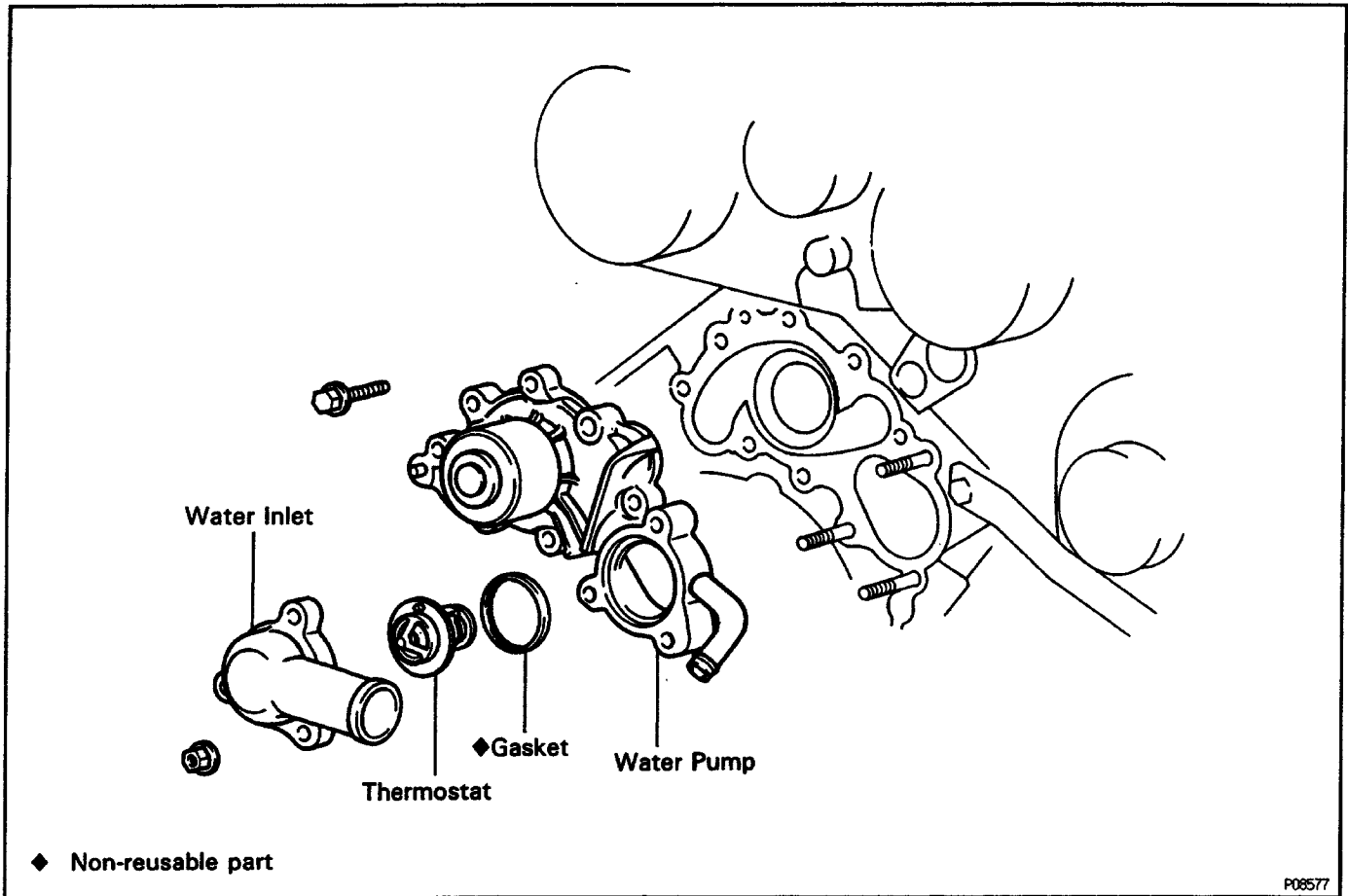

## WATER PUMP REMOVAL

### 1. REMOVE TIMING BELT

(See timing belt removal in timing belt in Engine Mechanical)

### 2. REMOVE THERMOSTAT

### 3. DISCONNECT NO.2 OIL COOLER HOSE FROM WATER PUMP

### 4. REMOVE WATER PUMP

Remove the 7 bolts and water pump.

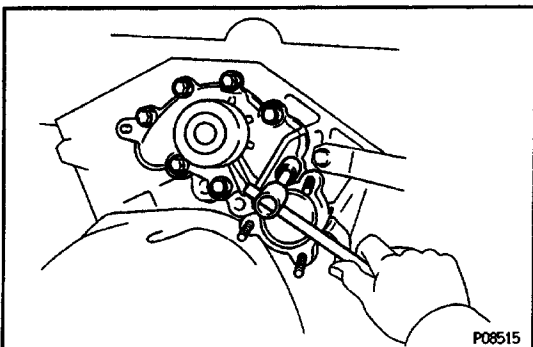

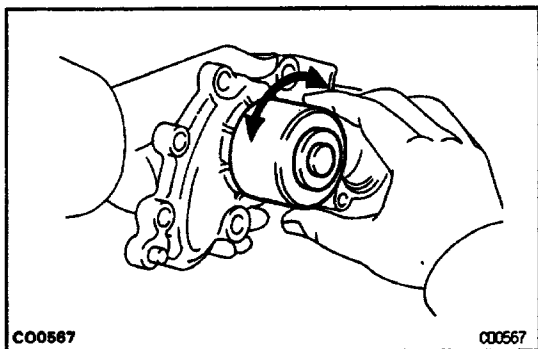

## WATER PUMP INSPECTION

### 1. INSPECT WATER PUMP BEARING

Check that the water pump bearing moves smoothly and quietly.

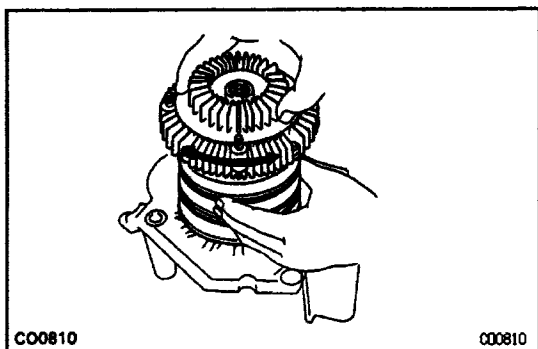

### t. INSPECT FLUID COUPLING

Check the fluid coupling for damage and silicone oil leakage.

### 3. INSPECT FAN PULLEY BRACKET

Check the turning smoothness of the fan pulley. If necessary, replace the pulley bracket.

## WATER PUMP INSTALLATION

(See components for Removal and Installation)

### 1. INSTALL WATER PUMP

- (a) Remove any old packing (FIPG) material and be careful not to drop any oil on the contact surfaces of the water pump and cylinder block.

Using a razor blade and gasket scraper, remove all the old packing (FIPG) material from the gasket surfaces and sealing groove.

Thoroughly clean all components to remove all the loose material.

Using a non-residue solvent, clean both sealing surfaces.

- (b) Apply seal packing to the water pump groove.

#### Seal packing:

##### Part No. 08826-00100 or equivalent

- Install a nozzle that has been cut to a 2 – 3 mm (0.08 – 0.12 in.) opening.

HINT: Avoid applying an excessive amount to the surface.

Parts must be assembled within 5 minutes of application.

Otherwise the material must be removed and reapplied.

Immediately remove nozzle from the tube and reinstall cap.

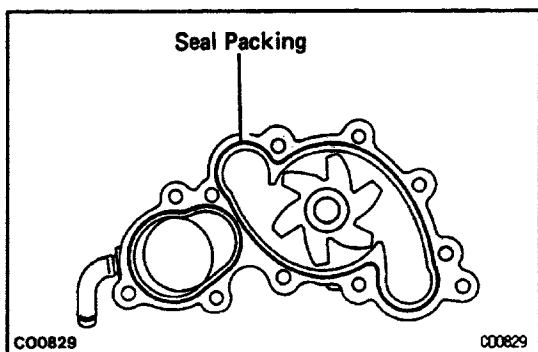

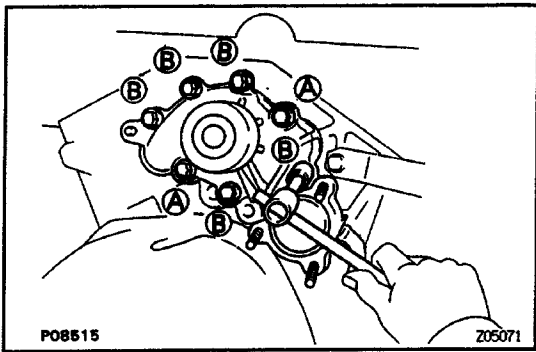

(c) Install the water pump with the 7 bolts.

**Torque:**

**Bolt (A) 18 N-m (185 kgf-cm, 13 ft-lbf)**

**Bolt (B): 20 N-m (200 kgf-cm, 14 ft-lbf)**

**2. CONNECT NO.2 OIL COOLER HOSE**

**3. INSTALL THERMOSTAT**

**4. INSTALL TIMING BELT**

**(See timing belt installation in timing belt in  
Engine Mechanical)**