



A Transformed Waterfront for...

The New Seattle Waterfront

Our Economy

Replacing the Alaskan Way Viaduct with a tunnel is a once-in-a-century opportunity that will allow Seattle to reclaim the waterfront for people rather than cars.



Seattle 2006



Sydney



Portland



Manhattan, NYC



Bill Hook

Improved Mobility

Urban Amenity

Employment Growth

Increased Tourism

Increased Tax Revenues

Partnership Opportunities

A Summary of the Central Waterfront Plan

Seattle's waterfront will be an even more important economic generator for Washington State than it is today. People and freight will move efficiently through this important link in the regional transportation network. New businesses on Seattle's working waterfront will provide numerous job opportunities. Millions of visitors from all over the world will visit the waterfront's many attractions.

The New Seattle Waterfront will reconnect the core of the city with our spectacular natural environment. The shoreline will be a rich habitat for the aquatic life of Puget Sound, the second largest estuary in North America. The new waterfront will highlight the interface between a vital city and a healthy, dramatic shoreline, creating an environment that is uniquely Seattle.



Our Place

- A Grand Civic Space**
- New Gathering Places**
- More Walkable Environment**
- Public Art**
- Spaces for Cultural Events and Exhibits**



Our Environment



- Improved Water & Air Quality**
- Shoreline Restoration**
- Improved Wildlife Habitat**
- Noise Reduction**
- Sustainable Development**
- Educational Opportunities**

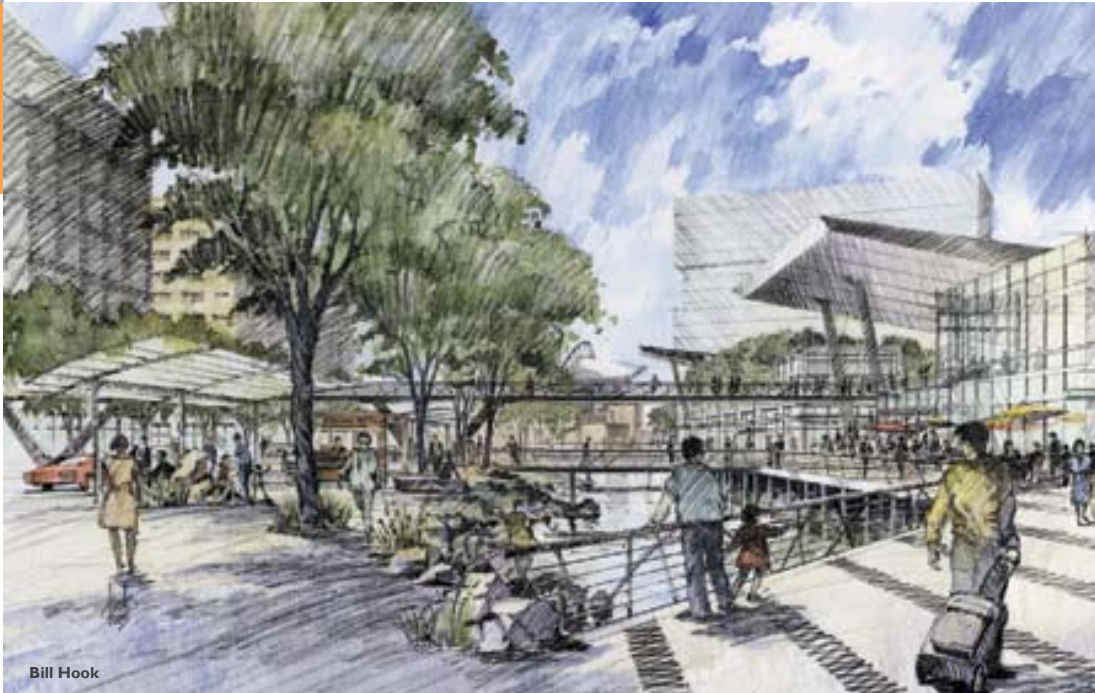

Seattle’s waterfront will be the city’s most memorable place. New public spaces, art and views on the waterfront will spark everyone’s imagination. The waterfront will be reconnected with the city. A grand waterfront promenade will make walking the ultimate urban experience and create a healthier and more sustainable city.

- Celebrating Our Heritage**
- A New Historic Preservation District**
- Year-Around Activities**



The Waterfront is Now...

“Replacing the viaduct with a tunnel is a once in a lifetime opportunity to reclaim our waterfront.”

Mayor Greg Nickels

Next Steps

2006

- Finalize Concept Plan
- City Council resolution
- Select consultant for Public Realm Plan
- Prepare initial Comprehensive Plan amendments
- Begin update of Shoreline Management Program

2006-2007

- Complete Waterfront Public Realm Plan (including preliminary cost estimates and public financing analysis)
- Prepare regulatory changes

2008

- Begin utility relocation
- Begin detailed master plan

The Waterfront benefits all of Washington:

- An economic generator for all of Washington state.
- A significant link in the state's regional highway system, ferry system, and rail corridor.
- A major regional attraction for millions of visitors from all over the world.



For additional information on Seattle's Waterfront planning project, visit

www.seattle.gov/dpd/centralwaterfront

Send your questions and comments to Waterfront Plan staff at waterfrontplan@seattle.gov.



Printed with soy-based inks on recycled and alternative fibers.

Seattle Waterfront Plan

