

BUSINESS CENTER as of 03/03/2010 10:15

Dimension	Size	Qty	SqFt
10x10	100	4	400
10x20	200	1	200
20x20	400	3	1,200
20x30	600	3	1,800
20x40	800	1	800
20x50	1,000	1	1,000
30x40	1,200	1	1,200
30x50	1,500	1	1,500
3x3	9	5	45
3x5	15	9	135
40x50	2,000	1	2,000
40x70	2,800	1	2,800
60x80	4,800	1	4,800
Totals:	32	19,637	

EXHIBITS as of 03/03/2010 10:15

Dimension	Size	Qty	SqFt
10x10	100	126	12,600
10x20	200	38	7,600
10x30	300	3	900
20x20	400	9	3,600
20x30	600	10	6,000
20x40	800	3	2,400
20x50	1,000	1	1,000
30x30	900	4	3,600
30x40	1,200	1	1,200
30x50	1,500	1	1,500
40x50	2,000	2	4,000
40x60	2,400	1	2,400
50x50	2,500	2	5,000
50x60	3,000	1	3,000
Totals:	202	54,800	

CAREER PAVILION as of 03/03/2010 10:15

Dimension	Size	Qty	SqFt
10x10	100	7	700
10x20	200	15	3,000
20x20	400	9	3,600
20x30	600	7	4,200
20x40	800	2	1,600
3x6	194	7	1,358
Totals:	47	14,456	

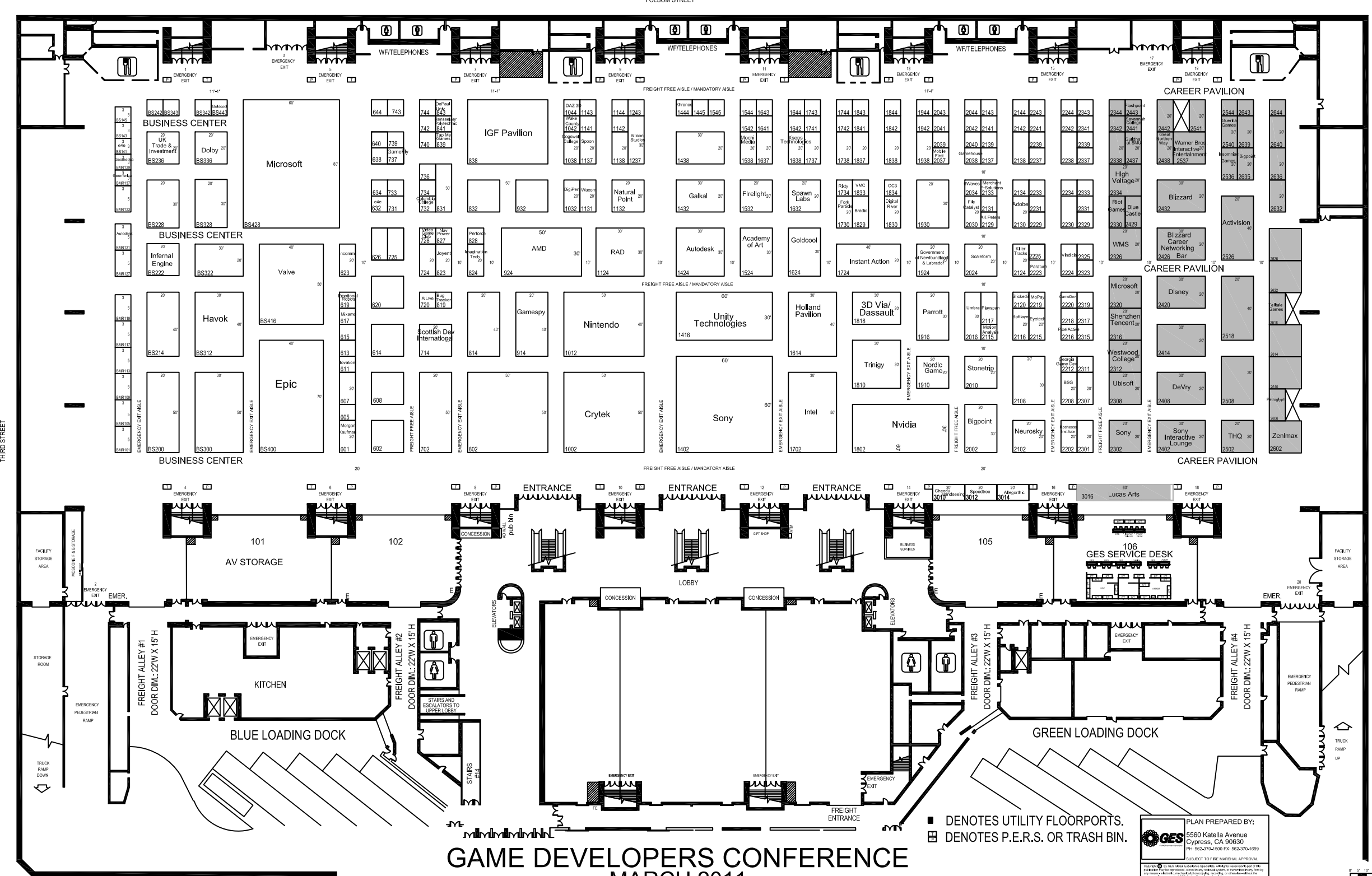

**GAME DEVELOPERS CONFERENCE
MARCH 2011
MOSCONE CENTER - SOUTH HALL
SAN FRANCISCO, CA**

- DENOTES UTILITY FLOORPORTS.
- ▣ DENOTES P.E.R.S. OR TRASH BIN.

PLAN PREPARED BY:
GES
 5560 Katella Avenue
 Cypress, CA 90630
 PH: 562-747-1000 FX: 562-747-1699
SUBJECT TO FIRE MARSHAL APPROVAL

M-0324 24-00000 09-11-09
 D. McDERMID
 I. KENNEDY

