

"The Original"

ARCTIC FOX

NORTHWOOD MFG

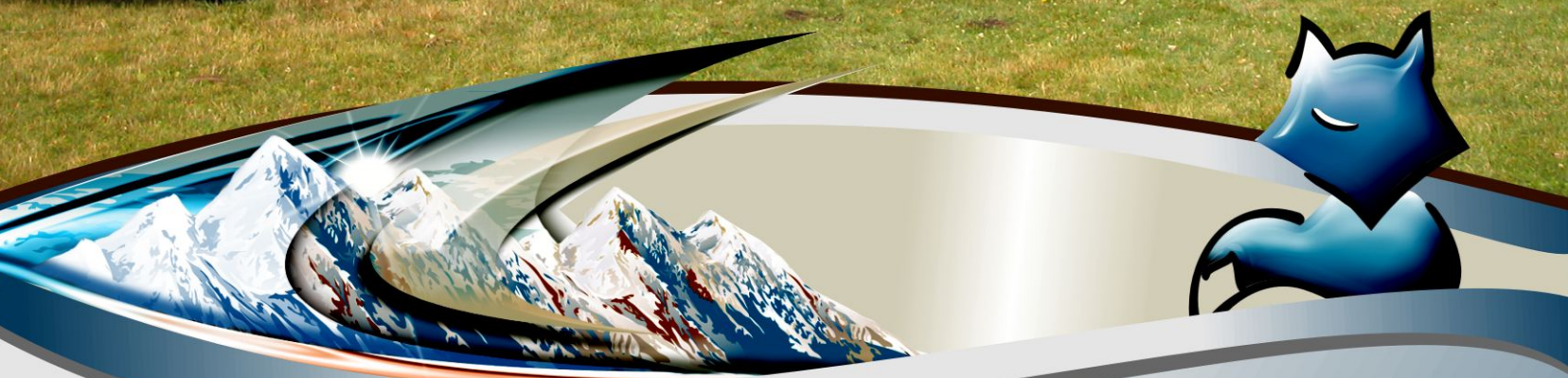

4SEASON
All Weather Coach

"Home is where you park it"



'Quality You Can See'

ARCTIC FOX

NORTHWOOD MFG



Cactus - Model 1150

For years, Northwood has been the industry leader in slide out truck campers and this year is no exception! Like all Arctic Fox Campers, these new Foxes are durable enough for extended cross-country and off-road travel! Our transverse floor structure offers a wider main floor giving a spacious feel that is immediately apparent upon entering the coach. Check out the new features such as the comfortable and convenient Dream Dinette, with no table legs to negotiate around, and the new larger dinette window to enhance your view of the outdoors while dining or relaxing. Arctic Fox is the leader in slide out truck camper design.



Typical Dry Bath



Typical Wet Bath



Taupe - Model 992

Many manufacturers are building aluminum frame truck campers nowadays, but aluminum frames are not all the same. We are proud of the quality materials we use and the construction methods we employ to build America's best selling full wall slide out truck camper. There's no doubt that our Arctic Fox truck campers are attractive, but what really sets us apart from the competition is how beautifully they're constructed. From our heavy gauge aluminum with continuous welded joints and solid fill anchor blocking, to our bonded full walk on roof (that will support 29 employees), the Arctic Fox Truck Camper is truly a thing of beauty. Once you've owned an Arctic Fox, you'll never be satisfied with less. That's why we say... "Beauty is more than skin deep!"

Northwood is pleased to introduce you to the Arctic Fox Truck Camper. With eight plans to choose from, there is an Arctic Fox to fit the needs of nearly every camper buyer. You can purchase your Fox Camper with confidence because Northwood builds more slide out truck campers than any other manufacturer! Arctic Fox offers a wide variety of features and options sure to satisfy your truck camper needs. That's because The Fox was designed with the informed camper purchaser in mind. We invite you to take a closer look and you'll see why Arctic Fox is the truck camper of choice for the experienced buyer.

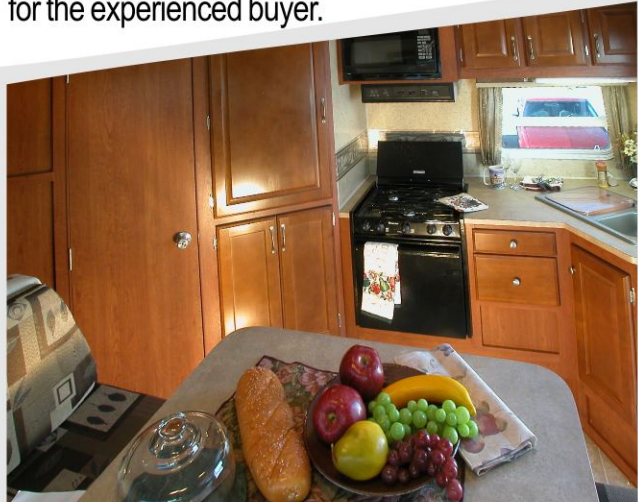

When you compare the specifications of our slide out with the competition, you will see why Arctic Fox continues to be the industry leader. Our full wall slides are up to 26" deep, and our aluminum super structure slide out operates under heavier load conditions than competitors. We build our slide outs right, using dual ram rack and pinion slide mechanisms. Many competitors rely on a single slide mechanism. The dual rams carry the slide-out room smoothly even under full load weights. Five separate seals insure against water intrusion. The slide room is completely insulated for your comfort in all weather conditions. We will continue to lead the industry in innovative slide out camper engineering.



Chestnut - Model 811

Feature fabrics enhance the Presidential Cherry finish hardwoods and textured wall boards. You have your choice of a number of beautiful interior decor colors. We use only commercial grade vinyl floor covering and you also have the option of a removable carpet kit. (Carpet kit not available in the 865 and 992 model.)

ARCTIC FOX

NORTHWOOD MFG

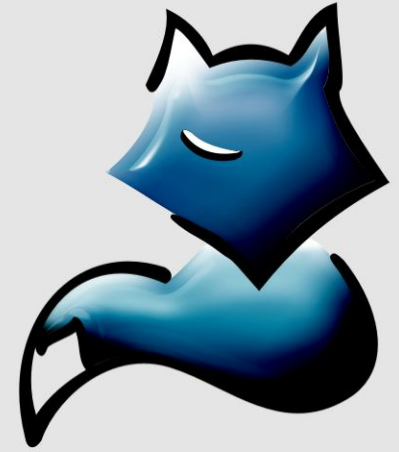

TV Indicates pre wired locations where TV's can be installed

865 & 811 are available for 6 1/2' truck box or 8' truck box



Approximate Overall Weight and Measure Specifications For Arctic Fox Campers:

Description	Arctic Fox Truck Campers (*) Designates NON Slide-out					
	811	865*	990	992	1140	1150
Model Number	811	865*	990	992	1140	1150
Dry Weight Lbs.	2873	2641	3010	3235	3465	3358
Dry Weight Kgs.	1303	1198	1365	1467	1571	1523
Width	96 1/2"	96 1/2"	96 1/2"	96 1/2"	96 1/2"	96 1/2"
Exterior Height	102"-112"w/air	102"-112"w/air	102"-112"w/air	102"-112"w/air	102"-112"w/air	102"-112"w/air
Interior Height	79"	79"	79"	79"	79"	79"
Floor Length	9' 0"	9' 4"	9' 10"	10' 2"	11' 4"	11' 4"
Overall Length	16' 8"	17'	17' 6"	17' 10"	19'	19'
Fresh Water w/Water Heater	45	34	55	47	55	55
Grey Water	41	32	44	29	44	44
Black Water	25	31	43	37	43	43
LPG Capacity (approx. gallons)	14	14	14	14	14	14

Weights include slide-out (if applicable). Some options are not included in the weights displayed. See the list of features that are included in the calculation table.



Features & Options

FOX VALUE PACK CONSTRUCTION

- Thermal Pane Windows
- Storm Windows
- Front Cab-Over Window

ELECTRICAL

- 50 Watt Solar Panel w/ Controller
- 100 Watt Solar Panel w/ Controller
- Combo Satellite Dish
- Auto Scan Satellite Dish
- 2.5 Onan Generator (Short Box Only 865 / 811)
- 11K BTU Air Conditioner

KITCHEN / GALLEY

- 2-way Double Door 6 Cu. Ft Fridge
- 2-way Double Door 8 Cu. Ft Fridge
- 3 Burner Range with 22" Oven
- 3 Burner Range with 16" Oven

PLUMBING & LAVY

- DSI Gas Electric Water Heater

INTERIOR

- LCD Flat Screen TV
- DVD Player
- Overhead Bunk in Dinette
- Full Wall Wardrobe
- Removable Livingroom Carpet

EXTERIOR

- Diamond Plate Front Panel
- Side Box Awning
- Full Wall Slide Out Awnings
- Swing Out Brackets For Dually
- Add-a-Step
- LP Barbeque
- Remote Power Jacks

KEY: **S** Standard Equipment (no charge)
O Option Available on Request
N Not Available in this Model

Full 12 Month Warranty (All Models)

	811	865	990	992	1140	1150
FOX VALUE PACK CONSTRUCTION	O	O	O	O	O	O
Thermal Pane Windows	O	O	O	O	O	O
Storm Windows	O	O	O	O	O	O
Front Cab-Over Window	O	O	O	O	O	O
ELECTRICAL						
50 Watt Solar Panel w/ Controller	O	O	O	O	O	O
100 Watt Solar Panel w/ Controller	O	O	O	O	O	O
Combo Satellite Dish	O	O	O	O	O	O
Auto Scan Satellite Dish	O	O	O	O	O	O
2.5 Onan Generator (Short Box Only 865 / 811)	O	O	O	O	O	O
11K BTU Air Conditioner	O	O	O	O	O	O
KITCHEN / GALLEY						
2-way Double Door 6 Cu. Ft Fridge	O	O	O	O	O	O
2-way Double Door 8 Cu. Ft Fridge	N	N	N	N	O	N
3 Burner Range with 22" Oven	O	O	O	O	N	O
3 Burner Range with 16" Oven	N	N	N	N	O	N
PLUMBING & LAVY						
DSI Gas Electric Water Heater	S	S	S	S	S	S
INTERIOR						
LCD Flat Screen TV	O	O	O	O	O	O
DVD Player	O	O	O	O	O	O
Overhead Bunk in Dinette	O	O	O	O	O	O
Full Wall Wardrobe	O	O	O	O	O	O
Removable Livingroom Carpet	O	N	O	N	O	O
EXTERIOR						
Diamond Plate Front Panel	O	O	O	O	O	O
Side Box Awning	O	O	O	O	O	O
Full Wall Slide Out Awnings	O	O	O	O	O	O
Swing Out Brackets For Dually	O	O	O	O	S	S
Add-a-Step	O	O	O	O	O	O
LP Barbeque	O	O	O	O	O	O
Remote Power Jacks	O	O	O	O	O	O

Value Pack

Fox Value Pack is a mandatory option bundle that includes all of the following high value features:

- Rear Awning
 - Sliding Battery Tray
 - Rieco Titan® Electric Jacks
 - Dual 30 lb. LP Tanks
 - Exterior "Marine Speakers"
 - Roof Rack and Ladder
 - Sliding Storage "Joey" Tray
 - Diamond Plate Armor- Basement Siding
 - Large 22" Oven
 - Microwave Oven
 - LP/110 - 6 Cu Ft Dbl Door Refrigerator
 - Pull-Out Pantry
 - Deluxe Refrigerator Doors
 - Fantastic Fan® - Multi-Speed/Reversible
 - TV Antenna
 - Dinette Storage Door
 - Dinette Storage Drawer
 - Bedsread/Shams
 - Bedroom Front Shelf
- Weight: 595 lbs.**

Option Weights

Approximate weight of specific additional features:

Feature	Est. Weight
Weight Unit of Measure	Lbs. Kgs.
OHD Bunk	40 18
Swing Out Brackets	21 10
11M BTU Air Cond.	90 41
Solar Panel 50W	22 10
Solar Panel 100W	32 15
Removable Carpet	10 5
Side Box Awning	63 29
Generator Ready	25 11
2.5 Generator	78 35
Barbeque	22 10
One Battery	30 14
Typical Water Full (8.3 Lb/Gal)	458 208
Propane Full	60 27

Use these figures to estimate the total weight of the coach with added options:
 ...camper weight + options

Items Included In Unit Weight Estimation

All Unit Weights Include All of The Following Features Below:
 Fiberglass Exterior; Heavy-Duty Camper Tie Downs; Exterior Rinse Station; 20 M BTU Auto Ignition Furnace with Thermostat Control; 60x80 Pillow Top Inner Spring Mattress; Pre-wire for Solar and Satellite; Pre-wire for TV antenna; Pre-wire for microwave oven; Pre-wire for Air Conditioner; Large 3-burner Range; Range Cover; Range Hood w/ Light and Exhaust Fan; DSI Gas Electric Water Heater with Insulated Porcelain Tank; Water Heater By-pass Valve; Semi-Automatic Winterization System; Night/Privacy Shades; Galley Skylight w/Shade; 25 Watt Speakers; Fire Extinguisher; LPG Leak, Smoke and CO Detectors.

Northwood Manufacturing reserves the right to modify options, change feature availabilities and plan configurations at any time. Please note that weights are approximate and for estimation purposes only. Specifications and weights are subject to change without notice.

Camper Safety Tips

For your safety while driving, use mirrors that allow you to view past the camper to the rear on both sides. Trucks can be purchased with extended mirror options or you may purchase mirror extensions. Truck manufacturers state that you should not exceed the GVRW for the vehicle that carries your camper. The configuration of your truck will determine what size camper your vehicle can carry. A dual rear wheel truck is advisable for Arctic Fox Campers over 10 ft. Adjustable air bags will help to level your vehicle transfer rear axle weight forward

for comfort and safety and are recommended for all Arctic Fox applications. Some states allow passengers to ride in the camper, but it is not recommended as there are no seat belts available. When driving in any adverse weather condition it is always best to reduce your speed. The pickup should be outfitted with a durable rubber mat liner to reduce shifting while traveling. The mat will also protect the truck bed and camper from scratching while loading and unloading.



Use **TORKLIFT** frame mounted camper tie downs for greatest safety. www.torklift.com



111 Reasons To Buy An Arctic Fox



Construction

- Aluminum Superstructure
- Welded Aluminum Framing (.060" - .125")
- 2 lb. Virgin Block Foam Insulation
- Full Walk-On Roof
- Crowned Roof: 3-1/2" Tapered to 1-1/2"
- TPO Durable, Seamless Vinyl Roof
- Transverse Floor Maximizes Floor Space
- Continuous 1 Piece Fiberglass Cabover Rack and Pinion Slide Out Mechanism



Exterior

- LED Running Lights
- LED Tail Lights - Recessed Automotive Style
- Large 1" Thick, Insulated Compartment Doors
- Metal Latches, Catches, and Pulls
- Automotive Bulb Seals Around All Doors
- 12V Light in Termination Compartment
- Removable 110V Power Cord (25' Length)
- Outdoor High Pressure Rinse Station
- 5/8" Cast Iron Gas Manifold
- Diamond Plate Armor Above Bumper
- Entry Door w/ 2 View Windows
- Aluminum Bumper w/ Dual Access
- 3 Position Step Mount
- Entry Door/ Patio Light
- Exterior Convenience Light (Non-slide Side)
- Black Tank Flush
- Exterior 110 Volt Outlets (GFI Protected)
- Rain Gutters and Drip Spouts
- LP Hookup for BBQ
- White Frame Torque/Jalousie Windows
- Large Tinted Safety Glass Windows
- Thermal Pane Window Option



Interior

- Presidential Cherry Finish Cabinets
- Face Frame Cabinet Construction
- 3 Interior Color Décor Choices
- AM/FM CD Player w/ 6 Speakers
- Rheostat Adjustable Lighting
- Recessed Halogen Lighting
- Wood Trim Accents
- Ozite Ceiling Liner
- 2 Fluorescent Lights
- Night/Privacy Shades
- Direct Spark Ignition LP/110 Water Htr
- Adjustable Heat Vents
- Systems Monitor Panel
- 12 Volt Disconnect Switch
- 8 - 110 Volt Outlets (9 - Dry Bath Models)
- Large Capacity Holding Tanks
- Enclosed Heated Holding Tanks
- Enclosed Heater Termination Valves
- Pre-Wired for Solar Panel
- Pre-Wired for Satellite Receiver
- Power Converter with Charger
- Charge Wizard © Battery Maint. System
- Generator Ready (Most Models)
- Generator Transfer Switch (Most Models)
- Optional Carpet Kit



Bathroom

- Fiberglass Shower Stall
- Bathroom Skylight
- Fold-Away Clothes Hanger
- Vanity Cabinet & Mirror
- Freeze Resistant Waterlines



Kitchen

- Galley Overhead Cabinets w/ Shelves
- Solid Wood Doors
- Full Extension Ball Bearing Drawer Glides
- Single Lever Faucet w/ Pullout Sprayer
- Counter Extension
- Galley Backsplash
- Large Kitchen Skylight w/ Shade
- 20 Mil Wear Surface Linoleum



Bedroom

- Pillow Top, Inner Spring Mattress
- 20" Flat Panel TV Option
- Amplified TV Antenna Hookup
- Park Cable Connection
- 110 Volt Outlets
- 12 Volt Outlet
- Large Wardrobe Cabinet
- Cabover Hampers
- Swivel Accent Reading Lights
- Mirrored Closet Doors
- Padded Headboard
- Full Wall Wardrobe Option
- Optional Front Window



Slide Out

- Full Wall Slide
- 26" Deep Slide (Most Models)
- Oversized Dinette Window
- Dream Dinette
- Longer/Wider Dinette Table
- Dinette Converts to 43 x 76 Bed
- 5 Seals on Slide-Out
- Below Seat Storage
- High Density Foam Seat Cushions
- Optional Fold Down Overhead Bunk w/ Pad
- Below Step Storage



Fox Value Package

- Rieco Titan © Electric Jacks (w/ Remote)
- Large Rear Awning (7' x 8') Carefree ©
- Sliding Storage "Joey" Tray
- 7 Gal LP Tanks (2 Stand-up)
- Dual Battery Compartment w/ Slideout Tray
- Diamond Plate Armor - Basement Siding
- Roof Access Ladder
- 7" Tall Roof Rack
- Rear Exterior "Marine" Speakers
- 3 Burner Hi-Output Range w/ 22" Oven (most models)
- Microwave
- 6 CU FT. Refrigerator (LP/110)
- Deluxe Refrigerator Doors
- Dinette Storage Drawer
- Dinette Storage Door
- Pull-Out Pantry
- TV Antenna
- FANTASTIC © Reversible, Multi-Speed Fan
- Coordinated Bedspread & Shams
- Bedroom Front Shelf

THE BENEFITS OF LOCALLY PURCHASING YOUR RV :

- * You enjoy valuable relationship building with Dealer Representatives, close to your home, who will explain the features and benefits of the product.
- * You receive a full product orientation prior to delivery, which includes hands-on directions for many of the coach's systems and functions. You are also introduced to the Dealership's Service/Parts/Warranty personnel who are at the ready to help you with any issues you may encounter, now and in the future.

- * You enjoy customer PRIORITY. Dealerships generally service their purchasing customers first - others may experience long delays and miss opportunities to use their RV. What is it worth for you to have a dealership's full attention and motivation to satisfy you when you need service - in a timely manner?
- * Valuable TAX dollars and jobs stay in YOUR community which pays for your roads, schools, police and fire departments.

Thank you!

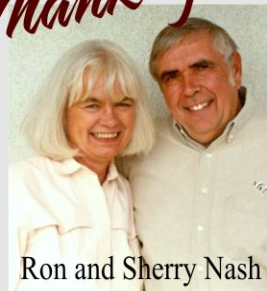

Ron and Sherry Nash

Thank you for taking a moment to check out our Northwood products. Our highest priority is to offer you the best combination of quality and value in an RV and we are confident you will appreciate and thoroughly enjoy your Northwood RV purchase for many years to come.

ARCTIC FOX

NORTHWOOD MFG

FOX



Still more reasons why you should buy Arctic Fox

Aluminum Superstructure with Solid Core Blocking

Aluminum Superstructure with Solid Core Anchor Blocking

Anchor blocking gives substantial strength at main connection points.



Solid Core Anchor Blocking

CONTINUOUS BEAD WELDS
ALL THREADS ARE SECURING THE FASTENER

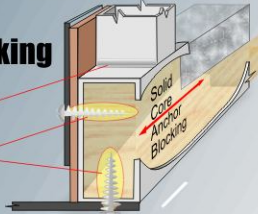

other brands

SPOT WELDS
WEAKER JOINTS
WEAKER ANCHOR SCREWS
ONLY ONE OR TWO THREADS ARE SECURING THE FASTENER

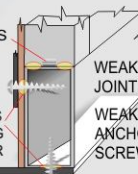

Full Walk On Roof - 29 Employees On Board!



When Northwood advertises a "Full Walk-On Roof" for our slide out truck campers, you not only can walk everywhere on the roof, but you could also invite a couple dozen of your friends to join you!

We tested the strength of our 1150 full-wall slide model by loading the roof with 29 of our camper line employees (a good testimonial for our camper jacks too!).

Structural Aluminum Basement Floor Frame



Big holding tanks require a 'Big' floor structure...
That's the Arctic Fox floor!

Thick wall aluminum basement floor joists support our holding tanks under the basement of every Arctic Fox Truck Camper.

Fully Insulated Holding Tank Compartments



Dual Rams - Dual Battery Rack - Dual LPG Tanks



Dual Ram Rack and Pinion Slide Assembly in All Slide Outs



Sliding Dual Battery Tray Holds **Two** Group 29 Batteries
420 Amp Total Capacity



Dual 30 LPG Tanks w/Auto Change-over Regulator

You'll appreciate the large tank capacities in the Arctic Fox too:
Up to 55 gallon fresh, 44 gallon grey, and 43 gallon black tank capacities.

Your Local Nash Dealer is:



Dec 2010



PO BOX 3359
59948 Downs Road
La Grande, OR 97850

Phone 541.962.6274
Fax 541.963.4392
www.northwoodmfg.com