

Region 3 District 8

GREEN SPRINGS HIGHWAY No. 21

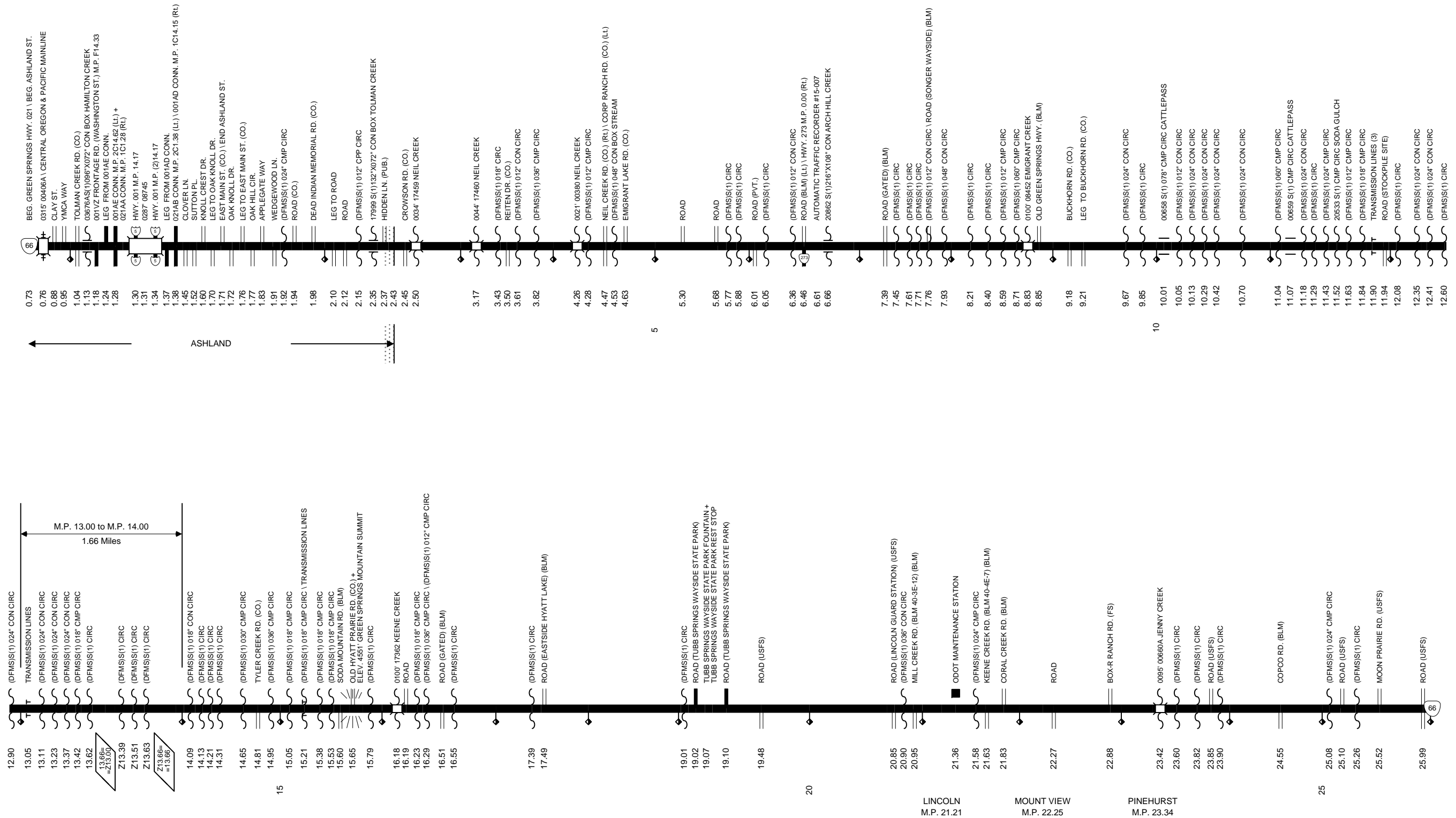

Region 3 District 8 / Region 4 District 11

GREEN SPRINGS HIGHWAY No. 21

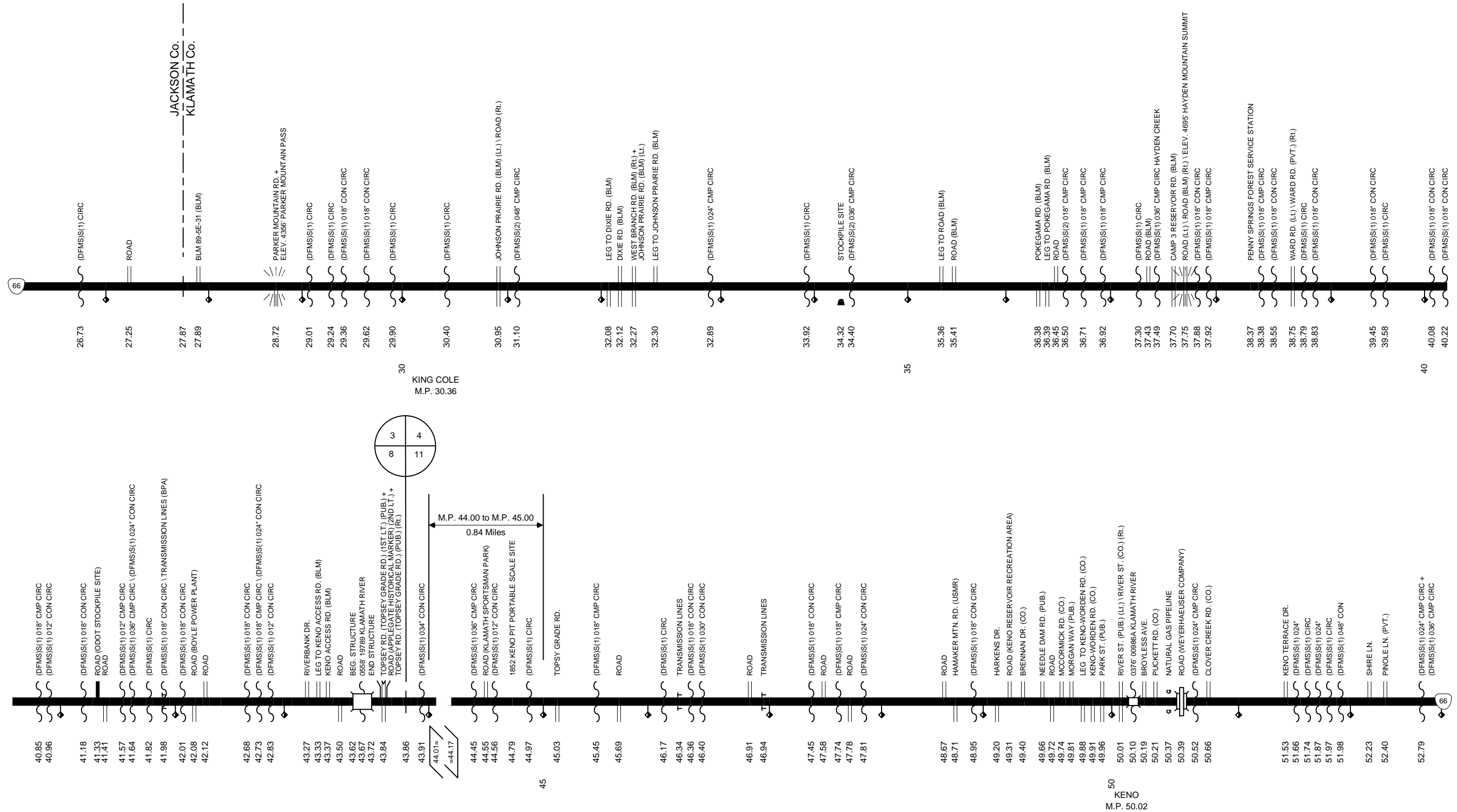

Region 4 District 11

GREEN SPRINGS HIGHWAY No. 21

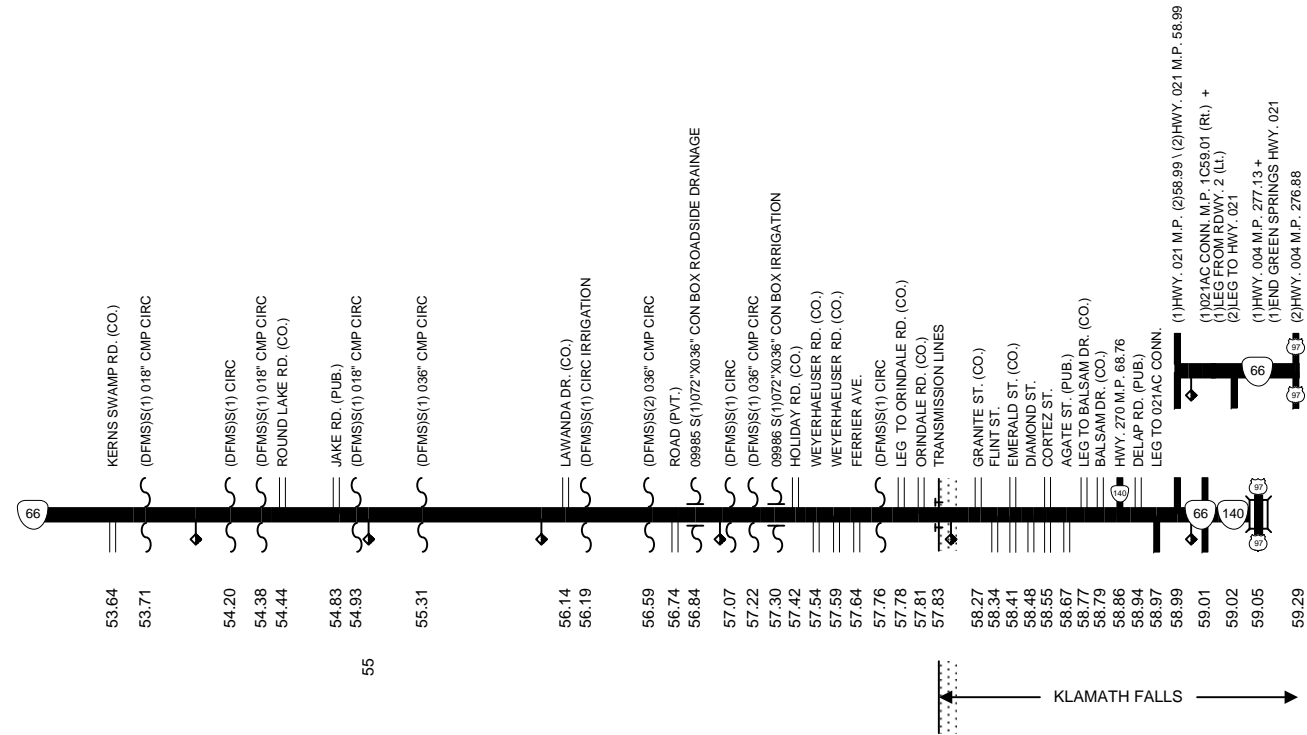

GREEN SPRINGS HWY. CONNECTION

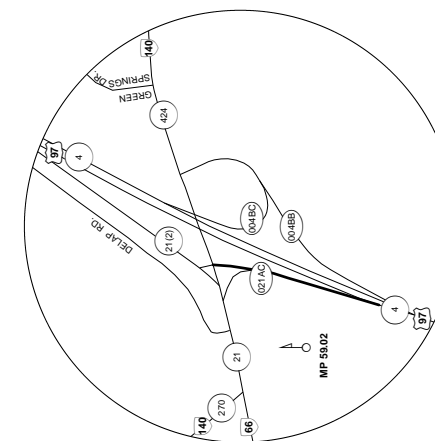

CONNECTION No. 1 (021AC)

59.01 GREEN SPRINGS HWY. CONNECTION \ HWY. 021 M.P. 59.01
 59.05 LEG FROM HWY. 021
 59.18 HWY. 004 M.P. 277.33

Total Length 0.17 Miles

PACIFIC HWY. CONNECTIONS

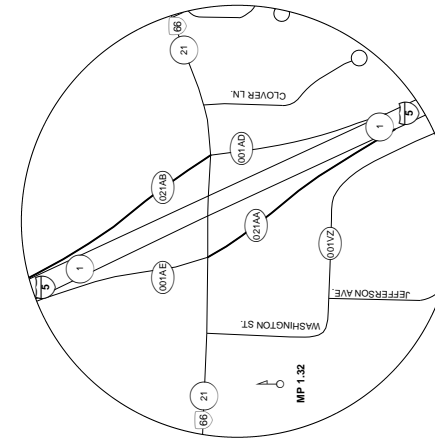

CONNECTION No. 1 (021AA)

1.28 PACIFIC HWY. CONNECTIONS +
 1.33 HWY. 021 M.P. 1.28
 1.55 (DFMS/S)1' CIRC
 HWY. 001 M.P. 13.93

Total Length 0.27 Miles

CONNECTION No. 2 (021AB)

1.38 HWY. 021 M.P. 1.38
 1.65 HWY. 001 M.P. (2)14.42

Total Length 0.27 Miles

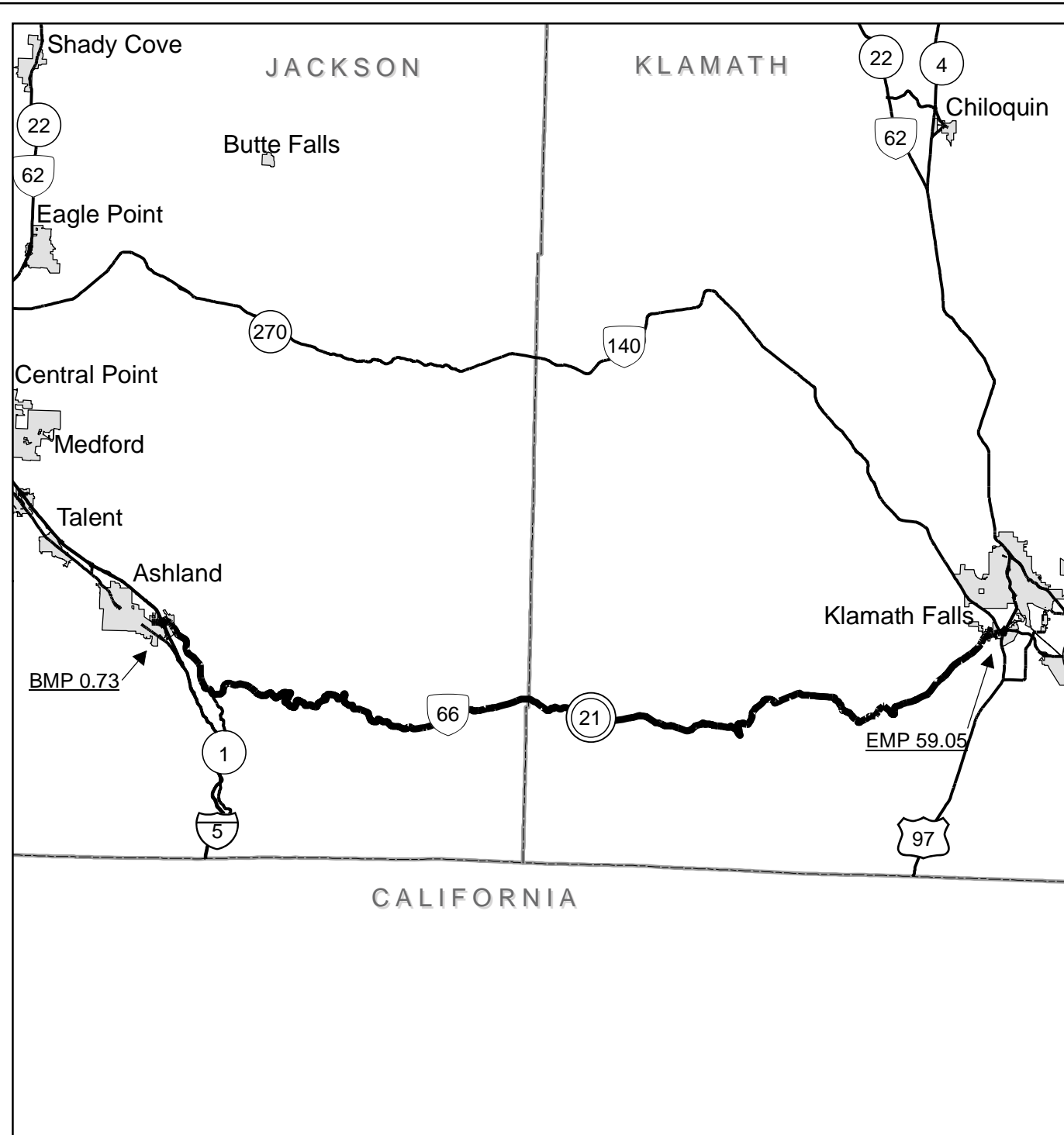

Legend

- State Highway No. 21
- State Highways
- County Boundaries
- City Limits

- Interstate, US Route, State Route Markers
- State Highways

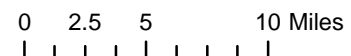

The same information displayed on the Straightline Charts is updated monthly and available in tabular form on ODOT's Internet site. Use the Highway Inventory Summary report for more detailed information.

[HTTP://WWW.OREGON.GOV/ODOT/TD/TDATA/OTMS/OTMS_Highway_Reports.shtml](http://www.oregon.gov/ODOT/TD/TDATA/OTMS/OTMS_Highway_Reports.shtml)

NOTE: Milepoints on Straightline Chart are not to scale.

Note:

Jurisdiction of intersecting local roads as of:

Jackson County	2010
Klamath County	2010