

***“Buffalo’s greatest resource is its people,  
Buffalo’s greatest natural resource is its water.”***



**Revitalize WNY’s waterfront by restoring economic growth based on the region’s legacy of pride, urban significance & natural beauty.**

# Redevelopment Vision: Buffalo's Waterfront Future



# Buffalo's Waterfront

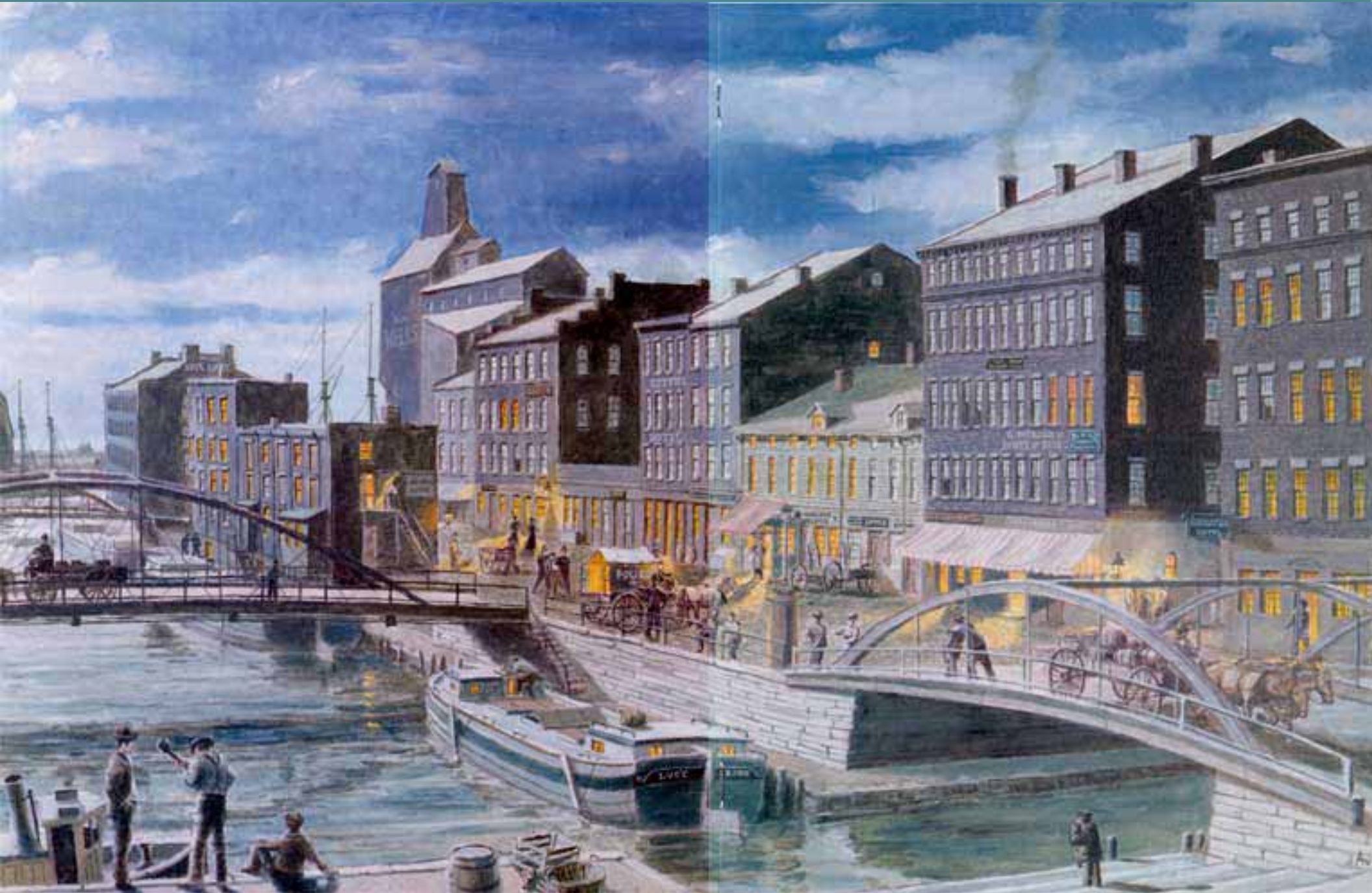

ERIE CANAL HARBOR DEVELOPMENT CORPORATION **BUFFALO CANAL SIDE**

# Hub of Commerce



# Guiding Principles

## Accessibility

- Public Access
- Public Use
- No/Low Cost Opportunity

## Diverse Use

- Neighborhood
- Mixed Use
- Recreation, Cultural, Community

## Design

- Urban
- Green & Sustainable
- 4 Seasons

## Financial Payback

- Economic Growth
- Increase Tax Revenue
- Local Business Opportunity/Jobs



# Completed Phases



# Success on the Waterfront since 2008



# Canal Side Project Components





# Multi-Modal Connections

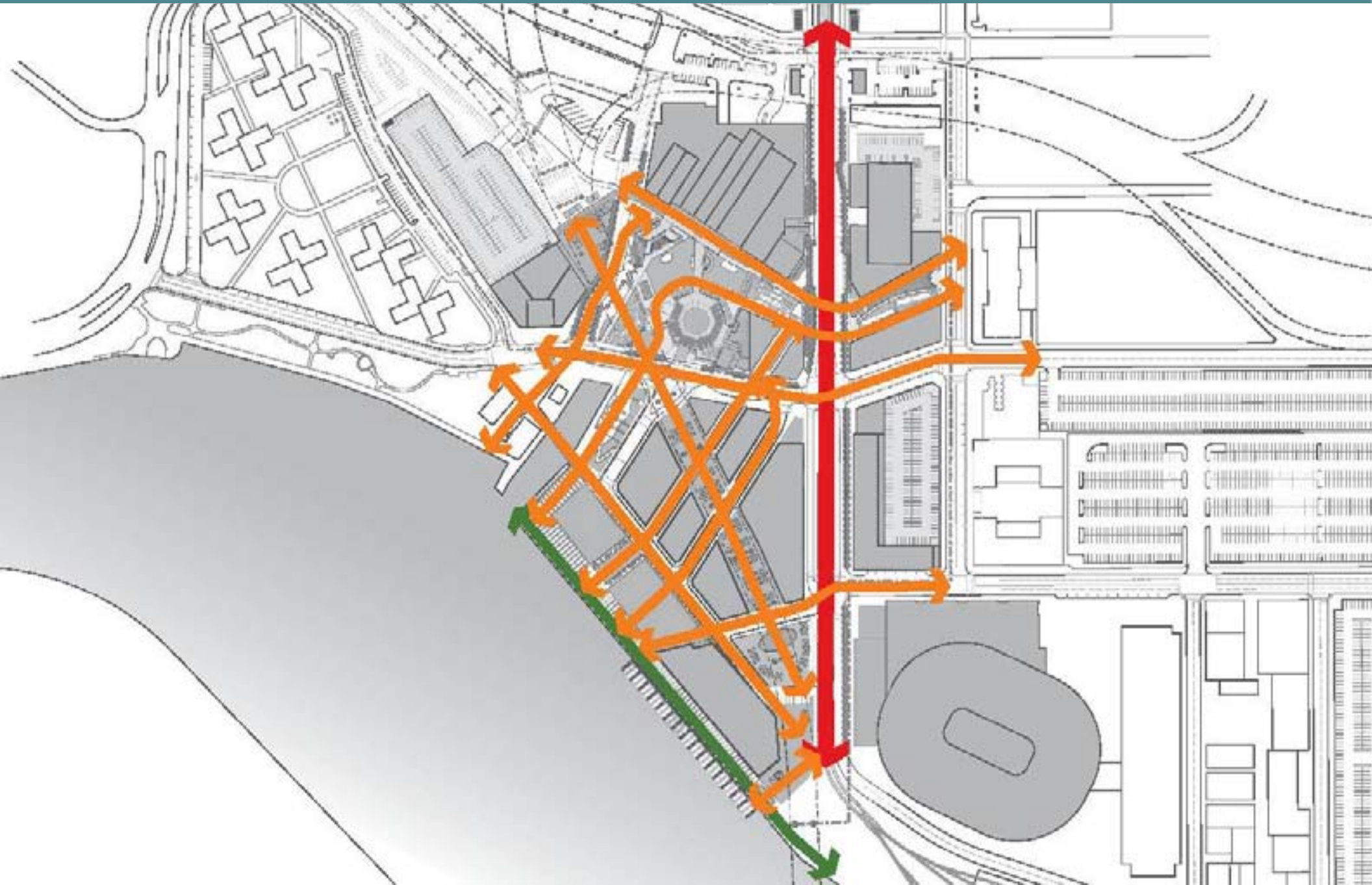

# Current Phase: Public Infrastructure



# Modified General Project Plan

## Project Components under MGPP

- Canals
- Towpaths
- Landscaping
- 1 Level of Below Grade Parking



## Project Timeline:

- November* – End of MGPP Public Comment Period
- December* – Necessary Approvals
- January 2011* – Award Design/Build Contract
- Spring 2011* – Begin Construction of Public infrastructure

# Modified General Project Plan

## Canal Side Funding Sources

- *New York Power Authority*  
\$105,000,000
- *New York State Appropriation*  
\$21,000,000
- *ESDC- Blueprint Grant*  
\$5,000,000
- *Federal Transit Authority*  
\$11,800,000
- *Federal Highway Authority*  
\$11,300,000
- *Private Investment*  
\$140,880,000

**Total Funding Sources: \$294,980,000**

## MGPP Project Funding Uses

- Canals and Towpaths  
\$32,593,623
- Sub-Mechanical Basement  
\$1,854,621
- 1 Level of Below Grade Parking  
\$7,496,058
- Miscellaneous  
\$1,300,000
- Design Contingency  
\$5,000,000
- Soft Cost  
\$2,800,000

**Total Funding Uses: \$51, 044,302**

# East Canal



# The Barges

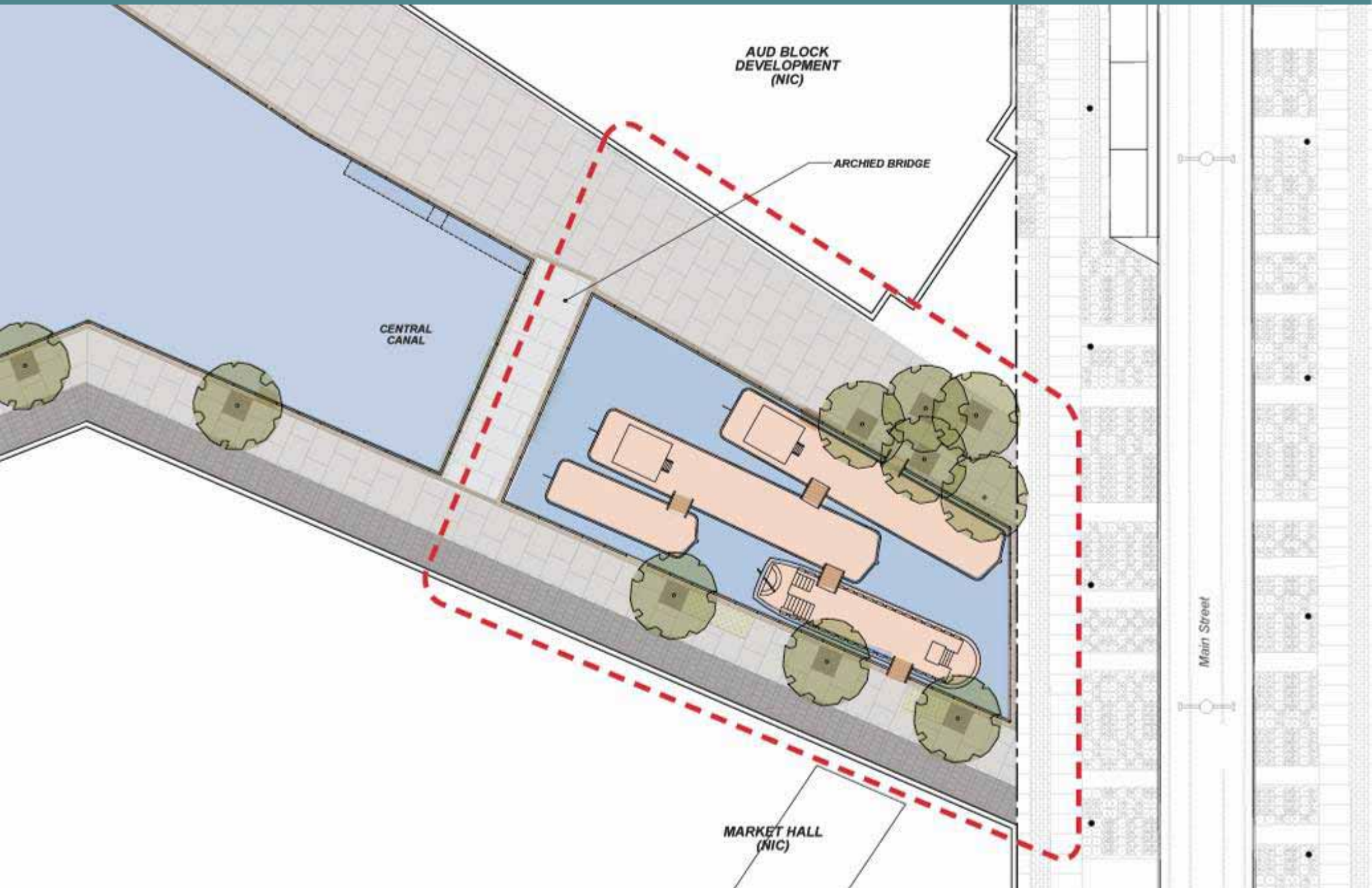

# Historic Barges - Packet Boats

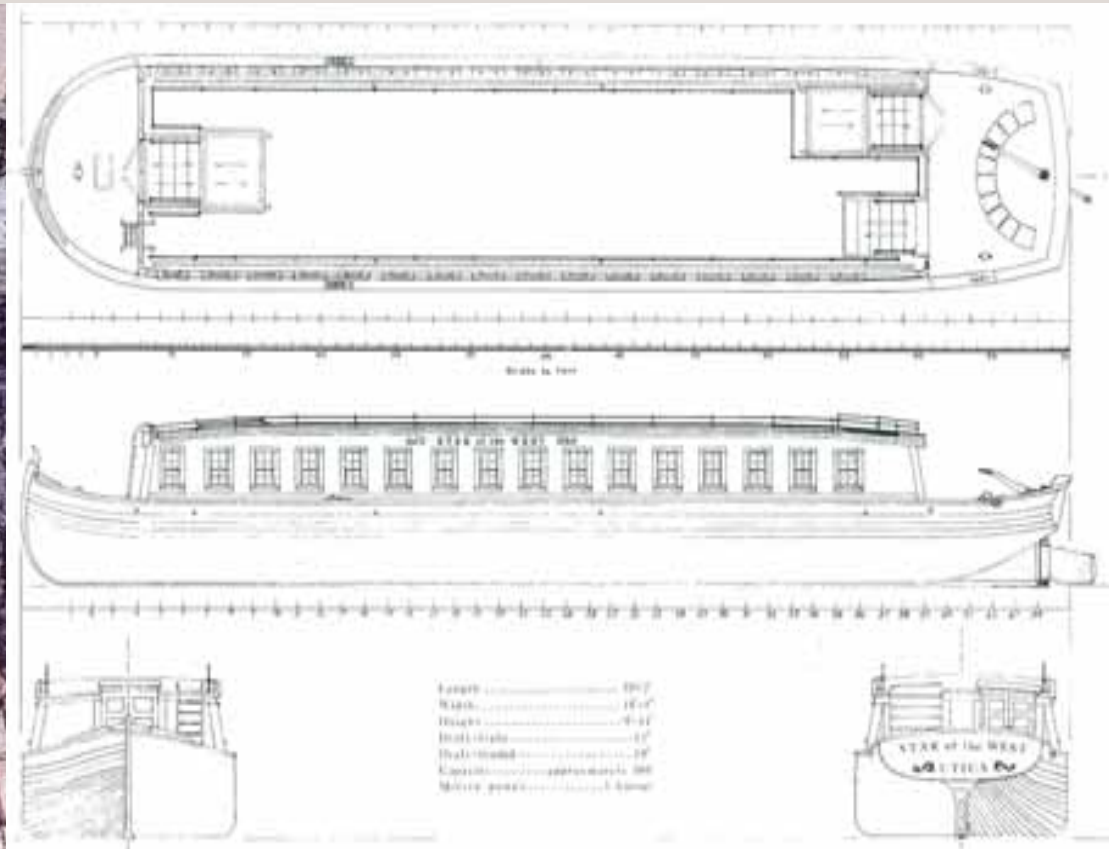
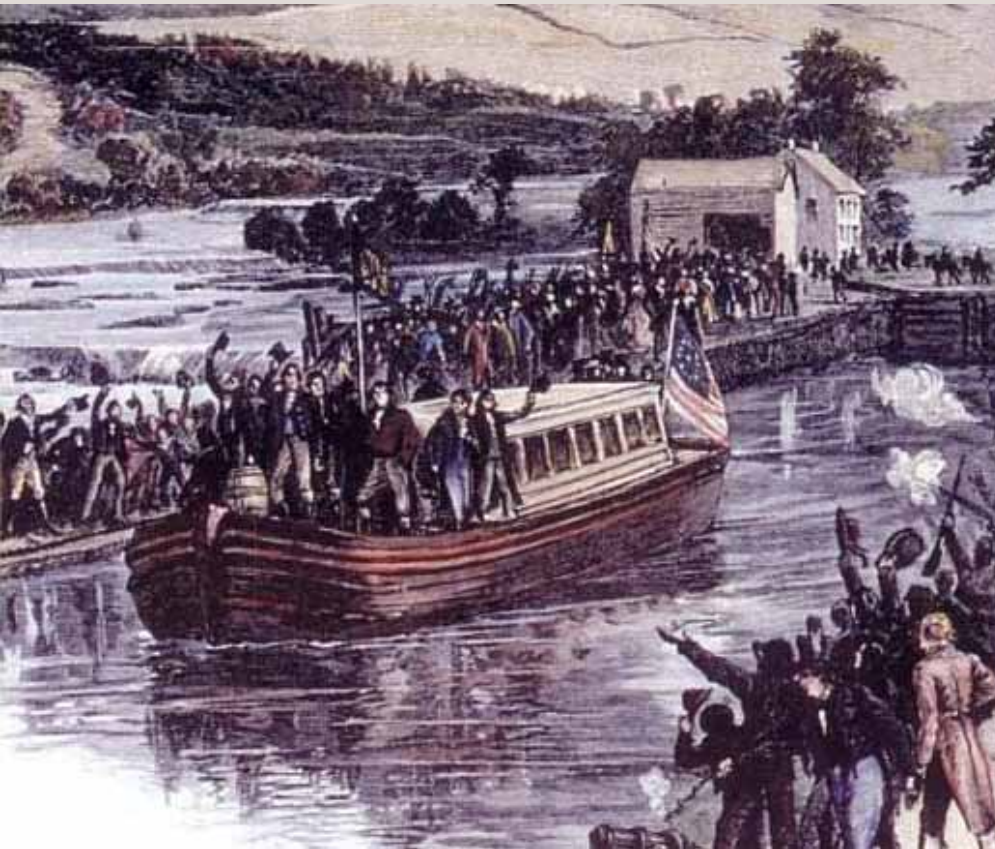

- Passenger Boats
- Sleek with round bottoms
- Seneca Messenger Packet Boat, first to travel length of Erie Canal

