

# MOULD BLOCKS Parts List

Your bullet mould is a piece of precision equipment which, with a little care and common sense, can easily last your lifetime. Before using a new mould, it must be cleaned in alcohol, or other suitable solvent, to remove the protective film of oil. Never cast bullets with oil still in the mould as the oil will vaporize, leaving an undesirable residue.

Detachable mould handles are available in two sizes to fit single and double, or four cavity moulds. A shooter may interchange the blocks in his handles as he wishes, provided he uses that size block for which the handles are intended. It should be noted that in current single cavity moulds, a double cavity-size block is used to make a single cavity mould.

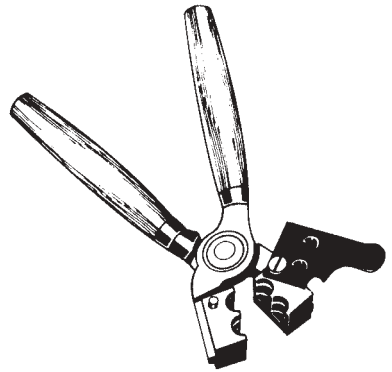

## SINGLE CAVITY MOULD BLOCK PARTS

1	Cutter Screw	2998292
2	Spring Washer	2990202
3	Sprue Cutter	2990205
4	Stop Pin*	2990206
5	Large Single Block Assembly*	2990206
6	Handle Screw (2)	2990200
7	Set Screw #10-32	2990751

\*Not sold separately

Mould Rebuild Kit – Contains complete set of replacement screws, washer and sprue cutter.  
Single cavity - 2680100

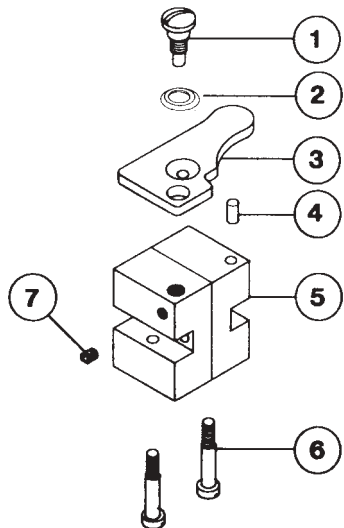

### DOUBLE CAVITY MOULD BLOCK PARTS

1	Cutter Screw	2998292
2	Spring Washer	2990202
3	Sprue Cutter	2998291
4	Stop Pin*	2990206
5	Large Single Block Assembly*	2990222
6	Set Screw #10-32	2990751
7	Handle Screw (2)	2990200

\*Not sold separately

Mould Rebuild Kit – Contains complete set of replacement screws, washer and sprue cutter.  
 Double cavity - 2680102

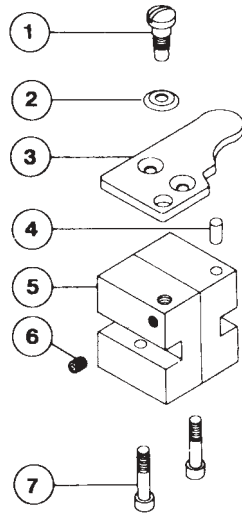

### FOUR CAVITY MOULD BLOCK PARTS

1	Hold Down Screw	2990102
2	Four Cavity Block Assembly*	2990226
3	Set Screw #10-32	2990751
4,5	Hinge Screw w/Lock Washer	2990249
6	Sprue Cutter	2998294
7	Handle Screw (2)	2990103

\*Not sold separately

Mould Rebuild Kit – Contains complete set of replacement screws, washer and sprue cutter.  
 Four cavity - 2680104

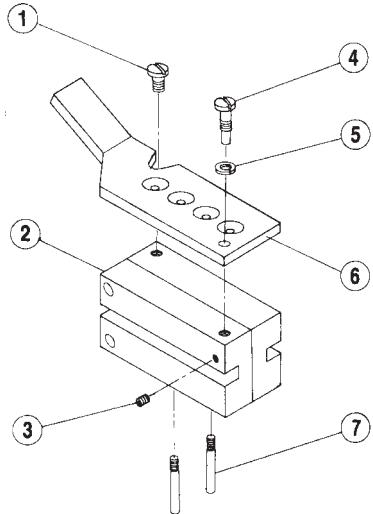

Visit our complete Lyman website at  
[www.lymanproducts.com](http://www.lymanproducts.com)