







**Character area 3:
The Harbour**

Key

-  Character Area boundary
-  Scheduled Monument
-  Listed Building
-  Other Historic Building
-  Historic Plot
-  Other Historic Site

Character Area 3: The Harbour

This sheet summarises the comprehensive assessments of character and regeneration opportunities in sections 5 and 6 of the report.

Character summary

The harbour forms a secluded and sheltered, inward looking space set apart from the surrounding bustle of the town. The cliff face and rubble revetment wall surrounding it on the landward side provides a strong sense of enclosure, extended by the overlooking properties of Fore Street and Dane Hill. It is still a working environment, with a fishing fleet of brightly coloured boats and collections of lobster pots and plastic crates stacked along the pier arms. The built environment is a mix of robust stone built historic structures and more temporary timber framed buildings.

Regeneration opportunities

- **Raise the profile of the harbour**
Recognise, enhance and promote the area as a key asset for the town
- **Improve the harbour's accessibility**
Define gateways to the harbour within the townscape and enhance approach routes. Explore alternative connections such as Treffry's mineral tramway tunnel and links to the beach
- **Enhance the public realm**
Acknowledge, respect and contribute to the special character of the area
- **Increase the vitality of the harbour**
Retain the central role of the harbour as a place of work. Investigate opportunities for further fishing-related activity
- **Explore the potential of interpretation opportunities**



The working harbour.



Treffry's mineral tramway tunnel: potential opportunity to improve access to the harbour

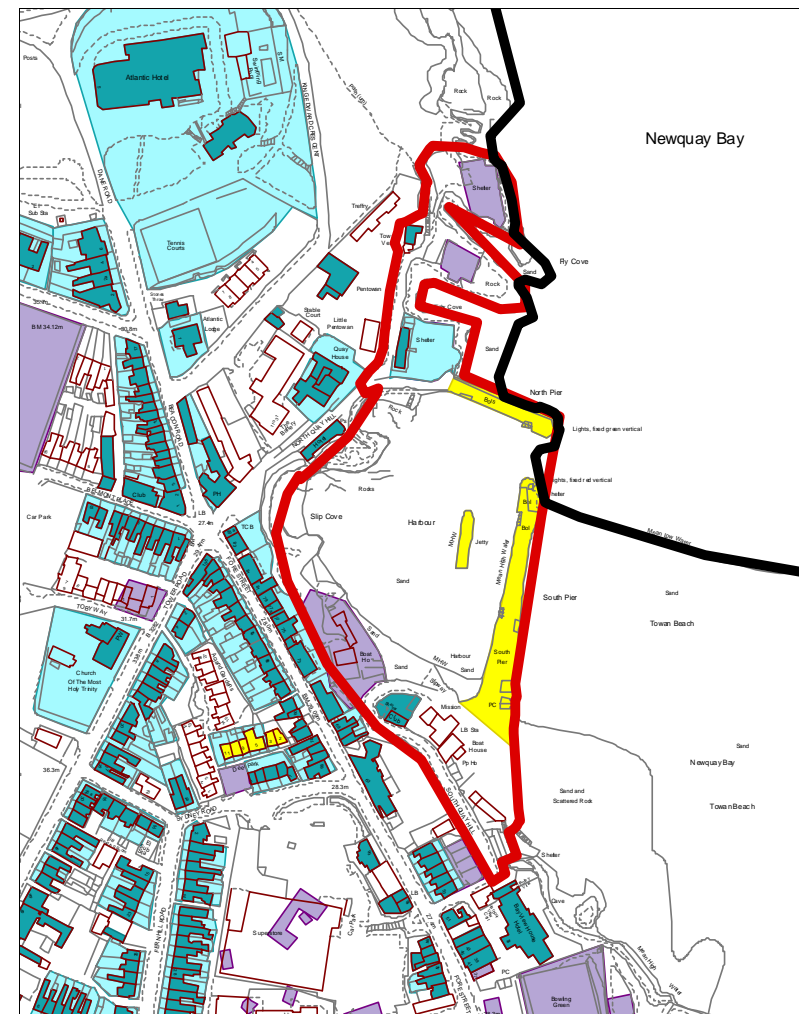

Site and partial remains of the Active fish cellar: potential for harbour related interpretation centre

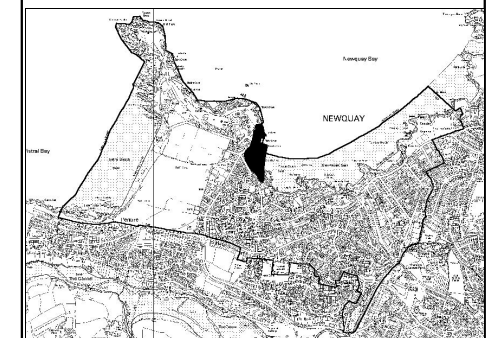

CCC licence No. LA076538. All material copyright (c) Cornwall County Council 2002.

Cornwall Archaeological Unit
Historic Environment
Cornwall County Council
(01872) 323603
cau@cornwall.gov.uk

