

COMMUNITY/NEIGHBOURHOOD PROFILES

Neighbourhood Information

Our community is comprised of ten distinct neighbourhoods. Each offers something unique for potential residential or commercial needs. The ten neighbourhoods are highlighted on a map on the following page and a detailed description of each neighbourhood follows.

Population by Neighbourhood

The population of each neighbourhood varies substantially. The West Flat boasts the largest number of residents, followed closely by the East Hill. Conversely, the Nordale/Hazeldell area has the least amount of residents with 825. The rest of the neighbourhoods have similar populations ranging from 2,425 to 3,725.

Average Employment Income

The average employment income varies quite substantially among the neighbourhoods. The neighbourhood with the highest employment income is Crescent Acres at \$36,358 where the lowest is the West Flat at \$21,581.

Labour Force

The neighbourhood with the lowest labour force participation rate is Midtown at 49.8%. Crescent Acres boasts the highest labour force participation rate at 85.4%.

Neighbourhood	Population	Average Employment Income	Labour Force (Participation Rate)
Carlton Park	2,940	\$32,451	76.7%
Crescent Acres	2,515	\$36,358	85.4%
Crescent Heights	3,010	\$27,600	71.5%
East Flat	3,320	\$24,736	68.7%
East Hill	5,495	\$25,304	63.4%
Midtown	3,725	\$21,671	49.8%
Nordale/Hazeldale	825	\$34,012	75.4%
Riverview	2,425	\$25,965	80.9%
West Flat	5,545	\$21,581	56.1%
West Hill	3,635	\$33,979	62.8%

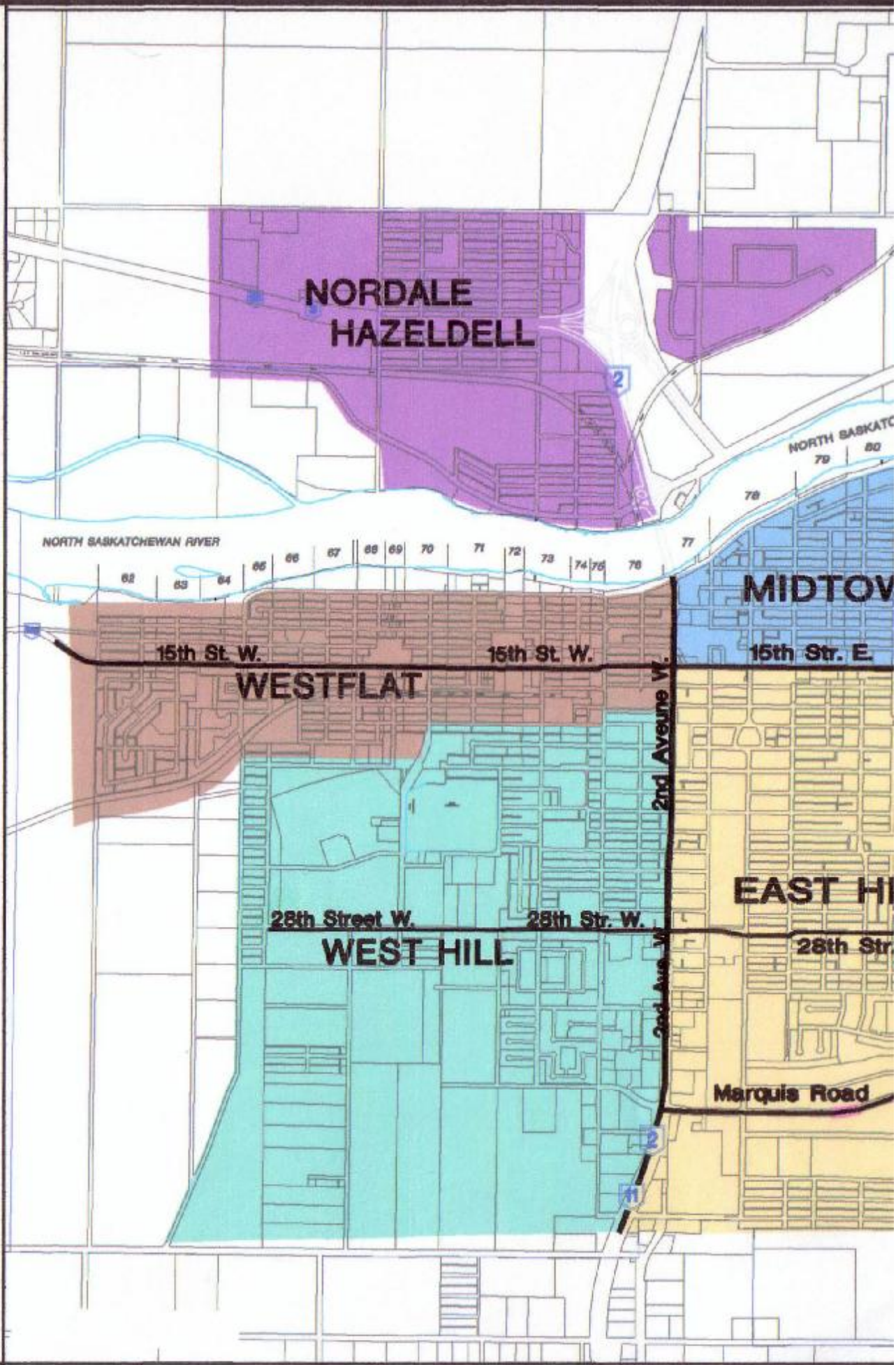

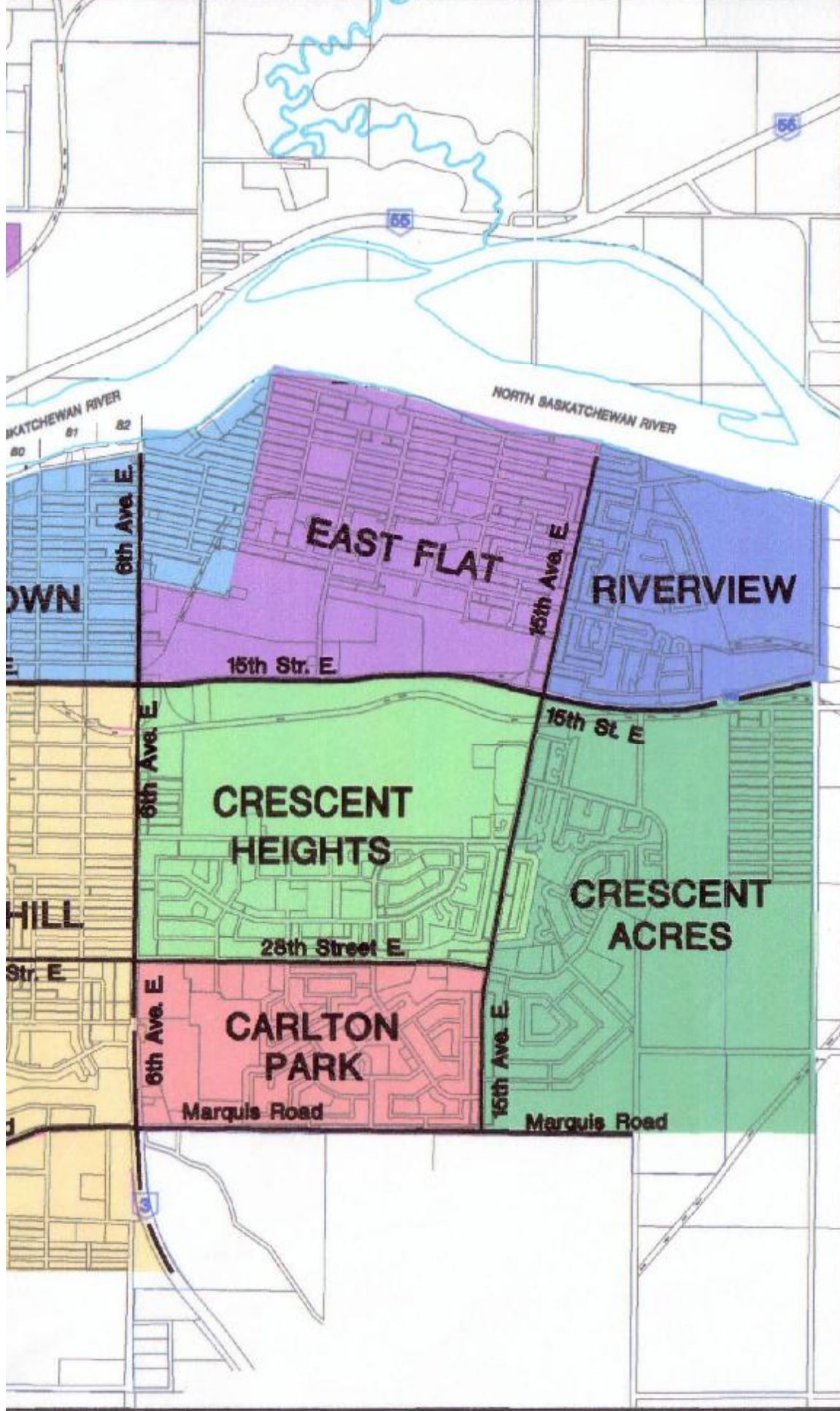

- CARLTON PARK**
- CRESCENT ACRES**
- CRESCENT HEIGHTS**
- EAST FLAT**
- EAST HILL**
- MIDTOWN**
- NORDALE/HAZELDELL**
- RIVERVIEW**
- WEST FLAT**
- WEST HILL**

BOURHOOD PROFILES

SCALE **NTS**
 DWG. No. **00000000**

DAY / MONTH / YEAR
21 / 08 / 04
 DRAWN BY
K JOHNSON

CARLTON PARK

Location

Carlton Park is a small neighbourhood bound between Marquis Road, 6th Avenue East, 28th Street East and 15th Avenue East.

Population

In 2001, Carlton Park had a population of 2,940, which is 8.79% of the overall population of the city. 23.30% of the population in Carlton Park is of Aboriginal descent, which is 6.73% of the total Aboriginal population in Prince Albert.



Income

The average employment income in Carlton Park is \$32,451, making it the fourth highest neighbourhood in terms of average employment income in the city. The average family income is \$72,631, which is the third highest of all neighbourhoods in Prince Albert. 18.87% of all families in the neighbourhood are considered to be low income, which places it fourth out of all neighbourhoods.

	Carlton Park	City of Prince Albert	Overall Ranking
Average Employment Income	\$32,451	\$27,682	4th
Males	\$41,720	\$33,603	4th
Females	\$22,782	\$21,820	4th
Composition of Total Income			
Employment Income	84.4%	74.7%	3rd
Government Transfer Payments	8.5%	15.1%	8th
Other	7.0%	10.2%	8th
Average Family Income	\$72,631	\$56,022	3rd
Median Family Income	\$65,586	\$48,655	2nd
# of Economic Families	795	9,145	7th
# of Low Income Families	150	1,795	6th
% of Low Income Families	18.87%	19.63%	4th

CARLTON PARK

Schools

- Carlton Comprehensive High School—665—28th Street East
- Children's Choice Pre-School—3100—Dunn Drive

Education

The following are the totals for the levels of Education for the residents of Carlton Park and for the City of Prince Albert as a whole.

<i>Levels of Education</i>	Carlton Park #	Carlton Park %	Prince Albert #	Prince Albert %
Total Population 20 years and over by highest level of schooling	1,930		22,590	
Less than Grade 9	55	2.85%	2,330	10.31%
Grades 9 to 12	620	32.12%	7,650	33.86%
Without high school graduation certificate	365	18.91%	5,325	23.57%
With high school graduation certificate	250	12.95%	2,325	10.29%
Trades certificate or diploma	275	14.25%	3,470	15.36%
College	405	20.98%	4,775	21.13%
Without certificate or diploma	165	8.55%	315	1.39%
With certificate or diploma	240	12.44%	3,460	15.31%
University	575	29.79%	4,370	19.34%
Without degree	175	9.07%	1,620	7.17%
Without certificate or diploma	110	5.7%	1,130	5.00%
With certificate or diploma	60	3.11%	490	2.17%
With bachelor's degree or higher	400	20.73%	2,745	12.15%

When comparing Carlton Park to the City of Prince Albert, 2.85% of residents in Carlton Park have less than a Grade nine education whereas 10.31% of Prince Albert's population has less than Grade nine. Carlton Park is comparable (14.25%, 20.98%) to the rest of Prince Albert (15.36%, 21.13%) in attaining a Trades certificate or diploma and some College education. 29.79% of Carlton Park residents have some University education whereas only 19.34% of Prince Albert has University education.

CARLTON PARK

Labour Force

The following is a Labour Force comparison between Carlton Park and the entire city as a whole. Carlton Park's percentages seem to fair better than the overall city averages.

<i>Population</i>	Prince Albert	Carlton Park
Total Population—15 and over	25,215	2,210
Total Labour Force — 15 and over	16,600	1,695
Employed	15,160	1,545
Unemployed	1,500	155
Not in Labour Force —15 and over	8,555	510
Participation Rate—15 years and over	66.1%	76.7%
Employment Rate—15 years and over	60.1%	69.9%
Unemployment Rate—15 years and over	9%	9.1%

Recreation

- Frank J. Dunn Swimming Pool
- Prince Albert Comuniplex
- Prime Minister's Park
- Carlton Park Community Club (Hall, Meeting Room, Day Care, Outdoor Hockey Rink, Pleasure Skating Rink, Play Equipment)

Religion

- First Baptist Church—1351—28th Street East

Housing

- The Average gross rent is \$561.00
- The Average value of a dwelling is \$126,024.00

Health Care Facilities

- Mont St. Joseph Home Inc.—777—28th Street East

CARLTON PARK



Carlton Park allows for a nice walk on a path through a relaxing park that leads past beautiful homes surrounded by lush greenery.



CRESCENT ACRES

Location

Crescent Acres is a medium sized neighbourhood bound between Marquis Road, 15th Avenue East, 15th Street East and reaches to the city limits in the East.

Population

In 2001, Crescent Acres had a population of 2,515, which is 7.52% of the overall population of the city. 12.9% of the population in Crescent Acres is of Aboriginal descent, which is 3.19% of the total Aboriginal population in Prince Albert.



Income

The average employment income in Crescent Acres is \$36,358, making it the highest neighbourhood in terms of average employment income in the city. The average family income is \$86,538, which is the highest of all neighbourhoods in Prince Albert. 5.26% of all families in the neighbourhood are considered to be low income, which places it ninth out of all neighbourhoods.

	Crescent Acres	City of Prince Albert	Overall Ranking
Average Employment Income	\$36,358	\$27,682	1st
Males	\$46,461	\$33,603	1st
Females	\$26,586	\$21,820	1st
Composition of Total Income			
Employment Income	88.8%	74.7%	1st
Government Transfer Payments	4.5%	15.1%	10th
Other	6.6%	10.2%	9th
Average Family Income	\$86,538	\$56,022	1st
Median Family Income	\$75,974	\$48,655	1st
# of Economic Families	665	9,145	9th
# of Low Income Families	35	1,795	2nd
% of Low Income Families	5.26%	19.63%	9th

CRESCENT ACRES

Education

The following are the totals for the levels of Education for the residents of Crescent Acres and for the City of Prince Albert as a whole.

<i>Levels of Education</i>	Crescent Acres #	Crescent Acres %	Prince Albert #	Prince Albert %
Total Population 20 years and over by highest level of schooling	1,610		22,590	
Less than Grade 9	50	3.11%	2,330	10.31%
Grades 9 to 12	395	24.53%	7,650	33.86%
Without high school graduation certificate	200	12.42%	5,325	23.57%
With high school graduation certificate	195	12.11%	2,325	10.29%
Trades certificate or diploma	255	15.84%	3,470	15.36%
College	455	28.26%	4,775	21.13%
Without certificate or diploma	55	3.42%	315	1.39%
With certificate or diploma	395	24.53%	3,460	15.31%
University	455	28.26%	4,370	19.34%
Without degree	150	9.32%	1,620	7.17%
Without certificate or diploma	105	6.52%	1,130	5.00%
With certificate or diploma	45	2.80%	490	2.17%
With bachelor's degree or higher	305	18.94%	2,745	12.15%

When comparing Crescent Acres to the City of Prince Albert, 3.11% of residents in Crescent Acres have less than a Grade nine education whereas 10.31% of Prince Albert's population has less than Grade nine. Crescent Acres is comparable at 15.84% to the rest of Prince Albert at 15.36%, in attaining a Trades certificate or diploma. Crescent Acres has a higher population in attaining some College education at 28.26% then the rest of Prince Albert at 21.13%. 28.26% of Crescent Acres residents have some University education whereas only 19.34% of Prince Albert has some University Education.

CRESCENT ACRES

Schools

- Ecole Vickers School—2800 Bradbury Drive
- St. Francis School—1695 Olive Diefenbaker Drive
- Wee Care Preschool—1510 Olive Diefenbaker Drive

Labour Force

The following is a Labour Force comparison between Crescent Acres and the entire city as a whole. Crescent Acre's percentages seem to fair much better than the overall city averages.

<i>Population</i>	Prince Albert	Crescent Acres
Total Population—15 and over	25,215	1,855
Total Labour Force — 15 and over	16,600	1,580
Employed	15,160	1,510
Unemployed	1,500	70
Not in Labour Force —15 and over	8,555	270
Participation Rate—15 years and over	66.1%	85.4%
Employment Rate—15 years and over	60.1%	81.6%
Unemployment Rate—15 years and over	9%	4.4%

Recreation

- Crescent Acres Park
- Crescent Acres Community Club (Multi Purpose Hall, Meeting Room, Gymnasium, Outdoor Hockey Rink, Play Equipment, Basketball Courts, Tennis Courts)

Religion

- Cornerstone Free Methodist Church—2200—15th Avenue East
- Crossroads Pentecostal Assembly—1510 Olive Diefenbaker Drive
- Messiah Lutheran Church—1796 15th Avenue East

Housing

- The Average gross rent is \$599.00
- The Average value of a dwelling is \$145,897.00

CRESCENT ACRES



Crescent Acres is full of many things to see and do including parks and playgrounds for people of all ages.



CRESCENT HEIGHTS

Location

Crescent Heights is a small neighbourhood bound between 28th Street East, 6th Avenue East, 15th Street East and 15th Avenue East.

Population

In 2001, Crescent Heights had a population of 3,010, which is 9.00% of the overall population of the city. 19.77% of the population in Crescent Heights is of Aboriginal descent, which is 5.84% of the total Aboriginal population in Prince Albert.



Income

The average employment income in Crescent Heights is \$27,600, making it the fifth highest neighbourhood in terms of average employment income in the city. The average family income is \$62,644, which is the fifth highest of all neighbourhoods in Prince Albert. 12.90% of all families in the neighbourhood are considered to be low income, which places it seventh out of all neighbourhoods.

	Crescent Heights	City of Prince Albert	Overall Ranking
Average Employment Income	\$27,600	\$27,682	5th
Males	\$32,134	\$33,603	5th
Females	\$22,581	\$21,820	5th
Composition of Total Income			
Employment Income	74.1%	74.7%	5th
Government Transfer Payments	11.6%	15.1%	6th
Other	14.5%	10.2%	1st
Average Family Income	\$62,644	\$56,022	5th
Median Family Income	\$58,854	\$48,655	5th
# of Economic Families	930	9,145	5th
# of Low Income Families	120	1,795	5th
% of Low Income Families	12.90%	19.63%	7th

CRESCENT HEIGHTS

Education

The following are the totals for the levels of Education for the residents of Crescent Heights and for the City of Prince Albert as a whole.

<i>Levels of Education</i>	Crescent Heights #	Crescent Heights %	Prince Albert #	Prince Albert %
Total Population 20 years and over by highest level of schooling	2,115		22,590	
Less than Grade 9	95	4.49%	2,330	10.31%
Grades 9 to 12	660	31.21%	7,650	33.86%
Without high school graduation certificate	420	19.86%	5,325	23.57%
With high school graduation certificate	240	11.35%	2,325	10.29%
Trades certificate or diploma	275	13.00%	3,470	15.36%
College	550	26.00%	4,775	21.13%
Without certificate or diploma	140	6.62%	315	1.39%
With certificate or diploma	415	19.62%	3,460	15.31%
University	530	25.06%	4,370	19.34%
Without degree	225	10.64%	1,620	7.17%
Without certificate or diploma	165	7.80%	1,130	5.00%
With certificate or diploma	60	2.84%	490	2.17%
With bachelor's degree or higher	310	14.66%	2,745	12.15%

When comparing Crescent Heights to the City of Prince Albert, 4.49% of residents in Crescent Heights have less than a Grade nine education whereas 10.31% of Prince Albert's population has less than Grade nine. Crescent Heights is comparable at 13% to the rest of Prince Albert at 15.36%, in attaining a Trades certificate or diploma. Crescent Heights has a higher population in attaining some College education at 26% then the rest of Prince Albert at 21.13%. 25.06% of Crescent Heights residents have some University education whereas only 19.34% of Prince Albert has some University Education.

CRESCENT HEIGHTS

Schools

- Ecole Holy Cross School—2051—15th Avenue East.
- John Diefenbaker School—1090 Branion Drive
- Turgeon W.F.A. Catholic School—1180 Branion Drive

Labour Force

The following is a Labour Force comparison between Crescent Heights and the entire city as a whole. Crescent Heights' percentages seem to fair better than the overall city averages.

<i>Population</i>	Prince Albert	Crescent Heights
Total Population—15 and over	25,215	2,365
Total Labour Force — 15 and over	16,600	1,690
Employed	15,160	1,540
Unemployed	1,500	155
Not in Labour Force —15 and over	8,555	670
Participation Rate—15 years and over	66.1%	71.5%
Employment Rate—15 years and over	60.1%	65.1%
Unemployment Rate—15 years and over	9%	9.2%

Religion

- Scarborough Baptist Church—2650 6th Avenue East

Housing

- The Average gross rent is \$546.00
- The Average value of a dwelling is \$112,782.00

Recreation

- Cooke Municipal Golf Course
- Prince Albert Golf and Curling Club
- Crescent Heights Community Club (Indoor Arena, Outdoor Hockey Rink, Play Equipment)

CRESCENT HEIGHTS



Crescent Heights is a developed neighbourhood where finding a place to go and pick up last minute groceries or play an 18 hole round of golf are both close at hand.



EAST FLAT

Location

The East Flat is a neighbourhood bound between 15th Street East, 6th Avenue East to Exhibition Drive, Exhibition Drive to 8th Avenue East, and finally borders the North Saskatchewan River to 15th Avenue East.

Population

In 2001, the East Flat had a population of 3,320, which is 9.93% of the overall population of the city. 29.97% of the population in the East Flat is of Aboriginal descent, which is 9.77% of the total Aboriginal population in Prince Albert.



Income

The average employment income in the East Flat is \$24,736, making it the eighth highest neighbourhood in terms of average employment income in the city. The average family income is \$50,057, which is the seventh highest of all neighbourhoods in Prince Albert. 18.32% of all families in the neighbourhood are considered to be low income, which places it at fifth out of all neighbourhoods.

	East Flat	City of Prince Albert	Overall Ranking
Average Employment Income	\$24,736	\$27,682	8th
Males	\$30,599	\$33,603	7th
Females	\$19,004	\$21,820	8th
Composition of Total Income			
Employment Income	72.5%	74.7%	6th
Government Transfer Payments	17.7%	15.1%	3rd
Other	9.6%	10.2%	5th
Average Family Income	\$50,057	\$56,022	7th
Median Family Income	\$48,427	\$48,655	7th
# of Economic Families	955	9,145	4th
# of Low Income Families	175	1,795	7th
% of Low Income Families	18.32%	19.63%	5th

EAST FLAT

Housing

- The Average gross rent is \$529.00
- The Average value of a dwelling is \$92,106.00

Health Care Facilities

- Prince Albert Medical Walk-In Clinic—220—800 15th Street East

Education

The following are the totals for the levels of Education for the residents of the East Flat and for the City of Prince Albert as a whole.

<i>Levels of Education</i>	East Flat #	East Flat %	Prince Albert #	Prince Albert %
Total Population 20 years and over by highest level of schooling	2,160		22,590	
Less than Grade 9	235	10.88%	2,330	10.31%
Grades 9 to 12	730	33.80%	7,650	33.86%
Without high school graduation certificate	465	21.06%	5,325	23.57%
With high school graduation certificate	270	12.5%	2,325	10.29%
Trades certificate or diploma	450	20.83%	3,470	15.36%
College	455	21.06%	4,775	21.13%
Without certificate or diploma	125	5.79%	315	1.39%
With certificate or diploma	330	15.28%	3,460	15.31%
University	290	13.43%	4,370	19.34%
Without degree	115	5.32%	1,620	7.17%
Without certificate or diploma	55	2.55%	1,130	5.00%
With certificate or diploma	60	2.78%	490	2.17%
With bachelor's degree or higher	175	8.10%	2,745	12.15%

Comparing the East Flat to the City of Prince Albert, the East Flat is comparable at 10.88% in having less than a Grade nine education to Prince Albert's population at 10.31%. The East Flat is at 20.83% which is superior to the rest of Prince Albert at 15.36%, in attaining a Trades certificate or diploma. The East Flat is equal in attaining some College education at 21.06% to the rest of Prince Albert. 13.43% of East Flat residents have some University education which is less than all of Prince Albert at 19.34%.

EAST FLAT

Schools

- Acadia Centre for Small Business & Entrepreneurship—1-1499 10th Avenue East
- L'Ecole Des Petits—Exhibition Park
- Princess Margaret School—351—13th Avenue East
- St. John Community School—1453—7th Street East
- SIAST-Woodland Campus—1100—15 Street East
- Small World Day Care Cooperative—205—10th Avenue East

Labour Force

The following is a Labour Force comparison between the East Flat and the entire city as a whole. The East Flat percentages seem to fair better than the overall city averages.

<i>Population</i>	Prince Albert	East Flat
Total Population—15 and over	25,215	2,430
Total Labour Force — 15 and over	16,600	1,670
Employed	15,160	1,510
Unemployed	1,500	165
Not in Labour Force —15 and over	8,555	760
Participation Rate—15 years and over	66.1%	68.7%
Employment Rate—15 years and over	60.1%	62.1%
Unemployment Rate—15 years and over	9%	9.9%

Recreation

- Dave Steuart Arena
- Cornerstone Shopping District
- East End Community Club (Multi Purpose Hall, Meeting Room, Day Care, Indoor Arena, Curling Rink, Outdoor Hockey Rink, Pleasure Skating Rink, Play Equipment)

Religion

- Abundant Life Community Church—1201—1st Street East
- Community Bible Church—950—6th Avenue East
- St. George's Anglican Church—1104—4th Street East
- Seventh Day Adventist Church—1112—3rd Street East

EAST FLAT



Enjoy a lovely stroll along the riverbank which is walking distance from most all East Flat homes.



EAST HILL

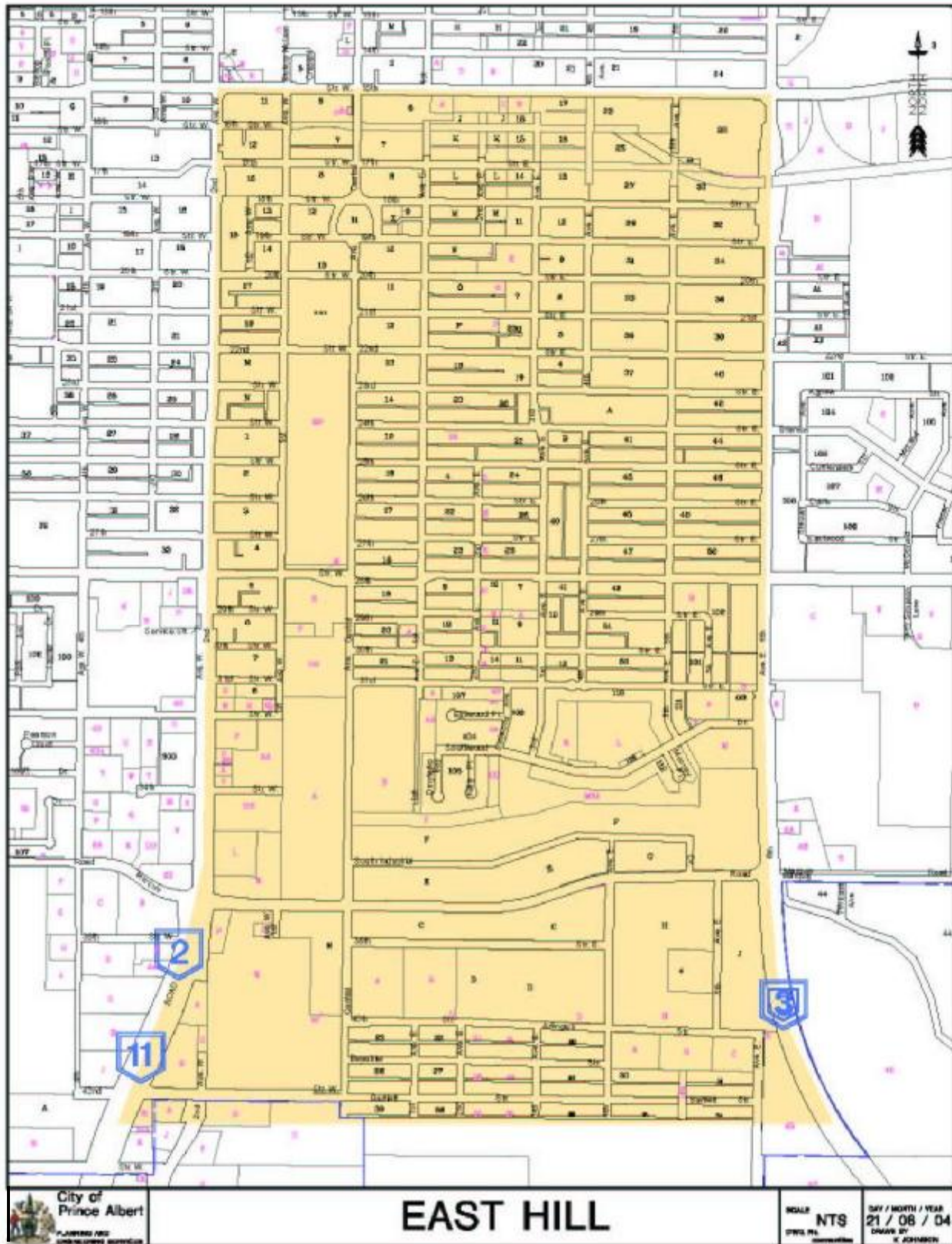

EAST HILL

Location

The East Hill is a large neighbourhood bound between the Southern city limits, 2nd Avenue West, 15th Street East and 6th Avenue East.

Population

In 2001, the East Hill had a population of 5,495, which is 16.44% of the overall population of the city. 29.75% of the population in the East Hill is of Aboriginal descent, which is 16.05% of the total Aboriginal population in Prince Albert.



Income

The average employment income in the East Hill is \$25,304, making it the seventh highest neighbourhood in terms of average employment income in the city. The average family income is \$47,390, which is the eighth highest of all neighbourhoods in Prince Albert. 21.73% of all families in the neighbourhood are considered to be low income, which places it at third out of all neighbourhoods.

	East Hill	City of Prince Albert	Overall Ranking
Average Employment Income	\$25,304	\$27,682	7th
Males	\$28,884	\$33,603	8th
Females	\$21,862	\$21,820	6th
Composition of Total Income			
Employment Income	70.7%	74.7%	8th
Government Transfer Payments	17.5%	15.1%	4th
Other	11.9%	10.2%	3rd
Average Family Income	\$47,390	\$56,022	8th
Median Family Income	\$41,487	\$48,655	8th
# of Economic Families	1565	9,145	1st
# of Low Income Families	340	1,795	9th
% of Low Income Families	21.73%	19.63%	3rd

EAST HILL

Schools

- King George Community School—421—23rd Street East
- P.A.C.I.—45—20th Street West
- Vincent Massey Community School—2800—2nd Avenue East
- Won Ska Cultural School—2004—4th Avenue East

Education

The following are the totals for the levels of Education for the residents of the East Hill and for the City of Prince Albert as a whole.

<i>Levels of Education</i>	East Hill #	East Hill %	Prince Albert #	Prince Albert %
Total Population 20 years and over by highest level of schooling	3,900		22,590	
Less than Grade 9	405	10.38%	2,330	10.31%
Grades 9 to 12	1340	34.36%	7,650	33.86%
Without high school graduation certificate	890	22.82%	5,325	23.57%
With high school graduation certificate	450	11.54%	2,325	10.29%
Trades certificate or diploma	660	16.92%	3,470	15.36%
College	775	19.87%	4,775	21.13%
Without certificate or diploma	155	3.97%	315	1.39%
With certificate or diploma	615	15.77%	3,460	15.31%
University	725	18.59%	4,370	19.34%
Without degree	280	7.18%	1,620	7.17%
Without certificate or diploma	215	5.51%	1,130	5.00%
With certificate or diploma	60	1.54%	490	2.17%
With bachelor's degree or higher	450	11.54%	2,745	12.15%

When comparing the East Hill to the City of Prince Albert, the East Hill is comparable at 10.38% in having less than a Grade 9 education to Prince Albert's population at 10.31%. The East Hill is at 16.92% which is comparable to the rest of Prince Albert at 15.36%, in attaining a Trades certificate or diploma. The East Hill is comparable in attaining some College education at 19.87% to the rest of Prince Albert at 21.13%. 18.59% of East Hill residents have some University education which is less than all of Prince Albert at 19.34%.

EAST HILL

Labour Force

The following is a Labour Force comparison between the East Hill and the entire city as a whole. The East Hill's percentages seem to fair not quite as well as the overall city averages.

<i>Population</i>	Prince Albert	East Hill
Total Population—15 and over	25,215	4,270
Total Labour Force — 15 and over	16,600	2,705
Employed	15,160	2,430
Unemployed	1,500	270
Not in Labour Force —15 and over	8,555	1565
Participation Rate—15 years and over	66.1%	63.4%
Employment Rate—15 years and over	60.1%	57.0%
Unemployment Rate—15 years and over	9%	10.0%

Recreation

- Kinsmen Water Park
- Kinsmen Park
- Kinsmen Arena
- East Hill Community Club (Multi Purpose Hall, Meeting Room, Indoor Arena, Outdoor Hockey Rink)

Religion

- Calvary United Church—114—25th Street East
- Church of Jesus Christ of Latter Day Saints—452—30th Street East
- Church of The Nazarene—26—18th Street East
- Prince Albert Gospel Assembly—2405—5th Avenue East
- St. David's Anglican Church—500—24th Street East
- St. Joseph's Church—260—25th Street East

Housing

- The Average gross rent is \$537.00
- The Average value of a dwelling is \$87,083.00

EAST HILL



The East Hill is home to many beautiful character homes and buildings where history and beauty abound.



MIDTOWN

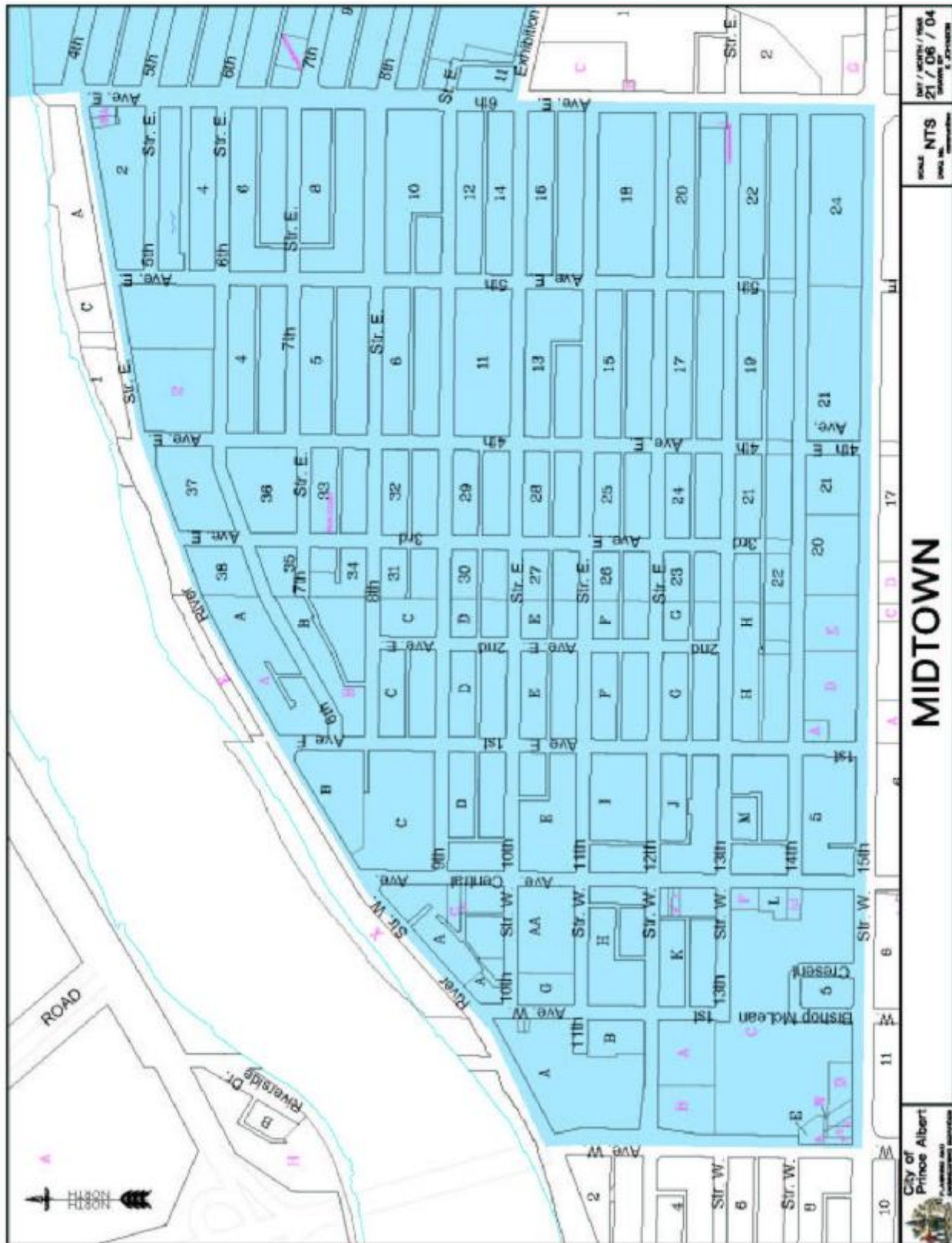

MIDTOWN

Location

Midtown is a small neighbourhood bound between 15th Street East, 2nd Avenue West, the North Saskatchewan River to 8th Avenue East and Exhibition Drive.

Population

In 2001, Midtown had a population of 3,725, which is 11.14% of the overall population of the city. 29.50% of the population in Midtown is of Aboriginal descent, which is 10.80% of the total Aboriginal population in Prince Albert.



Income

The average employment income in Midtown is \$21,671, making it the ninth highest neighbourhood in terms of average employment income in the city. The average family income is \$39,870, which is the ninth highest of all neighbourhoods in Prince Albert. 25.82% of all families in the neighbourhood are considered to be low income, which places it second out of all neighbourhoods.

	Midtown	City of Prince Albert	Overall Ranking
Average Employment Income	\$21,671	\$27,682	9th
Males	\$25,464	\$33,603	9th
Females	\$17,872	\$21,820	10th
Composition of Total Income			
Employment Income	58.9%	74.7%	10th
Government Transfer Payments	29.4%	15.1%	1st
Other	11.6%	10.2%	4th
Average Family Income	\$39,870	\$56,022	9th
Median Family Income	\$31,760	\$48,655	9th
# of Economic Families	910	9,145	6th
# of Low Income Families	235	1,795	8th
% of Low Income Families	25.82%	19.63%	2nd

MIDTOWN

Education

The following are the totals for the levels of Education for the residents of Midtown and for the City of Prince Albert as a whole.

<i>Levels of Education</i>	Midtown #	Midtown %	Prince Albert #	Prince Albert %
Total Population 20 years and over by highest level of schooling	2,865		22,590	
Less than Grade 9	590	20.67%	2,330	10.31%
Grades 9 to 12	1080	37.70%	7,650	33.86%
Without high school graduation certificate	885	30.89%	5,325	23.57%
With high school graduation certificate	190	6.63%	2,325	10.29%
Trades certificate or diploma	455	15.88%	3,470	15.36%
College	405	14.14%	4,775	21.13%
Without certificate or diploma	150	5.24%	315	1.39%
With certificate or diploma	255	8.9%	3,460	15.31%
University	340	11.87%	4,370	19.34%
Without degree	175	6.11%	1,620	7.17%
Without certificate or diploma	145	5.06%	1,130	5.00%
With certificate or diploma	30	1.05%	490	2.17%
With bachelor's degree or higher	170	5.93%	2,745	12.15%

When comparing Midtown to the City of Prince Albert, Midtown does not fair as well at 20.67% at having less than a Grade nine education to Prince Albert's population at 10.31%. Midtown is at 15.88% which is comparable to the rest of Prince Albert at 15.36%, in attaining a Trades certificate or diploma. Midtown has less of its population attaining some College education at 14.14% when compared to the rest of Prince Albert at 21.13%. 11.87% of Midtown residents have some University education which is less than all of Prince Albert at 19.34%.

MIDTOWN

Schools

- Academy of Learning Computer & Business Career College—29—11th Street East
- Adams Institute for Learning—1124—1st Avenue East
- DTI Practical Nursing Program—48—12th Street East
- Ecole Valois—449—10th Street East
- First Nations University of Canada-Northern Campus—1401—Central Avenue
- Gabriel Dumont Institute of Native Studies and Applied Research—48—12th Street East
- Image Extension School—15-13th Street East
- Prince Albert Aboriginal Headstart Preschool—202—10th Street East
- Prince Albert Child Care Cooperative—199—6th Street East
- Prince Albert Family Church Academy—540—8th Street East
- Prince Charles School—550—8th Street East
- Riverside Community School—511—5th Avenue East
- Saskatchewan Urban Native Teacher Education Program (SUNTEP) - 48—12th Street East

Labour Force

The following is a Labour Force comparison between Midtown and the entire city as a whole. Midtown's percentages seem to fair not as well as the overall city averages.

<i>Population</i>	Prince Albert	Midtown
Total Population—15 and over	25,215	3,100
Total Labour Force — 15 and over	16,600	1,540
Employed	15,160	1,385
Unemployed	1,500	155
Not in Labour Force —15 and over	8,555	1555
Participation Rate—15 years and over	66.1%	49.8%
Employment Rate—15 years and over	60.1%	44.7%
Unemployment Rate—15 years and over	9%	10.1%

Recreation

- Margo Fournier Center
- E.A. Rawlinson Centre for the Arts
- Prince Albert Arts Centre
- The Prince Albert Historical Museum
- The John M. Cuelenaere Public Library
- Midtown Community Club Inc. (Multi Purpose Hall, Meeting Room, Outdoor Hockey Rink, Pleasure Skating Rink, Play Equipment, Basketball Courts, Tennis Courts)

Religion

- Anglican Diocese of Saskatchewan Synod Office—1308—5th Avenue East
- Catholic Family Services—#1—101—15th Street East
- Jehovah's Witnesses East Congregation—683—7th Street East
- Prince Albert Family Church—550—1st Avenue East
- Prince Albert Full Gospel Outreach Center—925 Central Avenue
- Salvation Army—900 Central Avenue
- St. Alban's Cathedral—1410 Bishop McLean Crescent
- St. Mark Parish—589—9th Street East
- St. Paul's Presbyterian Church—12th Street & 1st Avenue East
- Ukrainian Greek Orthodox Church—305—6th Street East
- Wesley United Church—65—11th Street East

Housing

- The Average gross rent is \$474.00
- The Average value of a dwelling is \$68,049.00

Health Care Facilities

- Prince Albert Co-operative Health Centre/Community Clinic—110-8th Street East

MIDTOWN



Midtown has many areas of recreation and relaxation. From the riverbank to downtown amenities, to character homes, Midtown has a little bit of everything.



NORDALE/HAZEDELL

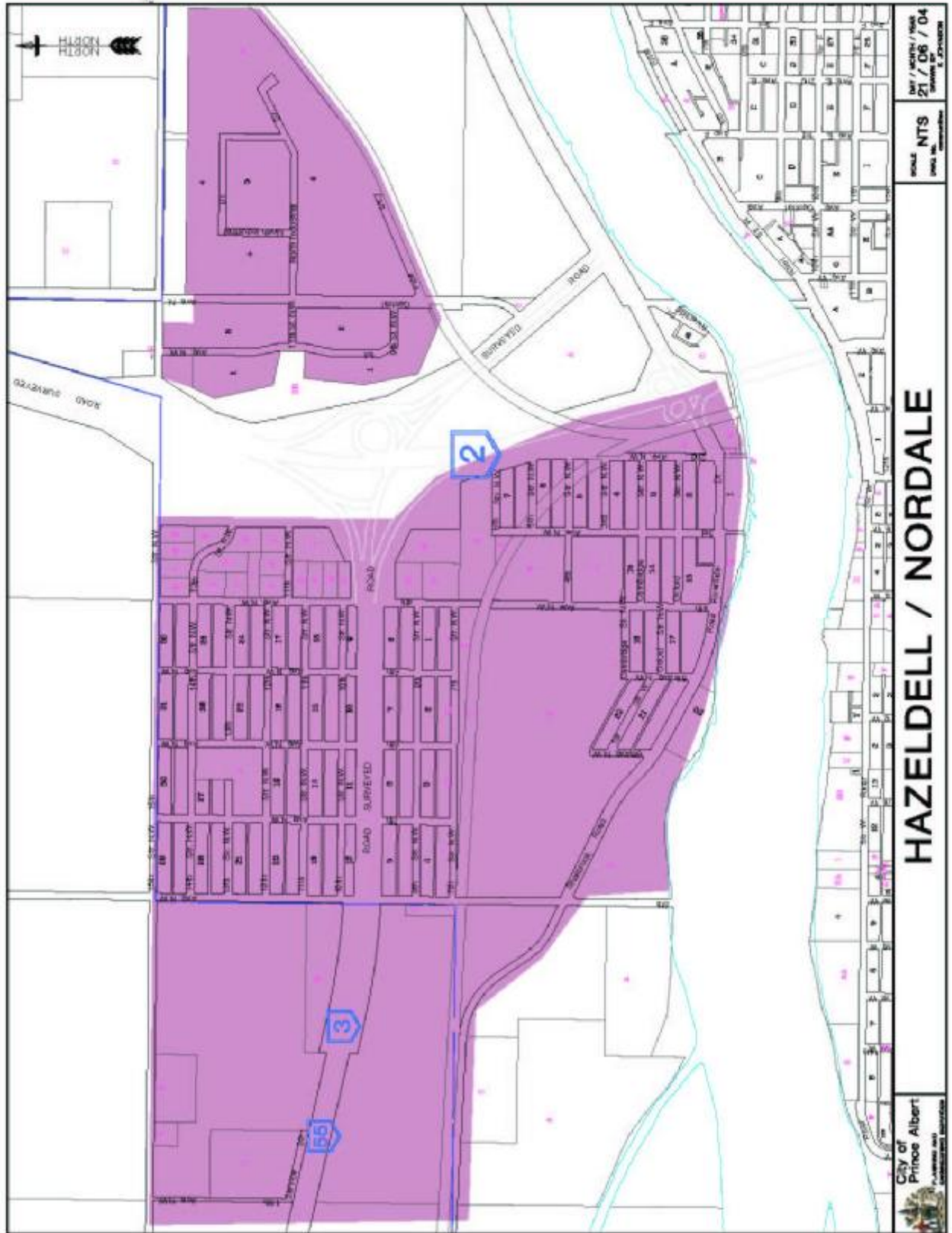

NORDALE/HAZELDELL

Location

Nordale/Hazeldell are small neighbourhoods located north of the city along the northern shore of the North Saskatchewan River.

Population

In 2001, Nordale/Hazeldell had a population of 825, which is 2.47% of the overall population of the city. 18.18% of the population in Nordale/Hazeldell is of Aboriginal descent, which is 1.47% of the total Aboriginal population in Prince Albert.



Income

The average employment income in Nordale/Hazeldell is \$34,012, making it the second highest neighbourhood in terms of average employment income in the city. The average family income is \$74,735, which is the second highest of all neighbourhoods in Prince Albert. 4.1% of all families in the neighbourhood are considered to be low income, which places it tenth out of all neighbourhoods.

	Nordale/ Hazeldell	City of Prince Albert	Overall Ranking
Average Employment Income	\$34,012	\$27,682	2nd
Males	\$43,728	\$33,603	2nd
Females	\$24,381	\$21,820	3rd
Composition of Total Income			
Employment Income	83.6%	74.7%	4th
Government Transfer Payments	7.7%	15.1%	9th
Other	8.0%	10.2%	7th
Average Family Income	\$74,735	\$56,022	2nd
Median Family Income	\$64,045	\$48,655	3rd
# of Economic Families	245	9,145	10th
# of Low Income Families	10	1,795	1st
% of Low Income Families	4.1%	19.63%	10th

NORDALE/HAZELDELL

Education

The following are the totals for the levels of Education for the residents of Nordale/Hazeldell and for the City of Prince Albert as a whole.

<i>Levels of Education</i>	Nordale/ Hazeldell #	Nordale/ Hazeldell %	Prince Albert #	Prince Albert %
Total Population 20 years and over by highest level of schooling	555		22,590	
Less than Grade 9	25	4.50%	2,330	10.31%
Grades 9 to 12	230	41.44	7,650	33.86%
Without high school graduation certificate	115	20.72%	5,325	23.57%
With high school graduation certificate	110	19.82%	2,325	10.29%
Trades certificate or diploma	90	16.22%	3,470	15.36%
College	90	16.22%	4,775	21.13%
Without certificate or diploma	60	10.81%	315	1.39%
With certificate or diploma	30	5.41%	3,460	15.31%
University	125	22.52%	4,370	19.34%
Without degree	35	6.31%	1,620	7.17%
Without certificate or diploma	25	4.50%	1,130	5.00%
With certificate or diploma	0	0	490	2.17%
With bachelor's degree or higher	95	17.12%	2,745	12.15%

When comparing Nordale/Hazeldell to the City of Prince Albert, Nordale/Hazeldell has fewer of their population at 4.50% at having less than a Grade nine education to Prince Albert's population at 10.31%. Nordale/Hazeldell is at 16.22% which is comparable to the rest of Prince Albert at 15.36%, in attaining a Trades certificate or diploma. Nordale/Hazeldell has less of its population attaining some College education at 16.22% when compared to the rest of Prince Albert at 21.13%. 22.52% of Nordale/Hazeldell residents have some University education which is more than all of Prince Albert at 19.34%.

NORDALE/HAZELDELL

Labour Force

The following is a Labour Force comparison between Nordale/Hazeldell and the entire city as a whole. Nordale/Hazeldell's percentages seem to fair quite a bit better than the overall city averages.

<i>Population</i>	Prince Albert	Nordale/ Hazeldell
Total Population—15 and over	25,215	630
Total Labour Force — 15 and over	16,600	475
Employed	15,160	445
Unemployed	1,500	35
Not in Labour Force — 15 and over	8,555	155
Participation Rate—15 years and over	66.1%	75.4%
Employment Rate—15 years and over	60.1%	70.6%
Unemployment Rate—15 years and over	9%	7.4%

Recreation

- Hazeldell Community Club (Multi Purpose Hall, Meeting Room, Outdoor Hockey Rink, Play Equipment)
- Nordale Community Club (Multi Purpose Hall, Meeting Room, Outdoor Hockey Rink, Play Equipment)

Religion

- Beulah Land Baptist Church—Highway 55
- Northern Canada Evangelical Mission/Tribal Trails—Shellbrook Highway

Housing

- The Average gross rent is \$635.00
- The Average value of a dwelling is \$141,020.00

NORDALE/HAZELDELL



Nordale/Hazeldell has the living out of town experience without actually leaving the city. Crossing the bridge into relaxation is only minutes away.



RIVERVIEW

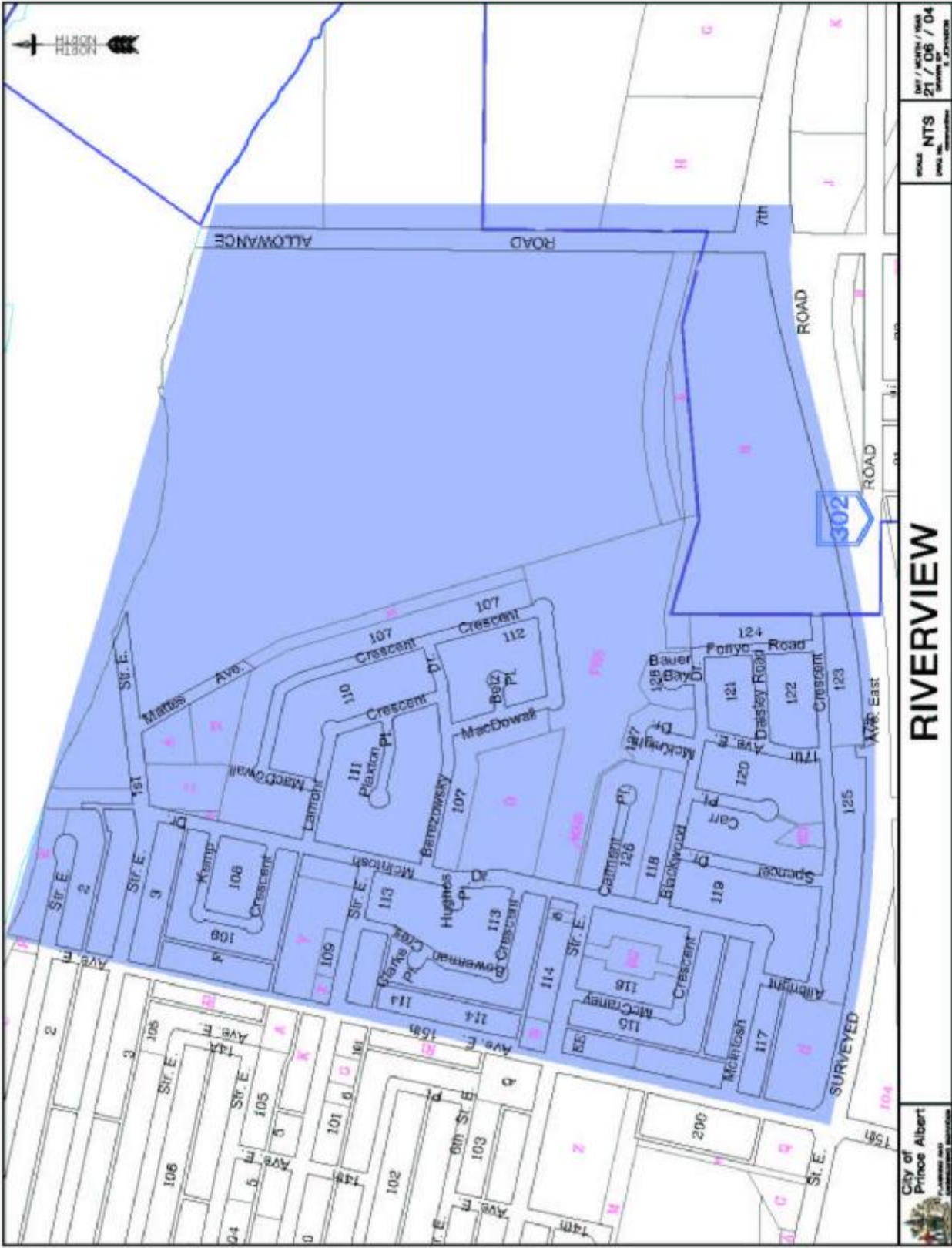

RIVERVIEW

Location

Riverview is a small neighbourhood bound between 15th Street East, 15th Avenue East, the North Saskatchewan River and the Eastern city limit boundaries.

Population

In 2001, Riverview had a population of 2,425, which is 7.25% of the overall population of the city. 31.96% of the population in Riverview is of Aboriginal descent, which is 7.61% of the total Aboriginal population in Prince Albert.

Income

The average employment income in Riverview is \$25,965, making it the sixth highest neighbourhood in terms of average employment income in the city. The average family income is \$59,362, which is the sixth highest of all neighbourhoods in Prince Albert. 17.16% of all families in the neighbourhood are considered to be low income, which places it sixth out of all neighbourhoods.

	Riverview	City of Prince Albert	Overall Ranking
Average Employment Income	\$25,965	\$27,682	6th
Males	\$31,859	\$33,603	6th
Females	\$20,588	\$21,820	7th
Composition of Total Income			
Employment Income	87.3%	74.7%	2nd
Government Transfer Payments	9.0%	15.1%	7th
Other	3.8%	10.2%	10th
Average Family Income	\$59,362	\$56,022	6th
Median Family Income	\$60,986	\$48,655	6th
# of Economic Families	670	9,145	8th
# of Low Income Families	115	1,795	4th
% of Low Income Families	17.16%	19.63%	6th

Schools

- W. J. Berezowsky School—566 McIntosh Drive

Education

The following are the totals for the levels of Education for the residents of Riverview and for the City of Prince Albert as a whole.

<i>Levels of Education</i>	Riverview #	Riverview %	Prince Albert #	Prince Albert %
Total Population 20 years and over by highest level of schooling	1,410		22,590	
Less than Grade 9	95	6.74%	2,330	10.31%
Grades 9 to 12	470	33.33%	7,650	33.86%
Without high school graduation certificate	270	19.15%	5,325	23.57%
With high school graduation certificate	200	14.18%	2,325	10.29%
Trades certificate or diploma	190	13.48%	3,470	15.36%
College	410	29.08%	4,775	21.13%
Without certificate or diploma	90	6.38%	315	1.39%
With certificate or diploma	325	23.05%	3,460	15.31%
University	245	17.38%	4,370	19.34%
Without degree	105	7.45%	1,620	7.17%
Without certificate or diploma	55	3.90%	1,130	5.00%
With certificate or diploma	55	3.90%	490	2.17%
With bachelor's degree or higher	135	9.57%	2,745	12.15%

When comparing Riverview to the City of Prince Albert, Riverview has less of the population at 6.74% at having less than a Grade nine education to Prince Albert's population at 10.31%. Riverview is at 13.48% which is comparable to the rest of Prince Albert at 15.36%, in attaining a Trades certificate or diploma. Riverview has more of its population attaining some College education at 29.08% when compared to the rest of Prince Albert at 21.13%. 17.38% of Riverview residents have some University education which is less than all of Prince Albert at 19.34%.

RIVERVIEW

Labour Force

The following is a Labour Force comparison between Riverview and the entire city as a whole. Riverview's percentages seem to fair quite a bit better than the overall city averages.

<i>Population</i>	Prince Albert	Riverview
Total Population—15 and over	25,215	1,650
Total Labour Force — 15 and over	16,600	1,330
Employed	15,160	1,240
Unemployed	1,500	90
Not in Labour Force —15 and over	8,555	315
Participation Rate—15 years and over	66.1%	80.9%
Employment Rate—15 years and over	60.1%	75.4%
Unemployment Rate—15 years and over	9%	6.8%

Recreation

- Riverview is a part of the East End Community Club (Please refer to the East Flat Community Profile).

Religion

- Gateway Covenant Church—1500—15th Street East

Housing

- The Average gross rent is \$542.00
- The Average value of a dwelling is \$99,994.00

RIVERVIEW



With access to beautiful parks, walking paths and the river bank, Riverview is a great place to be.



WEST FLAT

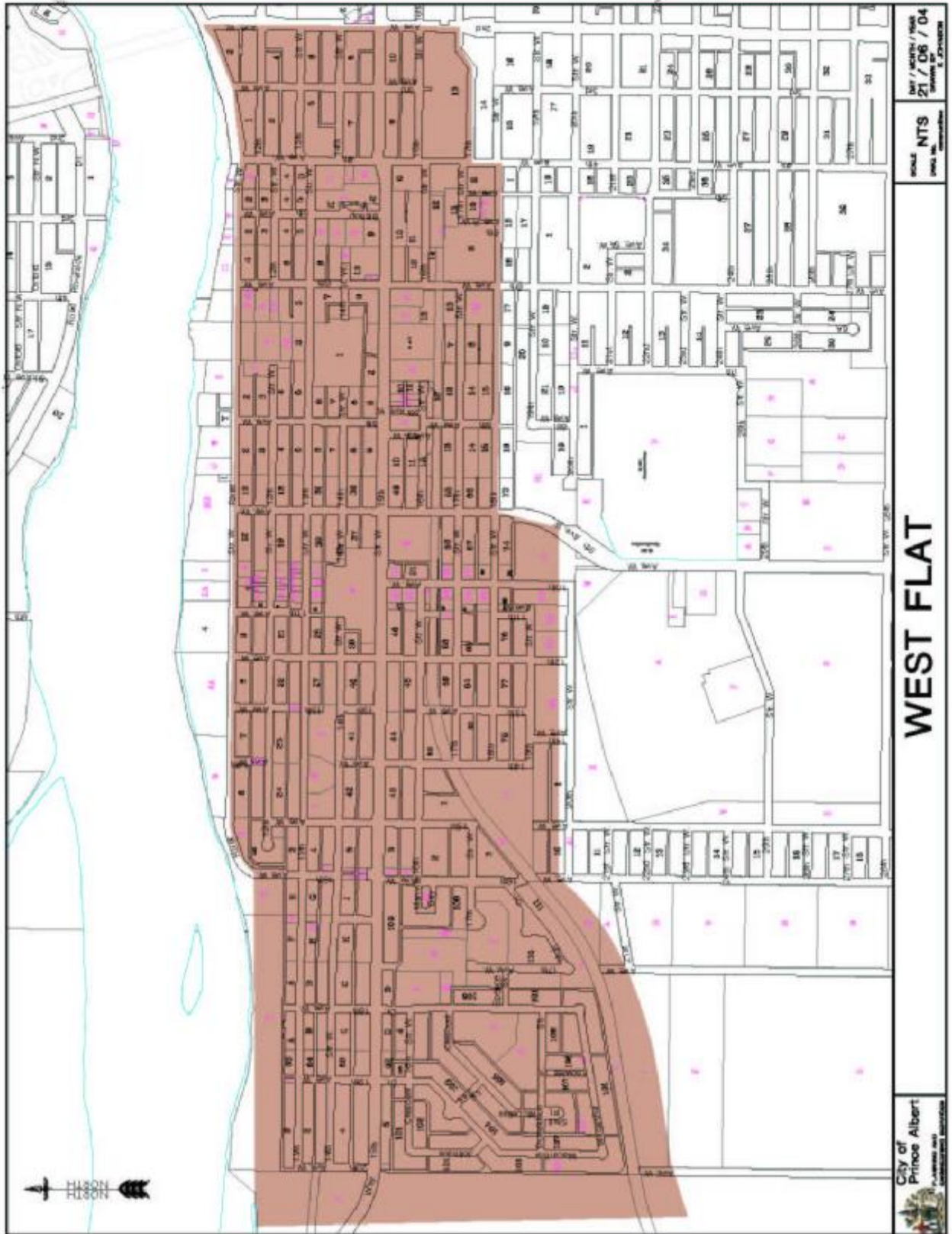

WEST FLAT

Location

The West Flat is a larger neighbourhood bound between 17th Street West, 2nd Avenue West, the North Saskatchewan River, and the Western city limit boundaries.

Population

In 2001, the West Flat had a population of 5,545, which is 16.59% of the overall population of the city. 58.61% of the population in the West Flat is of Aboriginal descent, which is 31.91% of the total Aboriginal population in Prince Albert.



Income

The average employment income in the West Flat is \$21,581, making it the tenth highest neighbourhood in terms of average employment income in the city. The average family income is \$37,270, which is the tenth highest of all neighbourhoods in Prince Albert. 37.55% of all families in the neighbourhood are considered to be low income, which places it first out of all neighbourhoods at having the highest percentage of low income families.

	West Flat	City of Prince Albert	Overall Ranking
Average Employment Income	\$21,581	\$27,682	10th
Males	\$25,066	\$33,603	10th
Females	\$17,988	\$21,820	9th
Composition of Total Income			
Employment Income	67.1%	74.7%	9th
Government Transfer Payments	24.2%	15.1%	2nd
Other	8.8%	10.2%	6th
Average Family Income	\$37,270	\$56,022	10th
Median Family Income	\$30,728	\$48,655	10th
# of Economic Families	1385	9,145	2nd
# of Low Income Families	520	1,795	10th
% of Low Income Families	37.55%	19.63%	1st

WEST FLAT

Education

The following are the totals for the levels of Education for the residents of the West Flat and for the City of Prince Albert as a whole.

<i>Levels of Education</i>	West Flat #	West Flat %	Prince Albert #	Prince Albert %
Total Population 20 years and over by highest level of schooling	3,275		22,590	
Less than Grade 9	530	16.18%	2,330	10.31%
Grades 9 to 12	1,280	39.08%	7,650	33.86%
Without high school graduation certificate	990	30.23%	5,325	23.57%
With high school graduation certificate	285	8.70%	2,325	10.29%
Trades certificate or diploma	470	14.35%	3,470	15.36%
College	680	20.76%	4,775	21.13%
Without certificate or diploma	275	8.40%	315	1.39%
With certificate or diploma	405	12.37%	3,460	15.31%
University	330	10.08%	4,370	19.34%
Without degree	165	5.04%	1,620	7.17%
Without certificate or diploma	120	3.66%	1,130	5.00%
With certificate or diploma	50	1.53%	490	2.17%
With bachelor's degree or higher	160	4.89%	2,745	12.15%

When comparing the West Flat to the City of Prince Albert, the West Flat has more of its population at 16.18% at having less than a Grade nine education to Prince Albert's population at 10.31%. The West Flat is at 14.35% which is comparable to the rest of Prince Albert at 15.36%, in attaining a Trades certificate or diploma. The West Flat is equal to the rest of Prince Albert in attaining some College education at (20.76%, 21.13%). 10.08% of West Flat residents have some University education which is less than all of Prince Albert at 19.34%.

WEST FLAT

Schools

- Antaya Driving School—1291 12th Street West
- Eagle Program—1350 15th Avenue West
- Lucy Baker School—215—12th Street West
- Queen Mary Community School—1010—15th Street West
- Rivier Academy—1405— Bishop Pascal Place
- St. Mary High School—380—14th Street West
- St. Michael Community School—1695—17th Street West
- West Flat Community Pre-School—1350 15th Avenue West
- Wesmor Community High School—1819—14th Avenue West
- Westview Community School—620 MacArthur Drive

Labour Force

The following is a Labour Force comparison between the West Flat and the entire city as a whole. The West Flat's percentages seem to fair not quite as well as the overall city averages.

<i>Population</i>	Prince Albert	West Flat
Total Population—15 and over	25,215	3,735
Total Labour Force — 15 and over	16,600	2,095
Employed	15,160	1,795
Unemployed	1,500	295
Not in Labour Force —15 and over	8,555	1,645
Participation Rate—15 years and over	66.1%	56.1%
Employment Rate—15 years and over	60.1%	48.1%
Unemployment Rate—15 years and over	9%	14.1%

Recreation

- Marion Aquatics Swimming Pool
- Dents Park
- Mair Park
- Parkland Community Club (Multi Purpose Hall, Meeting Room, Gymnasium, Day Care, Outdoor Hockey Rink, Play Equipment)

Religion

- Community of Christ Church—1840—15th Street West
- Fountain of Life School of Ministry—717 MacArthur Drive
- Grace Mennonite Church—250—28th Street West
- Holy Trinity Anglican—1381—15th Street West
- Jehovah's Witnesses—1204—3rd Avenue West
- Kateri House Roman Catholic Native Ministry - 410—12th Street West
- New Life Indian Alliance Fellowship—1779—15th Street West
- Prince Albert Apostolic Church—717 MacArthur Drive
- Roman Catholic Chancery Office—1415 4th Avenue West
- Sacred Heart Cathedral—1401—4th Avenue West
- St. George's Ukranian Catholic Church—752—14th Street West
- St. Michael Parish—1505—13th Street West

Housing

- The Average gross rent is \$528.00
- The Average value of a dwelling is \$68,169.00

WEST FLAT



The West Flat is located along the riverbank with access to beautiful scenery at the best rate in town!



WEST HILL

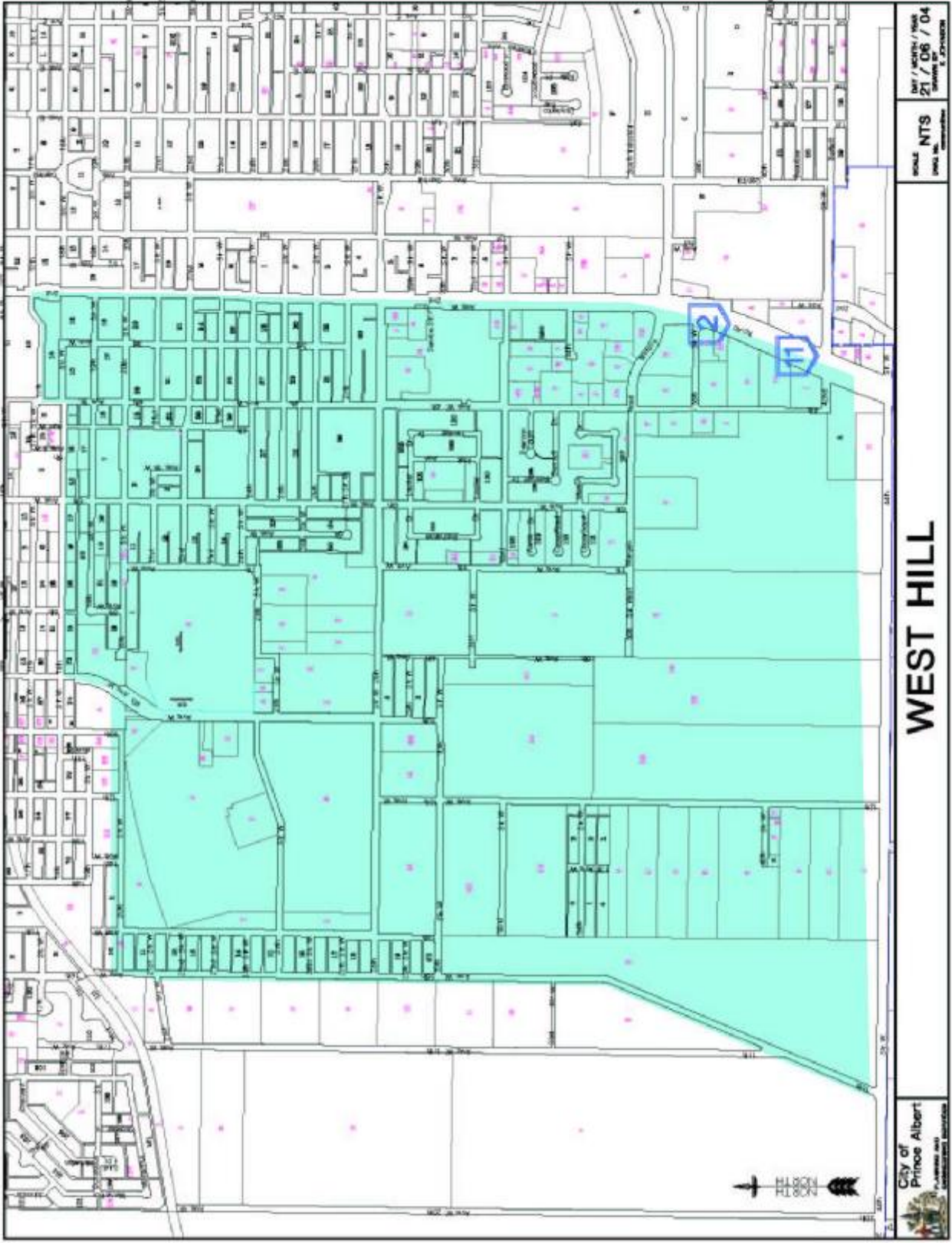

WEST HILL

Location

The West Hill is a large neighbourhood bound between the Southern city limit boundary, 16th Avenue West, 17th Street West and 2nd Avenue West.

Population

In 2001, the West Hill had a population of 3,635, which is 10.87% of the overall population of the city. 18.29% of the population in the West Hill is of Aboriginal descent, which is 6.53% of the total Aboriginal population in Prince Albert.



Income

The average employment income in the West Hill is \$33,979, making it the third highest neighbourhood in terms of average employment income in the city. The average family income is \$72,631, which is the fourth highest of all neighbourhoods in Prince Albert. 18.87% of all families in the neighbourhood are considered to be low income, which places it eighth out of all neighbourhoods.

	West Hill	City of Prince Albert	Overall Ranking
Average Employment Income	\$33,979	\$27,682	3rd
Males	\$42,158	\$33,603	3rd
Females	\$26,393	\$21,820	2nd
Composition of Total Income			
Employment Income	72.4%	74.7%	7th
Government Transfer Payments	13.6%	15.1%	5th
Other	14.1%	10.2%	2nd
Average Family Income	\$72,631	\$56,022	4th
Median Family Income	\$65,586	\$48,655	4th
# of Economic Families	795	9,145	3rd
# of Low Income Families	150	1,795	3rd
% of Low Income Families	18.87%	19.63%	8th

Schools

- Arthur Pechey School—2675—4th Avenue West
- St. Anne Catholic School—2245—5th Avenue West

Education

The following are the totals for the levels of Education for the residents of the West Hill and for the City of Prince Albert as a whole.

<i>Levels of Education</i>	West Hill #	West Hill %	Prince Albert #	Prince Albert %
Total Population 20 years and over by highest level of schooling	2,760		22,590	
Less than Grade 9	255	9.24%	2,330	10.31%
Grades 9 to 12	850	30.80%	7,650	33.86%
Without high school graduation certificate	725	26.27%	5,325	23.57%
With high school graduation certificate	130	4.71%	2,325	10.29%
Trades certificate or diploma	360	13.04%	3,470	15.36%
College	555	20.11%	4,775	21.13%
Without certificate or diploma	100	3.62%	315	1.39%
With certificate or diploma	450	16.30%	3,460	15.31%
University	750	27.17%	4,370	19.34%
Without degree	200	7.25%	1,620	7.17%
Without certificate or diploma	125	4.53%	1,130	5.00%
With certificate or diploma	70	2.54%	490	2.17%
With bachelor's degree or higher	550	19.93%	2,745	12.15%

When comparing the West Hill to the City of Prince Albert, 9.24% of the West Hill's population has less than a Grade nine education compared to Prince Albert's population at 10.31%. The West Hill is at 13.04% which is less than the rest of Prince Albert at 15.36%, in attaining a Trades certificate or diploma. The West Hill is comparable (20.11%) to the rest of Prince Albert in attaining some College education at 21.13%. 27.17% of West Hill residents have some University education which is more than all of Prince Albert at 19.34%.

WEST HILL

Labour Force

The following is a Labour Force comparison between the West Hill and the entire city as a whole. The West Hill's percentages seem to fair quite closely with the overall city averages.

<i>Population</i>	Prince Albert	West Hill
Total Population—15 and over	25,215	2,975
Total Labour Force — 15 and over	16,600	1,865
Employed	15,160	1,760
Unemployed	1,500	105
Not in Labour Force —15 and over	8,555	1,105
Participation Rate—15 years and over	66.1%	62.8%
Employment Rate—15 years and over	60.1%	59.3%
Unemployment Rate—15 years and over	9%	5.6%

Recreation

- The Rotary Museum of Police and Corrections
- The Prince Albert Evolution of Education Museum
- West Hill Community Club (Meeting Room, Indoor Arena, Outdoor Hockey Rink, Play Equipment, Basketball Courts)

Religion

- Prince Albert Alliance Church—2777—6th Avenue West
- Church of Christ—264—23rd Street West
- Evening Message Tabernacle—150—23rd Street West
- Redeemer Lutheran Church—310—27th Street West
- Windows of Heaven are Open Ministries Inc.—264—23rd Street West

Housing

- The Average gross rent is \$513.00
- The Average value of a dwelling is \$115,501.00

Health Care Facilities

- South Hill Minor Emergency Clinic—2685 2nd Avenue West
- Victoria Union Hospital/Herb Bassett Home—1200 24th Street West
- West Hill Medical Clinic—1A—2995 2nd Avenue West

WEST HILL



The West Hill has shopping, restaurants, and some of the most beautiful homes in Prince Albert from homes that are brand new to almost 100 years old! The West Hill is a spectacular neighbourhood.

