

chooselethbridge



chooselethbridge  
*for*  
*manufacturing*

Lethbridge Manufacturing Directory 2005-2006

Economic Development

LETHBRIDGE

# Vacant Land Options in the City of Lethbridge

*For business and industrial customers*

## Sherring Business and Industrial Park

**Developer:** City of Lethbridge  
**Location:** Northeast Lethbridge  
**Size:** 1280 Acre Site

Business Industrial (I-B) land starting at \$152,600/acre  
General Industrial (I-G) land starting at \$118,000/acre  
Heavy Industrial (I-H) land starting at \$115,000/acre

Phase 1 available late 2005

**Contact:** Real Estate and Land Development at  
(403)320-4000



## Chinook Business Park

**Developer:** Remington Development Corporation  
**Location:** Crowsnest Trail and 43<sup>rd</sup> Street South  
**Size:** 24 Acres still available

Highway Commercial (C-H) land available immediately  
Lots ranging from 1.00 acre and up  
Starting at \$217,800/acre

**Contact:** Cody Clayton at (403)255-7003

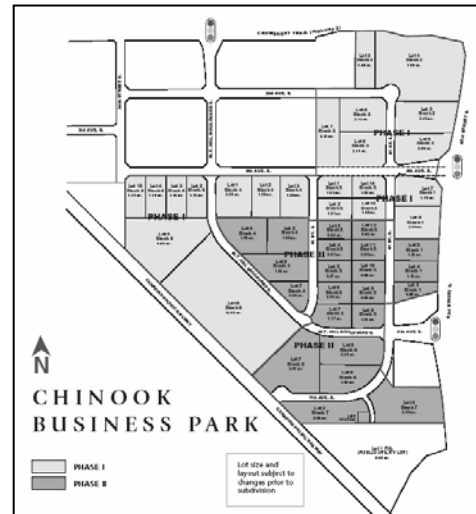

## Lethbridge County Airport

**Developer:** County of Lethbridge  
**Location:** 5 km south of city on Mayor Magrath Dr  
**Size:** 37 Acres of Industrial Land Available for Lease

Lease rates starting at: \$1.19 per square metre annually

**Contact:** Scott Butchart at (403) 329-4466

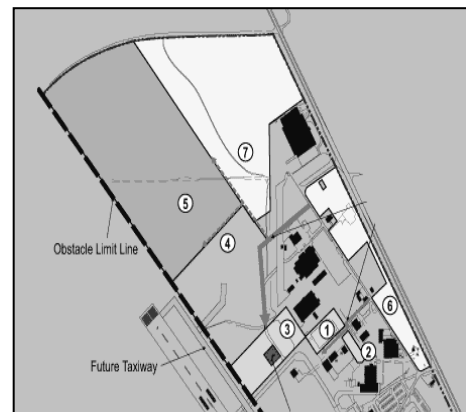

# The 2005 Economic Development Lethbridge Manufacturing Survey

## *Made in Lethbridge Manufacturing Directory*

---

Introduction	1
Categorical Index	2
Directory of Manufacturers	3-9

---

**Made in Lethbridge** was compiled by Economic Development Lethbridge to provide information about manufacturers and manufacturing activity in the Lethbridge area. The 2005 edition of the Made in Lethbridge directory is produced using information gathered annually by Economic Development Lethbridge through a mail and phone survey. In July of 2005, 105 manufacturing firms were surveyed to determine the projected expansion of their operations for the year. These manufacturers ranged from large companies exporting to world markets, to small family operations selling their products locally.

Manufacturers were asked about their plans to expand production, to develop new products, to increase employee numbers, and to develop new export markets. The following highlights of this year's survey shows the City's manufacturing sector to be vibrant and growing.

- The manufacturing industry in Lethbridge generates more than \$1.2 billion in annual sales, and has a total payroll of over \$185 million.
- Manufacturing firms in Lethbridge occupy more than 4.1 million square feet of floor space.
- The total number of employees in the manufacturing sector has increased by 25%, from 3,785 in 1997, the first year of the survey, to 4,747 in 2004.
- 28% of manufacturing companies are planning to increase the number of employees in their organization by the end of this year.
- 45% are planning on expanding their production and another 40% have recently expanded their production.
  - 25% are planning on producing a new product during 2005.
- 60% are exporting their products to other countries. This figure has been relatively consistent over the years of the survey.
  - 9 of the 105 manufacturers are planning on exporting to new countries this year.

This directory encourages economic development in Lethbridge by providing information to new businesses interested in locating their company in Lethbridge. It provides an opportunity for Lethbridge manufacturers to interact with other manufacturers and to assist businesses in the communication/partnership process.

Economic Development Lethbridge provides assistance and guidance to companies requiring site location and business information and by offering a coordinating and advocacy role for projects. Confidentiality of inquiries is assured.

---

## Categorical Index

---

### **Agricultural Implements & Equipment**

Agri-Tech Manufacturing Ltd.  
Armtec Construction Products Ltd.  
Australian Canadian Agricultural Machinery Corp.  
Edwards Grain Guard  
Gen Manufacturing Ltd.  
Hub Irrigation Services Ltd. (Headmasters)  
Joss Technical Ltd.  
Kirchner Machine Ltd.  
Park Lake Welding & Mfg.  
Wally's Irrigation Services (1985) Limited  
Wheatland Bins

### **Animal Feeds**

A.D.M. Animal Health and Nutrition  
Cargill Animal Nutrition  
DACO Western Canada Ltd. (Division of Ridley Inc.)  
East-Man Feeds  
Green Prairie International Inc.  
Klok Feed Ltd.  
Master Feeds  
New Life Feeds (Division of Ellison Milling Company)  
Newwest Feeds & Nutritional Services  
Sun Cured Alfalfa Cubes Inc.  
Unifeed Ltd.  
Wilbur-Ellis Company of Canada Ltd.

### **Concrete Products**

Burnco  
Inland Concrete Limited  
LaFarge Canada Inc.  
Construction Materials Group  
Noble Concrete 1987 Ltd.  
Nord International Inc.  
Precon Precast Products  
Rick's Concrete Products  
Rox Landscape Products Ltd.

### **Construction Materials**

Alta Aluminum Inc.  
Berdick Windows & Doors  
Gergely's Glass Ltd.  
Kawneer Co. Canada Ltd.  
Overhead Door Company  
Timber-Tech Truss Inc.

### **Fabricated Metal Products**

Bell's Welding Ltd.  
Boma Enterprises Ltd.  
Bullet Developments

Charlton & Hill Ltd.  
Coaldale Iron Products Ltd.  
D&D Machine Works Ltd.  
Kiwi Iron  
Lethbridge Iron Works Company Limited  
Park Lake Welding & Mfg.  
RCL Metalworks Inc.  
Southland Trailer Corp.  
Triple J Contracting Inc.  
Varsteel Ltd.

### **Foods & Beverages**

Alberta Industrial Mustard Co. Ltd.  
Ben's Beef Jerky by J T Food Corp.  
Canbra Foods Ltd.  
Ellison Milling Company (Div. Parrish & Heimbecker Ltd.)  
Frito-Lay Canada  
Lethbridge Meats & Seafood Ltd.  
Let's Pasta Food Services Ltd.  
Lucerne Foods  
Maple Leaf Pork  
Maple Leaf Potatoes  
McCain Foods (Canada)  
Parmalat Canada Inc.  
Prestige Panko Inc.  
Sakai Spice (Canada) Corporation  
Sunnyrose Cheese (Div. of Agropur)  
The Black Velvet Distilling Company

### **Furniture and Fixtures**

Adora Kitchens Ltd.  
Braman Furniture International Ltd.  
Circle Wood Products  
Ducan Industries Inc.  
Elite Wood Products Ltd.  
Kevin Dunn Cabinets  
Northern Lights Glass Studio  
Peka Rollshutters Ltd.  
Rehabilitation Society of Southwestern Alberta  
The Kitchen Centre Ltd.

### **Machine Shops**

H.S.B. Production Ltd.  
Hy/Lo Machine & Tool (Div. Roga Productions Ltd.)  
Lethbridge Industries Ltd.  
Lethbridge Machine Shop Inc.  
Modern Machine Shop Ltd.

### **Manufactured Housing Buildings**

Regent Home Systems (Division of SRI Homes Inc.)  
Triple M Housing Ltd.

### **Miscellaneous**

Bayer Crop Science  
Enercon Water Treatment Ltd.  
Ink It Canada Ltd.  
Jay Signs Ltd.  
Lethbridge Custom Canvas Ltd.  
Lethbridge Hides  
Lethbridge Orthotic-Prosthetic Services Ltd.  
National Neon  
Normerica Inc.  
Pounder Emulsions  
Varsteel Ltd.

### **Non-Metallic Mineral Products**

HCA Mountain Minerals (Lethbridge) Ltd

### **Plastics**

Big M Plastics Ltd.  
Flexahopper Plastics Ltd.  
Lou-Mac Manufacturing

### **Sheet Metal, Heating and**

### **Ventilation Products**

Altaweld (1999) Inc.  
Four Seasons Home Comfort  
Liberty Boilers & Mechanical Services Inc.  
Tradesman Manufacturing

### **Transportation Equipment**

Dex Unlimited  
El Robcar Manufacturing Ltd. (Rusco Brakes)  
Haul-All Equipment Ltd. (Sure Flame Products)  
Intercontinental Truck Body Ltd.  
Kirk's Tires  
Lethbridge Engine Rebuilders (Div. Wally's Irrigation)  
Mo-Tires Ltd.  
Pratt & Whitney Canada (Div. of United Technologies)  
Southland Trailer Corp.

---

**A.D.M. Animal Health and Nutrition**

1310 - 41 St. N. Lethbridge T1H 5V3  
Tel: 320-2659 Fax: 328-9141

**Contact:** Mr. Brian Barmett, Sales Manager

**Products:** Livestock & poultry micro & macro premixes, livestock & poultry minerals and salts, livestock specialty products, protein commodities, vegetable oils

**Services:** Animal health & nutrition consulting, livestock feed ingredient sales, animal health supplies & feed additives

**Exports to:** U.S.A.  
# Employees: 21

**Adora Kitchens Ltd.**

Box 1378 Coaldale T1M 1N2  
Tel: 345-3118 Fax: 345-4955  
Web Site: [www.adorakitchens.com](http://www.adorakitchens.com)

**Contact:** Mr. Dirk DeVries, President

**Products:** Kitchen cabinets, vanities, china cabinets, desks, wall units, custom cabinets

**Services:** Installation & service

**Exports to:** U.S.A., Japan  
# Employees: 35

**Agri-Tech Manufacturing Ltd.**

Box 87 Nobleford T0L 1S0  
Tel: 824-3737 Fax: 824-3700

Web Site: [agritechmanufacturing.com](http://agritechmanufacturing.com)

**Contact:** Mr. Ken Thomsen, President

**Products:** Manufacture agriculture chaff & straw spreader, land rollers, noble blade, chisel plow, potato cultivator marker, air drill and replacement parts

**Services:** Repair and welding shop, custom manufacturing

**Exports to:** U.S.A., Australia, Ukraine, Russia, France  
# Employees: 18

**Alberta Industrial Mustard Co. Ltd.**

Box 189 Lethbridge T1J 3Y5  
Tel: 329-4111 Fax: 329-4418

Web Site: [demeteragro.com](http://demeteragro.com)

**Contact:** Mr. Blair Roth, Manager

**Products:** De-heated ground mustard, peas, lentils, chickpeas

**Exports to:** Worldwide  
# Employees: 45

**Alta Aluminum Inc.**

252 - 12 Street N Lethbridge T1H 2G2  
Tel: 328-6777 Fax: 328-3843

**Contact:** Mr. Tony Pigat, General Manager

**Products:** Aluminum windows & doors, PVC windows & fencing, awnings, sealed units, glass & aluminum sunrooms and siding

**Services:** Exterior renovations and new home construction

# Employees: 7

**Altaweld (1999) Inc.**

1210 - 33 St. N. Lethbridge T1H 5H3  
Tel: 381-9086 Fax: 381-8271

**Contact:** Mr. Dave Zimmer, President

**Products:** Custom metal fabrication, flashing, electrical cabinets, ductwork, air intake systems, black iron, galvanized, aluminum, stainless steel, motorized drive systems, structural steel

**Services:** Furnace installation & ductwork, portable welding, plant maintenance & construction

# Employees: 10

**Armtec Construction Products Ltd.**

2210 - 39 St. N. Lethbridge T1H 5J2  
Tel: 320-2888 Fax: 320-2034

Web Site: [www.armtec.com](http://www.armtec.com)

**Contact:** Mr. Frank Stang, Area Supervisor

**Products:** Irrigation gates, H.D.P.E. Pipe, steel culverts

**Services:** Assembly of water control gates. Culvert and geotextile inventory, technical backup metal fabrication

**Exports to:** Australia, U.S.A., India, South America  
# Employees: 6

**Australian Canadian Agricultural Machinery Corp.**

Box 1477 Coaldale T1M 1N3  
Tel: 345-5717 Fax: 345-5357

Web Site: [www.jetstreamag.com](http://www.jetstreamag.com)

**Contact:** Mr. Mark McCarthy, Business Manager

**Products:** Jetstream sprayer, ATV Sprayer and firefighting unit

**Services:** Wholegoods, parts & service  
**Exports to:** U.S.A.  
# Employees: 12

**Bayer Crop Science**

#10, 3106 - 9 Ave. N. Lethbridge T1H 5E5

Tel: 329-0706 Fax: 329-0698

Web Site: [www.bayercropscience.com](http://www.bayercropscience.com)

**Contact:** Mr. George Lammertsen, Manager, Canola Seed Production

**Products:** Hybrid canola seed production

**Services:** Hybrid canola seed production

**Exports to:** Worldwide

# Employees: 12

**Bell's Welding Ltd.**

2508 - 2 Ave. N. Lethbridge T1H 0C2  
Tel: 328-4528 Fax:

**Contact:** Mr. Art Bell, President

**Products:** Car/Truck springs, iron fabrication, black-smithing

**Services:** Removal & installing springs, welding, black-smithing

# Employees: 2

**Ben's Beef Jerky by J T Food Corp.**

1528 - 36 St. N. Lethbridge T1H 5H8  
Tel: 329-4349 Fax: 329-4396

Web Site: [www.bensjerky.com](http://www.bensjerky.com)

**Contact:** Mr. Phil Tschetter, Manager

**Products:** Beef-jerky, beef sticks, pepperoni, sausage, bacon

# Employees: 6

**Big M Plastics Ltd.**

622 - 30 St. N. Lethbridge T1H 5G6  
Tel: 328-0364 Fax: 320-5735

Web Site: [www.bigmplastics.com](http://www.bigmplastics.com)

**Contact:** Mr Richard Friesen, President

**Products:** Plain & printed carry-out bags, bakery bags, produce bags and plain polyethylene film, shrink film, wide format printing

**Exports to:** U.S.A.

# Employees: 25

**Boma Enterprises Ltd.**

2215 - 2 Ave. N. Lethbridge T1H 0C1  
Tel: 320-9661 Fax: 320-9668

**Contact:** Ms. Janny Botterman, Secretary-Treasurer

**Products:** Metal flashings for buildings and tool boxes

**Services:** Sale of vinyl siding, metal roofing and screws

# Employees: 4

# Made in Lethbridge

---

## **Braman Furniture International Ltd.**

2930 - 9 Ave. N. Lethbridge T1H 5E4  
Tel: 329-3299 Fax: 329-3666  
Web Site: braman2000.com  
**Contact:** Mr. Craig Rumer, Chief Executive Officer  
**Products:** Case goods & upholstery furniture for hospitality, health care, timeshare, assisted living & education  
**Services:** Designer advice, colour coordination and installation  
**Exports to:** U.S.A., Mexico  
# Employees: 220

## **Bullet Developments**

Box 159 Barons T0L 0G0  
Tel: 757-3736 Fax: 757-3736  
Web Site: www.bullet.ab.ca  
**Contact:** Mr. Kirk Asplund, President  
**Products:** Metal home decor and furniture, ranch signs & truck endgate for 5th wheel trailers  
**Services:** Custom plasma arc cutting  
**Exports to:** U.S.A.  
# Employees: 3

## **Burnco**

2500 Westside Dr. Lethbridge T1J 4N1  
Tel: 381-6110 Fax: 381-1014  
Web Site: www.burnco.com  
**Contact:** Mr. Eric Bakko, Manager  
**Products:** Ready-mix concrete  
**Services:** Concrete pumping service & gravel  
# Employees: 15

## **Canbra Foods Ltd.**

2415 - 2A Ave. N. Lethbridge T1H 6P5  
Tel: 329-5500 Fax: 327-3887  
Web Site: www.canola.com  
**Contact:** Mr. Pat Van Osch, Vice-President and General Manager  
**Products:** Canola proteins and byproducts, bulk salad oil, hydrogenated bulk oil, salad oil, margarine and shortening for retail and food service, supplemental proteins, high stability oil  
**Exports to:** U.S.A., Pacific Rim, South America, Middle East, India, Mexico  
# Employees: 230

## **Cargill Animal Nutrition**

235 - 36 St. N. Lethbridge T1H 5R8  
Tel: 329-4462 Fax: 329-4853  
Web Site: www.cargillanimalnutrition.com  
**Contact:** Mr. Phil Graham, District General Manager  
**Products:** Animal feed products - dairy, poultry, swine, beef & specialty feeds  
**Services:** Agricultural support and animal nutrition  
**Exports to:** U.S.A.  
# Employees: 35

## **Charlton & Hill Ltd.**

655 - 30 St. N. Lethbridge T1H 5G5  
Tel: 3947291 Fax: 328-7332  
Web Site: www.charltonandhill.com  
**Contact:** Mrs Karen Reed  
**Products:** Sheet metal products, tanks/hoppers/bins, electrical cabinets/panels, commercial food service equipment, custom farm equipment. Structural steel railings, stairways, ramps, conveyors, agrifood equipment installation, oil and gas services equipment  
**Services:** Specialized stainless steel & aluminum fabrication and welding, profile cutting, rolling, HVAC equipment, roofing. Fabrication and equipment installation  
# Employees: 160

## **Circle Wood Products**

Box 646 Picture Butte T0K 1V0  
Tel: 732-5682 Fax: 732-5069  
**Contact:** Mr. Fred Vanhell, General Manager  
**Products:** Millwork, custom components, and PVC cabinet doors, study carrels, kitchen cabinets  
**Exports to:** U.S.A.  
# Employees: 21

## **Coaldale Iron Products Ltd.**

Box 3 Coaldale T1M 1M2  
Tel: 345-3973 Fax: 345-6322  
Web Site: www.pima.ca/members/Hexirod.html  
**Contact:** Mr. Walter Isaak, President  
**Products:** Rod weeder attachments, wrought iron railings & gates, hydraulic hose, super slide truck floor liners and custom manufacturing  
**Services:** Maintenance & repair, liquid air depot  
**Exports to:** U.S.A.  
# Employees: 4

## **D & D Machine Works Ltd.**

3010 - 6 Ave. N. Lethbridge T1H 5C3  
Tel: 328-8242 Fax: 320-8723  
Web Site: www.danddmachine.com  
**Contact:** Mr. Dennis Barbour, President  
**Products:** Soil coring drills, custom dies, hydraulic cylinders, seismic drilling rigs, wool bagging equipment, production machining  
**Services:** Production and manual machining, hydraulic cylinders, welding and fabrication, soil coring drills  
**Exports to:** U.S.A.  
# Employees: 39

## **DACO Western Canada Ltd.**

**(Division of Ridley Inc.)**  
1710 - 36 St. N. Lethbridge T1H 5H9  
Tel: 329-1324 Fax: 380-2043  
**Contact:** Mr. Larry Smid, Sales Manager  
**Products:** Feed premixes  
**Exports to:** U.S.A.  
# Employees: 17

## **Dex Unlimited**

R.R.8, SITE 38, COMP 43 Lethbridge T1J 4P4  
Tel: 320-7962 Fax: 394-0980  
**Contact:** Mr. Tom Kotke, Partner  
**Products:** Livestock trailers, flat-deck trailers, truck decks  
**Services:** Repairs, maintenance, general welding & fabrication  
# Employees: 4

## **Ducan Industries Inc.**

3307 - 6 Ave. N. Lethbridge T1H 5C1  
Tel: 328-3800 Fax: 328-4800  
Web Site: ducanindustries.com  
**Contact:** Mr. Clarence Taal, Vice-President  
**Products:** Wide range of recreational vehicle furniture, office, hospital and hotel/motel furniture. Steel fabrication for applications such as metal frame chairs, beds, awnings, molds. Snowmobile bumpers and feeders, textile insulation, mattresses  
**Exports to:** U.S.A.  
# Employees: 75

## **East-Man Feeds**

322 - 33 St. N. Lethbridge T1H 3Z5  
Tel: 320-0274 Fax: 328-0093  
Web Site: www.eastmanfeeds.com  
**Contact:** Mr. Art B. Friesen, Manager & Nutrition Consultant  
**Products:** Hog premixes & supplements, hog base mixes for hog starters & hog growers, cattle & sheep premixes, soybean meal products  
**Services:** Sales of concrete slats, bins, animal health products  
**Exports to:** U.S.A.  
# Employees: 15

## **Edwards Grain Guard**

Box 1600 Lethbridge T1J 4A2  
Tel: 320-5585 Fax: 320-5668  
Web Site: www.edwardsgrain.com  
**Contact:** Mr. Deb Richter, Controller  
**Products:** Grain aeration equipment, livestock watering equipment, grain aeration blowers and heaters, axial fans  
**Exports to:** U.S.A., France, Russia, Australia, New Zealand  
# Employees: 85

## **El Robcar Manufacturing Ltd. (Rusco Brakes)**

1805 - 2 Ave. S. Lethbridge T1J 0E8  
Tel: 327-2667 Fax: 327-4433

**Contact:** Mr. Craig Ellis, Vice President  
**Products:** Brake shoes and clutches  
**Services:** All types of friction application  
agriculture/industrial custom work  
# Employees: 2

## **Elite Wood Products Ltd.**

820 - 30 St. N. Lethbridge T1H 6E8  
Tel: 320-1755 Fax: 320-1631  
Web Site: [www.elitewoodproducts.com](http://www.elitewoodproducts.com)

**Contact:** Mr. Craig Lundquist, Owner  
**Products:** Kitchen & bathroom cabinetry,  
countertops, custom wood work (wall  
units, china cabinets, etc.), commercial  
millwork

**Services:** Antique Restoration  
# Employees: 10

## **Ellison Milling Company (Div. Parrish & Heimbecker Ltd.)**

P.O. Box 400 Lethbridge T1J 3Z1  
Tel: 328-6622 Fax: 327-3772

**Contact:** Mr. Mike Greer, General  
Manager  
**Products:** Industrial & retail flours (hard,  
soft, and durum), cake & pancake mixes,  
rye flours  
**Exports to:** Worldwide  
# Employees: 70

## **Enercon Water Treatment Ltd.**

3606 - 6 Ave. N. Lethbridge T1H 5C4  
Tel: 328-9730 Fax: 327-4375  
Web Site: [enercon.ca](http://enercon.ca)

**Contact:** Mr Keith Dys, President  
**Products:** Specialty chemicals &  
industrial water treatment chemicals  
# Employees: 40

## **Flexahopper Plastics Ltd.**

2530 - 39 St. N. Lethbridge T1H 5J2  
Tel: 328-8146 Fax: 328-8476  
Web Site: [www.flexahopper.com](http://www.flexahopper.com)

**Contact:** Mr. Bill Spenceley, President  
**Products:** Custom acrylic displays, grain  
& livestock handling equipment, insulated  
& non-insulated bins, polyethylene tanks,  
aerospace products  
**Services:** Design and prototyping,  
manufacturing  
**Exports to:** Europe, Australia, N.  
America, S. America  
# Employees: 40

## **Four Seasons Home Comfort**

1025 - 36 St. N. Lethbridge T1H 6L5  
Tel: 320-9884 Fax: 327-2782  
Web Site:

[www.fourseasonsfireplaces.com](http://www.fourseasonsfireplaces.com)  
**Contact:** Mr. George Duda, President  
**Products:**  
**Services:** Heating & ventilation duct  
work, air conditioning, fireplaces,  
appliances, barbeques  
# Employees: 20

## **Frito-Lay Canada**

2200 - 31 St. N. Lethbridge T1H 5K8  
Tel: 380-5775 Fax: 381-0067  
Web Site: [www.fritolay.ca](http://www.fritolay.ca)

**Contact:** Mr Chris Johnson, Planning  
Manager  
**Products:** Tortilla chips, baked extruded  
snacks, snack mix  
**Exports to:** U.S.A.  
# Employees: 210

## **Gen Manufacturing Ltd.**

Box 560 Coaldale T1M 1M5  
Tel: 345-3414 Fax: 345-3413  
Web Site: [www.wearpoints.com](http://www.wearpoints.com)

**Contact:** Mr. Henry J. Bergen, President  
**Products:** Agriculture equipment, gate  
closures and flags  
**Services:** R&D for design of agricultural  
wear points and seed boots  
**Exports to:** U.S.A., China, France,  
Australia  
# Employees: 11

## **Gergely's Glass Ltd.**

335 - 13 St N Lethbridge T1H 2S1  
Tel: 327-8008 Fax: 380-4022

**Contact:** Mr. John Gergely, Manager  
**Products:** Aluminum window frames  
**Services:** Window repair service  
# Employees: 2

## **Green Prairie International Inc.**

R.R. 8-30-11 Lethbridge T1J 4P4  
Tel: 327-9941 Fax: 327-1103  
Web Site: [www.greenprairie.com](http://www.greenprairie.com)

**Contact:** Mr. John van Hierden, C.E.O.  
**Products:** Timothy Hay Exportable  
Grades  
**Exports to:** Japan, Taiwan, S.Korea,  
USA, S.Arabia, Greece  
# Employees: 65

## **H.S.B. Production Ltd.**

2210 - 41 St. N. Lethbridge T1H 5S3  
Tel: 328-8794 Fax: 328-3922

**Contact:** Mr. Hans Sieber-Borath,  
President  
**Products:** Custom manufacturing  
# Employees: 13

## **Haul-All Equipment Ltd. (Sure Flame Products)**

4115 - 18 Ave. N. Lethbridge T1H 5G1  
Tel: 328-7788 Fax: 328-9956

Web Site: [www.haulall.com](http://www.haulall.com)  
**Contact:** Mr. Dennis Neufeldt, President  
**Products:** Wide area parks mower, leaf  
& litter vacuum equipment, refuse &  
recycling containers, refuse & recycling  
collection bodies & stations, utility  
vehicles, gas fired equipment,  
construction heaters & torches, air  
movers, fans, blowers  
**Exports to:** U.S.A., Caribbean, Asia,  
Mexico, S. America  
# Employees: 120

## **HCA Mountain Minerals (Lethbridge) Ltd**

3403 - 6 Ave. S. Lethbridge T1J 1G6  
Tel: 327-5688 Fax: 327-5187  
Web Site: [www.heemskirkcanada.com](http://www.heemskirkcanada.com)

**Contact:** Mr. Robert Bennett, General  
Manager  
**Products:** Pulverized Barite, pulverized  
gypsum, pulverized zeolite  
**Services:** Ground Zeolite for industrial  
and agriculture use, barite for oil industry  
(drilling fluid additions), powdered  
gypsum for industrial and agricultural use  
**Exports to:** U.S.A.  
# Employees: 18

## **Hy/Lo Machine & Tool (Div. Roga Productions Ltd.)**

2915 - 12 Ave. N. Lethbridge T1H 5K9  
Tel: 328-3464 Fax: 756-2164

**Contact:** Mr. Robert Webber, Owner  
**Products:** Machinery & equipment parts  
**Services:** Machine Shop  
# Employees: 2

## **Ink It Canada Ltd.**

3885 9th Avenue North Lethbridge T1H  
0G8

Tel: 320-7555 Fax: 327-0888  
**Contact:** Mr. Rick Derricott, President  
**Products:**  
**Services:** Remanufacture laser, bubble  
jet, typewriter, cash register, or other  
cartridges & specialty cartridges  
# Employees: 6

## **Inland Concrete Limited**

3104 - 6 Ave. N. Lethbridge T1H 5C3  
Tel: 327-3175 Fax: 327-3193

Web Site: [www.inlandcanada.com](http://www.inlandcanada.com)  
**Contact:** Mr. Rick Boulay, Plant Manager  
**Products:** Ready-mix concrete  
**Services:** Concrete pumping service  
# Employees: 15

# Made in Lethbridge

---

## **Intercontinental Truck Body Ltd.**

1806-11 St, Box 1300 Coaldale T1M 1N1  
Tel: 345-4427 Fax: 345-6078

Web Site: [www.itb.ca](http://www.itb.ca)

**Contact:** Mr. Jake Van Seters, General Manager

**Products:** Custom built aluminum van bodies, trailers, cattle vans, freight vans, service bodies, mobile oil field equipment

**Services:** Parts sales & repairs

# Employees: 88

## **Jay Signs Ltd.**

#4 4010 9 Ave N Lethbridge T1H 5G3

Tel: 327-8794 Fax: 327-2646

**Contact:** Mr. Richard Friesen, President

**Products:** Silk-screening, plastic signs, full line of general signs

**Exports to:** USA

# Employees: 4

## **Joss Technical Ltd.**

3218 - 12 Ave. N. Lethbridge T1H 5V1

Tel: 320-7272 Fax: 328-7606

**Contact:** Mr. Wayne Joss, President

**Products:** Natural gas irrigation engines, pump jack engines for oil & gas industries, heat exchangers, various machine adapters

**Services:** Engine dynamometer services, new product development & patent assistance, mechanical design services

**Exports to:** U.S.A.

# Employees: 3

## **Kawneer Co. Canada Ltd.**

4000 - 18 Ave. N. Lethbridge T1H 5S8

Tel: 382-6730 Fax: 394-7702

Web Site: [www.kawneer.com](http://www.kawneer.com)

**Contact:** Mr. Barry Ferguson, Human Resources Manager

**Products:** Windows, doors, curtain walls, custom aluminum extrusions, store fronts, skylights

**Services:** Architectural engineering, fabrication, electrostatic painting

**Exports to:** U.S.A.

# Employees: 250

## **Kevin Dunn Cabinets**

245D - 12 A St N. Lethbridge T1H 2J2

Tel: 380-3240 Fax: 320-7949

**Contact:** Mr. Kevin Dunn, Owner

**Products:** Kitchen & bathroom cabinets, wall units & desks

**Services:** Installation & service & manufacture

# Employees: 2

## **Kirchner Machine Ltd.**

2419 - 2 Ave. N. Lethbridge T1H 0C1

Tel: 328-5568 Fax: 328-3883

**Contact:** Mr. Dwayne Kirchner, Operations Manager

**Products:** Round bale handling equipment, ditchers, sugarbeet equipment, row crop equipment, utility scrapers, pipe trailers, bean equipment, swath fluffers, potato equipment, manure scrapers, skid steer dozer blades

**Services:** Sales of farm equipment and implements Welding and repair work.

**Exports to:** U.S.A.

# Employees: 25

## **Kirk's Tires**

238 - 22 St. N. Lethbridge T1H 3R7

Tel: 327-5985 Fax: 327-5302

**Contact:** Mr Brad Kirk,

**Products:** Re-tread tires

# Employees: 6

## **Kiwi Iron**

2632 2 Ave North Lethbridge T1H 0C2

Tel: 380-6333 Fax: 329-9026

**Contact:** Mr. James Gibbs, Owner

**Products:** Ornamental iron work, custom manufacturing

**Services:** Installation, powder coating

# Employees: 8

## **Klok Feed Ltd.**

Box 478 Nobleford T0L 1S0

Tel: 381-4906 Fax: 381-6426

**Contact:** Mr. Gerret Beekman, Manager

**Products:** Hog feed & cattle supplement

# Employees: 6

## **LaFarge Canada Inc. Construction Materials Group**

P.O. Box 667 Lethbridge T1J 3Z6

Tel: 328-9251 Fax: 328-8834

**Contact:** Mr. Jonas Slanisky, General Manager

**Products:** Ready mix concrete, concrete blocks, washed and crushed aggregates

**Services:** Concrete pumping service

# Employees: 35

## **Lethbridge Custom Canvas Ltd.**

1262 - 2 Ave. S. Lethbridge T1J 0E6

Tel: 328-8424 Fax: 328-8100

**Contact:** Mr. Craig Fawcett, President

**Products:** Commercial awning signs, truck tarps, agricultural items (swather canvas, drill covers), tents, teepees

**Services:** Custom made items from industrial fabrics, tent rental

# Employees: 9

## **Lethbridge Engine Rebuilders (Div. Wally's Irrigation)**

3610 - 14 Ave. N. Lethbridge T1H 6E7

Tel: 320-0377 Fax: 320-0377

**Contact:** Mr. Les Dyck, Manager

**Products:** Machine Parts

**Services:** Engine machining and rebuilding

# Employees: 2

## **Lethbridge Hides**

3718 - 5 Ave. N. Lethbridge T1H 0P6

Tel: 329-0466 Fax: 329-0466

**Contact:** Mr. Joe Semak, Plant

Superintendent

**Products:** Cured hides

**Exports to:** U.S.A.

# Employees: 10

## **Lethbridge Industries Ltd.**

3305 - 16 Ave. N. Lethbridge T1H 5E8

Tel: 328-4222 Fax: 328-4281

Web Site: [www.lil.ab.ca](http://www.lil.ab.ca)

**Contact:** Mr. Wayne Gayford, General Manager

**Products:** Roller chain sprockets, feed roller mill, spline shafts, pulleys and sheaves, replacement parts for agriculture, oil & gas, mining, forestry & processing

**Services:** Production runs, machining welding, millwright services, CNC machining, turning & flame cutting with CAD/CAM technology, component rebuilding

ISO 9002-94 Certified Quality Assurance Program

# Employees: 25

## **Lethbridge Iron Works Company Limited**

Box 967 Lethbridge T1J 4A2

Tel: 329-4242 Fax: 327-1131

Web Site: [www.lethbridgeironworks.com](http://www.lethbridgeironworks.com)

**Contact:** Mr. Bart Davies, Vice-President of Production and Sales

**Products:** Ferrous castings

**Services:** Value added - machining & painting

**Exports to:** U.S.A., Mexico

# Employees: 115

## **Lethbridge Meats & Seafood Ltd.**

3621 - 6 Ave. N. Lethbridge T1H 5C2

Tel: 329-4912 Fax: 329-4554

**Contact:** Mr. John McNaughton, Manager

**Products:** Beef jerky, sausages, & meat products

**Services:** Food service distribution - custom killing & cutting

# Employees: 25



## **Lethbridge Orthotic-Prosthetic Services Ltd.**

524 - 13 St. N. Lethbridge T1H 2S4  
Tel: 328-1144 Fax: 328-1137

Web Site: [www.bracing.ca](http://www.bracing.ca)

**Contact:** Mr. Armand Huneault,  
President

**Products:** Artificial limbs, orthotic  
bracing, custom footwear, graphite frame  
custom knee orthosis

**Services:** Complete fitting of these  
products

# Employees: 11

## **Let's Pasta Food Services Ltd.**

1510 - 36 St. N. Lethbridge T1H 5H8  
Tel: 328-8288 Fax: 328-8218

**Contact:** Mr. John Suriano,

**Products:** Fresh & frozen pasta and  
sauces

**Exports to:** U.S.A.

# Employees: 10

## **Liberty Boilers & Mechanical Services Inc.**

3302 - 3 Ave. S. Lethbridge T1J 4H5  
Tel: 327-3921 Fax: 328-5794

Web Site: [www.libertyboilers.com](http://www.libertyboilers.com)

**Contact:** Mr. Rick Johnson, President

**Products:** Boilers (steam and hot water),  
oil fired and portable boilers, c.s. & s.s.  
pressure vessels & tanks, condensate  
pumps & tanks

**Services:** Mechanical contractors, boiler  
installations repairs & service, maintenance  
contracts, pressure welding,

carbon & stainless steel pressure piping,  
chemical water treatment, steam fitting,  
repair & rebuild heat exch. Registered  
Q.C. Program AQP 1036

**Exports to:** USA, Russia

# Employees: 13

## **Lou-Mac Manufacturing**

233 - 31 St. N. Lethbridge T1H 3Z4  
Tel: 331-0039 Fax: 394-9514

**Contact:** Mr Bud St. Louis, Owner

**Products:** Plastic injection molding and  
assembly

**Exports to:** USA

# Employees: 17

## **Lucerne Foods**

131 - 22 St. N. Lethbridge T1H 3R6  
Tel: 328-5501 Fax: 327-4737

**Contact:** Mr. Kevin Andresen, Plant  
Manager

**Products:** Frozen juice concentrates,  
frozen vegetables

**Exports to:** Worldwide

# Employees: 49

## **Maple Leaf Pork**

4141 - 1 Ave. S. Lethbridge T1J 4P8  
Tel: 328-1756 Fax: 327-9821

**Contact:** Mr. Dave Wood, Plant  
Manager

**Products:** Boxed pork, chilled pork, pork  
offal, rendered products

**Exports to:** U.S.A., Mexico, Japan,  
Australia, Russia, China, Taiwan,  
Singapore, Korea

# Employees: 300

## **Maple Leaf Potatoes**

2720 - 2A Ave. N. Lethbridge T1H 5B4  
Tel: 380-9900 Fax: 328-5262

**Contact:** Mr. Lee Glaim, Plant Manager

**Products:** Frozen french fries & related  
products

**Exports to:** Japan, Singapore, Taiwan,  
Mexico, U.S.A., Saudi Arabia, Malaysia,  
Korea, Indonesia, Philippines, Hong  
Kong, Venezuela

# Employees: 150

## **Master Feeds**

Box 87 Picture Butte T0K 1V0

Tel: 732-5633 Fax: 732-4862

Web Site: [www.masterfeeds.com](http://www.masterfeeds.com)

**Contact:** Mr. Jassen Jackman, Plant  
Manager

**Products:** Animal feed products, dairy,  
poultry, swine, beef & special feeds

**Services:** Agricultural support & animal  
nutrition

**Exports to:** U.S.A.

# Employees: 11

## **McCain Foods (Canada)**

Box 1479 Coaldale T1M 1N3

Tel: 345-4418 Fax: 345-4419

**Contact:** Mr. Brad Doak, Human  
Resources Manager

**Products:** French fries & potato products

**Exports to:** Japan, Pacific Rim, U.S.A.,  
Mexico

# Employees: 281

## **Modern Machine Shop Ltd.**

2720 - 2 Ave. N. Lethbridge T1H 0C2

Tel: 320-8815 Fax: 320-9394

**Contact:** Mr. Charlie Rabl, Manager

**Products:** Replacement parts for  
industry, general machining

**Services:** Repair & millwright service

**Exports to:** U.S.A.

# Employees: 3

## **Mo-Tires Ltd.**

2830 - 5 Ave. N. Lethbridge T1H 0P1  
Tel: 329-4533 Fax: 329-4070

Web Site: [www.mo-tires.com](http://www.mo-tires.com)

**Contact:** Mr. Brian Roelofs, President

**Products:** Tire retreads, tread rubber,  
miscellaneous rubber products

**Services:** Sale & installation of tires

**Exports to:** U.S.A.

# Employees: 35

## **National Neon**

3302 - 5 Ave. N. Lethbridge T1H 0P5

Tel: 327-4215 Fax: 327-3145

Web Site: [nationalneon.com](http://nationalneon.com)

**Contact:** Bob Brown,

**Products:** Custom backlit illuminated,  
neon, and non-illuminated including CNC  
routed signage

**Services:** Full service - signs installing,  
signs service & maintenance, neon unit  
fabrication, computerized routing

# Employees: 20

## **New Life Feeds (Division of Ellison Milling Company)**

1301 - 2 Ave. S. Lethbridge T1J 3Z1

Tel: 328-6622 Fax: 327-3772

**Contact:** Mr. Wayne Holt, Manager

**Products:** Animal feed products

**Services:** Agricultural support & animal  
nutrition

**Exports to:** U.S.A.

# Employees: 15

## **Newwest Feeds & Nutritional Services**

3845 - 9 Ave. N. Lethbridge T1H 6G8

Tel: 320-2777 Fax: 329-4228

**Contact:** Mr. Sinisa Micovic, Owner

**Products:** Dairy feed

**Services:** Dairy nutrition

**Exports to:** U.S.A.

# Employees: 5

## **Noble Concrete 1987 Ltd.**

Box 176 Picture Butte T0K 1V0

Tel: 732-5628 Fax: 732-5629

Web Site: [www.nobleconcrete.com](http://www.nobleconcrete.com)

**Contact:** Mr. Tom Caruso, General  
Manager

**Products:** Ready-mix concrete

**Services:** Mobile concrete plant, mobile  
batching plant, slipforming concrete

# Employees: 16

# Made in Lethbridge

---

## **Nord International Inc.**

320 Bridge Dr. W. Lethbridge T1J 4S5  
Tel: 381-6933 Fax: 381-9447

**Contact:** Mr. Norbert Bohnert, President  
**Products:** Architectural & structural pre-cast concrete components, pre-cast specialty items

**Services:** Project management, general contracting & research

**Exports to:** U.S.A.

# Employees: 20

## **Normerica Inc.**

112 - 30 St. N. Lethbridge T1H 3Z1  
Tel: 320-6117 Fax: 320-2771

Web Site: [www.normericainc.com](http://www.normericainc.com)

**Contact:** Mr. Rob Saar, Plant Manager

**Products:** Cat litter

**Exports to:** U.S.A.

# Employees: 30

## **Northern Lights Glass Studio**

3177 - 5 Ave. N. Lethbridge T1H 0P2  
Tel: 329-6008 Fax: 329-6008

**Contact:** Ms. Irene Secretan, Owner

**Products:** Stained glass windows and glass sand blasting, trophies & awards, torchwork, beads & jewellery

# Employees: 3

## **Overhead Door Company**

2835 - 12 Ave. N. Lethbridge T1H 5K9  
Tel: 328-0922 Fax: 329-0250

Web Site: [www.overheaddoor.tv](http://www.overheaddoor.tv)

**Contact:** Mr. Craig Watson, Manager, Sales & Marketing

**Products:** Pre-hung door systems

**Services:** Installation & service of door systems & windows

# Employees: 34

## **Park Lake Welding & Mfg.**

Box 22 Picture Butte T0K 1V0  
Tel: 381-4706 Fax: 381-3788

Web Site: [www.parklakewelding.com](http://www.parklakewelding.com)

**Contact:** Mr. John VanSchothorst, Owner/Manager

**Products:** Vacuum tanks, dairy and livestock equipment, feeders, & land rollers

**Services:** Parts & service for vacuum pumps & tanks

**Exports to:** U.S.A.

# Employees: 8

## **Parmalat Canada Inc.**

3410 - 24 Ave. N. Lethbridge T1H 5K3  
Tel: 380-5200 Fax: 320-5493

Web Site: [www.parmalat.ca](http://www.parmalat.ca)

**Contact:** Mr. Claude Bilodeau, Manager  
**Products:** Cottage cheese, sour cream, yogurts

**Services:** Distribution of products to stores, restaurants, and institutions

# Employees: 50

## **Peka Rollshutters Ltd.**

1246 - 3 Ave. N. Lethbridge T1H 0J1  
Tel: 329-4597 Fax: 329-4577

Web Site: [www.rollshutters.net](http://www.rollshutters.net)

**Contact:** Mr. Peter Mueller, President

**Products:** Aluminum roll-shutters

**Services:** Installation & service of roll-shutters

**Exports to:** U.S.A.

# Employees: 4

## **Pounder Emulsions**

705 - 36 Street N. Lethbridge T1H 5H4  
Tel: 328-0277 Fax: 328-0025

**Contact:** Mr. Joel Jagielski, Plant Manager

**Products:** Asphalt emulsion

**Exports to:** U.S.A.

# Employees: 2

## **Pratt & Whitney Canada (Div. of United Technologies)**

4045 - 26 Ave. N. Lethbridge T1H 6G2  
Tel: 380-5144 Fax: 380-5180

Web Site: [www.pwc.ca](http://www.pwc.ca)

**Contact:** Mr. Bill Halley, Plant Manager

**Products:** Aircraft engines

**Services:** Assembly & test of gas turbine engines

**Exports to:** Worldwide

# Employees: 136

## **Precon Precast Products**

1315 - 33 St. N. Lethbridge T1H 5H2  
Tel: 327-2711 Fax: 329-0596

Web Site: [www.precon.ca](http://www.precon.ca)

**Contact:** Mr. Jim Cunningham, Owner/President

**Products:** Municipal precast products: manhole & catch basin components, vault structures & buildings; Irrigation precast products: inlet structures, check & check drop structures, and pipeline inlets

**Services:** Delivery of same products

**Exports to:** U.S.A.

# Employees: 25

## **Prestige Panko Inc.**

3609 - 18 Ave. N. Lethbridge T1H 6C2  
Tel: 317-2020 Fax: 317-0333

Web Site: [www.prestigepanko.com](http://www.prestigepanko.com)

**Contact:** Mr Mark Shmygol, Vice-President

**Products:** Japanese style fresh bread crumbs

**Exports to:** USA, South America, Europe, China

# Employees: 10

## **RCL Metalworks Inc.**

Box 189 Picture Butte T0K 1V0  
Tel: (403) 732-4493 Fax: (403) 732-5440

Web Site: [www.rclmetalworks.com](http://www.rclmetalworks.com)

**Contact:** Mr. Doug Rudelich, General Manager

**Products:** Square feed bins, feedmill components, fabricated products

**Services:** Welding, fabricated, machining, installations

**Exports to:** U.S.A.

# Employees: 15

## **Regent Home Systems (Division of SRI Homes Inc.)**

131 Stubb Ross Road S. Lethbridge T1J 3Z6

Tel: 328-7731 Fax: 328-7285

Web Site: [srihomes.com](http://srihomes.com)

**Contact:** Mr. Ken R. Josuttis, P.Eng, Plant Manager

**Products:** Manufactured homes (single & modular double wide)

**Exports to:** U.S.A.

# Employees: 180

## **Rehabilitation Society of Southwestern Alberta**

1610 - 29 St. N. Lethbridge T1H 5L3  
Tel: 329-3911 Fax: 329-3581

Web Site: [www.rehab.ab.ca](http://www.rehab.ab.ca)

**Contact:** Mr. Irwin Wyrystok, Operations Manager

**Products:** Buttons, lath, stakes, custom industrial woodworking, crates, frames

**Services:** Complete bottle depot, supported work service for adults with disabilities, lawn crew, light assembly work, piece work, labelling, packaging

# Employees: 92

## **Rick's Concrete Products**

2343 - 2 Ave. N. Lethbridge T1H 0C1  
Tel: 329-3686 Fax: 317-0072

**Contact:** Mr. Rick Veldjesgraf, Owner

**Products:** Precast curbs & lawn ornaments, custom precast

# Employees: 3

**Rox Landscape Products Ltd.**

3621 - 8 Ave. N. Lethbridge T1H 5C8  
Tel: 328-3330 Fax: 328-3330  
Web Site: roxcanada.com

**Contact:** Mr. Aric Pavan, Owner

**Products:** Landscape blocks and mold making, precast concrete products

**Exports to:** U.S.A.

# Employees: 7

**Sakai Spice (Canada) Corporation**

4201 - 2 Ave. N. Lethbridge T1H 0C8  
Tel: 320-9445 Fax: 320-9446  
Web Site: www.sakaispice.com

**Contact:** Mr. Merv Newinger, Director of Operations

**Products:** Mustard flour and mustard cake, wasabi

**Services:** Supply farmers with oil for cattle feed and ship mustard flour and cake and wasabi powder

**Exports to:** Japan, Pacific Rim, U.S.A., Europe, South America, Australia

# Employees: 24

**Southland Trailer Corp.**

1405 - 41 St. N. Lethbridge T1H 6G3  
Tel: 327-8212 Fax: 327-8256  
Web Site: www.southlandtrailers.com

**Contact:** Mr. Monty Sailer, Chief Operating Officer

**Products:** Gravel equipment (boxes, pups, end dumps, wagons, belly dumps), grain boxes, unibodies, horse trailers, stock trailers-aluminum & steel, equipment trailers, flatdeck trailers, cargo trailers

**Services:** Manufacture service and repair trailers

**Exports to:** U.S.A.

# Employees: 160

**Sun Cured Alfalfa Cubes Inc.**

Box 62 Lethbridge T1J 3Y3  
Tel: 381-4764 Fax: 381-9078

**Contact:** Mr. Norm Watmough, Owner

**Products:** Cubed alfalfa hay

**Exports to:** Japan, Korea

# Employees: 6

**Sunnyrose Cheese (Div. of Agropur)**

Box 93 Diamond City T0K 0T0  
Tel: 381-4024 Fax: 320-4259

**Contact:** Mr. Doug Wingfield, Office Manager

**Products:** Cheddar, Colby, Mozzarella, Monterey Jack, Gouda, Marble and specialty cheeses

# Employees: 35

**The Black Velvet Distilling Company**

2925 - 9 Ave. N. Lethbridge T1H 5E3  
Tel: 317-2100 Fax: 317-2125

**Contact:** Mr. Rory Wright, Plant Manager

**Products:** Canadian whiskey, gin, vodka, tequila, rum

**Exports to:** U.S.A., Europe, Taiwan, Russia, Korea, New Zealand, Israel

# Employees: 59

**The Kitchen Centre Ltd.**

220 Stafford Dr. N. Lethbridge T1H 2A4  
Tel: 329-1813 Fax: 320-1077

Web Site: www.thekitchencentreltd.com

**Contact:** Mr. John Bane, President

**Products:** Kitchen & bathroom cabinets, millwork

**Services:** Installation, service & design

**Exports to:** U.S.A.

# Employees: 20

**Timber-Tech Truss Inc.**

1405 - 31 St. N. Lethbridge T1H 5G8  
Tel: 328-5499 Fax: 320-5835

Web Site: www.timbertechtruss.com

**Contact:** Mr. Kelly Skauge, Manager

**Products:** Wooden roof & floor trusses

**Services:** Dealer of structural wooden components (joists, beams)

# Employees: 20

**Triple J Contracting Inc.**

Stewart Siding/3801 Pebble Pl. S.  
Lethbridge T1K 3V1

Tel: 327-4810 Fax: 380-4729

**Contact:** Mr. Duane Farries, Owner

**Products:** Chain link gates & fences, Texas gates, handrails, and rebar cages for foundation pilings, design built metal products

**Services:** Installation & service of fences & foundation pilings

# Employees: 4

**Triple M Housing Ltd.**

185 Stubb Ross Road S. Lethbridge  
T1K 7N3

Tel: 320-8588 Fax: 320-9004

Web Site: www.mmmhousing.com

**Contact:** Mr. John Bennett, General Manager

**Products:** Manufactured housing - single and double wides, sectional and modular, modular econo lines, multi family/apartment blocks

**Exports to:** U.S.A., Japan

# Employees: 260

**Unifeed Ltd.**

1810 - 39 St. N. Lethbridge T1H 5J2  
Tel: 328-1731 Fax: 328-5515

**Contact:** Mr. Robert E. McDonald, Manager

**Products:** All types of livestock feeds

**Services:** Management & nutritional expertise

**Exports to:** U.S.A.

# Employees: 46

**Varsteel Ltd.**

2900 - 5 Ave. N. Lethbridge T1H 6K3  
Tel: 329-0233 Fax: 327-0630

Web Site: www.varsteel.net

**Contact:** Mr. Thomas B. Mansfield, General Manager

**Products:** Anchor bolts, threaded water well casing, fabricated reinforcing steel

**Services:** Pipe & round steel threading, custom band sawing, shearing & braking, plate rolling, flame cutting, reinforcing steel, plasma cutting

**Exports to:** U.S.A.

# Employees: 32

**Wally's Irrigation Services (1985) Limited**

4314 - 1 Ave. S. Lethbridge T1J 4B3  
Tel: 328-9382 Fax: 328-5321

**Contact:** Mr. Walter Franz, President

**Products:** Genset & pumping units, screenboxes and gun carts

**Services:** Irrigation maintenance and repairs

# Employees: 28

**Wheatland Bins**

3125 - 24 Ave. N. Lethbridge T1H 5G2  
Tel: 320-7070 Fax: 320-7579

Web Site: www.wheatlandbins.com

**Contact:** Mr. Brian Macdonald, Senior Vice-President

**Products:** Hopper bottom fertilizer and grain storage bins

**Services:** Custom Manufacturing

**Exports to:** U.S.A.

# Employees: 67

**Wilbur-Ellis Company of Canada Ltd.**

R.R. 8-2-9 Lethbridge T1J 4P4  
Tel: 328-3311 Fax: 328-3365

Web Site: wilburellis.com

**Contact:** Mr. Brent Quintin, General Manager

**Products:** Double compressed hay

**Exports to:** USA, Europe, Japan, Korea

# Employees: 25

# Economic Development



## *LETHBRIDGE*

200, 817 – 4<sup>th</sup> Avenue South  
Lethbridge, Alberta T1J 0P3

Telephone: (403) 331-0022  
Fax: (403) 320-0202

**1-866-213-4070**

Website: [www.ecdevlethbridge.com](http://www.ecdevlethbridge.com)  
E-mail: [info@ecdevlethbridge.com](mailto:info@ecdevlethbridge.com)

Printed in Canada for Free Distribution

Although every effort was made in good faith to ensure the accuracy of the information contained herein, Economic Development Lethbridge accepts no warranty nor accepts liability from any incorrect, incomplete, or misleading information or its improper use.

© 2005 Economic Development Lethbridge