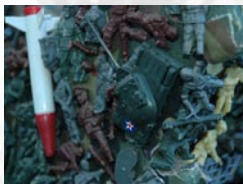

**1. Tiwi Design Aboriginal Corporation**

Wayai, 2.2m, Immaculata Tipungwuti, Tessie Tipungwuti, Jane Aliminkinni
Purukupali, 1.75m, Immaculata Tipungwuti, Tessie Tipungwuti, Jane Aliminkinni
Moonman, 2m, John Patrick Kelantumama
Bima, 1.55m, Bede Tungatalum
 Five prominent and nationally exhibited Tiwi artists tell their story of how death arrived on the Tiwi islands, representing the ancestors Purukupali, Moon-Man, Bima, Jirmani and the Pukumani ceremony. Today, Pukumani ceremonies are performed for each Tiwi person who passes away.

**2. Zeb Olsen**

Free 2006. Polyethylene, waxed string, tent pegs
 The work is intended as a stimulus for contemplation on the concepts of freedom, camping, homelessness, hopelessness, loneliness and social isolation.
 Zeb Olsen is a Darwin based writer, filmmaker, musician and visual artist interested in the personal experiences of politics and social interaction and their expression through the arts.

**3. Fiona Gavino**

Evolution Revolution 2002. Mixed media
 Evolution Revolution / We don't want no violent revolution / Yet blindly we are led...../
 Images are fed to us / Managing to sedate us / Sedation they say / Is the new tool of democracy / People..... speak up, speak up, speak up
 Fiona Gavino is a Darwin artist of Spanish/Filipino, Maori and Anglo Australian heritage, making her a 'typical Aussie'. Gavino's artwork is conceptually driven by a well-developed political consciousness.

**4. Dripstone High School - Nellie McLean**

There was this terrible accident involving a bird and a box kite 2006. Mixed media
 I based this particular work on the early aircrafts of Wilbur and Orville Wright, the inventors of the aerial age. I decided to make it more modern,
 I am currently studying year twelve art at Dripstone High School. I chose to enter Sculpture in the Park because I plan to study art at a university level and enjoy art.

**5. Rozzi George**

Tree Cozy 2006. Assorted knits
 I propose wrapping one of the large trees with knitted garments and items. This is a continuation of my knitted artistic journey over the last year or so.
 I have been involved in the Darwin art scene for the last 25 years. I am currently studying a Bachelor of Visual Arts at CDU. My present body of work focuses on knitted objects.

**6. Kathy Hillery**

Self-Protection/Self-Strangulation 2006. Metal
 In recent years the Australian Government has excised its own islands, deported its own citizens, and incarcerated innocent children behind razor wire in order to keep "undesirables" out.
 Born in the NT, Kathy Hillery (nee Downing) studied in Canberra and taught in the NT and Indonesia before completing a Bachelor of Visual Arts at CDU in 2005.

**7. Ivor Cole**

The leaning tower of pizza 2006. Marine ply, steel, concrete, enamel paint
 This sculpture makes an icon of 'vandalised' urban structures and youth popular culture. Viewers are encouraged to provide the 'topping' with their own graffiti.
 I have been working in art practice and exhibiting both three-dimensional and two-dimensional works since 1969. My work has been exhibited in galleries in the UK, USA, Scandinavia and Australia.

**8. Georgia Glen**

SHOGS - The quiet lawnmower 2006. Off-cut recycled timber, wire and washers
 SHOGS, a genetic crossbreed of domesticated animals (sheep/hens/dogs/humans), are grazing peacefully on the city park lawns.
 Georgia Glen is a Darwin based artist working across a broad range of media, including video, sculpture, digital and drawing.

**9. Geoff Sharples**

Black Triangle 2006. Painted timber
 I've had great pleasure creating this sculpture. The triangle is my favourite shape.
 1957 Started High School in Adelaide/ 1961 Commenced at the South Australian School of Art/ 1964 Graduated, Diploma of Fine Art/ 1971 Arrived in Darwin/ 2006 Enjoying Darwin more than ever

**10. John Hazeldine**

The Noble Herd 2005 - 2006. Limestone and sheet steel
 The Noble Herd limestone component was commenced in Mt Gambier at the National Sculpture Symposium in 2005 and completed in Darwin in July 2006. Lived in Darwin for 24 years. Works from Small Pond Studio in Malak.
 Represented in permanent collections in Australia and New Zealand. Designed Solomon Islands Flag and Coat of Arms.

**11. Glynis Lee**

The Expanding Forest 2005. PVC Pipe
 The construction of language is explored in this work. The Chinese character for 'wood' or 'tree' (mu) when doubled becomes 'forest' (lin), while tripling the character transforms the meaning to 'large forest' (senlin).
 Originally from North Queensland, Glynis Lee has resided in Darwin for the past twelve years. Concentrating predominately in printmaking, with a focus in the three-dimensional form, Glynis is currently undertaking a B.VisArts at C.D.U.

**12. Sarah Body**

On the horns of a dilemma - too many? 2006. Mixed media
 Mankind's strong desire to procreate is leading us where exactly?
 With a background in art and science, Sarah Body has regularly exhibited in Darwin since 1999 as well as being selected in the 2005 Alice Craft Acquisition and exhibited in The Artist sans in the Garden, Sydney Botanic Gardens.

**13. Aly de Groot**

Transient Nature. 2006. Palm berry stalks, pandanus bush dyes & cane
 A celebration of the diversity of cultures and the intensity of the Darwin climate, which inspires so many people to flock here in the cooler months.
 The artwork is the result of collaboration with community members attending a fibre arts workshop led by local artist, Aly de Groot, who uses plant material to create art as political, social and environmental commentary.
 Photo by Peter Solness

**14. Jean Martin**

Omphalodium Observation. 2006. Handmade paperpulp & twine
 Fascinating folds of flesh lie at the centre of the abdomen. They are a reminder of our connection to those who gave us life.
 I am currently completing my final year of a Bachelor of Visual Arts, majoring in Photography, however I do dabble in the odd sculptural piece.

**15. Lia Ngaree Gill**

Worm 3 2006. Fencing wire, papermache, paperbark and leaves
 'In nature the world of relativity does not exist.'
 Massanobu Fukuoka, The One Straw Revolution
 Most of my work reflects my concern with environmental issues. I predominately use materials indigenous to the local area I work in.

**16. Palmerston High School Art Group**

Lost on Empire Road 2006. Mixed media
 The church is symbolic for the beliefs that influence human communities' direction through life, answering the needs for different peoples at a time in a place. The Roman Falls Church has ceased to function at this time.
 A narrative installation crafted and assembled by a group of Year 11 and 12 students and guided by their teacher.

**17. Imbi Davidson**

Colonisation 2006. Plaster, wire pigment
 My work reflects an ongoing interest in repetition within the landscape, especially in the form of termite mounds. This work investigates the ecology of the termite mound as a metaphor for human processes of 'colonisation'.
 In 1999, I hitchhiked from Adelaide to Katherine becoming interested in the forms of roadside termite mounds and their associations with the human body.

**18. Winsome Jobling**

NESTS 2006. Pink Proposed Development signs
 Developments destroy or damage natural habitats allowing an influx of feral species. A globalisation of ecology is underway. Akin to the seeming globalisation of ugly architecture!!
 I have lived in Darwin for around twenty years. My primary medium is handmade plant fibre paper. I have used pink Proposed Development signs for sculptural works in various forms for the last six years.

**19. Darwin High School**

Toads go home 2006. Mixed Media
 Cane toads have been coming to Darwin for a few years and we dread their environmental impact. Green tree frogs inhabit our work areas and we love them.
 Darwin High School middle and senior school students have participated in this project. The variety of frogs are loved, concern for their wellbeing is shown in their protest.

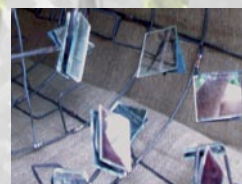
**20. Ben Shimeld**

Tear Drop 2006. Mattress inner spring frame, industrial fabrics & found mirror
 Every being has been inside the tear drop of life. This piece questions our whole reality, how complex we are and how altered we've become. I look through the Tear Drop of life and see the world in its fractured state, disconnected and disjointed.
 Benjamin Shimeld is currently studying fine arts at CDU with a focus in printmaking and sculpture when he has time between being a dad and cabinetmaker.

**21. Jett Street**

Trunklace 2006. Natural and manufactured materials
 This concept extends worn sculptural adornment into jewellery for a tree. Creatively assisted by the lovely Haylee Robinson.
 Jett loves jewellery and animation, and sometimes humans.

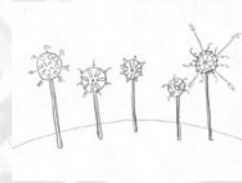
**22. Henbury School**

Here we are, 2006. Hubcaps decorated with shells, feathers, found objects, hung on tall poles.
 Here we are. A gathering of our creative energies. Together Strong and Beautiful. Created by the students of Henbury School.

**23. Adrienne Kneebone**

"as rough as grass undies" 2006. Hills Hoist, women's underwear, grass & pegs
 I like the contrast between the hidden and sensual nature of women's underwear and the awkward, itchy nature of wild grass. Both beautiful, provoking a reaction and allowing thought to reflect on the aesthetics of the NT environment.
 Adrienne Kneebone has been working as a fibre artist in the NT for the past seven years. Her work focuses on the feminine creating domestic, and non-domestic artefacts.

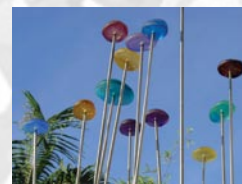
**24. Helen Peake**

Sky Stones 2006. Cast glass stones & stainless steel rods
 In 1968 I came to Darwin - and stayed. I have since emerged with a Masters in Fine Art and continue to practice as artist, artisan, designer, teacher and mentor.
 My finished works range in size from sculptural installations in landscape to wearable pieces. I feel that what I do is play endlessly and obsessively with ideas of landscape; the mythologies, perceptions and experiences of the Northern Territory. And the result of all this mental and physical play is I am a maker!

**25. 'Women Behind Bars' Darwin Prison**

As free as a bird 2006. Mixed media
 Birds are symbols of freedom, we watch them fly in and out whenever they like. If we could fly over the wire, we would.
 'Women Behind Bars' is a creative group of people, comprising of female inmates and art education staff at Darwin Prison, guided by Veronica Priestly.

**26. Katrina Tyler**

Dewdrops in the Garden 2006. Mirrors, glass beads & fishing wire
 Dewdrops in the Garden enlarges and brings into permanence the effect of tiny droplets of morning dew caught on spiders' webs. Miniature garlands, momentary, fragile and jewel-like.
 Katrina Tyler designs jewellery and objects influenced by the beauty she finds in the impermanence, fragmentation and decay found in her surroundings.

**27. Tobias Richardson**

Mystery Service 2005. Wood, enamel & acrylic paint
 Mystery Service is part of an ongoing inquiry into the peripheries of urban design. The work deals with the interface between function and decoration and the compromises that each make.
 Richardson has exhibited locally and nationally, has studied education, science and visual arts in Australia and overseas. Tobias works with a variety of mediums and currently lectures at Charles Darwin University.

**28. Claudio Carrus & Carol Phayer**

Have you heard? 2006. Impermanent paint
 With mobiles and gadgets we are removed from our immediate environment. Our installation is an attempt to give people an opportunity to become more aware of their environment
 Claudio Carrus, born Berlin; Fine Art tertiary studies; currently writing screenplay.
 Carol Phayer, born Holland; BFA N.T.U.; various exhibitions in Darwin galleries.

SCULPTURE IN THE PARK 2006

From August 6 to 13 visitors to Civic Park will discover the diverse art practice the Northern Territory has to offer, including fibrework, metal work, glasswork and innovative use of recycled materials by artists including established, emerging, Indigenous and school students. Darwin city comes alive with a vibrant range of public art, large and small, monumental and subversive, innovative and contemporary.

Civic Park is located behind Browns Mart, in Darwin City, between Smith Street, Darwin Civic Centre and Christ Church Cathedral.

The information marquee is at the Smith Street entrance to Civic Park and open 10am – 6pm daily. Works are for sale, pricelist available at marquee.

For further information contact the Project Officer Talitha Kennedy.
T 08 8981 5522 E sip@brownsmart.com.au W www.brownsmart.com.au



Sculpture in the Park Opening Event

Sunday 6 August, 4pm at Civic Park

Russell Lilford, Blood of Nation

Sculptural performance

We have the capability of shifting perception through our art and actions, beyond fear through to freedom. The work I present is an honest, spontaneous and sometimes reflective look at situation or parody of self-awareness. I try to evoke humour, sadness and a whole range of emotional states that interplay and engage the audience.

Matt Ryder

Sound performance

Original, acoustic rock/roots that engages the audience on an emotional level whilst delivering aggression and technical rhythm in an intriguing unique way.

Smash It I Dare Ya!

Making spontaneous appearances throughout Darwin city, including Sculpture in the Park, will be a collection of piñata's embracing the tragedy and destruction of a broken heart. 10 piñata's representing the feelings and emotions you go through in process of a relationship. The good, bad and the ugly. This is a please touch, and even smash, exhibition by Boozy Thorne



Diversity: Sculpture in the Park closing event

Sunday 13 August, 4pm at Brown's Mart

The Paspaley People's Choice Award as part of an afternoon of multicultural entertainment including the Belfast Poets, Kulture Diversity, Midnight Oasis, Samba Rascals with Indian and Pacific Island Dancers.

Thanks to our supporters

This event follows on the success of Sculpture in the Park in 2002 and 2004. Sculpture in the Park is funded by the NT Government and Darwin City Council. It is organised by the Trustees of Brown's Mart, 24HR Art and Brown's Mart Community Arts, as part of the Darwin Festival and Darwin Fringe, with the support of Darwin Visual Arts Association (DVAA), Christ Church Cathedral and local businesses.

Partners



Special thanks to the Sculpture in the Park sponsors:

Paspaley for the Paspaley People's Choice Award; Chubb providing security; Fosters Australia with Pure Blonde supporting the opening event; Shadetec providing the information marquee; Coleman's supporting the print material; Yellow Tail Wines supporting the opening event, also with assistance from Vintage Cellars; the award prizes have been made possible thanks to J. Bird Memorial, Palm Photographics, Territory Colours, Parap Family Dental, Cavenagh Medical Centre, Jackson's Drawing Supplies, Helmet Hair Studio, Darwin Central Hotel, Birch Carol & Coyle, Creative Jewellers & Roma Bar; and many thanks to the volunteers.

Major Sponsors



Map Legend

- | | |
|--|--|
| 1. Tiwi Design Aboriginal Corporation | 2. Zeb Olsen |
| 3. Fiona Gavino | 4. Dripstone High School - Nellie McLean |
| 5. Rozzi George | 6. Kathy Hillery |
| 7. Ivor Cole | 8. Georgia Glen |
| 9. Geoff Sharples | 10. John Hazeldine |
| 11. Glynis Lee | 12. Sarah Body |
| 13. Aly de Groot | 14. Jean Martin |
| 15. Lia Ngaree Gill | 16. Palmerston High School Art Group |
| 17. Imbi Davidson | 18. Winsome Jobling |
| 19. Darwin High School | 20. Ben Shimeld |
| 21. Jett Street | 22. Henbury School |
| 23. Adrienne Kneebone | 24. Helen Peake |
| 25. 'Women Behind Bars' Darwin Prison | 26. Katrina Tyler |
| 27. Tobias Richardson. 7 sculptures in various locations in Civic Park & Smith St Mall. | |
| 28. Carol Phayer and Claudio Carrus. Various locations in Civic Park & surrounds, see flyer at marquee | |

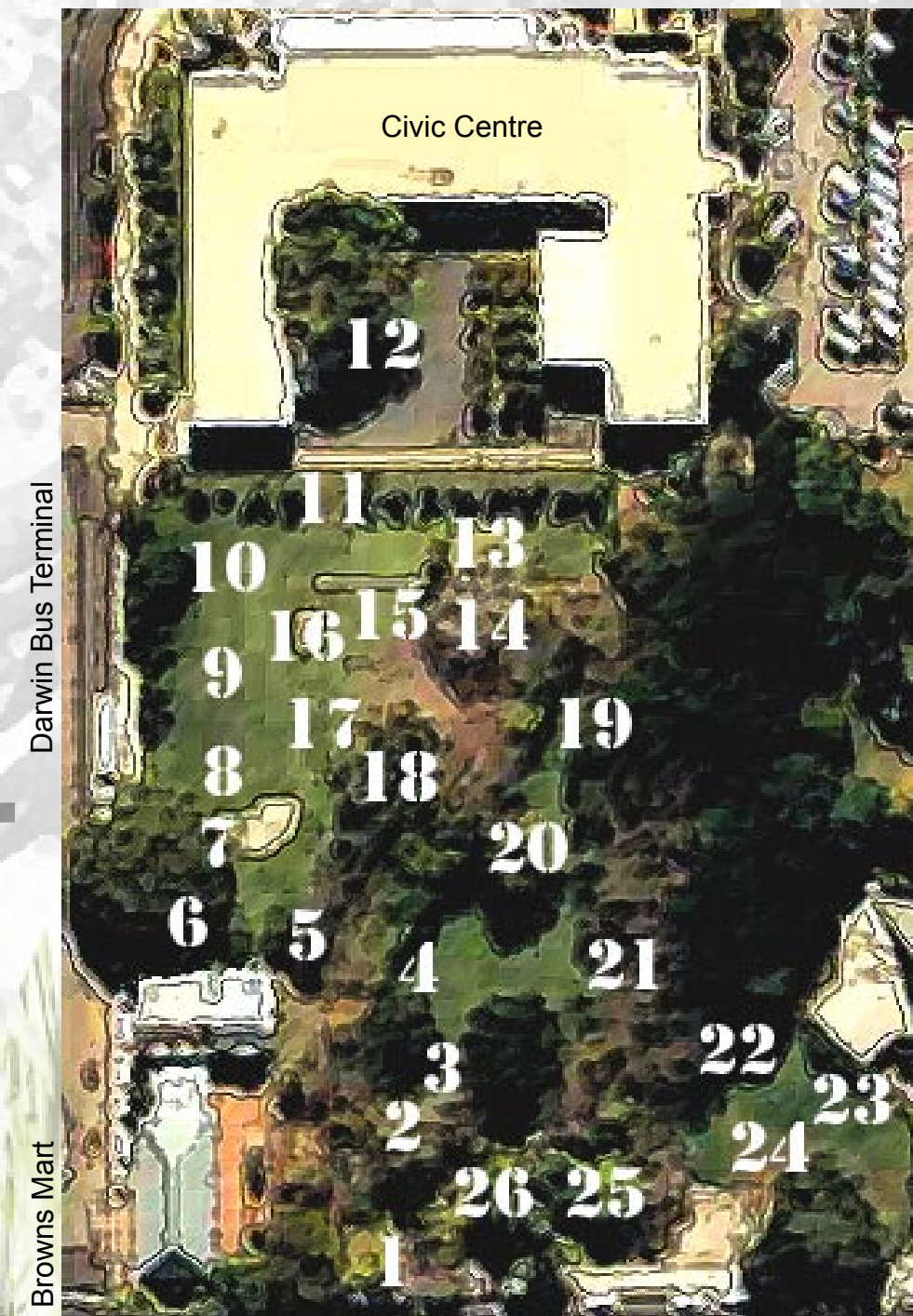

Darwin Bus Terminal

Browns Mart

Smith Street

Tiwi Design Aboriginal Corporation. Zeb Olsen. Fiona Gavino.
Dripstone High School - Nellie McLean. Rozzi George. Kathy Hillery. Ivor Cole.
Georgia Glen. Geoff Sharples. John Hazeldine. Glynis Lee. Sarah Body. Aly de Groot.
Jean Martin. Lia Ngaree Gill. Palmerston High School Art Group. Imbi Davidson.
Winsome Jobling. Darwin High School. Ben Shimeld. Jett Street. Henbury School.
Adrienne Kneebone. Helen Peake. 'Women Behind Bars' Darwin Prison. Katrina Tyler.
Tobias Richardson. Carol Player and Claudio Carrus.

SCULPTURE IN THE PARK 2006

A free public art event as part of the Darwin Fringe Festival and Darwin Festival
6 - 13 AUGUST
CIVIC PARK, DARWIN CITY