

Hector - 1D6



Airport Manager: Ed Newberg - 320-848-2745 - newberg@hcctel.net

Contact Person: Ed Newberg - 320-848-2745 - newberg@hcctel.net

Chamber of Com: 320-848-2122 - hector.govoffice.com

Aero Cht Coord: 11-F

AWOS/ASOS: No

MnWAS Loc/Hrs: Arrival/Departure Building - 24 hours

Attended: All/All/All

Fuel: 100LL

Self Service Fuel: No

After Hrs Service: 320-848-2745

FBO(s): Newberg Sky Spray, LLC - 320-848-2745 - newberg@hcctel.net - www.pipercubs.com

Ground Transport: Possible - call Ed Newberg

Food Service: None

Dining: Pete's Grill - 320-848-2200 - 1 mile
High Point Café - 320-848-6112 - 1 mile
The Other Place - 320-848-6421 or 320-848-6428 - ½ mile
Cenex Pizza & Subs - 320-848-2286 - ½ mile

Lodging: Sheepshed Hotel - 320-523-5000 - 15 miles West
212 Motel - 320-523-1480 - 15 miles West

Airport Events: Annual Flight Breakfast - third Sunday in September

Underwing Camp: Yes

Campgrounds: None reported

Golf Courses: Oakdale Country Club - 12 miles

Local Attractions: Corn Chaff Days - second weekend in July

Comments: Newberg Brothers (aircraft sales) - www.pipercubs.com

FIELD ELEV. 1077'

(ID6)

HECTOR

VICINITY MAP

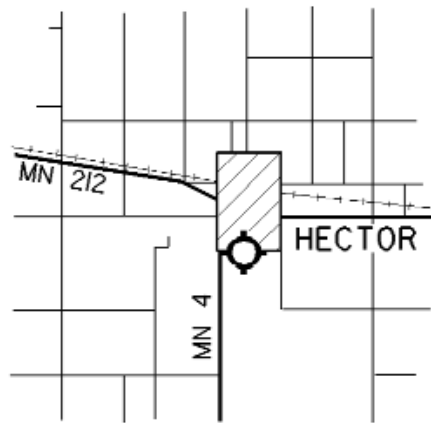

SEC. CH: TWIN CITIES (S)

LAT: 44° 43.9'

LONG: 94° 42.9'

COMM: CTAF: 122.8

MPLS CTR: 127.1

RNAV: (RWF 113.3) R044 D23.9

TPA: 1880' (803')



N VARIATION
4° E

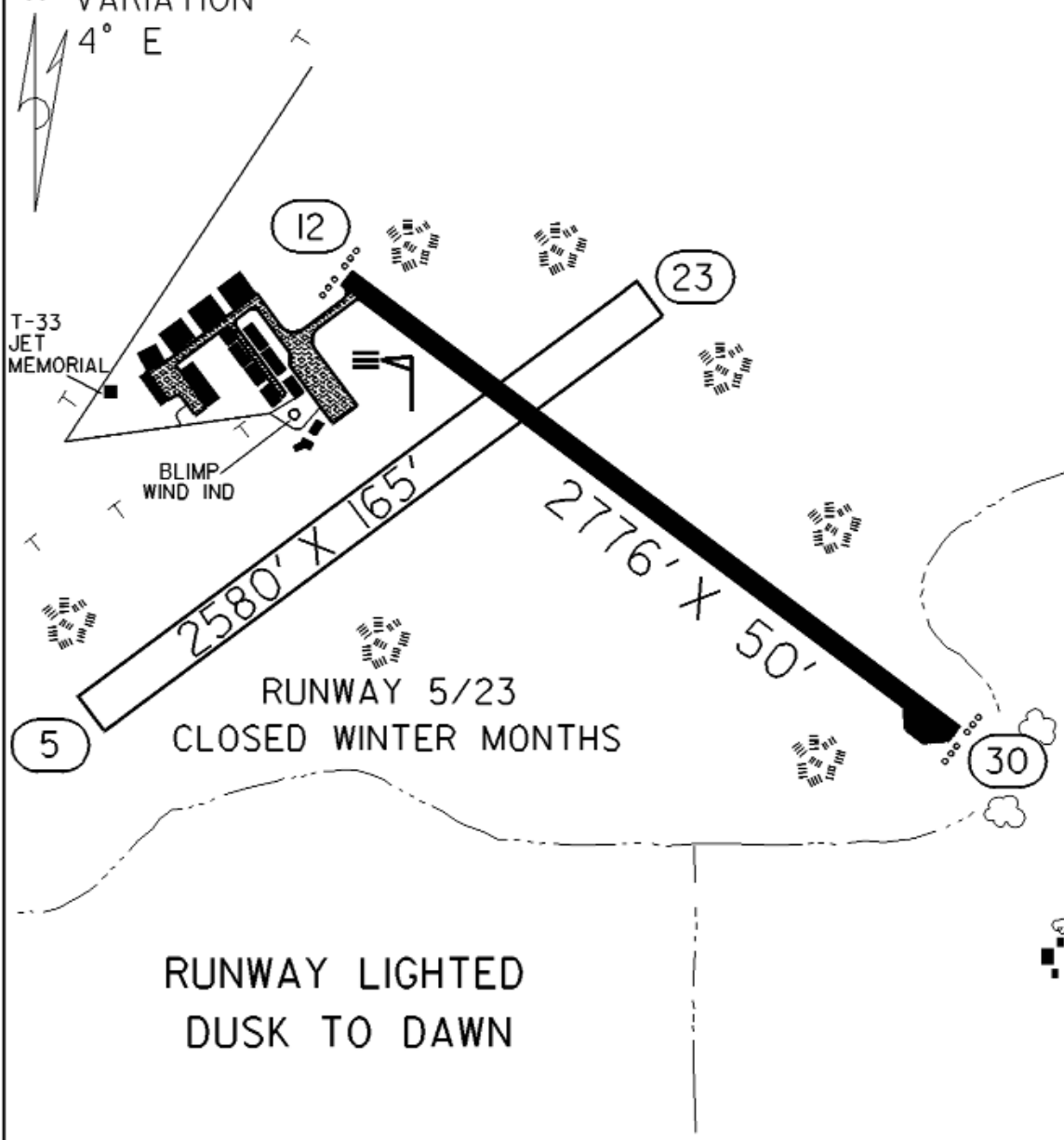

HECTOR MUNICIPAL AIRPORT

HECTOR