

## Winsted - 1ØD

---



**Airport Manager:** Russ Paschke - 320-485-3720 - [administrator@winsted.mn.us](mailto:administrator@winsted.mn.us)

**Contact Person:** Brent Mareck - 320-485-2366 - [administrator@winsted.mn.us](mailto:administrator@winsted.mn.us)

**Chamber of Com:** 320-485-2366 - [www.winstedchamber.com](http://www.winstedchamber.com)

**Aero Cht Coord:** 11-G

**AWOS/ASOS:** No

**MnWAS Loc/Hrs:** Arrival/Departure Building - 24 hours

**Attended:** All/All/0800-1800

**Fuel:** 100LL

**Self Service Fuel:** Major credit cards

**After Hrs Service:** 320-485-3720

**FBO(s):** None

**Ground Transport:** Contact - 320-485-3891

**Food Service:** Convenience Stores - 1 mile

**Dining:** The Pantry - 320-485-9172 - 1 mile  
Blue Note Bar & Ballroom - 320-485-9698 - 1 mile  
Ernie's Bar & Grill - 320-485-2888 - 1 mile  
Subway - 320-485-2000 - 1 mile  
V's Grill - 320-485-3333 - 1 mile

**Lodging:** Winsted Motel - 320-485-4441 - 1 mile

**Airport Events:** Chili Feed in January

**Underwing Camp:** Yes

**Campgrounds:** None

**Golf Courses:** Shadow Brook - 3 miles

**Local Attractions:** Winsted Lake  
7 municipal parks  
1 county park  
Luce Line Trail  
Winstock Country Music Festival - [www.winstockfestival.com](http://www.winstockfestival.com) - June - adjacent to airport

**Comments:** Additional information phone - 320-485-2366  
City web site - [www.winsted.mn.us](http://www.winsted.mn.us)

FIELD ELEV. 1030'

(IØD)

WINSTED

VICINITY MAP

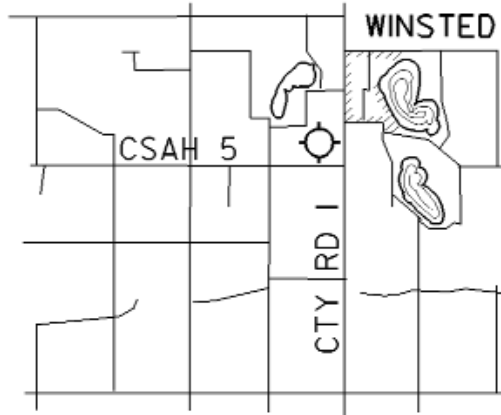

SEC. CH: TWIN CITIES (S)

LAT: 44° 57.0'

LONG: 94° 04.0'

COMM: CTAF: 122.9

MPLS CTR: 125.5

RNAV: (DWN 109.0) R109 D18.6

TPA: 1830' (800')

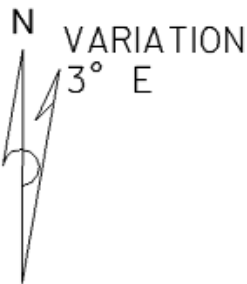

RUNWAY LIGHTED  
DUSK TO DAWN

9

27

3248' X 200'

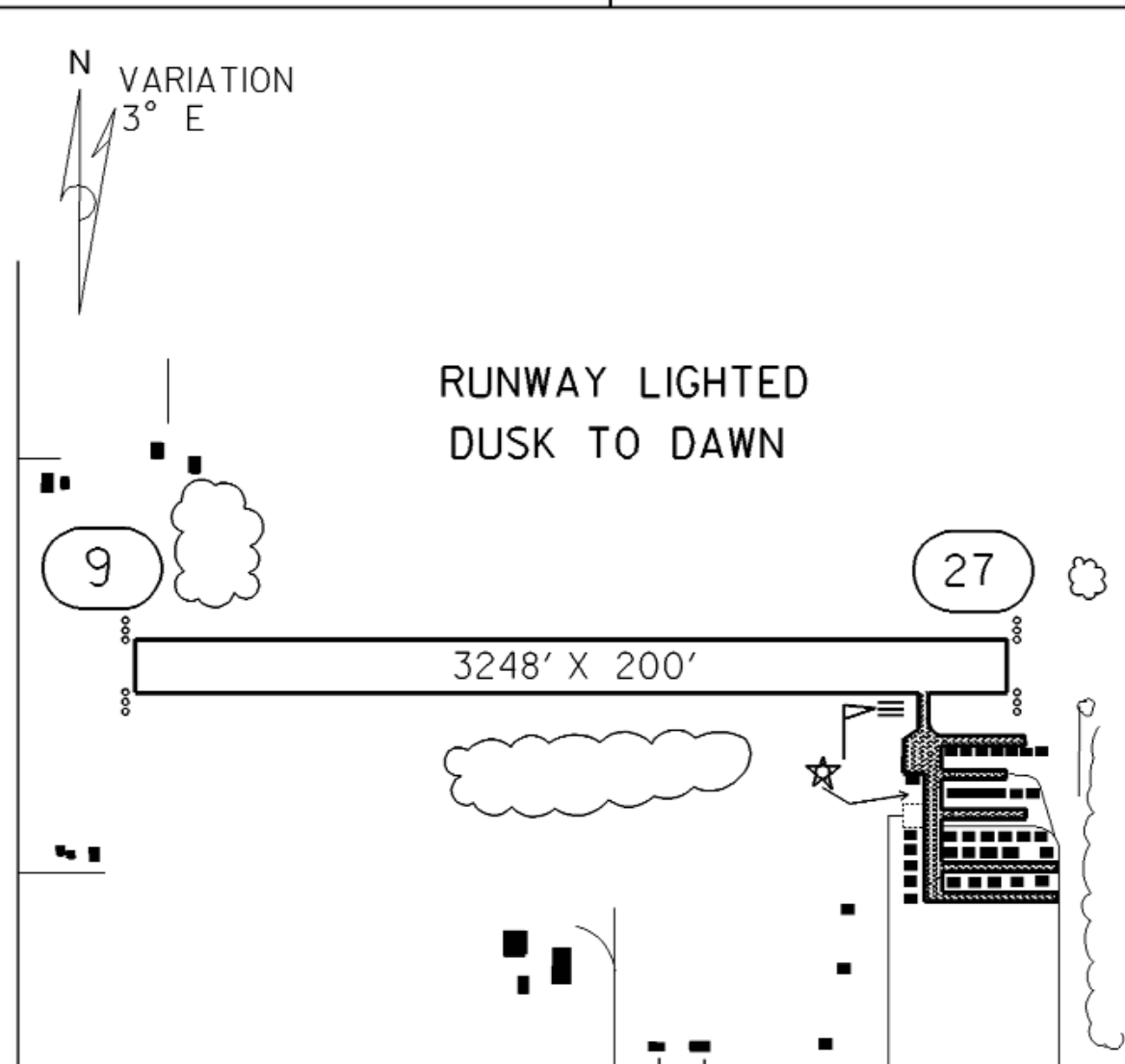

WINSTED MUNICIPAL AIRPORT

WINSTED