



www.US31E.com

(270) 766-5066 or (800) 459-3566

e-mail: us31e@us31e.com

Mr. Gary Valentine, P.E.
KY Department of Highways
District 4
634 E. Dixie
P.O. Box 309
Elizabethtown, KY 42702-0309



CITIZEN'S ADVISORY GROUP BEING FORMED

We need your help!

The Kentucky Transportation Cabinet (KYTC) is currently performing preliminary engineering and an environmental assessment on U.S. 31E from KY 332 to the Salt River Bridge. The first phase of the project is to identify and document properties eligible for the National Historic Register. All of these properties have been identified and the boundaries have been mapped. The next step is to gain approval from the Federal Highway Administration. Once that is done, engineers can begin to develop alternative alignments for the new U.S. 31E. The KYTC needs your help in this process!

A Citizen's Advisory Group(CAG) is currently being formed to work with the KYTC and the project team to review and evaluate the new alignments. It is critical that the CAG be representative of all interest groups and points of view on the project. The KYTC is seeking individuals who are interested in serving on the CAG over the next several months to assist the project team and represent the Bardstown-Nelson County community.

If you wish to be a part of this project please mail the enclosed letter to:

Mr. Gary Valentine, P.E.
Kentucky Department of Highways
Highway District 4
634 E. Dixie
P.O. Box 309
Elizabethtown, Kentucky 42702-0309
Phone 270-766-5066 ♦ FAX 270-766-5069
E-mail: gary.valentine@mail.state.ky.us

Field Identification of Eligible Properties Completed

All properties within the U.S. 31E corridor A.P.E.(Area of Potential Effect), have been field identified and reviewed for potential eligibility for the National Historic Register. A project map has been included in this newsletter that shows these properties (shaded). Due to the 14 mile length of the project, the maps are shown as segments of the project. Each property has a designation number and the name of the current property owner listed on the map. A listing of all properties, with additional information, is also in this edition of the newsletter.

Please note that determination of eligibility has not yet been approved by the Federal Highway Administration and is subject to change. Formal review will occur with the submittal of the Cultural Historic Resources Report to the Federal Highway Administration. This report is expected to be completed and submitted around the first of the year.

ELIGIBLE HISTORIC PROPERTIES (all eligible properties not shown)



Hedge Haven



Grant House



Old Star Inn



Cox's Creek Baptist Church



David Cox House



Catherine Cox House

US 31-E RECONSTRUCTION PROJECT REPORT OF FINDINGS FROM CULTURAL HISTORIC REPORT LISTED AND POTENTIALLY ELIGIBLE PROPERTIES WITHIN THE PROJECT AREA

IMPORTANT NOTE: THIS IS A DRAFT DOCUMENT AND THESE FINDINGS ARE PRELIMINARY. THIS REPORT HAS NOT BEEN REVIEWED BY THE APPROPRIATE FEDERAL AND STATE AGENCIES.

The fieldwork to document the historic properties within the project area was completed in September of 2002 and a total of 123 sites were evaluated within the Area of Potential Effect. Two sites are listed in the National Register of Historic Place, The Sisters of Charity of Nazareth, (Ne-236) in Nelson County and the Riverview Schoolhouse, (Ne-26) in Spencer County. In addition, 42 other properties appear to meet the National Register Criteria, some as individual sites, and others as part of historic districts. Please note that the two letter designation identifying the sites refer to the counties in which they are located ie: **Ne-Nelson, Sp-Spencer and Bu-Bullitt.**

SITE	HISTORIC NAME	PRESENT OWNER	LOCATION	LISTED OR ELIGIBLE
Ne-236	Sisters of Charity of Nazareth	Catholic Diocese	31-E at Rt. 332	Listed
Ne-23	Wellington Inn	Gilbert Milburn	31-E	Eligible
Ne-18	Whelan House	J.C. Lyvers	Allender Lane	Eligible
Ne-19	David & Elizabeth Cox House	Leonard Mudd	31-E	Eligible
Ne-20	Catherine Cox House	Bobby Stumph	31-E	Eligible
Ne-21	Knapper House	Richard Wheeler	Wright-Wheeler Lane	Eligible
Ne-441	Windy Hill Farm	Kevin Honaker	West of 31-E	Eligible
Ne-427	Bean House	Jeff Davidson	East of 31-E	Eligible
Ne-433	McGee Farm	Russman	Sullivan Lane	Eligible
Ne-437	Walker Farm	E. Abel/H. Hart	East of 31-E	Eligible
Ne-10	Cox's Crk Baptist Church & Cemetery	Cox's Crk Baptist Church	Fairview Rd at Hobbs Lane	Eligible
Ne-11	Cartmell House/Farm	Jack Foster	South of Fairview Rd	Eligible
Ne-12	Bealmer House/Farm	Oliver Rogers	North of Fairview Rd	Eligible
Ne-440	Wright House	Edgar Abel	Wright-Wheeler Lane	Eligible
Ne-449	House	Oliver Rogers	Fairview Road	Eligible
Ne-450	House	Oliver Rogers	Fairview Road	Eligible
Ne-456	Hobbs Farm	Jim Vogt	South of Hobbs Lane	Eligible
Ne-460	Wolf House	Jim Brooks	31-E	Eligible
Ne-461	Manakee Farm	Robert Browning	31-E	Eligible
Ne-462	Stumph Farm	Mac Holt	31-E	Eligible
Ne-6	Higdon Farm	Franklin Wright	Hibbs Lane	Eligible
Ne-469	Briggs Farm	Robert Briggs	31-E at Hibbs Lane	Eligible
Ne-8	Old Star Inn	Ben Hayden	31-E	Eligible
Ne-471	Foreman Cemetery	Harry Hurst	East of 31-E	Eligible
Ne-470	Dr. Foreman House	John Trager	31-E	Eligible
Ne-7	Hedge Haven	Betty Calvert	31-E	Eligible
Ne-473	Montgomery Cemetery	Warren Cheek	East of 31-E	Eligible
Ne-475	JosephForeman House/ Farm	Warren Cheek	West of 31-E	Eligible
Ne-478	Crume FarmShipman Stables	Bill Knight	31-E	Eligible
Ne-5	Grant House	Warren Clay Hibbs	31-E at Rt. 480	Eligible
Ne-493	Hardman House	Stephen Harris	East of 31-E	Eligible
Ne-494	Cassell House	Betty Ashbaugh	High Grove Lane	Eligible
Ne-496	Cassell Cemetery	Johnny Murray	High Grove Lane	Eligible
Ne-4	Ms. M. Cassell House	Terry Curtsinger	31-E in High Grove	Eligible
Ne-2	McCrocklin House	Wilbur Bowman	31-E in High Grove	Eligible
Ne-500	31-E Turnpike Marker	State of Kentucky	East Side of 31-E	Eligible
Ne-501	31-E Turnpike Marker	State of Kentucky	East Side of 31-E	Eligible
Ne-502	31-E Turnpike Marker	State of Kentucky	East Side of 31-E	Eligible
Sp-372	Salt River Overlook	State of Kentucky	East side of 31-E	Eligible
Sp-26	Riverview School	Betty Calvert	31-E next to overlook	Listed
Sp-27	Lloyd House	George W. Jones	31-E	Eligible
Sp-28	Clark House	Monica Clark	31-E	Eligible
Sp-374	Crist House	Ray Justice	31-E	Eligible
Bu-181	House	Jimmy Hammond	31-E at Smithville	Eligible

Section 1

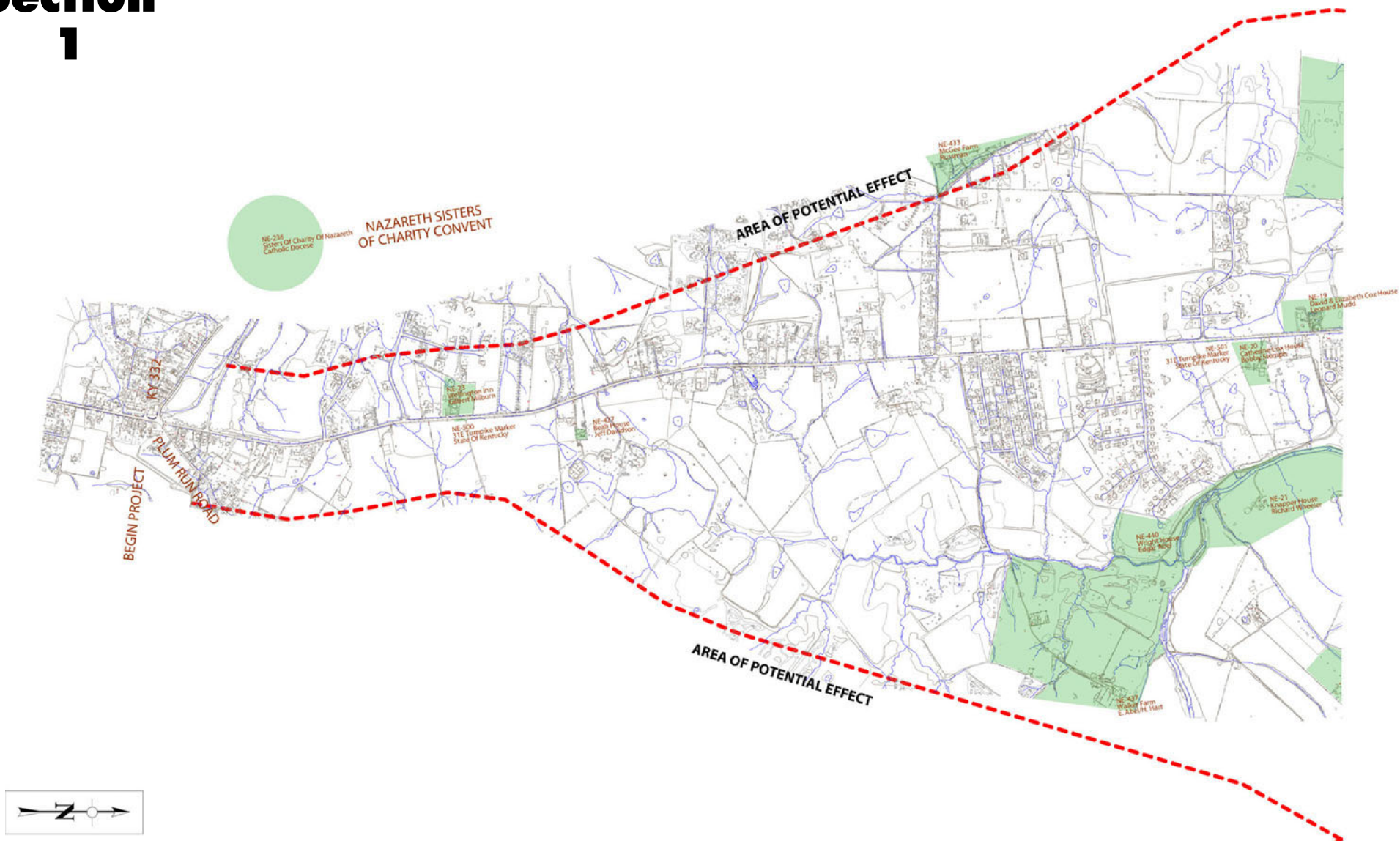

Section 2

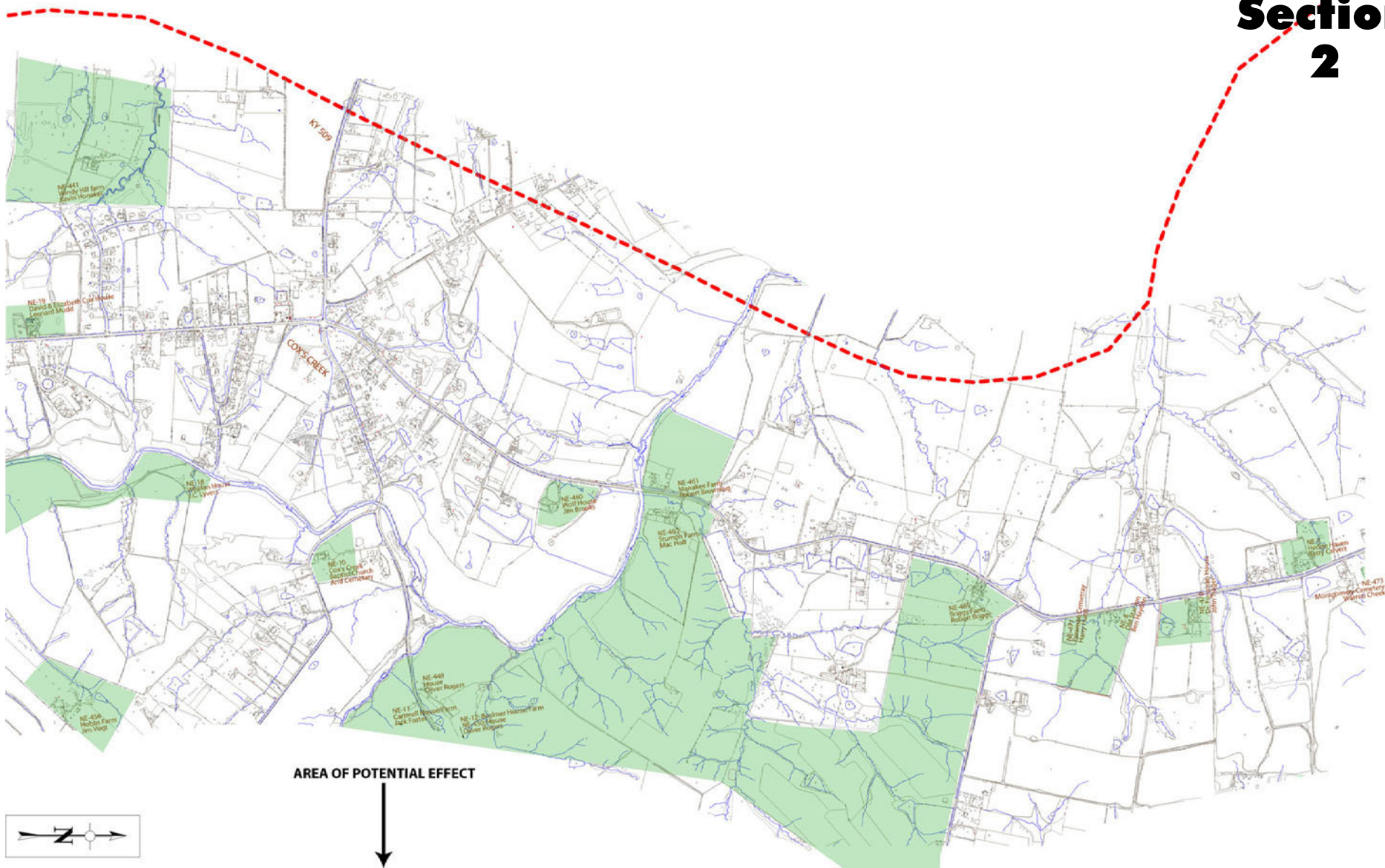

Section 3

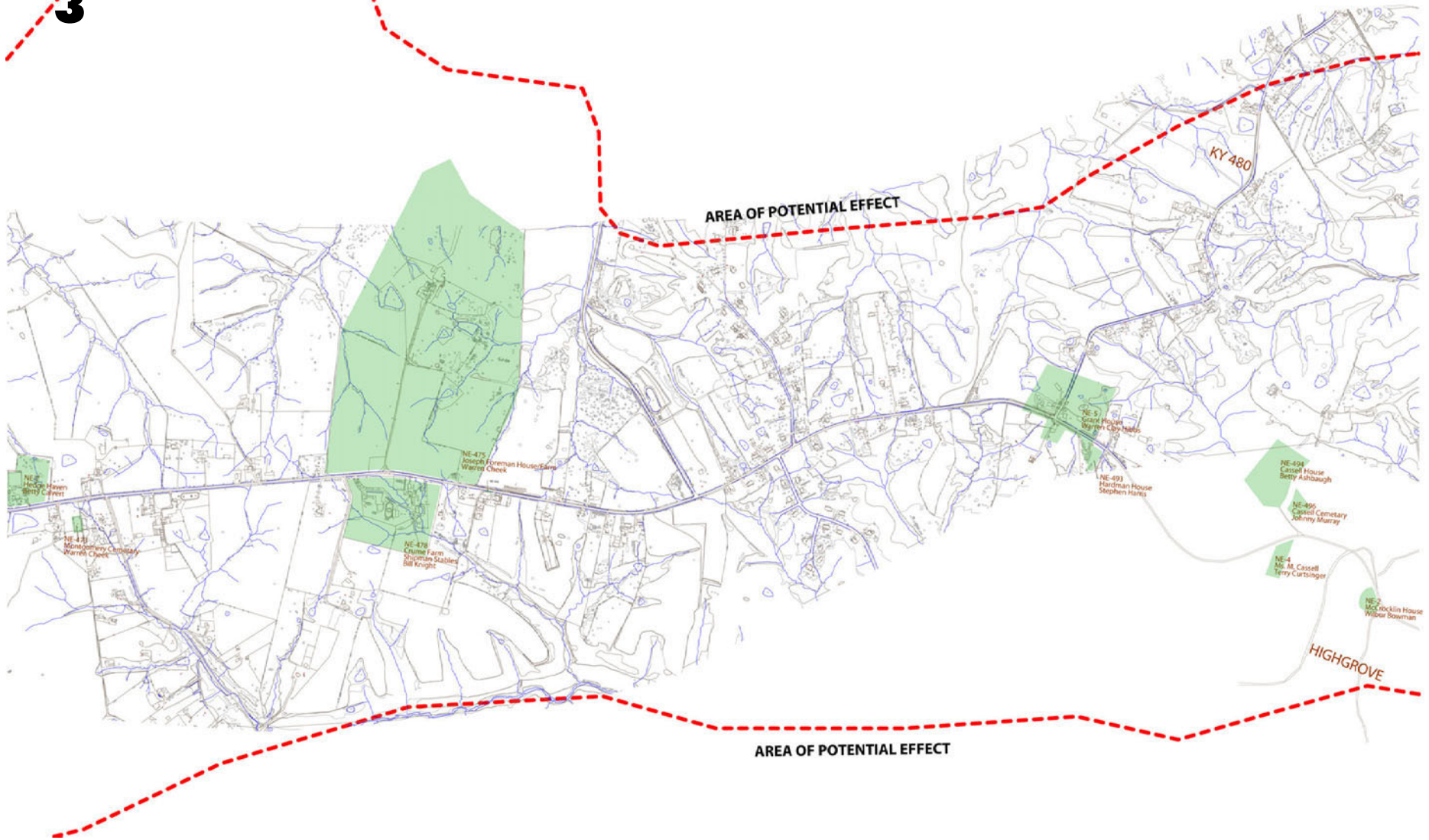

Section 4

