

AIP SUPPLEMENT

TEL: 91-11-24632950 Extn: 2219/2233 AFS: VIDDYXAX FAX: 91-11-24615508 E_mail:- gmais@aai.aero	AERONAUTICAL INFORMATION SERVICES AIRPORTS AUTHORITY OF INDIA RAJIV GANDHI BHAVAN SAFDARJUNG AIRPORT NEW DELHI - 110003	31/2008
		15 MA / 2008

File No. AAI/NAD/09-09/I 3/AIP-SUPP (Part-AIS)

Following supplement is issued for information, guidance and necessary action.



H.S. BAINS

Acting CHAIRMAN
AIRPORTS AUTHORITY OF INDIA

[W.E.F 0805221831UTC]

SUB:- CHARTS – BANGALORE INTERNATIONAL AIRPORT , DEVANAHALLI ,BANGALORE

Following charts are enclosed for information :

1. AERODROME CHART
2. AIRCRAFT PARKING/DOCKING CHART-ICAO
3. AERODROME OBSTACLE CHART-TYPE A , RWY 09/27
4. PRECISION APPROACH TERRAIN CHART- RWY 27
5. PRECISION APPROACH TERRAIN CHART – RWY 09

AERODROME CHART

INDIA/BANGALORE (Devanhalli)

13°11'55.92"N
077°42'19.70"E

ELEV. 915 TWR 124.350

BANGALORE INTERNATIONAL AIRPORT

RWY	DIRECTION	THR CO-ORDINATES	THR ELEV.	BEARING STRENGTH
09	092°	13°12'25.78"N 077°41'09.84"E	914.5M	80/F/B/W/T ASPHALT
27	272°	13°12'24.63"N 077°43'22.67"E	889M	

- * DATUM : WGS-84
- * ELEVATIONS AND DIMENSIONS IN METRES
- * BEARINGS ARE MAGNETIC



TAXWAY WIDTH 25M

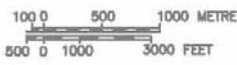
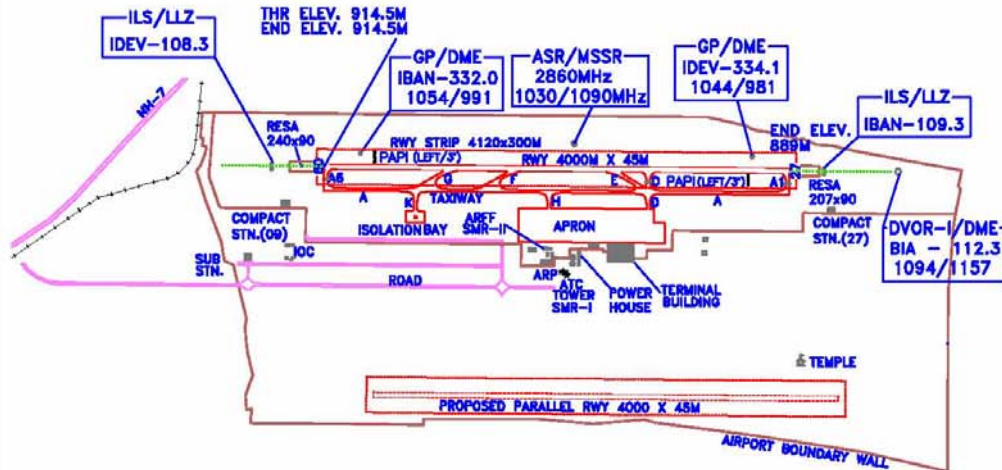

ELEV. OF RWY HOLDING POSITIONS (Nearest Half Metre)	
AT TWY A1	888.5
AT TWY D	896.0
AT TWY AG	914.5

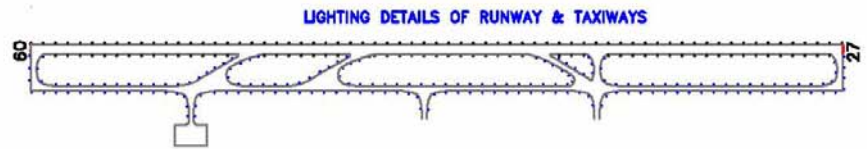

Date of Aeronautical Information - April 2008

Consultant: Cartography unit, Airports Authority of India
Client : Bangalore International Airport Ltd.

Based on AAI Survey Jan.-Feb 07 and BIAL data upto April 2008

AIRCRAFT PARKING/
DOCKING CHART-ICAO

APRON ELEV.
898 TO 903m

TWR 124.350

INDIA/BANGALORE (Devanahalli)

BANGALORE INTERNATIONAL AIRPORT

- DATUM : WGS-84
- ELEVATIONS IN METRES
- ALL TAXWAYS WIDTH 25m

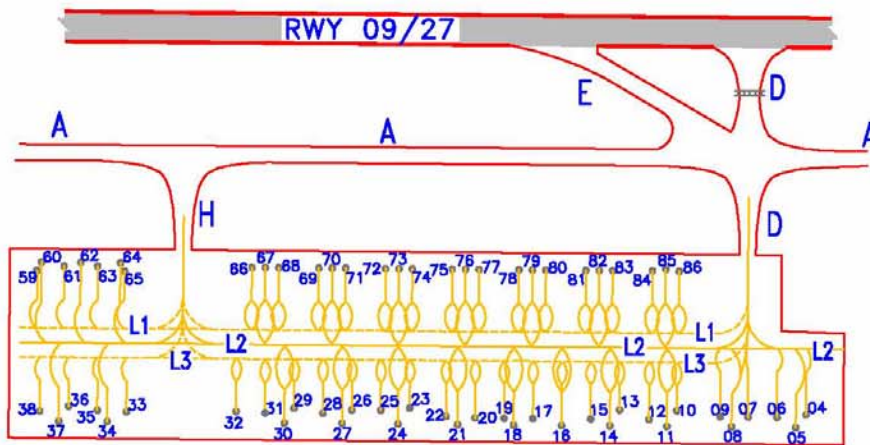

LEGEND	
AIRCRAFT STAND	04
RWY HOLDING POSITION	xxxx

APRON PCN 80/R/B/W/T
TAXWAYS PCN 80/F/B/W/T

NOTE: FOR PARKING BAY CO-ORDINATES, ELEVATIONS AND SUITABILITY OF AIRCRAFT TYPE DETAILS REFER ATTACHMENT 'A' (SPAGES)

Date of Aeronautical Information-April 2008

Consultant: Cartography unit, Airports Authority of India
Client : Bangalore International Airport Ltd.

Based on AAI Survey Jan.-Feb 07
and BIAL data upto April 2008

ATTACHMENT-A

Stand No.	Coordinate Details		Aircraft Fleet Suitable	Elevation in nearest Half Metre
	Latitude	Longitude		
4	13° 12' 05.78" N	77° 42' 45.25" E	ATR42, 72, A318, A319, A320, A321, B717, B737all series, CRJ200, ERJ170, 190	898
5	13° 12' 05.46" N	77° 42' 44.74" E	A300, A330-200/300, A340-200 to 600, AN-12, B747-200 to 400, B757-200/300, B767-200 to 400, B777 200/300, B787, MD11	898.5
6	13° 12' 05.79" N	77° 42' 43.80" E	ATR42, 72, A318, A319, A320, A321, B717, B737all series, CRJ200, ERJ170, 190	898.5
7	13° 12' 05.80" N	77° 42' 42.36" E	ATR42, 72, A318, A319, A320, A321, B717, B737all series, CRJ200, ERJ170, 190	898.5
8	13° 12' 05.49" N	77° 42' 41.54" E	A300, A330-200/300, A340-200 to 600, AN-12, B747-200 to 400, B757-200/300, B767-200 to 400, B777- 200/300, B787, MD11	898.5
9	13° 12' 05.81" N	77° 42' 40.96" E	ATR42, 72, A318, A319, A320, A321, B717, B737all series, CRJ200, ERJ170, 190	898.5
10	13° 12' 06.11" N	77° 42' 38.79" E	A318, A319, A320, A321, B717, B737all series	898.5
11	13° 12' 05.51" N	77° 42' 38.30" E	A300, A330-200/300, A340-200 to 600, A380, B747-200 to 400, B757-200/300, B767-200 to 400, B777- 200/300, B787	898.5
12	13° 12' 05.68" N	77° 42' 37.40" E	A318, A319, A320, A321, B717, B737all series	898.5
13	13° 12' 06.16" N	77° 42' 35.93" E	A318, A319, A320, A321, B717, B737all series	898.5
14	13° 12' 05.54" N	77° 42' 35.44" E	A300, A330-200/300, A340-200 to 600, B747-200 to 400, B757-200/300, B767-200 to 400, B777 -200/300, B787	898.5
15	13° 12' 05.70" N	77° 42' 34.49" E	A318, A319, A320, A321, B717, B737all series	898.5
16	13° 12' 05.56" N	77° 42' 33.04" E	A300, A330-200/300, A340-200 to 600, B747-200 to 400, B757-200/300, B767-200 to 400, B777 -200/300, B787, A318, A319, A320, A321, B717, B737all series	898.5
17	13° 12' 05.73" N	77° 42' 31.59" E	A318, A319, A320, A321, B717, B737all series	898.5
18	13° 12' 05.58" N	77° 42' 30.63" E	A330-200/300, A340-200 to 600, B747-200 to 400, B757-200/300, B767-300/ 400, B777 -200/300, B787	898.5
19	13° 12' 05.74" N	77° 42' 30.15" E	A318, A319, A320, A321, B717, B737all series	898.5
20	13° 12' 05.75" N	77° 42' 28.71" E	A318, A319, A320, A321, B717, B737all series	898.5
21	13° 12' 05.60" N	77° 42' 27.83" E	A300, A330-200/300, A340-200 to 600, AN12, MD11, B747-200 to 400, B757-200/300, B767-200 to 400, B777 -200/300, B787	898.5
22	13° 12' 05.77" N	77° 42' 27.24" E	ATR42, 72, A318, A319, A320, A321, B717, B737all series, CRJ200, ERJ170, 190	898.5

23	13° 12' 06.25" N	77° 42' 25.42" E	ATR42, 72, A318, A319, A320, A321, B717, B737all series, CRJ200, ERJ170, 190	898.5
24	13° 12' 05.63" N	77° 42' 24.85" E	A300, A330-200/300, A340-200 to 600, AN12, MD11, B747-200 to 400, B757-200/300, B767-200 to 400, B777 - 200/300, B787	899
25	13° 12' 06.14" N	77° 42' 23.99" E	ATR42, 72, A318, A319, A320, A321, B717, B737all series, CRJ200, ERJ170, 190	899
26	13° 12' 06.16" N	77° 42' 22.54" E	ATR42, 72, A318, A319, A320, A321, B717, B737all series, CRJ200, ERJ170, 190	899
27	13° 12' 05.65" N	77° 42' 22.06" E	A300, A330-200/300, A340-200 to 600, AN12, MD11, B747-200 to 400, B757-200/300, B767-200 to 400, B777 - 200/300, B787	899
28	13° 12' 05.98" N	77° 42' 21.10" E	ATR42, 72, A318, A319, A320, A321, B717, B737all series, CRJ200, ERJ170, 190	899
29	13° 12' 06.18" N	77° 42' 19.65" E	ATR42, 72, A318, A319, A320, A321, B717, B737all series, CRJ200, ERJ170, 190	899.5
30	13° 12' 05.68" N	77° 42' 19.17" E	A300, A330-200/300, A340-200 to 600, AN12, MD11, B747-200 to 400, B757-200/300, B767-200 to 400, B777 - 200/300, B787	899.5
31	13° 12' 06.01" N	77° 42' 18.21" E	ATR42, 72, A318, A319, A320, A321, B717, B737all series, CRJ200, ERJ170, 190	899.5
32	13° 12' 06.02" N	77° 42' 16.76" E	ATR42, 72, A318, A319, A320, A321, B717, B737all series, CRJ200, ERJ170, 190	899.5
33	13° 12' 06.07" N	77° 42' 11.27" E	ATR42, 72, A318, A319, A320, A321, B717, B737all series, CRJ200, ERJ170, 190	901.5
34	13° 12' 05.75" N	77° 42' 10.30" E	A300, A330-200/300, A340-200 to 600, MD11, B747-200 to 400, B757-200/300, B767-200 to 400, B777 - 200/300, B787	901.5
35	13° 12' 06.08" N	77° 42' 09.82" E	ATR42, 72, A318, A319, A320, A321, B717, B737all series, CRJ200, ERJ170, 190	901.5
36	13° 12' 06.28" N	77° 42' 08.38" E	ATR42, 72, A318, A319, A320, A321, B717, B737all series, CRJ200, ERJ170, 190	901.5
37	13° 12' 05.78" N	77° 42' 07.89" E	A300, A330-200/300, A340-200 to 600, AN12, MD11, B747-200 to 400, B757-200/300, B767-200 to 400, B777 - 200/300, B787	902
38	13° 12' 06.11" N	77° 42' 06.93" E	ATR42, 72, A318, A319, A320, A321, B717, B737all series, CRJ200, ERJ170, 190	902
59	13° 12' 13.22" N	77° 42' 06.81" E	ATR42, 72, A318, A319, A320, A321, B717, B737all series, CRJ200, ERJ170, 190	903
60	13° 12' 13.22" N	77° 42' 07.03" E	ATR42, 72, A318, A319, A320, A321, A300, AN12, B717, B737all series, B747-400, B757-200/300, B767-200/300, CRJ200, ERJ170, 190, MD11.	903
61	13° 12' 13.21" N	77° 42' 08.16" E	ATR42, 72, A318, A319, A320, A321, B717, B737all series, CRJ200, ERJ170, 190	903
62	13° 12' 13.21" N	77° 42' 09.00" E	A300, AN12, B757-200/300, B767-200to 400, MD11	902.5
63	13° 12' 13.20" N	77° 42' 09.84" E	ATR42, 72, A318, A319, A320, A321, B717, B737all series, CRJ200, ERJ170, 190	902.5

64	13° 12' 13.19" N	77° 42' 10.98" E	A300,AN12,B757-200/300,B767-200 to400,MD11	902.5
65	13° 12' 13.19" N	77° 42' 11.18" E	ATR42,72,A318,A319,A320,A321, B737all series except 900 Winglet ,CRJ200,ERJ170,190	902.5
66	13° 12' 12.90" N	77° 42' 17.56" E	ATR42,72,A318,A319,A320,A321,B717, B737all series,CRJ200,ERJ170,190	900.5
67	13° 12' 13.13" N	77° 42' 18.23" E	A300,A330-200/300,A340-200/300,AN12,B757-200/300,B767-200 to400,MD11	900.5
68	13° 12' 12.89" N	77° 42' 18.90" E	ATR42,72,A318,A319,A320,A321,B717, B737all series,CRJ200,ERJ170,190	900.5
69	13° 12' 12.88" N	77° 42' 20.89" E	ATR42,72,A318,A319,A320,A321,B717, B737all series,CRJ200,ERJ170,190	900
70	13° 12' 13.20" N	77° 42' 21.57" E	A300,A330-200/300,A340-200/300,AN12,B757-200/300,B767-200 to400,MD11	900
71	13° 12' 12.86" N	77° 42' 22.24" E	ATR42,72,A318,A319,A320,A321,B717, B737all series,CRJ200,ERJ170,190	900
72	13° 12' 12.85" N	77° 42' 24.23" E	ATR42,72,A318,A319,A320,A321,B717, B737all series,CRJ200,ERJ170,190	900
73	13° 12' 13.17" N	77° 42' 24.90" E	A300,A330-200/300,A340-200/300,AN12,B757-200/300,B767-200 to400,MD11	900
74	13° 12' 12.84" N	77° 42' 25.57" E	ATR42,72,A318,A319,A320,A321,B717, B737all series,CRJ200,ERJ170,190	899.5
75	13° 12' 12.82" N	77° 42' 27.57" E	ATR42,72,A318,A319,A320,A321,B717, B737all series,CRJ200,ERJ170,190	899.5
76	13° 12' 13.14" N	77° 42' 28.24" E	A300,A330-200/300,A340-200/300,AN12,B757-200/300,B767-200 to400,MD11	899.5
77	13° 12' 12.81" N	77° 42' 28.91" E	ATR42,72,A318,A319,A320,A321,B717, B737all series,CRJ200,ERJ170,190	899
78	13° 12' 12.91" N	77° 42' 30.90" E	ATR42,72,A318,A319,A320,A321,B717, B737all series,CRJ200,ERJ170,190	899
79	13° 12' 13.11" N	77° 42' 31.58" E	A300,A330-200/300,A340-200/300,AN12,B757-200/300,B767-200 to400,MD11	899
80	13° 12' 12.78" N	77° 42' 32.25" E	ATR42,72,A318,A319,A320,A321,B717, B737all series,CRJ200,ERJ170,190	899
81	13° 12' 12.88" N	77° 42' 34.24" E	ATR42,72,A318,A319,A320,A321,B717, B737all series,CRJ200,ERJ170,190	898.5
82	13° 12' 13.08" N	77° 42' 34.92" E	A300,A330-200/300,A340-200/300,AN12,B757-200/300,B767-200 to400,MD11	898.5
83	13° 12' 12.75" N	77° 42' 35.59" E	ATR42,72,A318,A319,A320,A321,B717, B737all series,CRJ200,ERJ170,190	898.5
84	13° 12' 12.73" N	77° 42' 37.58" E	ATR42,72,A318,A319,A320,A321,B717, B737all series,CRJ200,ERJ170,190	898
85	13° 12' 13.05" N	77° 42' 38.25" E	A300,A330-200/300,A340-200/300,AN12,B757-200/300,B767-200 to400,MD11	898
86	13° 12' 12.72" N	77° 42' 38.92" E	ATR42,72,A318,A319,A320,A321,B717, B737all series,CRJ200,ERJ170,190	898

DIMENSIONS AND ELEVATIONS IN METRES

AERODROME OBSTACLE CHART
TYPE-A(OPERATING LIMITATIONS)

CONSULT NOTAM FOR LATEST INFORMATION

INDIA/BANGALORE (Devanahalli)
BANGALORE INT'L AIRPORT
RWY 09/27

MAGNETIC VARIATION 2°W 1995

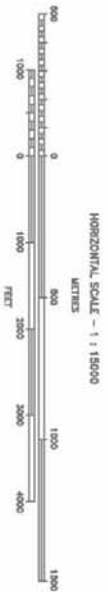
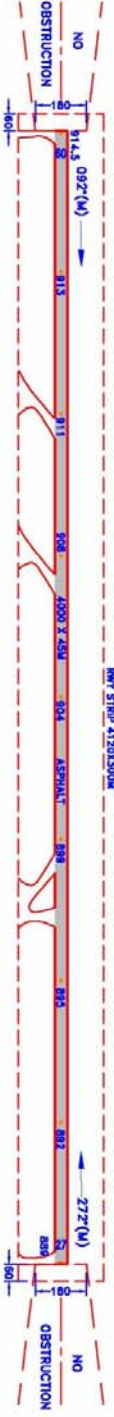
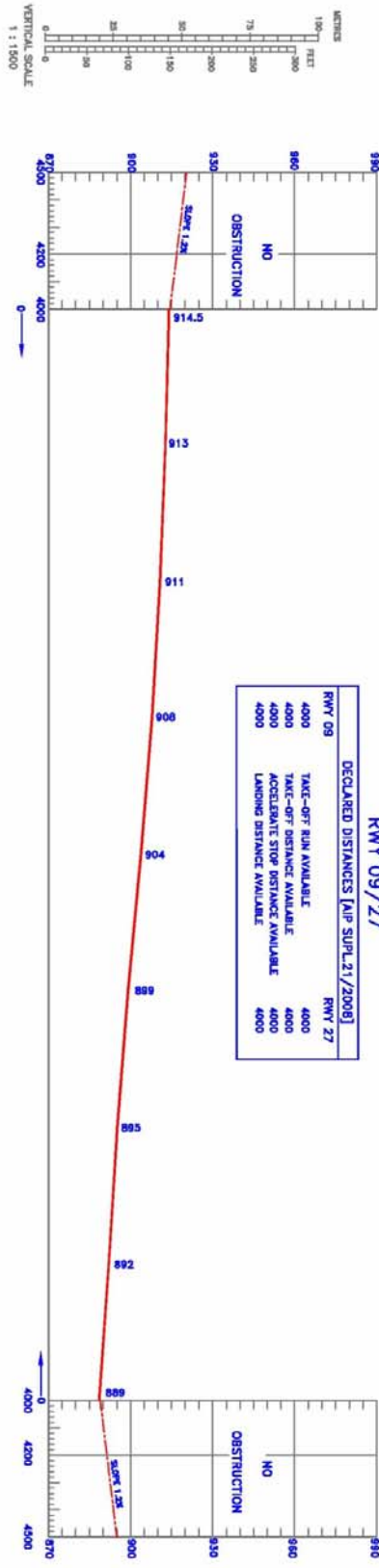

LEGSID	
RUNWAY SHOT ELEVATION	-915

GRADE OF ACCURACY	
HORIZONTAL	1.0m
VERTICAL	0.5m

NOTES:
1. Datum - All Elevations are AMSL.
2. Obstacles are based on aeronautical charters Survey FEB.2007.

NO.	DATE	EXTENDED BY

Date of Aeronautical Information - April 2008

Consultant: Cartography unit, Airports Authority of India
Client : Bangalore International Airport Ltd.

Based on AAI Survey Jan.-Feb 07
and BIAL data upto April 2008

PRECISION APPROACH TERRAIN CHART

CONSULT NOTAM FOR LATEST INFORMATION

INDIA/BANGALORE
BANGALORE INTL. AIRPORT
RWY 27

DISTANCES AND ELEVATIONS IN METRES

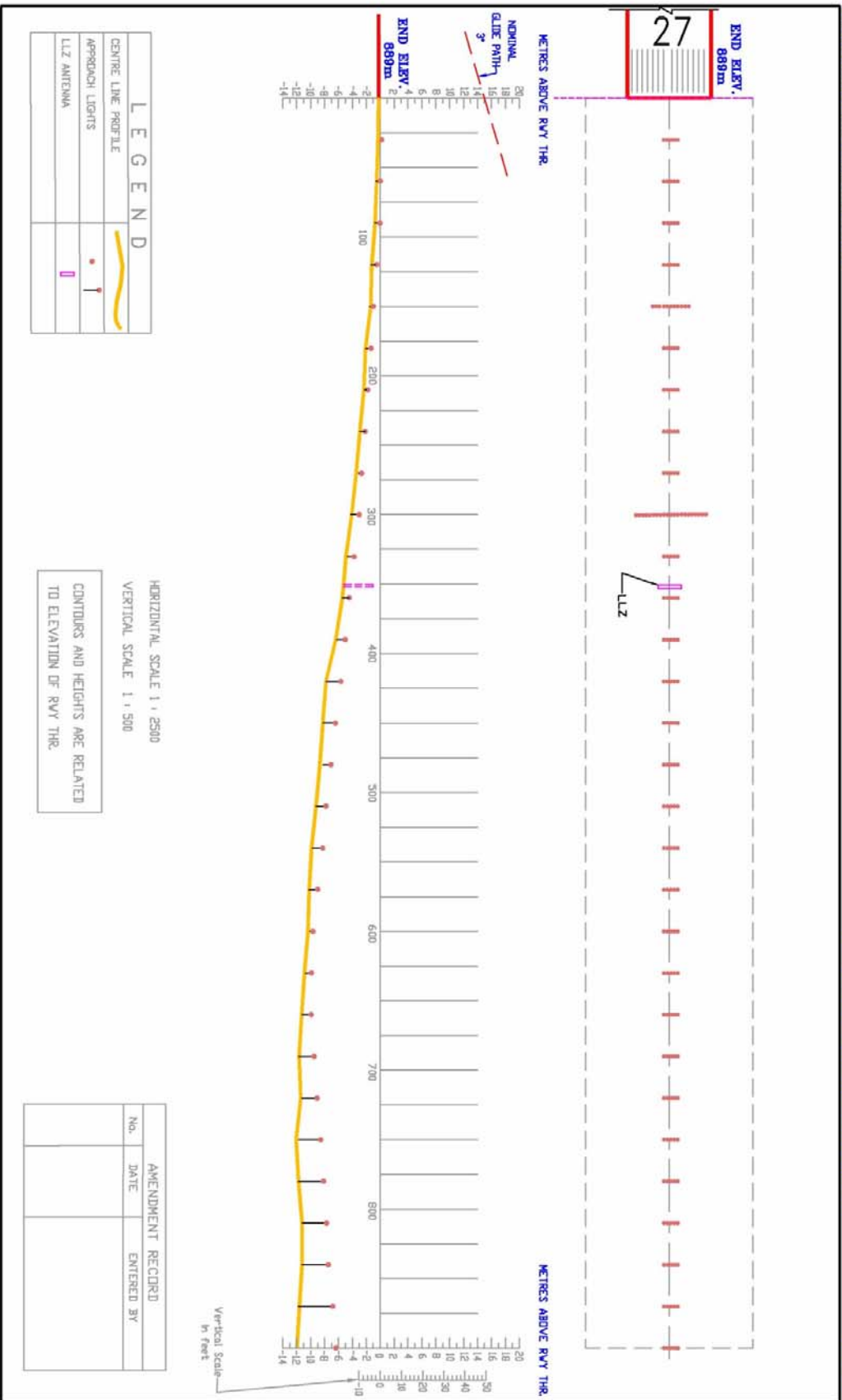

Date of Aeronautical Information-April 2008

Consultant: Cartography unit, Airports Authority of India
Client : Bangalore International Airport Ltd.

Based on AAI Survey Jan.-Feb 07
and BIAL data upto April 2008

