

National Register of Historic Places Registration Form

This form is for use in nominating or requesting determinations of eligibility for individual properties or districts. See instructions in *Guidelines for Completing National Register Forms* (National Register Bulletin 18). Complete each item by marking "x" in the appropriate box or by entering requested information. If an item does not apply to the property being documented, enter "N/A" for "not applicable." For functions, styles, materials, and areas of significance, enter only the categories and subcategories listed in the instructions. For additional space use continuation sheets (Form 10-900a). Type all entries.

Name of Property

Historic name Warrick, John Wesley and Grace Shafer, House
Other names/site number NEHBS # MD04-001

Location

Set & number RR 2, Box 11 n/a not for publication
Town Meadow Grove n/a vicinity
State Nebraska code NE county Madison code 119 zip code 68752

Classification

Ownership of Property	Category of Property	Number of Resources within Property	
private	<input checked="" type="checkbox"/> building(s)	Contributing	Noncontributing
public-local	<input type="checkbox"/> district	<u>2</u>	<u> </u> buildings
public-State	<input type="checkbox"/> site	<u> </u>	<u> </u> sites
public-Federal	<input type="checkbox"/> structure	<u>1</u>	<u> </u> structures
	<input type="checkbox"/> object	<u> </u>	<u> </u> objects
		<u>3</u>	<u> </u> Total

Number of related multiple property listing: na
Number of contributing resources previously listed in the National Register 0

State/Federal Agency Certification

I, the designated authority under the National Historic Preservation Act of 1966, as amended, I hereby certify that this ☒ nomination ☐ request for determination of eligibility meets the documentation standards for registering properties in the National Register of Historic Places and meets the procedural and professional requirements set forth in 36 CFR Part 60. In my opinion, the property ☒ meets ☐ does not meet the National Register criteria. ☐ See continuation sheet.

James A. Hanson
Signature of certifying official

October 14, 1990
Date

State or Federal agency and bureau

In my opinion, the property ☐ meets ☐ does not meet the National Register criteria. ☐ See continuation sheet.

Signature of commenting or other official

Date

State or Federal agency and bureau

National Park Service Certification

I hereby certify that this property is:

Entered in the National Register;

☐ See continuation sheet,

Determined eligible for the National

Register. ☐ See continuation sheet.

Determined not eligible for the

National Register.

Removed from the National Register.

Other, (explain):

Signature of the Keeper

Date of Action

DOMESTIC/secondary structure

Domestic/secondary structure

7. Description

Architectural Classification
(enter categories from instructions)

Materials (enter categories from instructions)

Queen Anne

foundation brick
walls wood
roof wood
other

Describe present and historic physical appearance.

The John Wesley and Grace Shafer Warrick House, located in the south part of Meadow Grove in Madison County, Nebraska, is a large two-and-one-half story nineteen room frame house built in 1903. The Warrick House is an excellent and well-preserved example of the Free Classic Queen Anne style, and is a landmark structure in the Meadow Grove community. In the early 1920s a basement and large frontal porch was added. The interior retains original features such as decorative woodwork, glazed tile fireplaces, sliding doors and a large hallway and staircase. The nomination includes two (2) contributing buildings: the house and carriage barn, and one (1) contributing structure: a row of 4 brick piers. The interior and the exterior of the house and carriage barn retain the features that distinguish them as turn-of-the-century buildings. The property is in excellent repair and displays good architectural integrity.

The Warrick House is located in the south part of Meadow Grove, Nebraska (1980 population: 400) in Madison County, a northeast Nebraska county that is bisected west to east by the Elkhorn River. When the house was built, it reflected the financial success that Mr. Warrick had achieved as a dealer in lumber, grain, and livestock.

The large two-and-one-half story frame house sits in a large well landscaped acreage that is framed by four brick piers, (1922) formerly joined by hedge rows, that provide a formal approach to the property. The house sits on a red brick foundation that was added on as a full finished basement in 1922. Also added at that time was the distinctive front porch that fully enclosed the front first floor of the house. Classical columns on brick pedestals are on all four corners of the front porch, which is also fully enclosed and finished. The balcony is enclosed by a railing of

United States Department of the Interior
National Park ServiceNational Register of Historic Places
Continuation SheetSection number 7 Page 2

spindlework supports. The roof is steeply pitched front to back with two cross gables. A small flat deck crowns the hip. The two cross gables and front gable are noteworthy for their decorative half-timbering and palladian windows. Modillions can also be seen as support arches over a second floor screened-in porch. A second enclosed porch displays wall covering of wood shingles overlay. This porch is used for a summer sleeping porch.

The back entrance has been altered by the addition of a greenhouse in 1988. Before the addition an enclosed porch was in that area. Large two-story bay windows dominate the south and north facades. A second-story bay window is also found on the east facade. Before the addition of the enclosed front porch in 1922, the main facade of the house was dominated by a porch that followed the curvature of the house with support of classical columns both on the first floor and on the second (see photo #3). The second floor columns support the front gable and the side gable. The front was also dominated by a large bay window, with leaded glass windows on each side of the main front door. Sometime after the 1922 remodeling the front porch was enclosed.

The Queen Anne style is distinguished by asymmetry, variety in roof shapes, patterned shingles, decorative woodwork, and large bay windows. The Warrick House illustrates Queen Anne variety of textures and materials and Free Classic detailing in its use of classical columns and Palladian windows. Its use of wood shingling and decorative half-timbering is also representative of the style.

The interior of the Warrick House retains many of its original features including a variety of woods used in doors, moldings and floors. The maple molding and staircase in the front hall embellish the solid oak flooring that covers all of the first and second floors. The fireplace in the main living room is white tile surrounded by maple molding. The first floor is also dominated by solid walnut bookshelves, a dining room trestle table and writing desk, made from walnut trees planted in the surrounding yard. All bedrooms have dressing rooms with large walk-in closets.

United States Department of the Interior
National Park Service

**National Register of Historic Places
Continuation Sheet**

Section number 7 Page 3

The carriage barn (built c. 1903) is very complimentary to the house, both in terms of its styling and setting. Its steeply pitched hip roof is set off by two lower cross gables, and is dominated by a square cupola. Each cross gable has a large window in the middle. The carriage barn has been converted into a garage, however most of the building retains its original appearance when it was used to house horses for carriages.

The property has a concrete curbed driveway on the south that leads up to the carriage barn. The house is dominated by a large cottonwood and maple tree in front that were planted at the time the house was built in 1903. To the north are rows of ponderosa pine, and scotch pine trees. The property has many maple, oak, pine, cottonwood and fir trees. On the south side of the house (see site plan) was also a 1920s brick and wood pergola, which was covered by trumpet vines. On the north was a large goldfish pond, bordered by a rose trellis. The pergola and fish pond are no longer extant. A wash house and chicken house were also once located on the site.

The John Wesley Warrick House has been continuously owned and lived in by the Warrick family since it was built. John Wesley Warrick Jr.'s widow Ruth lives in the next house south, and John Wesley Warrick III lives next to the carriage barn. Robert H. and Gudrun C. Warrick have lived in the house since their marriage in 1963.

8. Statement of Significance

Certifying official has considered the significance of this property in relation to other properties:

☐ nationally ☐ statewide ☒ locally

Applicable National Register Criteria ☐ A ☐ B ☒ C ☐ D

Criteria Considerations (Exceptions) ☐ A ☐ B ☐ C ☐ D ☐ E ☐ F ☐ G

Areas of Significance (enter categories from instructions)

Architecture

Period of Significance

1903-22

Significant Dates

1903

1922

Cultural Affiliation

na

Significant Person

na

Architect/Builder

unknown

State significance of property, and justify criteria, criteria considerations, and areas and periods of significance noted above.

The John Wesley and Grace Shafer Warrick House is architecturally significant (Criterion C) as the most distinct and sophisticated turn-of-the-century residence in Meadow Grove. The grandiose Queen Anne dwelling is located on a large landscaped lot and stands as a landmark in town. The building of the house represented the accomplishments of a successful rural businessman who operated a lumber, grain, and livestock business. The period of significance is derived from the original construction date of the house (1903) through significant later remodelings (1922).

The Warrick House, the most architecturally distinct residential dwelling in Meadow Grove, is an excellent local example of the Free Classic Queen Anne style. The style is characterized by irregular form, steeply pitched rooflines, full frontal porches, bay windows, and use of various elements such as decorative shingles, half-timbering, classical columns, and Palladian windows (McAlester, 1984, pp. 263-264). In Nebraska, the style enjoyed widespread popularity in residential architecture during the 1880s-1900. Queen Anne stylistic features found in the Warrick House include a multi-hipped and gabled roof with wood shingles, half-timbering on the gables with Palladian windows, large bay windows on three facades and the use of classical columns on the first and second levels.

The house stands as a landmark, both visually and historically in the town. Visually the dwelling is impressive due to both its size and design. The house is located on the south edge of town on a large residential lot, and this, along with the carriage barn and surrounding landscape features, enhance its local landmark status. Historically, the house is associated with the Warricks, a locally prominent family.

☒ See continuation sheet

**United States Department of the Interior
National Park Service**

**National Register of Historic Places
Continuation Sheet**

Section number 8 Page 2

Historic residential architecture in Meadow Grove, for the most part, consists of one to one-and-one-half story modest frame dwellings of vernacular design. In the Nebraska Historic Buildings Survey of Meadow Grove, only three other houses in town (MD04-12, MD04-15, MD04-18) compare to the Warrick House in the number of stories and construction material. All three dwellings are two-and-one-half stories, frame construction, and exhibit some decorative detailing. However, none attain the high degree of styling or setting of the Warrick property. The Queen Anne styling of the house, the complimentary carriage barn, and the large landscaped lot with conifer and deciduous trees, make the Warrick property a sophisticated and distinct turn-of-the-century architectural grouping.

9. Major Bibliographical References

Gary Kuchar and Mrs. Lenora Kuchar, They Called It Meadow Grove, Volume 1, Osborne, KS: Osborn Publishing Co. Inc., 1979.

McAlester, Virginia and Lee. A Field Guide to American Houses. New York: Alfred A. Knopf, 1984.

Previous documentation on file (NPS):

- ☐ preliminary determination of individual listing (36 CFR 67) has been requested
- ☐ previously listed in the National Register
- ☐ previously determined eligible by the National Register
- ☐ designated a National Historic Landmark
- ☐ recorded by Historic American Buildings Survey # _____
- ☐ recorded by Historic American Engineering Record # _____

☐ See continuation sheet

Primary location of additional data:

- ☒ State historic preservation office
- ☐ Other State agency
- ☐ Federal agency
- ☐ Local government
- ☐ University
- ☐ Other

Specify repository: _____

10. Geographical Data

Acreage of property 2.5

UTM References

A

Zone	Easting	Northing
14	604530	4653240

B

Zone	Easting	Northing

D

Zone	Easting	Northing

☐ See continuation sheet

Verbal Boundary Description

The property is described as the east 242 feet of the north 176 feet and the west 319 feet of the north 166 feet of tax lot 28, in the southeast quarter of the northeast quarter of Section 26, Township 24 north, Range 4 east, Meadow Grove, Madison County, Nebraska.

☐ See continuation sheet

Boundary Justification

The boundary encompasses that track of land which contains the house, carriage barn and the immediate surrounding landscape that has historically been associated with the property.

☐ See continuation sheet

11. Form Prepared By

name/title Robert Warrick

organization Husband of Owner

street & number RR 2, Box 11

city or town Meadow Grove

date April 25, 1990

telephone (402) 634-2361

state Nebraska zip code 68752

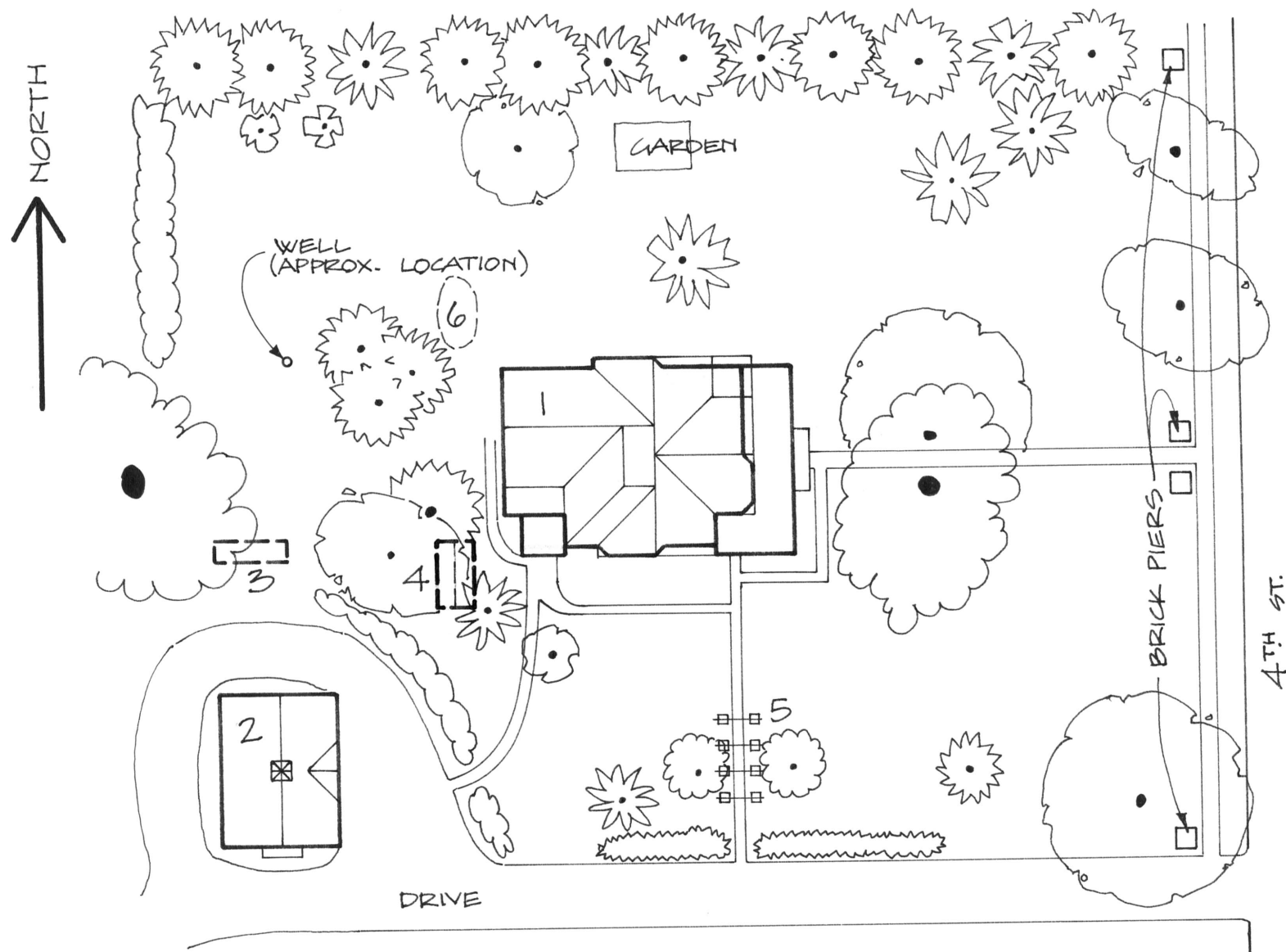

JOHN W. & GRACE WARRICK
HOUSE (NEHBS #MDO4-1)
MEADOW GROVE, NEBRASKA

SITE PLAN - NO SCALE

DRAWN BY DELL DARLING FROM FIELD
NOTES BY BOB PUSCHENDORF
JUNE 1990

KEY

1. HOUSE
2. CARRIAGE HOUSE / BARN
3. CHICKEN HOUSE (NOT EXTANT)
4. WASH HOUSE (NOT EXTANT)
5. PERGOLA (NOT EXTANT)
6. GOLDFISH POND (NOT EXTANT)



View looking NW showing house & carriage barn – Photo by Joni Gilkerson, NSHS, June 1982 (8206/25:18)



View looking SW showing NE facades – Photo by Joni Gilkerson, NSHS, June 1982 (8206/25:20)



1908 historic photo



Photo by Bob Warrick, c1989



Photo by Bob Warrick, c1989