

# TOCKY touch

This is a guide for Tocky touch®, the alarm clock that rolls away and hides to get you out of bed. To reduce the risk of injury, prevent loss of warranty, and/or damage to this product, follow these instructions as you welcome Tocky Touch into your home.

2010 © Nanda Home Inc. All Rights Reserved. This product is produced from original artwork. All copyright and trademark rights in the distinctive appearance and function of this article are owned by Nanda Home Inc. Tocky Touch® is a trademark of Nanda Home Inc. Distributed by Nanda Home Inc. Designed in the US. Printed in China. Patent Pending. nandahome.com.

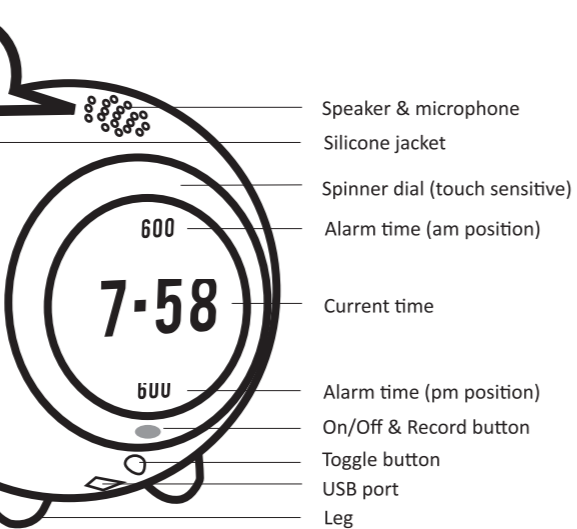

## anatomy of a tocky

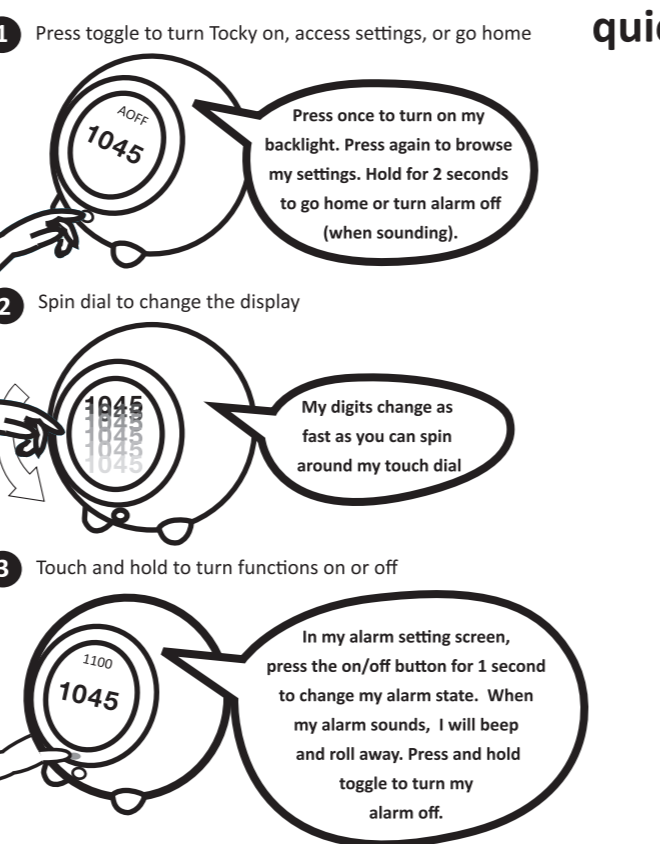

## quickstart

You can record or upload over 6 hours of sound in your Tocky touch! Enter music settings by pressing the toggle until **PLAY** appears on the screen. The track you select will be the first one you wake to when the alarm sounds, and subsequent tracks will play in order.

**PLAY** The track number displayed plays and repeats. Spin to advance tracks.

**REC** Record your own voice: Touch and hold record button below **-REC** for 1 second to record over the current track.

Upload MP3s from any Tocky screen using the steps below. While uploading, **UPLOAD** and the track number will display on the screen (and all other Tocky functions will disable).

**UPLOAD**

- 1 Plug USB into Tocky and a computer
- 2 Find the Tocky drive on your computer
- 3 Drag MP3s to the drive from your computer.
- 4 Eject the drive from your computer and disconnect. Data loss may occur if drive is not ejected first.

## add music

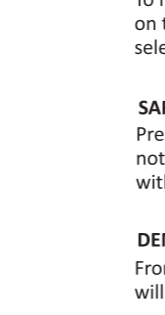
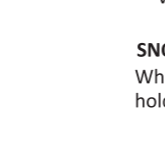

## everything else

**SETTINGS** Toggle through the other screens and you'll find a few more settings. Use spin and touch and hold motion to change Tocky's default settings.

LOUD	SNOOZE	ROLL	HOUR	SOUNDS
alarm sound volume	number of snooze minutes	rolling on or off	12 or 24 hour mode	sound effects on or off

**SNOOZING** When the alarm sounds, touch anywhere on the dial to snooze. Press and hold toggle to turn the alarm sound off.

**TURN-IN FEATURE** To help you fall asleep, use the turn-in feature. Press the toggle once to turn on the backlight and then roll your finger around the spinner dial. The selected song in the **PLAY** screen will playback and slowly fade out.

**SAFETY** Press the toggle at any time when Tocky is rolling to turn off all motion. Do not use Tocky near water or place next to a glass of water. Do not use Tocky without its protective silicone jacket.

**DEMO** From any screen, press and hold the toggle button for 4 seconds. Tocky will beep and roll away. Press and hold toggle again to turn demo off.

## installing batteries & skin

Before using Tocky, or when **BAtt** appears on the screen, replace the batteries by following these steps:

- 1 Strip off the protective silicone skin.
- 2 Twist and pull apart the two hemispheres.
- 3 Unscrew the battery door using a screwdriver.
- 4 Insert new 3 AAA batteries (Lithium recommended)
- 5 Screw the battery door shut.
- 6 Twist & lock together the two hemispheres. Follow the alignment labels.
- 7 Turn the skin inside out. Align back legs and toggle button. Pull skin over Tocky's shell.

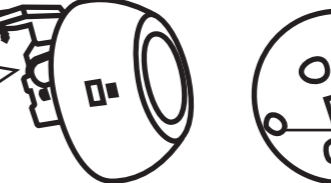
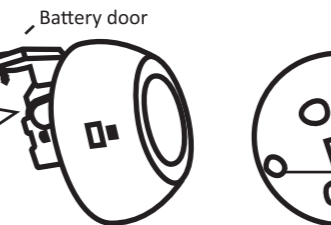

## warnings!

WARRANTY TO ORIGINAL PURCHASER

Nanda Home Inc. ("Nanda") warrants all products to be free of defects in material and workmanship, subject to the following conditions: The duration of Nanda's warranty with respect to each Nanda Home product ("Product") is limited to 90 days from the date of sale to the original consumer purchaser. No other express warranties are made with respect to any Product. All implied warranties, including warranties of merchantability and fitness for Product are limited to the warranty period set forth above. This warranty is not transferable and applies only to the original consumer purchaser of the Product. Nanda will, as its sole obligation under this warranty, replace or repair, at its option, any Product that does not conform to this warranty. This limited warranty does not cover defects in appearance, cosmetic or decorative items, including any non-operative parts. Under no circumstances will Nanda be liable for any loss of revenue, loss of profits or failure to realize expected savings under this warranty or any implied conditions or warranties. These remedies are the customer's exclusive remedies for breach of conditions or warranty. This limited warranty only extends to customers who purchase the Product in the US and Canada.

Nanda will not be responsible for damage resulting from any deviation from Nanda's operating instructions printed in Nanda's catalog or on any packaging, labels or other literature provided with Product Installation of a Product in a manner which is inconsistent with Nanda's written instructions including alteration or modification of a Product, misuse, neglect, abuse, accident, normal wear/tear, commercial use, improper storage, environmental conditions, including excessive temperature or humidity, service by any entity other than a Nanda authorized repair facility, use of the Product in conjunction with any non-Nanda branded accessory, other improper application, installation or operation of this Product, or defects or malfunctions of which Nanda is not advised within ten (10) days of the expiration of the 90 day warranty period.

FCC Compliance and Advisory Statement: This device complies with the limits for a Class B digital device, pursuant to Part 15 of the FCC Rules. These limits are designed to provide reasonable protection against harmful interference in a residential installation. This equipment generates, uses and can radiate radio frequency energy and, if not installed and used in accordance with the instructions, may cause harmful interference to radio communications. However, there is no guarantee that interference will not occur in a particular installation. If this equipment does cause harmful interference to radio or television reception, which can be determined by turning the equipment off and on, the user is encouraged to try to correct the interference by one or more of the following measures: reorient or relocate the receiving antenna, increase the separation between the equipment and receiver, connect the equipment into an outlet on a circuit different from that to which the receiver is connected, consult the dealer or an experienced radio/TV technician for help. Warning: changes or modifications to this unit not expressly approved by the party responsible for compliance could void the user's authority to operate the equipment.

Obtaining warranty service: Access and review the online resources prior to requesting warranty service. If the product is not functioning properly after making use of the help resources, contact Nanda for warranty service by using the email and phone number listed on www.nandahome.com. If warranty service is needed, the purchaser will be required to furnish a sales receipt or other proof of purchase indicating the date of purchase, amount paid, and place of purchase from an authorized Nanda reseller. Customers who fail to provide such proof of purchase will have the Product returned to them or will be charged for the repair/replacement of the Product. The customer is responsible for shipping the Product to the authorized Nanda Warranty Facility.

Some states and provinces do not allow limitations on the duration of implied warranties, or the exclusion or the limitation of incidental or consequential damages. Thus, the above limitations or exclusions may not apply to you. This warranty gives you specific legal rights. You may also have other rights that may vary from state to state. NO PERSON IS AUTHORIZED BY NANDA ELECTRONICS TO MODIFY OR ADD TO THIS LIMITED WARRANTY.

- Before using Tocky, please review these important warnings.
- Tocky touch is not a toy. Children under 6 should be supervised when the product is in use.
  - Tocky touch should sit on a nightstand NO HIGHER THAN 3 FEET.
  - Tocky touch should not be used without a protective silicone skin. The plastic shells should not hit the floor anytime during operation.
  - Make sure the two plastic shells of Tocky touch are in the lock position before use.
  - If the room where Tocky touch lives contains a balcony or access to downward steps, a physical barrier should be used to prevent the hazard of him running off of the balcony or onto the stairs.
  - Do not throw Tocky touch or drop yourself.
  - Do not place near liquids or by an object that may be knocked down.
  - Do not open the product, tamper and/or remove internal components.
  - Do not operate if the product is damaged. Do not try to fix if broken.
  - Batteries are to be inserted in Tocky touch with the correct polarity.
  - Do not mix old and new batteries, or standard and rechargeable batteries.
  - Exhausted batteries should be removed from Tocky touch
  - Always eject the internal TOCKY USB drive first before unplugging the USB cord.
  - Tocky touch is an indoor device only.

