

Proposed Rail Runner Station at Las Soleras



Santa Fe

Metropolitan Planning Organization

Technical Coordinating Committee

April 26, 2010



Overview



- ☐ Las Soleras Master Plan
 - ☐ 810 Application Process & Requirements
 - ☐ Technical Analysis
 - ☐ Ridership Analysis
 - ☐ Environmental Analysis
 - ☐ Public Involvement Program
-



Las Soleras Master Plan



- ☐ Las Soleras is a significant 560 acre mixed use development proposed alongside the Rail Runner route on I-25.
 - ☐ At build-out, 5,000 people will reside at Las Soleras and 9,300 people will work there.
 - ☐ The development promotes *Transit Oriented Development* (TOD) features as encouraged by federal policy and as sought by City, State, and Rail Runner initiatives.
 - ☐ A new Rail Runner station has been proposed at Las Soleras
 - ✓ Within the Interstate 25 median
 - ✓ Between Cerrillos Road and Richards Road
 - ✓ Approximately 3 miles north of NM 599 station
 - ✓ Approximately 4 miles south of Zia station
 - ☐ Authorization from FHWA is needed for the use of the I-25 ROW for this station.
-



Las Soleras Master Plan Location

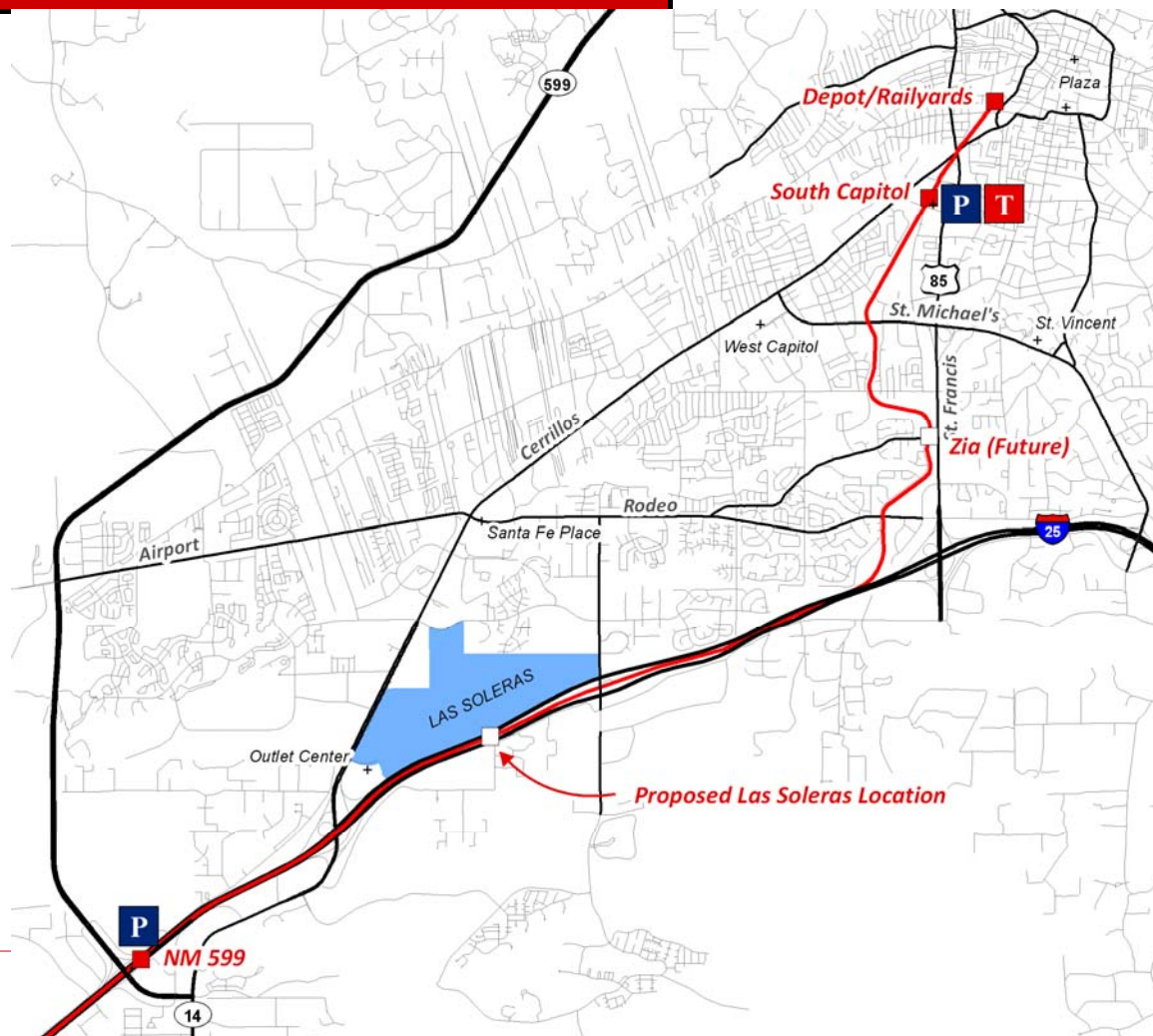



810 Application Process & Requirements



- ☐ **Application for use of public ROW on Federal-aid highway in accordance with 23 CFR section 810 subpart C**
 - ✓ Evidence that utilization of the land for proposed purpose will not impair future highway improvements or the safety of highway users
 - ✓ Public Interest will be served
 - ✓ Proposed action in an urbanized area is based on a continuing, comprehensive transportation planning process

 - ☐ **Agency Roles and Responsibilities**
 - ✓ Privately Funded Project
 - ✓ MRCOG & Rio Metro Transit District
 - ✓ NMDOT
 - ✓ FHWA
-



Technical Analysis



- ☐ I-25 Corridor Study Improvements
- ☐ Future Widening of Interstate 25
- ☐ Potential Interchange at Richards Road
- ☐ Safety for vehicular traffic on the Interstate, Patrons of commuter train, and pedestrians





VICINITY MAP
1"=8000'

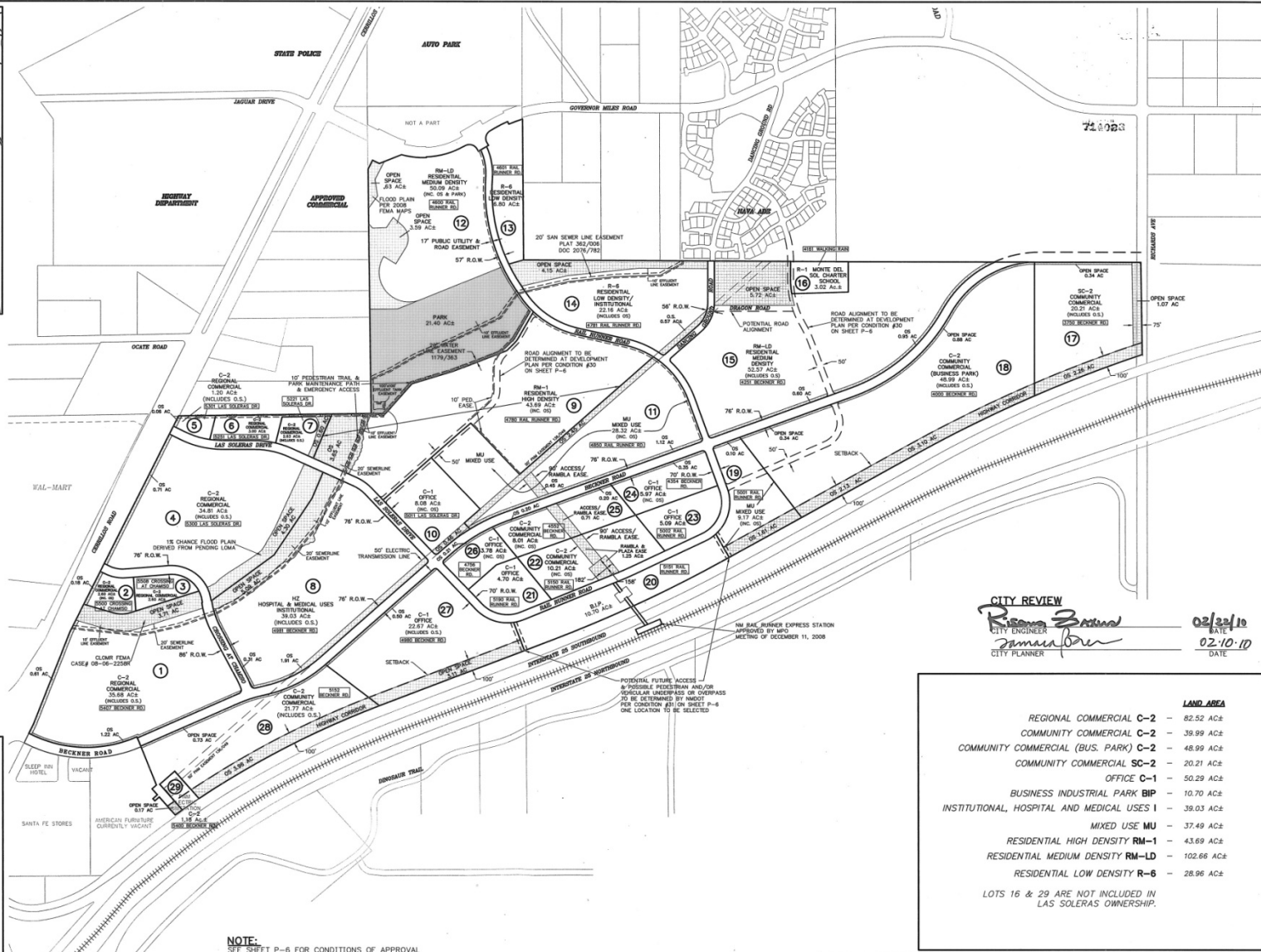
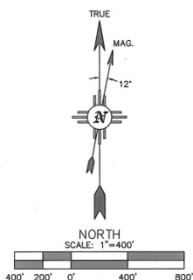

CITY REVIEW
Rising Star
CITY ENGINEER
Ramona Brown
CITY PLANNER

02/24/10
DATE
02-10-10
DATE

	LAND AREA
REGIONAL COMMERCIAL C-2	62.52 ACs
COMMUNITY COMMERCIAL C-2	39.99 ACs
COMMUNITY COMMERCIAL (BUS. PARK) C-2	48.99 ACs
COMMUNITY COMMERCIAL SC-2	20.21 ACs
OFFICE C-1	50.29 ACs
BUSINESS INDUSTRIAL PARK BIP	10.70 ACs
INSTITUTIONAL, HOSPITAL AND MEDICAL USE I	39.03 ACs
MIXED USE MU	37.49 ACs
RESIDENTIAL HIGH DENSITY RM-1	43.69 ACs
RESIDENTIAL MEDIUM DENSITY RM-LD	102.66 ACs
RESIDENTIAL LOW DENSITY R-6	28.96 ACs

LOTS 16 & 29 ARE NOT INCLUDED IN LAS SOLERAS OWNERSHIP.

NOTE:
SEE SHEET P-6 FOR CONDITIONS OF APPROVAL
LAS SOLERAS IS SUBJECT TO AN ANNEXATION AGREEMENT RECORDED AS INSTRUMENT #1332-252 IN THE OFFICE OF THE SANTA FE COUNTY CLERK.
APPROVED BY CITY COUNCIL AS ORDINANCE# 2009-6

CASE NUMBERS:
GENERAL PLAN AMENDMENT# M 2008-27
ANNEXATION# M 2008-28
LOT LINE ADJUSTMENT# SD 2008-15
REZONING# ZA 2008-11

JAMES W. SIEBERT
AND ASSOCIATES, INC.
915 MERCEY STREET • SANTA FE NEW MEXICO 87505
(505) 983-5588 FAX (505) 989-7323

LAS SOLERAS
ANNEXATION MASTER PLAN

SCALE: 1"=400'
DATE: JAN 2010
DRAWN BY: PST/HP
CHECKED BY: JWS
REVIEWED: 1/15/10
FILE NAME: 2008-27-28-15-11
WORKED ON: 1/15/10
SHEET: P-5

STORMWATER AGREEMENT.
PROPERTY OWNER(S) HEREBY AGREE THAT ALL STORM WATER EASEMENTS AND ANY OTHER DRAINAGE IMPROVEMENTS ON PRIVATE PROPERTY WILL BE MAINTAINED AND KEPT FULLY FUNCTIONAL AS ORIGINALLY DESIGNED AND CONSTRUCTED WITHIN PRIVATE PROPERTY BOUNDARIES BY THE PROPERTY OWNER AND SUBSEQUENT HEIRS, ASSIGNS, AND FUTURE OWNERS. THE CITY IS HEREBY GRANTED THE FOLLOWING: (1) ACCESS FOR INSPECTION OF SAID IMPROVEMENTS; (2) IN THE EVENT OF DRAINAGE FACILITY MAINTENANCE DEFICIENCY AND AFTER TEN (10) DAYS WRITTEN NOTICE TO THE RESPECTIVE PROPERTY OWNER, TO ENTER AND RESTORE FULL FUNCTIONAL CAPACITY OF THE DRAINAGE IMPROVEMENTS; AND (3) TO LIEN THE PROPERTY FOR BOTH DIRECT AND INDIRECT COSTS ASSOCIATED WITH SUCH WORK. BY SIGNATURE AFFIXED TO THIS INSTRUMENT, THE PROPERTY OWNER(S) APPROVE AND AGREE THAT THIS AGREEMENT IS BINDING PERPETUALLY, RUNNING WITH THE LAND, ON PRESENT AND FUTURE OWNERS, HEIRS, AND ASSIGNS.
Beckner Road Services, Inc.
by Gordon L. Swanson
(OWNER) *Gordon L. Swanson*
THE FOREGOING INSTRUMENT WAS ACKNOWLEDGED BEFORE ME THIS
18th DAY OF January, 2010
Cecilia M. Reyes
02/23/2011
MY COMMISSION EXPIRES





Ridership Analysis



- ☐ An analysis of Rail Runner ridership potential was performed on behalf of the proposed Las Soleras station.
 - ☐ The analysis was based on actual Rail Runner ridership levels exhibited at other stations in Santa Fe, to date.
 - ☐ The analysis shows significant ridership potential at Las Soleras, particularly as a commuter destination. Ridership levels will reach 900+ per day, making Las Soleras as important a destination as the Depot terminal and South Capitol stations are today.
 - ☐ The analysis also concludes that these transit ridership levels can not be achieved by running shuttle buses from the existing NM 599 station.
-



Rail Runner Egress Modes



- ❑ From Rail Runner internet survey, conducted in Spring, 2009
 - Did our own count at 599, since it was not open in Spring, 2009
 - Also checked Capitol to confirm survey figures
- ❑ 2:1 ratio in walk : bus usage
- ❑ Auto Egress: Significant numbers of commuters are picked up at station. Others (especially 599) park their own cars overnight at station.
- ❑ 599 traffic is heavily oriented to Los Alamos

Egress Mode	599	Capitol	Depot	Overall
Auto	63.7%	20.9%	7.6%	15.4%
Walk/Bike	0.0%	49.1%	68.4%	57.1%
Bus	36.3%	30.0%	24.0%	27.5%
Total	100%	100%	100%	100%

Note: 599 estimated on site on February 3
Capitol data verified on site on February 5

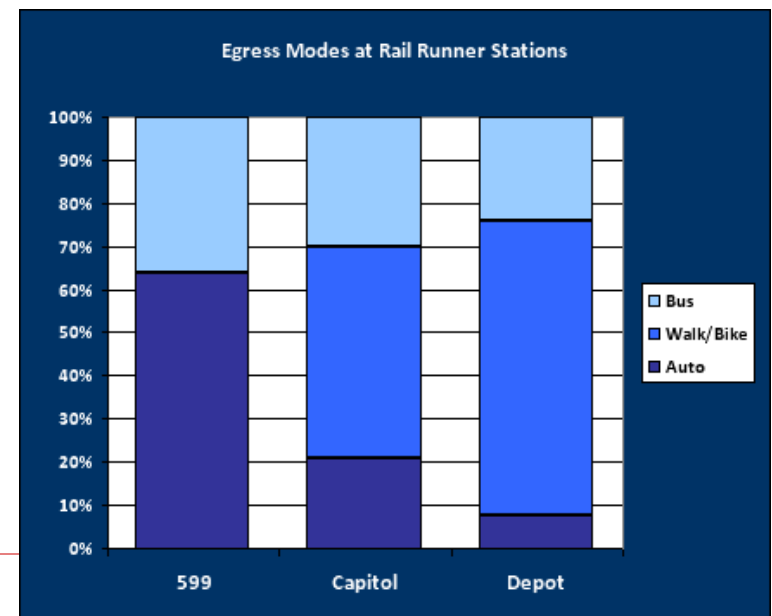



Project Proposal



- Build-Out Horizon Year: 2,198 DUs and 9,272 jobs
- Relocation of NM HSD Offices to high density tracts adjacent to proposed station (~3,000 jobs)

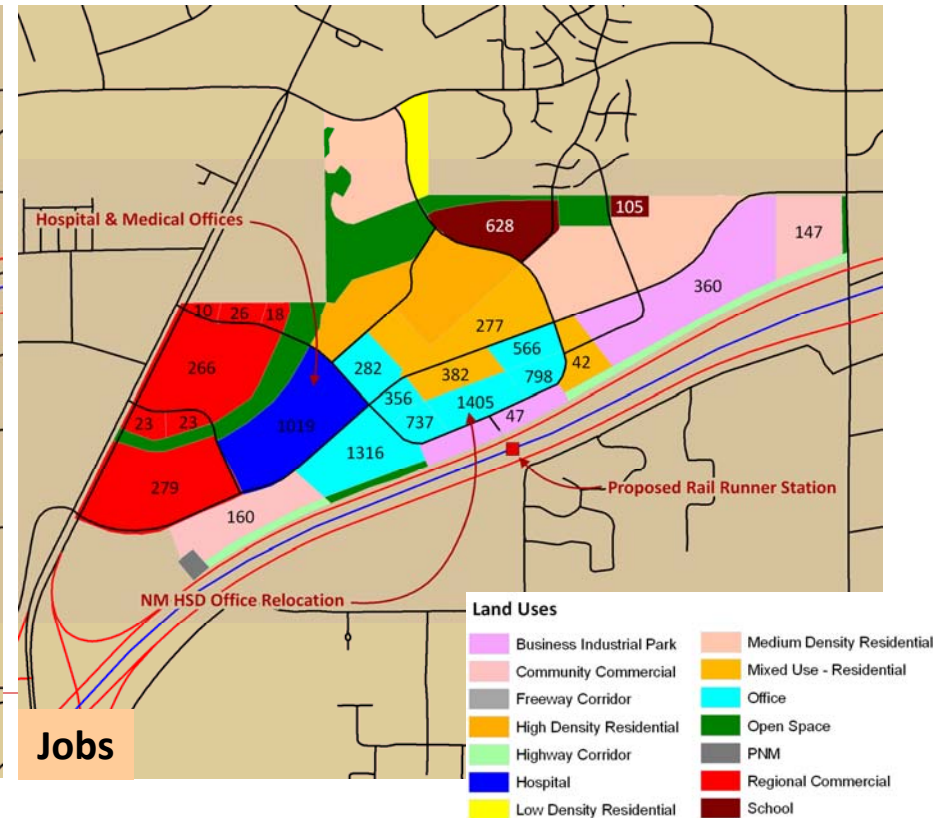
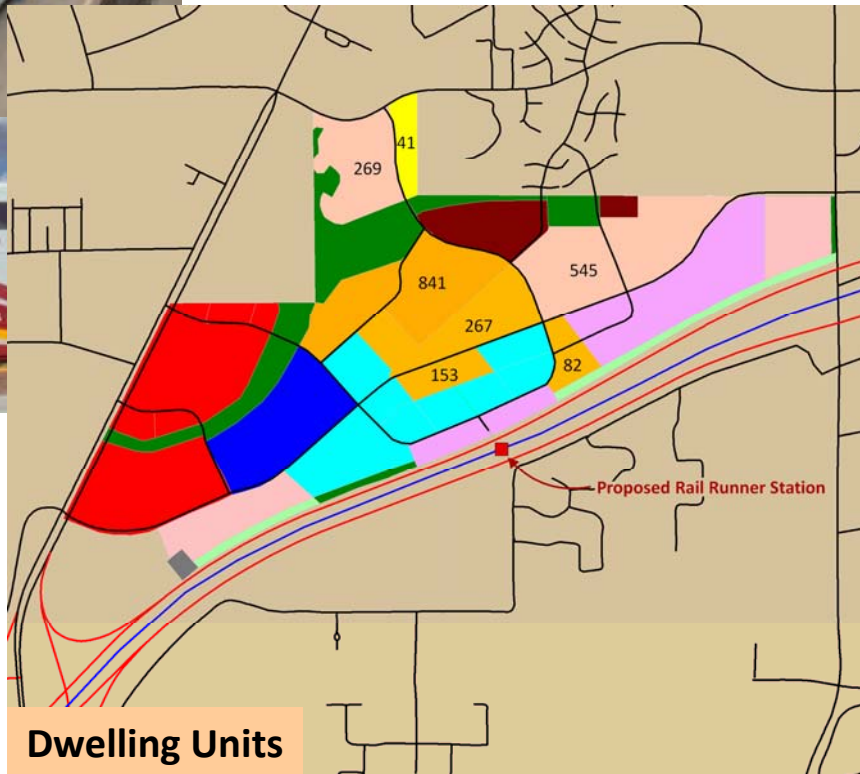



Access to Rail Runner from Las Soleras

- Similar methods for estimating ridership can be applied to Las Soleras station scenarios

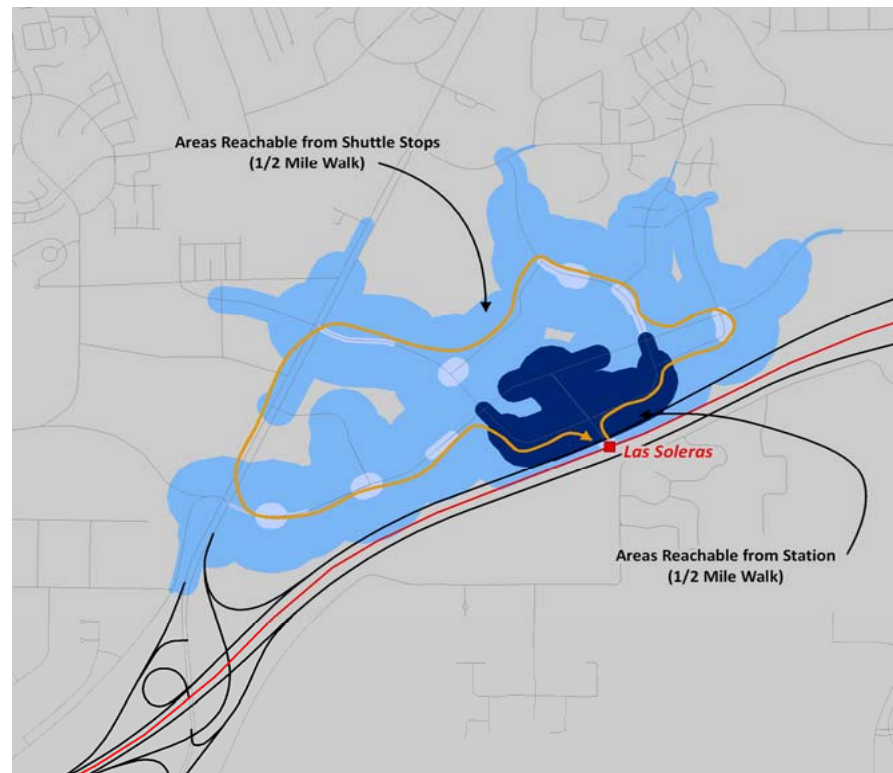



Environmental Analysis



- ☐ Field Surveys Completed
- ☐ No anticipated concerns regarding natural or cultural resources
- ☐ Draft Environmental Assessment Report in May 2010





Public Involvement Program



- ☐ Previous meetings at SFMPO
 - ☐ Public Information meeting May 6, 2010
 - Open House forum 5:00 to 7:00 pm
 - Inn of Santa Fe on Cerrillos Road
 - ☐ Additional Information available on MRCOG Web Site
 - ☐ Public Hearing associated with EA document
-