



BRITTON

Airport Ident BTN
BRITTON

AIRPORT LOCATION

LAT. 45° 48' 57"
LONG. 97° 44' 37"

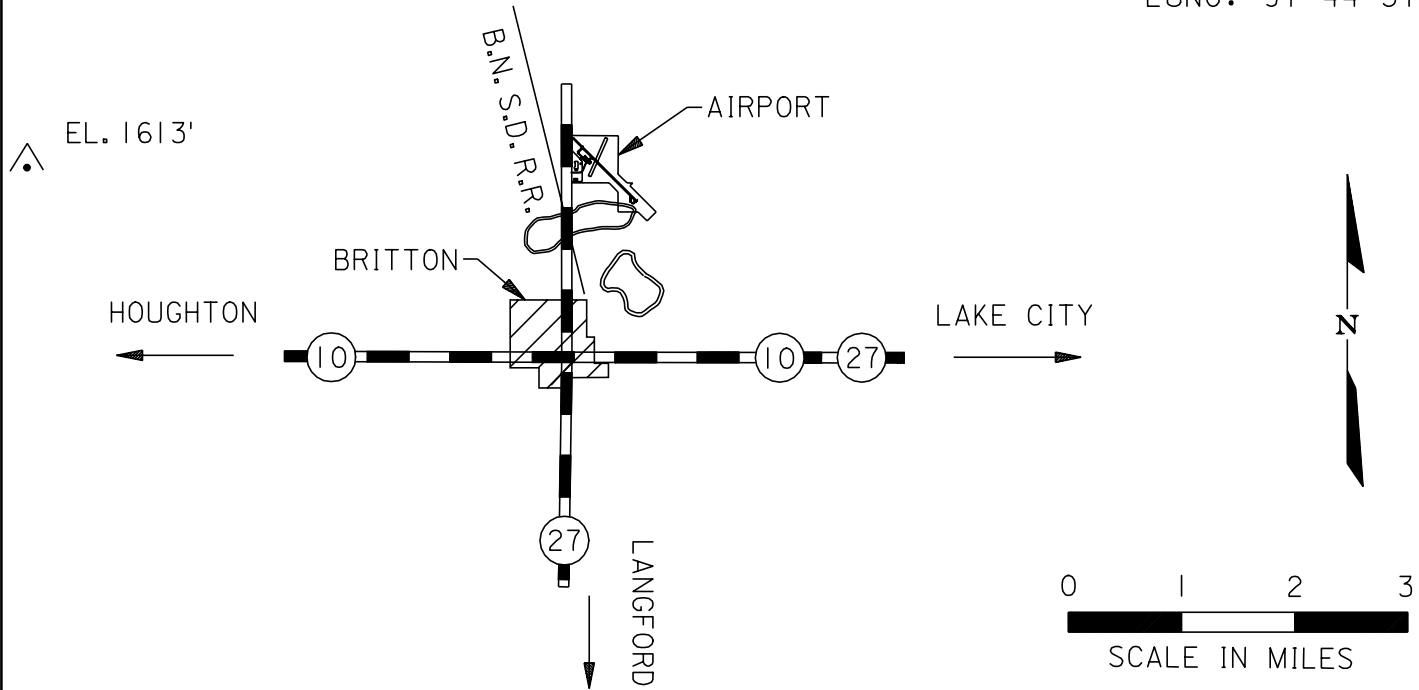

AIRPORT LAYOUT

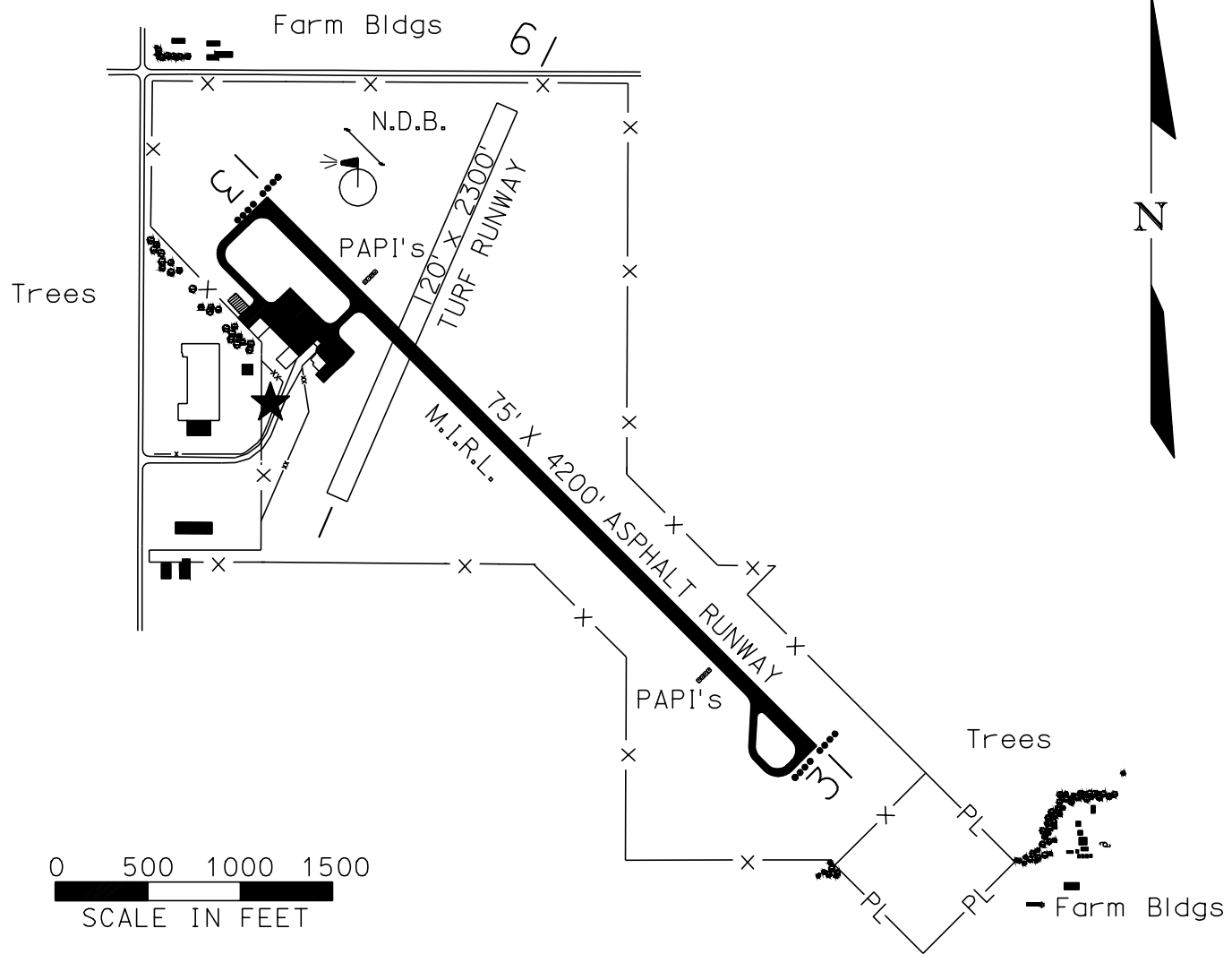

AIRPORT ELEVATION 1318'

RUNWAY SURFACE: 13 / 31 Asphalt
1 / 19 Turf

LIGHTED: 13 / 31 and Beacon

FUEL: 100 LL

REPAIRS: Minor, Major

TRANSPORTATION: Courtesy Car

MEALS: In Town

MANAGER: Terry Haven
(605)448-2264

OWNER: City of Britton

RADIO: AWOS 122.8

NAV. AIDS: GPS RWY 31

FSS: 1-800-992-7433

WEATHER: FSS,
AWOS 122.8 - (617) 262-3825

REMARKS: Attended daylight hours;
Telephone available

Lights Key Mike:
3 Times Low Intensity & PAPI's
5 Times Medium Intensity
7 Times High Intensity

BRITTON

Revised: 9/09