

REMARKS: No Takeoff East (RWY 7)
 Right Traffic RWY 7, 18
 1' Berm Around All Runways
 Rwy 25 powerlines marked with orange balls

NOTE: Not to Scale
 Distances and Heights are Approximate

ACRES 75
ELEVATION 3,990'

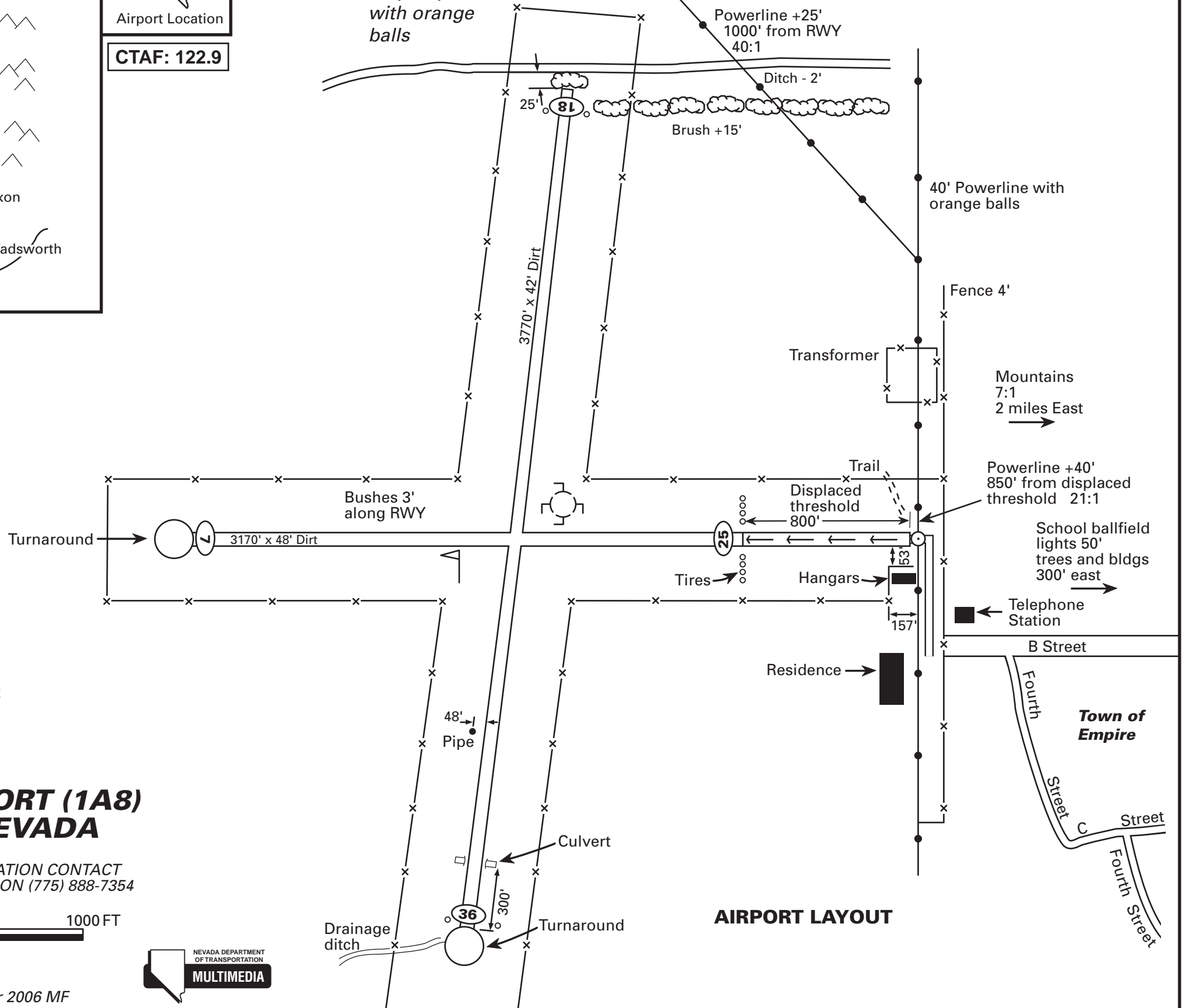

MAG VAR
 16° 06'E
 1989

**EMPIRE AIRPORT (1A8)
 EMPIRE, NEVADA**

FOR DETAILED INFORMATION CONTACT
 NDOT - PLANNING AVIATION (775) 888-7354

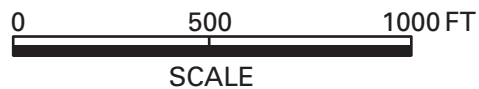

Revised November 2006 MF



AIRPORT LAYOUT