

UNICOM: 122.8

REMARKS: Avoid overflights of city, 2 miles SW of airport.

COORDINATES: 36° 50' 05"N (Est.)
114° 03' 18"W (Est.)

NOTE: Not to Scale
Distances and Heights are Approximate

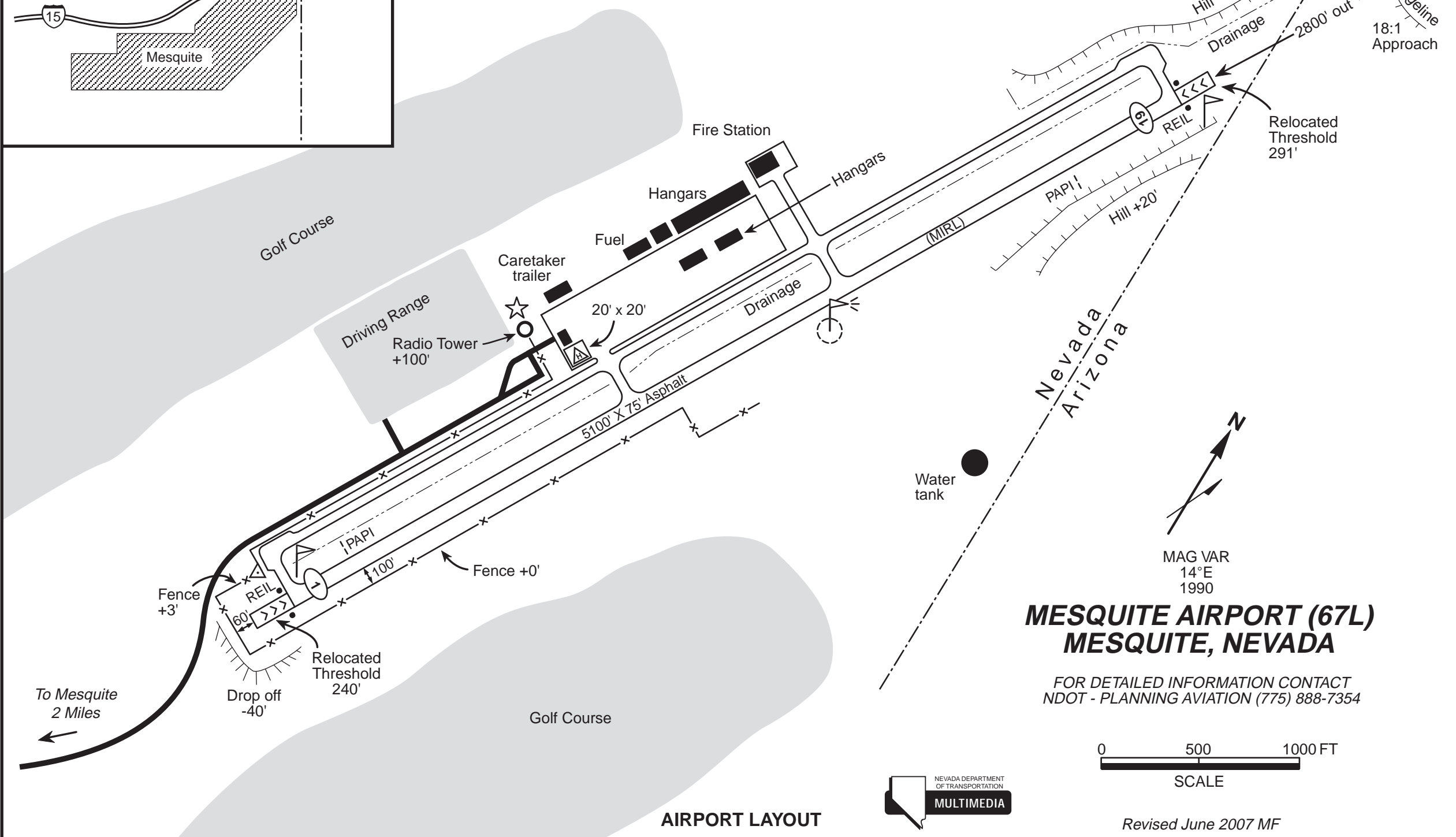

MESQUITE AIRPORT (67L) MESQUITE, NEVADA

FOR DETAILED INFORMATION CONTACT
NDOT - PLANNING AVIATION (775) 888-7354

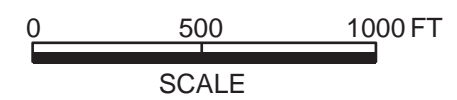

Revised June 2007 MF



MAG VAR
14°E
1990

To Mesquite
2 Miles