

PRIMARY WALKWAY STRUCTURE

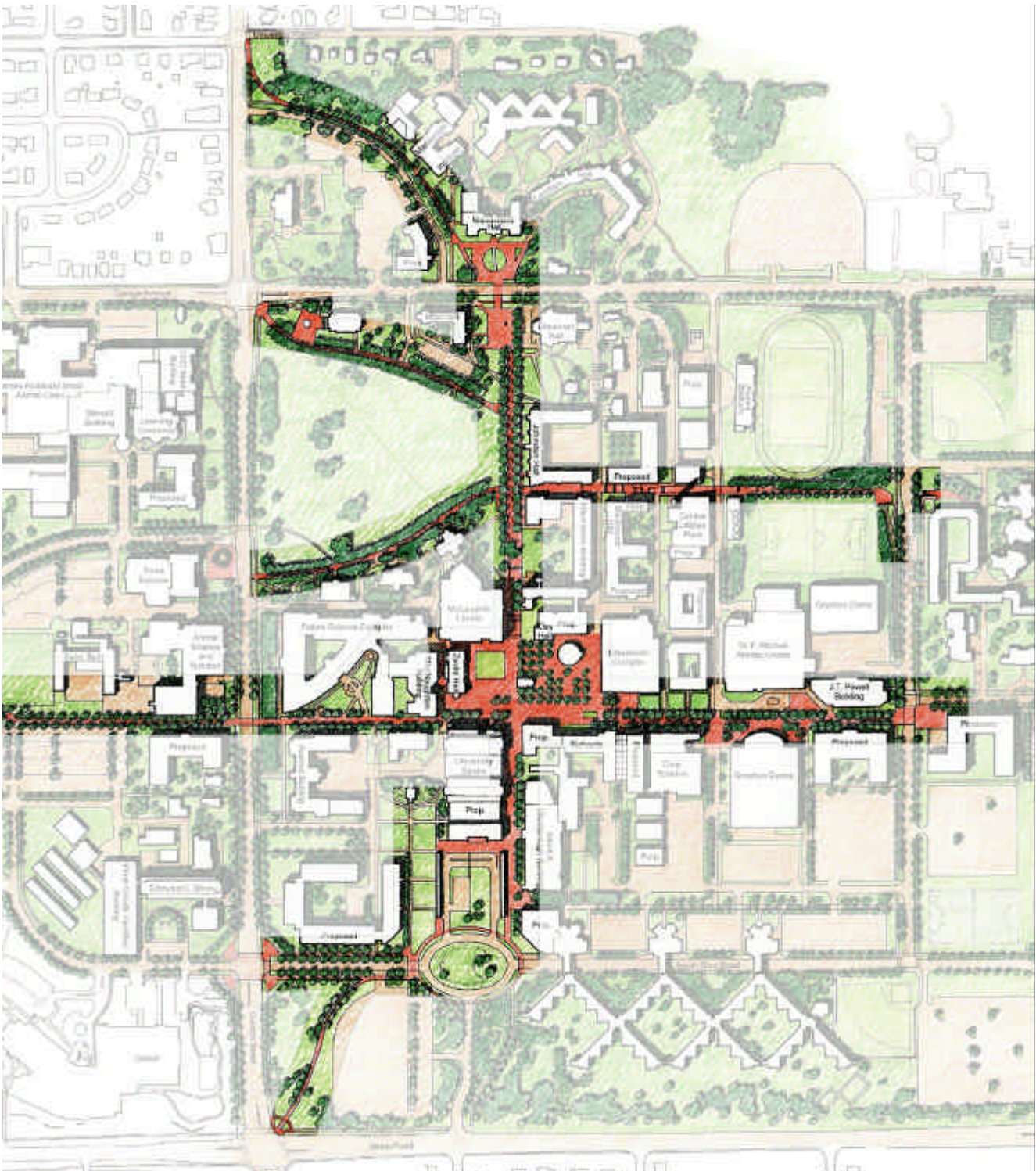

Figure 157: Demonstration Plan - Primary Walkway System

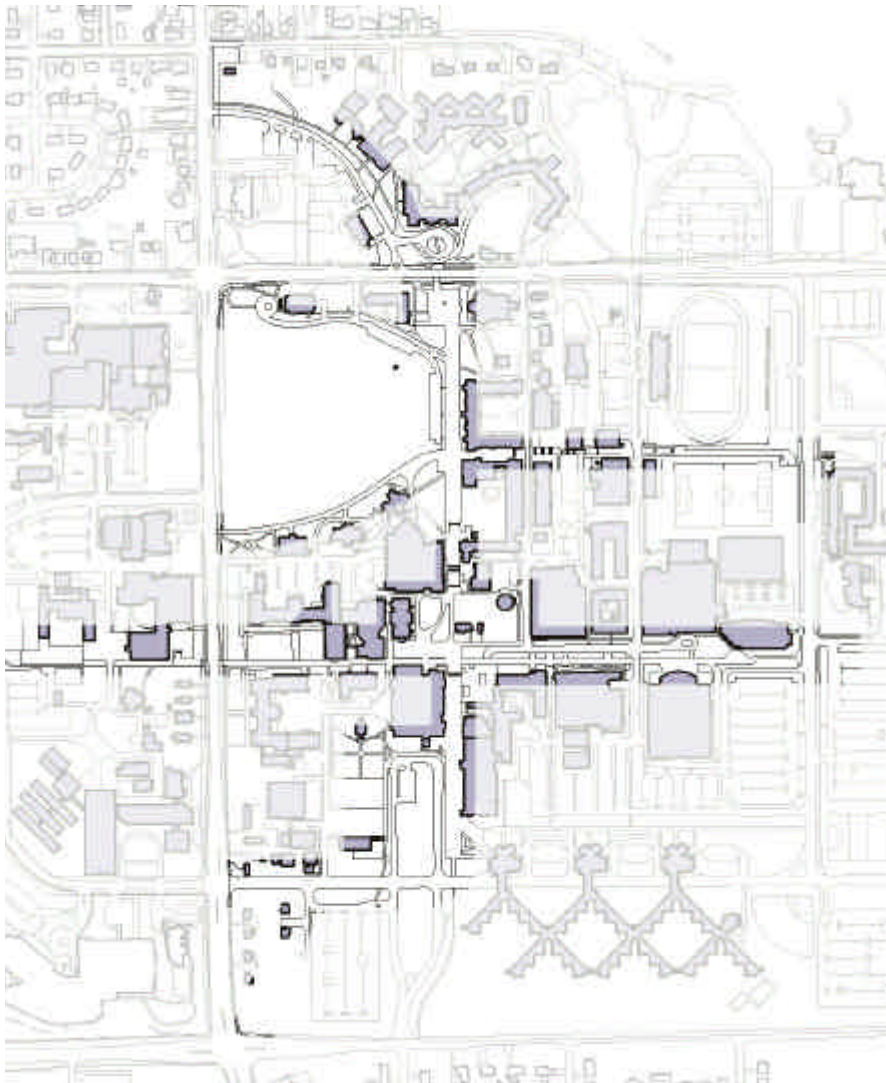

Figure 158: Existing Condition - Primary Walkway Structure

The primary walkways form a visually and functionally unifying structure to the campus. It embraces the formal entrance, Branion Plaza, and Johnston Green. It is composed primarily of Winegard, Reynolds, and Stadium Walks, and their extensions. Winegard is extended north and west along Macdonald Street, and south and west along South Ring Road and to the intersection of Stone Road and Gordon Street. The structure is reinforced by building frontages and landscapes which frame the walkways and open spaces.



Figure 159: Demonstration Model - Winegard Walk, Looking North



Figure 160: Demonstration Model - Reynolds Walk, Looking East

JOHNSTON GREEN

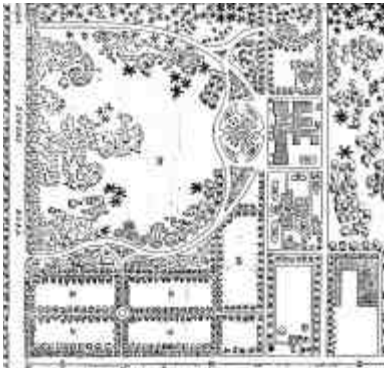

Figure 161: 1882 Master Plan



Figure 162: Existing Condition - Johnston Green

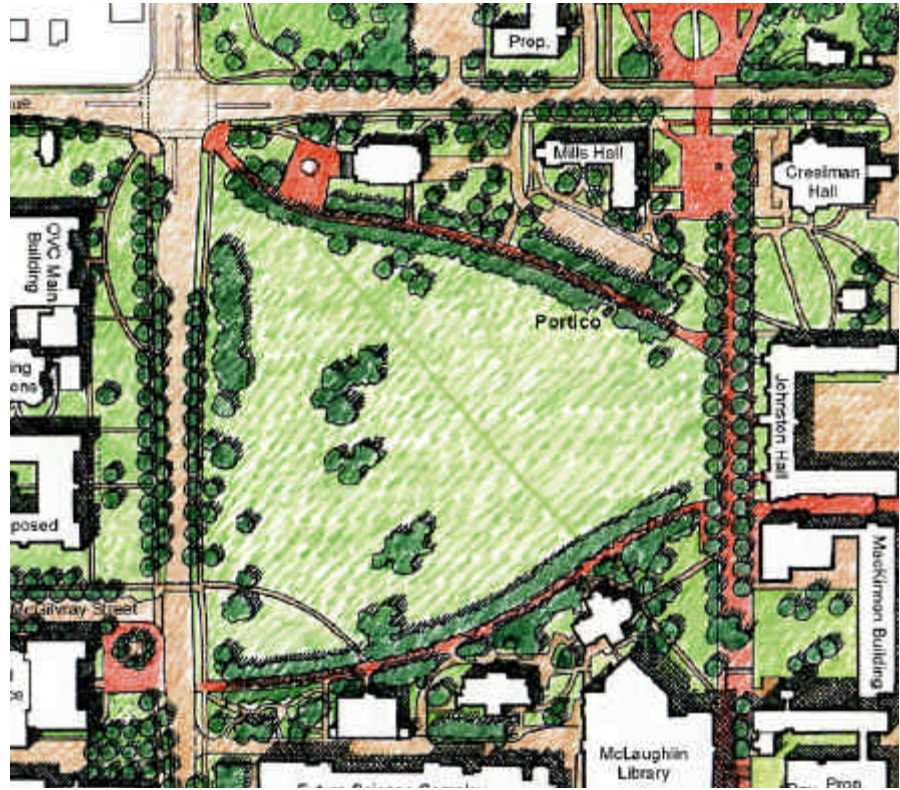

Figure 163: Demonstration Plan - Johnston Green

Johnston Green is the signature space of the university campus. It is beautifully framed to its south by the brick-paved, tree-lined walkway (the old carriageway), flanked with comfortably scaled, well-modeled buildings and by the commanding presence of Johnston Hall to the east. The north edge, while backed by historic buildings, lacks the gracing touch of a similar walkway. The roadways that exist in this area are less ordered.

A New Walk

Reorganizing the northern roadway into a primary pedestrian avenue would further reinforce the identity of Johnston Green. The idea is not new. It reflects the original 1882 Master Plan, which shows two carriageways.



Figure 164: Demonstration Model - Johnston Green, Looking South East

A Western Frame

The Green has a frontage to Gordon Street, from which it rises in a tilted plane towards its crown of Johnston Hall. This sense of frontage is partly reinforced by the OVC Main Building to the north and the Food Science building to the south. The gap in between should be developed with building frontages, in order to reinforce the sense of frontage and containment of the Green.

BRANION PLAZA



Figure 165: 1964 Plan

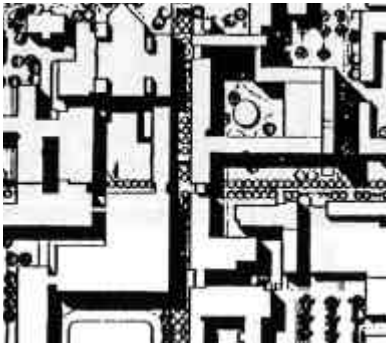

Figure 166: 1967 Plan

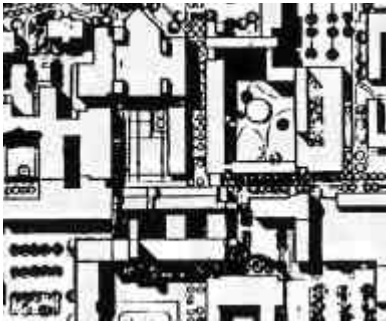

Figure 167: 1971 Plan



Figure 168: 1987 Plan

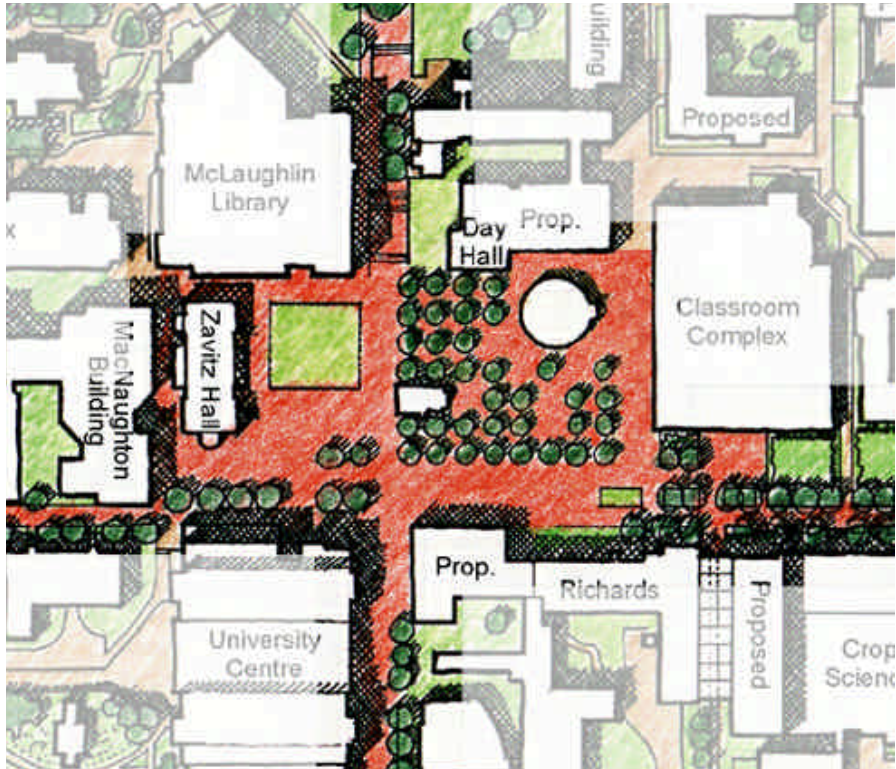

Figure 169: Demonstration Plan - Branion Plaza

Branion Plaza has been a main feature of the campus plan since 1964 when it was designated as the University's "town square", to be surrounded by central University buildings. This 2002 Plan differs from the previous ones in that it retains Zavitz Hall and incorporates the Classroom Complex on one edge of the square. Two infill buildings are shown to frame the square: an addition to the MacKinnon Building linking it with Day Hall (which also resolves the need for a satisfactory south east entrance into MacKinnon), and an addition to Richards and Thornbrough.

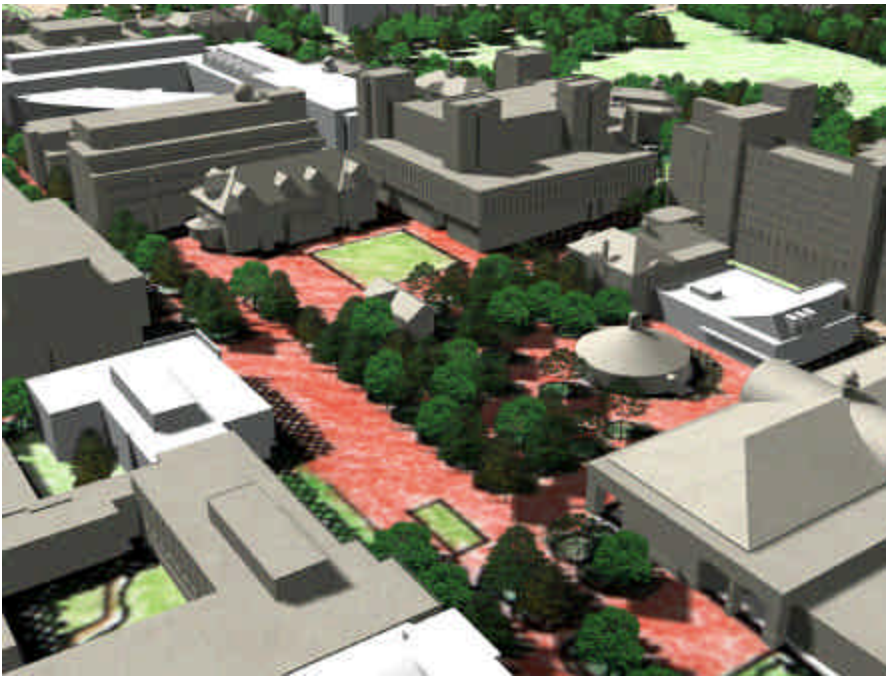

Figure 170: Demonstration Model - Branion Plaza, looking North West

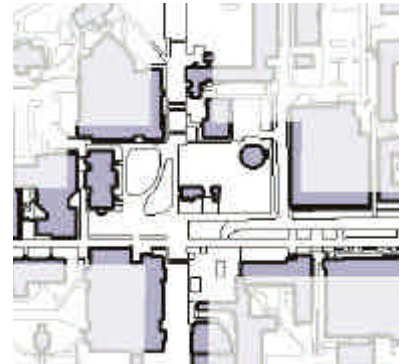

Figure 171: Existing Condition - Branion Plaza

The Plan demonstrates a composition of several landscapes within the frame of buildings: a hard surface north of University Centre, a green square north of that, and east of Winegard Walk a bosque of trees, which provides shade and visual relief but through which various pedestrian routes can cross. All the buildings surrounding the plaza should have public, animated uses at ground level, as already evident in the University Centre, Bookstore, Library, and future Classroom Complex.

FORMAL CAMPUS ENTRY



Figure 172: Existing Condition - Formal Entry



Figure 173: Blocked View of Campus, From the South on Gordon Street



Figure 174: If Aqualab is to remain in the long term, new development should wrap around it.

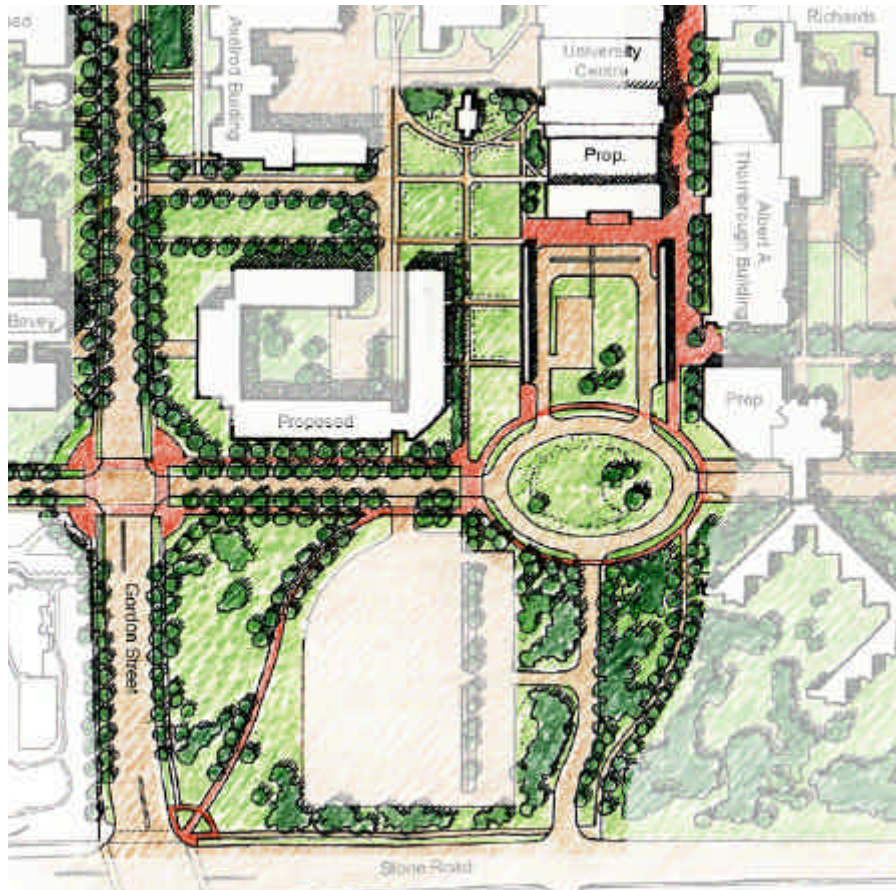

Figure 175: Demonstration Plan - Formal Entry

The north part of the University has excellent presence on Gordon Street and College Avenue, a condition lacking to the south along Gordon and Stone, yet the primary access is from the south. The roads and paths are shown reworked so that a primary entry situation is readily perceived at the intersection of Gordon and South Ring Road, and then turned north via an oval to University Centre, which has bus shelters and a drop-off area. This movement pattern is reinforced by the building and landscape pattern, which expands the northern campus identity to the south.

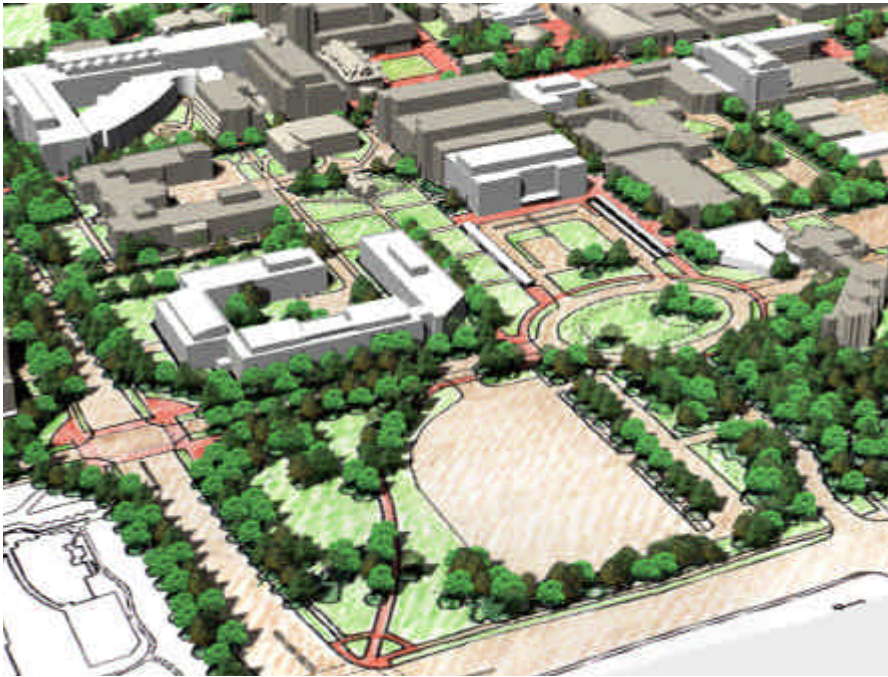

Figure 176: Demonstration Model - Formal Entry, Looking North East

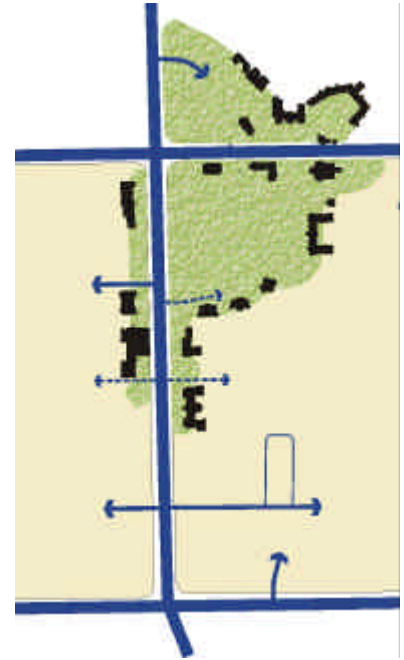

Figure 178: Existing areas With a Good Sense of Arrival



Figure 177: The Existing Sense of Arrival from the North on Gordon Street



Figure 179: Proposed Sense of Arrival, Expanded to the South



THE GORDON STREET FRONTAGE



Figure 180: Existing Condition - Gordon Street Frontage



Figure 181: Demonstration Plan - Gordon Street Frontage



Figure 182: Demonstration Model - Gordon Street Frontage, Looking North

At present, Gordon Street is a valuable frontage or address street to the University, but as a major traffic artery it also tends to split the campus. The Demonstration Plan shows a subtle re-orientation of the street character to emphasize its frontage and entry role and de-emphasize its barrier effects. This would be achieved through expanding the pedestrian environment on either side of the road, additional traffic lights at McGilvray Street and possibly University Avenue, and a change in surface material at places pedestrians normally cross.

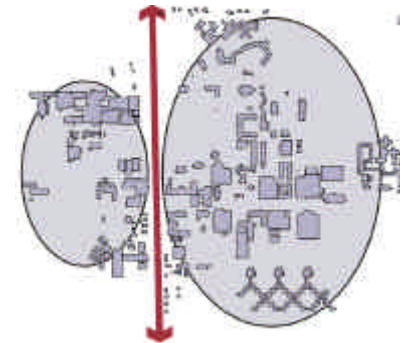

Figure 183: A Split Campus

REYNOLDS WALK WEST

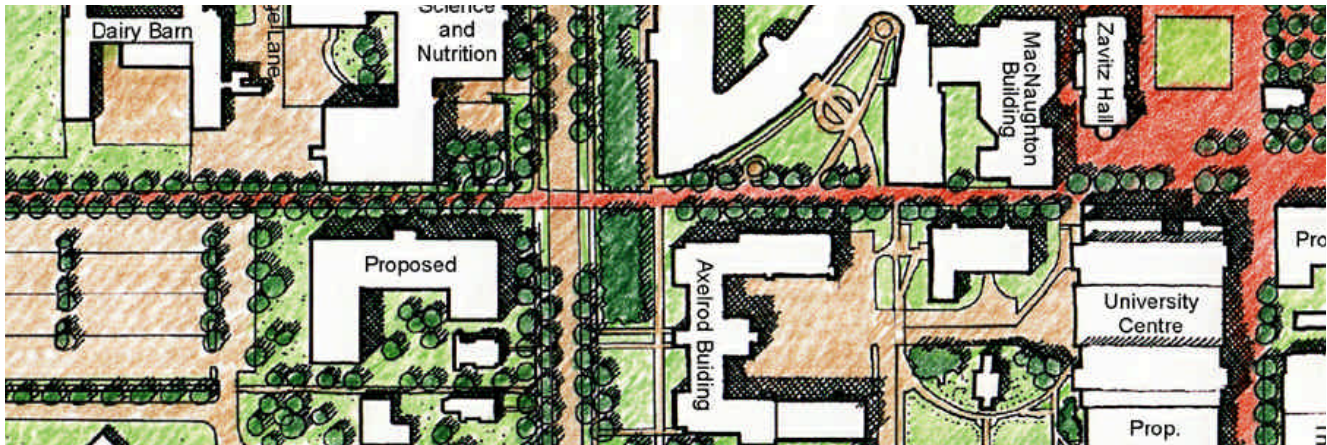

Figure 184: Demonstration Plan - Reynolds Walk West

Reynolds Walk West will be framed to its north by the new Science Complex. Its crossing of Gordon Street should be evident in a change of surface material on the road (such as a concrete crosswalk) and then extended as a generously paved and landscaped walkway west. A proposed building south of Animal Science and Nutrition is shown as a flanking element.



Figure 185: Demonstration Model - Reynolds Walk West, Looking West

REYNOLDS WALK EAST

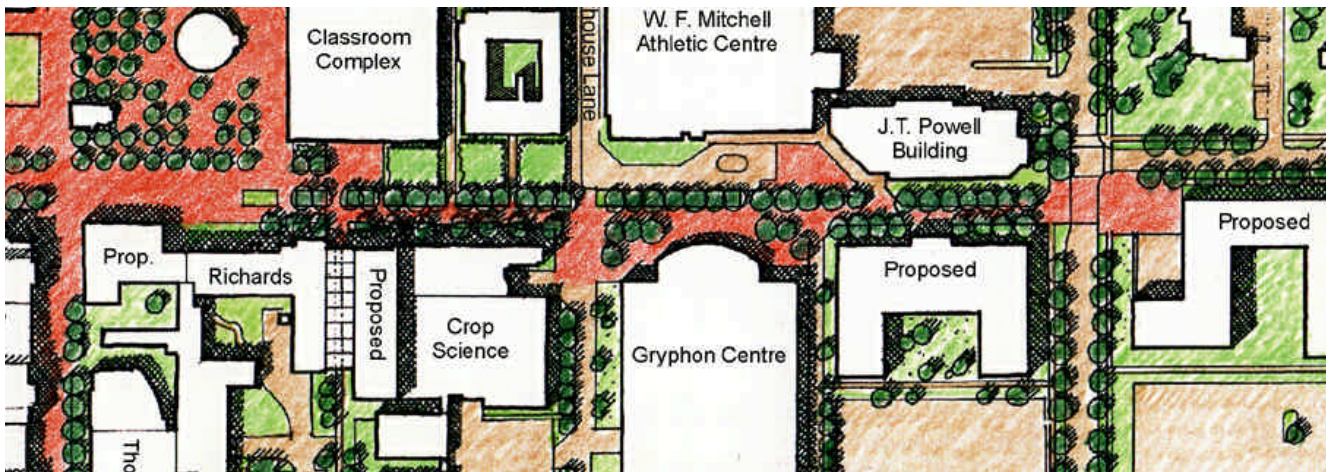

Figure 186: Demonstration Plan - Reynolds Walk East

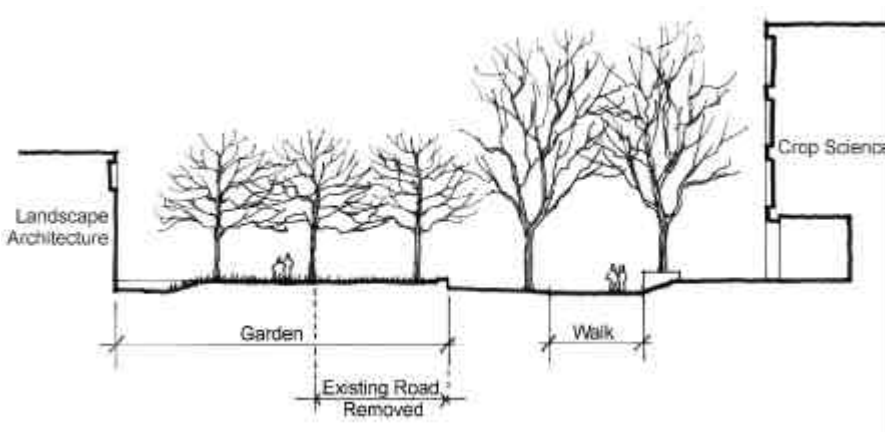

Figure 187: Demonstration Section - Reynolds Walk East



Figure 188: Demonstration Model - Reynolds Walk East, Looking East

The space between buildings on Reynolds Walk east of Winegard presently includes both a road and a walkway and as a result is much wider than the western section of the walk. The Demonstration Plan shows the removal of much of the road, and its replacement with a series of gardens. A new building is shown south of J.T. Powell as a framing element, and another east of East Ring Road as a termination to the visual axis.

