

- LEGEND**
- COUNTY BOUNDARY
 - STATE OR COUNTY LINE INDETERMINATE
 - SECTION LINE
 - U.S. LAND TOWNSHIP LINE
 - PARK OR RESERVATION BOUNDARY
 - PAVED STATE OR U.S. HIGHWAY
 - DIVIDED HIGHWAY OR U.S. HIGHWAY
 - INTERSTATE HIGHWAY
 - U.S. NUMBERED HIGHWAY
 - STATE HIGHWAY
 - PAVED LOCAL ROAD
 - GRAVEL LOCAL ROAD
 - GRADED & DRAINED LOCAL ROAD
 - UNIMPROVED LOCAL ROAD
 - INTERCHANGE
 - RAILROAD STATION
 - GRADE CROSSING
 - OVERPASS
 - UNDERPASS
 - HIGHWAY BRIDGE (SEE FEET OR MILES IN LENGTH)
 - LEVEE OR DUNE
 - MILEAGE BETWEEN POINTS
 - LAKE, RESERVOIR OR POND
 - MARSH OR SWAMP
 - WIDE RIVER OR STREAM
 - DOCK, PIER OR LANDING
 - SMALL STREAM
 - DRAINAGE DITCH
 - CORPORATE LIMITS AND ROADS THROUGH TOWN
 - COUNTY SEAT
 - OTHER CITIES AND TOWNS
 - MUNICIPAL AIRPORT
 - PRIVATE AIRFIELD
 - FARM UNIT OR DWELLING
 - GROUP OF CLOSELY SPACED DWELLINGS (i.e. FARM HOUSE)
 - CHURCH OR OTHER RELIGIOUS INSTITUTION
 - POST OFFICE & POST OFFICE AND BUSINESS
 - CEMETERY
 - CHURCH WITH CEMETERY ADJACENT
 - BUSINESS ESTABLISHMENT
 - FACTORY OR INDUSTRIAL PLANT
 - SAWMILL
 - GRAVEL PIT OR QUARRY
 - NURSERY
 - TOWN OR COMMUNITY HALL
 - RADIO OR TELEVISION STATION AND CALL LETTERS
 - MUSEUM, GENERAL
 - FIRE ENGINE HOUSE
 - GAUGING OR PUMPING STATION
 - NURSING OR REST HOME
 - POWER SUBSTATION
 - GRAN ELEVATOR
 - TRAILER PARK
 - FISH HATCHERY
 - PUMPING STATION, OIL OR GAS
 - CAMP OR LODGE
 - GOLF COURSE OR COUNTRY CLUB
 - ATHLETIC FIELD OR AMUSEMENT PARK
 - SMALL PARK (i.e. STATE, COUNTY, OR MUNICIPAL, OR RESERVE, OR REST AREA)
 - WATER SUPPLY STANDPIPE OR TANK
 - SEWAGE DISPOSAL PLANT
 - GARBAGE DUMP OR SANITARY LANDFILL
 - AUTO SALVAGE YARD
 - ARMORY
 - CHICKEN HOUSE OR OTHER LIVESTOCK

GENERAL HIGHWAY MAP
LONOKE COUNTY
 ARKANSAS

PREPARED BY
 ARKANSAS STATE HIGHWAY AND TRANSPORTATION DEPARTMENT
 PLANNING AND RESEARCH DIVISION
 IN COOPERATION WITH
 U.S. DEPARTMENT OF TRANSPORTATION
 FEDERAL HIGHWAY ADMINISTRATION
 SCALE 1:62500
 METERS

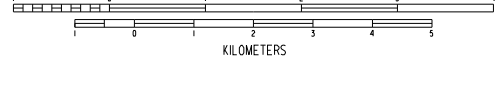

Copies of this map are available
 at a nominal fee from the
 Arkansas State Highway and
 Transportation Department,
 P.O. Box 226-Little Rock, Ark. 72203

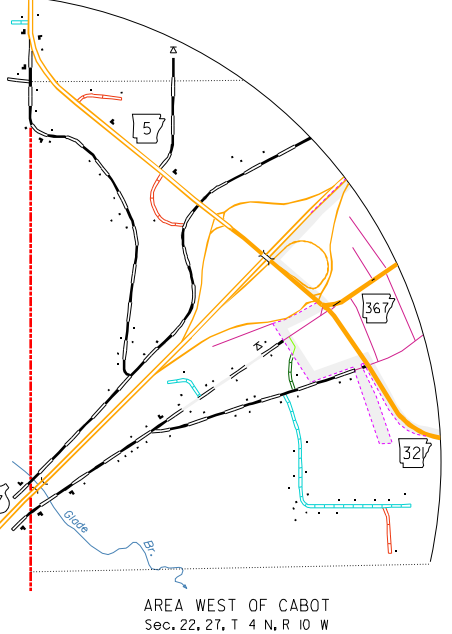
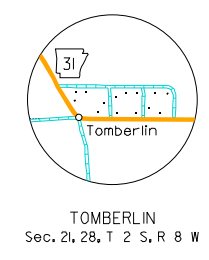
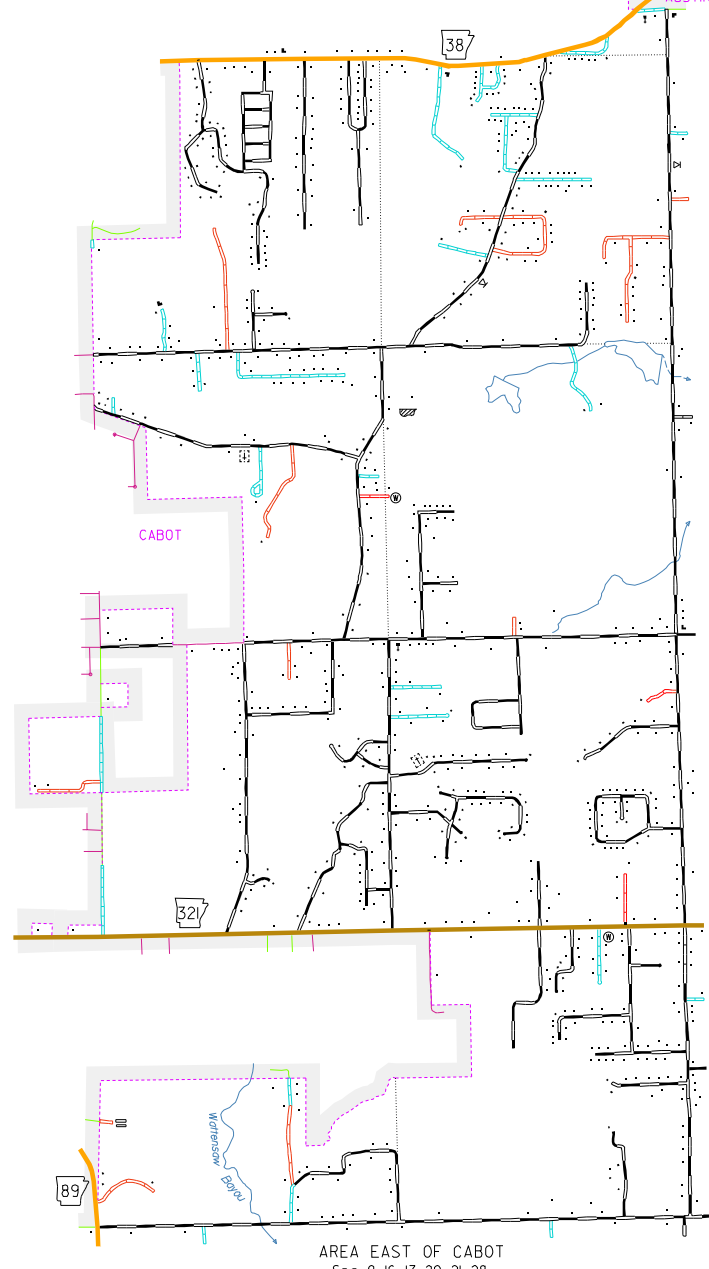

NOTE: Enlargements of congested areas are five times
 map scale unless otherwise noted.
 Individual maps are available for active incorporated cities.
 Area: 802.48 Square Mile
 Population: 52,838 - 2000 Census
 Map Issued: 2-11-00 - replaces map issued 6-9-93
 Filed Inventory: 9/99

Map revisions made from aerial photographs taken 2-5-98
 Map compilation completed 1-15-00
 County map produced using Computer Assisted Cartography.

Map Revised 05-08-06, Relocation of Sx 89 in Cabot.
 Map Revised 08-08-06, Lonoke Co. City limit changes to Cabot and Auair.
 Map Revised 02-08-07, Population change Special census of Cabot, 11-02-06.
 Map Revised 06-01-07, County Line between Pulaski and Lonoke Counties changed in vicinity of Scott.
 Map Revised 11-24-08, changed portion of Sx 5, Section 2 to multi-lane divided, Cabot north approx. 2.5 miles, Lx 10.
 Map Revised 09-23-09, added and relocated a portion of Sx 38, Section 0, Lx 9.
 Map Revised 02-02-10, added bridge on Sx 98, Section 10, Lx 20, Lx 10.
 Map Revised 05-17-10, added a portion of roadway to the end of Sx 38, Section 2, Lx 10.



Polyconic Projection-North American Datum