

- LEGEND**
- COUNTY BOUNDARY
 - U.S. LAND TOWNSHIP LINE
 - SECTION LINE
 - NATIONAL FOREST BOUNDARY
 - PARK OR RESERVATION BOUNDARY
 - PAVED STATE OR U.S. HIGHWAY
 - STATE HIGHWAY
 - PAVED LOCAL ROAD
 - GRAVEL LOCAL ROAD
 - GRADED & DRAINED LOCAL ROAD
 - UNIMPROVED LOCAL ROAD
 - RAILROAD (BY NUMBER OF TRACKS CODED BY COLOR: 1 TRACK, 2 TRACKS, 3 TRACKS)
 - RAILROAD STATION
 - GRADE CROSSING
 - OVERPASS
 - UNDERPASS
 - HIGHWAY BRIDGE (BY FEET OR MORE IN LENGTH)
 - PAVED FORD OR LOW WATER BRIDGE
 - LEVEE OR DIKE
 - MILEAGE BETWEEN POINTS
 - LAKE, RESERVOIR OR POND
 - LAKE, RESERVOIR OR POND WITH DAM
 - MARSH OR SWAMP
 - WIDE RIVER OR STREAM
 - DOCK, PIER OR LANDING
 - NAVIGABLE STREAM
 - INTERMITTENT NAVIGATION
 - DAM WITH LOCK
 - SMALL STREAM
 - DRAINAGE DITCH
 - CORPORATE LIMITS AND ROADS THROUGH TOWN
 - COUNTY SEAT
 - OTHER CITIES AND TOWNS
 - PRIVATE AIRFIELD
 - FARM LINT OR DWELLING
 - GROUP OF CLOSELY SPACED DWELLINGS (IF NO FEARS SHOWN)
 - APARTMENT COMPLEX, OR HOTEL
 - CHURCH OR OTHER RELIGIOUS INSTITUTION
 - SCHOOL
 - CEMETERY
 - CHURCH WITH CEMETERY ADJACENT
 - BUSINESS ESTABLISHMENT
 - FACTORY OR INDUSTRIAL PLANT-COTTON OR
 - SAWMILL
 - GRAVEL PIT
 - QUARRY
 - TOWN OR COMMUNITY HALL
 - RADIO OR TELEVISION STATION AND CALL LETTERS
 - FOREST RANGER STATION
 - FIRE ENGINE HOUSE
 - GAUGING OR PUMPING STATION
 - POWER SUBSTATION
 - FISH HATCHERY
 - OBSERVATION OR LOOKOUT TOWER
 - CAMP OR LODGE
 - SMALL PARK (BY AREA OF COUNTY OR MUNICIPALITY CODED)
 - WATER SUPPLY STANDPIPE OR TANK
 - SEWAGE DISPOSAL PLANT
 - GARBAGE OR RUBBISH DUMP
 - AUTO JUNK YARD
 - FAIRGROUND, RACE COURSE OR SPEEDWAY
 - CHICKEN HOUSE
 - SCENIC SITE OR OVERLOOK
 - PICNIC GROUND
 - SCENIC HIGHWAY

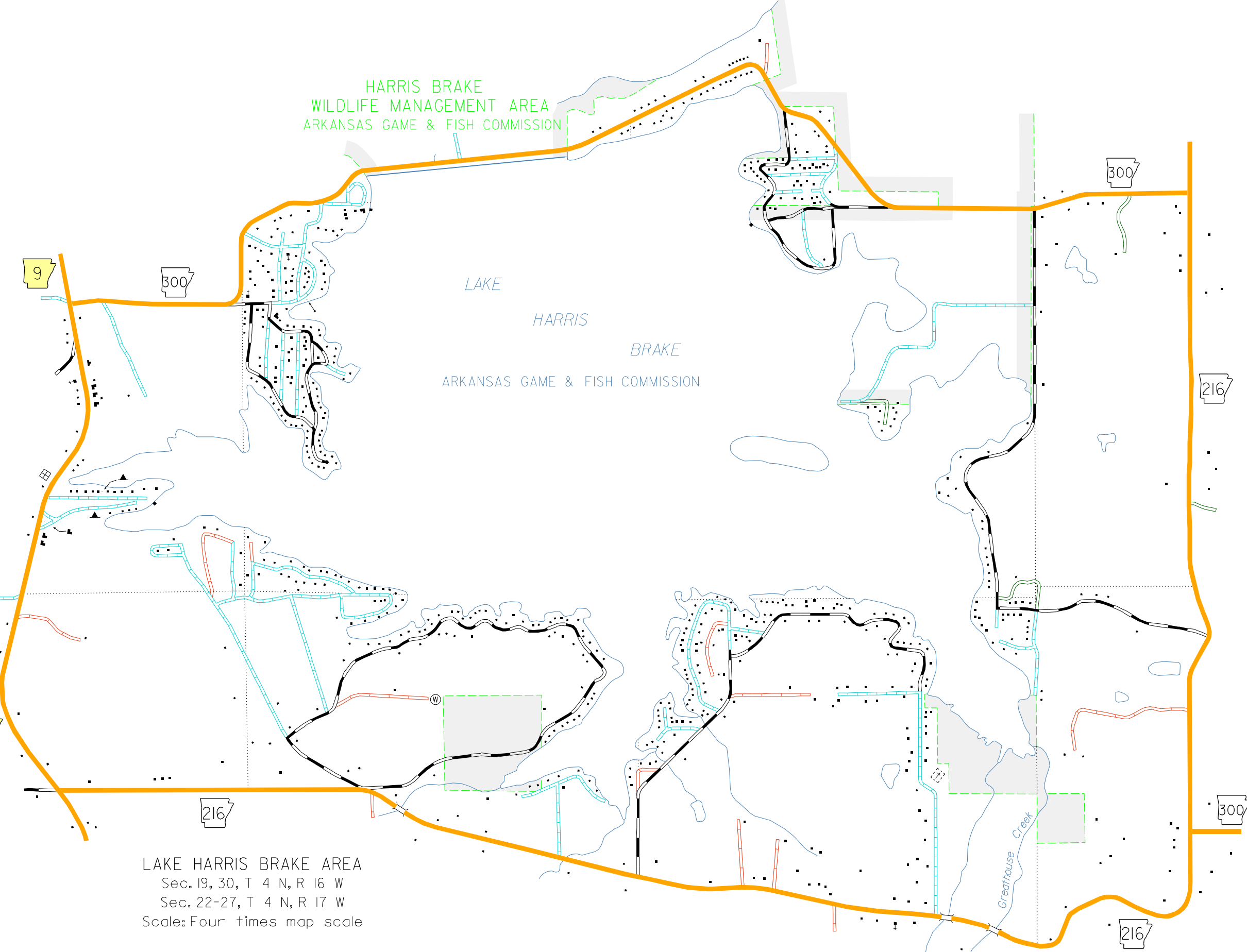
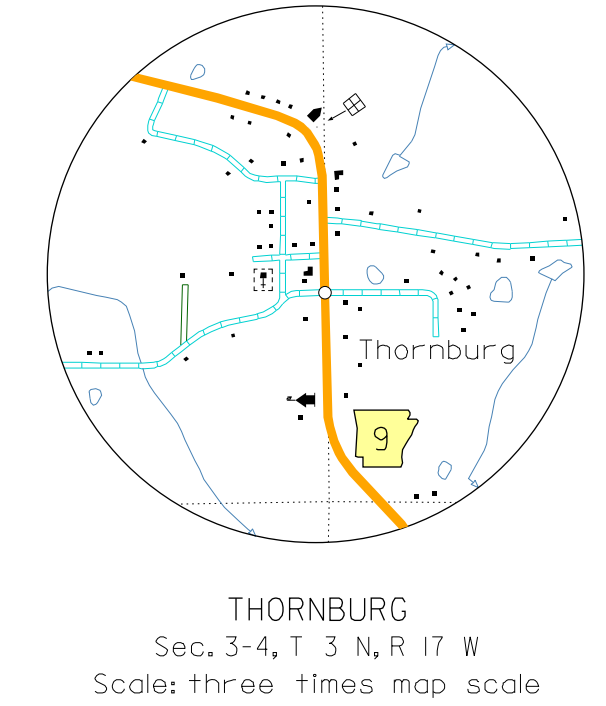
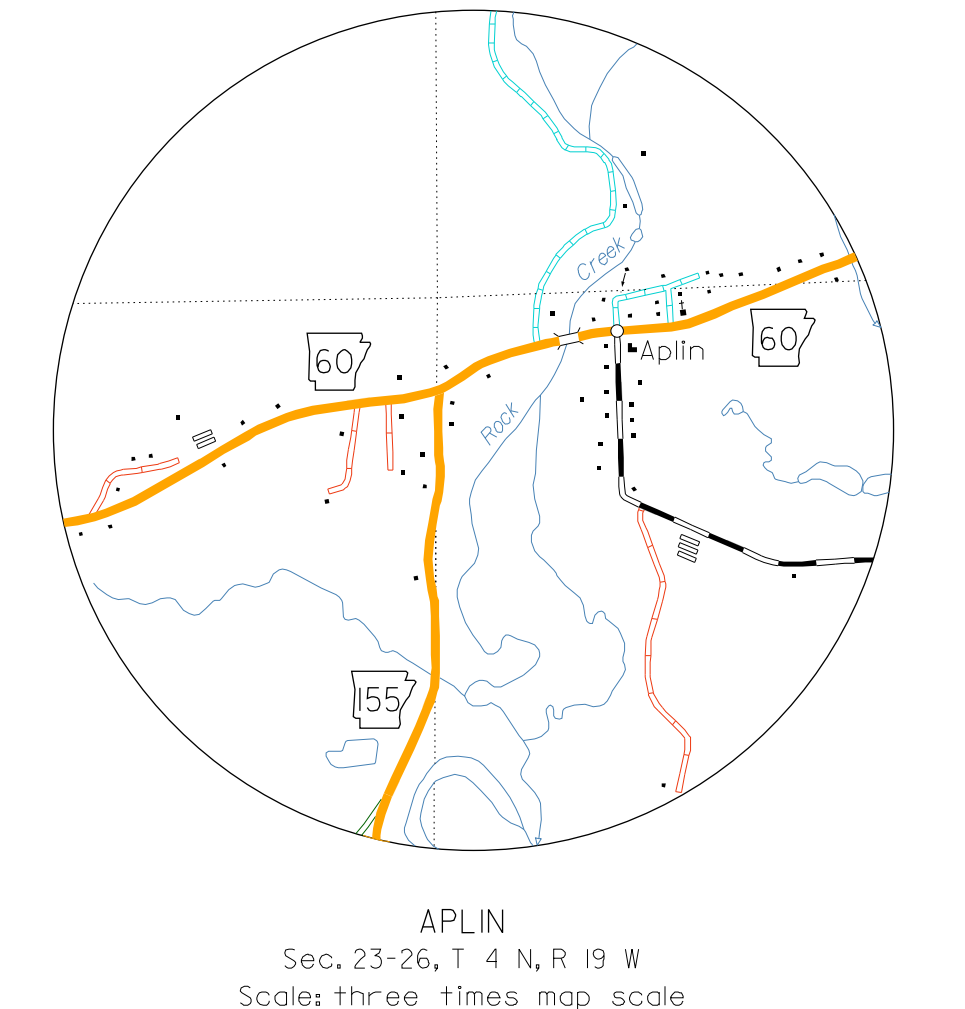

NOTE: Enlargements of all congested areas are five times map scale unless otherwise noted.
Individual maps are available for all active incorporated cities.
Area: 565 Square Miles
Population: 120,000 2000 Census
Map issued: 10/28/1998; revised map issued: 11/30/95
Field Inventory: 1979
Map revisions made from aerial photographs taken 1/24/98
Map completion completed: 11/9/99
County map produced using Computer Assisted Cartography.
Map Revised: 01-04-2008, re-creation of part of SALINE, Section 1, 2, 3, 4, 5, 6, 7, 8, 9, 10, 11, 12, 13, 14, 15, 16, 17, 18, 19, 20, 21, 22, 23, 24, 25, 26, 27, 28, 29, 30, 31, 32, 33, 34, 35, 36, 37, 38, 39, 40, 41, 42, 43, 44, 45, 46, 47, 48, 49, 50, 51, 52, 53, 54, 55, 56, 57, 58, 59, 60, 61, 62, 63, 64, 65, 66, 67, 68, 69, 70, 71, 72, 73, 74, 75, 76, 77, 78, 79, 80, 81, 82, 83, 84, 85, 86, 87, 88, 89, 90, 91, 92, 93, 94, 95, 96, 97, 98, 99, 100.

GENERAL HIGHWAY MAP
PERRY COUNTY
ARKANSAS

PREPARED BY
ARKANSAS STATE HIGHWAY AND TRANSPORTATION DEPARTMENT
PLANNING AND RESEARCH DIVISION
IN COOPERATION WITH
U.S. DEPARTMENT OF TRANSPORTATION
FEDERAL HIGHWAY ADMINISTRATION
SCALE: 1:62,500
MILES

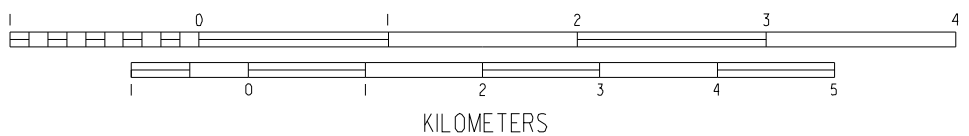

Copies of this map are available at a nominal fee from the Arkansas State Highway and Transportation Department, P.O. Box 2261 Little Rock, Ark. 72203

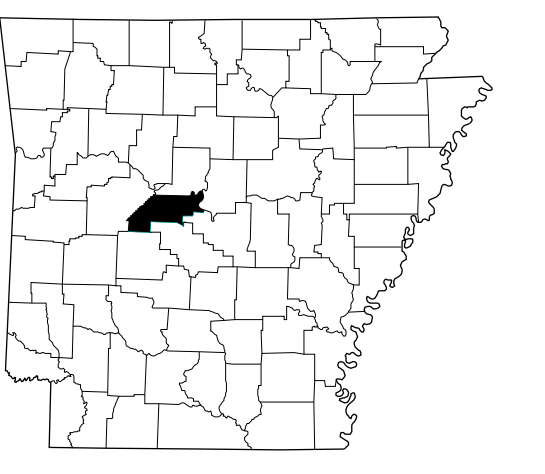

Polyconic Projection-North American Datum