

200124

- COPY. W. SHPO. SIGNATURE -

Form 100-10-100 (Rev. 10-74)

UNITED STATES DEPARTMENT OF THE INTERIOR
NATIONAL PARK SERVICE

FOR NPS USE ONLY
RECEIVED
DATE ENTERED

NATIONAL REGISTER OF HISTORIC PLACES INVENTORY -- NOMINATION FORM

SEE INSTRUCTIONS IN HOW TO COMPLETE NATIONAL REGISTER FORMS
TYPE ALL ENTRIES -- COMPLETE APPLICABLE SECTIONS

NAME

HISTORIC SYCAMORE HISTORIC DISTRICT

AND/OR COMMON

LOCATION

Most of Main and Sononauk streets from the northern to the southern city limits and immediately adjacent areas.

STREET & NUMBER

NOT FOR PUBLICATION
CONGRESSIONAL DISTRICT

CITY, TOWN

Sycamore

VICINITY OF

STATE

Illinois

CODE

COUNTY
DeKalb

CODE

CLASSIFICATION

CATEGORY	OWNERSHIP	STATUS	PRESENT USE
<input checked="" type="checkbox"/> DISTRICT	<input type="checkbox"/> PUBLIC	<input type="checkbox"/> OCCUPIED	<input type="checkbox"/> AGRICULTURE
<input type="checkbox"/> BUILDING(S)	<input type="checkbox"/> PRIVATE	<input type="checkbox"/> UNOCCUPIED	<input checked="" type="checkbox"/> COMMERCIAL
<input type="checkbox"/> STRUCTURE	<input type="checkbox"/> BOTH	<input type="checkbox"/> WORK IN PROGRESS	<input type="checkbox"/> EDUCATIONAL
<input type="checkbox"/> SITE	<input checked="" type="checkbox"/> PUBLIC ACQUISITION	<input checked="" type="checkbox"/> ACCESSIBLE	<input type="checkbox"/> ENTERTAINMENT
<input type="checkbox"/> OBJECT	<input type="checkbox"/> IN PROCESS	<input type="checkbox"/> YES, RESTRICTED	<input checked="" type="checkbox"/> GOVERNMENT
	<input type="checkbox"/> BEING CONSIDERED	<input type="checkbox"/> YES, UNRESTRICTED	<input type="checkbox"/> INDUSTRIAL
		<input type="checkbox"/> NO	<input type="checkbox"/> MILITARY
			<input type="checkbox"/> MUSEUM
			<input type="checkbox"/> PARK
			<input checked="" type="checkbox"/> PRIVATE RESIDENCE
			<input checked="" type="checkbox"/> RELIGIOUS
			<input type="checkbox"/> SCIENTIFIC
			<input type="checkbox"/> TRANSPORTATION
			<input type="checkbox"/> OTHER:

OWNER OF PROPERTY

NAME

STREET & NUMBER

CITY, TOWN

VICINITY OF

STATE

LOCATION OF LEGAL DESCRIPTION

COURTHOUSE, REGISTRY OF DEEDS, ETC. De Kalb County Courthouse

STREET & NUMBER Main and State Streets

CITY, TOWN

Sycamore

STATE
Illinois

REPRESENTATION IN EXISTING SURVEYS

TITLE Illinois Historic Structures Survey, October 1973
Illinois Historic Landmarks Survey, April 1974

DATE

FEDERAL STATE COUNTY LOCAL

DEPOSITORY FOR SURVEY RECORDS Illinois Department of Conservation

CITY, TOWN

Springfield

STATE
Illinois

DESCRIPTION

CONDITION		CHECK ONE	CHECK ONE
<input type="checkbox"/> EXCELLENT	<input type="checkbox"/> DETERIORATED	<input type="checkbox"/> UNALTERED	<input type="checkbox"/> ORIGINAL SITE
<input checked="" type="checkbox"/> GOOD	<input type="checkbox"/> RUINS	<input type="checkbox"/> ALTERED	<input type="checkbox"/> MOVED DATE _____
<input type="checkbox"/> FAIR	<input type="checkbox"/> UNEXPOSED		

DESCRIBE THE PRESENT AND ORIGINAL (IF KNOWN) PHYSICAL APPEARANCE

The town of Sycamore (1970 pop. approx. 7,000), seat of De Kalb County, lies on the south bank of the East Branch of the South Branch of the Kishwaukee River, about 35 miles SE of Rockford and 55 WNW of Chicago. The town and surrounding area are characterized by gently undulating terrain and rich, productive soil and were originally well-forested. There are no prominent topographical features.

The Sycamore Historic District is a relatively narrow strip along the town's north-south axis and is generally confined to Main and Somonauk, the town's most prestigious streets, and immediately adjacent areas. The actual boundary (v. Item 10) was determined on the basis of visual cohesion and circumscribes the maximum extent of a largely homogeneous area of substantial older architecture. The short northern and southern boundaries are determined mainly by the proximity of the corporate limits and the virtual lack of significant older construction beyond. The eastern boundary excludes areas of little architectural merit northeast of State and Main and east of Main and/or Somonauk south of Elm as well as areas of new construction at the northeast corner of Main and Elm and southeast of Somonauk and Lincoln. The tract northwest of State and Maple, excepting an older section of the central business district on State, is likewise of little architectural interest and has been excluded. South of State, the western boundary reflects the industrial development of Park, the affect of this on areas immediately adjacent, and widespread redevelopment northwest of High and California. Many boundary irregularities on the west are a direct result of irregular-sized lots on Somonauk and California.

Land use within the historic district conforms to the norm of small Illinois county seats, with governmental and commercial uses concentrated together (in Sycamore, on State) and surrounded by residential neighborhoods. The only major exception is the location of a relatively large hospital at Somonauk and Edward in an otherwise residential area. There are no industrial usages in the district, little vacant land, and the only Federal property seems to be the United States Post Office at State and Main. Religious, cultural, and social uses are scattered throughout the district.

Since almost all residential structures are single-family and detached, residential density in the district is quite moderate. What little variation there is is a direct result of lot size, particularly the two very large lots on N. Main. Construction is almost equally divided between masonry and frame and the vast majority of structures are two or 2½ stories in height. Most residences are sited on the north-south streets and setbacks from the streetline are generous throughout, particularly so on N. Main and parts of Somonauk. All of these factors combine with many mature shade trees to produce a well-balanced streetscape marked by strong relationships between individual buildings. The commercial area of the district - primarily State street from Main to just west of Somonauk - presents a closed, nearly gap-free wall three stories in height.

Sycamore's street pattern is a typical imperfectly expressed rectangular grid, though not strictly oriented along major compass points as it is in most of Illinois. The heaviest traffic is encountered on State street and Main street north of State, with considerably less volume on Elm and Somonauk. Transportation is entirely dependent upon the private automobile.

Of approximately 209 structures encompassed within the Sycamore Historic District, excluding garages and other minor outbuildings, 40 have been evaluated as possessing special architectural and/or historical significance contributing strongly to the character of the district and an additional 18 were photographed by the Illinois Historic Structures Survey. Most of the remaining older structures are of the period 1860-1900 and constitute good background of some distinction. Several, in fact, have been

NATIONAL REGISTER OF HISTORIC PLACES
INVENTORY - NOMINATION FORM

(Continuation Sheet)

STATE	
COUNTY	
FOR NPS USE ONLY	
ENTRY NUMBER	DATE

(Number all entries)

ITEM 7 - DESCRIPTION - Page Two

unsuitably altered with siding and could, if this were properly removed, contribute strongly to the district. Recent construction accounts for 22 structures or somewhat over 10% of those extant. Of these, the only ones that constitute major intrusions are the hospital at Somonauk and Edward, a gas station at State and Main, a store at Elm and Somonauk, a small apartment building at 313 Somonauk, and an undistinguished residence at 408 Somonauk.

The oldest structures in the district date from well before the Civil War and are Greek Revival in style (v.Nos.8 & 12 below, both somewhat altered). Since a major period of Sycamore's growth occurred shortly after that conflict, the Italianate is present both in quantity and significance (v.Nos.1, 7,14,15,18,19) that make it the district's dominant style. Non-archaeological 19th Century Gothic is also well-represented (v.Nos 4-5,13), as is the Queen Anne (v.Nos.9-10,2-3). Classical Revival forms are found in a number of public and commercial buildings, specifically the Courthouse (v.No.6), Public Library, U.S.Post Office, Sycamore Bank, and the Pierce Building at Somonauk and State. Twentieth Century Medieval Revival occurs as well. Neither of these later styles, however, is much in evidence in residential building, which thus remains dominated by the earlier fashions cited above.

SIGNIFICANCE

PERIOD	AREAS OF SIGNIFICANCE -- CHECK AND JUSTIFY BELOW			
<input type="checkbox"/> PREHISTORIC	<input type="checkbox"/> ARCHEOLOGY-PREHISTORIC	<input type="checkbox"/> COMMUNITY PLANNING	<input type="checkbox"/> LANDSCAPE ARCHITECTURE	<input type="checkbox"/> RELIGION
<input type="checkbox"/> 1400-1499	<input type="checkbox"/> ARCHEOLOGY-HISTORIC	<input type="checkbox"/> CONSERVATION	<input type="checkbox"/> LAW	<input type="checkbox"/> SCIENCE
<input type="checkbox"/> 1500-1599	<input type="checkbox"/> AGRICULTURE	<input type="checkbox"/> ECONOMICS	<input type="checkbox"/> LITERATURE	<input type="checkbox"/> SCULPTURE
<input type="checkbox"/> 1600-1699	<input checked="" type="checkbox"/> ARCHITECTURE	<input type="checkbox"/> EDUCATION	<input type="checkbox"/> MILITARY	<input type="checkbox"/> SOCIAL/HUMANITARIAN
<input type="checkbox"/> 1700-1799	<input type="checkbox"/> ART	<input type="checkbox"/> ENGINEERING	<input type="checkbox"/> MUSIC	<input type="checkbox"/> THEATER
<input checked="" type="checkbox"/> 1800-1899	<input type="checkbox"/> COMMERCE	<input type="checkbox"/> EXPLORATION/SETTLEMENT	<input type="checkbox"/> PHILOSOPHY	<input type="checkbox"/> TRANSPORTATION
<input checked="" type="checkbox"/> 1900-	<input type="checkbox"/> COMMUNICATIONS	<input type="checkbox"/> INDUSTRY	<input type="checkbox"/> POLITICS/GOVERNMENT	<input type="checkbox"/> OTHER (SPECIFY)
		<input type="checkbox"/> INVENTION		

SPECIFIC DATES

BUILDER/ARCHITECT

STATEMENT OF SIGNIFICANCE

Sycamore is one of a group of small Illinois county seats that have survived the vicissitudes of the 20th Century with both the fabric and the sense of their earlier history virtually intact. The courthouse, a central commercial district, and some fine residential areas are still in essence what they were shortly after our century began.

Beyond this, however, Sycamore also conveys a gracious calm very close to the popular American image of the ideal small town, particularly on Somonauk and Main streets. This is in no small part due to the architectural merits of the individual buildings - fine examples of the Italianate (Nos. 1, 7, 14-15, 18-19) and the Queen Anne (Nos. 2-3, 9-10) styles but is even more a result of the total ensemble. In this, substantial old houses, their relationships one to the other and to the whole, trees, quiet streets and excellent churches (v. Nos. 4-5) work in concert to create that feeling of beautiful calm, but punctuated by the outstanding individuals as by exclamation points.

HISTORY

Despite some early skirmishing concerning the permanent location of the county seat, Sycamore's history is one of orderly settlement, growth and development that verges on the purely uneventful. The first settlers arrived in 1835 and located mainly north of the Kishwaukee River -- and of the present town -- on land laid out as a town the following year by a wealthy New Yorker, Christian Sharer, and his associates. Despite the damming of the Kishwaukee and erection of a mill, this town did not succeed and in 1837, after the first county seat contest had been settled in favor of Orange (Sycamore's original name), it was removed to its present site and laid out by Evans Wharry and James Waterman. This new town's actual first settler, Carlos Lattin, had in fact preceded it, taking possession of a claim that included present Sycamore's west side in 1835.

A second county seat controversy was settled in Sycamore's favor in 1839, a year that also marked construction of the first courthouse and the village's first hotel. By 1840, the town consisted of 12 houses, a number that grew to 18 by 1844. After that, growth seems to have begun a steady increase, the population rising to 262 in 1848, 320 in 1849, 390 in 1850 and 435 in 1851. Though school was held in the courthouse as early as 1839, the first public schoolhouse was not built until 1853. By 1855, the now considerable town boasted 41 commercial and industrial establishments, ranging from shoe shops to a shingle manufactory. The Sycamore and Cortland Railroad, built in 1859, was financed by local subscription and began to have a salutary affect on the town's growth shortly after the Civil War. Sycamore was incorporated as a village in 1858 and organized as a city in 1869.

Sycamore is not now nor has it ever been a manufacturing center of any great significance, but has long had an adequate industrial base. Its early industries included the Marsh Harvester Manufacturing Co. (1869), the R. Ellwood Manufacturing Co.

NATIONAL REGISTER OF HISTORIC PLACES
INVENTORY - NOMINATION FORM

(Continuation Sheet)

STATE	
COUNTY	
FOR NPS USE ONLY	
ENTRY NUMBER	DATE

(Number all entries)

ITEM 8 - SIGNIFICANCE - Page Two

(1875, removed to the City of De Kalb in 1891), and the Sycamore Preserve Works (1881). Later concerns have included the F.C.Patten Manufacturing Co., the Hardware Supply Factory, Borden's Condensed Milk Factory, and the Turner Brass Works. Though not unusually extensive, this industrial growth - together with the town's continuing importance as a commercial and governmental center - was certainly a factor in pushing the population to 3,030 in 1880 and 3,300 in 1900, the latter being the high-water mark only recently surpassed.

Sycamore has been somewhat overshadowed by its larger neighbor, the City of De Kalb, since the later part of the 19th Century and certainly since the establishment of Northern Illinois University there in 1899. In recent years, both municipalities have experienced considerable growth - Sycamore's no doubt partially dependent on De Kalb's - and, with very little open land separating them along Illinois Route 23 (Sycamore's De Kalb Avenue), they are now close to having grown together. This development has pushed Sycamore's population over 7,000 and occasioned considerable new construction. But most of this has occurred on the fringes and the older part of the city - almost all of which achieved residential maturity before 1900 - has been largely unaffected.

SITES AND STRUCTURES OF SPECIAL SIGNIFICANCE

Numbers refer to the accompanying map. When more than one area of significance applies, the greater is cited first.

1. GEORGE P. WILD RESIDENCE

450 Somonauk

Built in 1869 by architect George or J.W. Ackermann of Chicago

G.P. Wild was one of the most successful and prominent of the early businessmen in Sycamore. He came to the fledgling town in 1857 and was a principal in the successive firms of Rogers, Wild and Smith, Rogers and Wild, and G.P. Wild & Co., dry-goods merchants. Later, he was interested in the banking house of Daniel Pierce and Co. and in the Pierce Trust and Savings Bank.

ARCHITECTURAL AND HISTORICAL SIGNIFICANCE

2. J.H. ROGERS RESIDENCE

432 Somonauk

Built before 1892

J.H. Rogers located in Sycamore in 1858 and went on to become one of the city's most respected citizens. He was a dry-goods merchant, starting as an associate of G.P. Wild (see above), but later acting independently. He was also heavily involved with the Sycamore Preserve Works.

ARCHITECTURAL AND HISTORICAL SIGNIFICANCE

3. DAVID A. SYME RESIDENCE

420 Somonauk

Built before 1892

NATIONAL REGISTER OF HISTORIC PLACES
INVENTORY - NOMINATION FORM

(Continuation Sheet)

STATE	
COUNTY	
FOR NPS USE ONLY	
ENTRY NUMBER	DATE

(Number all entries)

ITEM 8 - SIGNIFICANCE - Page Three

3. Cont.

David Alexander Syne, a native of County Antrim, Ireland, arrived in Sycamore in 1868 becoming almost at once a major factor in the town's business life. He dealt in grain, seeds, and agricultural implements and was later extensively interested in real estate, with large holdings in the Sycamore vicinity and the west and northwest. He also served as president of the Sycamore National Bank and of the Bank of West Chicago. His civic service included the city's Mayoralty and the presidencies of the school board and the Sycamore Chautauqua Association.

ARCHITECTURAL AND HISTORICAL SIGNIFICANCE

4. FIRST CONGREGATIONAL CHURCH (Now: Church of Latter Day Saints)

Southeast corner High and Somonauk
Built in 1884 by architect G.O. Carnsey

ARCHITECTURAL SIGNIFICANCE

5. ST. PETER'S EPISCOPAL CHURCH

206 Somonauk
Built in 1877

The congregation was organized in 1857.

ARCHITECTURAL SIGNIFICANCE

6. DE KALB COUNTY COURTHOUSE

Northwest corner State and Main
Built in 1903 by architects Watson and Hazleton

ARCHITECTURAL SIGNIFICANCE

7. PETER JOHNSEN RESIDENCE AND ROOMING HOUSE

127 South Main
Built in 1862

Built as a rooming house, it was in use as such until very recently, when it was divided into apartments. Little is known about Mr. Johnsen.

ARCHITECTURAL AND HISTORICAL SIGNIFICANCE

8. CARLOS LATTIN HOUSE

305 Somonauk
Built ca. 1855; since stuccoed

Carlos Lattin was the first settler on the site of Sycamore and is generally recognized as the city's founder. He arrived in 1835 and located on what is now Main street, removing to a house on High street in 1849. Carlos Lattin was also an important factor in retaining the county seat in Sycamore, thus not only founding the town but providing it with its raison d'etre as well.

HISTORICAL AND ARCHITECTURAL SIGNIFICANCE

NATIONAL REGISTER OF HISTORIC PLACES
INVENTORY - NOMINATION FORM

(Continuation Sheet)

STATE	
COUNTY	
FOR NPS USE ONLY	
ENTRY NUMBER	DATE

(Number all entries)

ITEM 9 - SIGNIFICANCE - Page Four

9. FREDERICK B. TOWNSEND HOUSE

331 N. Main

Built before 1892

F.B. Townsend, a scion of one of DeKalb County's best-known families, was associated for most of his life with the banking house of Daniel Pierce and Co. and its successor firm, the Pierce Trust and Savings Bank. Beyond this, however, he managed extensive agricultural property of the Townsend and Pierce estates, including 25 farms in De Kalb Co., 5,000 acres in Iowa and large tracts along the Red River of the North. His civic service included five terms as alderman (1889-93), and three as Mayor (1894-98). He was also a presidential elector on the Cleveland ticket in 1892.

HISTORICAL AND ARCHITECTURAL SIGNIFICANCE

10. CHARLES C. BOYNTON HOUSE AND STABLE

307 N. Main

Built ca. 1885

C.O. Boynton was one of Sycamore's wealthiest and most prominent citizens. He emigrated to Chicago from New York state in 1847, continuing on to Sycamore and opening a general store there in 1849. During the 1850's and 1860's, he was in business as a money-lender, accumulating considerable wealth. He was briefly associated in the banking house of Divine and Boynton (1871-2) and then turned his attention to land speculation. His immense holdings included 6,000 acres of timber in Arkansas; 15,000 acres in Iowa, Minnesota, Kansas and North and South Dakota; and 2,000 acres in northern Illinois. His wife, Lucetta, was prominent in the D.A.R. and was well-known as a world traveller. Their daughter was married to F.B. Townsend (v.No.9). The house is still in the Boynton family.

HISTORICAL AND ARCHITECTURAL SIGNIFICANCE

11. ABRAM ELLWOOD HOUSE

421 Somonauk

Built ca. 1877-80

The Ellwood name has figured prominently in the history of De Kalb Co. since Reuben Ellwood, Abram's father, entered his original claim near Sycamore in 1837. Abram Ellwood was at first engaged in railroading but achieved far greater prominence after joining his father and uncle (Alonzo Ellwood) in the R. Ellwood Manufacturing Co. in 1877. From 1880 until 1884, he maintained an independent firm engaged in the manufacture of wire fence stretchers, that firm having become amalgamated with his father's company in the latter year. (N.B. - The Ellwood's were very prominent in the early development of barbed wire, the most important work being accomplished by the branch of the family located in the City of De Kalb). After the senior Ellwood's death in 1885, the firm was re-named the Abram Ellwood Co., continuing its key role in Sycamore's

NATIONAL REGISTER OF HISTORIC PLACES
INVENTORY - NOMINATION FORM

(Continuation Sheet)

STATE	
COUNTY	
FOR NPS USE ONLY	
ENTRY NUMBER	DATE

(Number all entries.)

ITEM 8 - SIGNIFICANCE - Page Five

11. Cont.

economy until it was induced to relocate in the City of De Kalb in 1891. Abram Elwood's civic service included terms as Alderman and Mayor.

HISTORICAL SIGNIFICANCE

12. WILLIAM OR ELIZY YOUNG HOUSE

612 S.Main
Built ca.1847-51

Little is known of the Youngs. A later resident of the house was George Stewart Robinson, one of Sycamore's most prominent attorneys. Robinson emigrated from Georgia in 1866 and was engaged in private legal practice until 1877 when he was elected county judge. He served in this capacity until 1882. Judge Robinson also served under Governors Palmer, Beveridge and Cullom as a member of the Board of State Commissioners of Public Charities (1869-84), nine of those years as its president. His services to Sycamore included those of Alderman and City Attorney.

HISTORICAL AND ARCHITECTURAL SIGNIFICANCE

13. CAPT.R.A.SMITH (F.W.PARTRIDGE) HOUSE

230 Somonauk
Built before 1871 by Capt.Smith

Other than that he was elected treasurer of De Kalb Co. in 1865, little is known about Capt.Smith. F.W.Partridge began his legal career as a lawyer in Sandwich (Ill.) and later attained considerable fame in that profession in Sycamore. He was a breveted brigadier general in the Civil War and then served as De Kalb Co.Circuit Clerk and Recorder (1864-7). His most prominent governmental service was as Ambassador to Siam under President Grant.

HISTORICAL SIGNIFICANCE

14. DR.ORLANDO M.BRYAN HOUSE

319 Somonauk
Built ca.1866; since modified

Dr.Bryan began the practice of medicine in Sycamore in 1846 and was the settlement's pioneer physician. During the Civil War, he was in charge of the General Hospital of the Army of the Mississippi and later, at his request, was made Medical Director and Purveyor of the Department of New Mexico. He returned to Sycamore in 1866.

HISTORICAL AND ARCHITECTURAL SIGNIFICANCE

15. DAVID DE GRAFF HOUSE

925 Somonauk
Built in 1867

Mr.De Graff was a wealthy farmer.

ARCHITECTURAL SIGNIFICANCE

NATIONAL REGISTER OF HISTORIC PLACES
INVENTORY - NOMINATION FORM

(Continuation Sheet)

STATE	
COUNTY	
FOR NPS USE ONLY	
ENTRY NUMBER	DATE

(Number all entries)

ITEM 8 - SIGNIFICANCE - Page Six

16. H.C. WHITTEMORE HOUSE
232 South Main
Built between 1867 and 1873

Henry C. Whittemore was brought to Sycamore by his parents in 1848. After serving in the Civil War, he remained in government employ for the purpose of reorganizing the postal service in the South, returning to Sycamore in 1867. He was at first engaged in the operation of a tannery but in 1873 turned his attention to the hardware business. He remained in this line for most of his life, having had several partners in succession. He served as an Alderman and as a member of the county Board of Supervisors, was a member of the Thirty-Fourth General Assembly of Illinois, and also served as a trustee of the State Home for Juvenile Offenders at Geneva and as chairman of the building committee of the present De Kalb County Courthouse (v.No.6).

HISTORICAL AND ARCHITECTURAL SIGNIFICANCE

17. CHARLES KELLUM HOUSE(S)
608 Somonauk & 132 West Lincoln
Built before 1871; separated into two houses between 1905 & 1929

Charles Kellum was one of the most prominent and respected members of the legal profession in Sycamore. He served in numerous public offices and capacities.

HISTORICAL SIGNIFICANCE

18. RESIDENCE
804 Somonauk

ARCHITECTURAL SIGNIFICANCE

19. RESIDENCE
813 Somonauk
Built ca.1870

ARCHITECTURAL SIGNIFICANCE

20. GENERAL DANIEL DUSTIN HOUSE
423 S. California
Date unknown; house since sided

Daniel Dustin came to Sycamore from his native Vermont via the California gold fields, where he had been both a miner and a medical doctor and had also served in the California state legislature. Upon locating in Sycamore, he was associated with J.E. and Chauncey Elwood in the mercantile business, a career soon interrupted by the Civil War. His war record was long and distinguished, including service as Major in the Eighth Illinois Cavalry at the Battle of Manassas and commanding Colonel of the 2nd Brigade, 3rd Division, 20th Army Corps at the battle for Atlanta and on Gen. Sherman's march to the sea. He was brevetted

NATIONAL REGISTER OF HISTORIC PLACES
INVENTORY - NOMINATION FORM

(Continuation Sheet)

STATE	
COUNTY	
FOR NPS USE ONLY	
ENTRY NUMBER	DATE

(Number all entries)

ITEM 8 - SIGNIFICANCE - Page Seven

20. Cont.

brigadier general 16 March 1865. After the War, he held many elective and appointive public offices, including county clerk, county treasurer, circuit clerk and state treasurer of the United States Treasury at Chicago under President Harrison. He was also president of the board of trustees of the Soldiers and Sailors Home at Quincy (Ill.).

HISTORICAL SIGNIFICANCE

MAJOR BIBLIOGRAPHICAL REFERENCES

Atlas, Louis H., *Atlas and Directory of De Kalb Co.*, 2 vols., Chicago 1907
Brice, Henry L., *History of De Kalb Co.*, Chicago 1908
Holger, G.S., *Map of De Kalb Co.*, Decatur 1960
Portrait and Biographical Album of De Kalb Co., Chicago 1903

GEOGRAPHICAL DATA

ACREAGE OF NOMINATED PROPERTY Approx. 99
 UTM REFERENCES

A	ZONE	EASTING	NORTHING	B	ZONE	EASTING	NORTHING
C				D			

VERBAL BOUNDARY DESCRIPTION

Commencing at the intersection of Main and Page, the boundary extends S on Main to the N line of the Decatur Public Library, E and then S on this and the same property's E line, S and then W on the E and S lines of the United States Post Office to Main, S on Main to Elm, E on Elm to the E line of 119 E.St., S on this to the N line of 219 S. Locust, S on this to Locust, S on Locust to the S line of 130 E.High, W on this to the interior property lines E of Main, S on these to the S line of 112 S.Main, W on this and the interior property lines S of Lincoln to the extension of the interior property

LIST ALL STATES AND COUNTIES FOR PROPERTIES OVERLAPPING STATE OR COUNTY BOUNDARIES

STATE	CODE	COUNTY	CODE
STATE	CODE	COUNTY	CODE

FORM PREPARED BY

NAME TITLE
 Robert Wagner, National Register Assistant

ORGANIZATION
 Illinois Department of Conservation

DATE
 December 13, 1976

STREET & NUMBER
 9640 South Longwood Drive

TELEPHONE
 312-779-2109

CITY OR TOWN
 Chicago

STATE
 Illinois

STATE HISTORIC PRESERVATION OFFICER CERTIFICATION

THE EVALUATED SIGNIFICANCE OF THIS PROPERTY WITHIN THE STATE IS:

NATIONAL ___ STATE ___ LOCAL ___

As the designated State Historic Preservation Officer for the National Historic Preservation Act of 1966 (Public Law 89-665), I hereby nominate this property for inclusion in the National Register and certify that it has been evaluated according to the criteria and procedures set forth by the National Park Service.

STATE HISTORIC PRESERVATION OFFICER SIGNATURE

Jol McDevine

TITLE *Director*

DATE 1-27-77

FOR NPS USE ONLY

I HEREBY CERTIFY THAT THIS PROPERTY IS INCLUDED IN THE NATIONAL REGISTER

DATE

DIRECTOR, OFFICE OF ARCHEOLOGY AND HISTORIC PRESERVATION

ATTEST

DATE

KEEPER OF THE NATIONAL REGISTER

LUCAS

PAGE

SYCAMORE

SYCAMORE

EXCHANGE

STATE

SACRAMENTO

CALIFORNIA

SOMONIAUK

MAPLE

MAIN

LOCUST

ELM

PKG

INT 5

PKG

N

INT 13

DE KALB

HIGH

PKG

INT 5

PKG

N

INT 5

PKG

N

INT 13

PKG

N

INT 5

PKG

N

PKG

N

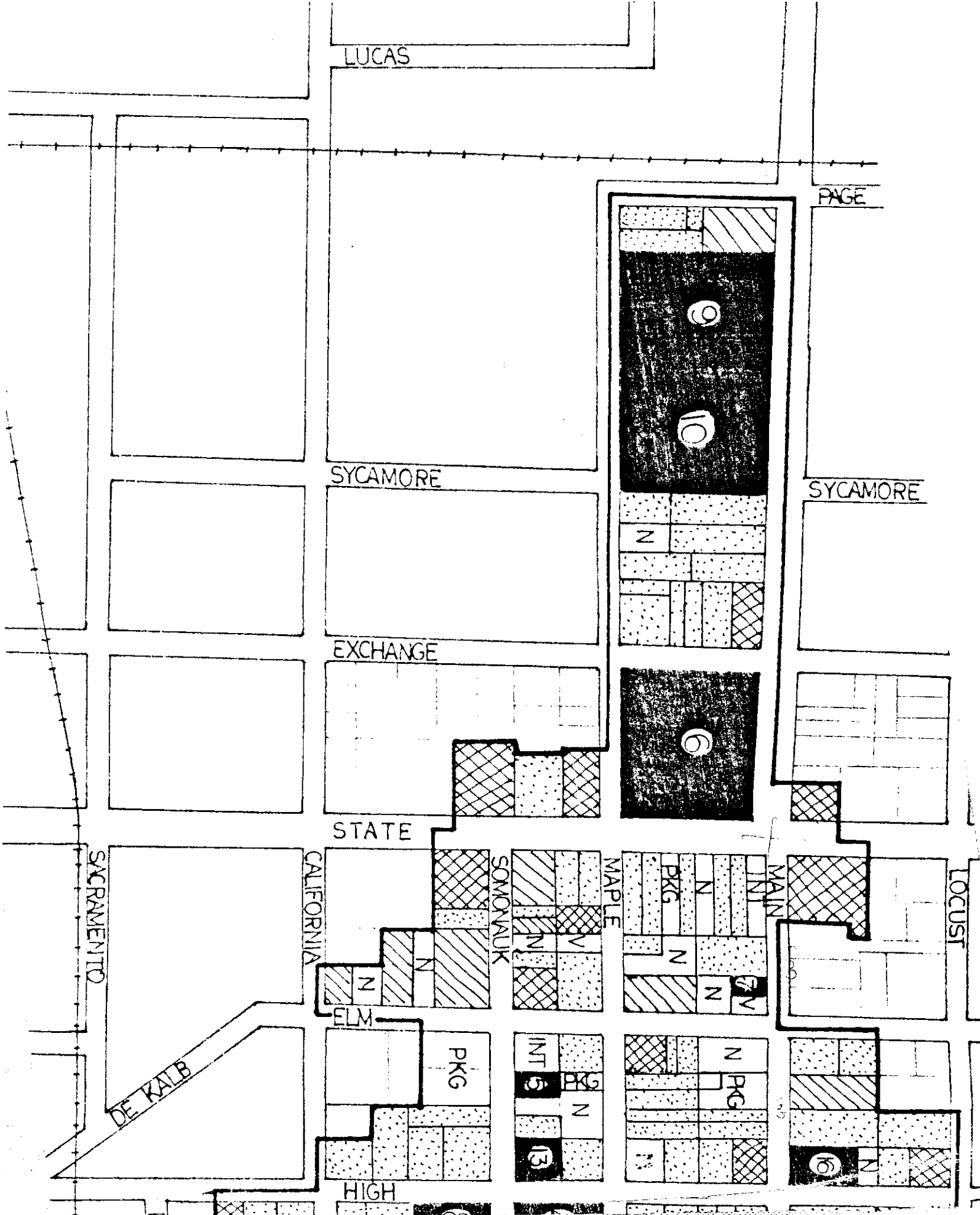

PARK

HIGH

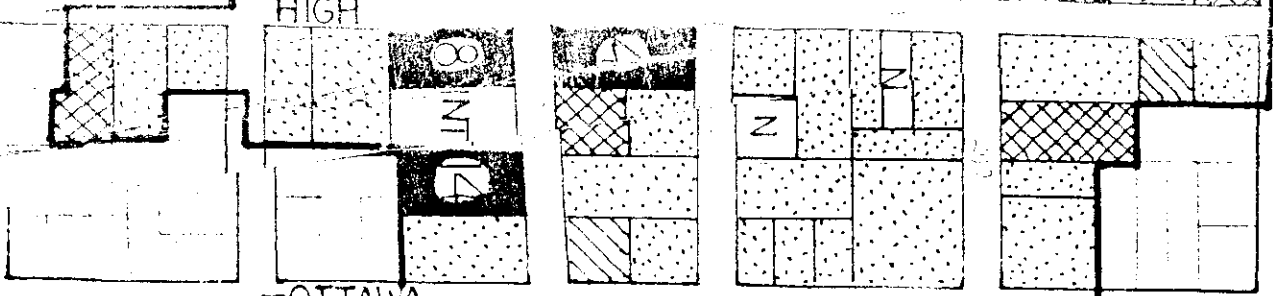

OTTAWA

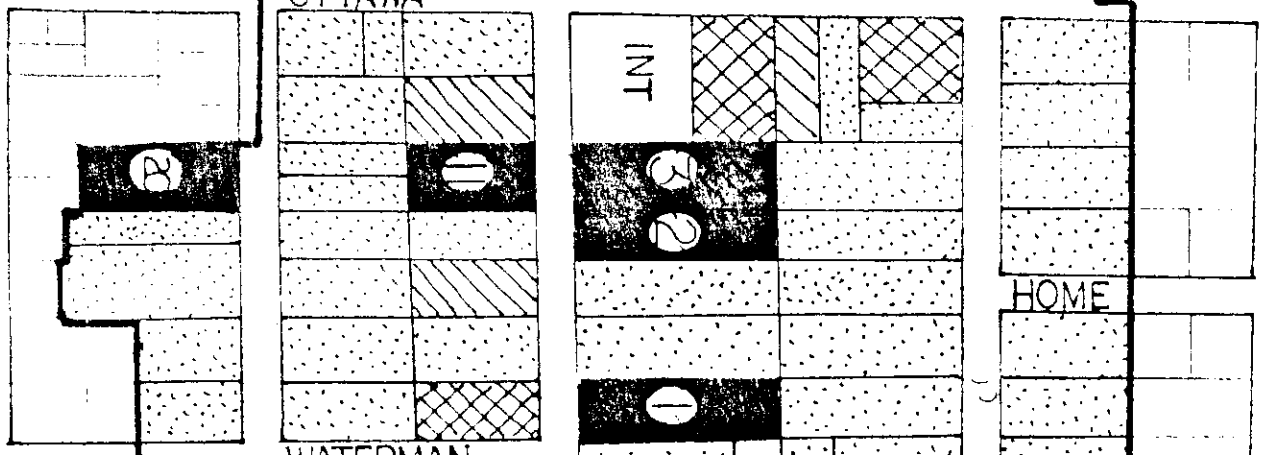

WATERMAN

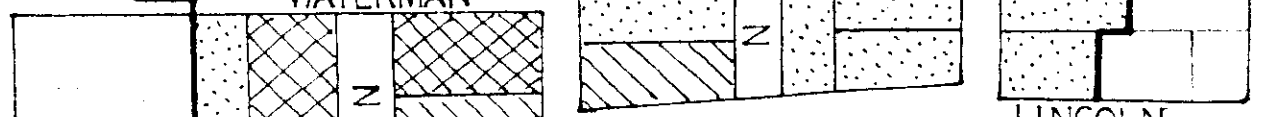

EDWARD

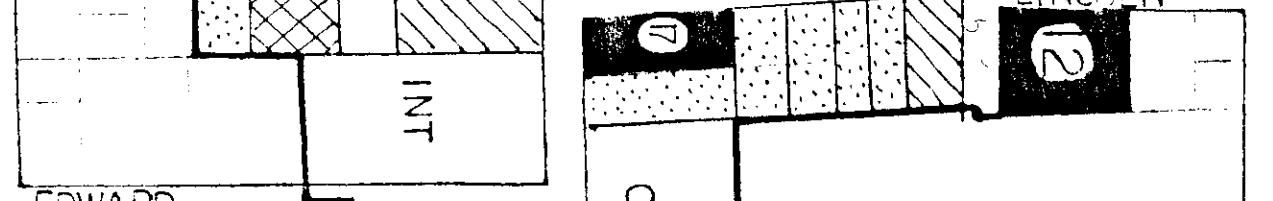

CHARLES

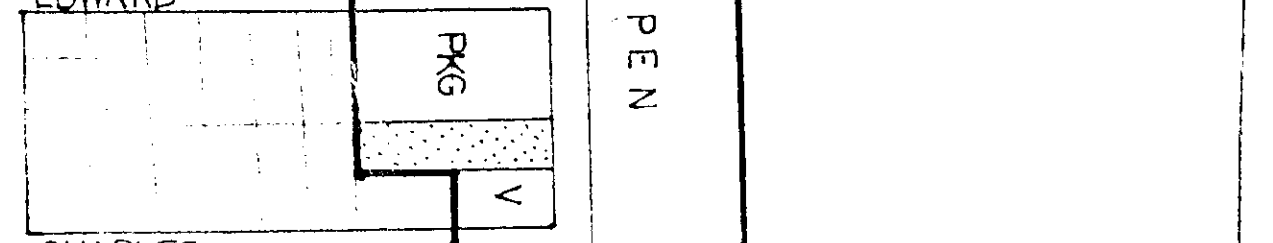

HAUNCY

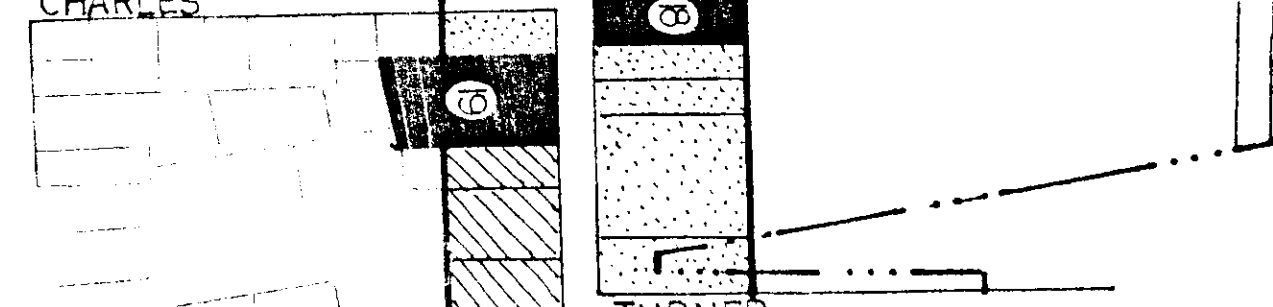

TURNER

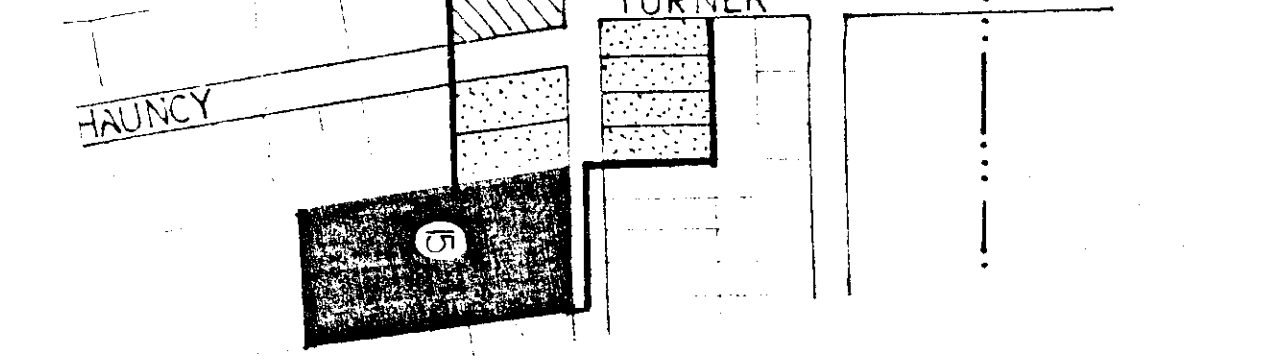

SYCAMORE HIS



STRUCTURES OF SPECIAL IMPORT CITED IN NOMINATION

OTHERS OF SPECIAL IMPORT

FURTHER PHOTOS BY ILL. HIST. STRUCT. SURVEY

OTHER OLD STRUCTURES

NEW CONSTRUCTION(N) ◦ INTRUSIONS (INT) ◦ OR AS INDICATED

