

<b>DE-ICING AREAS</b>	TWR (W)	118.300 MHz	<b>OSLO GARDERMOEN  NORWAY</b>
	TWR (E)	120.100 MHz	
	GND (W)	121.600 MHz	
	GND (E)	121.900 MHz	
	CLR DE-ICING COORDINATOR	121.675 MHz 121.850 MHz	

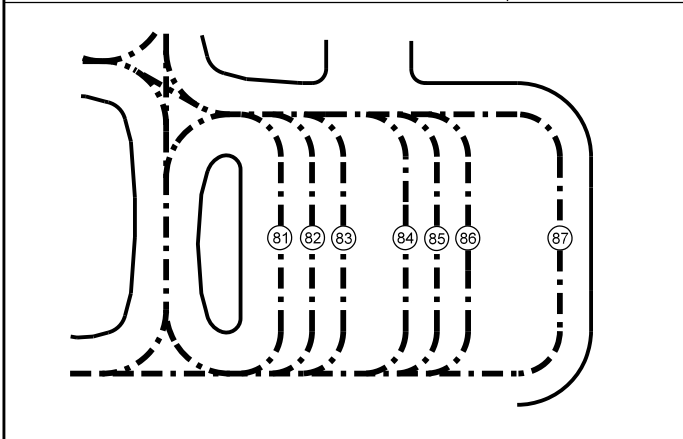
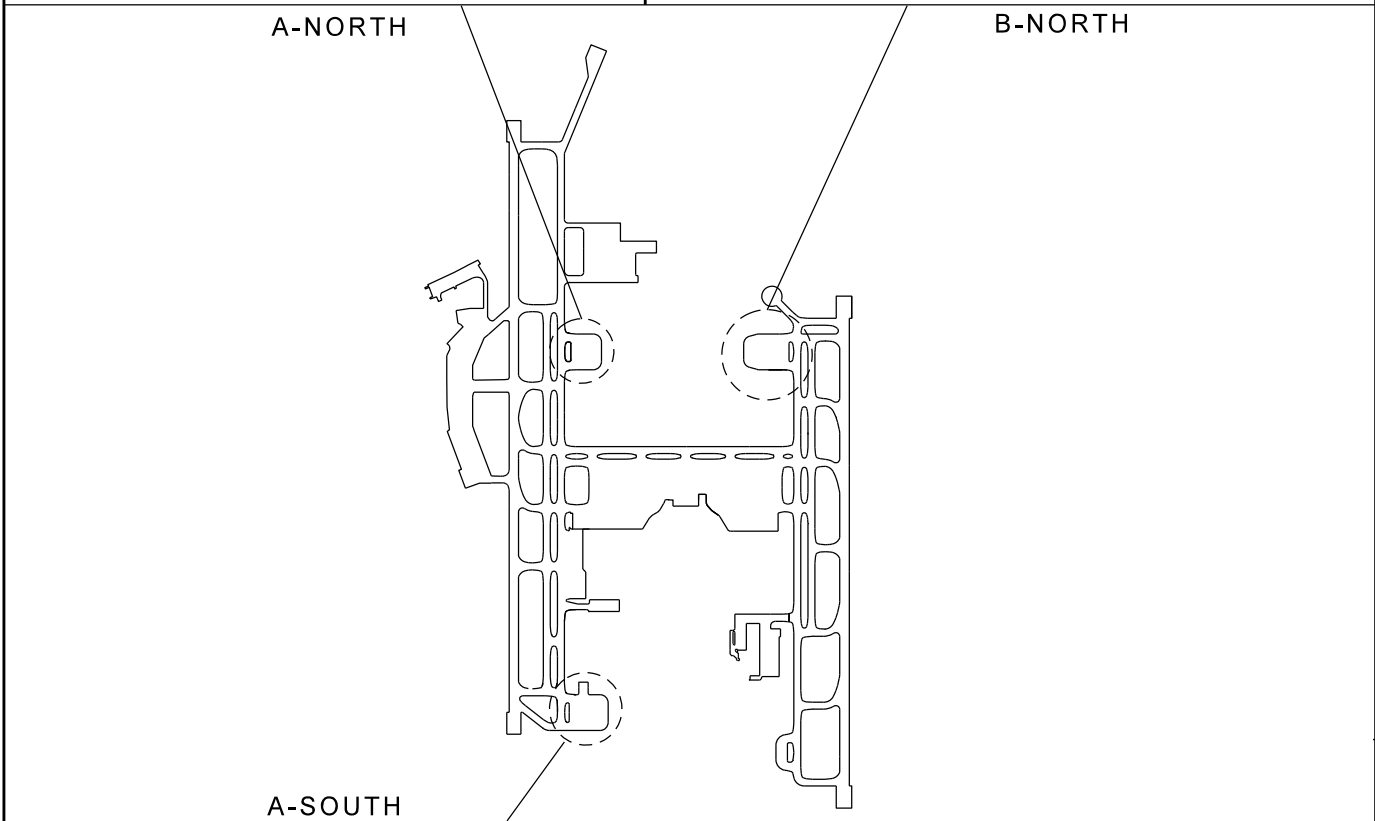
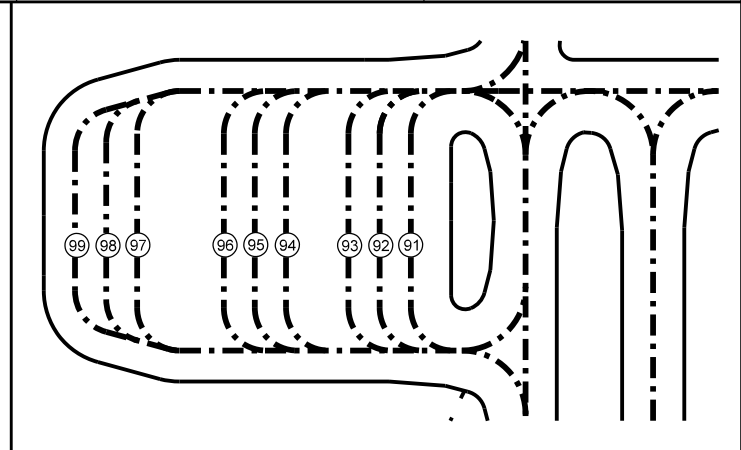
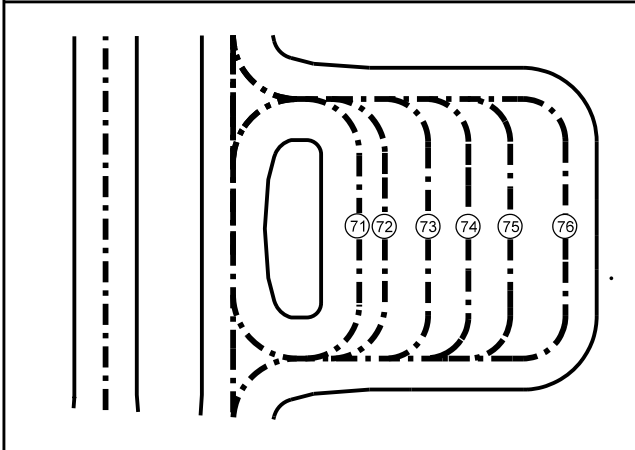

**CHANGES:** NEW FREQUENCIES GND W, GND E AND CLR. PLATFORM BRAVO SOUTH NOT USED FOR DE-ICING

**PROCEDURES FOR ACFT DE-ICING**

REF: AD 2 ENGM 1 - 10  
 CAUTION: AFTER DE-ICING DO NOT MOVE ACFT UNTIL "ALL CLEAR SIGNAL" (THUMBS UP) IS GIVEN FROM GROUND CREW AND TAXI INSTRUCTIONS ARE RECEIVED FROM ATC.  
 LISTENING WATCH ON LAST ASSIGNED ATC FREQ IS TO BE MAINTAINED DURING DE-ICING.