

**United States Department of the Interior  
National Park Service**

**National Register of Historic Places  
Registration Form**

This form is for use in nominating or requesting determinations for individual properties and districts. See instructions in *How to Complete the National Register of Historic Places Registration Form* (National Register Bulletin 16A). Complete each item by marking "x" in the appropriate box or by entering the information requested. If any item does not apply to the property being documented, enter "N/A" for "not applicable". For functions, architectural classification, materials, and areas of significance, enter only categories and subcategories from the instructions. Place additional entries and narrative items on continuation sheets (NPS Form 10-900a). Use a typewriter, word processor, or computer to complete all items.

**1. Name of Property**

Historic name Weyl Service Station  
Other names/site number HK05-040

**2. Location**

Street & number 124 East D St Not for publication   
City or town Trenton Vicinity   
State Nebraska Code NE County Hitchcock Code 087 Zip code 69044

**3. State/Federal Agency Certification**

As the designated authority under the National Historic Preservation Act of 1986, as amended, I hereby certify that this  nomination  request for determination of eligibility meets the documentation standards for registering properties in the National Register of Historic Places and meets the procedural and professional requirements set forth in 36 CFR Part 60. In my opinion, the property  meets  does not meet the National Register Criteria. I recommend that this property be considered significant  nationally  statewide  locally. (See continuation sheet for additional comments.)

/s/ Lawrence Sommer  
Signature of certifying official

5/24/02  
Date

Director, Nebraska State Historical Society  
State or Federal agency and bureau

In my opinion, the property  meets  does not meet the National Register criteria. (See continuation sheet for additional comments.)

\_\_\_\_\_  
Signature of certifying official/Title

\_\_\_\_\_  
Date

\_\_\_\_\_  
State or Federal agency and bureau

**4. National Park Service Certification**

I, hereby, certify that this property is:

- entered in the National Register. \_\_\_\_\_
- see continuation sheet. \_\_\_\_\_
- determined eligible for the National Register. \_\_\_\_\_
- see continuation sheet. \_\_\_\_\_
- determined not eligible for the National Register. \_\_\_\_\_
- removed from the National Register. \_\_\_\_\_
- other, (explain): \_\_\_\_\_

\_\_\_\_\_  
Signature of Keeper

\_\_\_\_\_  
Date of Action

**Weyl Service Station**

Name of Property

**Hitchcock, Nebraska**

County and State

**5. Classification**

**Ownership of Property**

(Check as many boxes as apply)

- Private
- Public-local
- Public-state
- Public-federal

**Category of Property**

(Check only one box)

- Building(s)
- District
- Site
- Structure
- Object

**Number of Resources within Property**

(Do not include previously listed resources in the count.)

Contributing		Noncontributing	
<u>1</u>			Buildings
			Sites
			Structures
			Objects
<u>1</u>			Total

**Name of related multiple property listing**

(Enter "N/A" if property is not part of a multiple property listing.)

N/A

**Number of contributing resources previously listed in the National Register**

0

**6. Function or Use**

**Historic Functions**

(Enter categories from instructions.)

COMMERCE/TRADE

specialty store, filling station

\_\_\_\_\_

\_\_\_\_\_

\_\_\_\_\_

\_\_\_\_\_

\_\_\_\_\_

**Current Functions**

(Enter categories from instructions.)

RECREATION AND CULTURE

museum

\_\_\_\_\_

\_\_\_\_\_

\_\_\_\_\_

\_\_\_\_\_

\_\_\_\_\_

**7. Description**

**Architectural Classification**

(Enter categories from instructions.)

Other: Filling Station – house type with canopy

\_\_\_\_\_

\_\_\_\_\_

\_\_\_\_\_

**Materials**

(Enter categories from instructions.)

Foundation Poured Concrete

Walls Poured concrete and stucco

Roof Asphalt

Other \_\_\_\_\_

\_\_\_\_\_

**Narrative Description**

(Describe the historic and current condition of the property on one or more continuation sheets.)

**Weyl Service Station**

Name of Property

**Hitchcock, Nebraska**

County and State

**8. Statement of Significance**

**Applicable National Register Criteria**

(Mark "X" in one or more boxes for the criteria qualifying the property for National Register listing.)

- A** Property is associated with events that have made a significant contribution to the broad patterns of our history.
- B** Property is associated with the lives of persons significant in our past.
- C** Property embodies the distinctive characteristics of a type, period, or method of construction or represents the work of a master, or possesses high artistic values, or represents a significant and distinguishable entity whose components lack individual distinction.
- D** Property has yielded, or is likely to yield information important in prehistory or history.

**Criteria Considerations**

(Mark "X" in all the boxes that apply.)

Property is:

- A** Owned by a religious institution or used for religious purposes.
- B** Removed from its original location.
- C** A birthplace or a grave.
- D** A cemetery.
- E** A reconstructed building, object, or structure.
- F** A commemorative property.
- G** Less than 50 years of age or achieved significance within the past 50 years.

**Narrative Statement of Significance**

(Explain the significance of the property on one or more continuation sheets.)

**Areas of Significance**

(Enter categories from instructions.)

Commerce

Economics

Architecture

**Period of Significance**

1921 - 1952

**Significant Dates**

1921

**Significant Person**

(Complete if Criterion B is marked above.)

**Cultural Affiliation**

**Architect/Builder**

O. E. Reynolds

**9. Major Bibliographical References**

**Bibliography**

(Cite the books, articles, and other sources used in preparing this form on one or more continuation sheets.)

**Previous documentation on file (NPS):**

- Preliminary determination of individual listing (36 CFR 67) has been requested
- Previously listed in the National Register
- Previously determined eligible by the National Register
- Designated a National Historic Landmark
- Recorded by Historic American Buildings Survey # \_\_\_\_\_
- Recorded by Historic American Engineering Record # \_\_\_\_\_

**Primary location for additional data:**

- State Historic Preservation Office
  - Other State agency
  - Federal agency
  - Local Government
  - University
  - Other Hitchcock County Historical Society, Trenton, Nebraska
- Name of repository: \_\_\_\_\_

**Weyl Service Station**

Name of Property

**Hitchcock, Nebraska**

County and State

**10. Geographical Data****Acreage of property** Less than one acre

UTM References (place additional UTM references on a continuation sheet).

	<b>Zone</b>	<b>Easting</b>	<b>Northing</b>		<b>Zone</b>	<b>Easting</b>	<b>Northing</b>
1.	14	328743	4448981	3.			
2.				4.			
				[ ]	See continuation sheet		

**Verbal Boundary Description**

(Describe the boundaries of the property on a continuation sheet.)

**Boundary Justification**

(Explain why the boundaries were selected on a continuation sheet.)

**11. Form Prepared By**

name/title Stacy Stupka-Burda, National Register Coordinator  
 organization Nebraska State Historical Society date 03/25/02  
 street & number 1500 R Street, PO Box 82554 telephone (402) 471-4770  
 city or town Lincoln state NE zip code 68501-2554

**Additional Documentation**

Submit the following items with the completed form:

**Continuation Sheets****Maps**A **USGS map** (7.5 or 15 minute series) indicating the property's location.A **Sketch map** for historic districts and properties having large acreage or numerous resources.**Photographs**Representative **black and white photographs** of the property.**Additional items**

(Check with the SHPO or FPO for any additional items.)

**Property Owner**

(Complete this item at the request of the SHPO or FPO.)

name/title Hitchcock County Historical Society  
 street & number 313 East 1<sup>st</sup> St, PO Box 511 telephone \_\_\_\_\_  
 city or town Trenton state NE zip code 69044

**Paperwork Reduction Act Statement:** This information is being collected for applications to the National Register of Historic Places to nominate properties for listing or determined eligibility for listing, to list properties, and to amend existing listings. Response to this request is required to obtain a benefit in accordance with the National Historic Preservation Act, as amended, (15 USC 470 et seq.).

**Estimated Burden Statement:** Public reporting burden for this form is estimated to average 18.1 hours per response including the time for reviewing instructions, gathering and maintaining data, and completing and reviewing the form. Direct comments regarding this burden estimate or any aspect of this form to the chief, Administrative Services Division, National Park Service, P.O. Box 37127, Washington, DC 20013-7127; and the Office of Management and Budget, Paperwork Reductions Project (1024-0018), Washington, DC 20503.

United States Department of the Interior  
National Park Service

National Register of Historic Places  
Continuation Sheet

Weyl Service Station

Name of Property

Hitchcock County, Nebraska

County and State

Section 7 Page 1

---

**Description**

The Weyl Service Station is located in the village of Trenton, Nebraska (2000 population, 507). Located in the southwestern portion of the state in Hitchcock County, the region is characterized topographically by dissected plains. Positioned near the center of the county, Trenton is approximately 250 miles southwest of Lincoln, the State Capital, 12 miles north of the Nebraska-Kansas border, and 60 miles east of the Nebraska-Colorado border. The service station is located one block east of the current business district. When constructed in 1921, the Weyl Service Station was positioned on a busy commercial street; however, the character of that street is now residential.

---

The Weyl Service Station (HK05-040) is a small one-story filling station sited diagonally on two commercial lots, positioned to allow access from two directions. The building retains its historic exterior and interior integrity. The interior and exterior of the building reflects a standard filling station type that conveys the significance of the building.

This small house with canopy type filling station exhibits elements of the residential bungalow house type, such as a gable roof with exposed rafters, purlins, and overhanging eaves<sup>1</sup>. The main portion of the building is stuccoed and the gable roof is covered with asphalt shingles. A brick chimney is located along the ridgeline. The foundation is poured concrete. The gasoline pumps are placed under the canopy toward the outside edge of the support pillars. These gasoline pumps, while not original to the station, probably date to the 1940's and were those in use when the filling station ceased operation in 1967. An air stand resting on a poured concrete base is complete with a pressure gauge and housing for the automatic recoil of the tubing. This air pump sits immediately adjacent to the southeastern pillar and when the correct tire pressure was reached, the air stand would ring to alert the attendant.

The front entry door is centered on the front façade, under the canopy. This door is flanked on either side by a double hung, wood sash window. Large three bay windows consisting of three double hung wood sash windows on each of the secondary façades would have provided a good deal of light through the workday.

An addition was made to the rear of this building, and though its construction date is unknown, it was clearly completed shortly after the construction of the primary portion of the filling station. This portion of the station was added to accommodate an interior restroom, and a small workbench. The addition is clad with stucco and matches the initial construction. The roof of this addition is flat, and one small double hung window provides light on the southeastern façade while a second double hung window was placed in the center of the rear façade.

---

<sup>1</sup> John Jakle, "The American Gasoline Station, 1920-1970." *Journal of American Culture* 1 (Fall 1978): 520-542.

United States Department of the Interior  
National Park Service

National Register of Historic Places  
Continuation Sheet

Weyl Service Station

Name of Property

Hitchcock County, Nebraska

County and State

Section 7 Page 2

A second addition was added to the side and the rear of the first addition. This second addition was placed perpendicularly, and extends to the northwest of the building. This shed addition is constructed of wood frame covered by corrugated tin. Access to this shed addition could be gained through the interior, or by a wooden door placed in the addition where the corrugated tin addition meets the original building. An industrial type, steel sash window was placed off center in the northwest façade of this addition. The construction date of this addition is unknown, but is estimated to be in the late 1940's or early 1950's given the window type.

The interior of the Weyl Service Station is intact. In fact, it appears that the operation of filling station could resume with little effort. Upon entering, the customer would see a glass display case, now filled with maps, but presumably could have displayed small parts. Immediately behind the display case is the attendant's desk and work area. A set of locking boxes, built into the underside of the desk, may have held important papers such as customer accounts. The interior walls are painted plaster, and the floor is poured concrete.

As advertised by a sign above the door, the doorway immediately to the left of the attendant's desk leads to the toilet, and also to a small workbench. The small restroom is free standing, and one wainscoted wall also serves as a backdrop for the workbench and storage shelves. The workbench and shelves above hold tools and equipment. A door located a few feet to the right of the workbench accesses the storage area created by the shed addition.

The interior of this filling station contains numerous examples of automotive hardware and equipment, some amassed during the operation of the station, and some donated to the museum that now owns the property. The sights and smells associated with a filling station are still present, ranging from the automotive tools and equipment to the smell of old grease and oil.

United States Department of the Interior  
National Park Service

National Register of Historic Places  
Continuation Sheet

Weyl Service Station

Name of Property

Hitchcock County, Nebraska

County and State

Section 8 Page 1

The Weyl Service Station is locally significant under Criteria A and C, representing an important period of development of the local economy, and the type of gasoline filling station design that evolved during this period and served to replace earlier, curbside gasoline outlets. The building's period of significance begins in 1921, its date of construction, and extends to 1952, fifty years prior to this nomination.

### History

O.E. Reynolds, an early Trenton businessman, constructed the Weyl Service Station in 1921. Mr. Reynolds arrived in the Trenton area in 1884 to take advantage of the need for stores and services.<sup>2</sup> Reynolds established himself as a successful businessman upon his arrival and established a hardware, furniture and undertaking business. Later, he built a grocery and dry goods store, which was operated by his son.<sup>3</sup>

In 1921, Reynolds constructed a small gasoline filling station, the subject of this nomination, on the corner of Washington and Commercial Streets in Trenton, Nebraska (1920 population, 592<sup>4</sup>). This filling station, believed to be the first constructed in the community with the primary intent to deliver gasoline and services, was located along the busy "main street" in Trenton. The trans-regional Golden Rod Highway was located 3 blocks north of the filling station.

On April 22, 1921, the *Trenton Register* described the new filling station and stated "Trenton's new filling station located at the corner of Commercial and Washington Streets is as nifty a little building as can be found in any of the larger towns and cities. It is of stucco and greatly improves the looks of the corner and advertises the progressiveness which exists with the good and better roads movement."<sup>5</sup>

Constructed for Reynolds's grandson Leon "Spin" Weyl to manage, the Weyl Service Station advertised that it was open for business in the April 29, 1921 edition of the *Trenton Register*. "The oil service station, located just east of the Reynolds Hardware Store, is now open for business. Your orders solicited and appreciated. — Leon Weyl, mgr."<sup>6</sup> By July 1 of that year, advertisements in the *Trenton Register* referred to the new filling station as the Weyl Service Station<sup>7</sup> and by August of the same year, advertisements indicated that the filling station was ready to distribute oil to customers.<sup>8</sup> Early advertisements for the filling station indicate that in addition to gasoline and kerosene, the Weyl Service Station also offered tanker service and a limited line of products and service.

<sup>2</sup> *Hitchcock County History 1873-1989* (Dallas, Texas: Curtis Media Corporation, 1990), p. 449.

<sup>3</sup> *Ibid.*

<sup>4</sup> *The Nebraska Blue Book, 1922*. Nebraska Legislative Reference Bureau, Lincoln, Nebraska. December 1922.

<sup>5</sup> *The Trenton Register*, April 22, 1921.

<sup>6</sup> *Ibid.*, April 29, 1921.

<sup>7</sup> *Ibid.*, July 1, 1921.

<sup>8</sup> *Ibid.*, August 26, 1921.

United States Department of the Interior  
National Park Service

National Register of Historic Places  
Continuation Sheet

Weyl Service Station

Name of Property

Hitchcock County, Nebraska

County and State

Section 8 Page 2

O.E. Reynolds died in the fall of 1922<sup>9</sup> at which time ownership of the filling station passed to Mrs. Lena E. Weyl, Reynolds's daughter and the mother of Leon Weyl. Leon Weyl continued to operate the Weyl Service Station until 1925 when he and his wife (who Weyl met when she became a customer of the filling station) moved to a nearby community to construct another filling station.

B.O. Kipp managed the Weyl Service Station following Leon Weyl's tenure, and offered many of the same products and services. Mrs. Weyl sold the station to T. Cloyd and Maria Curran in 1944.<sup>10</sup> The Curran's continued to operate the filling station until 1967.

**Significance**

The Weyl Service Station is significant under Criterion C, displaying distinctive characteristics of a type: the American gasoline station. It reflects the evolution of the gasoline station as the automobile gained dominance and the corresponding market for petroleum products and services grew<sup>11</sup>. The design, form and function of this filling station reflect the important marketing trends of the American gasoline station during the period when most gasoline was distributed from curbside pumps, a secondary service to those already offered. The design of this filling station fits into well-known typology, the house with canopy, as defined by Jakle.<sup>12</sup> Borrowing many design influences from residential construction of the time, this small filling station looked tidy and neat, unlike the earlier curbside services of the community.

The Weyl Service Station was constructed during a period when the automobile was revolutionizing travel much the way the railway had earlier. At a time when much of nation's gasoline was dispensed from curbside pumps outside general stores, O.E. Reynolds and his grandson Leon Weyl were well ahead of the national trend when they constructed a separate facility to market gasoline to the residents of Trenton and the surrounding area. In choosing to construct a filling station that was reflective of a bungalow the most modern building style of the time, Reynolds demonstrated that he understood his customers and his community would appreciate a stylish, yet functional building.

The Weyl Service Station is significant under Criterion A as it reflects the development of separate commercial facilities by which petroleum products and related services were offered to the consumer. This commercial venture, the first of its kind in the community of Trenton, offered the motorist a glimpse of the future of the increasingly prevalent automobile. In addition, the tanker service that delivered petroleum products to residents of Trenton and the surrounding rural countryside played an important role in the local economy.

In advertisements, the Weyl Service Station continually stressed service and its commitment to its customers. This dedication undoubtedly proved itself, when after a flood on the Republican River in 1935, the channel shifted and the new river bridge constructed was a bit further west. This movement of the river bridge helped

<sup>9</sup> *Hitchcock County History 1873-1989* (Dallas, Texas: Curtis Media Corporation, 1990), p. 449.

<sup>10</sup> Warranty Deed, Hitchcock County Nebraska, April 24, 1944.

<sup>11</sup> L. Bob Puschendorf, National Register Nomination for the Gloe Brothers Service Station, 03/17/2000, Section 8, page 3. On file, Nebraska State Historic Preservation Office.

<sup>12</sup> John Jakle, "The American Gasoline Station, 1920-1970." *Journal of American Culture* 1 (Fall 1978): 520-542.



**United States Department of the Interior  
National Park Service**

**National Register of Historic Places  
Continuation Sheet**

**Weyl Service Station**

Name of Property

**Hitchcock County, Nebraska**

County and State

**Section 8 Page 3**

---

facilitate the movement of the Trenton business district one block west to Market Street. As the new business district solidified, the businesses along Commercial Street slowly began to disappear. The Weyl Service Station survived this gradual change, continuing to provide an integral service to the community until 1967.

United States Department of the Interior  
National Park Service

National Register of Historic Places  
Continuation Sheet

**Weyl Service Station**

Name of Property

**Hitchcock County, Nebraska**

County and State

Section 9 Page 1

**Bibliography**

Hitchcock County Historical Society

1990 *History of Hitchcock County, Nebraska 1873-1989*. Curtis Media Corporation, Dallas, Texas.

2002 Unpublished information compiled by the Hitchcock County Historical Society. On file, Hitchcock County Historical Society, Trenton, Nebraska.

Jakle, John A.

1978 "The American Gasoline Station, 1920-1970." *Journal of American Culture* 1 (Fall): 520-542.

Nebraska Legislative Reference Bureau

1922 *The Nebraska Blue Book*. Lincoln, Nebraska December 1922.

Puschendorf, L. Robert

2000 National Register Nomination for the Gloe Brothers Service Station. March 17, 2000, on file, Nebraska State Historic Preservation Office.

*The Trenton Register*. April 22, 1921 – December 23, 1921.

Witzel, Michael Karl

1999 *The American Gas Station History and Folklore of the Gas Station in American Car Culture*. Barnes & Noble, Inc.

**United States Department of the Interior  
National Park Service**

**National Register of Historic Places  
Continuation Sheet**

**Weyl Service Station**

Name of Property

**Hitchcock County, Nebraska**

County and State

**Section 10 Page 1**

**Verbal Boundary Description**

The east 60 feet of lots 1 and 2 in Block 19, original Town of Trenton, Nebraska.

**Boundary Justification**

The nominated property includes the entire parcel historically associated with the Weyl Service Station.

East 'D' Street  
(Washington Street at time station was built)

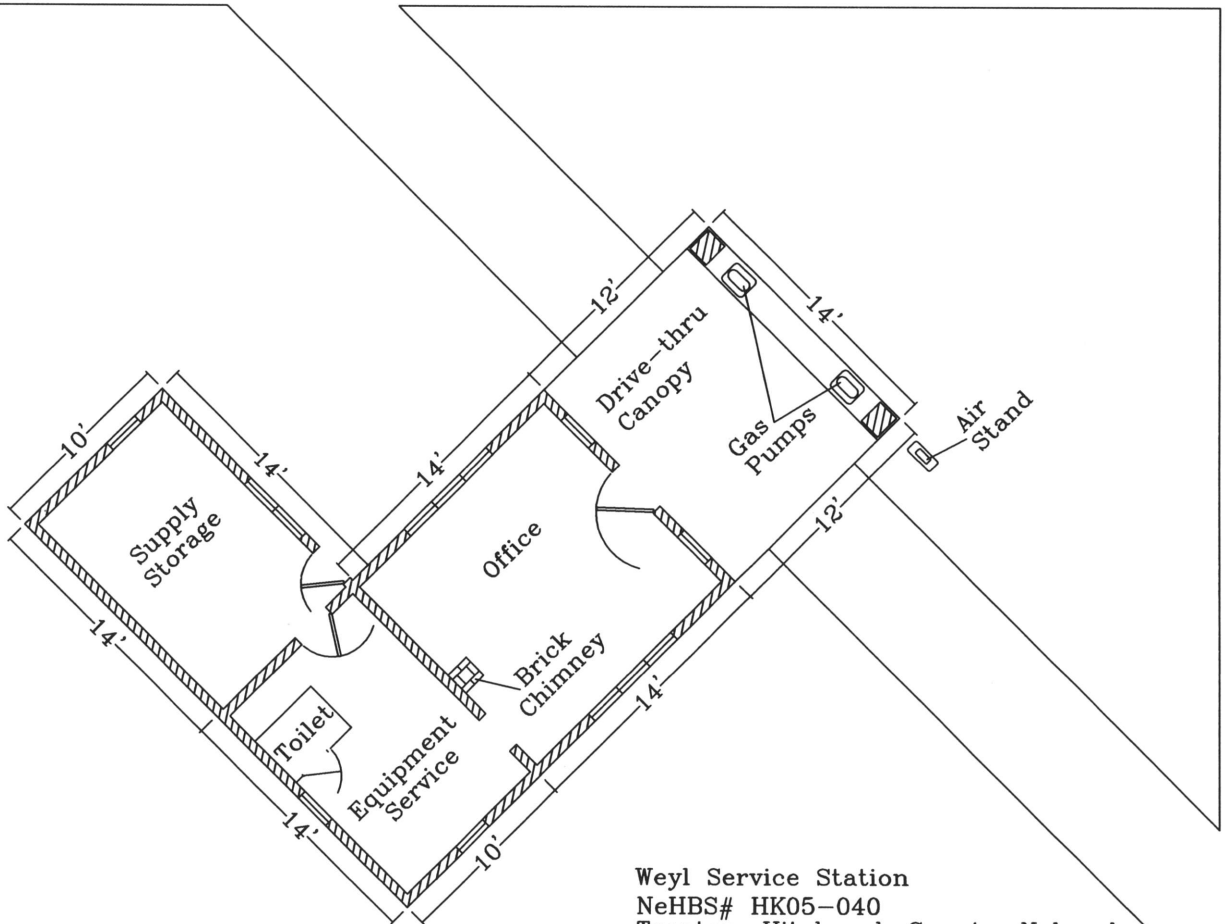

Weyl Service Station  
NeHBS# HK05-040  
Trenton, Hitchcock County, Nebraska

East 1st Street  
(Commercial Street at time station was built)

All photos by Stacy Stupka-Burda, March 2002, original negatives at Nebraska State Historic Preservation Office, Nebraska State Historical Society



View of main façade, looking southwest



View of service station, looking west



View of service station, looking south



View of interior, glass display case at center, looking south



View of attendant's desk, looking southwest



View of work bench, restroom door to left



View of entry door from attendant's desk