

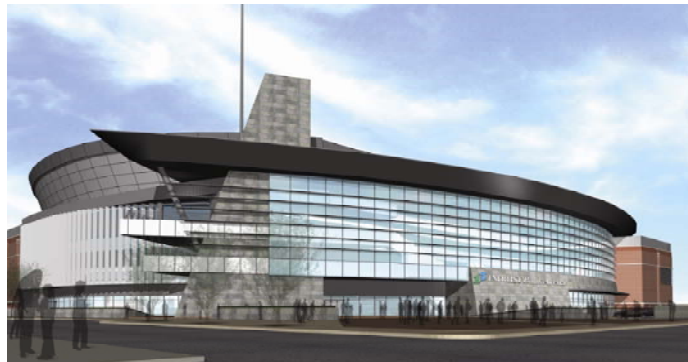

Fire Protection Engineering
Mechanical/Electrical/Plumbing
Engineering
Code Consulting

Sports Facilities



FSC provides professional MEP engineering, Fire Protection, Code Consulting / Life Safety and Sports Lighting design services for the following types of Sports facilities:

- Arenas
- Stadiums
- Training Facilities
- Wellness & Recreation Centers

FSC, Inc.

Corporate Headquarters:

3100 South 24th Street, Suite E
Kansas City, KS 66106 U.S.A.
Tel: (913) 722-3473
Fax: (913) 722-3484

Subsidiaries:

FSC MEP Engineers, LLC

8511 Hillcrest Road, Suite 100
Kansas City, MO 64138 U.S.A.

FSC Bredson, Inc.

8511 Hillcrest Road, Suite 100
Kansas City, MO 64138 U.S.A.

FSC Engineers, Pvt. Ltd.

221 Bisarya Complex
Bhopal - 462011 M.P. India

FSC Consulting Services, Pvt. Ltd.

221 Bisarya Complex
Bhopal - 462011 M.P. India

Web: www.fsc-inc.com



Arenas

INTRUST Sedgwick County Arena Wichita, KS

Fire Protection and Code Consulting services for the new Arena with a 19,700 maximum occupancy and over 420,000 square feet of floor space.

- Part of Design-Build team to prepare detailed design of fire sprinklers including standpipe system and hydraulic calculations.
- Performed performance approaches for smoke exhaust calculations and the omission of fire proofing and sprinklers at the roof of the bowl. Presented code issues to the AHJ.



Pittsburg Arena Pittsburg, PA

Fire Protection and Code Consulting services for the new Arena.

- Fire Protection engineering services including performance specifications for fire sprinklers and standpipe.
- Performed performance approaches for smoke exhaust calculations and the omission of sprinklers at the roof of the bowl. Performed exit studies. Issued Life Safety Drawings. Presented code issues to the Authority Having Jurisdiction.

Sprint Center Kansas City, MO

Fire Protection services for the new Arena included providing review of shop drawings & calculations and QC services for the Design-Build team.



New Orleans Sports Arena

New Orleans, LA

MEP services for the new Arena included: Commissary, Suite's Catering, Kitchen, Restaurant/Bar, Numerous Smaller Stands, Novelty Sales Area and Concessions

Charlotte Arena

Charlotte, N.C.

MEP Construction Administration for the new 18,000 seat NBA Arena.

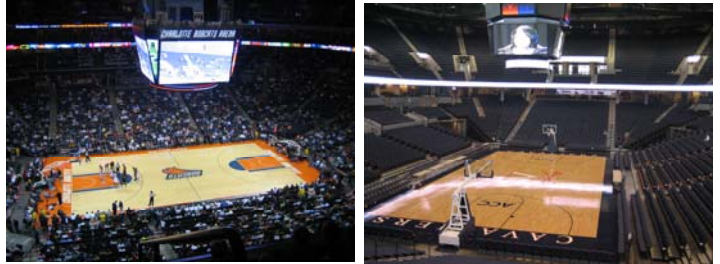

University of Virginia, John Paul Jones Arena

Charlottesville, VA

MEP Construction Administration for the new 15,700 seat arena.

Wichita State University Koch (Round House) Arena

Wichita, KS

FP services for the new arena included detailed fire sprinkler design documents.

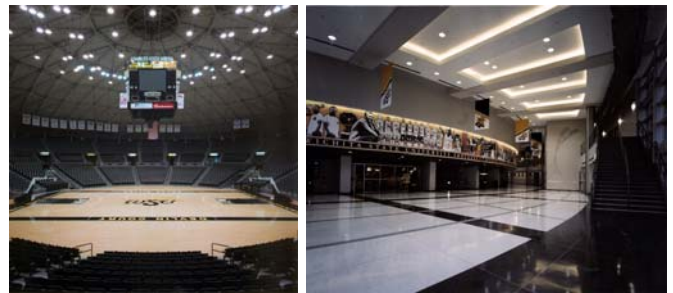

Stadiums

Kansas City Royals Kauffman Stadium

Kansas City, MO

MEP services for various projects at the Stadium since 1998:

- Stadium Renovations - Preparation of code consulting and life safety strategies. (2007-2008)
- Miscellaneous Concession Renovations
- Pump Feeder
- Expansion - Vision 2000
- T.V. Truck Relocation
- Water Heater Renovation
- Stadium Club HVAC
- Left Field Pavilion
- Electrical Repair
- Club Phase II
- Stadium Master Plan
- Dugout Suites Electronic Air Cleaner
- Stadium Post Renovation Master Plan
- K.C. Royals Kid's Zone & Ramp Lights
- VIP Lounge/Seat Expansion including Dugout Suites



Kansas City Chiefs Arrowhead Stadium

Kansas City, MO

- Following services for the 2008-2009 renovations.
 - Code Consulting services including preparation of fire and life safety strategy; development of documentation for code modifications, alternates and performance approaches.
 - Fire Protection services including detailed shop drawings, hydraulic calculations and stock listing.
 - Owner services including on-site observation of contractor installed FP and MEP systems.
- MEP services for various projects:
 - Concession Remodel
 - Tailgating Pavilion
 - Maintenance/TV Truck Complex
 - Condensing Unit Replacement
 - Arrowhead Club HVAC Renovation
 - Field Lighting & Wiring Renovation
 - Coach's Offices
 - Lighting No. 2
 - Expansion
 - Locker Room Consulting
 - Locker Room #3 (for KC Wizards Soccer Team)

Staten Island Stadium

Staten Island, NY

MEP services for:

- Interim Stadium Renovation
- Staten Island Stadium (St. George Station)



Arizona Cardinals Football Stadium - University of Phoenix Glendale, AZ

Provided code guidance, worked on alternate methods and performed fire and smoke modeling for the new NFL stadium.



Rochester Rhinos, PaeTec Park Soccer Stadium

Rochester, NY

Provided MEP, fire protection and sports lighting services for a new 18,000 seat professional soccer stadium.

- Electrical design services included field lighting, emergency egress lighting, scoreboard power and power & lighting for concessions, toilet rooms and auxiliary spaces.
- Heating & Ventilating design services of toilet rooms and concessions.
- Air Conditioning design services for auxiliary spaces.
- Plumbing engineering design services of toilet rooms and rough in for concessions.

Kansas City Wizards Soccer Stadium (on-going)

Kansas City, KS

MEP, FP and Code Consulting services for the new Wyandotte County Soccer Stadium. FP services include development of fire sprinkler drawings and specifications. Code Consulting services include exit study analysis, fire smoke modeling, review of design documents and general code consultation. MEP services include design of concession areas, pantry spaces, cooking stations, and all Kitchen/Commissary spaces.

University of Kansas - New Gridiron Club (on-going)

Lawrence, KS

MEP, Data/Telecom and FP design services for new Clubhouse facilities at Memorial Stadium including contemporary collegiate design standards for club lounge, suites, spectator seating, concessions, supporting areas and parking lot lighting.

University of Kansas - New Football Facilities

Lawrence, KS

Fire Protection services for the new 82,000 square feet football facility including football training area, locker rooms and related facilities on the lower level; and athletics administrative offices and support services on the upper level.

Bakersfield Minor League Baseball Stadium

Bakersfield, CA

MEP services for the new Minor League Baseball Stadium.

Cook County Cheetah Minor League Baseball Stadium

Crestwood, IL

MEP services for the home team and visiting team locker rooms, press box, toilet facility and concessions.

Sec Taylor Stadium (Principal Park)

Des Moines, IA

MEP services for the seating expansion, scoreboard, toilet room, and suites renovation.

New York Giants, Giants' Stadium

East Rutherford, NJ

MEP services for the suites and press box addition.

**Alliant Energy Field
Clinton, IA**

MEP services for the renovation of the toilets, concessions, home team locker room, administrative building, and Parks & Recreation's office expansion.

**DeVos Fieldhouse, Hope College
Holland, MI**

MEP Construction Administration for the new 4,000 seat field-house.

**Wyandotte County T-Bones Baseball Stadium
Kansas City, KS**

MEP design for the Pantry A/C.

**Sabina Park, Jamaica World Cup 2007 Cricket Stadium
Kingston, Jamaica**

MEP design for the remodel of the South Stand and new North Stand.

**Elfstrom Minor League Baseball Stadium
Geneva, IL**

MEP services for the new stadium facility, operations building, suites addition, seating addition, and concession/toilet addition.

**University of Oklahoma, Memorial Football Stadium
Norman, OK**

MEP services for various projects:

- 2007 Stadium Upgrade
- Master Plan Study
- Home Team Locker Expansion
- Restroom Expansion on North, East & West Sides
- Coach Offices and Strength Center Renovation & Expansion
- Santee Lounge Renovation
- Visitor's Team Locker Room Renovation
- Suites Build-out
- Concession & Restroom Expansion



**Indianapolis Indians, Victory Field Stadium
Indianapolis, IN**

MEP services for the following projects:

- Concessions
- Field Lighting

**University of Maryland, Byrd Stadium
Campus Park, MD**

MEP services for the seating expansion, field lighting, and new toilet facilities.

**Round Rock ISD Stadium
Austin, TX**

MEP services for the construction of a new \$20.5 million high school football stadium. The stadium consisted of 2,750 parking spaces, seating for 11,000 spectators, office space, a conference room, four ticket buildings, a two-tier press box, spacious locker rooms for both teams, and plenty of storage.

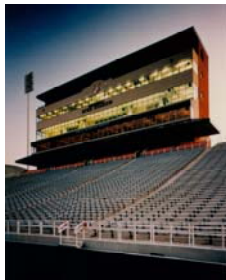

Training Facilities

**Goodyear Spring Training Facility
Goodyear, AZ**

MEP and sports lighting services for two development complexes for the Cleveland Indians and Cincinnati Reds and new Baseball Stadium. The development complexes include major & minor league clubhouses, indoor batting facility, maintenance building, six practice fields and observation towers. The 10,000 seat stadium includes a press box, suites, concessions and visitor's clubhouse.



**Surprise Tennis & Racquet Complex
Surprise, AZ**

MEP and sports lighting services for a new Tennis Complex, including 25 courts of which 17 are lit, 2,500 seat center arena, two racquet ball courts, locker rooms and pro shop. *The Complex received national recognition as the recipient of the 2008 USTA Outstanding Facility Award.*

**Port Charlotte Spring Training Facility
Port Charlotte, FL**

MEP services for the \$27.2 million renovation to the existing training facility for the Tampa Bay Rays and Charlotte Stone Crabs. The project included refurbishing the practice fields to big-league standards and a new clubhouse. Renovations to the main stadium included new seating, expanded area for press and luxury suites and three new concession/restroom building. *The facility received an "Excellence in Construction" award from the Florida Gulf Coast Chapter of ABC.*

**KC Royals & Texas Rangers Spring Training Facility
Surprise, AZ**

MEP services for the following:

- Concessions
- Parks & Recreation Office IT Expansion

**Chicago Cubs Spring Training Facility Complex
Mesa, AZ**

MEP services for the minor league spring training facility. The project included a major league clubhouse, four practice fields, one practice infield, enclosed batting tunnels, maintenance facility and administrative offices, concessions and public toilets.

**L.A. Dodgers Spring Training Facility
Vero Beach, FL**

MEPF Services.

Washington Redskins Football Training Facility Loudown, VA

MEP design services for :

- Training Facility with Hydrotherapy area
- Toilet Addition
- Press Conference Room Renovation
- Upgraded lighting and AC system

Washington Red Skins Football Stadium (Fed Ex Field) Loudown, VA

MEP design services for stadium including

- Owner Suites and Club area with concessions, restaurants, and rest rooms,
- Cigar Bar Ventilation and
- Novelty TEAM store

Cleveland Browns Indoor Training Facility Berea, OH

- 70 Yard Indoor Practice Field
- Corporate Offices
- Locker Room & Training Areas
- Whirlpool & Exercise Pool



Kansas City Chiefs Indoor Training Facility Kansas City, MO

- 70 Yard Indoor Practice Field
- Locker Room & Training Areas
- Whirlpool & Exercise Pool Areas



Seattle Mariners & San Diego Padres Spring Training Clubhouse Expansion Peoria, AZ

MEPF design services.

University of Kansas Training Facility Lawrence, KS

MEP services for the following: Anderson Family Strength Training Facility and Softball Complex. The 42,000 sq. ft. training facility includes a cardiovascular workout area, meeting rooms and lockers.



Surprise Aquatic Center Surprise, AZ

MEP design services for aquatic center including reception area, offices locker rooms and rest rooms, with two lighted outdoor swimming pools, concessions, and support facilities.



Wellness/Recreation Centers

University of MO-Kansas City Swinney Recreation Center Kansas City, MO

MEP design services for Recreation Center Natatorium Addition with rolling roof for natural day lighting.



Missouri Southern State University (MSSU) New Beimdiek Recreation Center Joplin, MO

MEPF design for 60,000 square feet new recreation center including:

- 3 Regulation-Size Basketball Courts
- Elevated Walking Track
- 2 Separate Exercise Areas -- Weight Room and Cardio Equipment Room
- 2 Separate Aerobics Rooms
- Student Health Clinic
- Separate Men's and Women's Locker Rooms



Grand River Family Area YMCA Chillicothe, MO

MEP Services for new community recreation Center including swimming pool, basketball courts, locker rooms and support areas.



Additional MEP Sports Facilities projects:

- Ripken Minor League Stadium, Addition/Team Store/Ticket - Aberdeen, MD
- Augustana College Baseball - Rock Island, IL
- University of Miami Baseball Stadium - Miami, FL
- County Independence League Baseball Stadium - Kansas City, MO
- Excelsior Springs Sports Complex - Excelsior Springs, MO
- John O'Donnell Stadium Renovation/Addition -Davenport, IA
- CAL Lutheran University Baseball - Thousand Oaks, CA
- Case Western Football Field Lighting - Cleveland, OH
- Garnett School District Track - Garnett, KS
- John O'Donnell Stadium Food Service/Concessions - Davenport, IA
- Benedictine University Field Lighting Study - Lisle, IL
- San Jose Evaluation of Facility - San Jose, CA
- Fed Ex Field Suites - Landover, MD
- University of Pacifica, Klein Family Field, Stockton University Baseball - Stockton, CA
- Indiana University, Field Hockey & Soccer Fields - Bloomington, IN
- Charlotte County Sports Complex, Hurricane Damage - Charlotte, NC
- Belton School District Field Lighting - Belton, MO
- Belton High School Ball Fields - Belton, MO
- New Jersey Devils Concession (Newark Arena) - Newark, NJ
- Raytown High School Field Lighting - Raytown, MO
- Paul Eames Stadium - Albany, GA
- Quicken Loans Arena, Roof Signage Study - Cleveland, OH
- Bonner Springs Schools Phase III "A" Concession/Press Box (Sports Fields Improvements) - Bonner Springs, KS
- Padres Dominican Republic - Dominican Republic
- Parkhill School District Football - Parkhill, MO
- Parkhill School District Soccer - Riverside, MO
- University of South Carolina Baseball Stadium - Columbia, SC
- Akron AA Baseball Stadium - Landover, MD
- Albuquerque Baseball Stadium - Albuquerque, NM
- New Fresno Grizzlies Ballpark Stadium Facility & Concessions - Fresno, CA
- New Essex County Sport Complex - Fairfield, NJ
- New T.R. Hughes Ballpark, Ozzie Smith Sports Complex - O'Fallon, MO
- Tampa Bay Devil Rays, Tropicana Field Concession Renovation & Addition - St. Petersburg, FL
- California Angels, Anaheim Stadium Concession Renovation & Expansion - Anaheim, CA
- New Canal Park Minor League Baseball Stadium - Akron, OH
- New Minor League Baseball Stadium & Concessions - Charleston, SC
- Wichita Wranglers, New Lawrence-Dumont Stadium Facility & Field Lighting - Wichita, KS
- Minor League Baseball Stadium Field Lighting - Salt Lake City, UT
- Tampa Bay Buccaneers, Raymond James Stadium - Tampa, FL

- Norfolk State University Baseball Stadium Field Lighting - Norfolk, VA
- New York Yankees Spring Training Facility Concession Renovation - Tampa, FL
- Minneapolis Vikings & Twins, Hubert H. Humphrey MetroDome Concession Picnic Area - Minneapolis, MN
- Roger Dean Stadium - Jupiter, FL
- Jacksonville Jaguars Memorial Coliseum Concession Kitchen - Jacksonville, FL
- Kemper Arena Improvements - Kansas City, MO
- Blue Springs South Concession - Blue Springs, MO
- K.U. Softball Complex , Lawrence, KS
- Central Missouri State University Softball Complex Warrensburg, MO

Code Projects

- MU Baseball - Columbia, MO
- Edward Jones Dome - St. Louis, MO
- East Limestone Gymnasium - Alabama
- Omaha Baseball Stadium - Omaha, NE
- Basrah Sports City - Iraq
- University of Alabama - Coleman Coliseum Men's Basketball Practice Facility Birmingham, AL



Fire Protection Engineering
Mechanical/Electrical/Plumbing
Engineering
Code Consulting

Sports Lighting

Surprise Tennis & Racquet Complex Surprise, AZ

MEP and sports lighting services for a new Tennis Complex, including 25 courts of which 17 are lighted, 2,500 seat center arena, two racquet ball courts, locker rooms and pro shop. *The Complex received national recognition as the recipient of the 2008 USTA Outstanding Facility Award.*



Rochester Rhinos, PaeTec Park Soccer Stadium Rochester, NY

Provided MEP, fire protection and sports lighting services for a new 18,000 seat professional soccer stadium.

Goodyear Spring Training Facility Goodyear, AZ

MEP and sports lighting services for two development complexes for the Cleveland Indians and Cincinnati Reds and new Baseball Stadium. The development complexes include major & minor league clubhouses, indoor batting facility, maintenance building, six practice fields and observation towers. The 10,000 seat stadium includes a press box, suites, concessions and visitor's clubhouse.

University of Maryland, Byrd Stadium Campus Park, MD

MEP services for the seating expansion, field lighting, and new toilet facilities.

Indianapolis Indians, Victory Field Stadium Indianapolis, IN

MEP services for concessions and field lighting

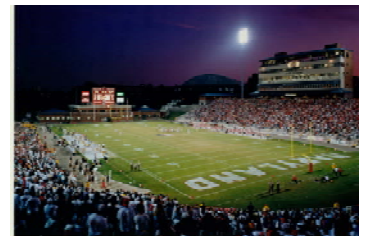

Additional sports lighting projects:

- Case Western Football Field Lighting - Cleveland, OH
- Benedictine University Field Lighting Study - Lisle, IL
- Belton School District Field Lighting - Belton, MO
- Raytown High School Field Lighting - Raytown, MO
- New Lawrence-Dumont Stadium Facility & Field Lighting - Wichita, KS
- Minor League Baseball Stadium Field Lighting - Salt Lake City, UT
- Norfolk State University Baseball Stadium Field Lighting - Norfolk, VA
- Raytown South High School Soccer/Football Field Lighting - Raytown, MO

FSC, Inc.

Corporate Headquarters:

3100 South 24th Street, Suite E
Kansas City, KS 66106 U.S.A.
Tel: (913) 722-3473
Fax: (913) 722-3484

Subsidiaries:

FSC MEP Engineers, LLC

8511 Hillcrest Road, Suite 100
Kansas City, MO 64138 U.S.A.

FSC Bredson, Inc.

8511 Hillcrest Road, Suite 100
Kansas City, MO 64138 U.S.A.

FSC Engineers, Pvt. Ltd.

221 Bisarya Complex
Bhopal - 462011 M.P. India

FSC Consulting Services, Pvt. Ltd.

221 Bisarya Complex
Bhopal - 462011 M.P. India

Web: www.fsc-inc.com