

# YEAR OF THE VOLUNTEER: ANIMALS MONTH

**We need you!**  
**Whatever your skills and experience**  
**there are many ways you can help - not**  
**just practical animal care -**  
**and this is a great way to get involved!**



## MAKE-A-THON: DORMOUSE BOX

### What we'd like you to make:

- The Common Dormouse is a small rodent that lives in mixed woodland and hedgerows in southern England. The population has been declining over the past century due to changes in the landscape, which have resulted in the destruction of good dormouse habitat. It has been shown that dormouse boxes, like these are asking you to make, can provide shelter for them and so they are being used in projects all over England. We always need more boxes and by making one you would be contributing to the conservation of one of Britain's most endearing mammals.

### What you'll need to make it:

- Exterior grade plywood, 8mm thick. Wood glue, nails or staples to put the box together.
- Saw (jigsaw), drill, hammer.

### How to make it:

Cut out pieces of the plywood to the dimensions shown on the following three diagrams, then fix them together using glue and staples or nails. All dimensions are in centimetres.

(Exterior grade plywood 0.8cms thick and glued and stapled or nailed together.)

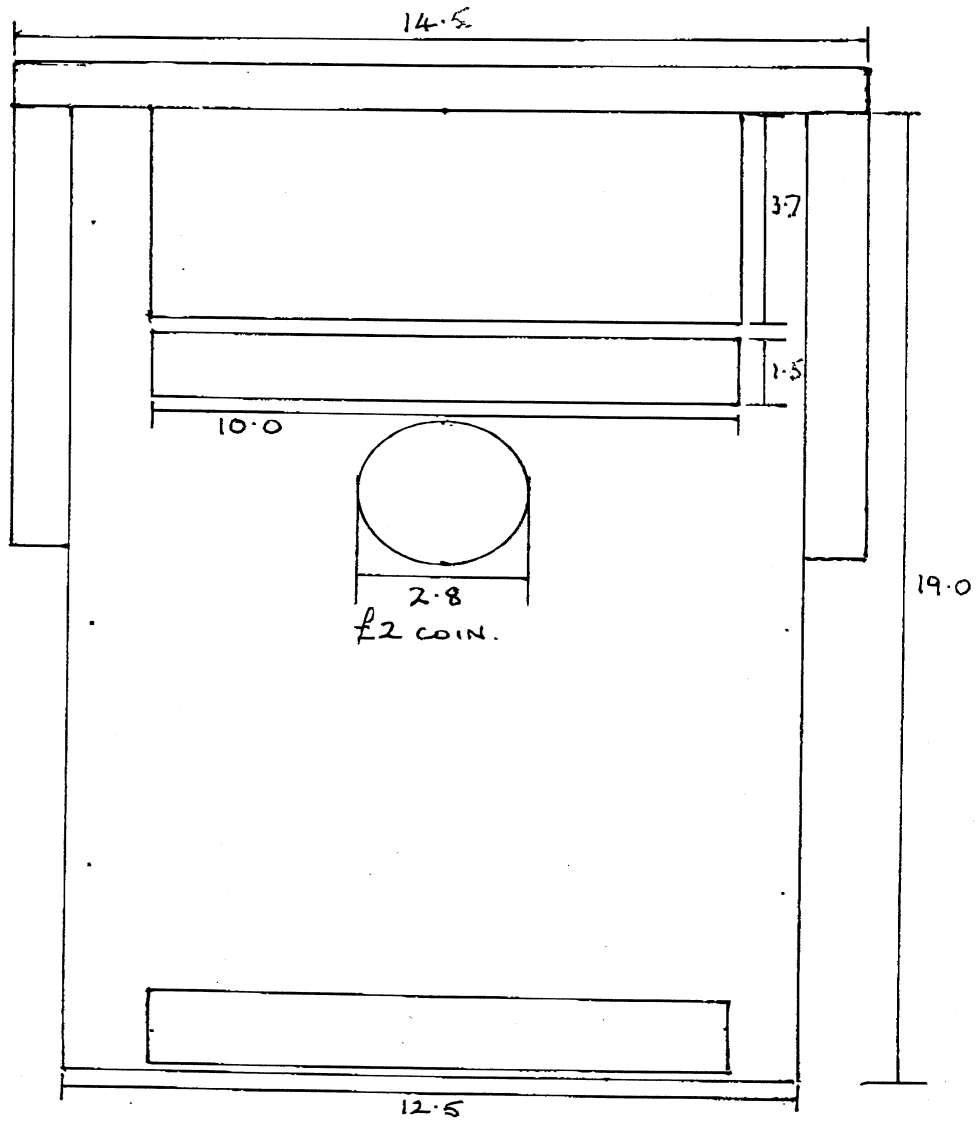

# **Dormouse Box - Side**

(Floor should have holes drilled in it for drainage)

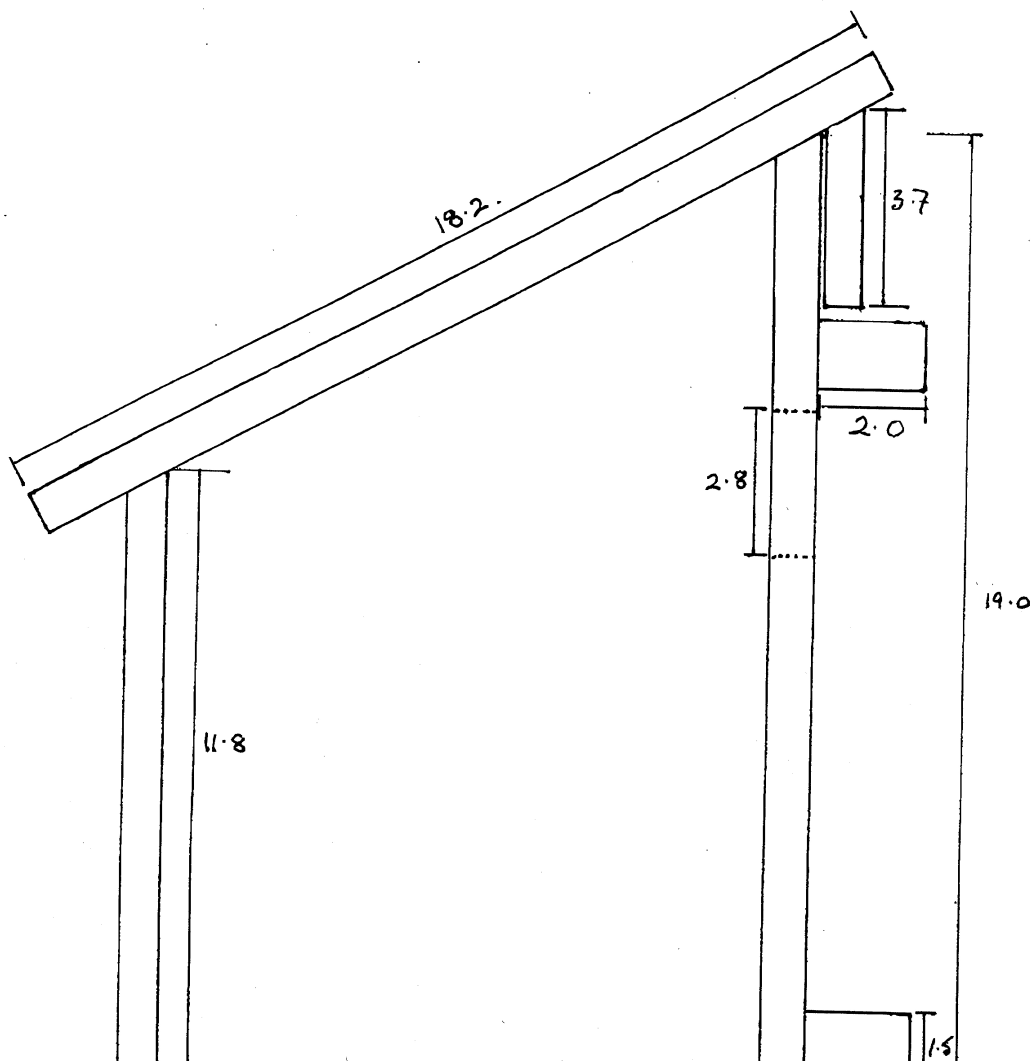

**Dormouse Box - Back**

(Fastened with wire bent around staple  
in lid and hooked round a nail in back.)

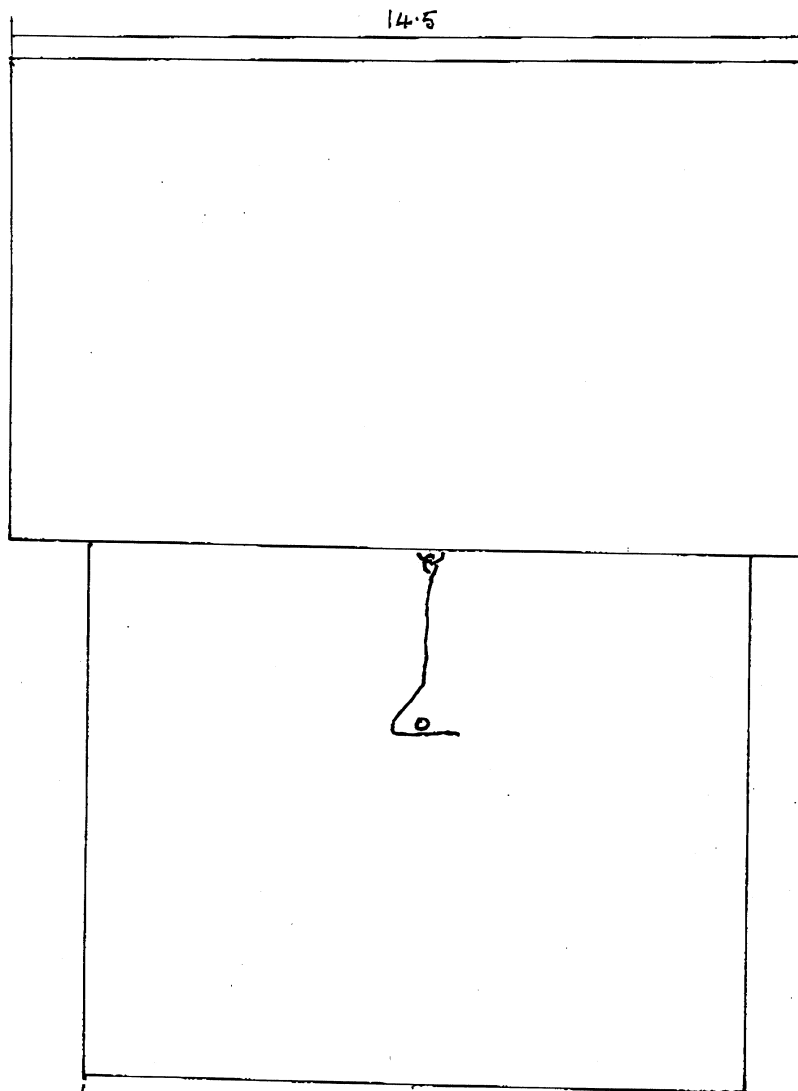

### **What to do with it:**

- When you have finished your dormouse boxes, please contact The Mammal Society on 0207 350 2200 or [enquiries@mammal.org.uk](mailto:enquiries@mammal.org.uk).
- There is plenty of scope for experimentation in siting the box. Try attaching it to a post driven into the ground among brambles, or try putting the entrance hole in the bottom of the box. You can also vary the height at which you site the box.
- Check the box from time to time. It may be used by wood mice or birds but, if you are lucky, a dormouse may take up residence and allow you to see it as it makes its escape. Even when it is not very cold, you may find a dormouse in a torpid state (deep sleep) when you open the box. If so, leave it undisturbed and fix the lid firmly back in place.

- **Caution**

Take care never to disturb a hibernating dormouse, as an animal woken from this state uses up some of its essential fat store and may not be able to survive the winter. Dormice usually hibernate underground so it is unlikely that your box will be used for this purpose – but not impossible.

**THANK YOU FOR TAKING PART IN ANIMALS MONTH!**



**Year of the Volunteer 2005 is supported by The Home Office,  
Community Service Volunteers (CSV) and Volunteering England**

**[www.yearofthevolunteer.org](http://www.yearofthevolunteer.org)**