



PARK ROYAL 3
Pratumnak
Exclusivity & Ultra-Modern Design

Spiritual Serenity

'Location, location, location' is the mantra, proverb, motto and basic consideration in any real estate purchase. With this in mind, Park Royal 3 will appeal to any savvy investor or potential home-owner by virtue of the spectacular setting of Pratumnak Soi 6. Pratumnak is an area of outstanding natural beauty positioned on an exclusive hillside - five minutes away in either direction from the vibrant Pattaya city centre on one side, and Jomtien beach on the other. Surrounded by the spiritual backdrop of Buddha Hill and the wondrous golden Buddha which overlooks Jomtien, Pratumnak is a location which is eye-catching, exclusive, and enchanting.



Uncompromising Quality

Despite our amazingly low prices, we refuse to compromise on the high standard of comfort and living that our clients have become accustomed to enjoying. The Park Royal 3 development will feature virtually all of the facilities and amenities our other luxury projects enjoy, including:

- Stunning Pratumnak location
- Premium quality building materials
- Top-level structural integrity and engineering concepts
- 24-hour security
- 'Smart Home' features
- Secluded ground floor pool and relaxation area
- Free Wi-Fi zones
- Hotel-like concierge services
- Luxury reception area
- Underground parking

And more....



The Search For Affordable Luxury Is Over

Another revolutionary development from Heights Holdings:

Heights Holdings has done it again - we have taken affordable luxury to the next level. With the launch of the unbelievable Park Royal 3 in another prime Pratumnak location, we have provided the ultimate Pattaya real estate investment package

Welcome Home.

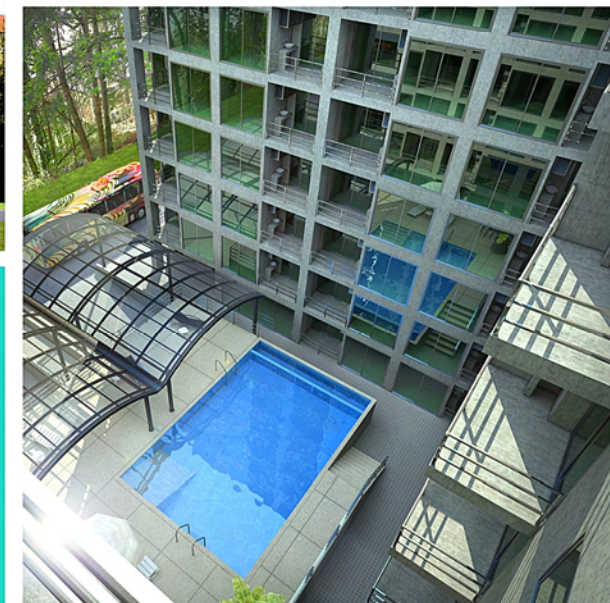

As well as completing the building to our usual impeccable European-quality standards, with this development we are also introducing an exclusive boutique furnishing package as an optional extra for all our units. This package will come in two styles – superior and executive, and will include 2 x 42" LCD televisions, avant-garde furniture, as well as providing all of our units with a guaranteed 'wow' factor.

As with all of our projects, Park Royal 3 represents yet another incredible investment opportunity from Heights Holdings. Why pay over the odds when you can acquire unbelievable quality at unbeatable prices. We invite you to celebrate our success by enjoying your very own with us at Park Royal 3.

Cutting-Edge Design

A leading development requires a leading designer, and in the peerless Mario Kleff and his Wandee Group there can be no finer selection. Having previously been contracted to design plans for international standard projects in the USA, Russia and Dubai; Mario Kleff now spends his time exclusively in Thailand.

Having designed several other projects for Heights Holdings, Mario Kleff is keen to outline his latest unique vision in the form of Park Royal 3. In an attempt to highlight the beauty of the local area, the building will be constructed using lightweight and transparent materials. With very few concrete walls, green reflective glass will be employed to provide exceptional as well as to allow the integration of tropical green landscape into your living environment. The relationship between Wandee Group and Heights Holdings is one which allows Mario and his team to fully express their creative visions while enabling Heights Holdings to enjoy the latest in ultra-modern design and engineering concepts.

PARK ROYAL 3

Pratumnak

Exclusivity & Ultra-Modern Design
By Star Architect Mario Kleff



Pratumank Soi 6, Pratumank Hill, South Pattaya

