

# SHIMANO 105 Cassette Sprocket CS-5600 10-Speed

11T Top Gear Type

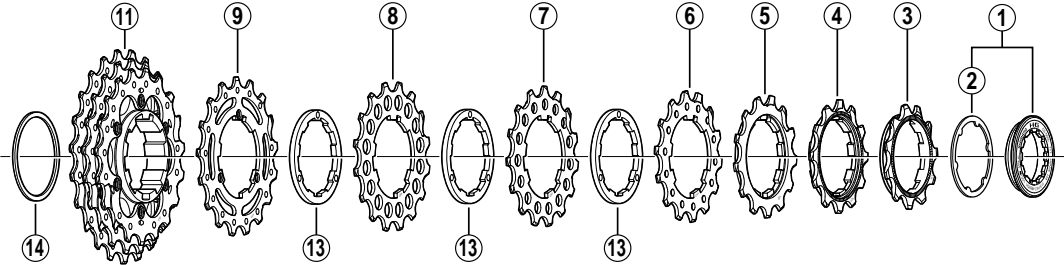

12T Top Gear Type

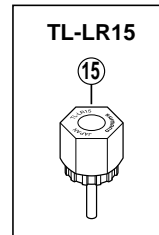
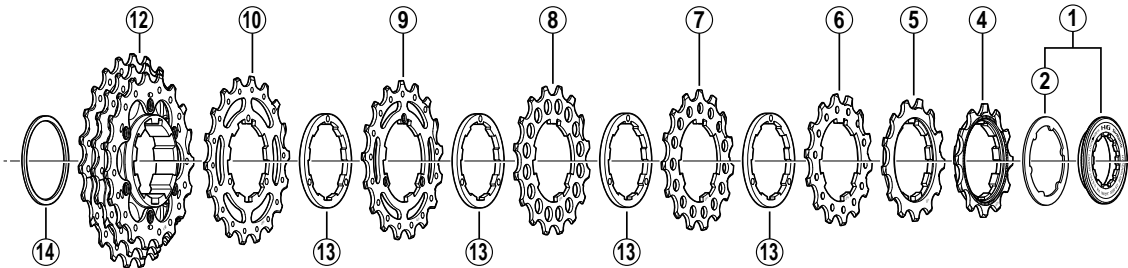

### CS-5600 sprocket teeth combinations

11 – 23T	11-12-13-14-15-16-17	- [19-21-23] T
11 – 25T	11-12-13-14-15	-17-19- [21-23-25] T
12 – 25T	12-13-14-15-16-17-19	- [21-23-25] T
12 – 27T	12-13-14-15-16-17-19	- [21-24-27] T

CS-5600

ITEM NO.	SHIMANO CODE NO.	DESCRIPTION	INTERCHANGEABILITY
1	Y-1ZF 98010	Lock Ring & Spacer for 11T Top Gear	B
	Y-1ZF 98020	Lock Ring & Spacer for 12T Top Gear	B
2	Y-10Z 04000	Lock Ring Spacer for 11T Top Gear	
	Y-11W02000	Lock Ring Spacer for 12T Top Gear	A
3	Y-1Z8 1100N	Sprocket Wheel 11T (Built in spacer type)	B
4	Y-1Z8 1200N	Sprocket Wheel 12T (Built in spacer type)	B
5	Y-1ZD 1390N	Sprocket Wheel 13T (Built in spacer type)	B
6	Y-1Z8 1400N	Sprocket Wheel 14T	B
7	Y-1Z8 1500N	Sprocket Wheel 15T	B
8	Y-1Z8 1600N	Sprocket Wheel 16T	B
	Y-1ZF 1700N	Sprocket Wheel 17T for 11-25T	
9	Y-1ZD 1700N	Sprocket Wheel 17T	B
	Y-1ZF 1900N	Sprocket Wheel 19T for 11-25T	
10	Y-1ZD 1900N	Sprocket Wheel 19T	B
11	Y-1ZF 98050	Sprocket Unit (19 – 21 – 23T) for 11-23T	B
	Y-1ZF 98090	Sprocket Unit (21 – 23 – 25T) for 11-25T	
12	Y-1ZF 98060	Sprocket Unit (21 – 23 – 25T) for 12-25T	B
	Y-1ZF 98070	Sprocket Unit (21 – 24 – 27T) for 12-27T	B
13	Y-357 65231	Sprocket Spacer (t=2.35 mm)	B
14	Y-1Z8 07000	Low Spacer (t=1.0 mm)	A
15	Y-120 09230	Lock Ring Removal Tool (TL-LR15)	A

A: Same parts.

B: Parts are usable, but differ in materials, appearance, finish, size, etc.

Absence of mark indicates non-interchangeability.

0607-2455C

Specifications are subject to change without notice.

# SHIMANO