

NEXUS Rear Wheel WH-8R25 Inter-8

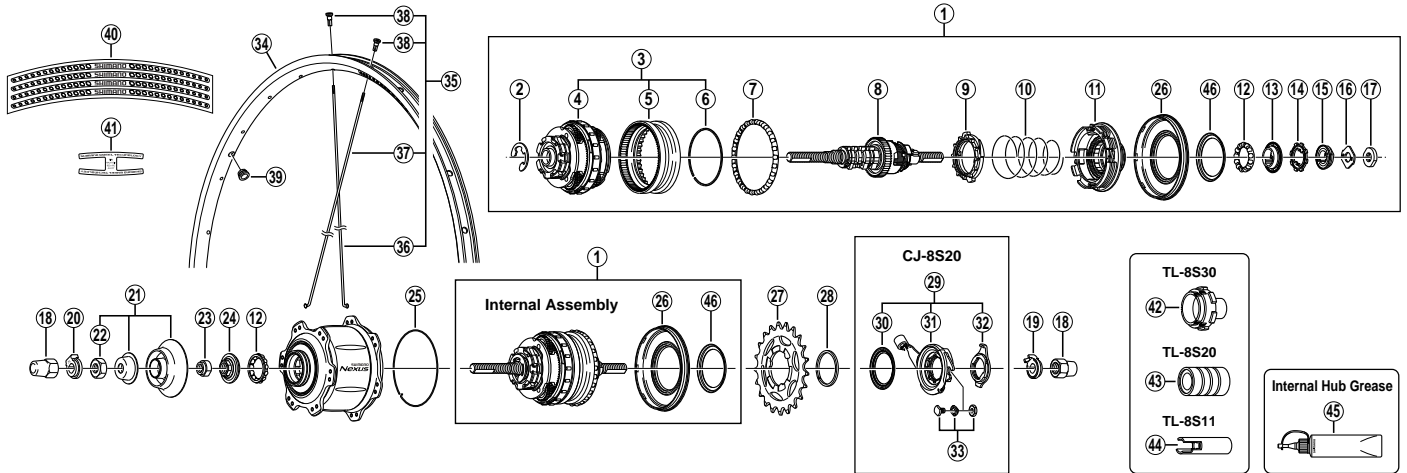

ITEM NO.	SHIMANO CODE NO.	DESCRIPTION
* 1	Y-35J 98060	Internal Assembly (Axle Length 184 mm)
	Y-34R 79000	Stop Ring (φ 12 / 1.0 mm)
* 2	Y-34R 79010	Stop Ring (φ 12 / 1.3 mm)
*	Y-34R 79020	Stop Ring (φ 12 / 1.6 mm)
3	Y-35J 98050	Ring Gear Unit
4	Y-35J 98020	Carrier Unit
5	Y-35J 07000	Ring Gear 1
6	Y-34R 80000	Ring Gear 1 Stop Ring
7	Y-34R 98030	Ball Retainer O (3/16" x 26)
8	Y-35J 98030	Hub Axle Unit (Axle Length 184 mm)
9	Y-34R 98050	Clutch Unit
10	Y-34R 21000	Return Spring A
11	Y-35J 98040	Driver Unit
12	Y-34R 98070	Ball Retainer P (3/16" x 13)
13	Y-34R 98080	Right Hand Cone w/Seal
14	Y-34R 12000	Driver Plate
15	Y-34R 98090	Lock Washer
16	Y-34R 09000	Stop Washer
17	Y-33Z 07020	Right Hand Lock Nut (3.4 mm)
18	Y-314 14010	Cap Nut (3/8")
	Y-33Z 20500	Non-turn Washer 5R (Yellow)
19	Y-33M 39600	Non-turn Washer 6R (Silver)
	Y-33M 39700	Non-turn Washer 7R (Black)
	Y-34R 85010	Non-turn Washer 8R (Dark Blue)
	Y-33M 39510	Non-turn Washer 5L (Brown)
20	Y-33M 39610	Non-turn Washer 6L (White)
	Y-33M 39710	Non-turn Washer 7L (Gray)
	Y-34R 85000	Non-turn Washer 8L (Dark Green)
21	Y-34R 98100	Left Hand Dust Cap Unit
22	Y-75V 13041	Left Hand Lock Nut (7.2 mm)
* 23	Y-31Z 06030	Lock Nut for Left Hand Cone
24	Y-35J 90000	Left Hand Cone w/Dust Cap
* 25	Y-35J 11100	Hub Shell Slide Spring
26	Y-34R 98110	Right Hand Dust Cap A w/Seal
	Y-322 03220	Sprocket Wheel 16T (Silver)
	Y-322 03420	Sprocket Wheel 18T (Silver)
27	Y-322 03520	Sprocket Wheel 19T (Silver)
	Y-322 03620	Sprocket Wheel 20T (Silver)
	Y-330 60000	Sprocket Wheel 21T (Silver)
	Y-330 60100	Sprocket Wheel 22T (Silver)
28	Y-321 20100	Snap Ring C
29	Y-74Y 98120	CJ-8S20 Cassette Joint Unit
30	Y-74Y 18000	Driver Cap
31	Y-74Y 98130	CJ-8S20 Cassette Joint
32	Y-33Z 98020	Cassette Joint Fixing Ring
33	Y-74Y 98030	Inner Cable Fixing Bolt Unit
34	E-WHRIMZDBC	Rim (24H / Anodized)
35	E-WHSP0KE1CB1	Spoke Unit {Spoke (260 mm x 12 pcs. & 274 mm x 12 pcs.) / Nipple (24 pcs.)}
36	Y-012 5Y74C	Right Hand Spoke (274 mm)
37	Y-012 5Y60C	Left Hand Spoke (260 mm)
38	Y-012 Y7341	Nipple
39	Y-4BU04000	Valve Stem Adapter
40	Y-4BU98010	Rim Sticker A / 1 sheet (4 pcs.)
41	Y-4BE50000	Rim Sticker C
42	Y-708 00300	TL-8S30 Carrier Unit Tool
43	Y-708 00200	TL-8S20 Right Hand Cone Installation Tool
44	Y-708 00600	TL-8S11 Right Hand Cone Removal Tool
45	Y-041 20800	Internal Hub Grease (Net. 100g)
* 46	Y-34R 0E000	Right Hand Dust Cap B

0609-2428B

Specifications are subject to change without notice.

SHIMANO