

11) Align 2nd Pocket, on bottom raw edge of AeroPac Exterior. (Now the velcro on 2nd Tab match up with the velcro on 2nd Pocket.

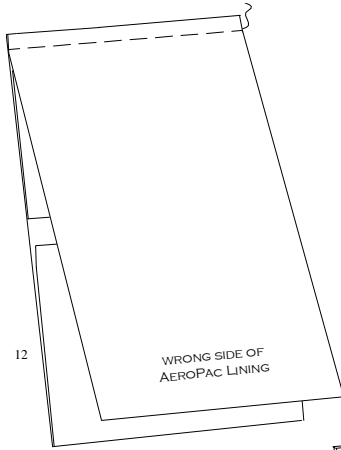

12) Now AeroPac Contrast & Exterior top edges, sandwiching 1st Tab in between. Stitch 1/4" from raw edges through all layers of fabric.

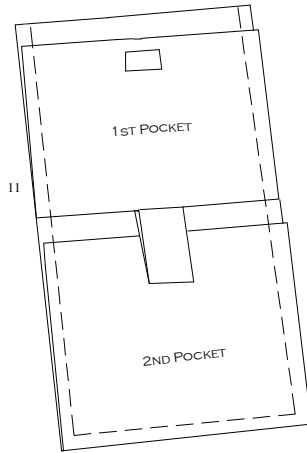
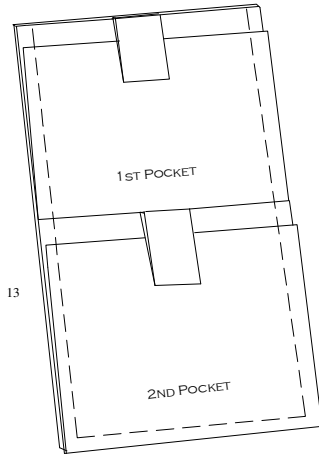

13) Flip fabric over, (wrong sides together). Now the velcro on 1st Tab matches up with velcro on 1st Pocket. Baste ~1/8" from both side edges and edge, through all layers of fabric, anchoring everything in place.

id & ticket holders

*** If you've chosen to use clear vinyl for the ID & Ticket Holders, then proceed to step 14. If you chose fabric for these pockets, then with rights together, stitch 1/4" from each diagonal edge for both. Trim each seam & flip so wrong sides are together now. Press flat and go to step 14.

14) Cut 2 pieces of single-fold bias tape, 6 1/2" each.

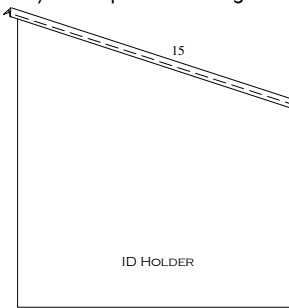

15) Place bias tape on diagonal ID Holder edge, allowing folded edges to hang equally on each side. Stitch in place. Clip excess bias tape from each side edge.

16) Repeat step 15 with Ticket Holder.

17) Place Ticket Holder on AeroPac Contrast, lining up bottom & side edges. Baste in place. Now place ID Holder on Ticket Holder, in same way. Choose to either have bias taped edges converge, or be parallel to each other. Baste in place.

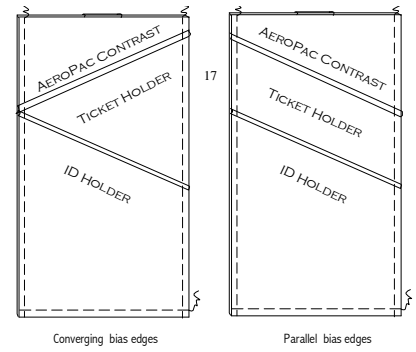

18) Cut 48" of cording or lacing for your strap. Pin strap ends in place on both sides of AeroPac Contrast. There should be ~1" of lacing in contact with the AeroPac edge. Stitch in place.

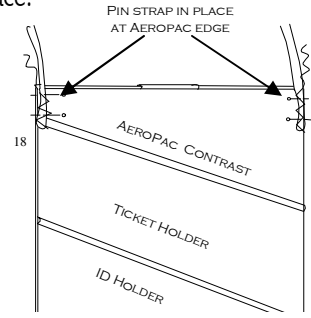

19) Cut a 5" piece of double-fold bias tape, and two pieces that measure 10". Press one of the folded edges open & flat on each.

20) Align pressed edge of small bias tape piece to bottom edge of ID Holder. Stitch 1/4" from raw edges through all layers of fabric.

21) Flip bias tape up & over raw edges to pocketed side of AeroPac. Stitch in place 1/4" from folded over edge.

22) Fold 1/2" over (wrong sides together) on a 10" piece of bias tape. Apply this folded over edge to top corner of AeroPac Contrast, covering the end of strap. Continue applying bias tape to edge, until bottom corner is reached. Finish end off by folding over this bias tape end, so it is even with AeroPac's bottom edge. Stitch in place 1/4" from raw edges through all layers of fabric. Repeat procedure on other side of AeroPac.

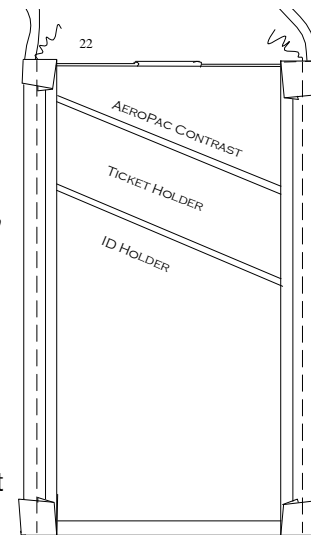

23) Flip bias tape up & over both AeroPac side edges to pocketed side. Stitch in place 1/4" from folded over edges.

let's put it all together now.

You are **DONE!**
I hope you enjoy your AeroPac. This pattern was provided for you free of charge by StudioKat Designs.
www.studiokatdesigns.com

