



PANORAM V10c

13 function cycle computer

User's Guide

GB

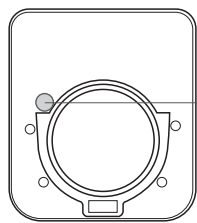
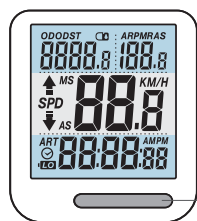
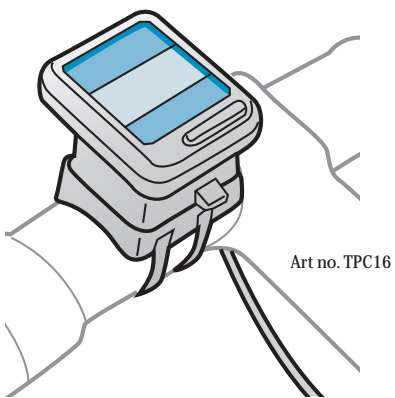

MODE
Button
M

SET
Button
S

DISPLAY	FUNCTION
SPD	Current speed
AS	Average speed
MS	Maximum speed
DST	Distance
ODO	Accumulated distance
RT	Ride time
ART	Accumulated ride time
LO	Low battery indicator
⌚	12H/24H clock
↕	Pace indicator
🔒	Button lock
RPM	Current Cadence (RPM)
AR	Average Cadence (RPM)
MR	Maximum Cadence (RPM)
KM/H M/H	Unit selection

DETAILED PARTS DESCRIPTION

ACCESSORIES (Fits handlebar and stem)

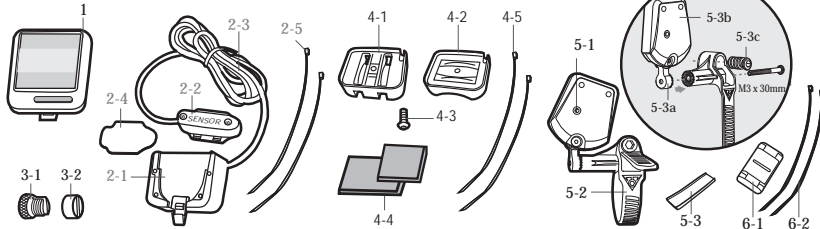

1. Computer Body
2. Computer Bracket Set A
 - 2-1 Computer Bracket
 - 2-2 Sensor
 - 2-3 Sensor Cable
 - 2-4 Sensor Rubber Pad
 - 2-5 Sensor Zip Tie (2pcs)
3. Wheel Magnet Set
 - 3-1 Wheel Magnet
 - 3-2 Magnet Nut
4. Bracket Set
 - 4-1 Handlebar Bracket
 - 4-2 Stem Bracket
 - 4-3 M2.5 x 10mm Bolt
- 4-4 Rubber Pad (2 pcs)
- 4-5 Bracket Zip Tie (4 pcs)
5. Cadence Sensor Set
 - 5-1 Battery Test Button
 - 5-2 Threaded Strap Clamp
 - 5-3 Sensor Rubber Pad
 - 5-3a Sensor Spacer
- 5-3b Sensor Body
- 5-3c Strap Clamp Screw
6. Cadence Magnet Set
 - 6-1 Cadence Magnet
 - 6-2 Magnet Zip Tie (width: 2.5mm - 2 pcs)

DETERMINE WHEEL CIRCUMFERENCE

METHOD A). CHOOSE FROM WHEEL CIRCUMFERENCE DATA BELOW

Tire Size	Designation	Wheel Circumference	Tire Size	Designation	Wheel Circumference
47-305	16 x 1.75 x 2	1217	32-630	27x1 1/4	2199
47-406	20 x 1.75 x 2	1590	28-630	27x1 1/4 Fifty	2174
37-540	24x1 3/8A	1948	40-622	28x1.5	2224
47-507	24x1.75x2	1907	40-622	28x1.75	2268
23-571	26x1	1973	40-635	28x1 1/2	2265
40-559	26x1.5	2026	37-622	28x1 1/8x1 5/8	2205
44-559	26x1.6	2051	18-622	700x18c	2102
47-559	26x1.75x2	2070	20-622	700x20c	2114
50-559	26x1.9	2089	23-622	700x23c	2133
54-559	26x2.00	2114	25-622	700x25c	2146
57-559	26x2.215	2133	28-622	700x28c	2149
37-590	26x1 3/8	2105	32-622	700x32c	2174
37-584	26x1 3/8x1 1/2	2086	35-622	700x35c	2205
			40-622	700x40c	2224

METHOD B). MEASURE WHEEL CIRCUMFERENCE

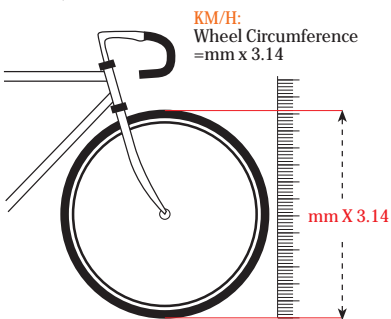

WHEEL CIRCUMFERENCE OF MY BIKES

BIKE :



CHANGING BATTERIES

Computer Body

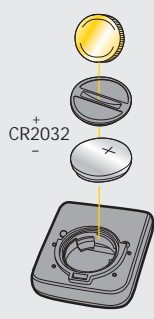

Cadence Sensor

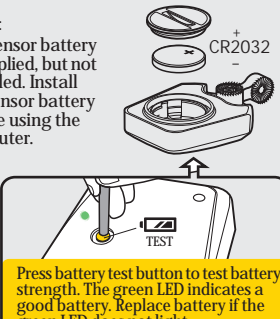

NOTE:
The sensor battery is supplied, but not installed. Install the sensor battery before using the computer.

Press battery test button to test battery strength. The green LED indicates a good battery. Replace battery if the green LED does not light.

SPECIFICATIONS

Wheel circumference default: BIKE-2155mm

DISPLAY	FUNCTION	SHOWN ON SCREEN	READ ON SCREEN	SPECIFICATIONS	INCREMENTS	ACCURACY
SPD	Current speed	SPD 26.7	26.7 KM/H	99.9 KM/H, 60.0 M/H	0.1 KM/H or M/H	± 1 %
AS	Average speed	AS 28.9	28.9 KM/H	99.9 KM/H, 60.0 M/H	0.1 KM/H or M/H	± 0.1 %
MS	Maximum speed	MS 45.6	45.6 KM/H	99.9 KM/H, 60.0 M/H	0.1 KM/H or M/H	± 0.1 %
DST	Distance	DST 31.8	31.8 KM	0.0-999.9 KM or M	0.1 KM or M	± 0.1 %
ODO	Accumulated distance	ODO 3224.1	3224.1 KM	0.0-9999.9 KM or M	0.1 KM or M	± 0.1 %
RT	Riding time	RT 0:13:00	13M	0:00:00-99:59:59	1 Second	± 0.1 %
ART	Accumulated riding time	ART 157:30	157H30M	000:00-999:59	1 Minute	± 0.1 %
LO	Low battery indicator	LO	low battery	< 2.4V		
⌚	12H/24H clock	⌚ 12:00:52	12H0M52S PM (12H)	1:00:00-12:59:59 (12H) 0:00:00-23:59:59 (24H)	1 Second	± 0.003 %
↕	Pace indicator	↕ SPD > AVG ↕ SPD < AVG				
🔒	Button lock	🔒	lock			
RPM	Current Cadence	RPM 65	65	0-199	1 Second	
AR	Average Cadence (RPM)	AR 50	50	0-199	1 Second	
MR	Maximum Cadence (RPM)	MR 90	90	0-199	1 Second	

Sensor:

No Contact Magnetic Sensor.

Wheel Circumference Setting:
0mm - 3999mm (1mm increment)

Operating Temperature:
0°C ~ 60°C (32°F ~ 140°F)

Storage Temperature:
-20°C ~ 80°C (-4°F ~ 176°F)

Computer Body Battery Power:

3V battery x 1 (CR2032). Battery life, approximately two years.

(Based on an average of 1.5 hours use per day)

Transmitter Battery Power:

3V battery x 1 (CR2032). 15,000 miles riding distance, or approximately 2 years.
(Battery included with sensor may have shorter battery life due to initial shipping and storage time.)

Dimensions/Weight:

Computer Body: 45.5 x 40 x 11.5mm / 24.4g

IMPORTANT NOTE

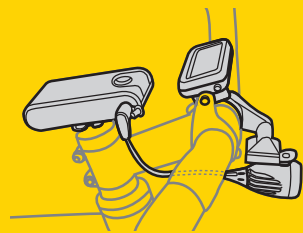

When using Panoram wireless cycle computer in conjunction with a Topeak light and powerpack, mount the light in the position shown to minimize electromagnetic interference with the cycling computer.

INSTALLATION

1

Computer / Handlebar Bracket Set

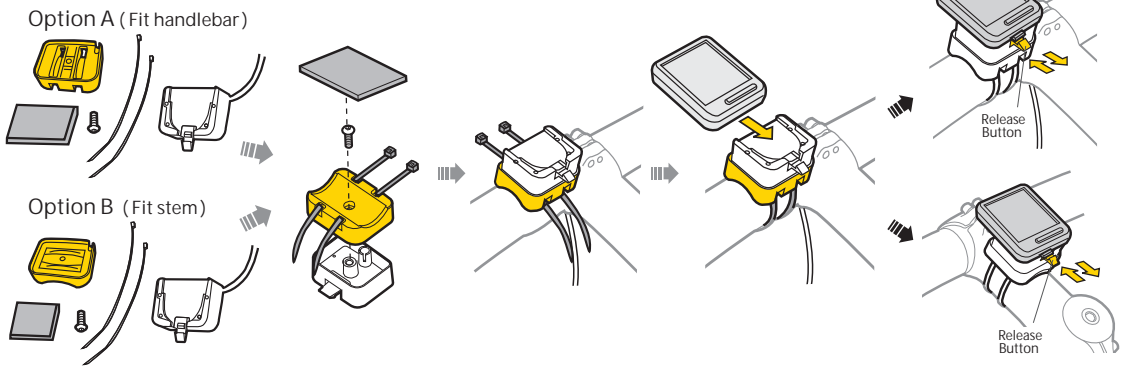

2

Wheel Sensor / Magnet Set

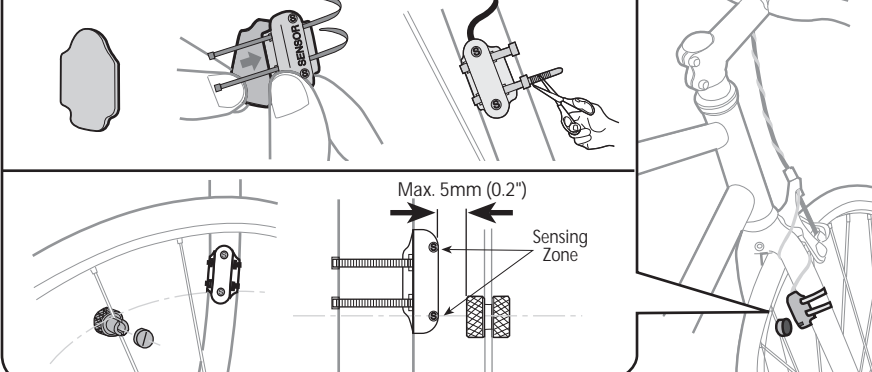

3

Cadence Sensor/Magnet Set

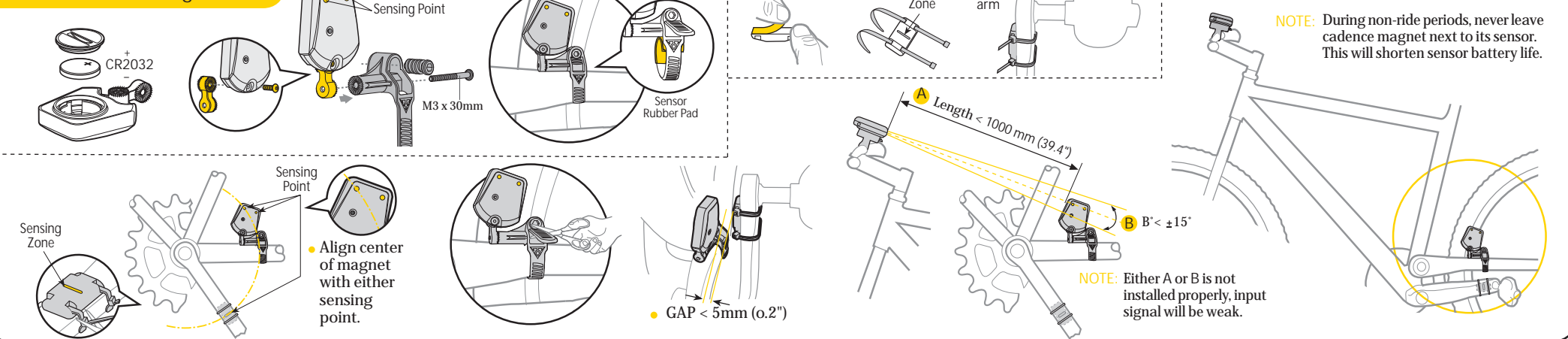

TROUBLE SHOOTING

Check the following before bringing unit in for repair.

PROBLEM	CHECK ITEMS	REMEDY
No display	1. Is the battery exhausted? 2. Is the battery installed correctly?	1. Replace the battery. 2. Make sure that the positive (+) pole of the battery is facing the battery cap.
No current speed or incorrect data	1. Is it in setup mode? 2. Are the contacts between the computer body and the bracket poor? 3. Are the relative positions and gap between sensor and magnet correct? 4. Is the wheel circumference correct?	1. Refer to the data setting procedure and complete the adjustment. 2. Clean the contacts. 3. Refer to INSTALLATION and re-adjust correctly. 4. Refer to CIRCUMFERENCE SETTING and enter correct value.
Irregular display		Refer to "Clear All Data setting" and initiate the computer again.
LCD is black	Did you leave the main unit in direct sunlight when not riding the bicycle for a long while?	Place the computer body in the shade to return to normal state.
Display is slow	Is the temperature below 0°C (32°F)?	The unit will return to normal state when the temperature rises.

PRECAUTIONS

1. The TOPEAK PANORAM cycle computer can be used in the rain but should not be used underwater.
2. Do not leave the main unit exposed to direct sunlight when not riding the bicycle.
3. Do not disassemble the computer body or its accessories.
4. Check relative positions and gap between sensor and magnet periodically.
5. Clean the bracket contacts and the button of the computer body periodically.
6. Do not use harsh chemicals to clean the computer body or its accessories.
7. Remember to pay attention to the road while riding.

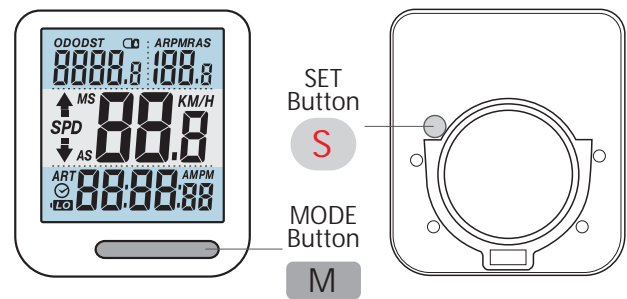

OPERATION SYMBOLS

M MODE Button

S SET Button

Press and Hold

Press

1 SETUP CLEAR ALL DATA and SELECT KM or MILE

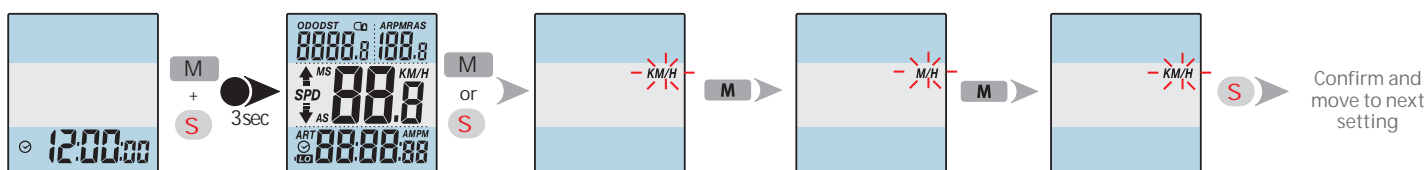

2 SETUP WHEEL CIRCUMFERENCE

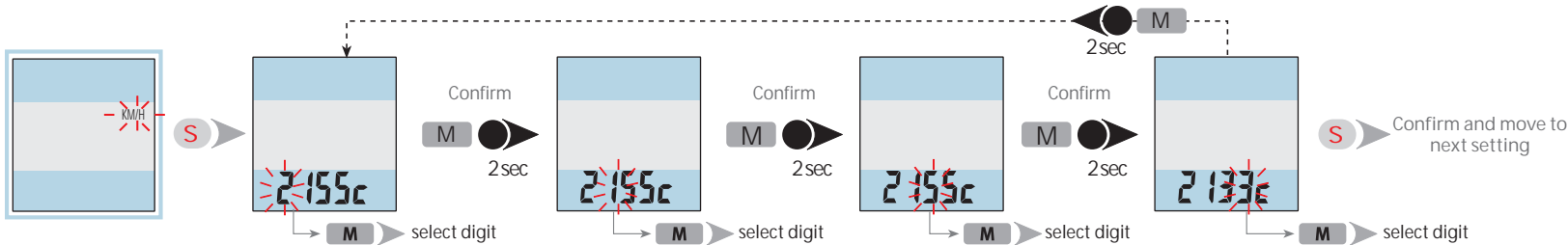

NOTE:

If no data is entered for 20 seconds, the screen will return to screen 1 automatically

When DST over 999.9 or RPM over 99:59:59, ERR will appear. Use CLEAR DATA function, to erase DST & PRM data.

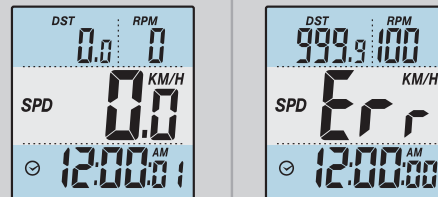

3 SETUP 12/24 hr CLOCK

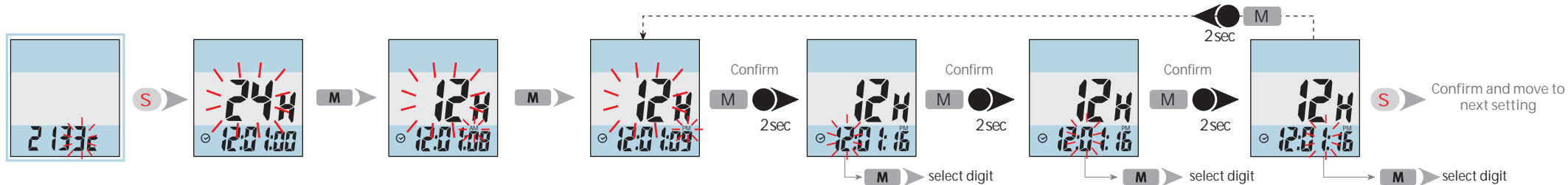

4 SETUP ODO (ACCUMULATED DISTANCE)

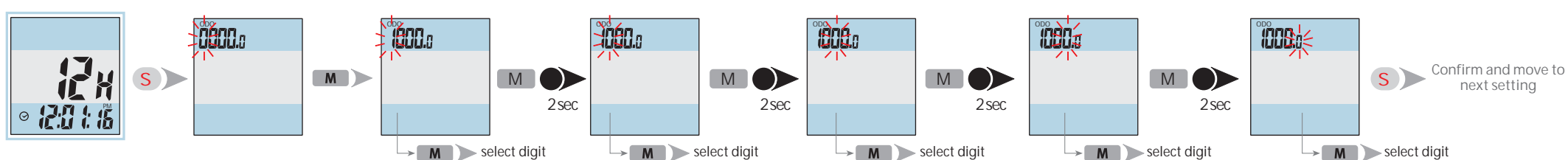

5 SETUP ART (ACCUMULATED RIDING TIME)

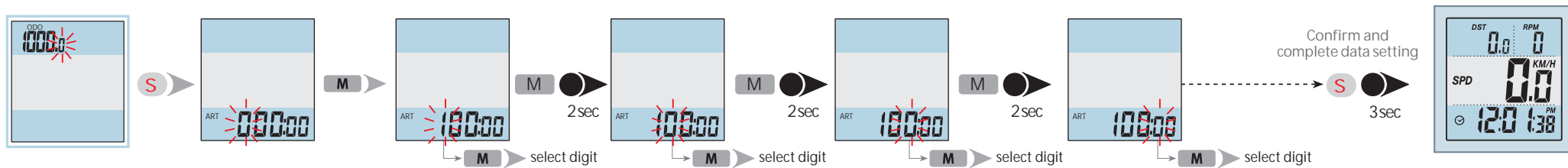

6 SCREEN DISPLAY (NON RIDING STATUS)

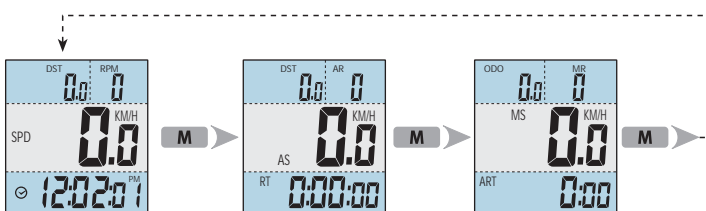

7 SCREEN DISPLAY (RIDING STATUS)

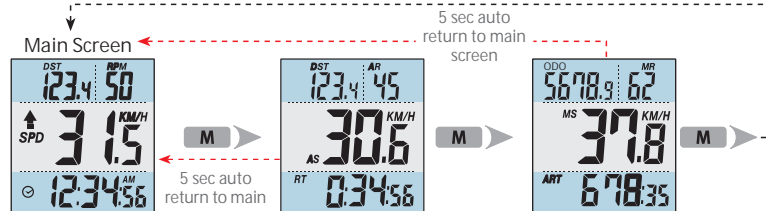

8 IMPORTANT NOTES

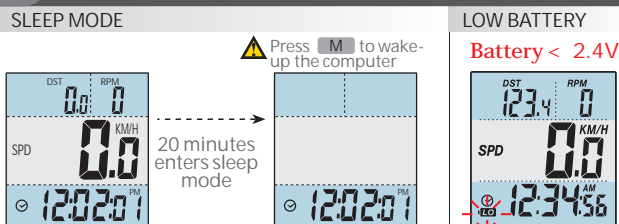

8 IMPORTANT NOTES (CONTINUED)

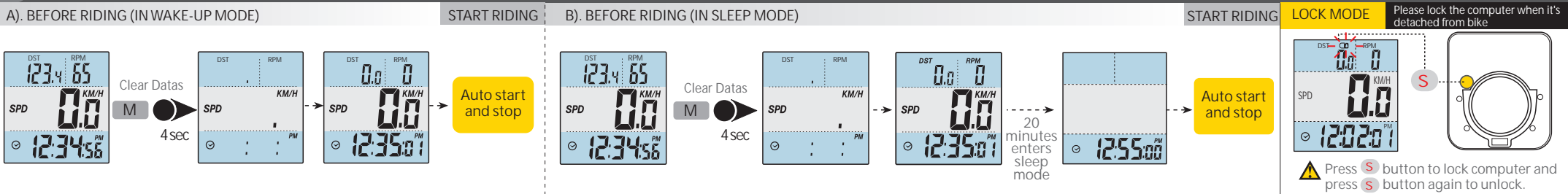

9 QUICK SETUP (KM/H or M/H selection is not available)

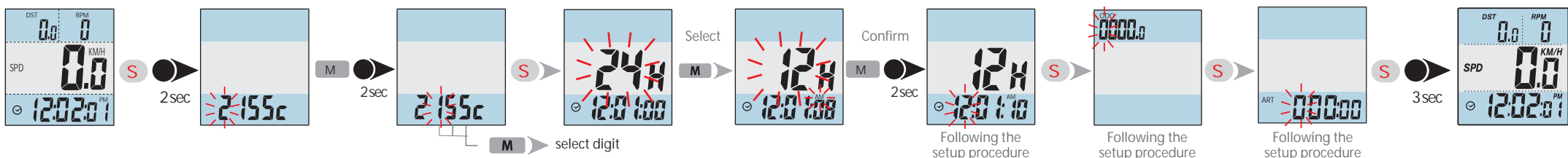

IMPORTANT NOTES

- CLEAR ALL DATA SETTING will clear all stored data.
- CLEAR ALL DATA SETTING is required during FIRST SETUP or BATTERY CHANGE.
- KM/H or M/H selection is only available from CLEAR ALL DATA SETTING.
- Before changing battery, write down stored data ODO and ART. All data will be cleared when replacing the battery, however, this computer will allow you to reenter your stored data.
- During non-riding status, if no button is touched for 20 minutes, the screen will go into Sleep Mode. Please press any button to start the computer before riding.
- During non-riding status, press S will lock the screen. Please press S again to unlock the screen before riding.

REBUILD KIT

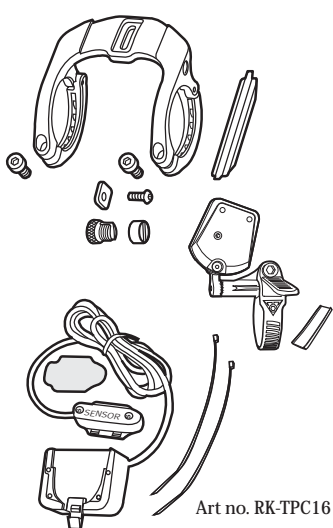

WARRANTY

2-year Warranty: All electronic and mechanical components against manufacturer defects only. Batteries are not covered under any implied warranty.

Warranty Claim Requirements
To obtain warranty service, you must have your original sales receipt. Items returned without a sales receipt will assume that the warranty begins on the date of manufacture. All warranties will be void if the product is damaged due to user crash, abuse, system alteration, modification, or used in any way not intended as described in this operating manual.

*The specifications and design are subject to change without notice.

Please contact your Topeak dealer with any questions.
For USA customer service call: 1-800-250-3068
www.topeak.com

Copyright © Topeak, Inc. 2011
M-TPC16-GB 02/11

OPTIONAL SPARE PARTS (INSTALLATION FOR DUAL AND SINGLE LIGHT)

