

Clifford Twp. (M. 338)

Morrisette Twp. (M. 374)

Kairine Twp. (M. 357)

Gauthier Twp. (M. 350)

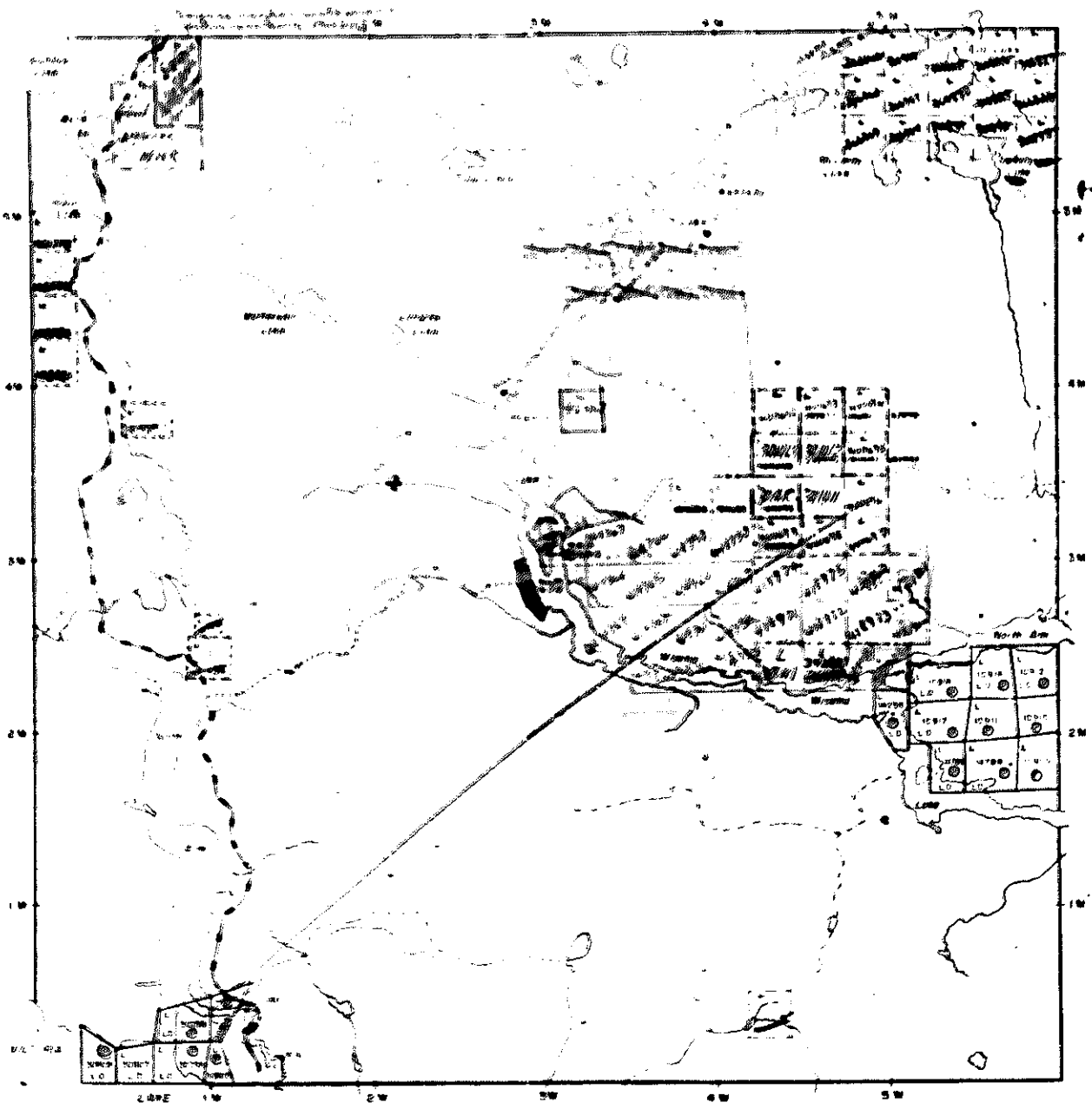

THE TOWNSHIP OF

ARNOLD

DISTRICT OF
TIMISKAMING

LARDER LAKE
MINING DIVISION

SCALE 1-INCH = 40 CHAINS

LEGEND

PATENTED LAND	⊙
CROWN LAND SALE	⊙
LEASES	⊙
LOCATED LAND	Loc.
LICENSE OF OCCUPATION	L.O.
MINING RIGHTS ONLY	M.R.O.
SURFACE RIGHTS ONLY	S.R.O.
ROADS	—
IMPROVED ROADS	—
KING'S HIGHWAYS	—
RAILWAYS	—
POWER LINES	—
MARSH OR MURKED	—
MINES	⊙
CANCELLED	C

NOTES

400' Surface Rights Reservation Around All Lakes And Rivers

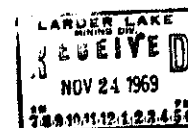

*Placed
June 6/75
by May 16/75*

PLAN NO. M. 321

DEPARTMENT OF MINES
- ONTARIO -

Clifford Twp. (M. 338)

THE TOWNSHIP OF
OF

ARNOLD

DISTRICT OF
TIMISKAMING

LARDER LAKE
MINING DIVISION

SCALE: 1-INCH = 40 CHAINS

LEGEND

PATENTED LAND	Ⓟ
CROWN LAND SALE	C.S.
LEASES	Ⓛ
LOCATED LAND	Loc.
LICENSE OF OCCUPATION	L.O.
MINING RIGHTS ONLY	M.R.O.
SURFACE RIGHTS ONLY	S.R.O.
ROADS	— — — — —
IMPROVED ROADS	— — — — —
KING'S HIGHWAYS	— — — — —
RAILWAYS	— — — — —
POWER LINES	— — — — —
MARSH OR MUSKEG	Ⓜ
MINES	Ⓜ
CANCELLED	Ⓧ

NOTES

400' Surface Rights Reservation Around All
Lakes And Rivers

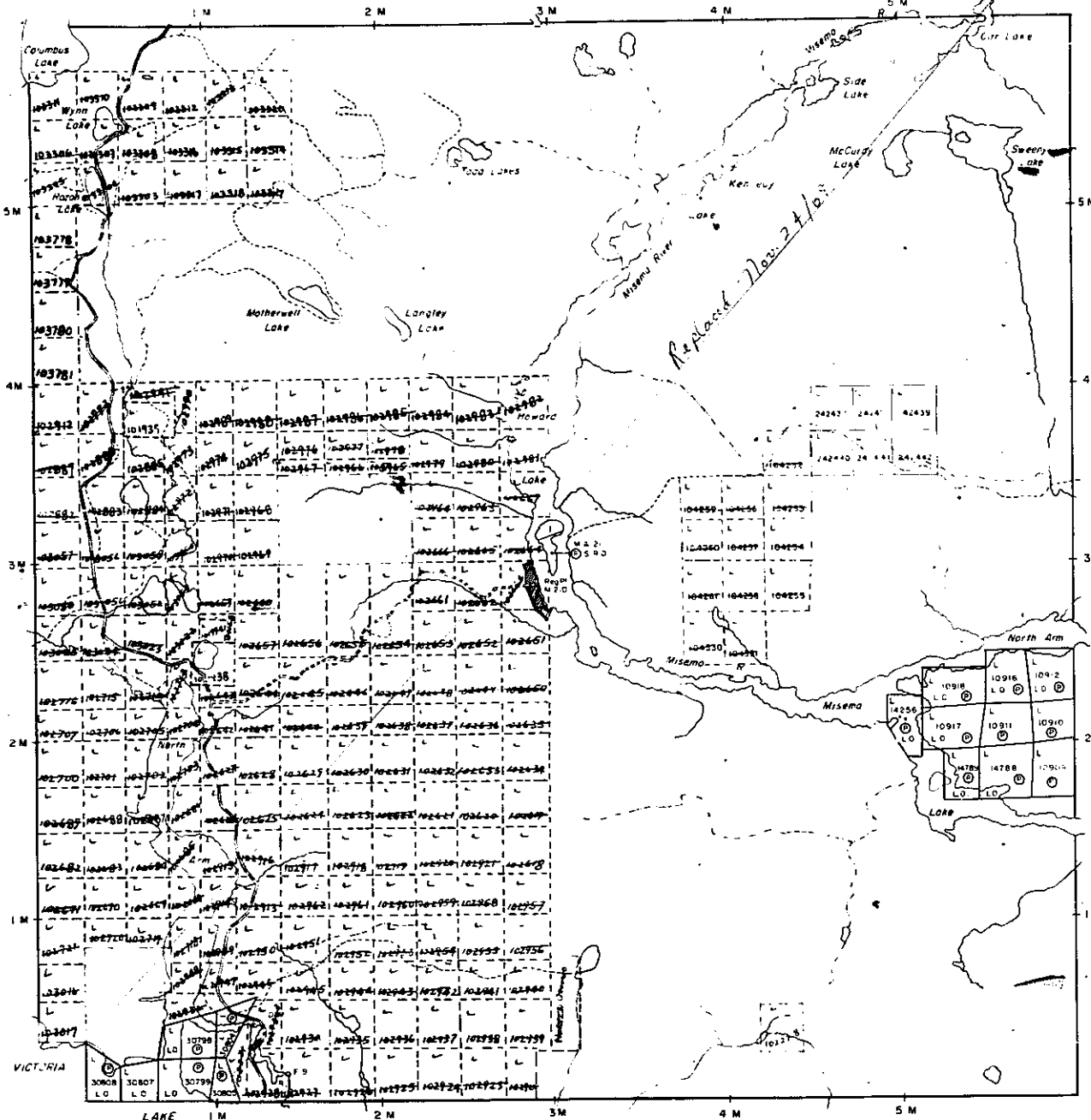
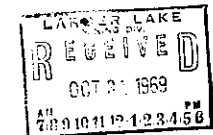

Morrisette Twp. (M. 374)

Katrine Twp. (M. 357)

Gauthier Twp. (M. 350)

PLAN NO. **M. 321**

DEPARTMENT OF MINES

— ONTARIO —

Clifford Twp. (M.338)

THE TOWNSHIP OF
OF
ARNOLD

DISTRICT OF
TIMISKAMING

LARDER LAKE
MINING DIVISION

SCALE: 1-INCH = 40 CHAINS

LEGEND

PATENTED LAND	⊙
CROWN LAND SALE	C.S.
LEASES	⊕
LOCATED LAND	Loc.
LICENSE OF OCCUPATION	L.O.
MINING RIGHTS ONLY	M.R.O.
SURFACE RIGHTS ONLY	S.R.O.
ROADS	—
IMPROVED ROADS	—
KING'S HIGHWAYS	—
RAILWAYS	—
POWER LINES	—
MARSH OR MUSKOG	—
MINES	⋈
CANCELLED	C

NOTES

400' Surface Rights Reservation Around All
Lakes And Rivers

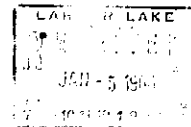

PLAN. NO. **M.321**

DEPARTMENT OF MINES

- ONTARIO -

Morrisette Twp.(M.374)

Katrine Twp.(M.357)

Gauthier Twp.(M.350)

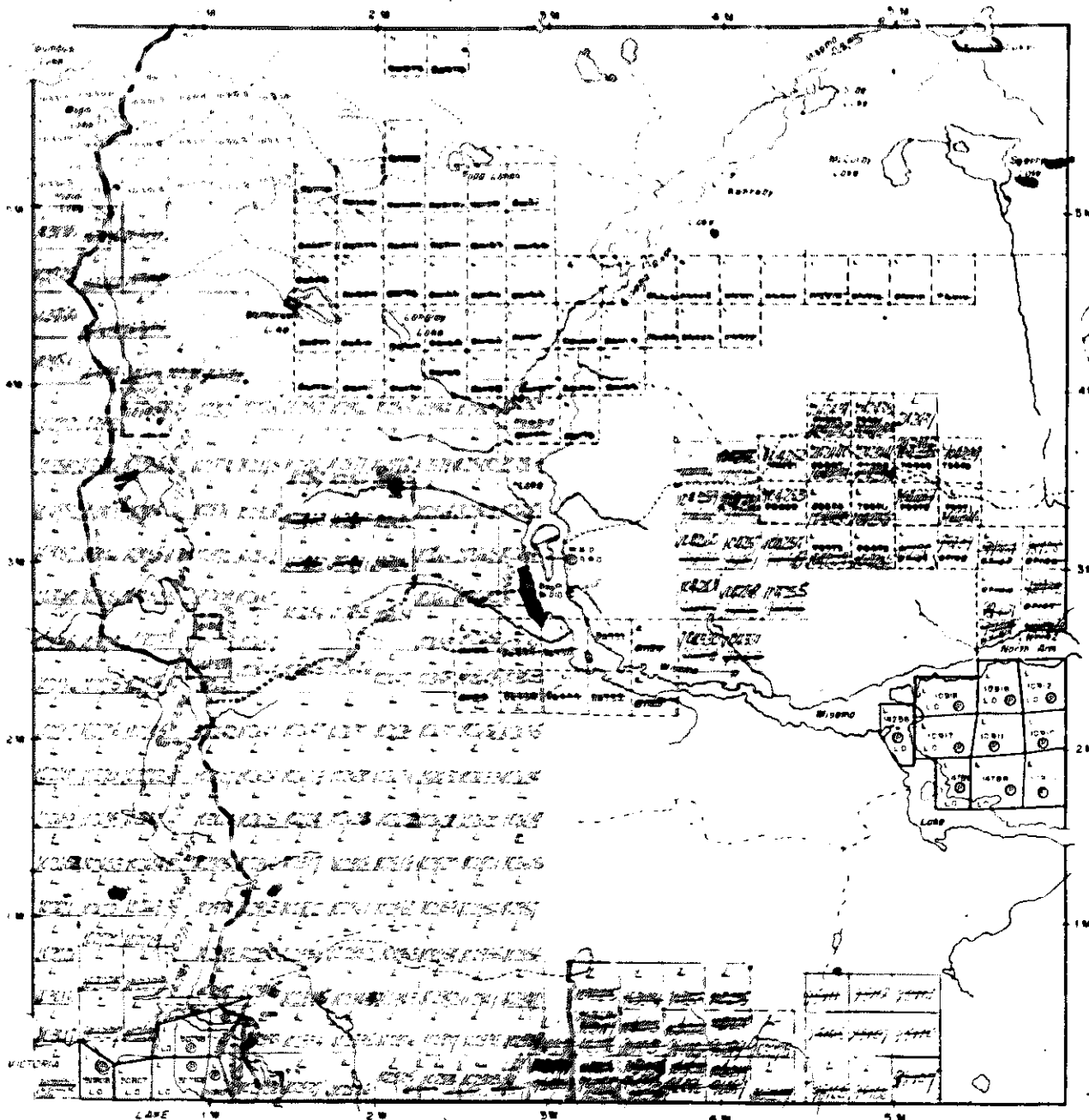

Clifford Twp. (M.338)

Replaced
Feb. 11/76.

THE TOWNSHIP
OF

ARNOLD

DISTRICT OF
TIMISKAMING

LARDER LAKE
MINING DIVISION

SCALE: 1-INCH = 40 CHAINS

LEGEND

PATENTED LAND	⊙
CROWN LAND SALE	C.S.
LEASES	⊖
LOCATED LAND	Loc.
LICENSE OF OCCUPATION	L.O.
MINING RIGHTS ONLY	M.R.O.
SURFACE RIGHTS ONLY	S.R.O.
ROADS	—
IMPROVED ROADS	—
KING'S HIGHWAYS	—
RAILWAYS	—
POWER LINES	—
MARSH OR MUSKEG	—
MINES	—
CANCELLED	—

NOTES

400' Surface Rights Reservation Around All
Lakes And Rivers

Areas withdrawn from staking under Section
43 of the Mining Act, R.S.O. 1970

File	Date	Disposition
163497	APRIL 17/70	S.R.O.
172213	21/3/74	S.R.O.



PLAN NO. **M.321**

ONTARIO
MINISTRY OF NATURAL RESOURCES
SUPERVISOR AND TRAINING BRANCH

Morrisette Twp. (M.374)

Kairine Twp. (M.357)

Gauthier Twp. (M.350)

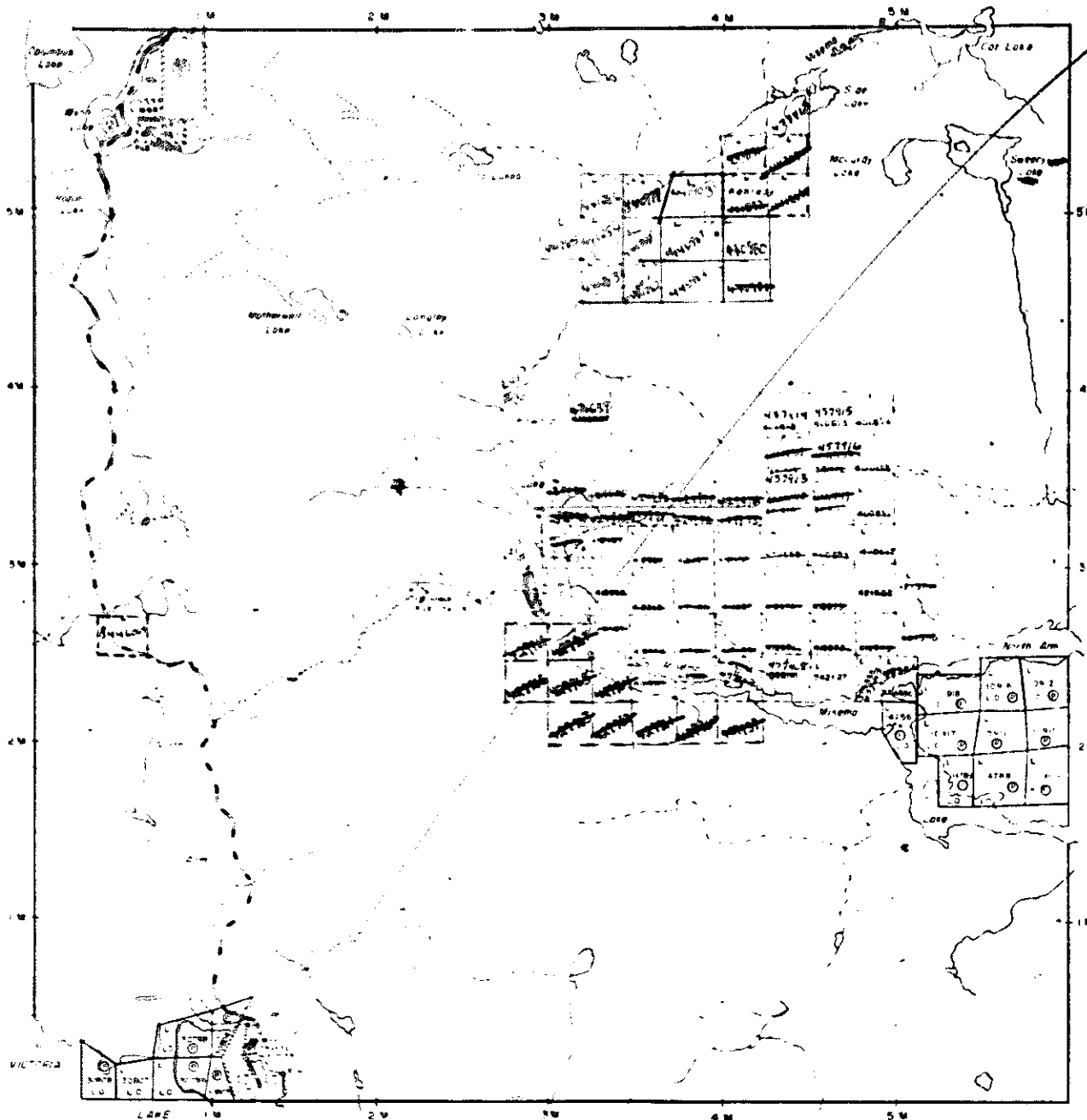

Clifford Twp. (M.338)

THE TOWNSHIP OF
OF
ARNOLD

DISTRICT OF
TIMISKAMING

LARDER LAKE
MINING DIVISION

SCALE: 1-INCH = 40 CHAINS

LEGEND

PATENTED LAND	Ⓟ
CROWN LAND SALE	C.S.
LEASES	Ⓛ
LOCATED LAND	Loc.
LICENSE OF OCCUPATION	L.O.
MINING RIGHTS ONLY	M.R.O.
SURFACE RIGHTS ONLY	S.R.O.
ROADS	—
IMPROVED ROADS	—
KING'S HIGHWAYS	—
RAILWAYS	—
POWER LINES	—
MARSH OR MUSKEG	—
MINES	Ⓧ
CANCELLED	C

NOTES

400' Surface Rights Reservation Around All
Lakes And Rivers

MINING RECORDER
RECORDED
SEP 23 1963
LARDER LAKE - ONT.

Morrisette Twp.(M.374)

Kairine Twp.(M.357)

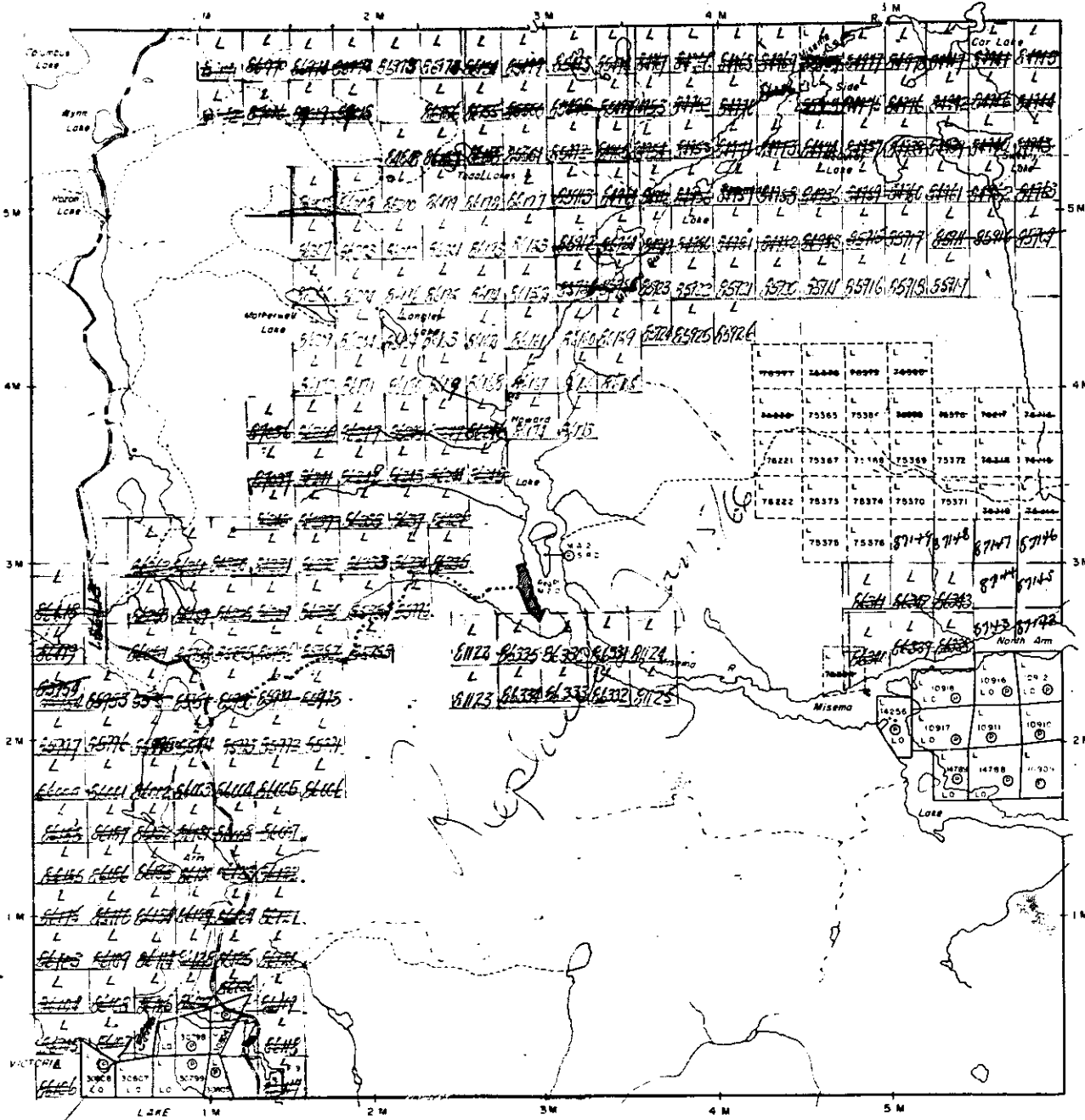

Gauthier Twp.(M.350)

PLAN NO. **M.321**

DEPARTMENT OF MINES

- ONTARIO -

31

LARDER LAKE MINING DIVISION

TOWNSHIP OF

ARNOLD

Scale 40 chains to one inch

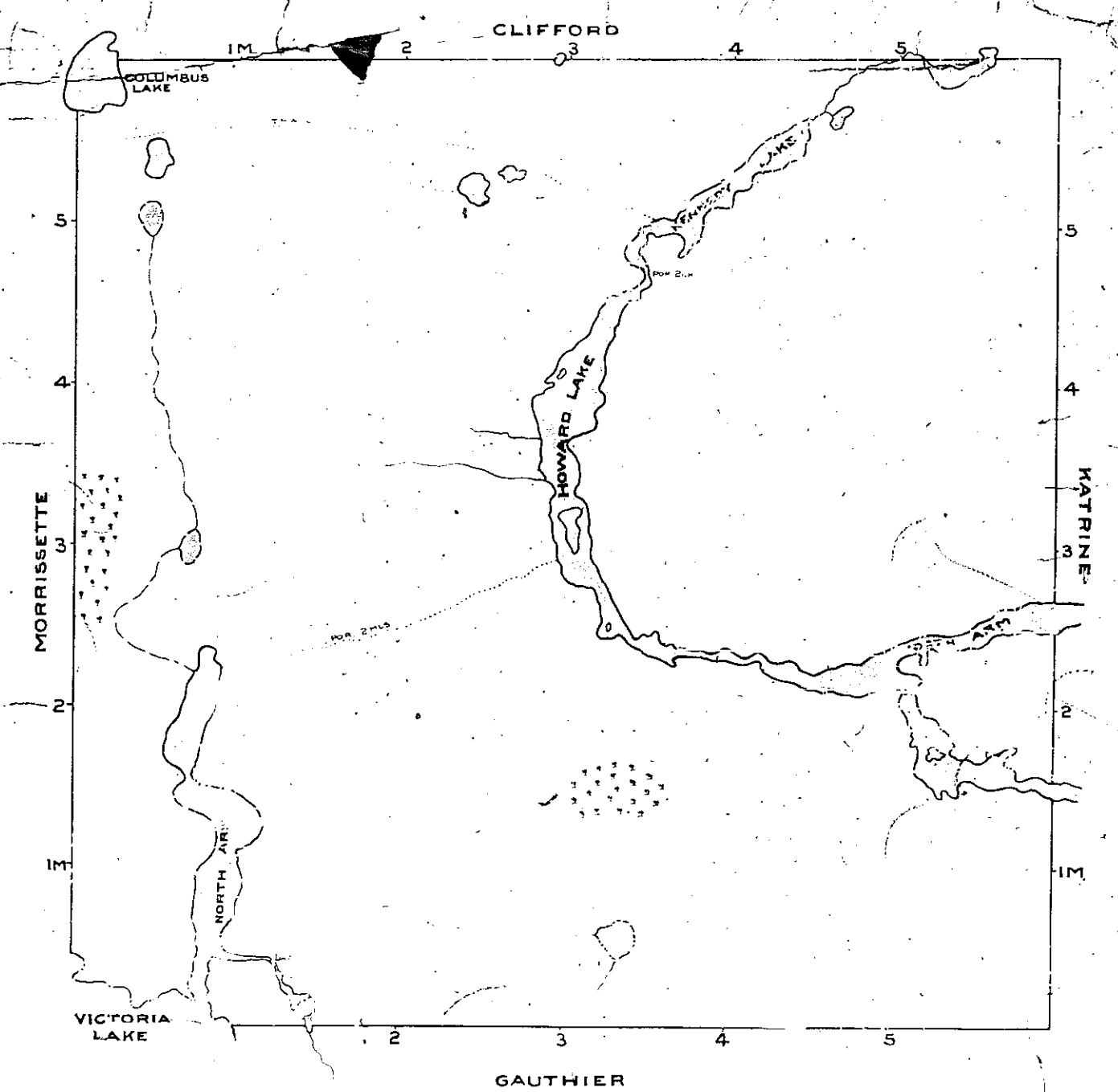

Dept. of Mines
LARDER LAKE MINING DIVISION

TOWNSHIP OF

ARNOLD

Scale: 40 chains to one inch. 41-311

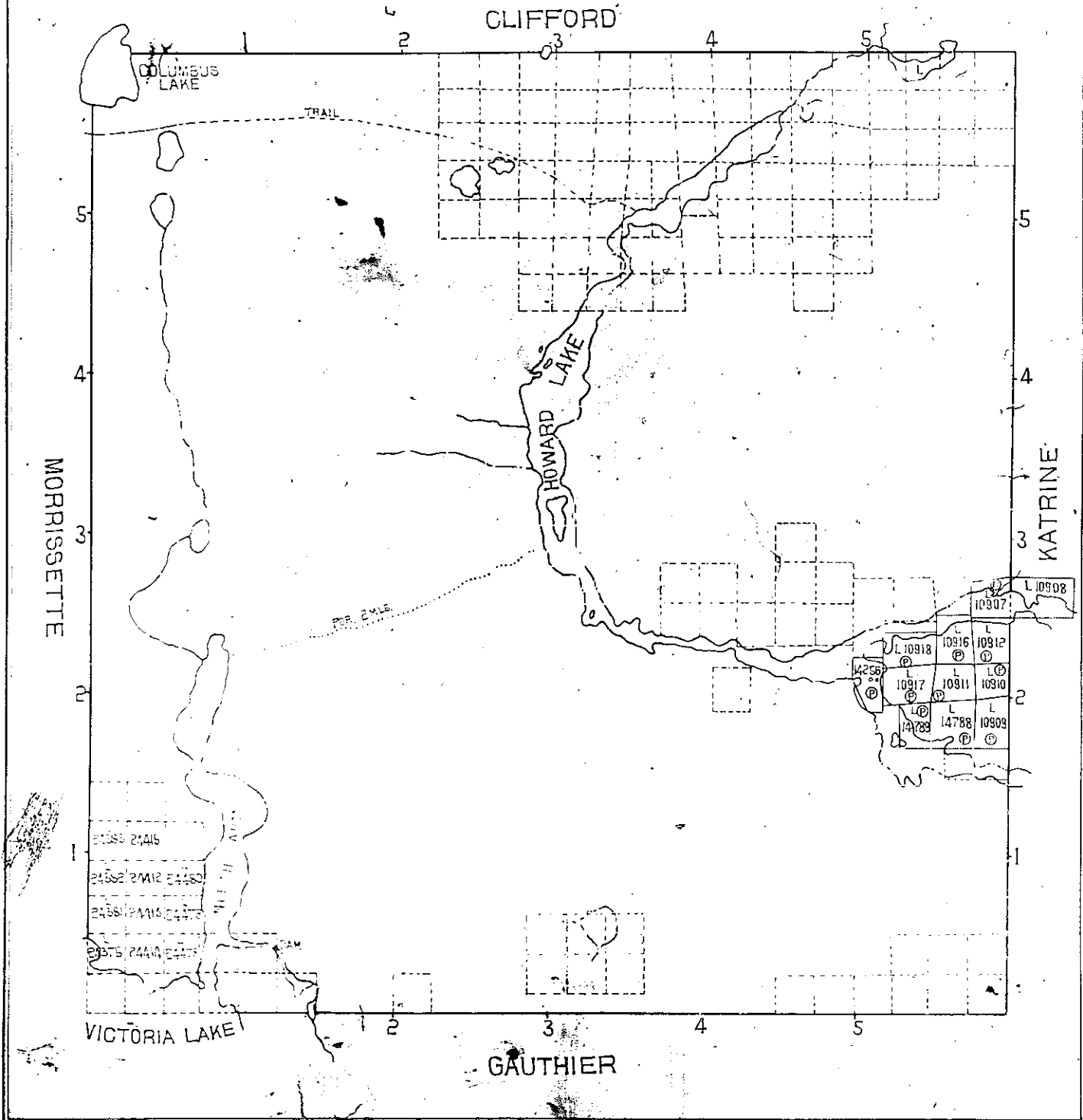

Dept. of Mines
LARDER LAKE MINING DIVISION

TOWNSHIP OF

ARNOLD

Scale: 40 chains to one inch.

M-321

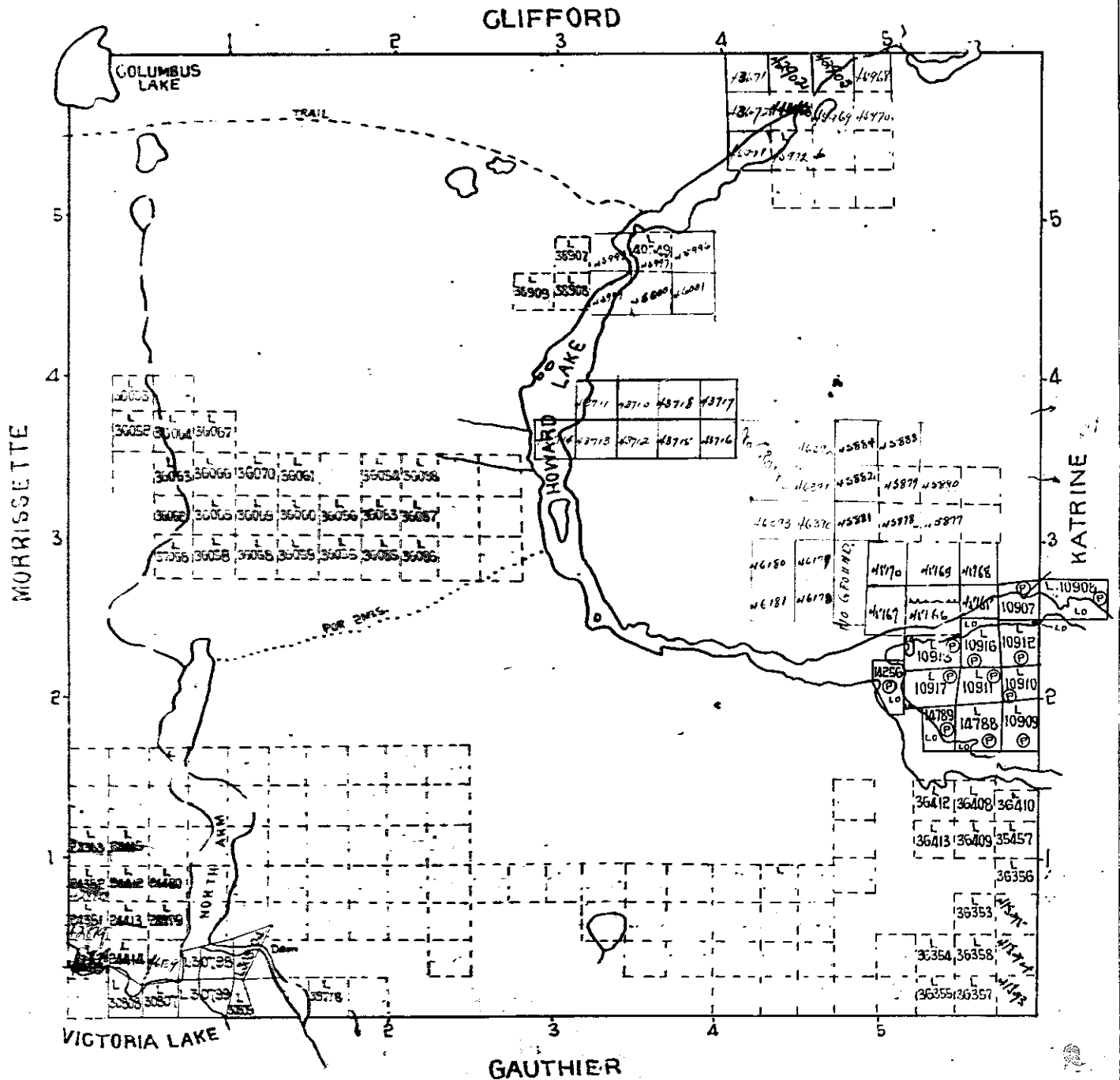

Dept. of Mines
LARDER LAKE MINING DIVISION

TOWNSHIP OF

ARNOLD

Scale: 40 chains to one inch.

M-321

GLIFFORD

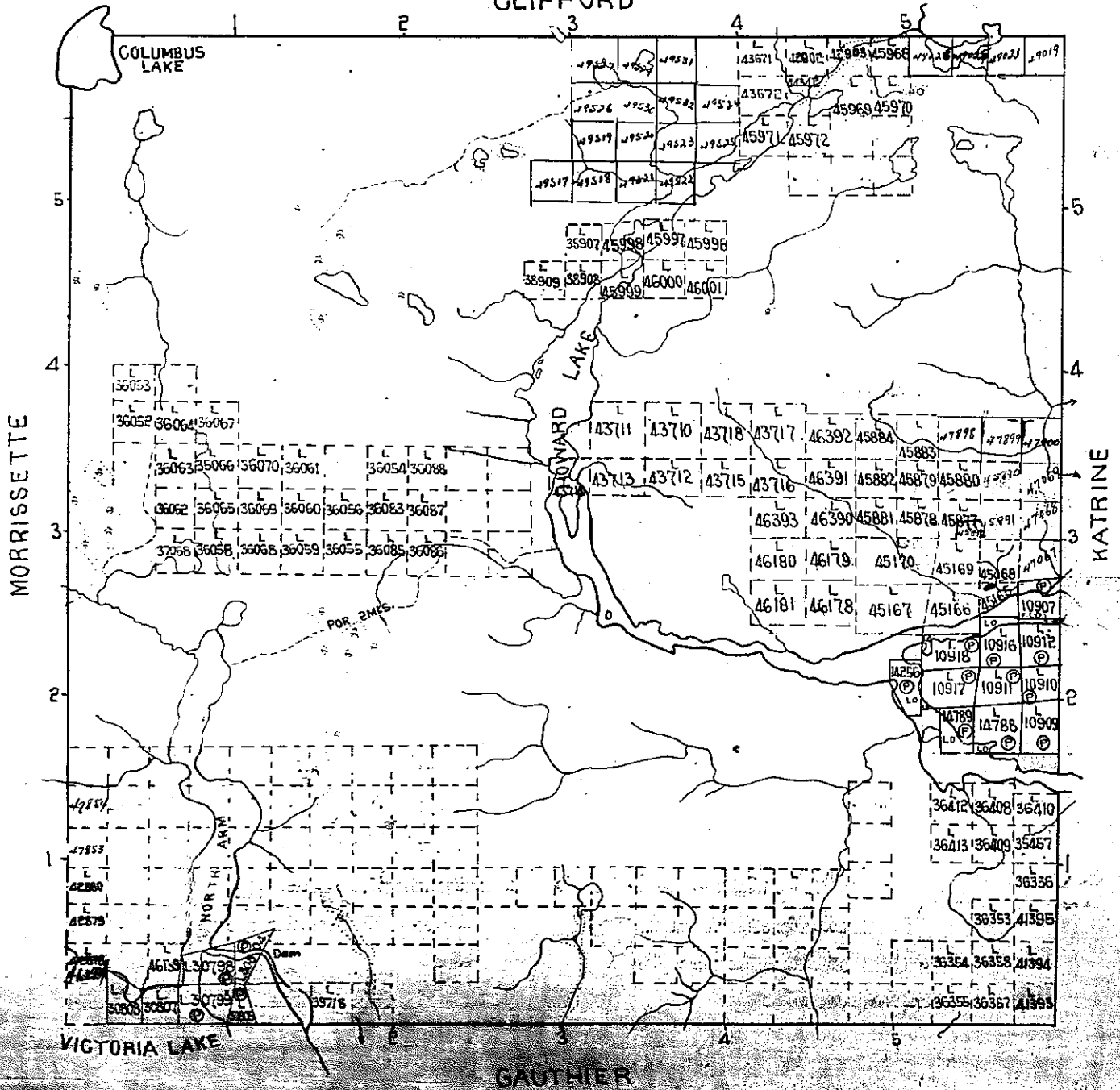

— PLAN OF —
ARNOLD TWP.
 LARDER LAKE MINING DIVISION.
 DISTRICT OF TIMISKAMING.

Scale, 40 chains to an inch.
CLIFFORD TWP.

M-321

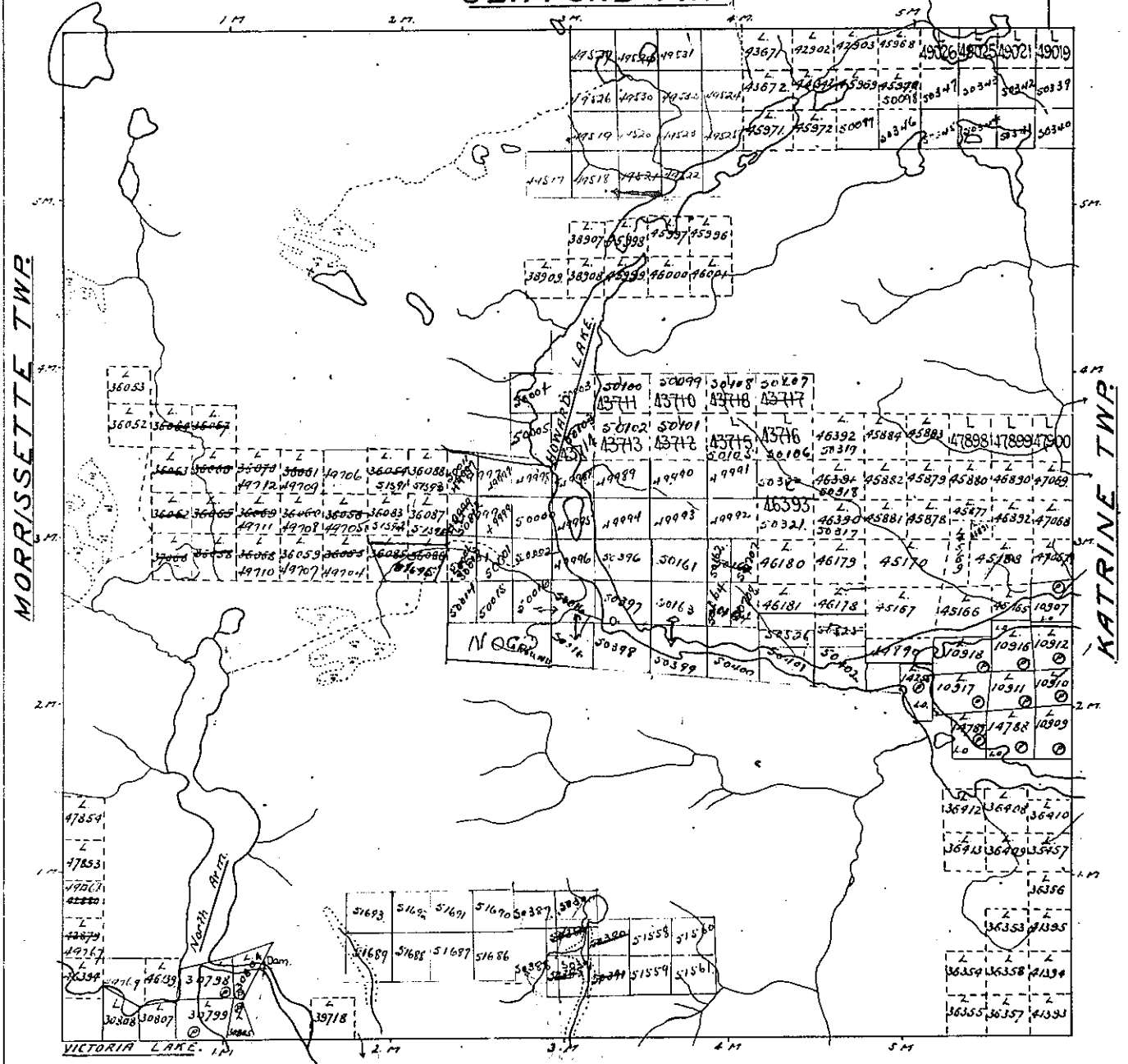
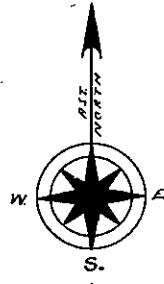

ARNOLD TWP.

321

ARNOLD

LARDER LAKE MINING DIVISION

DISTRICT OF TIMISKAMING

Scale: 40 Chains - 1 inch

M-321

CLIFFORD

North Ast

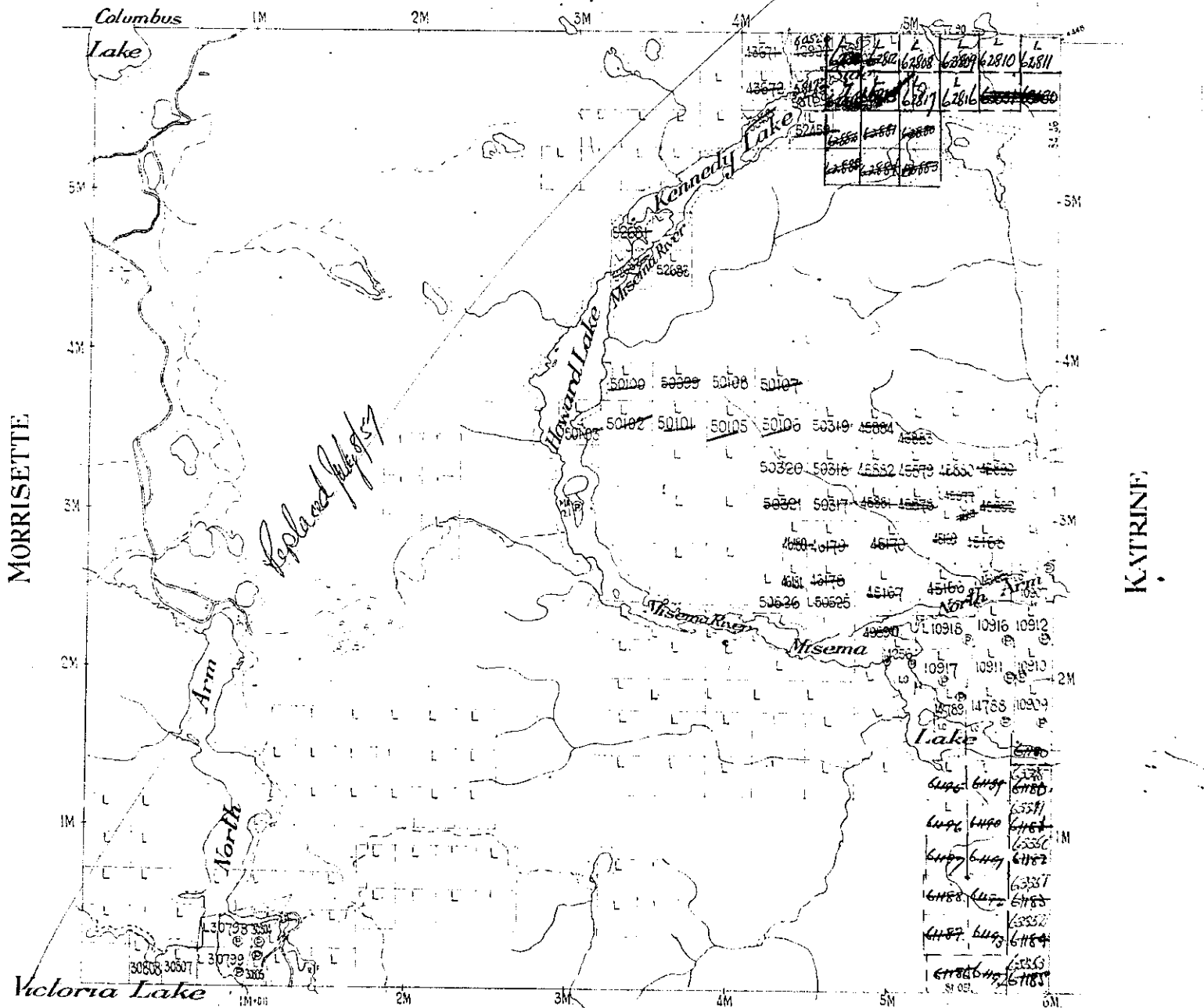

GAUTHIER

ARNOLD

LARDER LAKE MINING DIVISION

DISTRICT OF TIMISKAMING

Scale: 40 Chains - 1 Inch

M-321

CLIFFORD

MINING RECORDS
RECEIVED
JUL 8 1957
SWANSEA - ONT.

MORRISSETTE

KATRINE

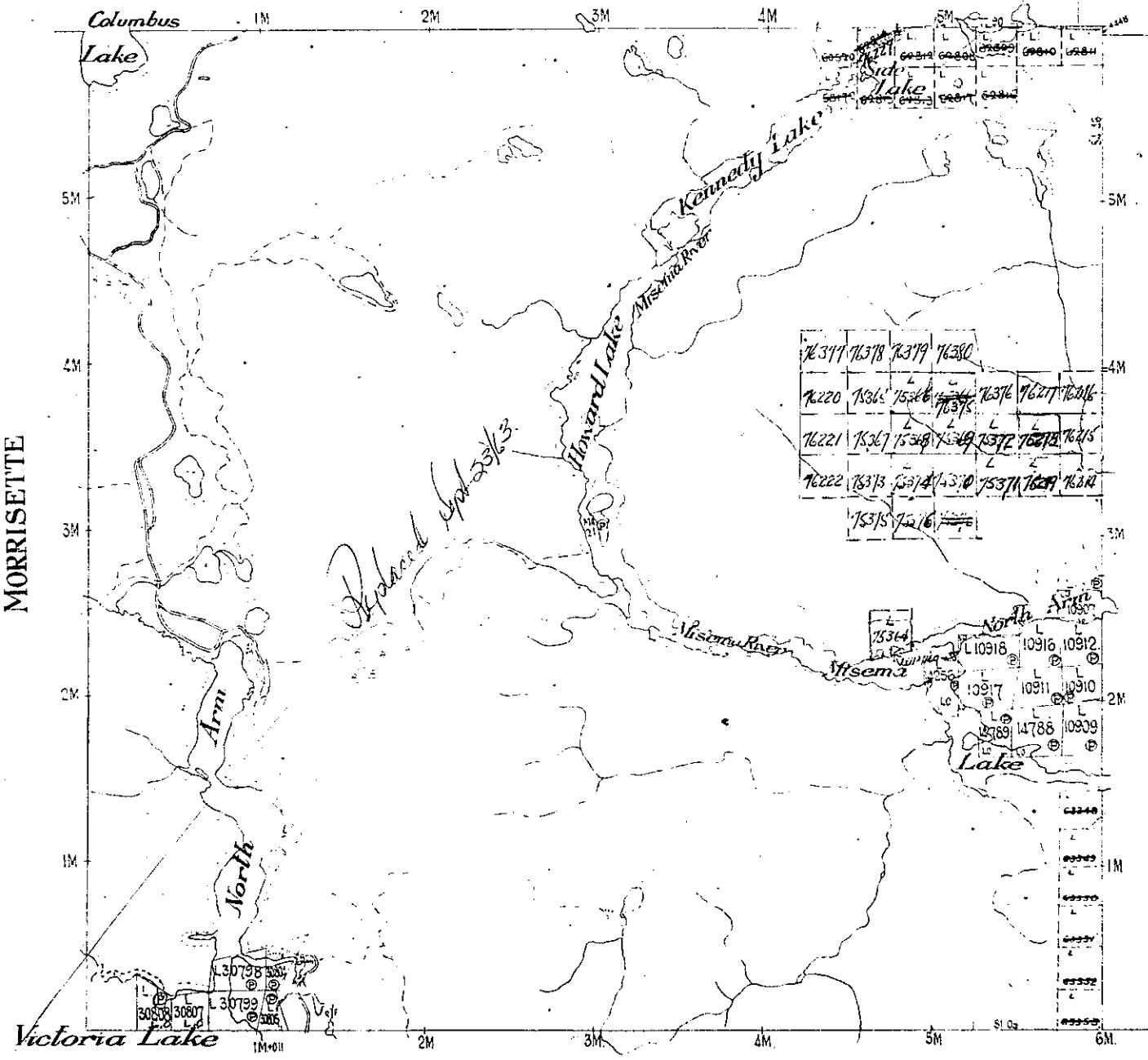

GAUTHIER

Clifford Twp.

Morrisette Twp.

Katrine Twp.

Gauthier Twp.

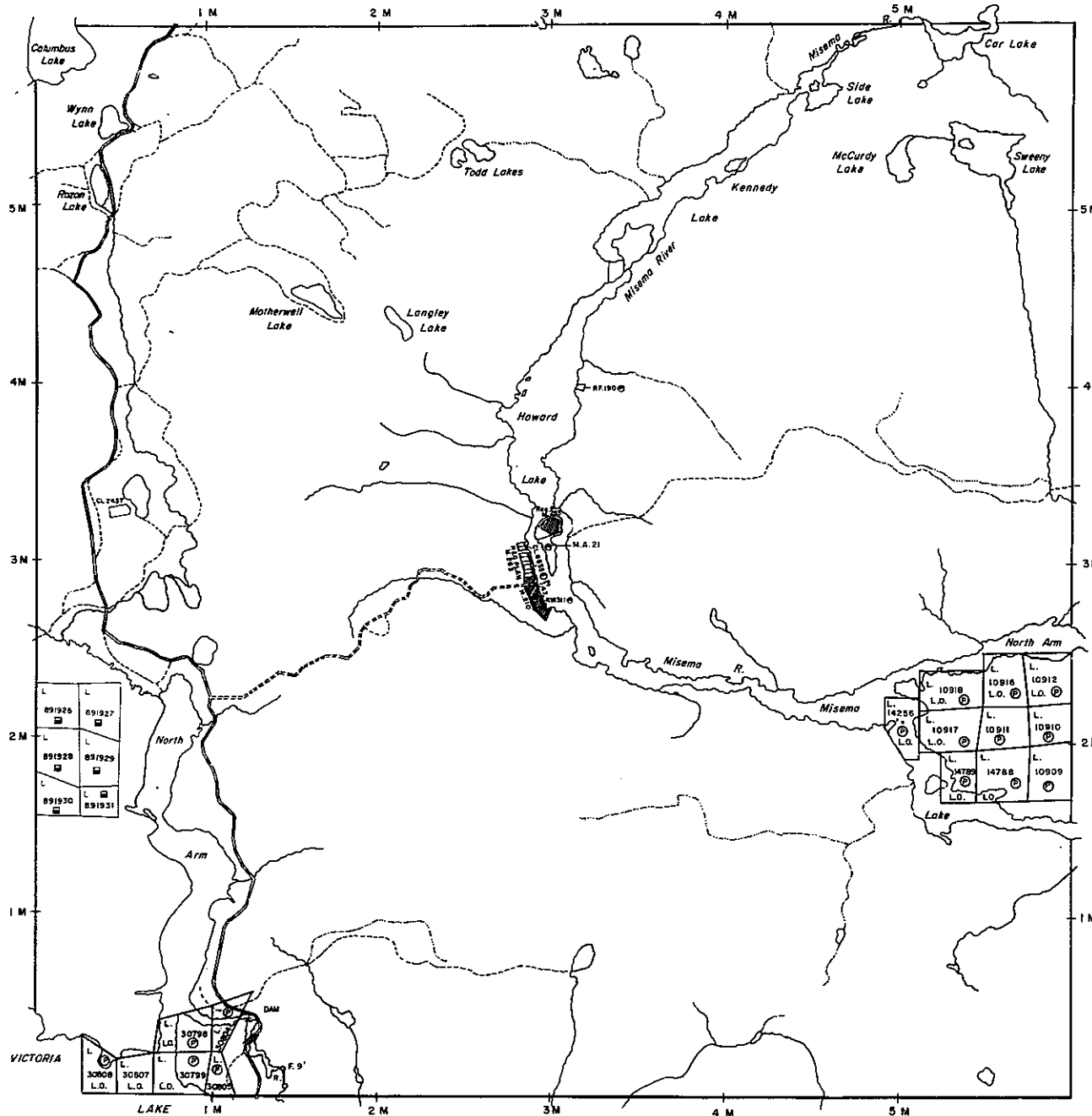

THE TOWNSHIP OF

ARNOLD

DISTRICT OF
TIMISKAMING

LARDER LAKE
MINING DIVISION

SCALE: 1-INCH = 40 CHAINS

LEGEND

PATENTED LAND	⊙
CROWN LAND SALE	C.S.
LEASES	⊕
LOCATED LAND	Loc.
LICENSE OF OCCUPATION	L.O.
MINING RIGHTS ONLY	M.R.O.
SURFACE RIGHTS ONLY	S.R.O.
ROADS	—
IMPROVED ROADS	—
KING'S HIGHWAYS	—
RAILWAYS	—
POWER LINES	—
MARSH OR MUSKEG	—
MINES	⋈
CANCELLED	C.
PATENT SURFACE RIGHTS ONLY	⊙

NOTES

400' Surface Rights Reservation along the shores of all lakes and rivers

Areas withdrawn from staking under Section 43 of the Mining Act (R.S.O. 1970).

Order No.	File	Date	Disposition
-----------	------	------	-------------

PLAN NO. M.321

ONTARIO
MINISTRY OF NATURAL RESOURCES

SURVEYS AND MAPPING BRANCH

W35M

TWP 35 N

W35M

THE INFORMATION THAT APPEARS ON THIS MAP HAS BEEN COMPILED FROM VARIOUS SOURCES, AND ACCURACY IS NOT GUARANTEED. THOSE WISHING TO STAKE MINING CLAIMS SHOULD CONSULT WITH THE MINING RECORDER, MINISTRY OF NORTHERN DEVELOPMENT AND MINES, FOR ADDITIONAL INFORMATION ON THE STATUS OF THE LANDS SHOWN HEREON.

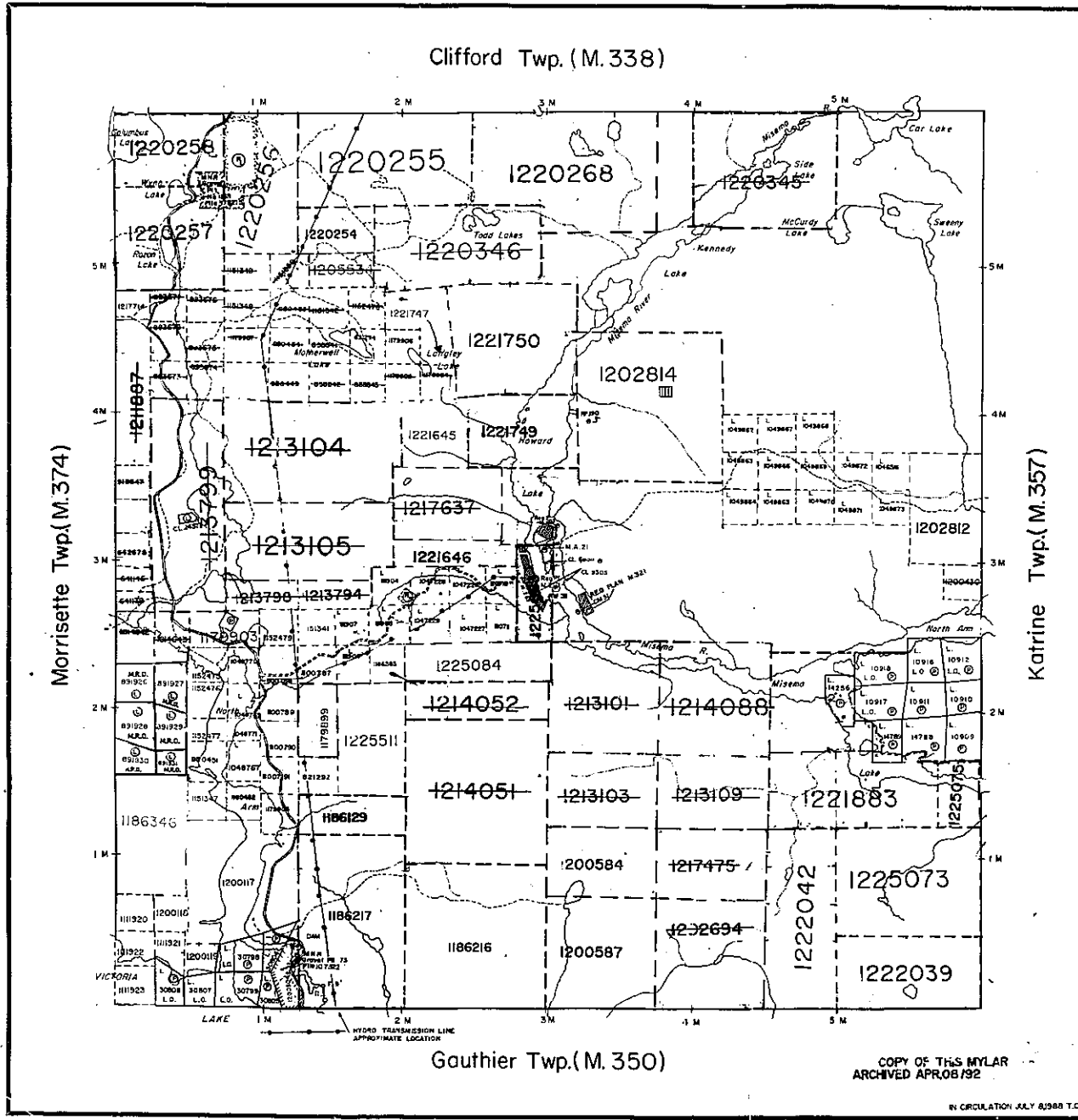

THE TOWNSHIP OF

ARNOLD

DISTRICT OF
TIMISKAMING

LARDER LAKE
MINING DIVISION

SCALE: 1-INCH = 40 CHAINS

LEGEND

PATENTED LAND	⊙
CROWN LAND SALE	⊙
LEASES	⊙
LOCATED LAND	⊙
LICENSE OF OCCUPATION	⊙
MINING RIGHTS ONLY	M.R.O.
SURFACE RIGHTS ONLY	S.R.O.
ROADS	
IMPROVED ROADS	
KING'S HIGHWAYS	
RAILWAYS	
POWER LINES	
MARSH OR MUSKEG	
MINES	
CANCELLED PATENT SURFACE RIGHTS ONLY	

NOTES

400' Surface Rights Reservation along the shores of all lakes and rivers

Areas withdrawn from staking under Section 36 of the Mining Act (R.S.O. 1980).
 Order No. File Date Disposition

- ① SURFACE RIGHTS WITHDRAWN FROM STAKING SECTION 43 ORDER (R.S.O.1970) FILE NO. 623437
- ② SURFACE RIGHTS WITHDRAWN FROM STAKING SECTION 43 ORDER (R.S.O.1970) ORDER W.32/179
- ③ ORDER W 32/75 1722/3 MAY 4/79 S.R.O.
- ④ SURFACE + MINING RIGHTS WITHDRAWN FROM STAKING section 36/80 order NO. W/32/488 ORDER NO. 0-34/88 OPENS W/32/88
- ⑤ SURFACE + MINING RIGHTS WITHDRAWN FROM STAKING section 36/80 ORDER NO. W/32/688R 0-07/88C OPENS W-33/88R
- ⑥ ORDER #0-L-20/1969 ORDER PART W-L-33/19/68R
- ⑦ PROPOSED CROWN SUBDIVISION
- ⑧ MINING & SURFACE RIGHTS WITHDRAWN FROM STAKING SECTION 35, THE MINING ACT RSO 1990, W.L. 30794 RCR
- ⑨ ORDER #0-L-19/1968 ORDER PART W-L-33/75/68R

PLAN NO. **M.321**

MINISTRY OF
NORTHERN DEVELOPMENT
AND MINES

Clifford Twp. (M.338)

Morrisette Twp. (M.374)

Katrine Twp. (M.357)

Gauthier Twp. (M.350)

COPY OF THIS MYLAR
ARCHIVED APR 08 1992

IN CIRCULATION JULY 8/1988 T.O.

NOTICE !!!

THIS TOWNSHIP AREA FALLS WITHIN THE TIMISKAMING MANAGEMENT UNIT AND MAY BE SUBJECT TO FORESTRY OPERATIONS. THE MNR UNIT FORESTER FOR THIS AREA CAN BE CONTACTED AT: P.O. BOX 129 SWASTKA, ONT.

ARCHIVED APR. 16, 1994
ARCHIVED MAY 13/96

W35M

TWP 35 N

W35M

Clifford Twp. (M.338)

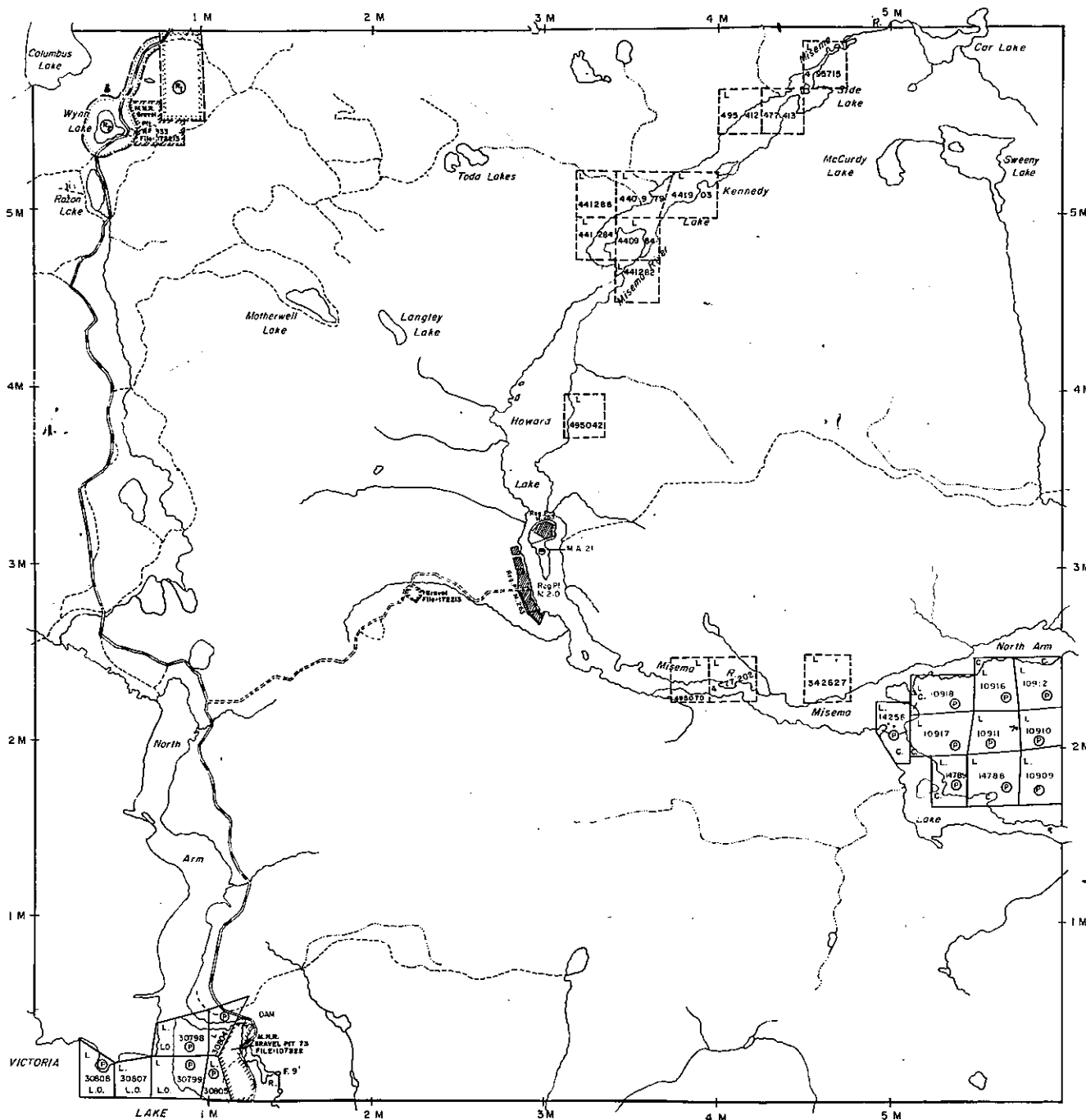

THE TOWNSHIP
OF

ARNOLD

DISTRICT OF
TIMISKAMING

LARDER LAKE
MINING DIVISION

SCALE: 1-INCH 40 CHAINS

LEGEND

PATENTED LAND	Ⓟ
CROWN LAND SALE	C.S.
LEASES	Ⓞ
LOCATED LAND	Loc.
LICENSE OF OCCUPATION	L.O.
MINING RIGHTS ONLY	M.R.O.
SURFACE RIGHTS ONLY	S.R.O.
ROADS	—
IMPROVED ROADS	—
KING'S HIGHWAYS	—
RAILWAYS	—
POWER LINES	—
MARSH OR MUSKEG	—
MINES	⚡
CANCELLED	—
PATENT SURFACE RIGHTS ONLY	—

NOTES

400' Surface Rights Reservation along the shores of all lakes and rivers

Areas withdrawn from staking under Section 43 of the Mining Act (R.S.O. 1970).

Order No.	File	Date	Disposition
Ⓟ W. 9/74	165497	APRIL 17/70	S.R.O.
Ⓞ W. 9/74	172213	MARCH 21/74	S.R.O.



PLAN NO. M.321

ONTARIO
MINISTRY OF NATURAL RESOURCES

Morrisette Twp.(M.374)

Katrine Twp.(M.357)

Gauthier Twp.(M.350)

Clifford Twp. (M. 338)

THE TOWNSHIP
OF

ARNOLD

DISTRICT OF
TIMISKAMING

LARDER LAKE
MINING DIVISION

SCALE: 1 INCH = 40 CHAINS

LEGEND

PATENTED LAND	⊙
CROWN LAND SALE	C.S.
LEASES	⊕
LOCATED LAND	Loc.
LICENSE OF OCCUPATION	L.O.
MINING RIGHTS ONLY	M.R.O.
SURFACE RIGHTS ONLY	S.F.O.
ROADS	—
IMPROVED ROADS	—
KING'S HIGHWAYS	—
RAILWAYS	—
POWER LINES	—
MARSH OR MUSKES	—
MINES	⚡
CANCELLED	⊖

NOTES

400' Surface Rights Reservation Argand All
Lakes And Rivers

Areas withdrawn from staking under Section
43 of the Mining Act. R.S.O. 1970

⊙	File	Date	Disposition
⊙	183497	APRIL 17/70	S.F.O.
⊙	172818	1/13/74	S.F.O.

— Timber Jan 3 1978
— Proposed Crown
Subdivision



PLAN NO M. 321

ONTARIO

Morrisette Twp. (M. 374)

Katrine Twp. (M. 357)

Gauthier Twp. (M. 350)

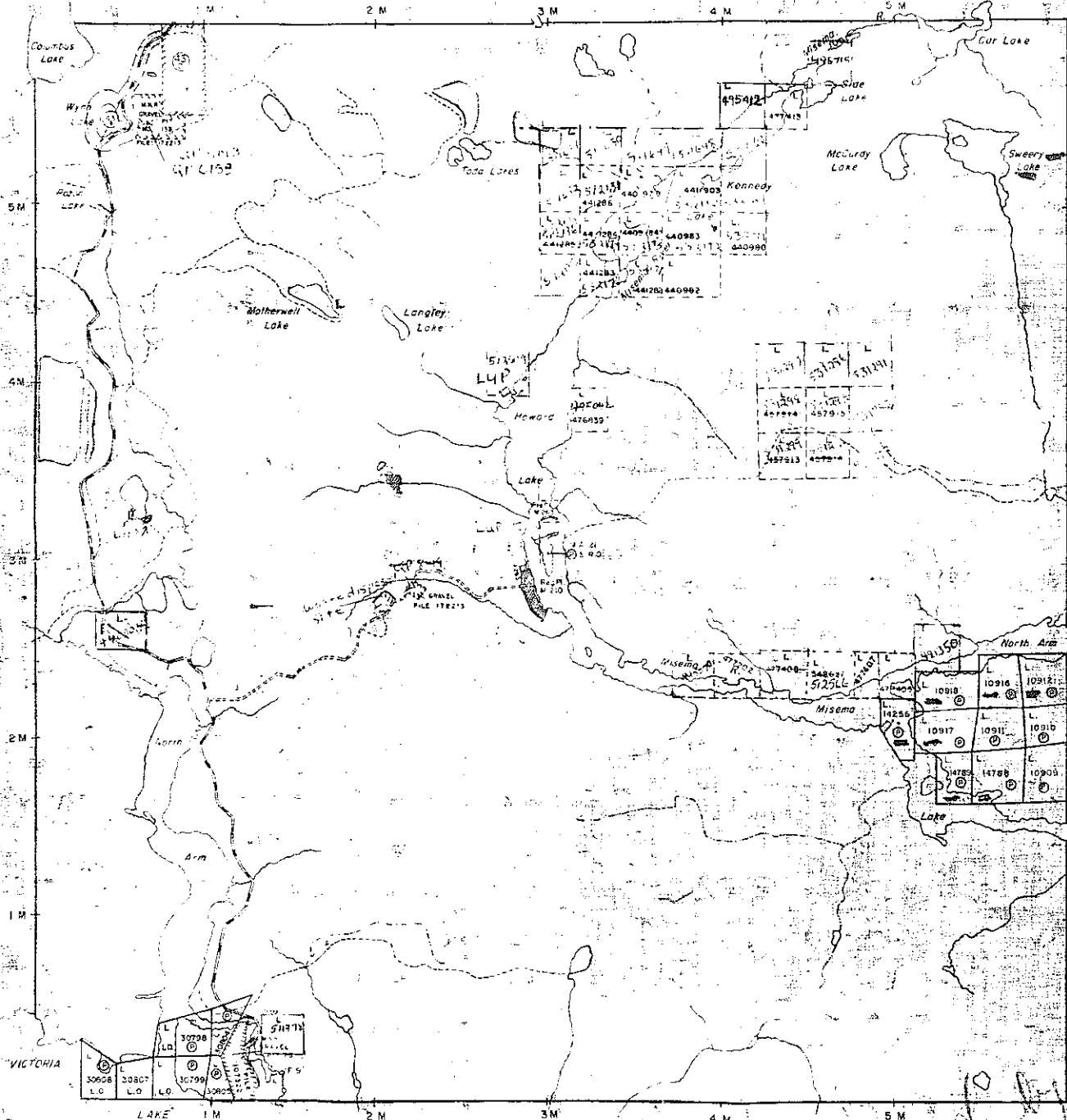

Relinquished by [unclear]

Clifford Twp. (M. 338)

Morrisette Twp. (M. 374)

Katrine Twp. (M. 357)

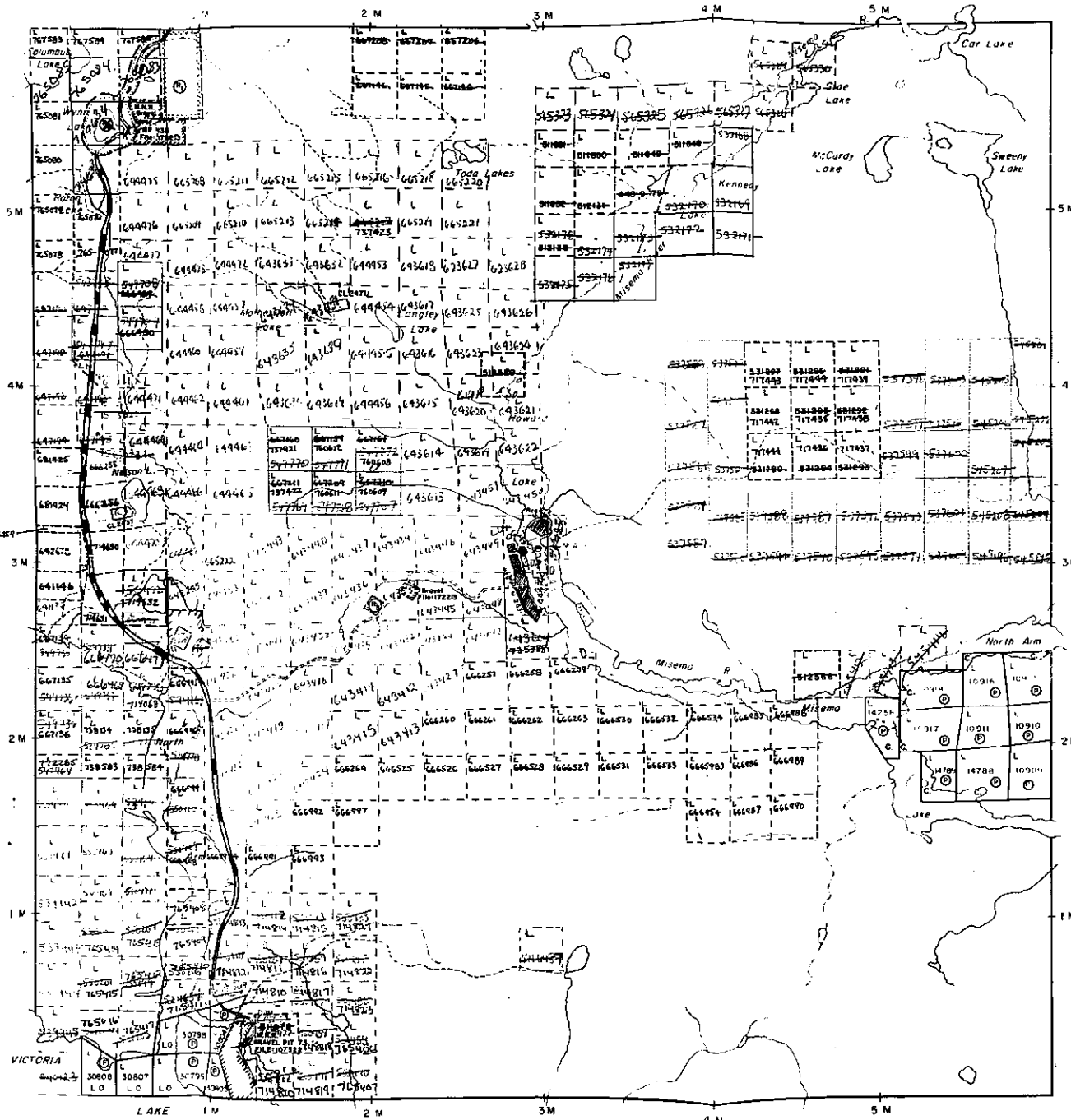

Gauthier Twp. (M. 350)

THE TOWNSHIP OF
OF

ARNOLD

DISTRICT OF
TIMISKAMING

LARDER LAKE
MINING DIVISION

SCALE: 1-INCH 40 CHAINS

LEGEND

PATENTED LAND	⊙
CROWN LAND SALE	C.S.
LEASES	⊕
LOCATED LAND	LOC
LICENSE OF OCCUPATION	LO
MINING RIGHTS ONLY	MRO
SURFACE RIGHTS ONLY	SRO
ROADS	—
IMPROVED ROADS	—
KING'S HIGHWAYS	—
RAILWAYS	—
POWER LINES	—
MARSH OR MUSKEG	—
MINES	—
CANCELLED	—
PATENT SURFACE RIGHTS ONLY	—

NOTES

40' surface rights reservation along the shore of all lakes and rivers.

Areas withdrawn from staking under Section 43 of the Mining Act (R.S.O. 1970).

Order No.	File	Date	Disposition
①	163497	APRIL 17/70	S.R.O.
②	173215	MARCH 27/74	S.R.O. rescinded Jan 17/81
③	N.R.M. 32/79	MAY 4/79	S.R.O.

PROPOSED CROWN SUBDIVISION

Proposed withdrawal, mining and surface rights for Transport Canada

Exp. August 7, 81
7/81

PLAN NO. **M. 321 #7**

ONTARIO
MINISTRY OF NATURAL RESOURCES
SURVEYS AND MAPPING BRANCH

Clifford Twp. (M.338)

Morrisette Twp.(M.374)

Katrine Twp.(M.357)

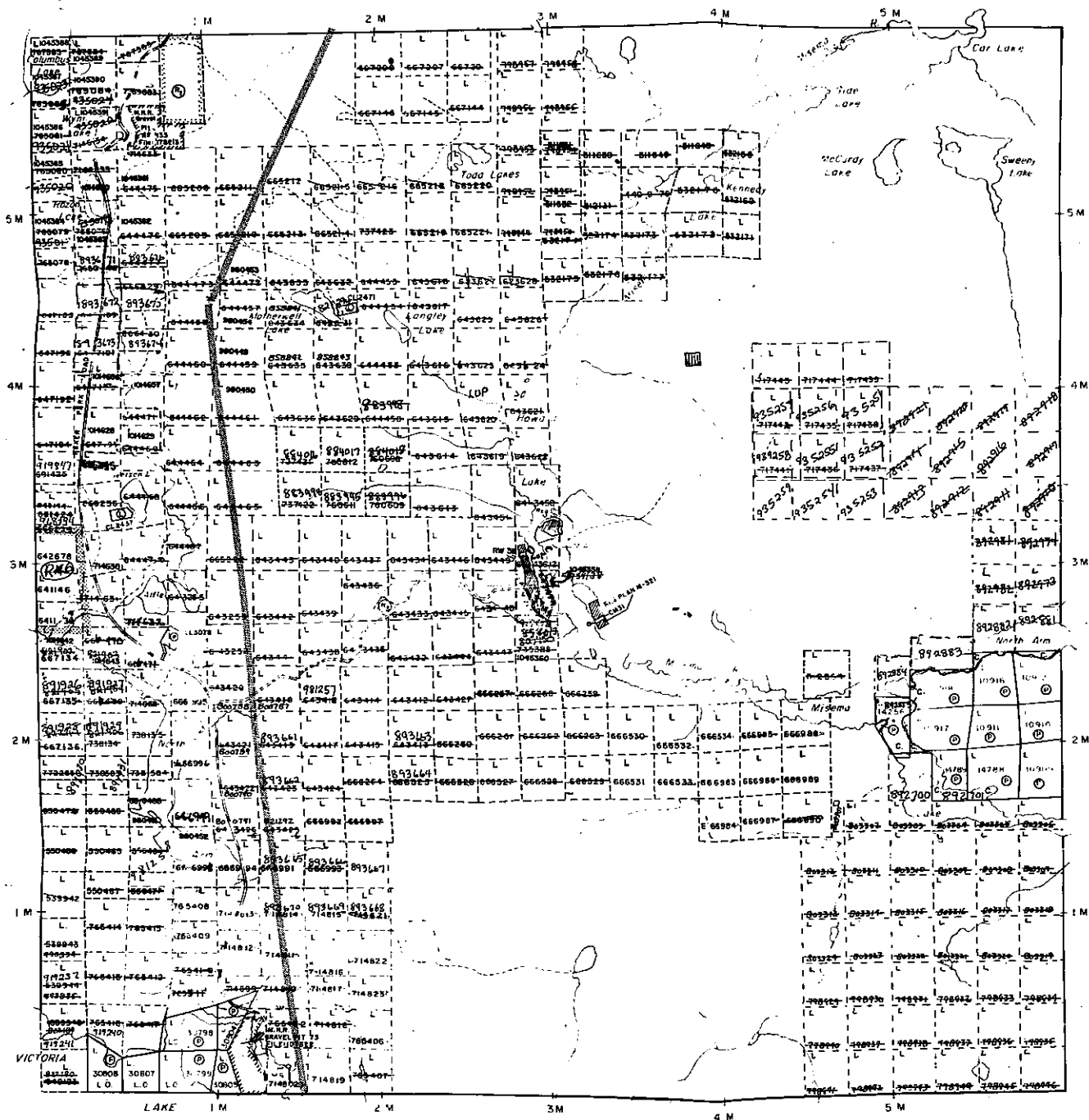

Gauthier Twp.(M.350)

THE TOWNSHIP OF

ARNOLD

DISTRICT OF TIMISKAMING

LARDER LAKE MINING DIVISION

SCALE: 1-INCH 40 CHAINS

LEGEND

PATENTED LAND	Ⓞ
CROWN LAND SALE	C.S.
LEASES	Ⓢ
LOCATED LAND	Loc.
LICENSE OF OCCUPATION	L.O.
MINING RIGHTS ONLY	M.R.O.
SURFACE RIGHTS ONLY	S.R.O.
ROADS	
IMPROVED ROADS	
KING'S HIGHWAYS	
RAILWAYS	
POWER LINES	
MARSH OR MUSKOG	
MINES	
CANCELLED	
PATENT SURFACE RIGHTS ONLY	

(Application Pending Under Public Lands Act)

NOTES

4/27/70 Surface Rights Reservation using the shores of all lakes and rivers.

Areas withdrawn from staking under Section 43 of the Mining Act (R.S.O. 1970).

Order No.	File	Date	Disposition
Ⓢ	183497	APRIL 17/70	S.R.O.
Ⓢ	NR M.32/79 172215	MAY 4/79	S.R.O.

PROPOSED CROWN SUBDIVISION
PROPOSED POWER LINE RIGHT-OF-WAY-CONTRACTOR J.D. STEVENS OF NEWLAND

- Ⓢ Surface and Mining Rights Withdrawn from Staking, section 36/80 order No. V-7288
- D-34/86 OPENS W/32/86
- Ⓢ Surface and Mining Rights Withdrawn from Staking, section 36/80 order No. 35788NR

PLAN NO. M.321#7

Clifford Twp. (M. 338)

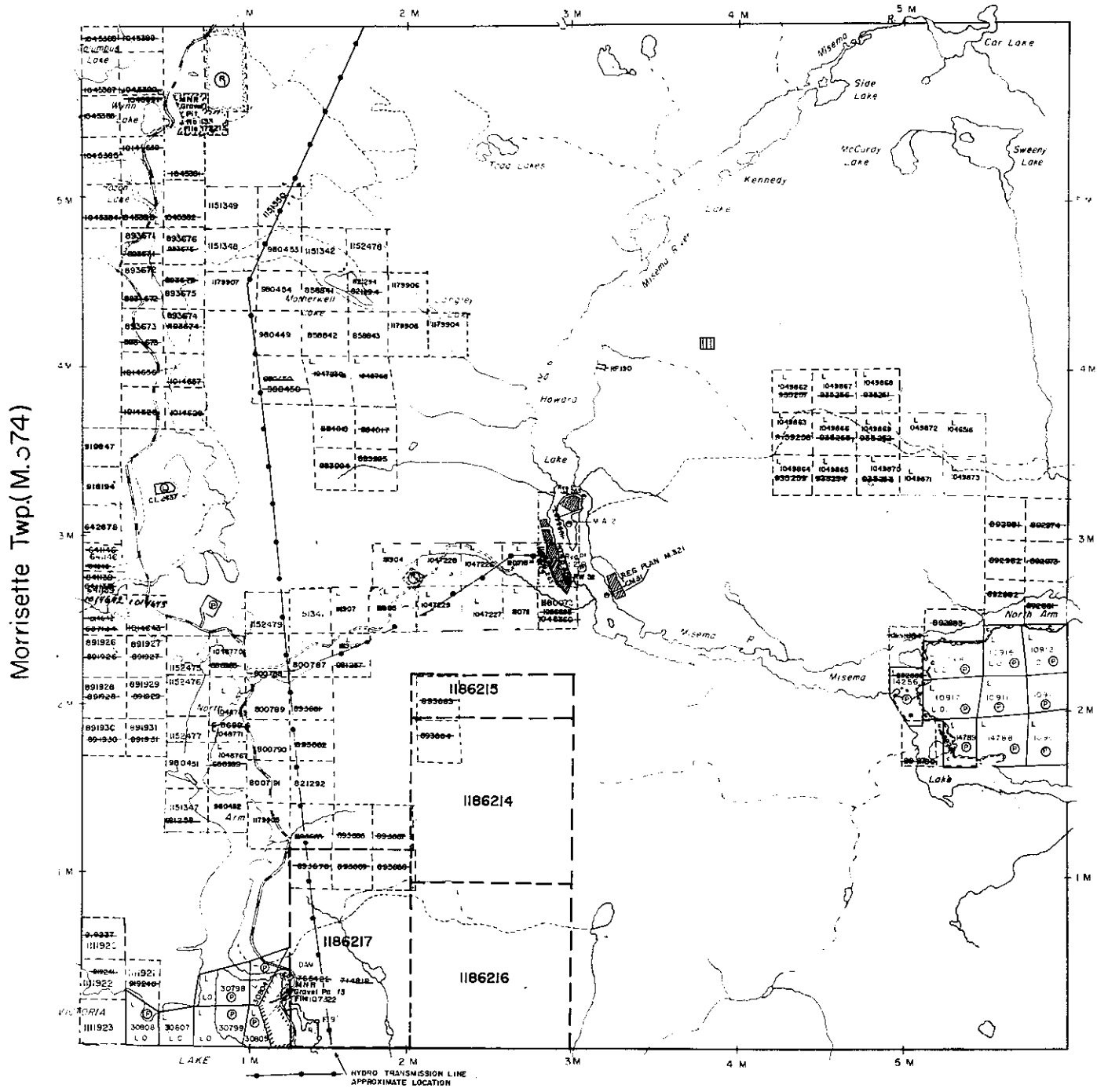

THE TOWNSHIP OF
OF
ARNOLD

DISTRICT OF
TIMISKAMING

LARDER LAKE
MINING DIVISION

SCALE: 1-INCH 40 CHAINS

LEGEND

- PATENTED LAND Ⓟ
- CROWN LAND SALE CS
- LEASES Ⓛ
- LOCATED LAND Loc
- LICENSE OF OCCUPATION L.O.
- MINING RIGHTS ONLY M.R.O.
- SURFACE RIGHTS ONLY S.R.O.
- ROADS —
- IMPROVED ROADS —
- KING'S HIGHWAYS —
- RAILWAYS —
- POWER LINES —
- MARSH OR MUSKEG —
- MINES Ⓜ
- CANCELLED Ⓢ
- PATENT SURFACE RIGHTS ONLY Ⓢ

NOTES

- 400' Surface Rights Reservation along the shores of all lakes and rivers.
- Areas withdrawn from staking under Section 36 of the Mining Act (R.S.O. 1980):
Order No. File Date Disposition
- Ⓟ SURFACE RIGHTS WITHDRAWN FROM STAKING
SECTION 43 ORDER (R.S.O.1970) FILE NO. 163497
- Ⓢ SURFACE RIGHTS WITHDRAWN FROM STAKING
SECTION 43 ORDER (R.S.O.1970) NO. NR. W.32/179
- Ⓜ SURFACE - MINING RIGHTS WITHDRAWN FROM
STAKING section 36/80 order NO. W/32/188-
ORDER NO. O-34/188 OPENS W/32/188
- Ⓡ5 SURFACE - MINING RIGHTS WITHDRAWN FROM
STAKING section 36/80 ORDER NO. W/33/88NR
O-07/188L OPENS W-33/88NR
- ▨ PROPOSED CROWN SUBDIVISION

PLAN NO. **M.321**

REMOVED FROM CIRCULATION
AND ARCHIVED ON APR.08/92

Gauthier Twp. (M. 350)

COPY OF THIS MYLAR
ARCHIVED APR.08/92

Clifford Twp. (M.338)

THE TOWNSHIP OF

ARNOLD

DISTRICT OF
TIMISKAMING

LARDER LAKE
MINING DIVISION

SCALE: 1-INCH 40 CHAINS

LEGEND

PATENTED LAND	(P)
CROWN LAND SALE	C S
LEASES	L
LOCATED LAND	Loc
LICENSE OF OCCUPATION	L.O.
MINING RIGHTS ONLY	M R O
SURFACE RIGHTS ONLY	S R O
ROADS	
IMPROVED ROADS	
KING'S HIGHWAYS	
RAILWAYS	
POWER LINES	
MARSH OR MUSKEG	
MINES	
CANCELLED	
PATENT SURFACE RIGHTS ONLY	

NOTES

400' Surface Rights Reservation along the shores of the lakes and rivers

Areas withdrawn from staking under section 36 of the Mining Act (R.S.O. 1980) Order No. File Date Disposition

(P) SURFACE RIGHTS WITHDRAWN FROM STAKING SECTION 43 ORDER (R.S.O.1970) FILE NO.163497

(L) SURFACE RIGHTS WITHDRAWN FROM STAKING SECTION 43 ORDER (R.S.O.1970) NO.NR.W.32/79

(M) SURFACE - MINING RIGHTS WITHDRAWN FROM STAKING section 36/80 order NG-W/32/88 ORDER NO. O-34/88 OPENS W/32/88

(RS) SURFACE - MINING RIGHTS WITHDRAWN FROM STAKING section 36/80 ORDER NO.W/33/BBNR O-07/88L OPENS W-33/88NR

(III) PROPOSED CROWN SUBDIVISION

DATE OF ISSUE
APR 10 1991
LARDER LAKE
MINING RECORDS OFFICE

PLAN NO. M.321

MINISTRY OF
NORTHERN DEVELOPMENT
AND MINES

Morrisette Twp.(M.374)

Katrine Twp.(M.357)

Gauthier Twp.(M.350)

IN CIRCULATION JULY 6/1988 T.O.

NOTICE !!!

THIS TOWNSHIP/AREA FALLS WITHIN THE TIMISKAMING MANAGEMENT UNIT, AND MAY BE

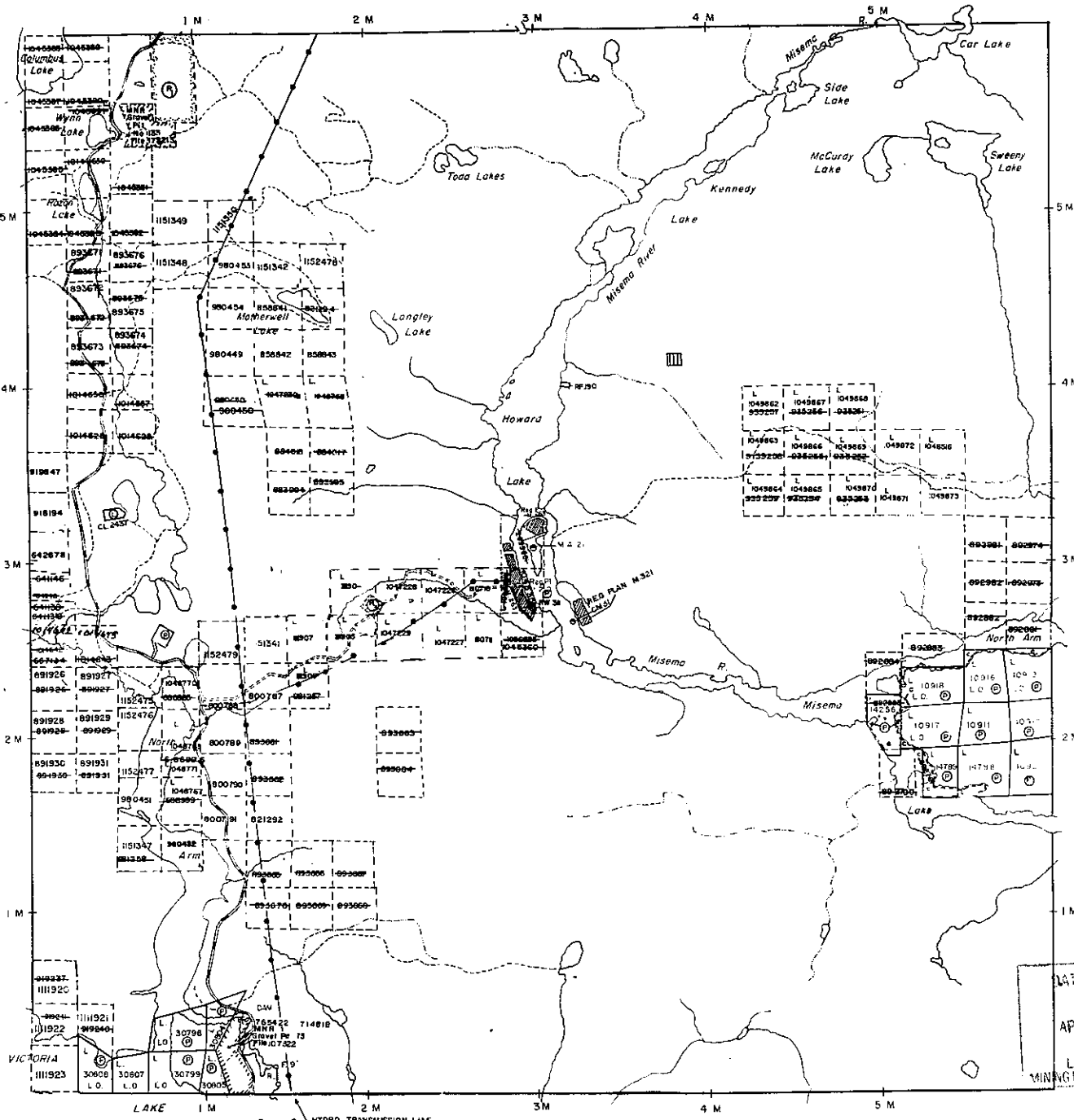

Clifford Twp. (M.338)

THE TOWNSHIP OF
OF

ARNOLD

DISTRICT OF
TIMISKAMING

LARDER LAKE
MINING DIVISION

SCALE: 1-INCH = 40 CHAINS

LEGEND

PATENTED LAND	Ⓟ
CROWN LAND SALE	C.S.
LEASES	Ⓛ
LOCATED LAND	Loc.
LICENSE OF OCCUPATION	L.O.
MINING RIGHTS ONLY	M.R.O.
SURFACE RIGHTS ONLY	S.R.O.
ROADS	—
IMPROVED ROADS	—
KING'S HIGHWAYS	—
RAILWAYS	—
POWER LINES	—
MARSH OR MUSKEG	—
MINES	Ⓜ
CANCELLED	Ⓢ
PATENT SURFACE RIGHTS ONLY	Ⓢ

NOTES

400' Surface Rights Reservation along the shores of all lakes and rivers

Areas withdrawn from staking under Section 36 of the Mining Act (R.S.J. 1980).
Order No. File Date Disposition

Ⓟ SURFACE RIGHTS WITHDRAWN FROM STAKING
SECTION 43 ORDER (R.S.O.1970) FILE NO. 163497

Ⓟ SURFACE RIGHTS WITHDRAWN FROM STAKING
SECTION 43 ORDER (R.S.O.1970) NO. NR. W.32/79

Ⓟ SURFACE + MINING RIGHTS WITHDRAWN FROM
STAKING section 36/80 order NO. W.32/88
ORDER NO. O-34/88 OPENS W.32/88

Ⓟ SURFACE + MINING RIGHTS WITHDRAWN FROM
STAKING section 36/80 ORDER NO. W.33/88NR
O-07/88L OPENS W-33/88NR

Ⓜ PROPOSED CROWN SUBDIVISION

PLAN NO. **M.321**

MINISTRY OF
NORTHERN DEVELOPMENT
AND MINES

Morrisette Twp. (M.374)

Katrine Twp. (M.357)

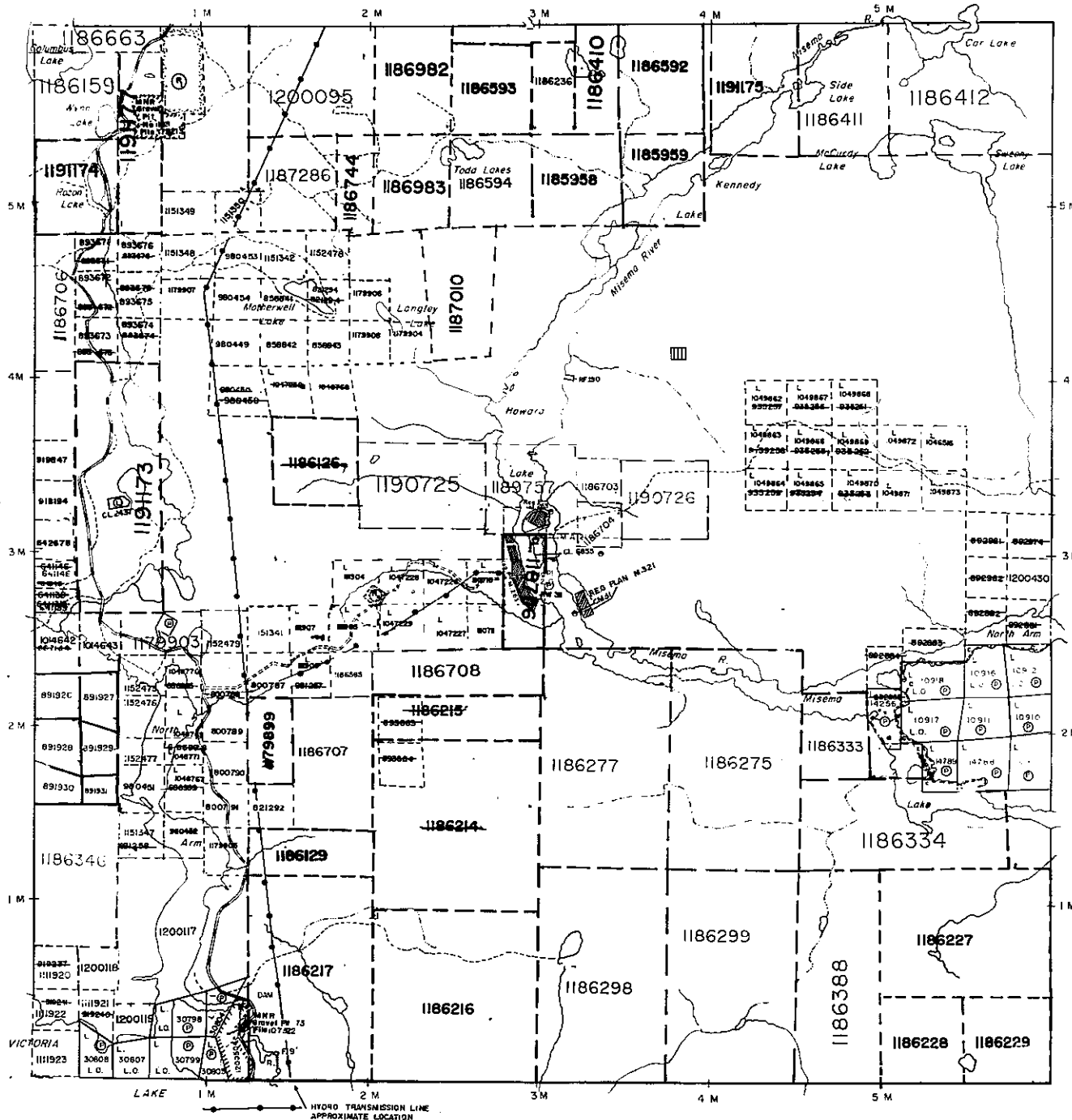

Gauthier Twp. (M.350)

COPY OF THIS MYLAR
ARCHIVED APR.08/92

Clifford Twp. (M. 338)

REPLACEMENT ISSUE

MAY 13 1996

LARDER LAKE
MINING DISTRICT'S OFFICE

THE TOWNSHIP
OF

ARNOLD

DISTRICT OF
TIMISKAMING

LARDER LAKE
MINING DIVISION

SCALE: 1-INCH = 40 CHAINS

LEGEND

PATENTED LAND	Ⓟ
CROWN LAND SALE	Ⓞ
LEASES	Ⓢ
LOCATED LAND	Loc.
LICENSE OF OCCUPATION	L.O.
MINING RIGHTS ONLY	M.R.O.
SURFACE RIGHTS ONLY	S.R.O.
ROADS	—
IMPROVED ROADS	—
KING'S HIGHWAYS	—
RAILWAYS	—
POWER LINES	—
MARSH OR MUSKEG	—
MINES	Ⓜ
CANCELLED	ⓧ
PATENT SURFACE RIGHTS ONLY	Ⓞ

NOTES

400' Surface Rights Reservation along the shores of all lakes and rivers

Areas withdrawn from staking under Section 36 of the Mining Act (R.S.O. 1980).
Order No. File Date Disposition

Ⓡ SURFACE RIGHTS WITHDRAWN FROM STAKING
SECTION 43 ORDER (R.S.O.1970) FILE NO. 163/497

Ⓢ SURFACE RIGHTS WITHDRAWN FROM STAKING
SECTION 43 ORDER (R.S.O.1970) NO. NR W.32/79

Ⓢ NR W 32/79 1722/3 MAY 4/79 S.R.O.

Ⓢ SURFACE - MINING RIGHTS WITHDRAWN FROM STAKING
SECTION 36/80 ORDER NO. W/32/88 -
ORDER NO. C-34/88 OPENS W/32/88

Ⓢ SURFACE - MINING RIGHTS WITHDRAWN FROM STAKING
SECTION 36/80 ORDER NO. W/33/88NR
O-07/88L OPENS W-33/88NR

Ⓢ PROPOSED CROWN SUBDIVISION

Ⓢ M/218 & SURFACE RIGHTS WITHDRAWN FROM STAKING
SECTION 35, THE MINING ACT RSO 1990, W-L-99/94 PER

PLAN NO. M.321

MINISTRY OF
NORTHERN DEVELOPMENT
AND MINES

Morrisette Twp. (M. 374)

Katrine Twp. (M. 357)

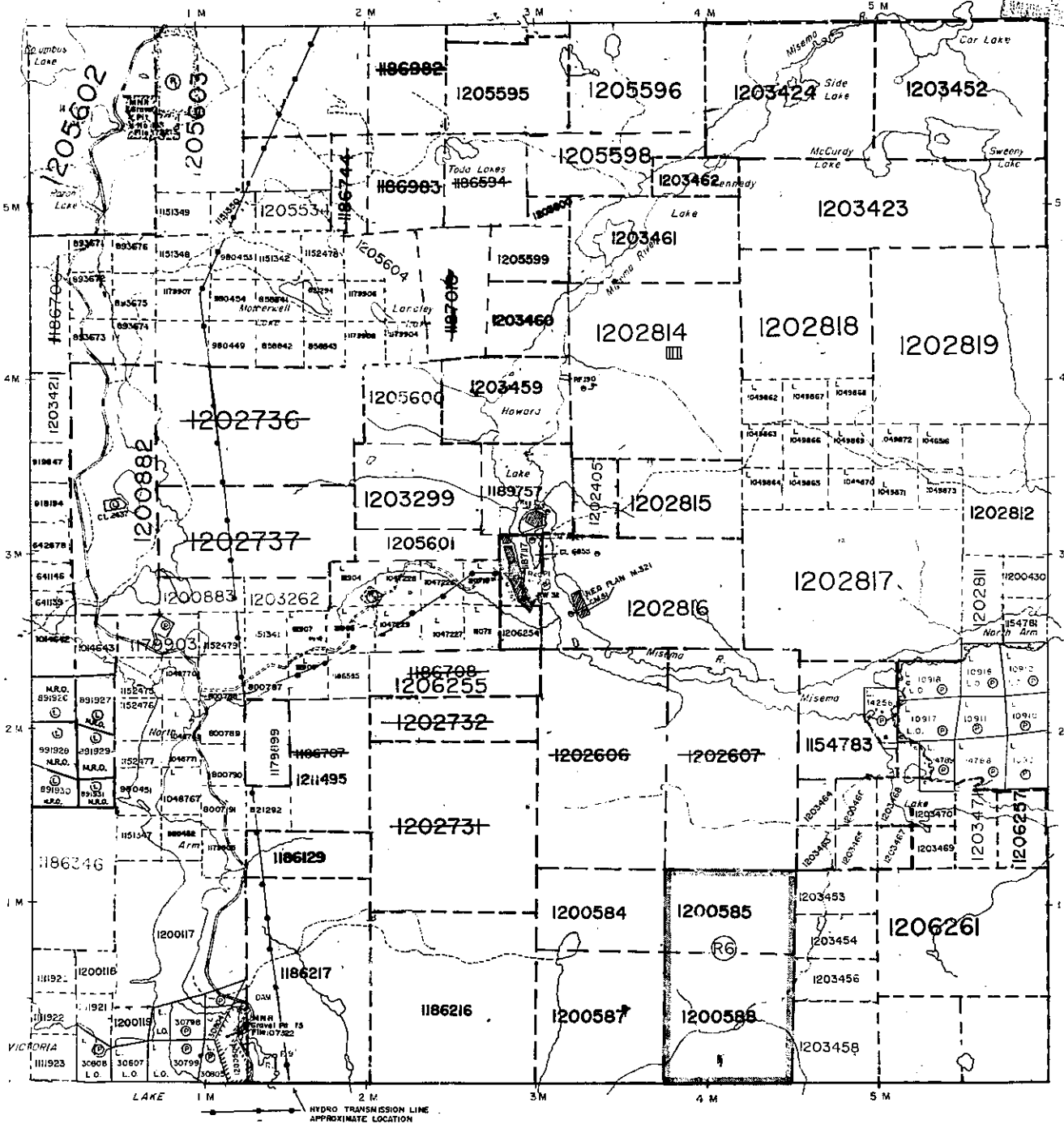

Gauthier Twp. (M. 350)

COPY OF THIS MYLAR
ARCHIVED APR. 08/92

Clifford Twp. (M.338)

THE TOWNSHIP OF

ARNOLD

DISTRICT OF
TIMISKAMING

LARDER LAKE
MINING DIVISION

SCALE: 1-INCH = 40 CHAINS

LEGEND

- PATENTED LAND Ⓟ
- CROWN LAND SALE C.S.
- LEASES Ⓢ
- LOCATED LAND Loc.
- LICENSE OF OCCUPATION L.O.
- MINING RIGHTS ONLY M.R.O.
- SURFACE RIGHTS ONLY S.R.O.
- ROADS —
- IMPROVED ROADS —
- KING'S HIGHWAYS —
- RAILWAYS —
- POWER LINES —
- MARSH OR MUSKEG —
- MINES ⚡
- CANCELLED C
- PATENTED SURFACE RIGHTS ONLY Ⓢ

NOTES

400' Surface Rights Reservation along the shores of all lakes and rivers

Areas withdrawn from staking under Section 36 of the Mining Act (R.S.O. 1980).

Order No. File Date Disposition

Ⓚ SURFACE RIGHTS WITHDRAWN FROM STAKING
SECTION 43 ORDER (R.S.O.1970) FILE NO. 163497

Ⓛ SURFACE RIGHTS WITHDRAWN FROM STAKING
SECTION 43 ORDER (R.S.O.1970) NO. NR W.32/79

Ⓛ NR W.32/79 17223 MAY 4/79 S.R.O.

Ⓛ SURFACE - MINING RIGHTS WITHDRAWN FROM
STAKING, section 36/80 order NO. W/32/80
ORDER NO. 0-34/88 OPENS W/32/88

Ⓛ SURFACE - MINING RIGHTS WITHDRAWN FROM
STAKING, section 36/80 ORDER NO. W/33/88NR
O-07/88 OPENS W-33/88NR

Ⓛ PROPOSED CROWN SUBDIVISION

Ⓛ MINING & SURFACE RIGHTS WITHDRAWN FROM STAKING
SECTION 35, THE MINING ACT RSO 1980, W-L-99194-NER

DATE OF ISSUE
JUL 4 1996

LARDER LAKE
MINING RECORDS SECTION

PLAN NO. M.321

MINISTRY OF
NORTHERN DEVELOPMENT
AND MINES

Morrisette Twp. (M.374)

Katrine Twp. (M.357)

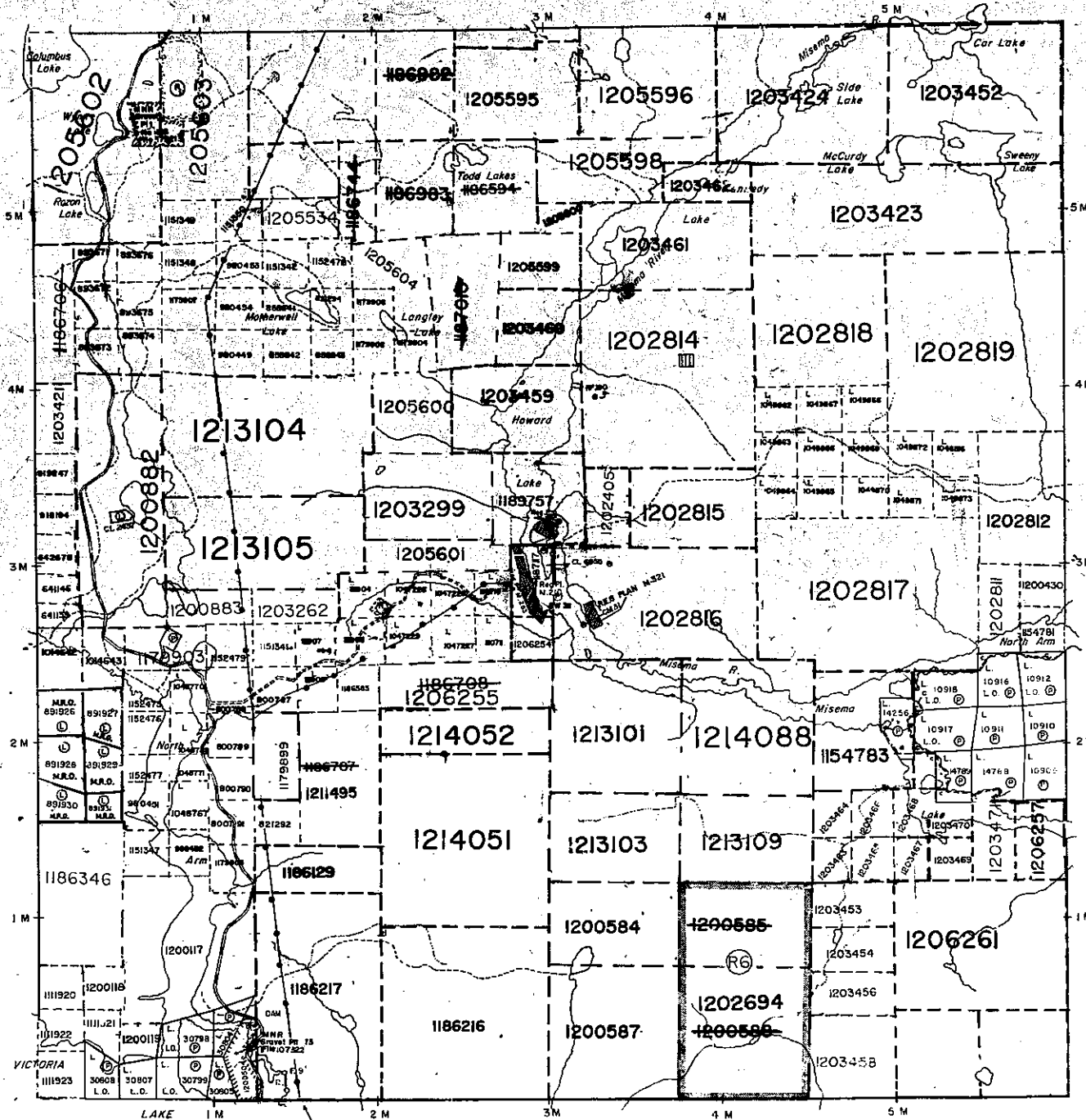

Gauthier Twp. (M. 350)

COPY OF THIS MYLAR
ARCHIVED APR.08/92

Clifford Twp. (M. 338)

THE TOWNSHIP OF

ARNOLD

DATE OF ISSUE DISTRICT OF
SEP 1 1987 TIMISKAMING

PROVINCIAL RECORDING OFFICE LARDER LAKE
MINING DIVISION

SCALE: 1-INCH = 40 CHAINS

LEGEND

PATENTED LAND	Ⓟ
CROWN LAND SALE	C.S.
LEASES	Ⓛ
LOCATED LAND	Loc.
LICENSE OF OCCUPATION	L.O.
MINING RIGHTS ONLY	M.R.O.
SURFACE RIGHTS ONLY	S.R.O.
ROADS	—
IMPROVED ROADS	—
KING'S HIGHWAYS	—
RAILWAYS	—
POWER LINES	—
MARSH OR MUSKEG	—
MINES	—
CANCELLED	ⓧ
PATENT SURFACE RIGHTS ONLY	Ⓞ

NOTES

- 400' Surface Rights Reservation along the shores of all lakes and rivers
- Areas withdrawn from staking under Section 36 of the Mining Act (R.S.O. 1980).
Order No. File Date Disposition
- (R) SURFACE RIGHTS WITHDRAWN FROM STAKING SECTION 43 ORDER (R.S.O.1970) FILE NO. 163497
- (R2) SURFACE RIGHTS WITHDRAWN FROM STAKING SECTION 43 ORDER (R.S.O.1970) NO.NR W32/79
- (R3) NR W 32/79 172213 MAY 4/79 S.R.O.
- (R4) SURFACE - MINING RIGHTS WITHDRAWN FROM STAKING section 36/80 order NO. W32/88 ORDER NO. O-34/88 OPENS W/32/88
- (R5) SURFACE - MINING RIGHTS WITHDRAWN FROM STAKING section 36/80 ORDER NO. W/33/88NR O-07/88L OPENS W-33/88NR
- (R6) ORDER #O-L-20/86NER OPENS PART W-L-99/94NER
- (R7) PROPOSED CROWN SUBDIVISION
- (R8) MINING & SURFACE RIGHTS WITHDRAWN FROM STAKING SECTION-35, THE MINING ACT R50 1990, W-L-99/94 NER
- (R9) ORDER #O-L-19/86NER OPENS PART W-L-39/86NER

PLAN NO. **M.321**

MINISTRY OF
NORTHERN DEVELOPMENT
AND MINES

Morrisette Twp. (M.374)

Katrine Twp. (M.357)

Gauthier Twp. (M. 350)

COPY OF THIS MYLAR
ARCHIVED APR.08/92

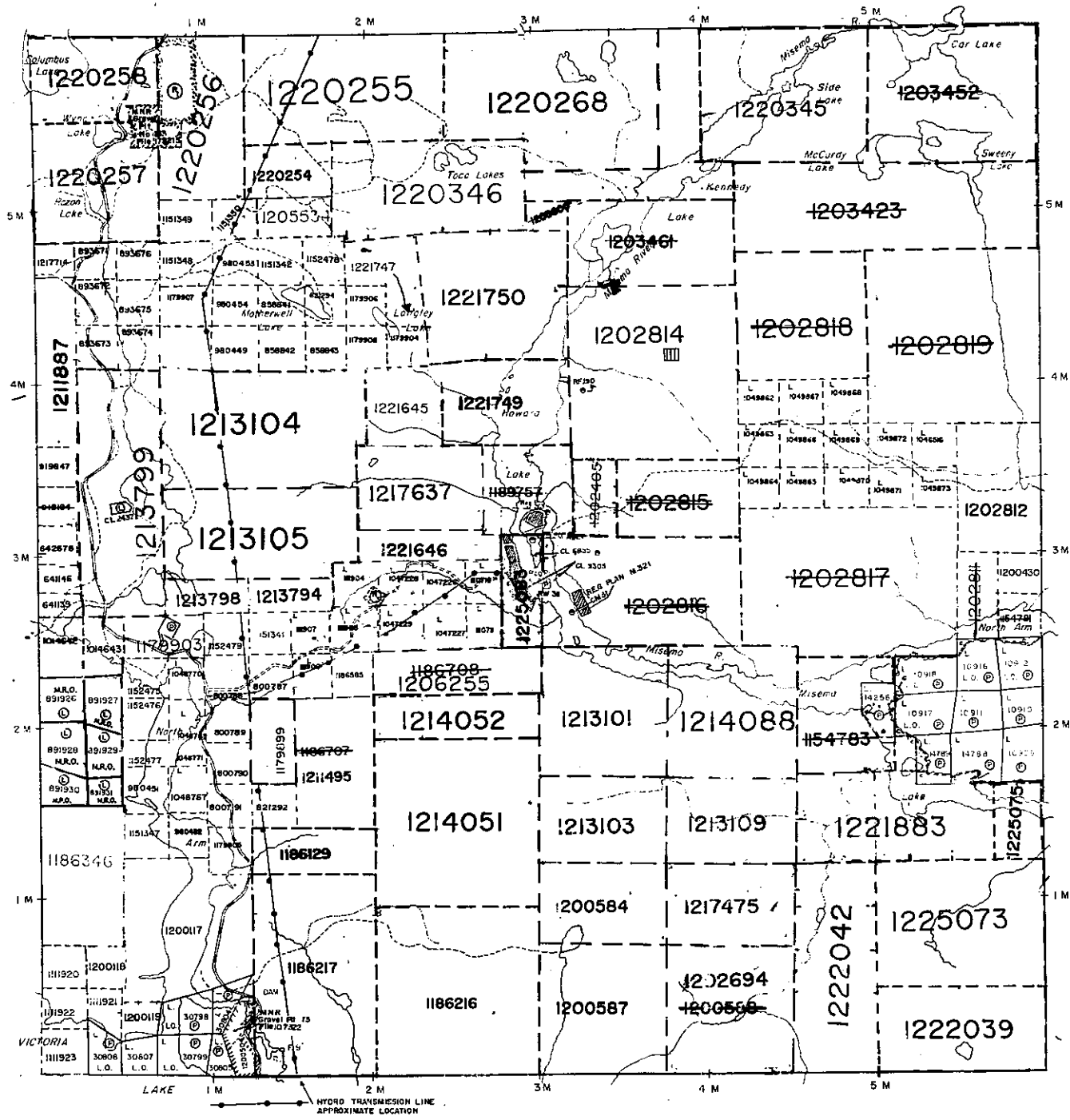

Clifford Twp. (M.338)

THE TOWNSHIP OF
OF

ARNOLD

DATE OF I

APR 27 1

PROVINCIAL REC
OFFICE - SUD

Bbb

DISTRICT OF
TIMISKAMING

LARDER LAKE
MINING DIVISION

SCALE: 1-INCH = 40 CHAINS

LEGEND

PATENTED LAND	Ⓢ
CROWN LAND SALE	C.S.
LEASES	Ⓢ
LOCATED LAND	Loc.
LICENSE OF OCCUPATION	L.O.
MINING RIGHTS ONLY	M.R.O.
SURFACE RIGHTS ONLY	S.R.O.
ROADS	—
IMPROVED ROADS	—
KING'S HIGHWAYS	—
RAILWAYS	—
POWER LINES	—
MARSH OR MUSKOG	—
MINES	—
CANCELLED	—
PATENT SURFACE RIGHTS ONLY	—

NOTES

400' Surface Rights Reservation along the shores of all lakes and rivers

Areas withdrawn from staking under Section 36 of the Mining Act (R.S.O. 1980).

Order No. File Date Disposition

Ⓢ SURFACE RIGHTS WITHDRAWN FROM STAKING
SECTION 43 ORDER (R.S.O.1970) FILE NO. 163497

Ⓢ SURFACE RIGHTS WITHDRAWN FROM STAKING
SECTION 43 ORDER (R.S.O.1970) NONR W.32/179

Ⓢ NR W 32/179, 17213 MAY 4/79 S.R.O.

Ⓢ SURFACE - MINING RIGHTS WITHDRAWN FROM STAKING
SECTION 36/80 ORDER NO. W/32/188
ORDER NO. O-34/88 OPENS W/32/188

Ⓢ SURFACE - MINING RIGHTS WITHDRAWN FROM STAKING
SECTION 36/80 ORDER NO. W/32/188
O-07/88 OPENS W-33/88NR

Ⓢ ORDER #0-L-20196NR OPENS PART W-L-99/94NER

Ⓢ PROPOSED CROWN SUBDIVISION

Ⓢ MINING RIGHTS WITHDRAWN FROM STAKING
SECTION 33, THE MINING ACT RSO 1990, W-L-99/94NER

Ⓢ ORDER #0-L-1979NER OPENS PART W-L-99/94NER

PLAN NO. **M.321**

MINISTRY OF
NORTHERN DEVELOPMENT
AND MINES

Morrisette Twp.(M.374)

Katrine Twp.(M.357)

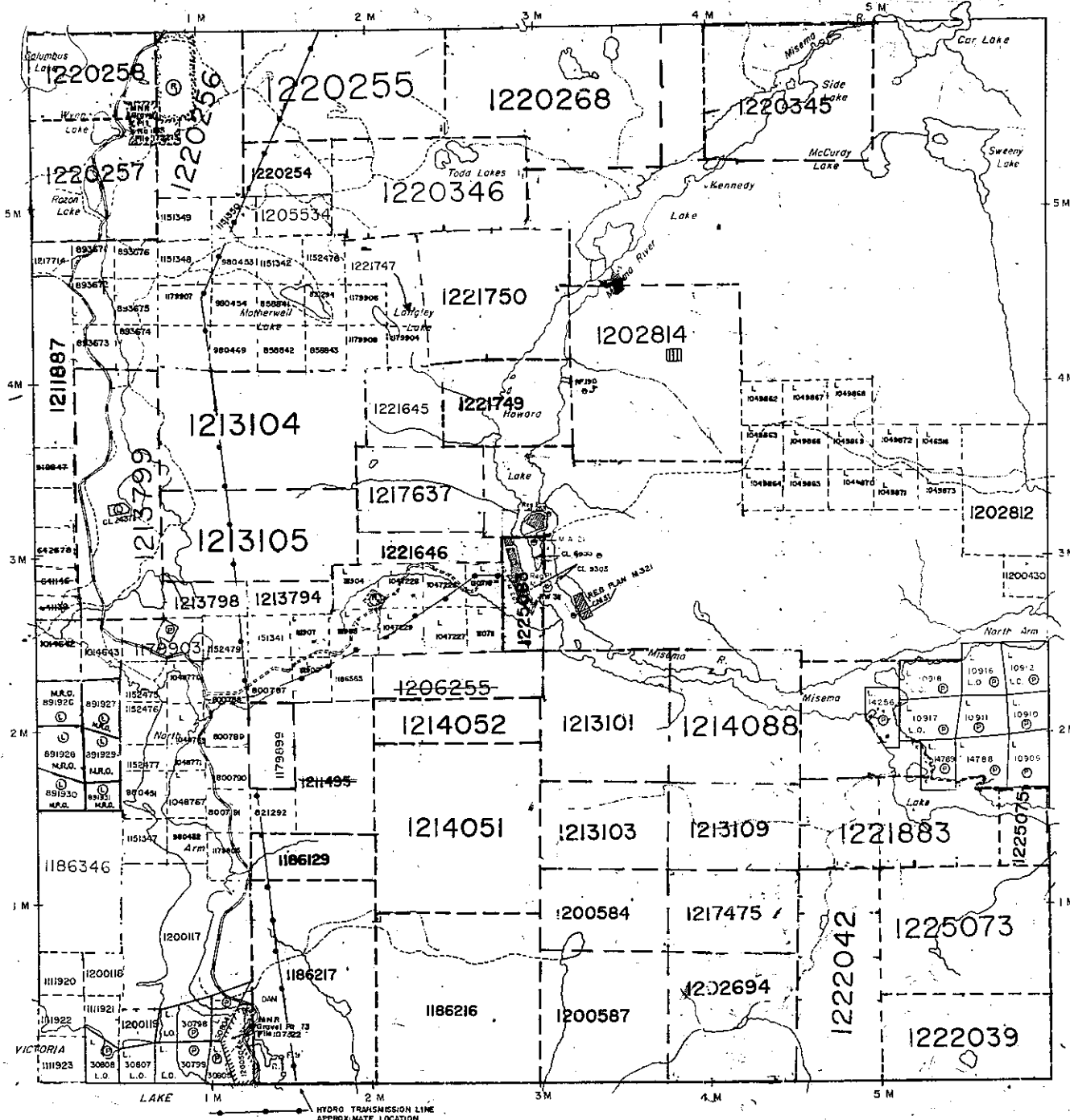

Gauthier Twp.(M.350)

COPY OF THIS MYLAR
ARCHIVED APR.06/92