





Ten Acre Wood



-  Entrance
-  Hillingdon Trail
-  Footpath
-  Parking

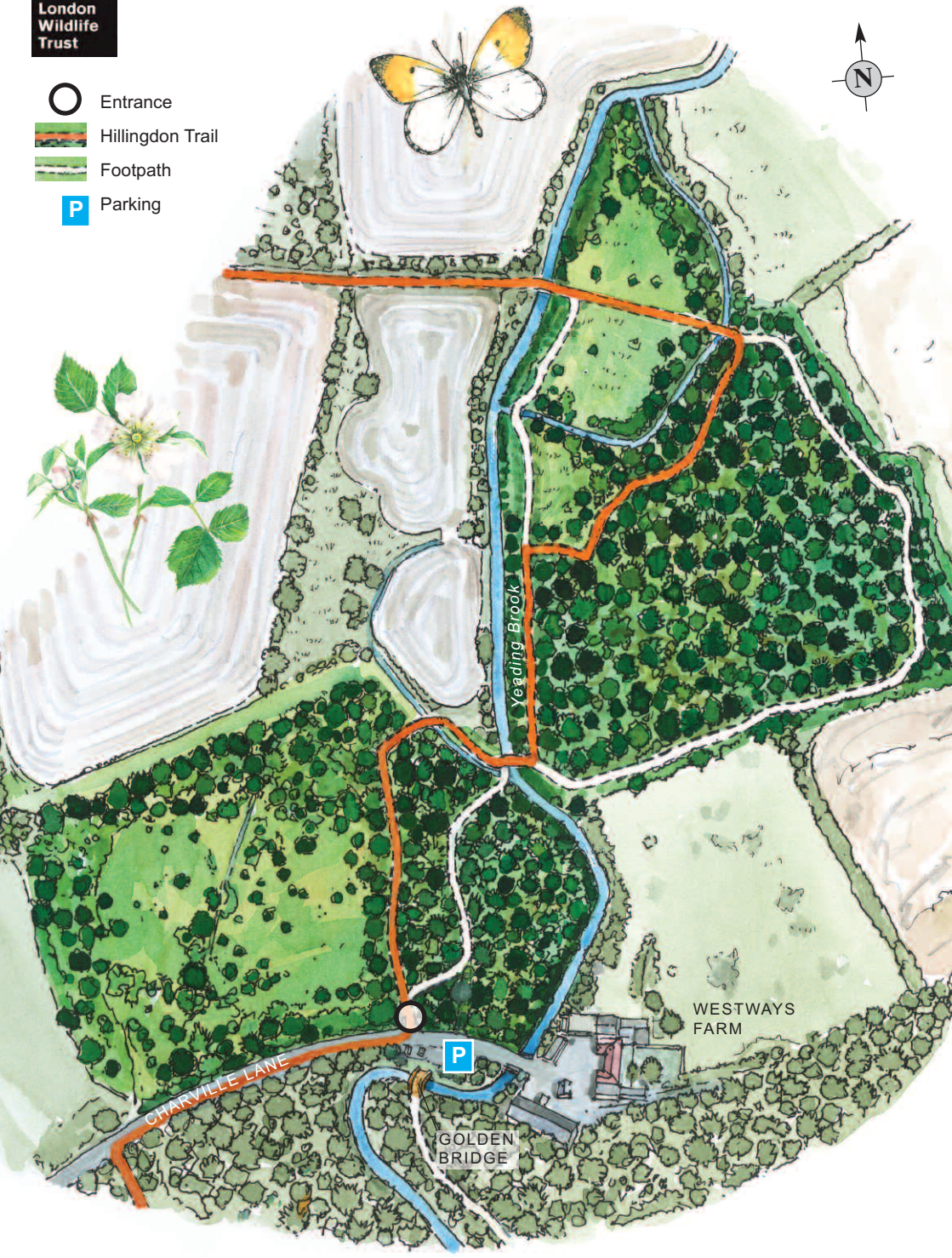
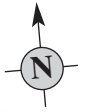

Ten Acre Wood

Ten Acre Wood was planted in the 19th century as an oak wood with a hazel coppice understory. It now contains oak, hazel, blackthorn and hawthorn as well as a host of other species. Hawthorn and blackthorn give fine displays of blossom early in the year, as well as providing an abundance of berries which keep the birds well fed in autumn and winter.

The meadows range from dry to wet, and there is also a small pond, a marshy area and a brook, which runs along the western side of the woodland in the north and the eastern edge in the south. It forms part of the necklace of sites within Yeading Valley that have an importance for wildlife and nature conservation.

The Wood is laid with a series of informal paths.

Ten Acre Wood is managed by London Wildlife Trust on behalf of London Borough of Hillingdon.

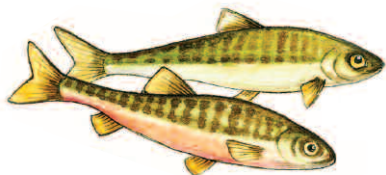

What to look out for at Ten Acre Wood:

- English oak
- Sessile oak
- Dog rose
- Field maple
- Ladies smock
- Water plantain
- Celery-leaved crowfoot
- Bluebell
- Kingfisher
- Stag beetle



How to get involved:

London Wildlife Trust runs regular conservation workdays.

To use the site for educational visits and for details of events and other activities please contact London Wildlife Trust.

Contact details:

London Wildlife Trust 0208 755 2339 or
e-mail wildcrane@wildlondon.org.uk

Hillingdon London Wildlife Trust Volunteer Group:
Roger Taylor 01895 448028 or
e-mail LWTHillingdon@aol.com

How to get there:

Buses: U7, 195: Charville Lane Estate,
90: Kingshill Close, E7: Harvey Road/West End Road
Not wheelchair accessible
Parking at Charville Lane

Access – open at all times