

1269

HANLAN

m-1269

BANNERMAN

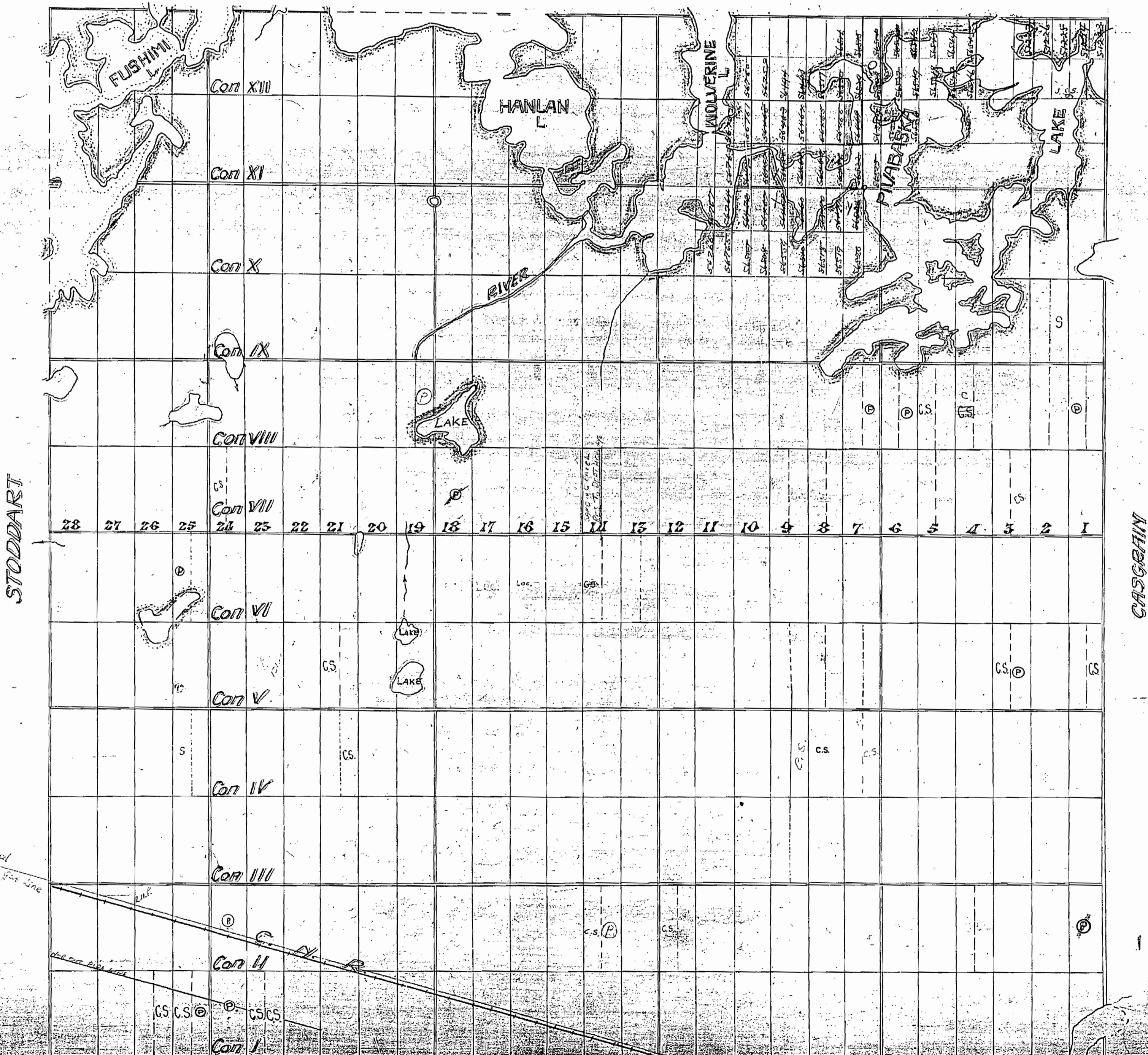

Surface reservations 200 wide by Dept. of L. & E.
Inland between 1911

WAY

1269

HANLAN

m-1269

DISTRICT OF COCHRANE
SAULT STE. MARIE MINING DIVISION

SCALE: 1-INCH = 40 CHAINS
BANNERMAN

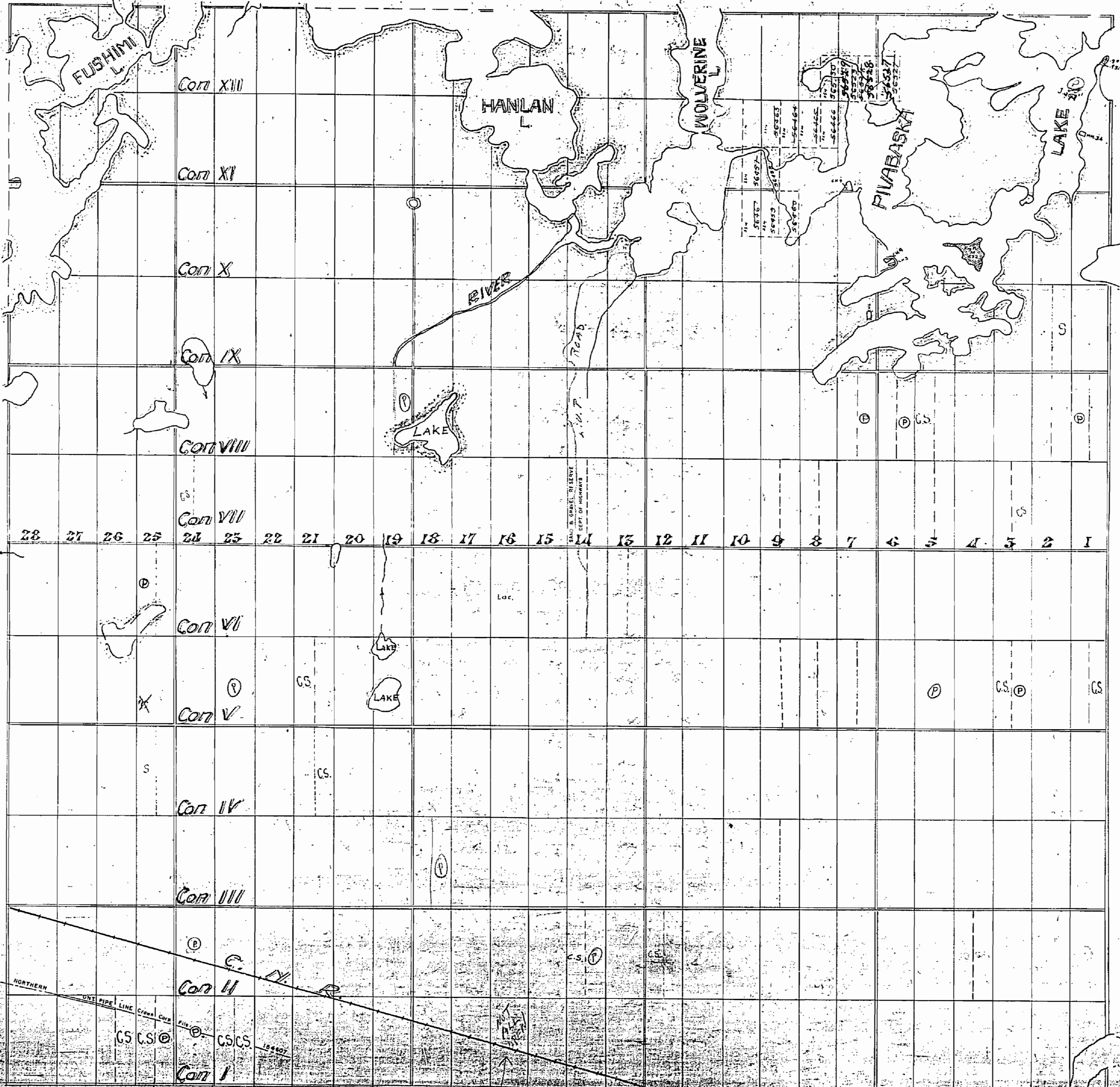

STODDART

CASGRAIN

Scale 1 inch = 40 chains
 Surveyed by D. J. ...
 1897

Areas withdrawn from staking under Section
43 of the Mining Act (R.S.O. 1970)

File	Date	Disposition	Reg. No.
20461	1/3/77	S.R.O.	W.27/77
28294	23/3/77	S.R.O.	W.38/77

MINISTRY OF NATURAL RESOURCES
SURVEYS AND MAPPING BRANCH

DISTRICT OF COCHRANE

PERCUPINE MINING DIVISION

- A. U. P.

SCALE: 1-INCH = 40 CHAINS

BANNERMAN

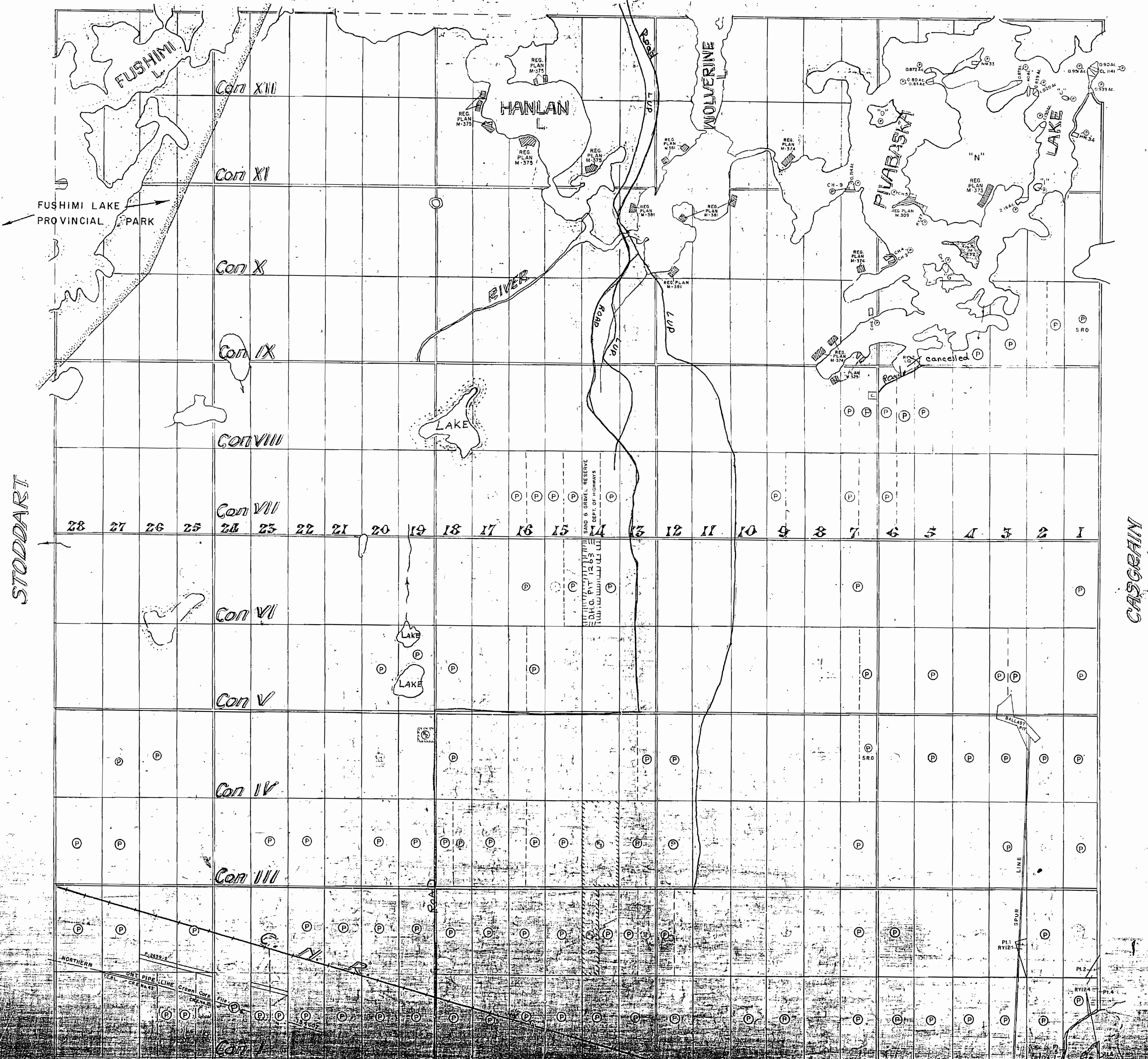

HANLAN

Order of Municipal Officers
dated 2/1/63 does not
apply to mining claims
P. U. S. 448 200, 12/63

DISTRICT OF COCHRANE SAULT STE. MARIE MINING DIVISION

M-1269

SCALE: 1-INCH = 40 CHAINS
BANNERMAN

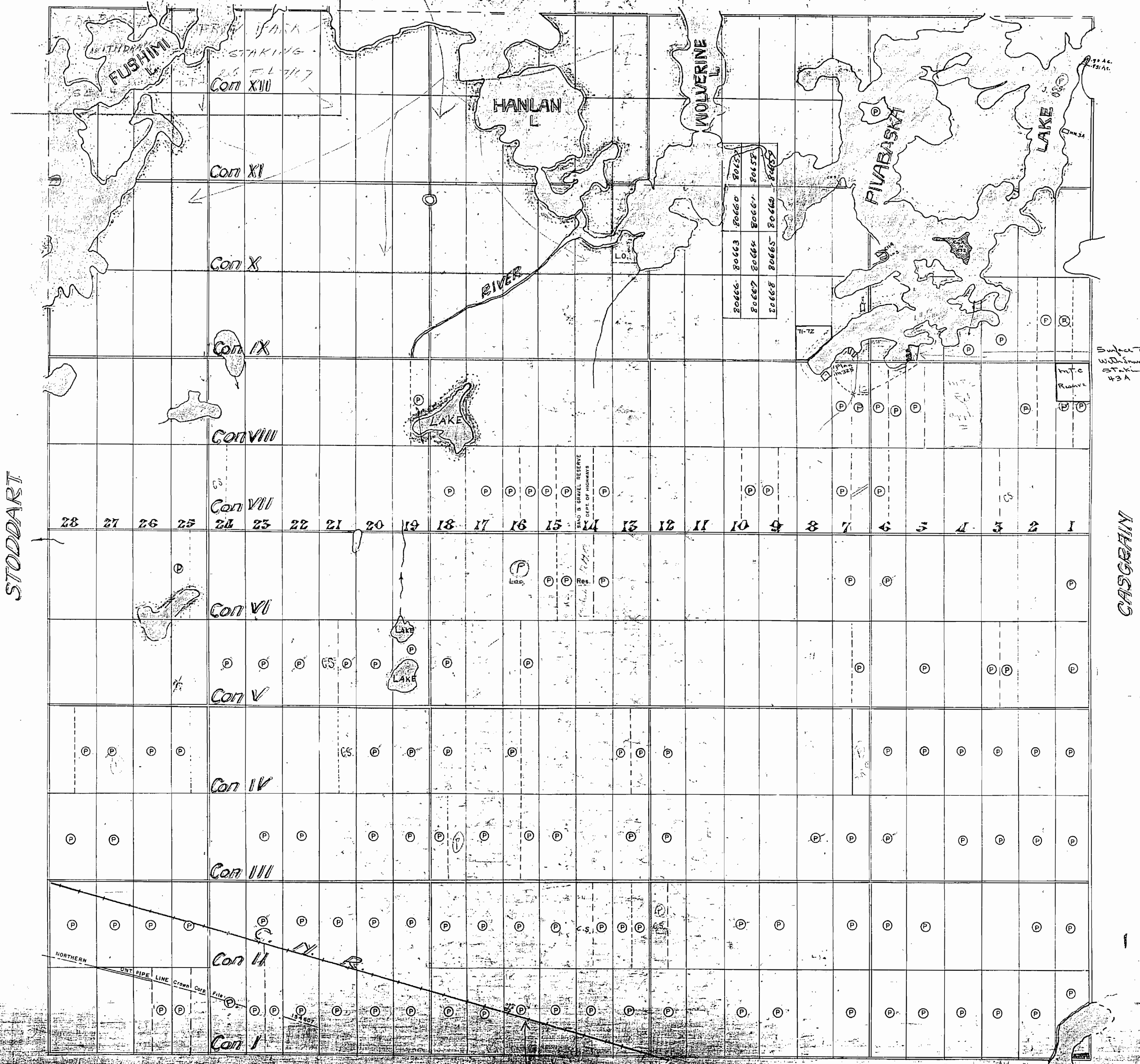

STODDART

CASGRAIN

Surface reservation 500' wide by Dept. of Lands
and Forests, 1940

BANNERMAN

M 126

ONTARIO

MINISTRY OF NATURAL RESOURCES
SURVEYS AND MAPPING BRANCH

Area withdrawn from staking under Section 43 of the Mining Act. (R.S.O. 1970)

File	Date	Disposition
164585	3/8/72	SRO

L.U.P.

S.R.O. withdrawn from staking
Waste disposal site March 1, 1977

DISTRICT OF COCHRANE

PORCUPINE MINING DIVISION

SCALE: 1-INCH = 40 CHAINS

BANNERMAN

DATE OF ISSUE
MAY 23 1974

RECEIVED
MAY 28 1974
AM 7 18 9 10 11 12 1 2 3 4 5 6 PM

PROPOSED PROVINCIAL PARK

Withdrawn From Staking
under Sec. 42 of The Mining Act.
File: 171510

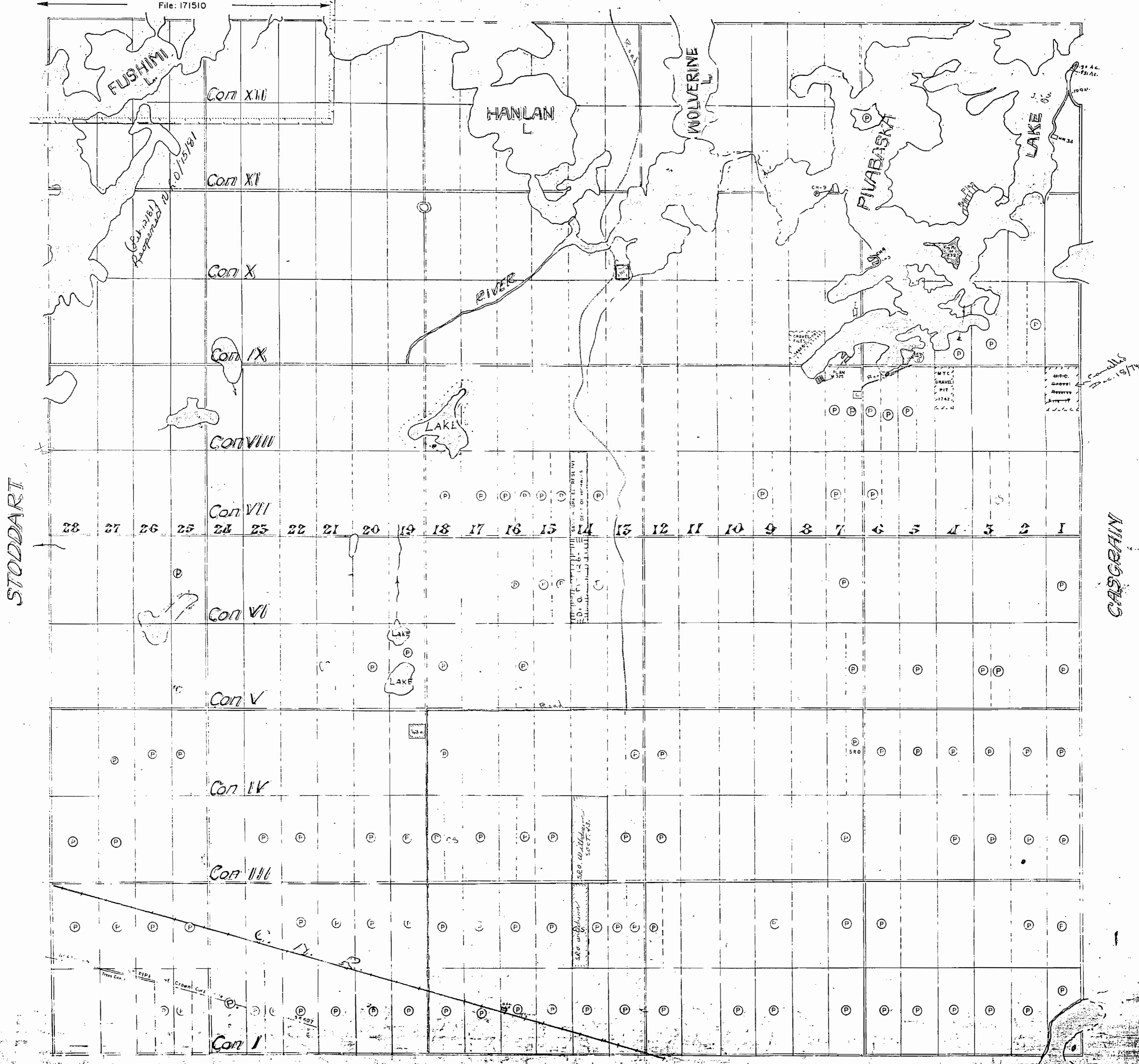

400' surface rights reservation around all lakes & rivers

WAY

REFERENCES

AREAS WITHDRAWN FROM DISPOSITION

- M.R.O. - MINING RIGHTS ONLY
- S.R.O. - SURFACE RIGHTS ONLY
- M.+S. - MINING AND SURFACE RIGHTS

Description	Order No.	Date	Disposition	File
④	W87/77	1/3/77	SRO	20481
⑤	W88/77	3/1/77	SRO	20254

⑭ Surface Rights Withdrawn under Sec. 36, The Mining Act R.S.O. 1980, ORDER NO. W-O/81/ONT (From Canada Pipeline Right of Way and Butler Zone particularly 40.25 meters or 132 ft. on either side of centre line of right of way)

⑮ THIS TWP. IS SUBJECT TO FOREST ACTIVITIES IN 1994/95. FURTHER INFORMATION AVAILABLE ON FILE.

⑯ SURFACE AND MINING RIGHTS WITHDRAWN UNDER SEC. 36 OF THE MINING ACT R.S.O. 1980 ORDER NO. W-ML/90 DATED 90-MAR-20

⑰ MINING RIGHTS ONLY RE-OPENED UNDER SECTION 35 OF THE MINING ACT R.S.O. 1980 ORDER NO. O-ONT-13/95 NER DATED 95-MAY-29 EFFECTIVE 95-JUN-01 AT 7:00 A.M.S.T.

⑱ PENDING APPLICATION UNDER THE PUBLIC LANDS ACT SUBJECT TO SECTION 30(B) OF THE MINING ACT

⑲ SEC 35 W-LL-C 1538/99 ONT MAY 13/99 M+S

BANNERMAN TWP

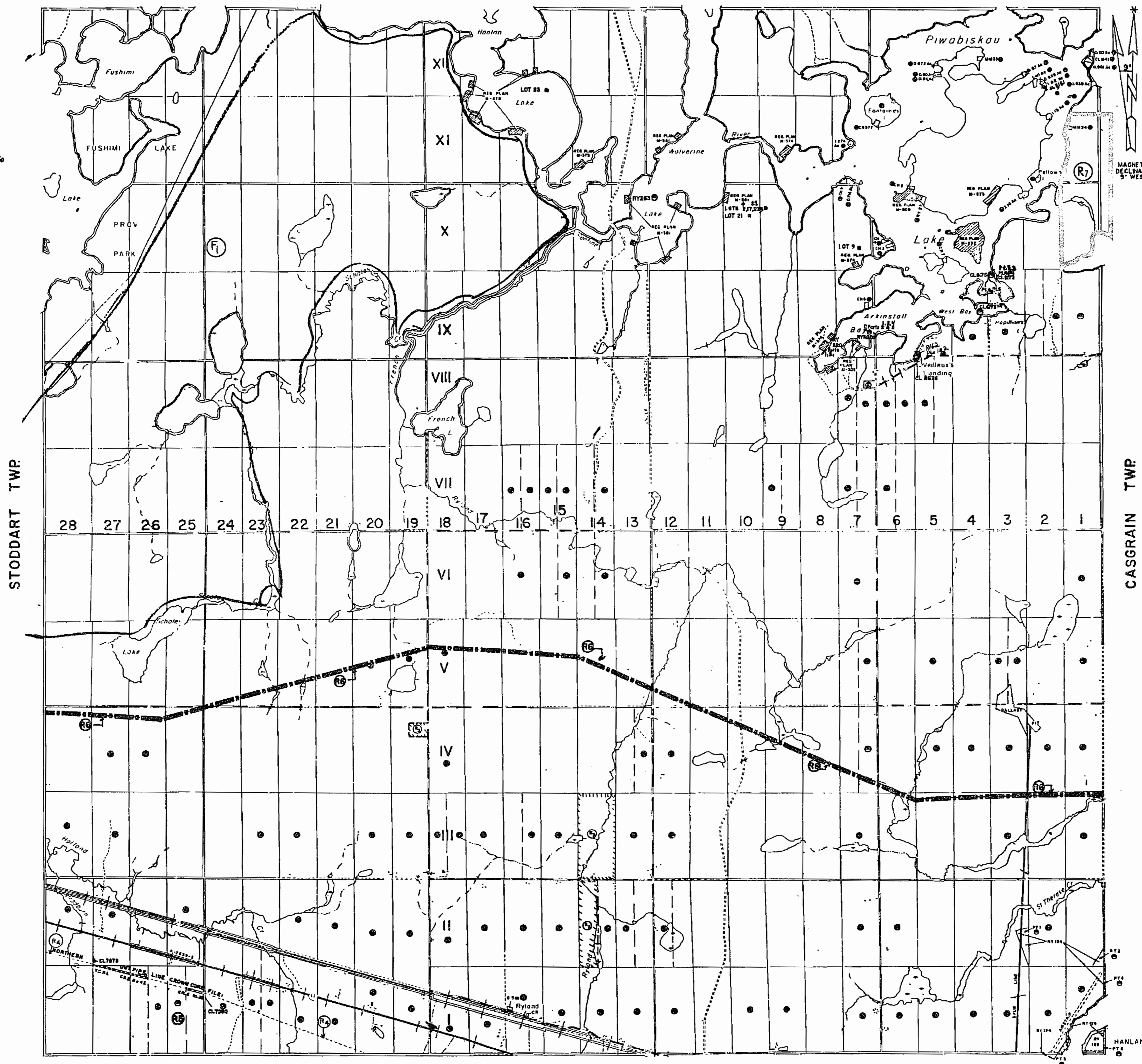

LEGEND

- HIGHWAY AND ROUTE No
- OTHER ROADS
- TRAILS
- SURVEYED LINES
- TOWNSHIPS, BASE LINES, ETC
- LOTS, MINING CLAIMS, PARCELS, ETC
- UNSURVEYED LINES
- LOT LINES
- PARCEL BOUNDARY
- MINING CLAIMS ETC
- RAILWAY AND RIGHT OF WAY
- UTILITY LINES
- NON-PERENNIAL STREAM
- FLOODING OR FLOODING RIGHTS
- SUBDIVISION OR COMPOSITE PLAN
- RESERVATIONS
- ORIGINAL SHORELINE
- MARSH OR MUSKEG
- MINES
- TRAVERSE MONUMENT

DISPOSITION OF CROWN LANDS

TYPE OF DOCUMENT	SYMBOL
PATENT, SURFACE & MINING RIGHTS	●
" SURFACE RIGHTS ONLY	○
" MINING RIGHTS ONLY	◐
LEASE, SURFACE & MINING RIGHTS	◑
" SURFACE RIGHTS ONLY	◒
" MINING RIGHTS ONLY	◓
LICENCE OF OCCUPATION	◔
ORDER-IN-COUNCIL	OC
RESERVATION	⊖
CANCELLED	⊙
SAND & GRAVEL	⊘

NOTE: MINING RIGHTS IN PARCELS PATENTED PRIOR TO MAY 2, 1913, VESTED IN ORIGINAL PATENTEE BY THE PUBLIC LANDS ACT, R.S.O. 1970 CHAP 380 SEC 43, SUBSEC 1

SCALE: 1 INCH = 40 CHAINS

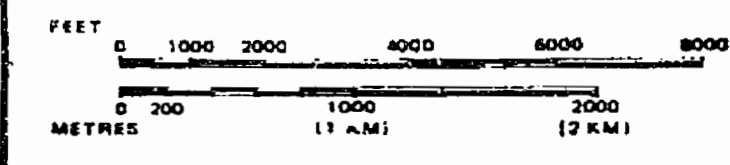

THE INFORMATION THAT APPEARS ON THIS MAP HAS BEEN COMPILED FROM VARIOUS SOURCES, AND ACCURACY IS NOT GUARANTEED. THOSE WISHING TO STAKE MINING CLAIMS SHOULD CONSULT WITH THE MINING RECORDER, MINISTRY OF NORTHERN DEVELOPMENT AND MINES, FOR ADDITIONAL INFORMATION ON THE STATUS OF THE LANDS SHOWN HEREON.

TOWNSHIP
HANLAN
M.R.N. ADMINISTRATIVE DISTRICT
HEARST
MINING DIVISION
PORCUPINE
LAND TITLES / REGISTRY DIVISION
COCHRANE

Ministry of Natural Resources Ontario
Ministry of Northern Development and Mines

Date: JULY, 1986.
March 2/87 RP
Number: **G-2315**

STODDART TWP

CASGRAIN TWP

WAY TWP

REFERENCES

AREAS WITHDRAWN FROM DISPOSITION

- M.R.O. - MINING RIGHTS ONLY
- S.R.O. - SURFACE RIGHTS ONLY
- M. + S. - MINING AND SURFACE RIGHTS

Description	Order No.	Date	Disposition	File
(2)	W27/77	1/3/77	SRO	20461
(3)	W38/77	23/3/77	SRO	28294

(R4) Surface Rights Withdrawn under Sec. 36, The Mining Act R.S.O. 1980, ORDER NO. W-01/91/ONT (Trans Canada Pipeline Right of Way and Buffer Zone particularly 40.25 meters or 132 ft, on either side of centre line of right of way)

(F) THIS TWP. IS SUBJECT TO FOREST ACTIVITIES IN 1994/95. FURTHER INFORMATION AVAILABLE ON FILE.

SURFACE AND MINING RIGHTS WITHDRAWN UNDER SEC. 36 OF THE MINING ACT R.S.O. 1980 ORDER NO. W-ML1/90 DATED 90-MAR-20

MINING RIGHTS ONLY RE-OPENED UNDER SECTION 35 OF THE MINING ACT R.S.O. 1990 ORDER NO. O-ONT-13/95 NER DATED 95-MAY-29 EFFECTIVE 95-JUN-01 AT 7:00 A.M.S.T.

(R6) PENDING APPLICATION UNDER THE PUBLIC LANDS ACT SUBJECT TO SECTION 30(5) OF THE MINING ACT

BANNERMAN TWP

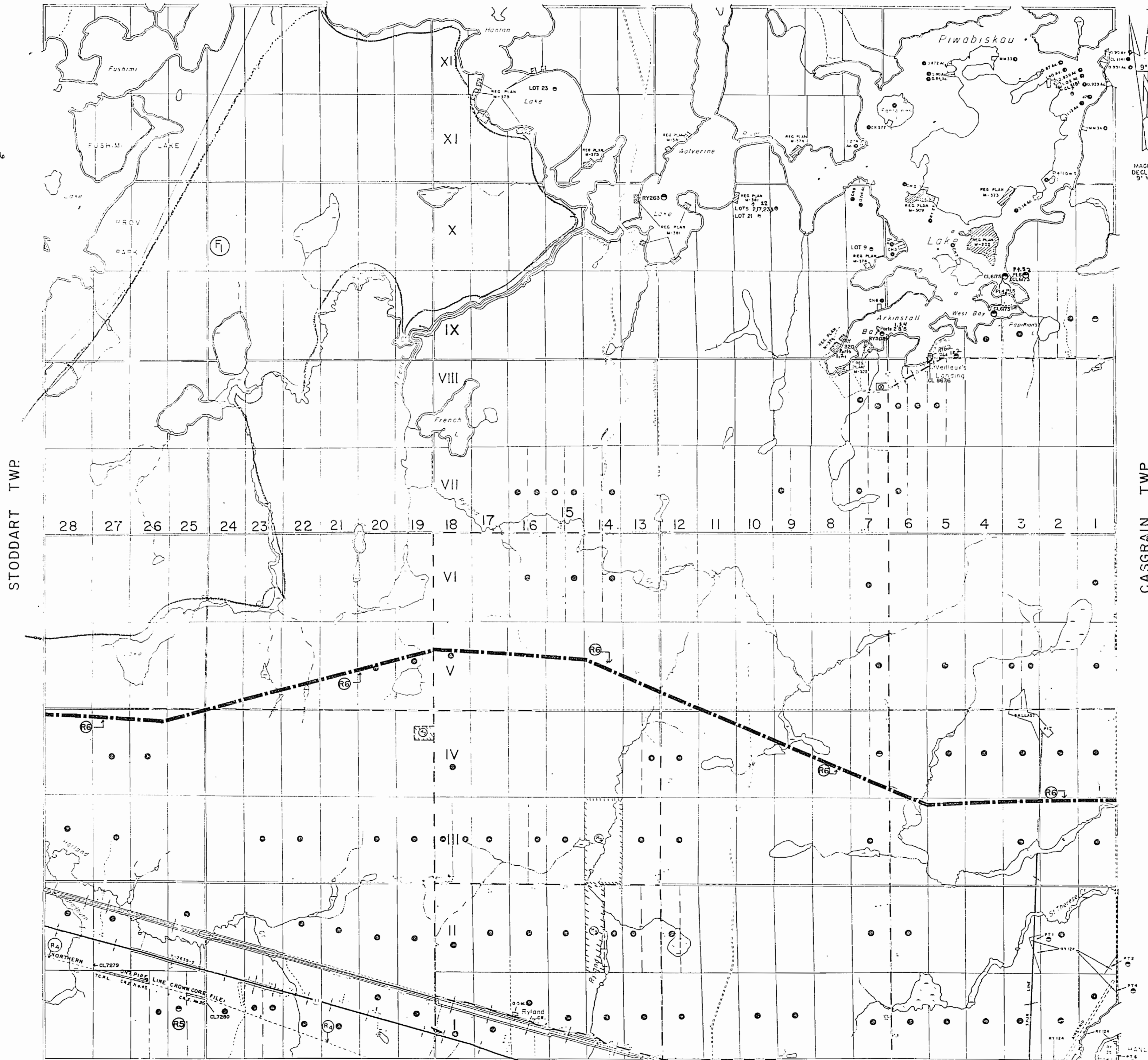

LEGEND

- HIGHWAY AND ROUTE No.
- OTHER ROADS
- TRAILS
- SURVEYED LINES:
 - TOWNSHIPS, BASE LINES, ETC.
 - LOTS, MINING CLAIMS, PARCELS, ETC.
- UNSURVEYED LINES
- LOT LINES
- PARCEL BOUNDARY
- MINING CLAIMS ETC.
- RAILWAY AND RIGHT OF WAY
- UTILITY LINES
- NON PERENNIAL STREAM
- FLOODING OR FLOODING RIGHTS
- SUBDIVISION OR COMPOSITE PLAN
- RESERVATIONS
- ORIGINAL SHORELINE
- MARSH OR MUSKEG
- MINES
- TRAVERSE MONUMENT

DISPOSITION OF CROWN LANDS

TYPE OF DOCUMENT	SYMBOL
PATENT, SURFACE & MINING RIGHTS	
" SURFACE RIGHTS ONLY	
" MINING RIGHTS ONLY	
LEASE, SURFACE & MINING RIGHTS	
" SURFACE RIGHTS ONLY	
" MINING RIGHTS ONLY	
LICENCE OF OCCUPATION	
ORDER-IN-COUNCIL	
RESERVATION	
CANCELLED	
SAND & GRAVEL	

NOTE: MINING RIGHTS IN PARCELS PATENTED PRIOR TO MAY 1, 1913, VESTED IN ORIGINAL PATENTEE BY THE PUBLIC LANDS ACT, R.S.O. 1977, CHAP. 380, SEC. 63, SUBSEC. 1

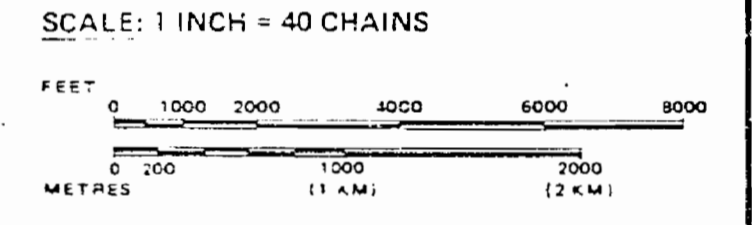

THE INFORMATION THAT APPEARS ON THIS MAP HAS BEEN COMPILED FROM VARIOUS SOURCES, AND ACCURACY IS NOT GUARANTEED. THOSE WISHING TO STAKE MINING CLAIMS SHOULD CONSULT WITH THE MINING RECORDER, MINISTRY OF NORTHERN DEVELOPMENT AND MINES, FOR ADDITIONAL INFORMATION ON THE STATUS OF THE LANDS SHOWN HEREON.

TOWNSHIP
HANLAN
 M.N.R. ADMINISTRATIVE DISTRICT
HEARST
 MINING DIVISION
PORCUPINE
 LAND TITLES / REGISTRY DIVISION
COCHRANE

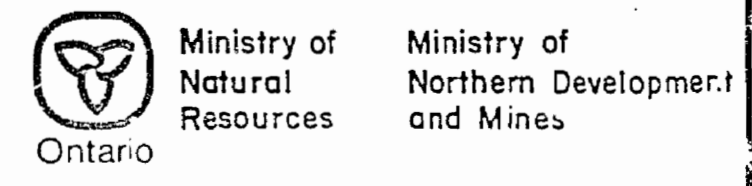

Date JULY, 1986. Number
 March 2/87 R.P. **G-2315**

1269

HANLAN

m-1269

BANNYERMAN

STODDART

CASGRAIN

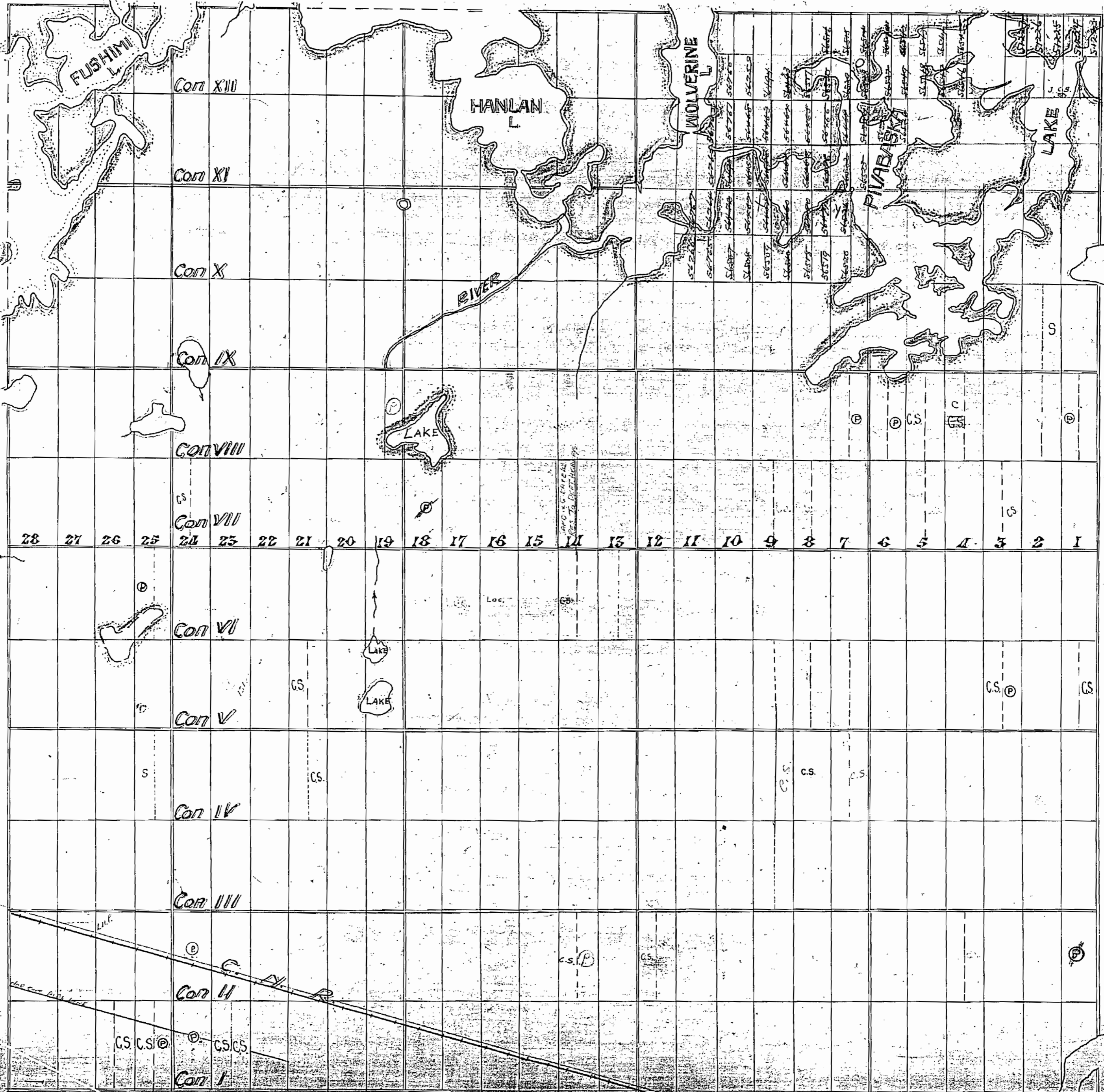

Surface reservation 200 wide by Dept. of L. C.
G.W. Benson, Eng.

WAY

1269

HANLAN

m-1269

DISTRICT OF COCHRANE
SAULT STE. MARIE MINING DIVISION

SCALE: 1-INCH=40 CHAINS
BANNERMAN

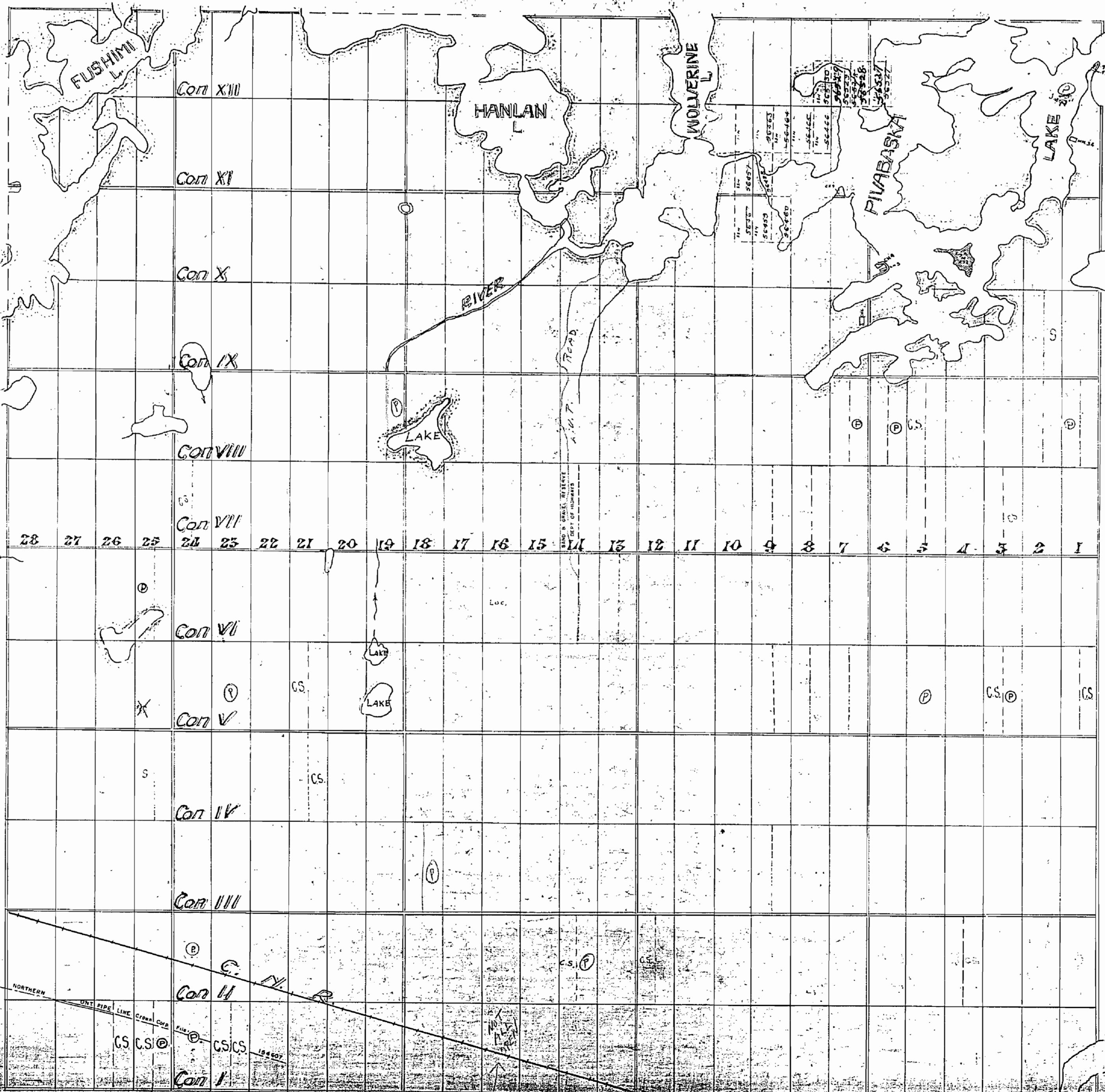

STODDART

CASGRAIN

Surface elevations 400 wgs by Det. J. L. C. 18407