

Hanlan Twp. (M.1269)

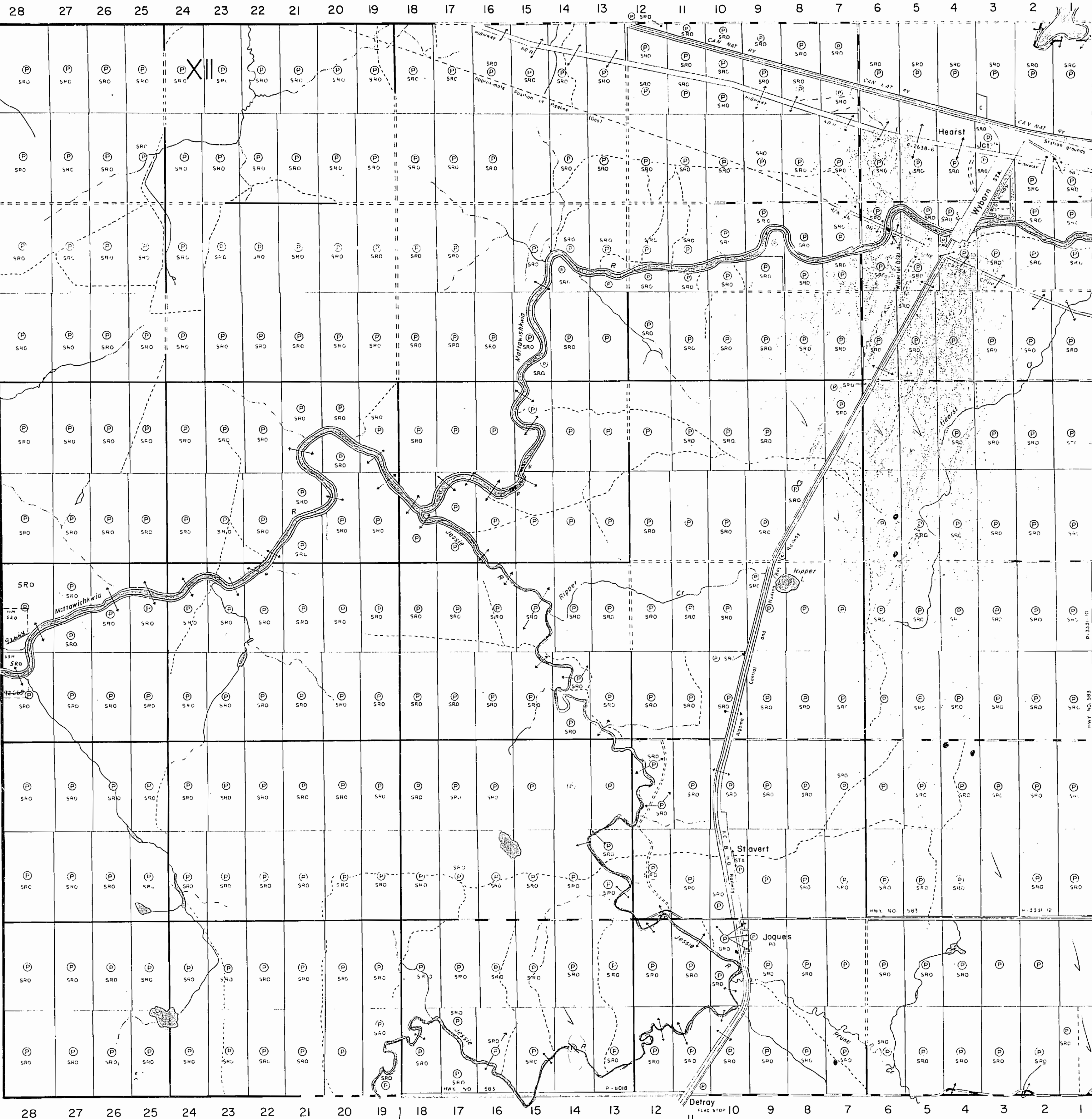

Irish Twp.

CON. "A"

XI

X

IX

VIII

VII

VI

V

IV

III

II

I

Kendall Twp.

Lowther Twp. (M.527)

THE TOWNSHIP OF

WAY

DISTRICT OF ALGOMA
Cochrane

PORCUPINE MINING DIVISION

SCALE: 1-INCH 40 CHAINS

LEGEND

PATENTED LAND	Ⓟ
CROWN LAND SALE	C.S.
LEASES	Ⓛ
LOCATED LAND	Loc.
LICENSE OF OCCUPATION	L.O.
MINING RIGHTS ONLY	M.R.O.
SURFACE RIGHTS ONLY	S.R.O.
ROADS	-----
IMPROVED ROADS	=====
KING'S HIGHWAYS	=====
RAILWAYS	=====
POWER LINES	-----
MARSH OR MUSKEG	-----
MINES	Ⓜ
CANCELLED TRAILS	-----
L.U.P.	Ⓛ.U.P.

NOTES

400' Surface Rights reservation around all Lakes & Rivers.

Parts of lots 9 & 10 con. 2 that may be covered by reg. Plans are subject to sec. 36 of the mining Act.

RECEIVED
OCT 27 1969
AM 7:8,9,10,11,12,1,2,3,4,5,6 PM

PLAN NO. M.1639

DEPARTMENT OF MINES
- ONTARIO -

Hanlan Twp. (M.1269)

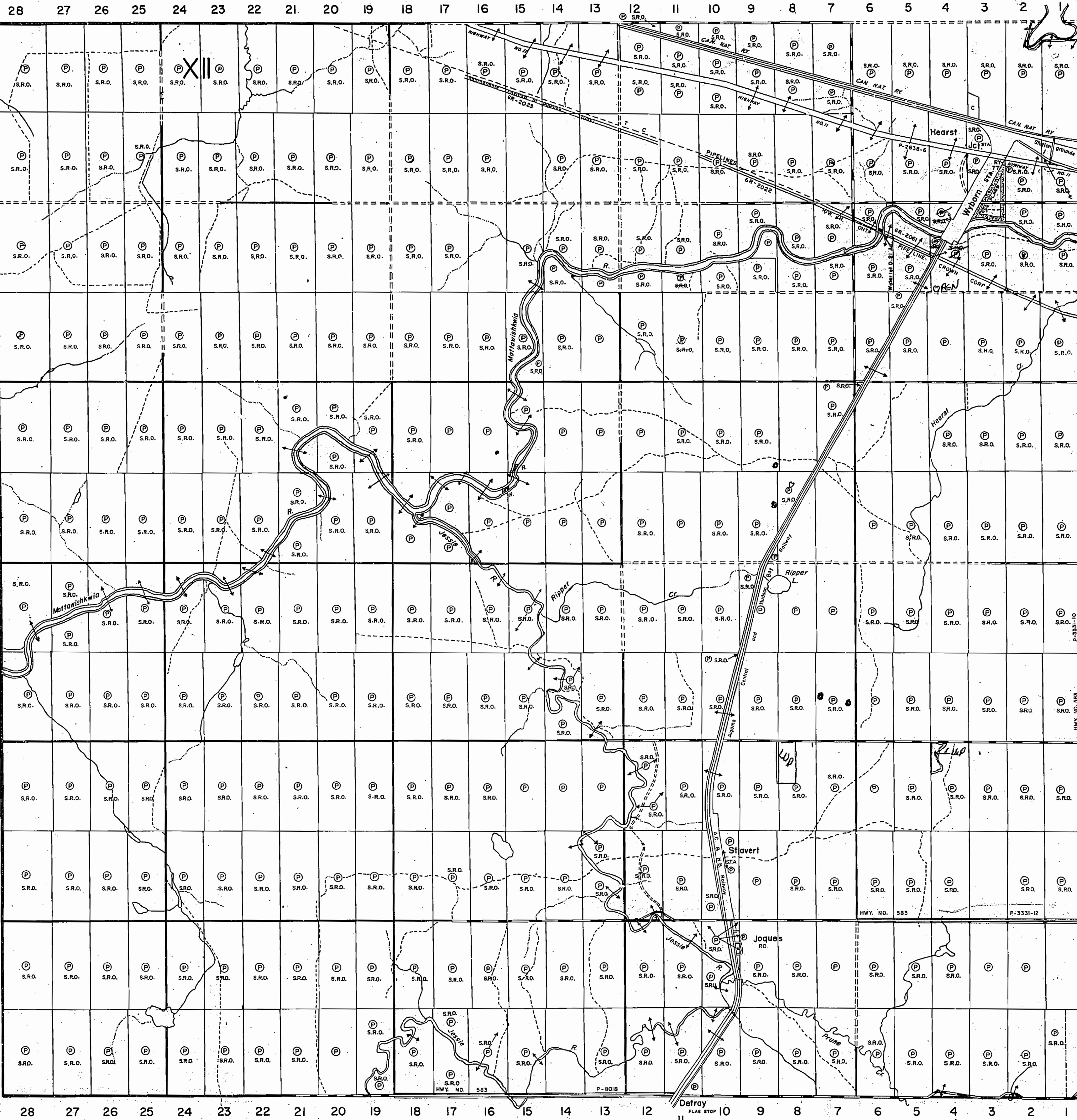

CON. "A"

XI

X

IX

VIII

VII

VI

V

IV

III

II

I

THE TOWNSHIP OF

WAY

DISTRICT OF ALGOMA

PORCUPINE MINING DIVISION

SCALE: 1-INCH = 40 CHAINS

LEGEND

PATENTED LAND	Ⓟ
CROWN LAND SALE	C.S.
LEASES	Ⓛ
LOCATED LAND	Loc.
LICENSE OF OCCUPATION	L.O.
MINING RIGHTS ONLY	M.R.O.
SURFACE RIGHTS ONLY	S.R.O.
ROADS	—
IMPROVED ROADS	—
KING'S HIGHWAYS	—
RAILWAYS	—
POWER LINES	—
MARSH OR MUSKEG	—
MINES	—
CANCELLED	—
TRAILS	—

NOTES

400' Surface Rights reservation around all Lakes & Rivers.

L.U.P.
 Parts of lots 9 & 10 con. 2 that may be covered by reg Plans are subject to sec. 36 of the mining Act.
 Re-opened NRO 8/82

Received Feb 12/80

PLAN NO. M.1639

ONTARIO
 MINISTRY OF NATURAL RESOURCES
 SURVEYS AND MAPPING BRANCH

173

Irish Twp.

Kendall Twp.

Lowther Twp. (M.527)

Hanlan Twp. (M.1269)

THE TOWNSHIP OF

WAY

DISTRICT OF ALGOMA

PORCUPINE MINING DIVISION

SCALE: 1-INCH = 40 CHAINS

LEGEND

PATENTED LAND	Ⓟ	C.S.
CROWN LAND SALE LEASES	Ⓛ	Loc.
LOCATED LAND	Ⓛ	L.O.
LICENSE OF OCCUPATION	Ⓛ	M.R.O.
MINING RIGHTS ONLY	Ⓛ	S.R.O.
SURFACE RIGHTS ONLY	Ⓛ	
ROADS	—	
IMPROVED ROADS	—	
KING'S HIGHWAYS	—	
RAILWAYS	—	
POWER LINES	—	
MARSH OR MUSKEG	—	
MINES	—	
CANCELLED	—	
TRAILS	—	

NOTES

400' Surface Rights reservation around all Lakes & Rivers.

L.U.P.

Parts of lots 9 & 10 con. 2 that may be covered by reg Plans are subject to sec. 36 of the mining Act.

Re-opened NRO 8/82

Received Feb 12/80

PLAN NO. M.1639

ONTARIO
MINISTRY OF NATURAL RESOURCES
SURVEYS AND MAPPING BRANCH

CON. "A"

XI

X

IX

VIII

VII

VI

V

IV

III

II

I

Kendall Twp.

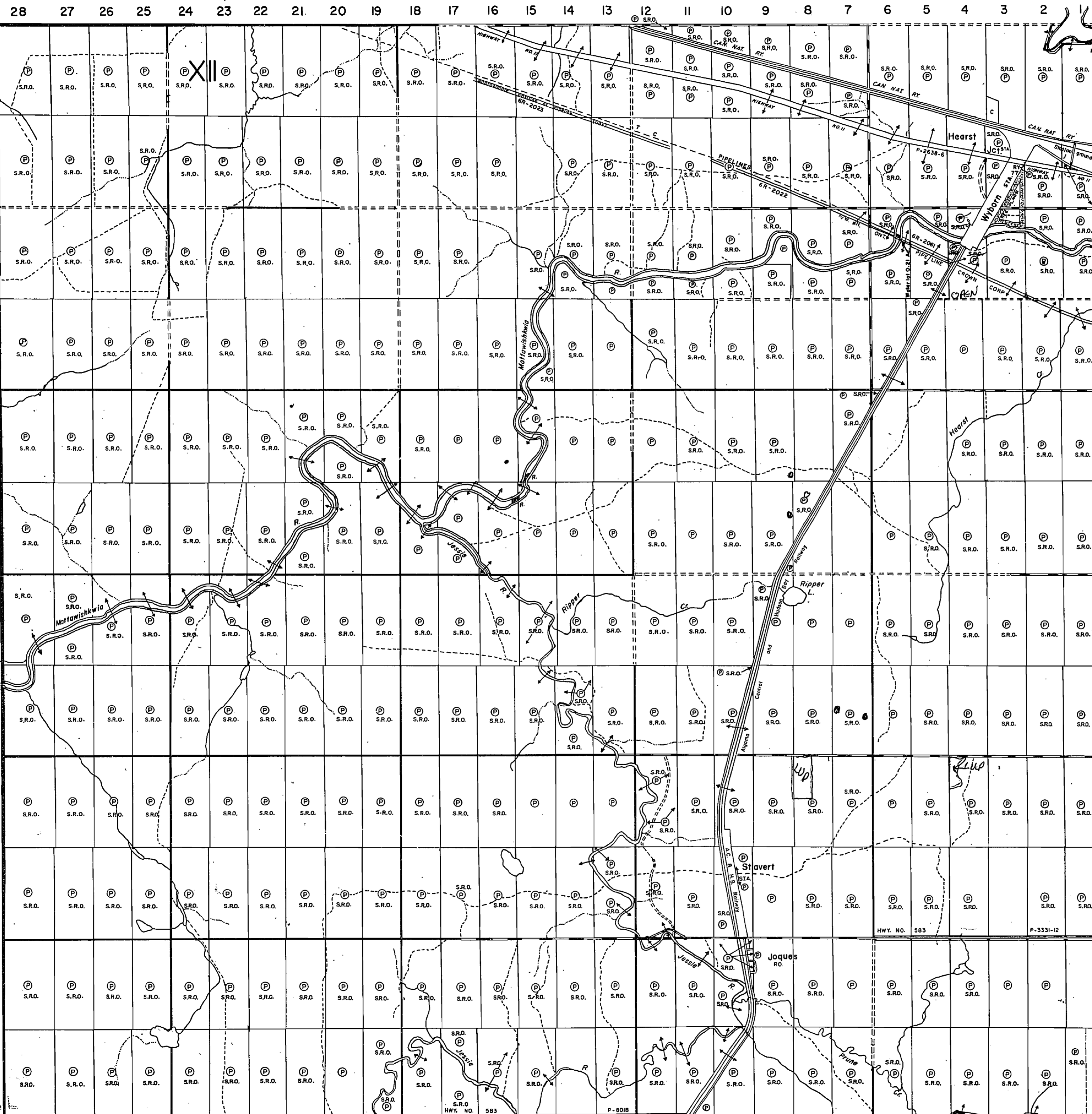

28

27

26

25

24

23

22

21

20

19

18

17

16

15

14

13

12

11

10

9

8

7

6

5

4

3

2

28

27

26

25

24

23

22

21

20

19

18

17

16

15

14

13

12

11

10

9

8

7

6

5

4

3

2

1

Lower Twp. (M.527)

Irish Twp.

Hanlan Twp.

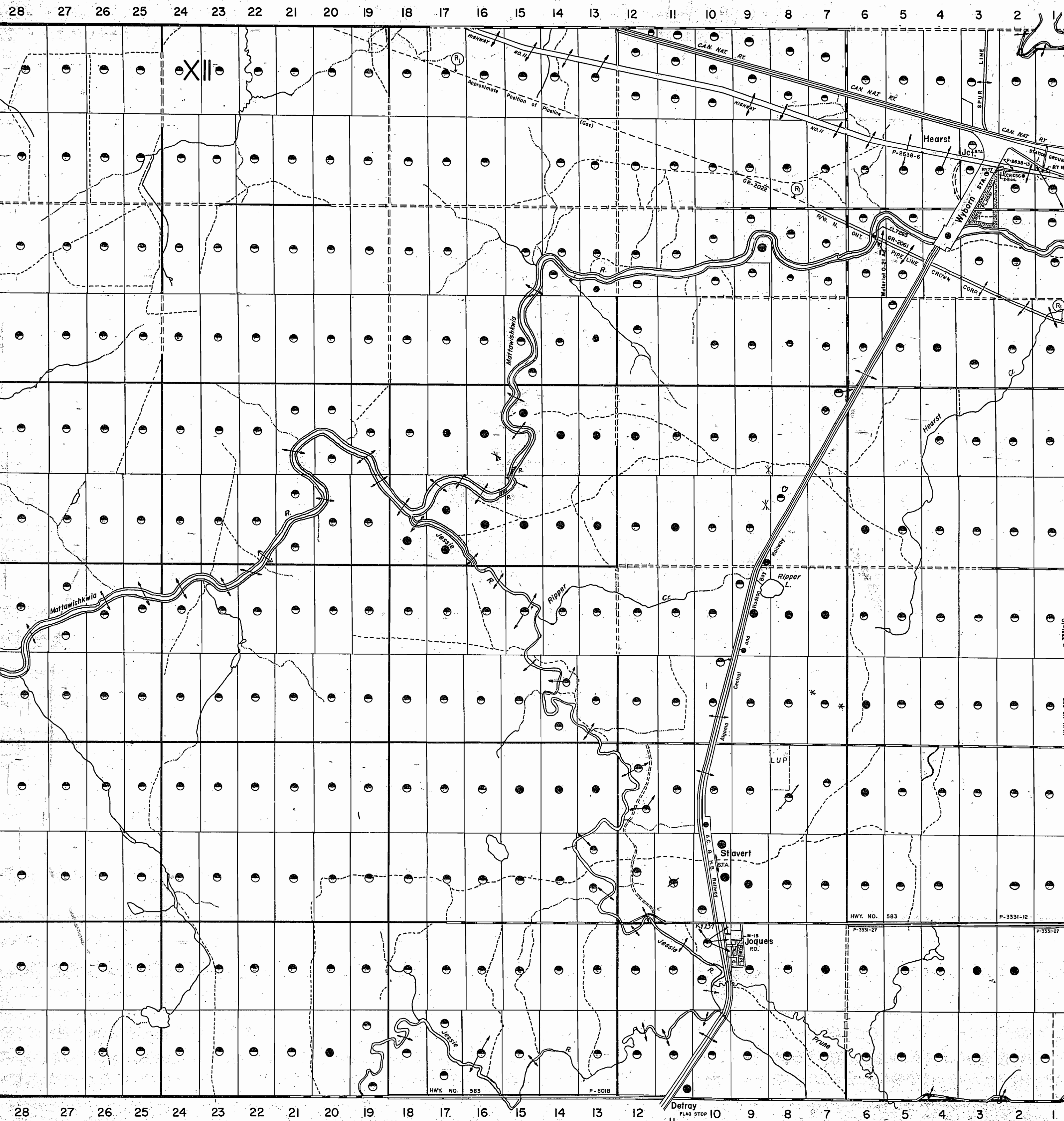

MAGN. TIC
DECLINATION
5° WEST

Irish Twp.

Lowther Twp.

REFERENCE

AREAS WITHDRAWN FROM DISPOSITION

Description	Order No.	Date	Disposition	File
M.R.O. - MINING RIGHTS ONLY				
S.R.O. - SURFACE RIGHTS ONLY				
M.+S. - MINING AND SURFACE RIGHTS				

Surface Rights Withdrawn under Sec. 36, The Mining Act R.S.O. 1980, ORDER NO. W-01/91/CNT (Trans Canada Pipeline Right of Way and Buffer Zone particularly 40.25 meters or 132 ft. on either side of centre line of right of way)

THE INFORMATION THAT APPEARS ON THIS MAP HAS BEEN COMPILLED FROM VARIOUS SOURCES AND ACCURACY IS NOT GUARANTEED. THOSE WISHING TO STAKE MINING CLAIMS SHOULD CONSULT WITH THE MINING RECORDER, MINISTRY OF NORTHERN DEVELOPMENT AND MINES, FOR ADDITIONAL INFORMATION ON THE STATUS OF THE LANDS SHOWN HEREON.

LEGEND

HIGHWAY AND ROUTE No.	
OTHER ROADS	
TRAILS	
SURVEYED LINES:	
TOWNSHIPS, BASE LINES, ETC.	
LOTS, MINING CLAIMS, PARCELS, ETC.	
UNSURVEYED LINES:	
LOT LINES	
PARCEL BOUNDARY	
MINING CLAIMS ETC.	
RAILWAY AND RIGHT OF WAY	
UTILITY LINES	
NON-PERENNIAL STREAM	
FLOODING OR FLOODING RIGHTS	
SUBDIVISION OR COMPOSITE PLAN	
RESERVATIONS	
ORIGINAL SHORELINE	
MARSH OR MUSKEG	
MINES	
TRAVERSE MONUMENT	

DISPOSITION OF CROWN LANDS

TYPE OF DOCUMENT	SYMBOL
PATENT, SURFACE & MINING RIGHTS	
" SURFACE RIGHTS ONLY	
" MINING RIGHTS ONLY	
LEASE, SURFACE & MINING RIGHTS	
" SURFACE RIGHTS ONLY	
" MINING RIGHTS ONLY	
LICENCE OF OCCUPATION	
ORDER-IN-COUNCIL	
RESERVATION	
CANCELLED	
SAND & GRAVEL	
LAND USE PERMIT	

NOTE: MINING RIGHTS IN PARCELS PATENTED PRIOR TO MAY 6, 1913, VESTED IN ORIGINAL PATENTEE BY THE PUBLIC LANDS ACT, R.S.O. 1970, CHAP. 380, SEC. 63, SUBSEC. 1.

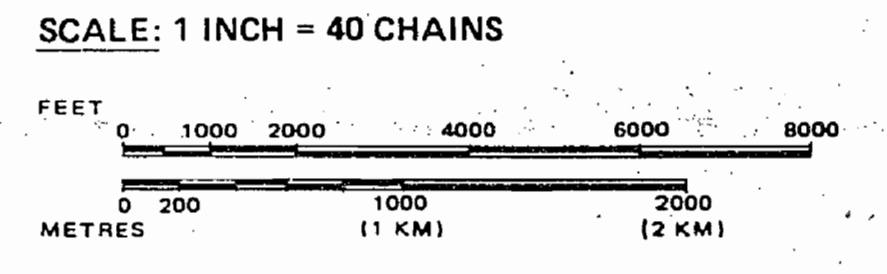

TOWNSHIP
WAY
M.N.R. ADMINISTRATIVE DISTRICT
HEARST
MINING DIVISION
PORCUPINE
LAND TITLES / REGISTRY DIVISION
COCHRANE

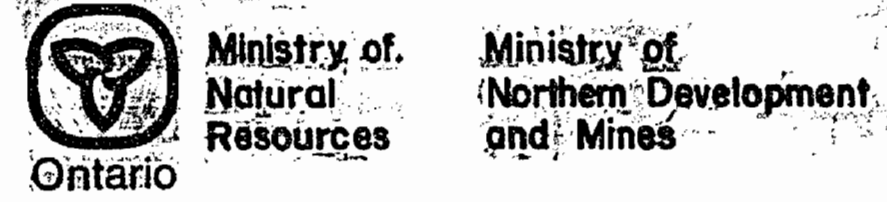

Date: JULY 1986
Number: **G-2361**
ck by R.N. Nov. 6/86
28

CON "A"

XI

X

IX

VIII

VII

VI

V

IV

III

II

I

Kendall Twp.

1639

Hanlan Twp. (M.1269)

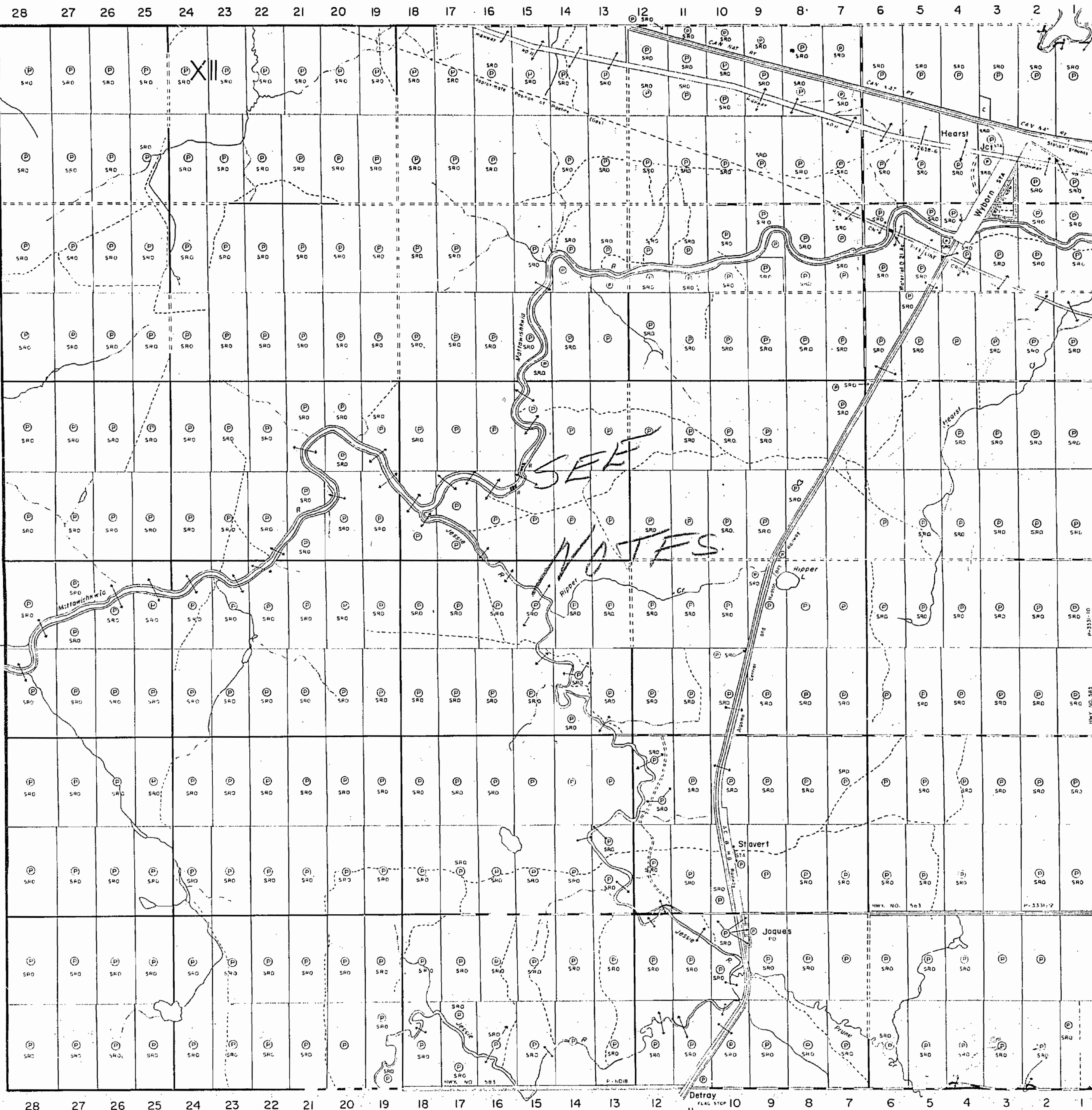

CON. "A"

XI

X

IX

VIII

VII

VI

V

IV

III

II

I

THE TOWNSHIP OF

WAY

DISTRICT OF ALGOMA

SAULT STE. MARIE MINING DIVISION

SCALE: 1-INCH = 40 CHAINS

LEGEND

PATENTED LAND	(P)
CROWN LAND SALE	C.S.
LEASES	(L)
LOCATED LAND	L.O.
LICENSE OF OCCUPATION	L.O.
MINING RIGHTS ONLY	M.R.O.
SURFACE RIGHTS ONLY	S.R.O.
ROADS	—
IMPROVED ROADS	—
KING'S HIGHWAYS	—
RAILWAYS	—
POWER LINES	—
MARSH OR MUSKEG	—
MINES	—
CANCELLED TRAILS	—

NOTES

400' Surface Rights reservation around all Lakes & Rivers.

This entire township withdrawn from staking by order of the Minister of Mines section 42(1)(6) of the Mining Act.

Parts of lots 9 & 10 con. 2 that may be covered by reg. Plans are subject to sec. 36 of the mining Act.

PLAN NO. M.1639

DEPARTMENT OF MINES
- ONTARIO -

2.06 WAY. Old

1639

Hanlan Twp. (M.1269)

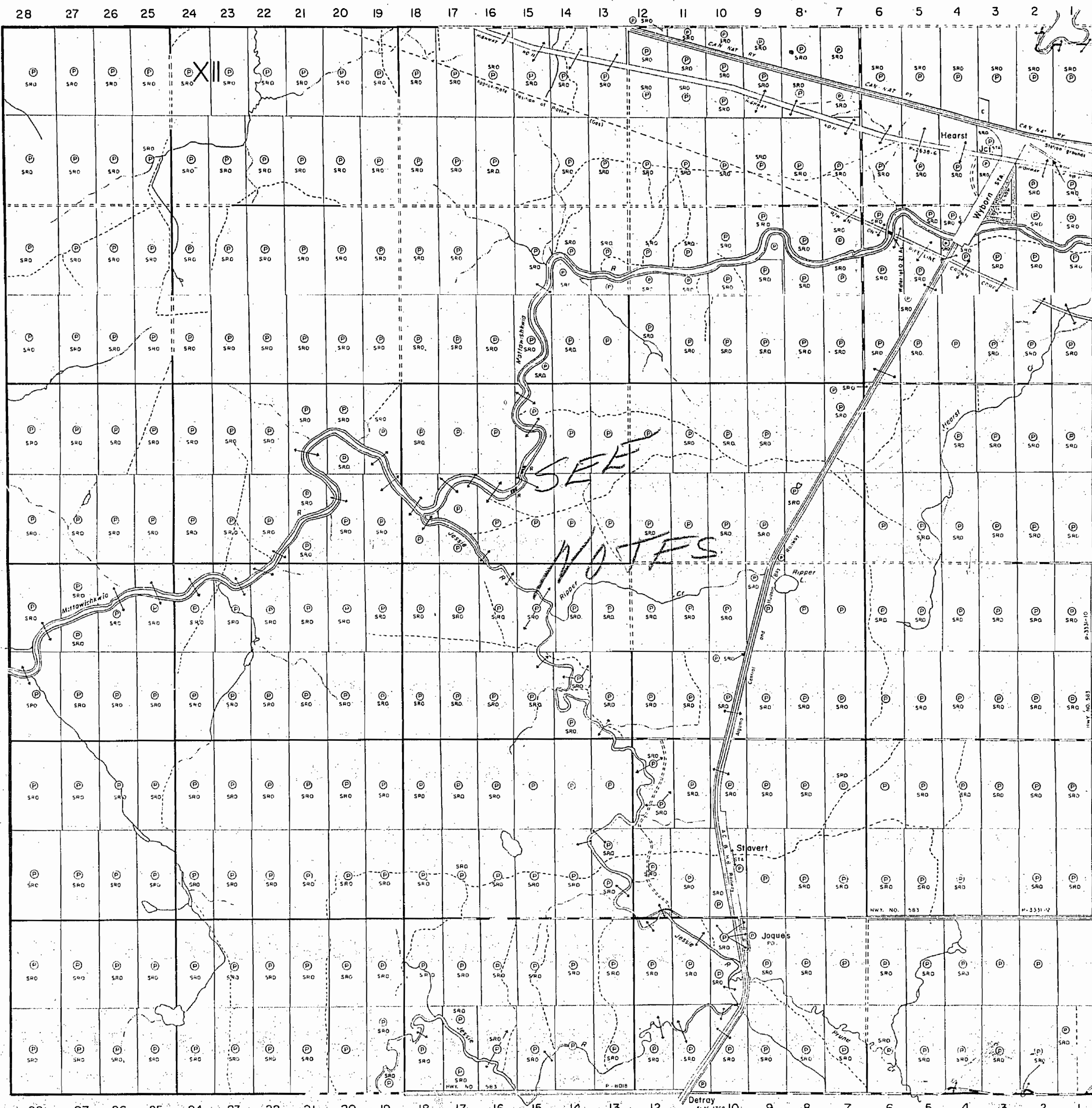

CON. "A"

XI

X

IX

VIII

VII

VI

V

IV

III

II

I

THE TOWNSHIP OF

WAY

DISTRICT OF ALGOMA

SAULT STE. MARIE MINING DIVISION

SCALE: 1-INCH = 40 CHAINS

LEGEND

PATENTED LAND	(P)
CROWN LAND SALE	(C.S.)
LEASES	(L)
LOCATED LAND	(L.O.)
LICENSE OF OCCUPATION	(L.O.)
MINING RIGHTS ONLY	(M.R.O.)
SURFACE RIGHTS ONLY	(S.R.O.)
ROADS	(---)
IMPROVED ROADS	(=)
KING'S HIGHWAYS	(=)
RAILWAYS	(=)
POWER LINES	(=)
MARSH OR MUSKEG	(=)
MINES	(=)
CANCELLED	(=)
TRAILS	(=)

NOTES

400' Surface Rights reservation around all Lakes & Rivers.

This entire township withdrawn from staking by order of the Minister of Mines section 42(1)(6) of the Mining Act.

Parts of lots 9&10 con.2 that may be covered by reg. Plans are subject to sec. 36 of the mining Act.

PLAN NO. - M.1639

DEPARTMENT OF MINES - ONTARIO -

206 WAY. Old