

# ALFINE 8-Speed Internal Hub

## SG-S500

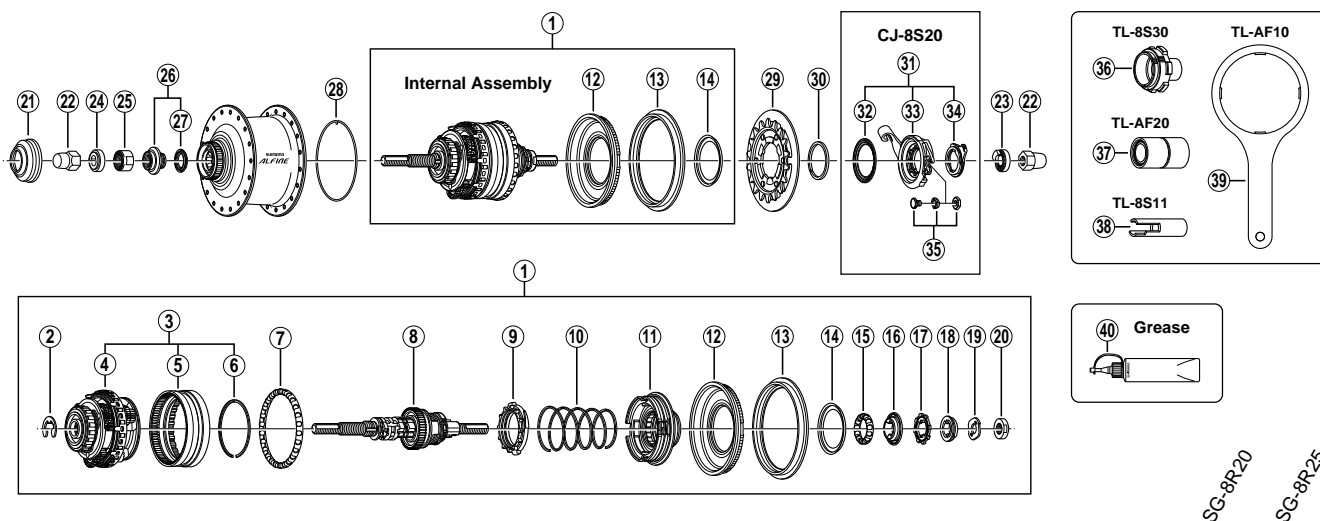

ITEM NO.	SHIMANO CODE NO.	DESCRIPTION	INTERCHANGE-ABILITY	
1	<b>Y-35Z 98010</b>	Internal Assembly (Axle Length 187 mm)		
2	<b>Y-34R 79000</b>	Stop Ring (φ 12 / 1.0 mm)	A	A
	<b>Y-34R 79010</b>	Stop Ring (φ 12 / 1.3 mm)	A	A
	<b>Y-34R 79020</b>	Stop Ring (φ 12 / 1.6 mm)	A	A
3	<b>Y-35Z 98020</b>	Ring Gear Unit		
4	<b>Y-35Z 98030</b>	Carrier Unit		
5	<b>Y-35J 07000</b>	Ring Gear 1		A
6	<b>Y-34R 80000</b>	Ring Gear 1 Stop Ring	A	A
7	<b>Y-34R 98030</b>	Ball Retainer O (3/16" x 26)	A	A
8	<b>Y-35Z 98040</b>	Hub Axle Unit (Axle Length 187mm)		
9	<b>Y-34R 98050</b>	Clutch Unit	A	A
10	<b>Y-34R 21000</b>	Return Spring A	A	A
11	<b>Y-35J 98040</b>	Driver Unit		A
12	<b>Y-35Z 98050</b>	Right Hand Dust Cap A w/Seal		
13	<b>Y-35Z 20000</b>	Chain Guard		
14	<b>Y-34R 0E000</b>	Right Hand Dust Cap B	A	A
15	<b>Y-34R 98070</b>	Ball Retainer P (3/16" x 13)	A	A
16	<b>Y-34R 98080</b>	Right Hand Cone w/Seal	A	A
17	<b>Y-34R 12000</b>	Driver Plate	A	A
18	<b>Y-34R 98090</b>	Lock Washer	A	A
19	<b>Y-34R 09000</b>	Stop Washer	A	A
20	<b>Y-35Z 11000</b>	Right Hand Serated Lock Nut (5.4 mm)		
21	<b>Y-24Z 02000</b>	Rotor Mount Cover		
22	<b>Y-314 14010</b>	Cap Nut (3/8")	A	A
23	<b>Y-34R 85010</b>	Non-turn Washer 8R (Dark Blue)	A	A
24	<b>Y-34R 85000</b>	Non-turn Washer 8L (Dark Green)	A	A
25	<b>Y-35Z 19000</b>	Left Hand Serated Lock Nut (10.7 mm)		
26	<b>Y-35Z 98060</b>	Left Hand Cone w/Dust Cap & Seal Ring		
27	<b>Y-377 10000</b>	Seal Ring		
28	<b>Y-35J 11000</b>	Hub Shell Slide Spring		A
29	<b>Y-12N 98010</b>	Sprocket Wheel 18T w/Guard Plate (CS-S500)		
	<b>Y-12N 98020</b>	Sprocket Wheel 20T w/Guard Plate (CS-S500)		
30	<b>Y-321 20100</b>	Snap Ring C	A	A
31	<b>Y-74Y 98120</b>	CJ-8S20 Cassette Joint Unit	A	A
32	<b>Y-74Y 18000</b>	Driver Cap	A	A
33	<b>Y-74Y 98130</b>	CJ-8S20 Cassette Joint	A	A
34	<b>Y-33Z 98020</b>	Cassette Joint Fixing Ring	A	A
35	<b>Y-74Y 98030</b>	Inner Cable Fixing Bolt Unit	A	A
36	<b>Y-708 00300</b>	TL-8S30 Carrier Unit Tool	A	A
37	<b>Y-708 10000</b>	TL-AF20 Right Hand Cone Installation Tool		
38	<b>Y-708 00600</b>	TL-8S11 Right Hand Cone Removal Tool	A	A
39	<b>Y-320 10000</b>	TL-AF10 Right Hand Dust Cap A Installation Tool		
40	<b>Y-041 20800</b>	Internal Hub Grease (Net. 100g)	A	A

A: Same parts.

B: Parts are usable, but differ in materials, appearance, finish, size, etc.  
Absence of mark indicates non-interchangeability.

0609-2637

Specifications are subject to change without notice.

# SHIMANO