



SOVRINTENDENZA
TAL-PATRIMONJU KULTURALI
SUPERINTENDENCE OF CULTURAL HERITAGE

National Inventory of the Cultural Property of the Maltese Islands

NICPMI Inv. No. 1470

Date of Publication 28 June 2013

Property Name	Ditch - Cittadella				
Address	Ditch				
Town Name	Cittadella	Toponym	-	Local Council	Rabat (Ghawdex)
Property Owner	Government	Managing Body	-		
Guardianship Deed	-				

Period	Modern (17th Century)		
Phase	Early Modern: Knights of St John (17th Century)		
Cultural Heritage Type & Value	Historical Architectural	Cultural Heritage Property Value Assessment	Outstanding
Property Function	Fortification	Conservation Area	UCA (Rabat/Gozo)

Outline Description	Outer work
Property Description	<p>The main ditch of the fortress originally spanned from near St Martin Demi-bastion down to the flank of the low battery. Today it starts from near the salient of St Michael Bastion. A nineteenth-century water reservoir was built into the ditch at the foot of the right face of St Michael Bastion. The ditch has the same level from St Michael Bastion all the way to the middle of the curtain wall linking St Michael Bastion to St John Demi-bastion, where it then descends steeply to reach a lower level at the foot of St John Bastion. Rough rocky scarps form the footing of the wing of St John Demi-bastion. The entrance of what is thought to have been a tunnel cut beneath the bastion in 1645 opens in this rocky scarps.</p>

Scheduled by MEPA	Yes	Degree of Protection	Grade 1	G.N. No.	427	G.N. Date	2001
--------------------------	-----	-----------------------------	---------	-----------------	-----	------------------	------

Recommended Bibliography	<p>S.C. Spiteri, Fortresses of the Knights (Malta, 2001), 237-43</p> <p>Q. Hughes, Malta, a guide to the fortifications (Malta, 1985), 80-3; Q. Hughes & K. Thake, Malta, The Baroque Island (Malta, 2003), 55, 107</p>
---------------------------------	---

Coordinates : Easting

31593

89503

Northing : Coordinates

Property Plan

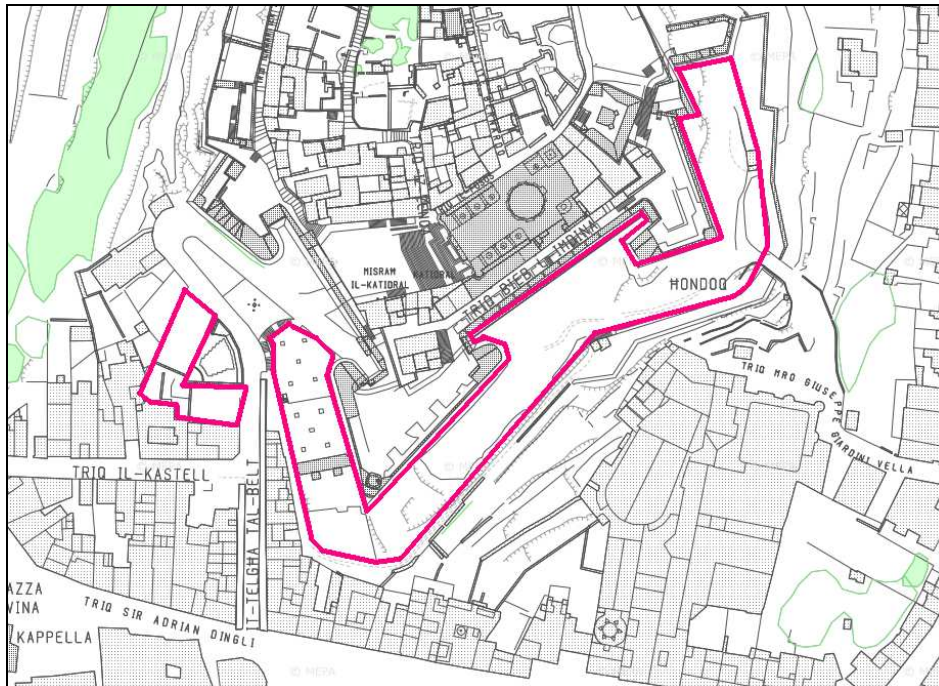

Property Images

