

## INSTALLATION

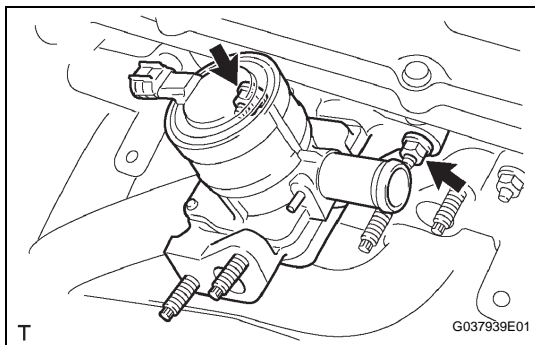

1. **INSTALL AIR SWITCHING VALVE ASSEMBLY**
  - (a) Install a new gasket onto the cylinder head.
  - (b) Install the air switching valve with the 2 nuts.  
**Torque: 20 N\*m (204 kgf\*cm, 15 ft.\*lbf)**

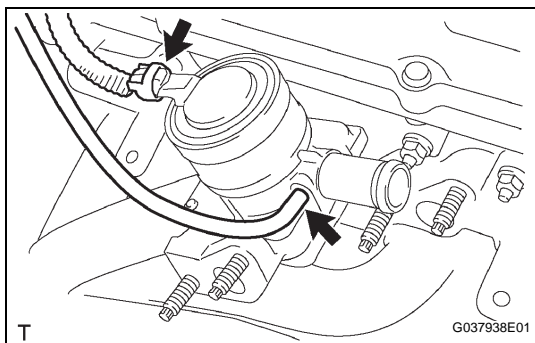

- (c) Connect the air switching valve connector.
- (d) Connect the vacuum hose.

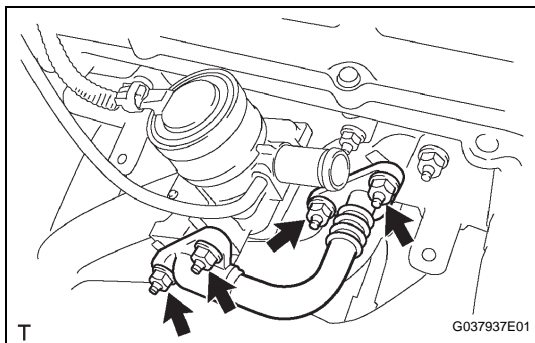

2. **INSTALL INTAKE PIPE INSULATOR**
  - (a) Install 2 new gaskets onto the cylinder head and air switching valve.
  - (b) Install the intake pipe insulator with the 4 nuts.  
**Torque: 20 N\*m (204 kgf\*cm, 15 ft.\*lbf)**

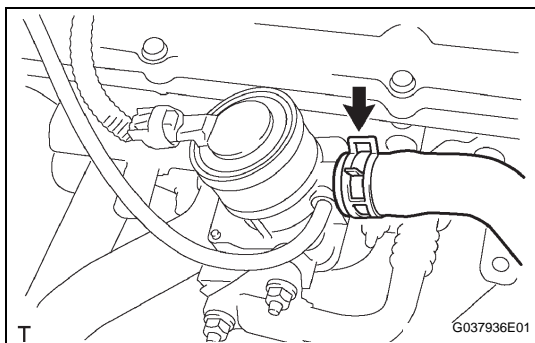

3. **CONNECT AIR INJECTION SYSTEM NO.1 HOSE**
  - (a) Connect the air injection system No. 1 hose to the air switching valve.

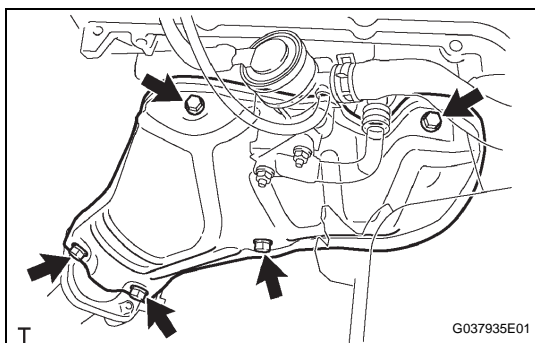

4. **INSTALL EXHAUST MANIFOLD HEAT INSULATOR NO.1**
  - (a) Install the exhaust manifold heat insulator No. 1 with the 5 bolts.  
**Torque: 12 N\*m (122 kgf\*cm, 9 ft.\*lbf)**

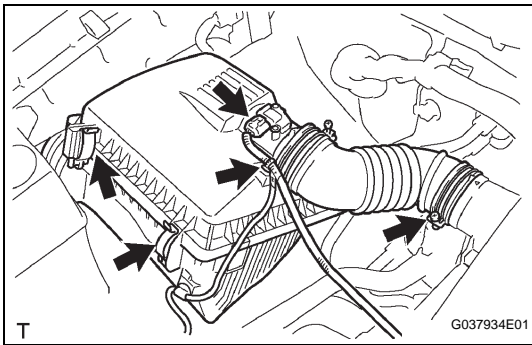
**5. INSTALL AIR CLEANER CAP SUB-ASSEMBLY**

- (a) Install the air cleaner cap together with the air cleaner hose No. 1.
- (b) Connect the 2 air cleaner clamps.
- (c) Tighten the hose clamp bolt, then connect the air cleaner hose No. 1.
- (d) Connect the wire harness clamp.
- (e) Connect the mass air flow meter connector.

**6. INSTALL INTAKE AIR CONNECTOR (See page [ES-455](#))****7. CONNECT CABLE TO NEGATIVE BATTERY TERMINAL**

**Torque: 3.9 N\*m (40 kgf\*cm, 35 in.\*lbf)**