

REASSEMBLY

1. INSTALL GENERATOR ROTOR ASSEMBLY

- (a) Place the drive end frame on the generator rotor assembly.

NOTICE:

Do not drop the generator rotor assembly.

- (b) Install the generator rotor assembly and plate retainer.
- (c) Using a 17 mm socket wrench and press, slowly press in the rectifier end frame.

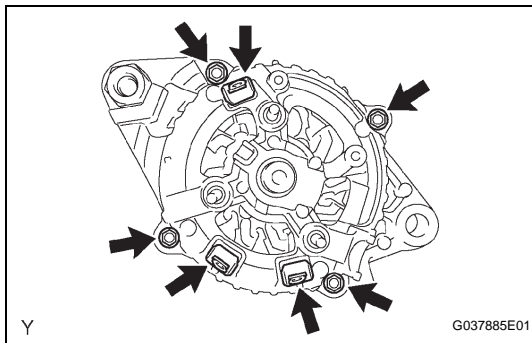
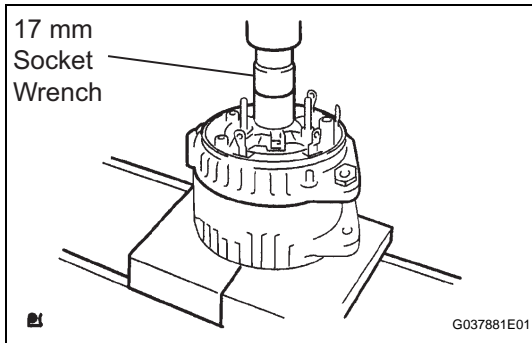

- (d) Install the 4 nuts.

Torque: 4.5 N*m (46 kgf*cm, 40 in.*lbf)

- (e) Install the 3 terminal insulators to the rectifier end frame.

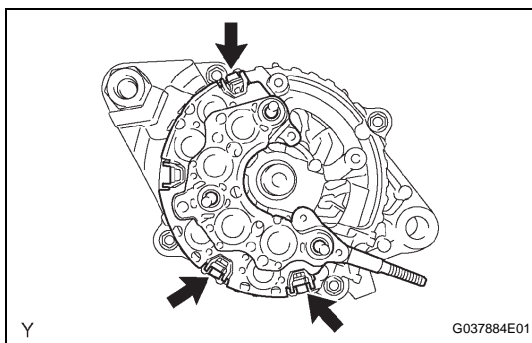

2. INSTALL GENERATOR HOLDER WITH RECTIFIER

- (a) Install the generator rectifier holder with the 3 screws.

Torque: 2.0 N*m (20 kgf*cm, 17 in.*lbf)

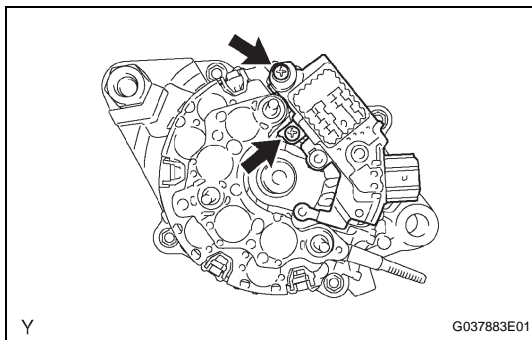

3. INSTALL GENERATOR REGULATOR ASSEMBLY

- (a) Install the generator regulator assembly with the 2 screws.

Torque: 2.0 N*m (20 kgf*cm, 17 in.*lbf)

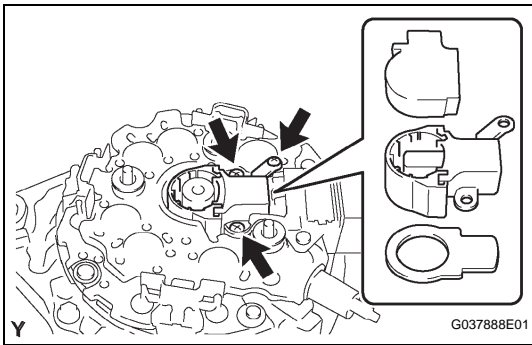

4. INSTALL GENERATOR BRUSH HOLDER ASSEMBLY

- (a) Install the plate seal.
- (b) Install the generator brush holder assembly with the 3 screws.
Torque: 2.0 N*m (20 kgf*cm, 17 in.*lbf)
- (c) Install the brush cover on the generator brush holder assembly.
- (d) Install the rear end cover with the 2 nuts.
Torque: 4.4 N*m (45 kgf*cm, 39 in.*lbf)
- (e) Install the rectifier plate with the nut and screw.
Torque: 4.4 N*m (45 kgf*cm, 39 in.*lbf) for nut
Torque: 3.9 N*m (40 kgf*cm, 34 in.*lbf) for bolt
- (f) Install the terminal insulator with the nut.
Torque: 4.1 N*m (42 kgf*cm, 36 in.*lbf)

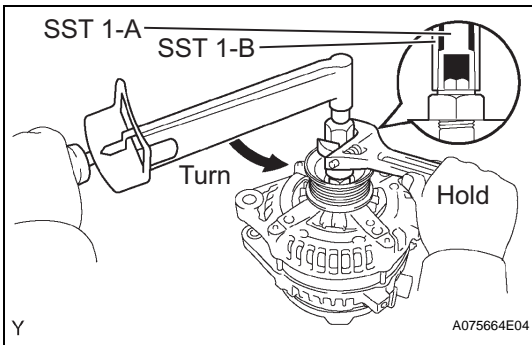

5. INSTALL GENERATOR PULLEY

SST 09820-63010 (09820-06010, 09820-06020)

HINT:

SST 1-A and B	09820-06010
SST 2	09820-06020

- (a) Install the generator pulley to the generator rotor shaft by tightening the generator pulley nut by hand.
- (b) Hold SST 1-A with a torque wrench, and tighten SST 1-B clockwise with the specified torque.

Torque:
39 N*m (398 kgf*cm, 29 ft.*lbf)

NOTICE:

Check that the SST is secured to the generator rotor shaft.

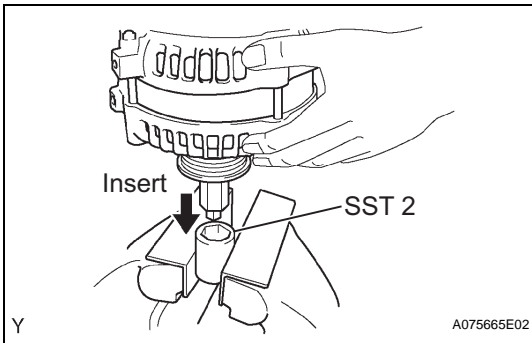

- (c) Mount SST 2 in a vise.
- (d) Insert SST 1-A and B into SST 2, and attach the generator pulley nut to SST 2.

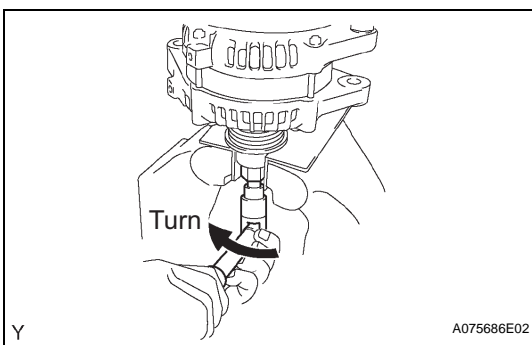

- (e) Tighten the generator pulley nut by turning SST 1-A in the direction shown in the illustration.
Torque: 137 N*m (1,397 kgf*cm, 101 ft.*lbf)
- (f) Remove the generator from SST 2.

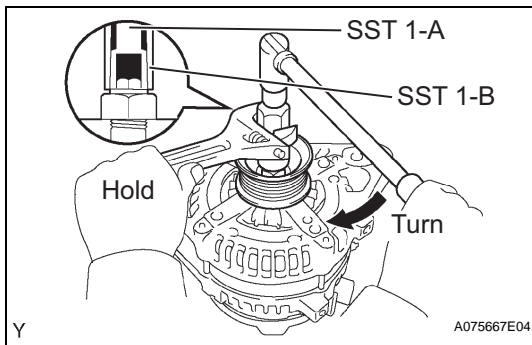

- (g) Turn SST 1-B, and remove SST 1-A and B.
- (h) Turn the generator pulley, and check that the generator pulley moves smoothly.

INSTALLATION

1. INSTALL GENERATOR ASSEMBLY

- (a) Install the generator with the 2 bolts.
Torque: 43 N*m (438 kgf*cm, 32 ft.*lbf)

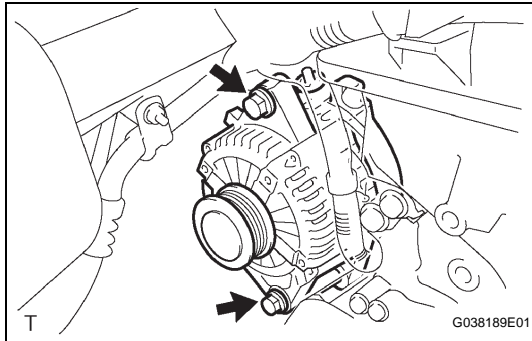

- (b) Connect the generator connector.
- (c) Install the generator wire with the nut.
Torque: 9.8 N*m (100 kgf*cm, 7 ft.*lbf)
- (d) Install the terminal cap.

2. INSTALL FAN AND GENERATOR V BELT (See page EM-6)

3. CONNECT CABLE TO NEGATIVE BATTERY TERMINAL

- Torque: 3.9 N*m (40 kgf*cm, 35 in.*lbf)

