

REMOVAL

1. REMOVE CONSOLE UPPER REAR PANEL SUB-ASSEMBLY (for Separate Seat Type) (See page IP-9)
2. REMOVE REAR CONSOLE BOX ASSEMBLY (for Separate Seat Type) (See page IP-10)
3. REMOVE INSTRUMENT PANEL CUP HOLDER TRAY (for Separate Seat Type) (See page IP-10)
4. REMOVE FRONT CONSOLE BOX (for Separate Seat Type) (See page IP-10)
5. REMOVE FRONT CONSOLE BOX (for Bench Seat Type) (See page IP-11)
6. DISCONNECT TRANSMISSION CONTROL CABLE ASSEMBLY

(a) CABLE TYPE:

- (1) Disconnect the transmission control cable assembly from the shift lever assembly.
- (2) Remove the clip and disconnect the transmission control cable.

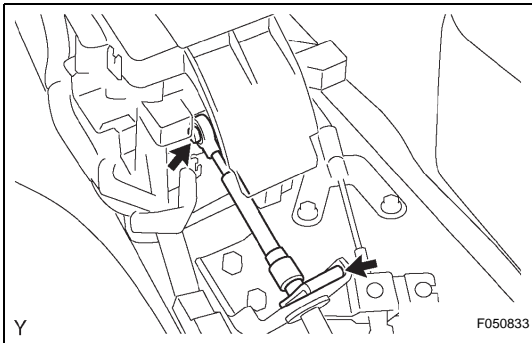

7. SEPARATE FLOOR SHIFT GEAR SHIFTING ROD SUB-ASSEMBLY

(a) ROD TYPE:

- (1) Remove the nut, then separate the floor shift gear shifting rod.

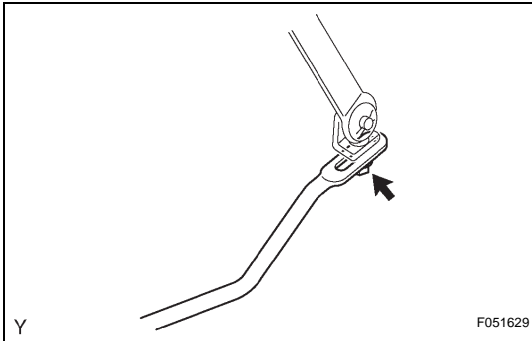

8. REMOVE FLOOR SHIFT ASSEMBLY

- (a) Disconnect the 2 connectors and 2 clamps.
- (b) Remove the 4 bolts and floor shift assembly.

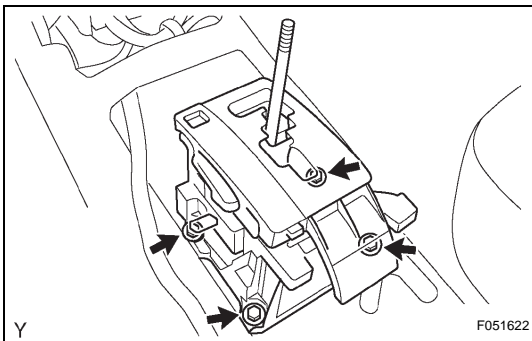

DISASSEMBLY

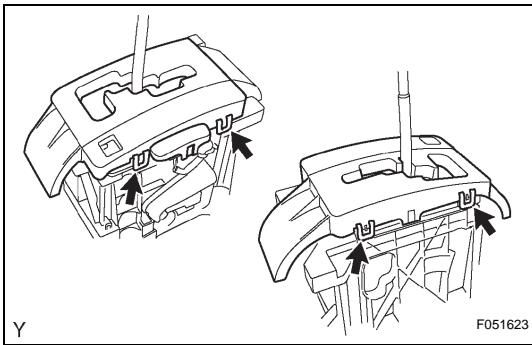

1. REMOVE UPPER POSITION INDICATOR HOUSING

- (a) Release the 4 claws with a screwdriver and remove the position indicator housing and slide cover.

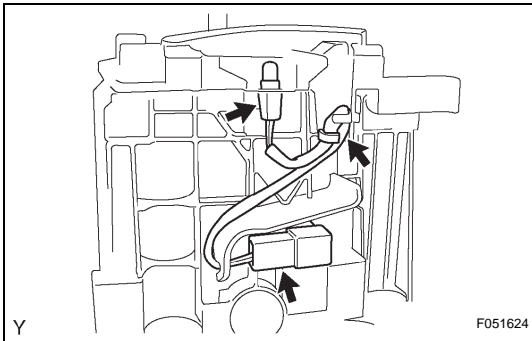

2. REMOVE INDICATOR LAMP WIRE SUB-ASSEMBLY

- (a) Remove the indicator lamp wire sub-assembly.
- (b) Remove the bulb from the indicator lamp wire sub-assembly.

3. REMOVE SHIFT LOCK RELEASE BUTTON

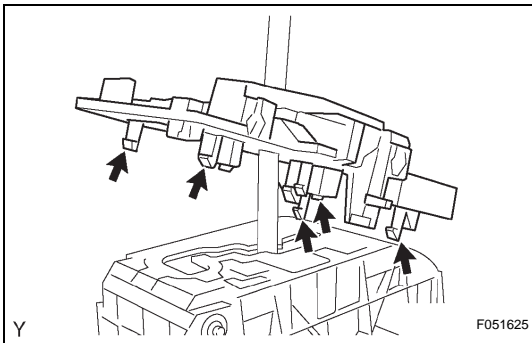

4. REMOVE LOWER POSITION INDICATOR HOUSING

- (a) CABLE TYPE:
 - (1) Release the 5 claws with a screwdriver and remove the position indicator housing lower.

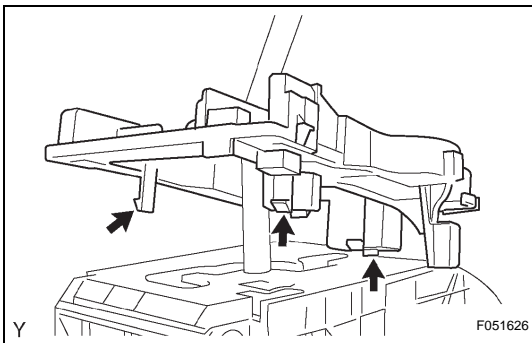

- (b) ROD TYPE:
 - (1) Release the 3 claws with a screwdriver and remove the position indicator housing lower.

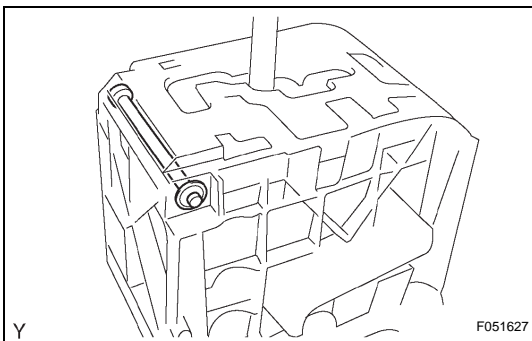

5. REMOVE SHIFT LOCK CONTROL ECU SUB-ASSEMBLY

- (a) Remove the shift lever nut and shift lever lock pin.
- (b) Remove the shift lever guide housing.
- (c) Release the 2 claws with a screwdriver and remove the shift lock release link and spring.

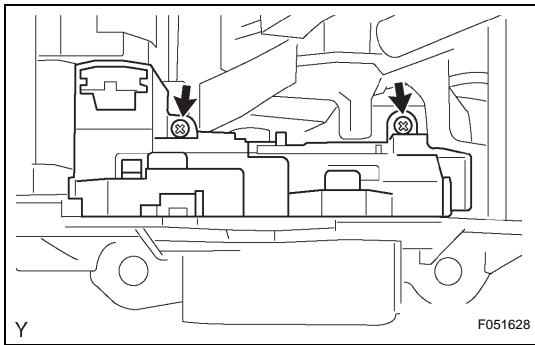

- (d) Remove the 2 screws and the shift lock control ECU.