

AT

## REMOVAL

1. REMOVE CONSOLE UPPER REAR PANEL SUB-ASSEMBLY (for Separate Seat Type) (See page [IP-9](#))
2. REMOVE REAR CONSOLE BOX ASSEMBLY (for Separate Seat Type) (See page [IP-10](#))
3. REMOVE INSTRUMENT PANEL CUP HOLDER TRAY (for Separate Seat Type) (See page [IP-10](#))
4. REMOVE FRONT CONSOLE BOX (for Separate Seat Type) (See page [IP-10](#))
5. REMOVE FRONT CONSOLE BOX (for Bench Seat Type) (See page [IP-11](#))
6. DISCONNECT TRANSMISSION CONTROL CABLE ASSEMBLY
  - (a) CABLE TYPE:
    - (1) Disconnect the transmission control cable assembly from the shift lever assembly.
    - (2) Remove the clip and disconnect the transmission control cable.

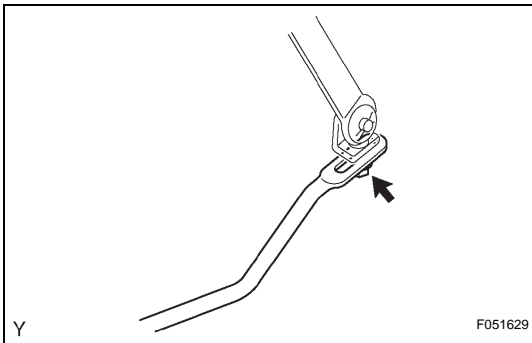
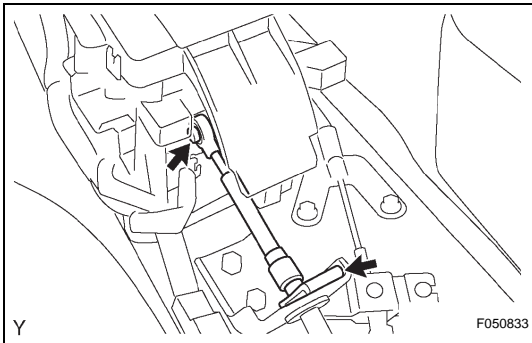

7. SEPARATE FLOOR SHIFT GEAR SHIFTING ROD SUB-ASSEMBLY
  - (a) ROD TYPE:
    - (1) Remove the nut, then separate the floor shift gear shifting rod.

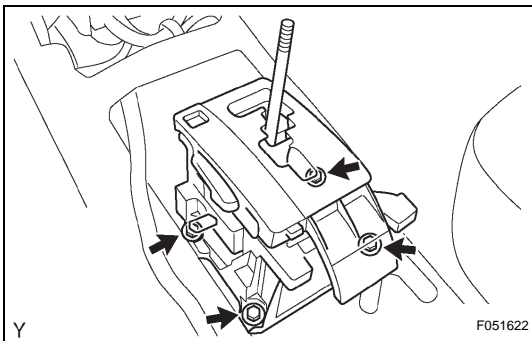

8. REMOVE FLOOR SHIFT ASSEMBLY
  - (a) Disconnect the 2 connectors and 2 clamps.
  - (b) Remove the 4 bolts and floor shift assembly.

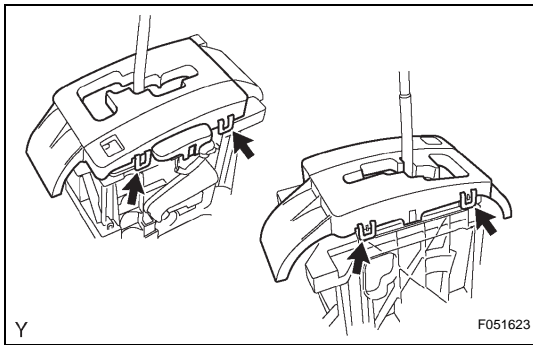
**DISASSEMBLY**

1. **REMOVE UPPER POSITION INDICATOR HOUSING**
  - (a) Release the 4 claws with a screwdriver and remove the position indicator housing and slide cover.

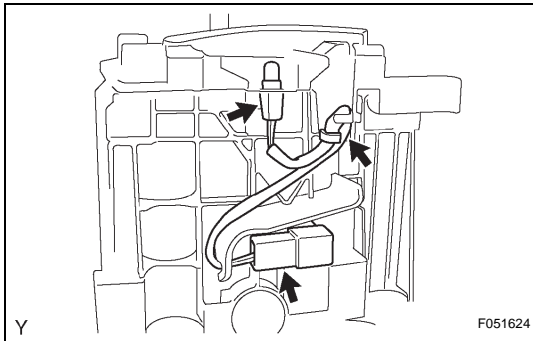

2. **REMOVE INDICATOR LAMP WIRE SUB-ASSEMBLY**
  - (a) Remove the indicator lamp wire sub-assembly.
  - (b) Remove the bulb from the indicator lamp wire sub-assembly.

3. **REMOVE SHIFT LOCK RELEASE BUTTON**

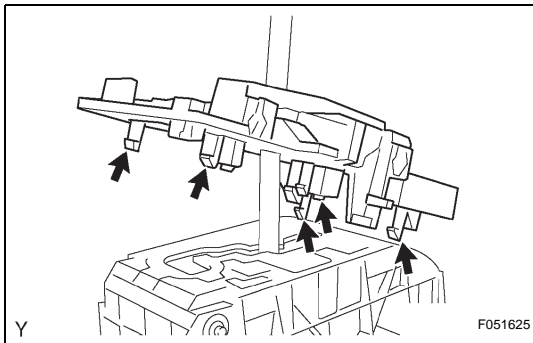

4. **REMOVE LOWER POSITION INDICATOR HOUSING**
  - (a) **CABLE TYPE:**
    - (1) Release the 5 claws with a screwdriver and remove the position indicator housing lower.

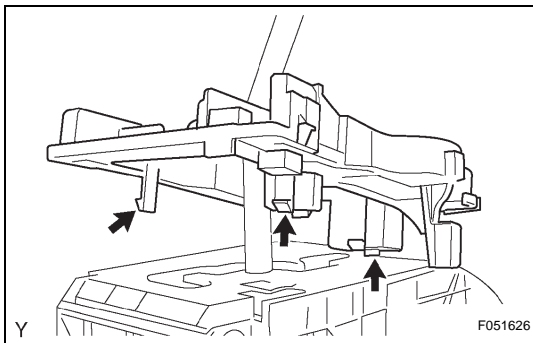

- (b) **ROD TYPE:**
  - (1) Release the 3 claws with a screwdriver and remove the position indicator housing lower.

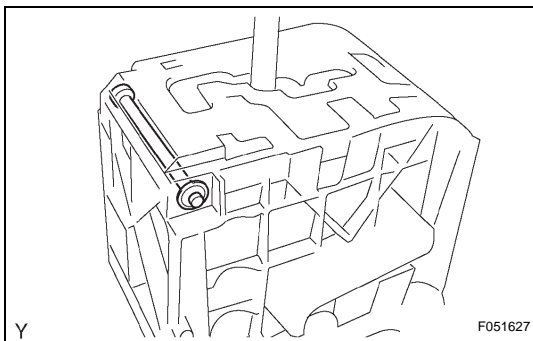

5. **REMOVE SHIFT LOCK CONTROL ECU SUB-ASSEMBLY**
  - (a) Remove the shift lever nut and shift lever lock pin.
  - (b) Remove the shift lever guide housing.
  - (c) Release the 2 claws with a screwdriver and remove the shift lock release link and spring.

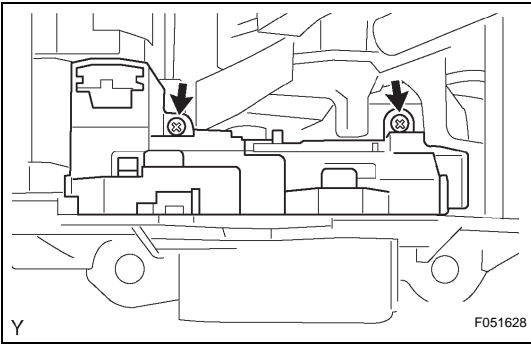

- (d) Remove the 2 screws and the shift lock control ECU.

AT