

CLUTCH RELEASE CYLINDER (for R155)

COMPONENTS

CL

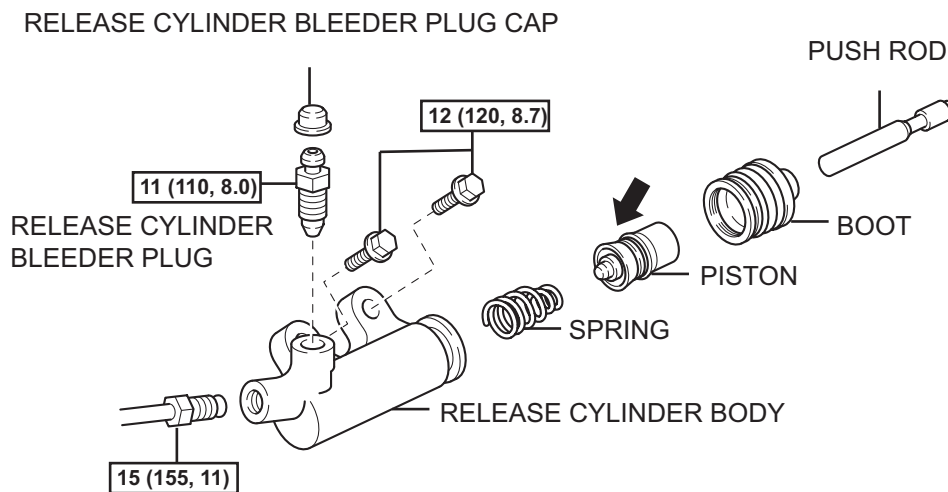

CLUTCH RELEASE CYLINDER TO FLEXIBLE HOSE TUBE

N*m (kgf*cm, ft*lbf) :Specified torque

Lithium soap base glycol grease

REMOVAL

1. DRAIN CLUTCH FLUID
2. DISCONNECT CLUTCH RELEASE CYLINDER TO FLEXIBLE HOSE TUBE

(a) Using SST, disconnect the flexible hose tube.
SST 09023-00101

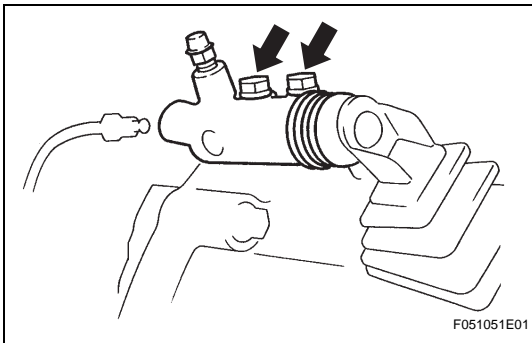
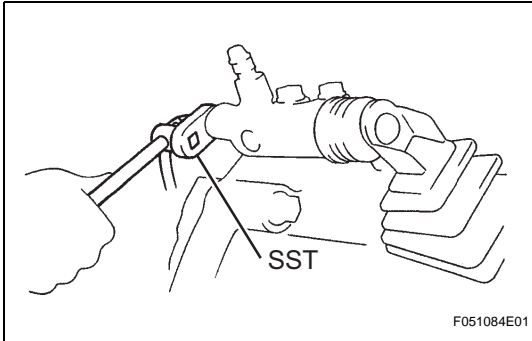

3. REMOVE CLUTCH RELEASE CYLINDER ASSEMBLY

(a) Remove the 2 bolts and pull out the clutch release cylinder.