

# CLUTCH RELEASE CYLINDER (for R155F)

## COMPONENTS

CL

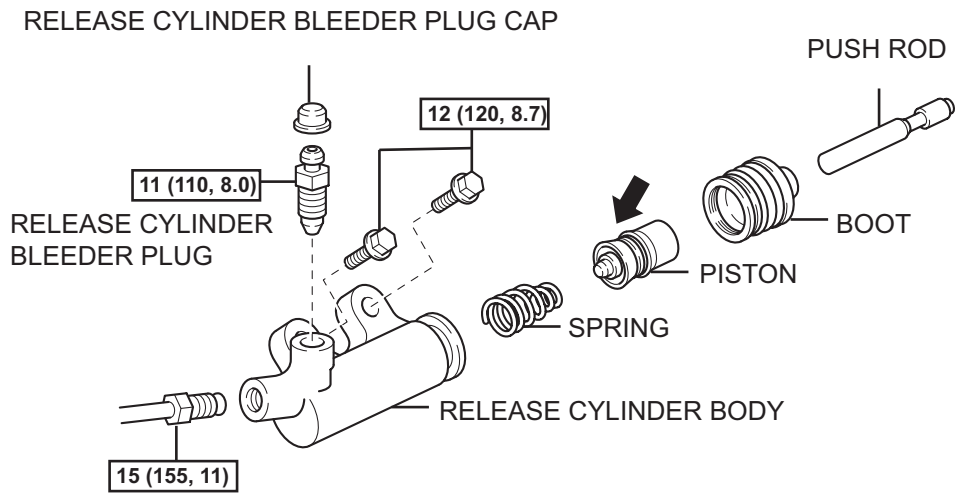

CLUTCH RELEASE CYLINDER TO FLEXIBLE HOSE TUBE

**N\*m (kgf\*cm, ft\*lbf)** :Specified torque

Lithium soap base glycol grease

## REMOVAL

1. DRAIN CLUTCH FLUID
2. DISCONNECT CLUTCH RELEASE CYLINDER TO FLEXIBLE HOSE TUBE

(a) Using SST, disconnect the flexible hose tube.  
**SST 09023-00101**

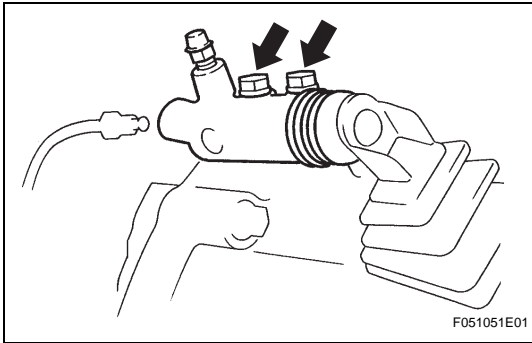
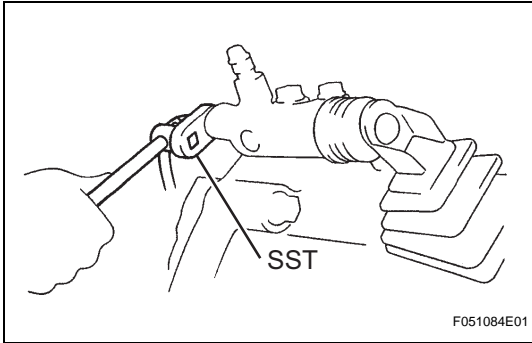

3. REMOVE CLUTCH RELEASE CYLINDER ASSEMBLY

(a) Remove the 2 bolts and pull out the clutch release cylinder.

**CL**