

MANUAL TRANSMISSION UNIT

COMPONENTS

MT

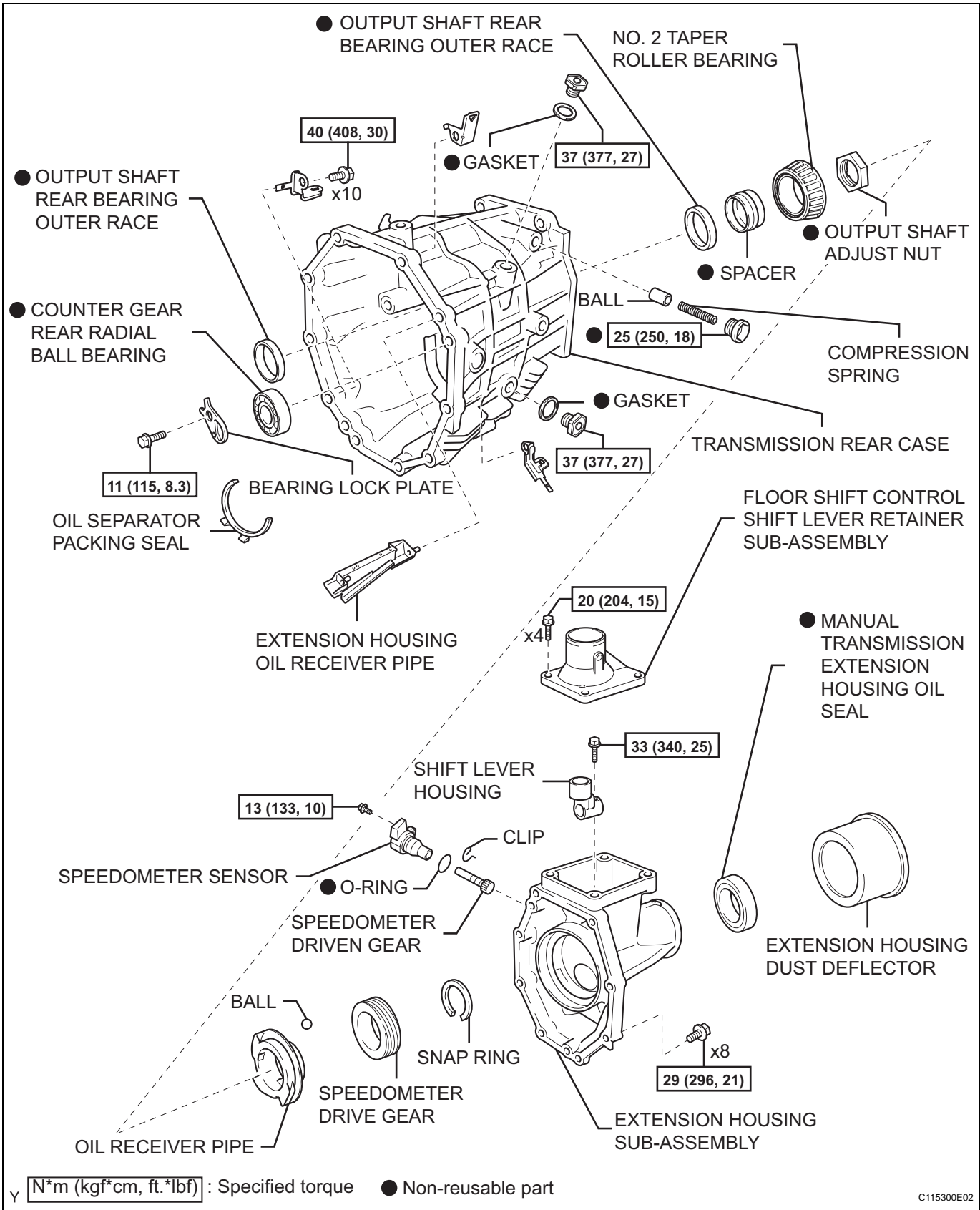

MT

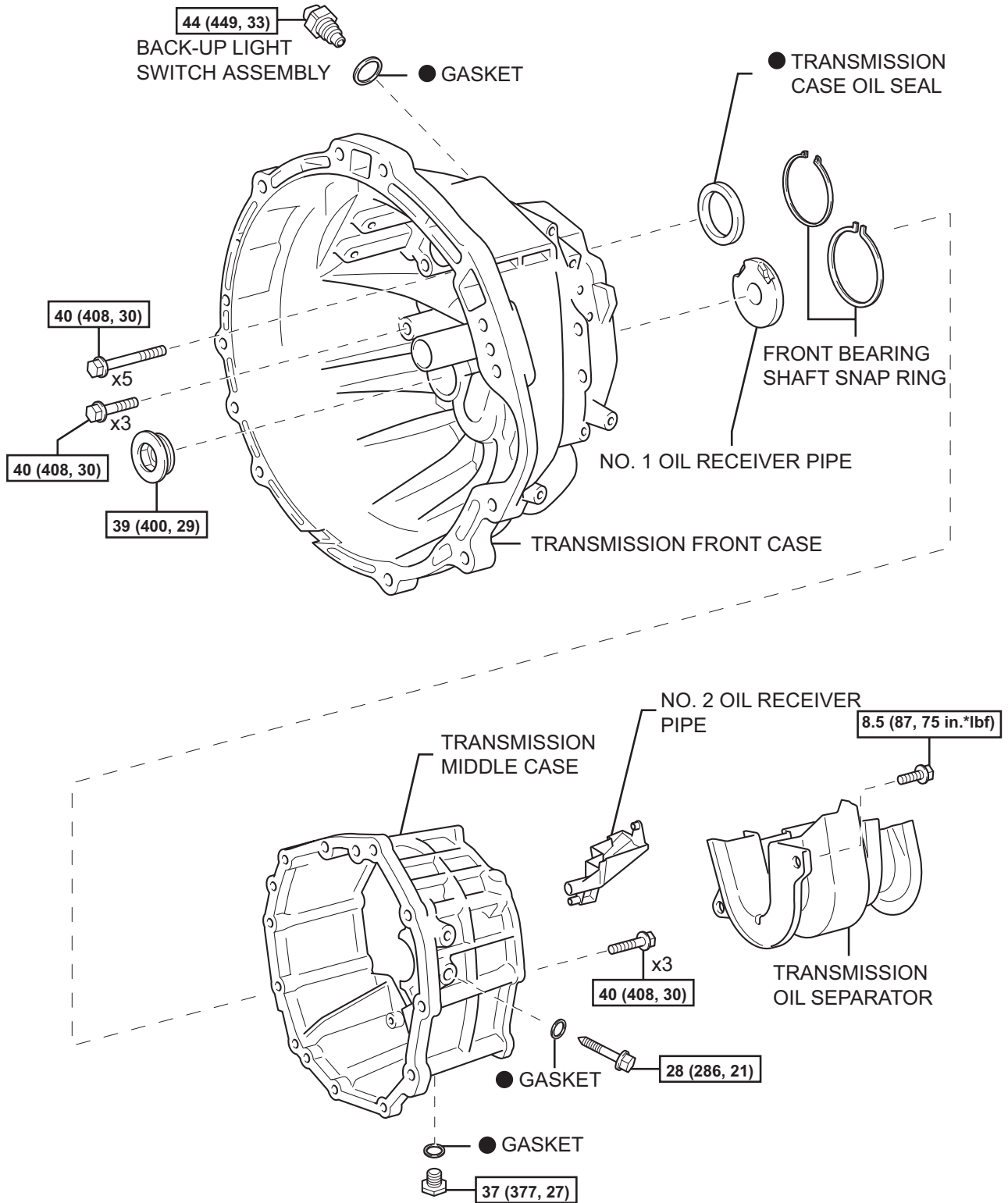

[N*m (kgf*cm, ft.*lbf)] : Specified torque

● Non-reusable part

MT

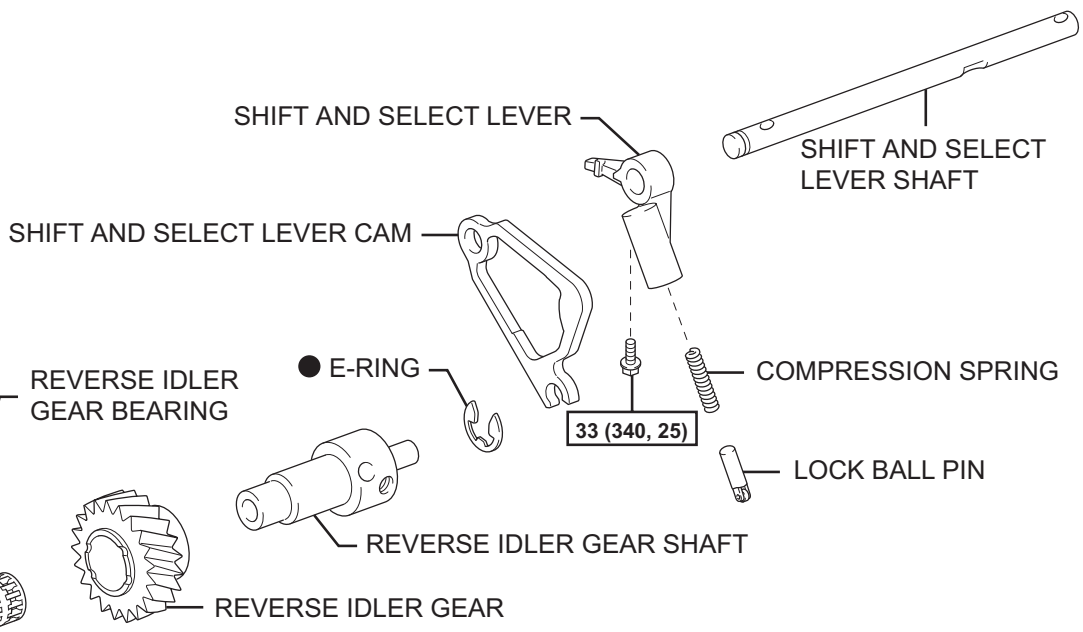
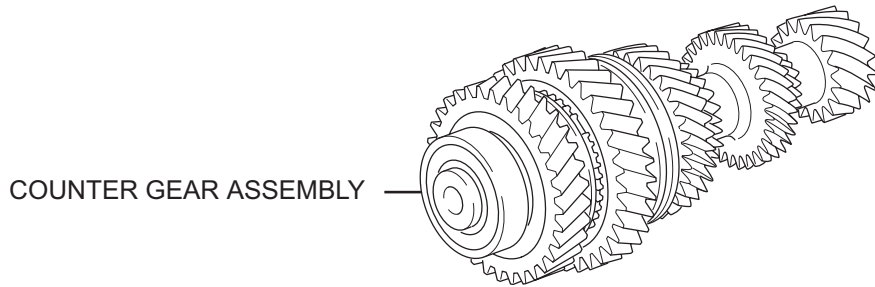
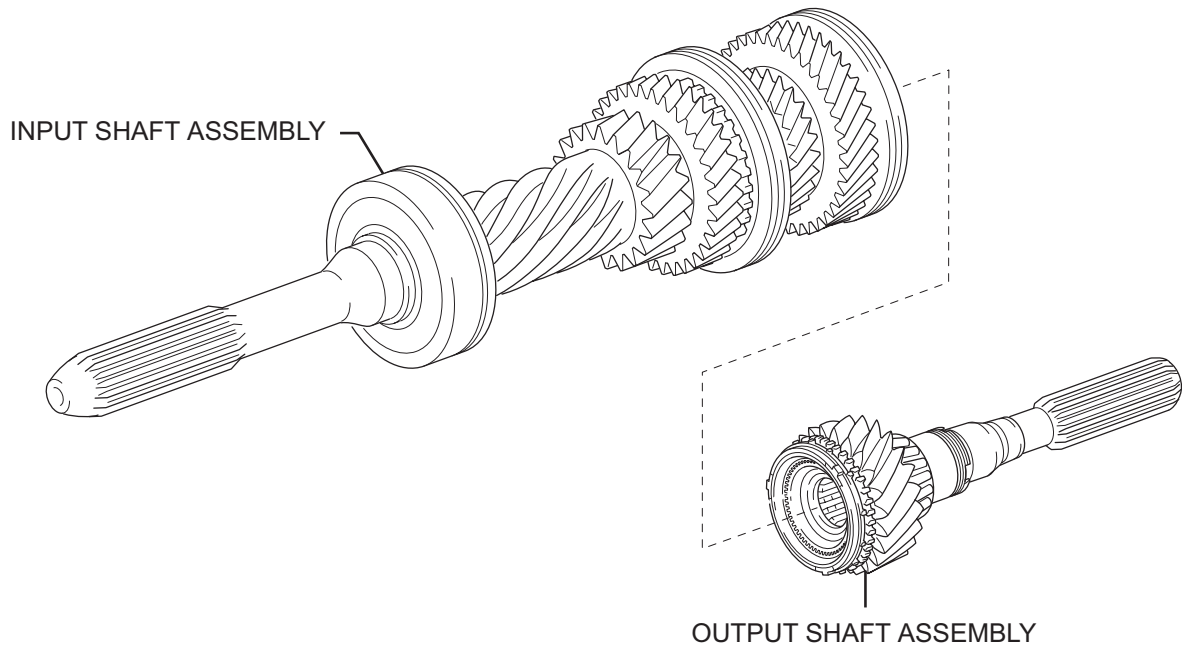

γ [N*m (kgf*cm, ft.*lbf)] : Specified torque ● Non-reusable part

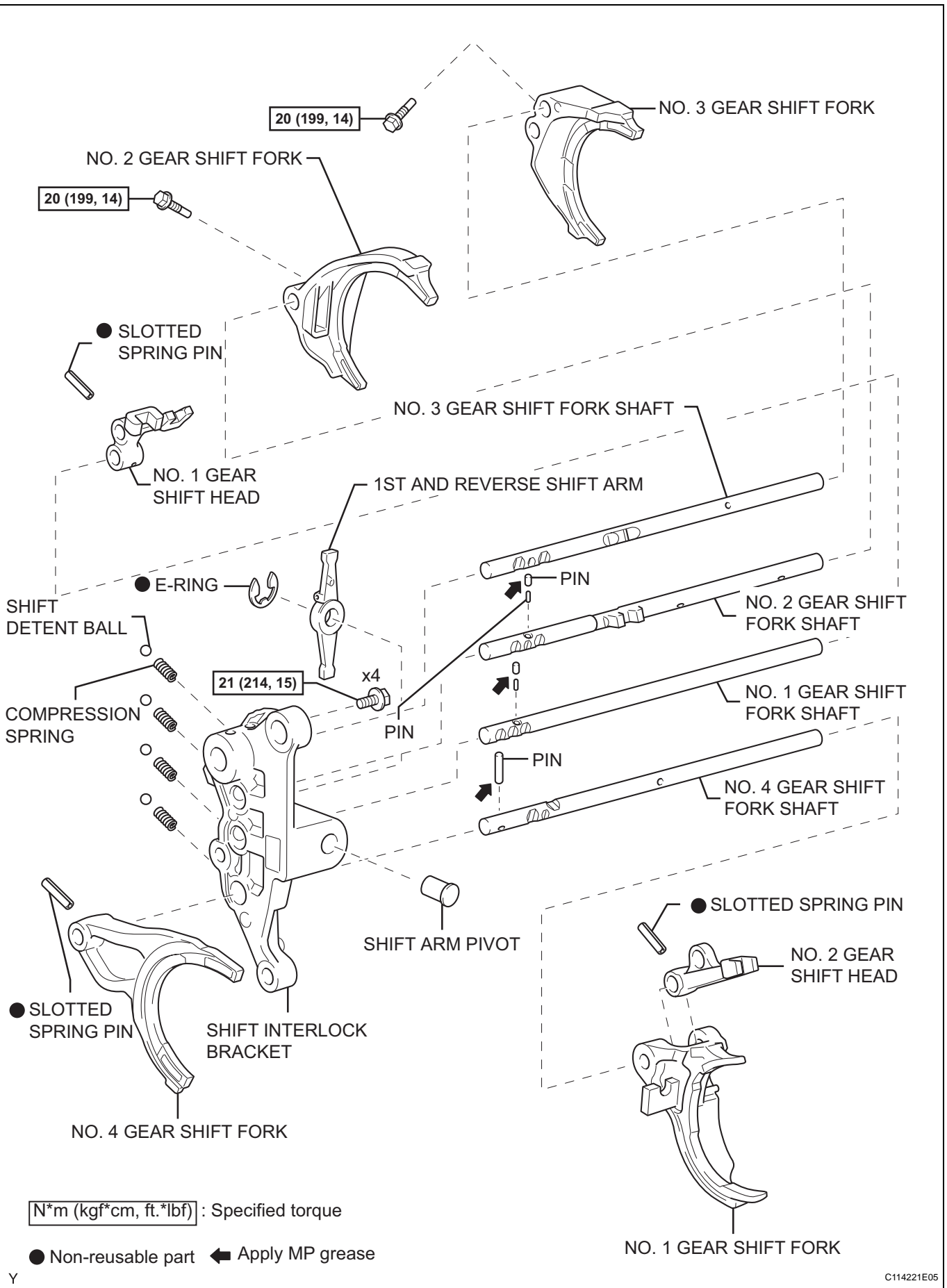

DISASSEMBLY

1. REMOVE FLOOR SHIFT CONTROL SHIFT LEVER RETAINER SUB-ASSEMBLY

(a) Remove the 4 bolts, then remove the floor shift control shift lever retainer.

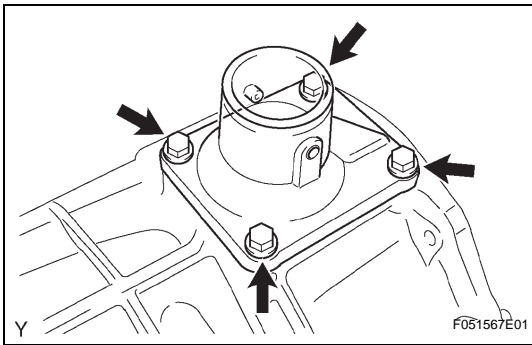

(b) Using a plastic hammer, remove the floor shift control shift lever retainer.

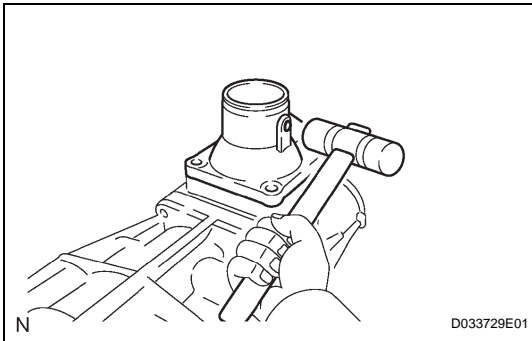

2. REMOVE SHIFT LEVER HOUSING

(a) Remove the bolt, then separate the shift lever housing.

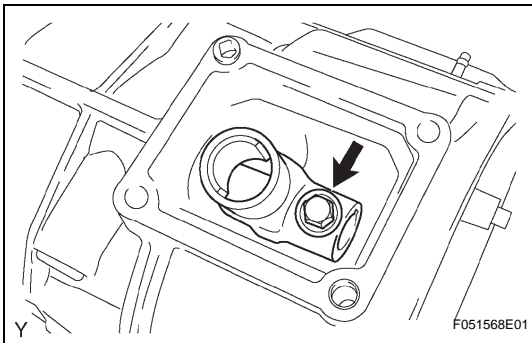

3. REMOVE SPEEDOMETER SENSOR

(a) Remove the bolt and speedometer sensor.

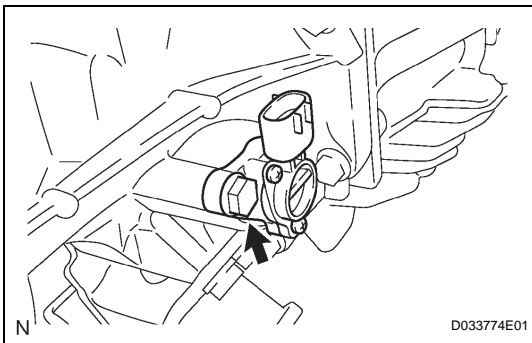

(b) Remove the clip from the speedometer sensor.

(c) Remove the driven gear from the speedometer sensor.

(d) Remove the O-ring from the speedometer sensor.

(e) Check the speedometer driven gear teeth.

If the driven gear is damaged, replace it.

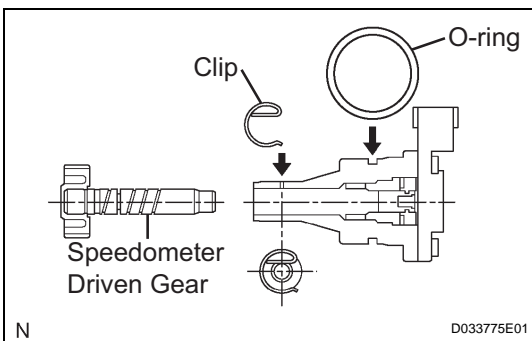

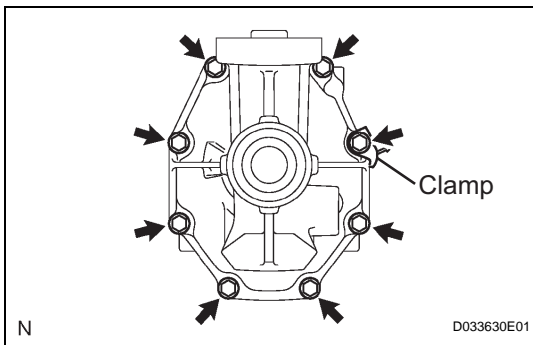

4. REMOVE EXTENSION HOUSING SUB-ASSEMBLY

- (a) Remove the 8 bolts and clamp, then remove the extension housing sub-assembly.

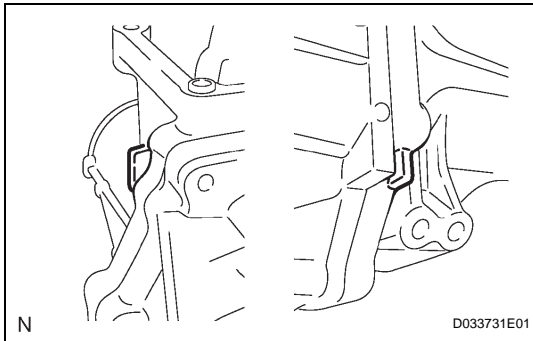

- (b) Using a plastic hammer, carefully tap out the extension housing.

- (c) Remove the shift lever housing.

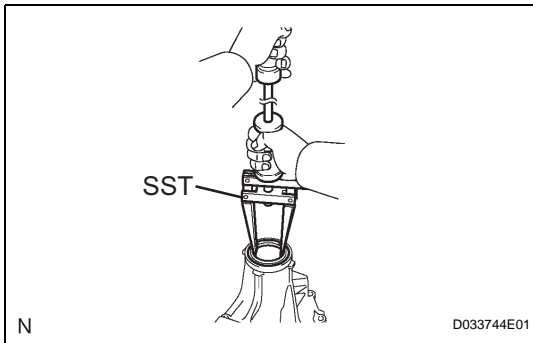

5. REMOVE MANUAL TRANSMISSION EXTENSION HOUSING OIL SEAL

- (a) Using SST, remove the extension housing oil seal.
SST 09308-00010

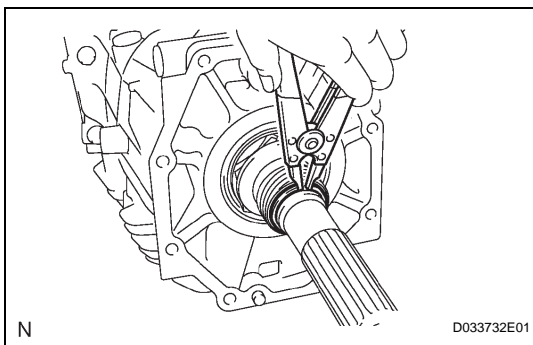

6. REMOVE SPEEDOMETER DRIVE GEAR

- (a) Using a snap ring expander, remove the snap ring.

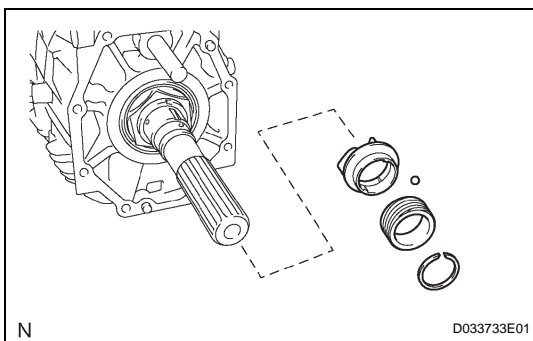

- (b) Remove the speedometer drive gear, ball and oil receiver pipe.

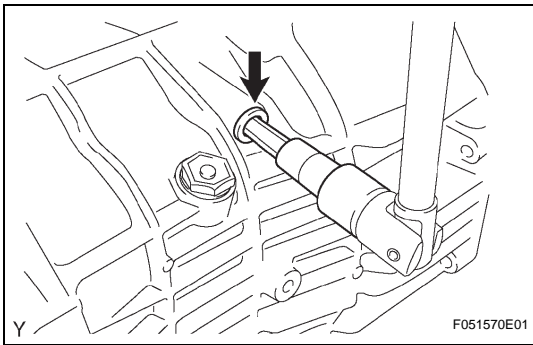

7. REMOVE SHIFT DETENT BALL PLUG

- (a) Using a socket hexagon wrench (10 mm), remove the shift detent ball plug from the transmission rear case.
- (b) Remove the ball and compression spring from the transmission rear case.

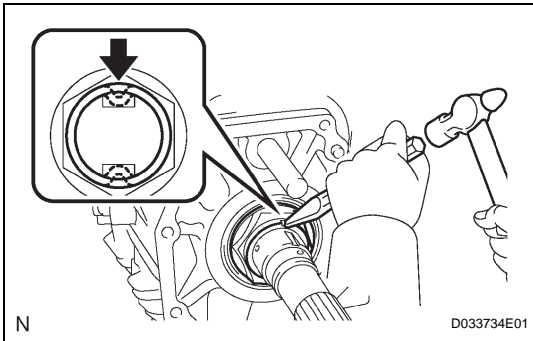

8. REMOVE OUTPUT SHAFT ADJUST NUT

- (a) Using a chisel and hammer, unstick the nut.

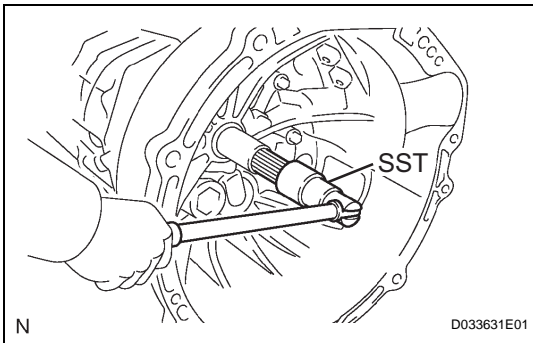

- (b) Place the gearshift into 5th gear, and then fix the input shaft using SST.

SST 09556-16030

- (c) Using a belt and wooden block, fasten the transmission to the workbench.

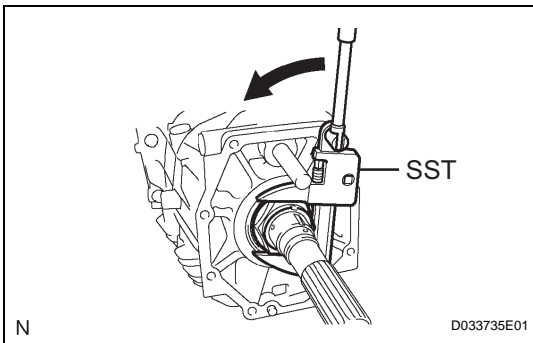

- (d) Using SST, remove the nut from the output shaft.

SST 09922-10010

- (e) Remove the belt and wooden block from the transmission.

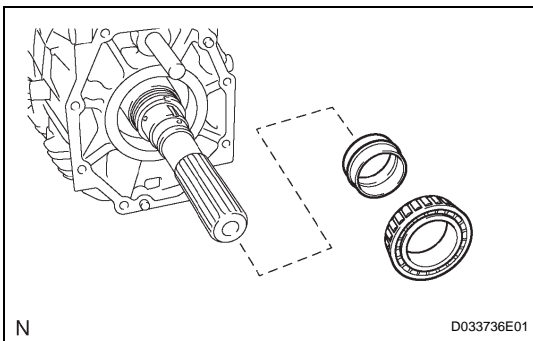

- (f) Remove the taper roller bearing No. 2 and spacer.

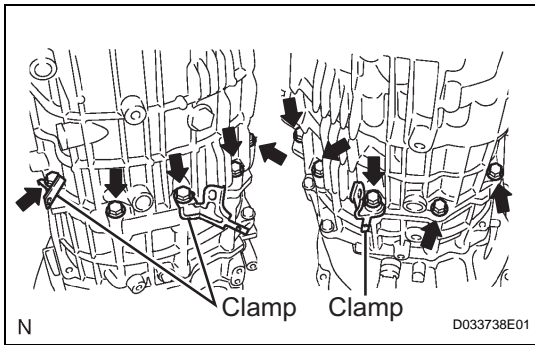

9. REMOVE TRANSMISSION REAR CASE

(a) Remove the 10 bolts and 3 clamps.

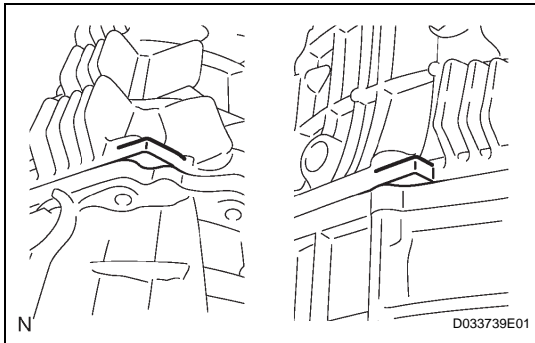

(b) Using a plastic hammer, carefully tap out the rear case.

MT

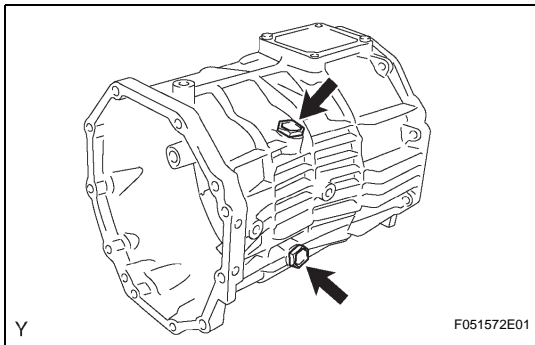

10. REMOVE MANUAL TRANSMISSION FILLER PLUG

(a) Remove the 2 transmission filler plugs and 2 gaskets from the transmission rear case.

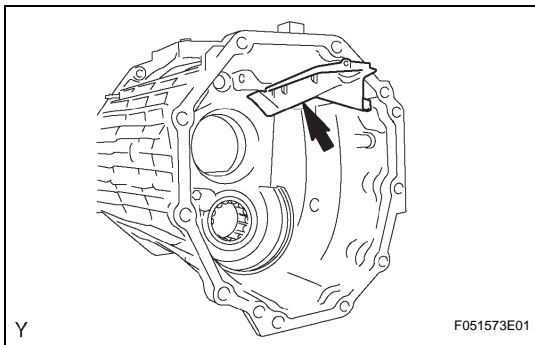

11. REMOVE EXTENSION HOUSING OIL RECEIVER PIPE

(a) Remove the extension housing oil receiver pipe from the transmission rear case.

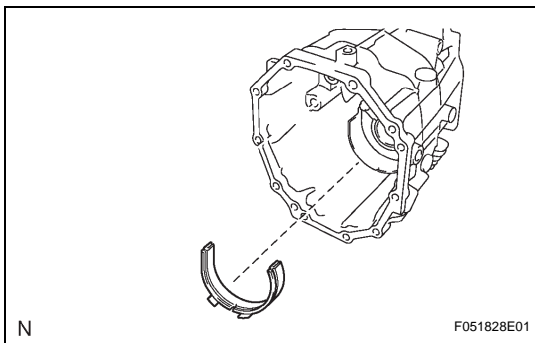

12. REMOVE OIL SEPARATOR PACKING SEAL

(a) Remove the oil separator packing seal from the transmission rear case.

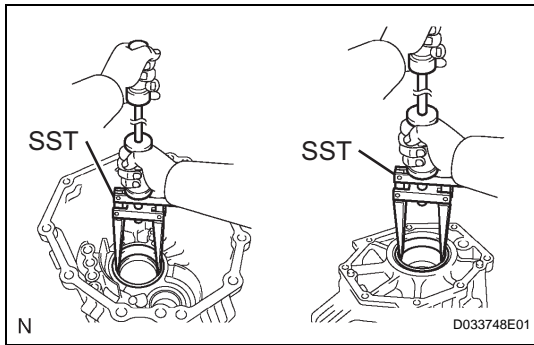

13. REMOVE OUTPUT SHAFT REAR BEARING OUTER RACE

- (a) Using SST, remove the 2 bearing outer races.
SST 09308-00010

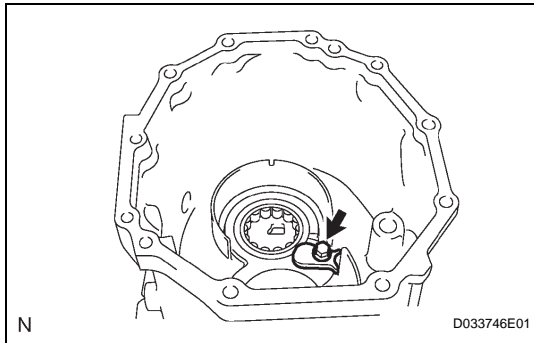

14. REMOVE COUNTER GEAR REAR RADIAL BALL BEARING

- (a) Remove the bolt, then remove the bearing lock plate.

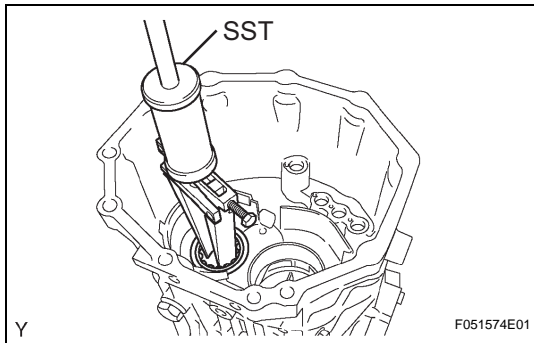

- (b) Using SST, remove the counter gear rear radial ball bearing from the transmission rear case.
SST 09308-00010

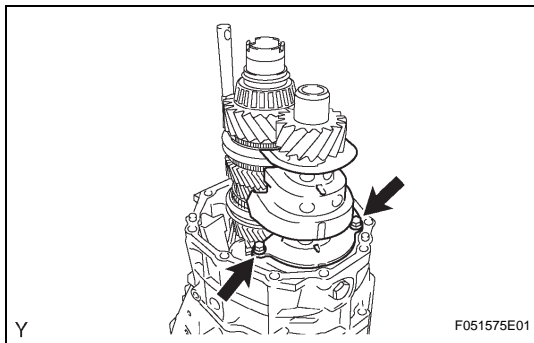

15. REMOVE TRANSMISSION OIL SEPARATOR

- (a) Remove the 2 bolts, then remove the oil separator.

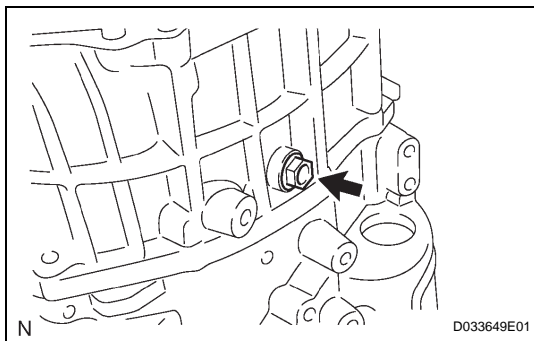

16. REMOVE REVERSE IDLER GEAR SHAFT BOLT

- (a) Remove the reverse idler gear shaft bolt from the transmission middle case.

MT

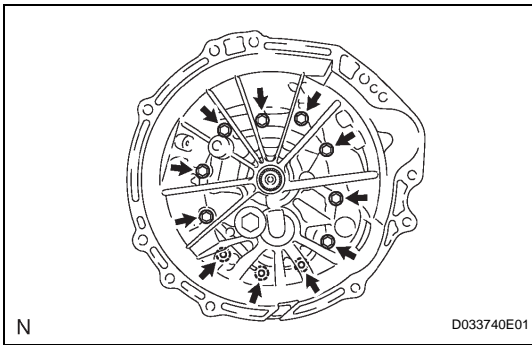
**17. REMOVE TRANSMISSION MIDDLE CASE**

- (a) Remove the 11 bolts, then remove the transmission middle case.

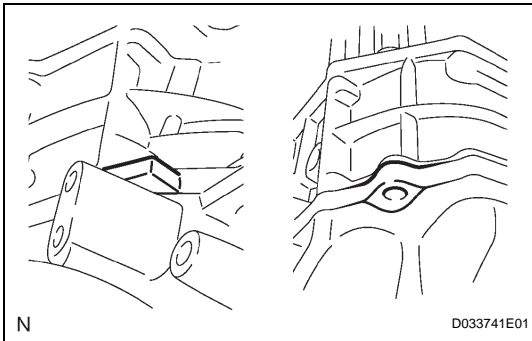

- (b) Using a plastic hammer, carefully tap out the middle case.

MT

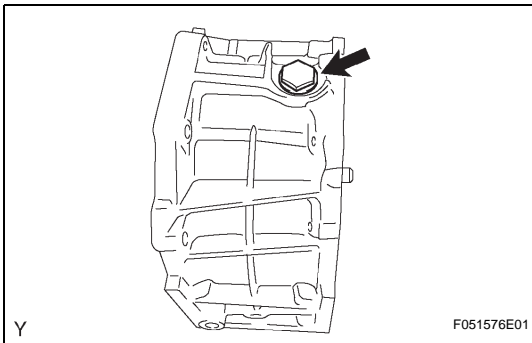
**18. REMOVE DRAIN PLUG SUB-ASSEMBLY**

- (a) Remove the drain plug and gasket from the transmission middle case.

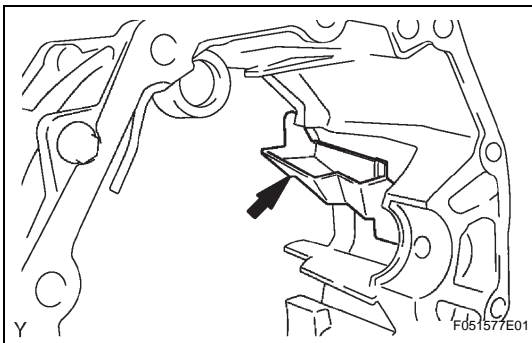
**19. REMOVE NO. 2 OIL RECEIVER PIPE**

- (a) Remove the oil receiver pipe No. 2 from the transmission middle case.

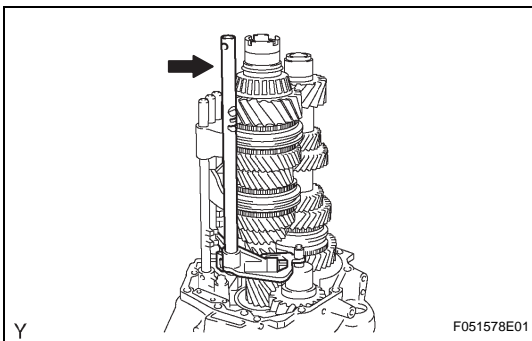
**20. REMOVE SHIFT AND SELECT LEVER SHAFT**

- (a) Remove the shift and select lever shaft from the reverse gear shaft.

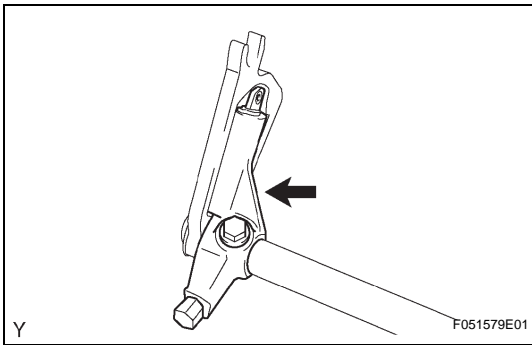
**21. REMOVE SHIFT AND SELECT LEVER**

- (a) Remove the bolt, then remove the shift and select lever.
- (b) Remove the lock ball pin and spring from the shift and select lever.

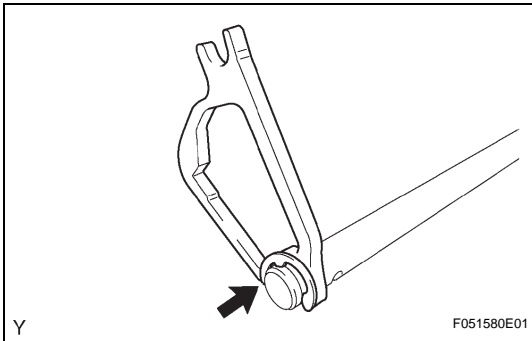
**22. REMOVE SHIFT AND SELECT LEVER CAM**

- (a) Using a screwdriver, remove the E ring and the shift and select lever cam from the shift and select lever shaft.

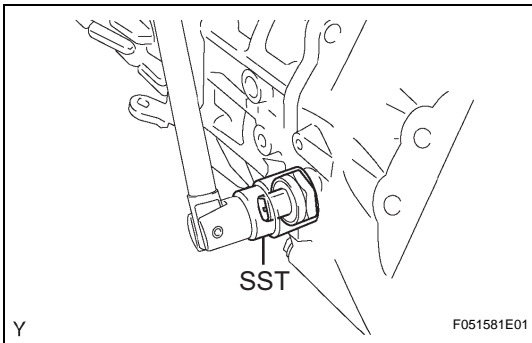
**23. REMOVE BACK-UP LIGHT SWITCH ASSEMBLY**

- (a) Using SST, remove the back-up light switch and gasket.

SST 09817-16011

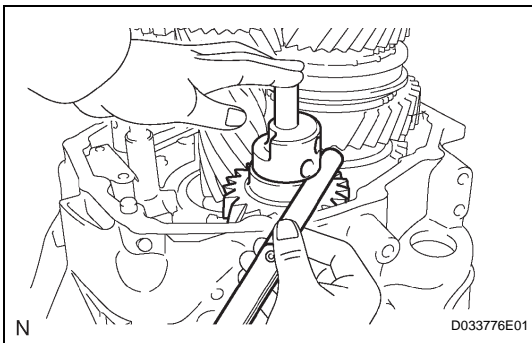
**24. INSPECT REVERSE IDLER GEAR THRUST CLEARANCE**

- (a) Using a feeler gauge, measure the thrust clearance.

Standard clearance:

0.10 to 0.55 mm (0.0039 to 0.0217 in.)

Maximum clearance:

0.55 to (0.0217 in.)

If the clearance is exceeds the maximum, replace the reverse idler gear shaft.

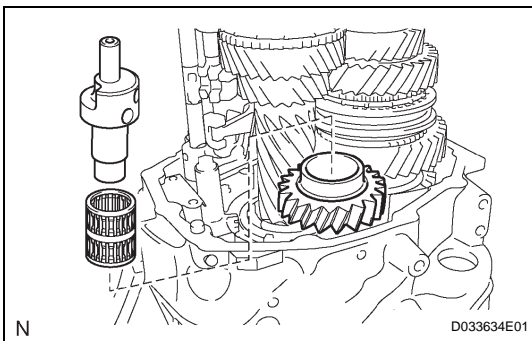
**25. REMOVE REVERSE IDLER GEAR**

- (a) Remove the reverse idle gear shaft, needle roller bearing and reverse idler gear.

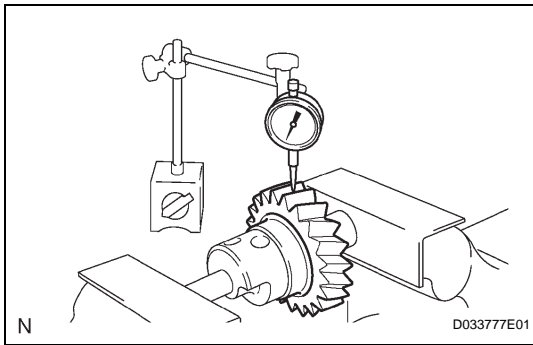

26. INSPECT REVERSE IDLER GEAR RADIAL CLEARANCE

- (a) Using a dial indicator, measure the radial clearance.
Standard clearance:
 0.015 to 0.050 mm (0.0006 to 0.0020 in.)
Maximum clearance:
 0.050 mm (0.0020 in.)
 If the clearance exceeds the maximum, replace the needle roller bearing.

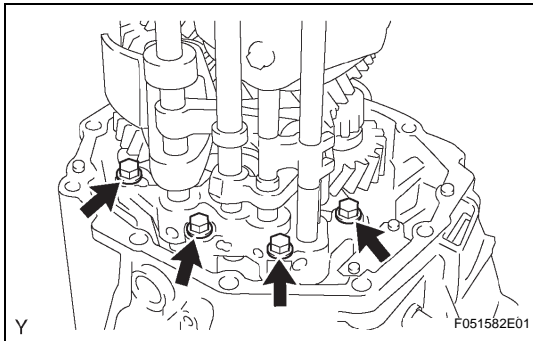

27. REMOVE TRANSMISSION FRONT CASE

- (a) Remove the 4 bolts from the interlock bracket.

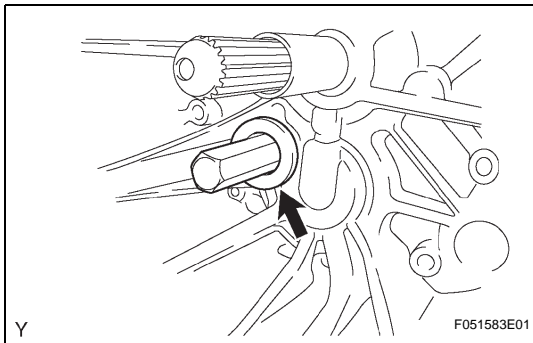

- (b) Using a hexagon wrench (24 mm), remove the plug.

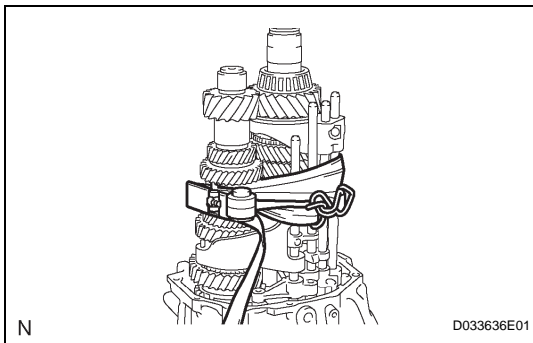

- (c) Tie the input shaft, counter gear and control assembly with a rope or string.

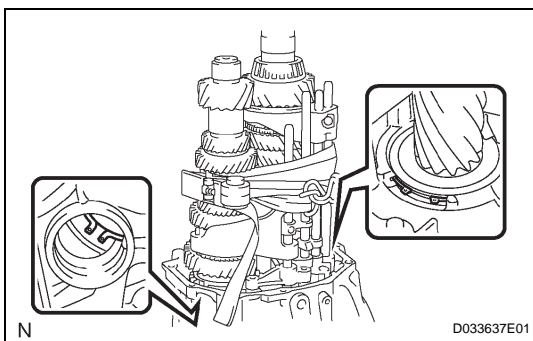

- (d) Expand the 2 snap rings, and lift up the output shaft, input shaft, counter gear and control assembly.

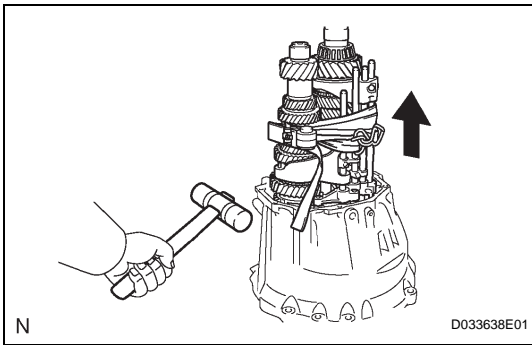

- (e) Remove the output shaft, input shaft, counter gear shaft and control assembly while gently tapping the clutch housing with a plastic hammer.

NOTICE:

Take care not to subject the output shaft, input shaft, counter gear shaft and control assembly to any impact. This could cause the ball and spring to come out.

- (f) Separate the output shaft, input shaft, counter gear shaft and control assembly.

28. REMOVE NO. 1 OIL RECEIVER PIPE

- (a) Remove the oil receiver pipe No. 1 from the transmission front case.

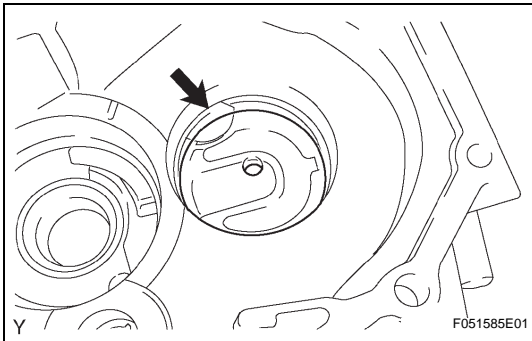
**29. REMOVE FRONT BEARING SHAFT SNAP RING**

- (a) Using a snap ring plier, remove the 2 snap rings.

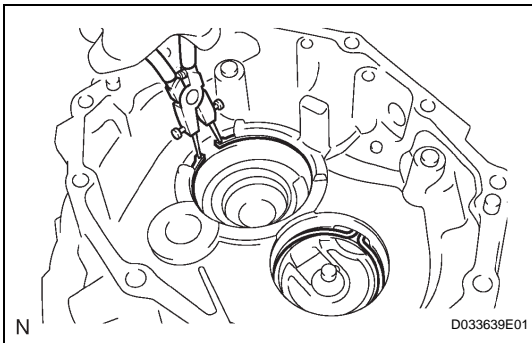
**30. REMOVE TRANSMISSION CASE OIL SEAL**

- (a) Using SST, remove the transmission case oil seal from the transmission front case.

SST 09308-00010

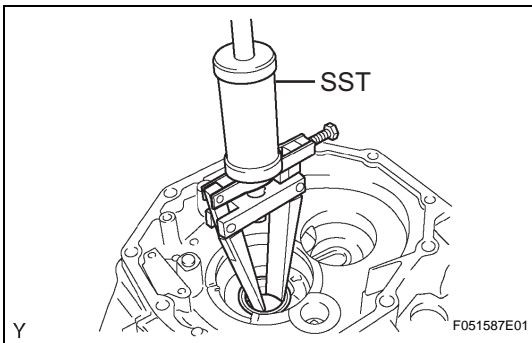
**31. REMOVE NO. 3 GEAR SHIFT FORK**

- (a) Remove the bolt, then remove the gear shift fork No. 3.

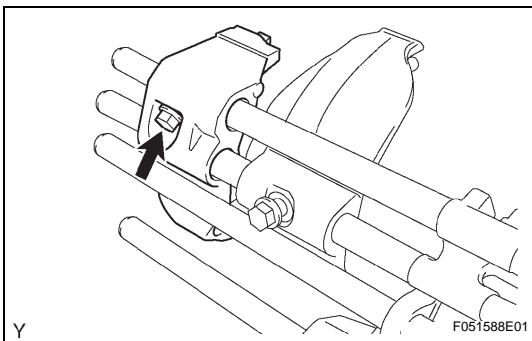

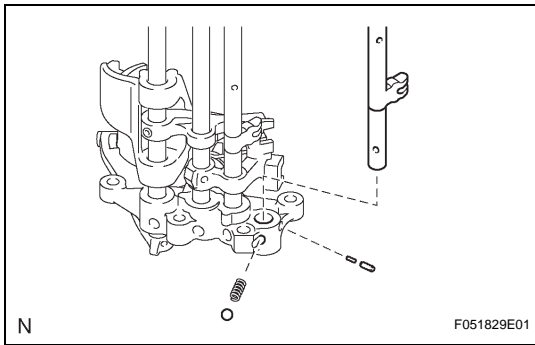
**32. REMOVE NO. 3 GEAR SHIFT FORK SHAFT**

- (a) Remove the shift fork shaft No. 3, boll, spring, interlock pin No. 2 and interlock pin No. 3.

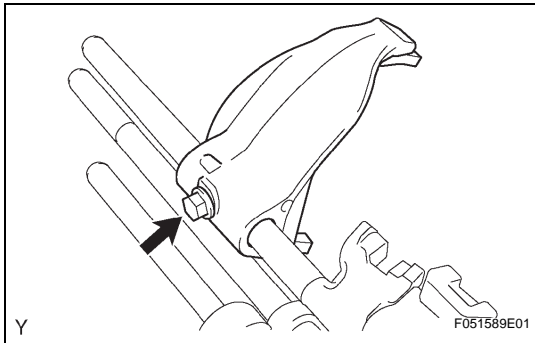
**33. REMOVE NO. 2 GEAR SHIFT FORK**

- (a) Remove the bolt, then remove the gear shift fork No. 2.

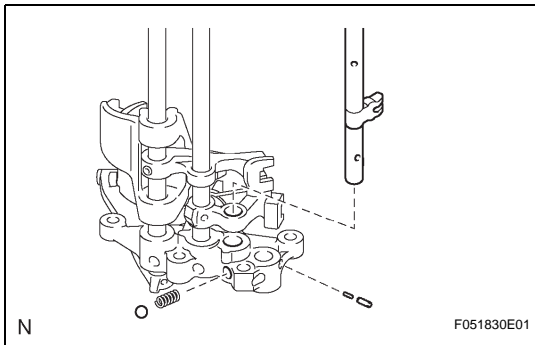
**34. REMOVE NO. 2 GEAR SHIFT FORK SHAFT**

- (a) Remove the shift fork shaft No. 2, ball, spring, interlock pin No. 2 and interlock pin No. 3.

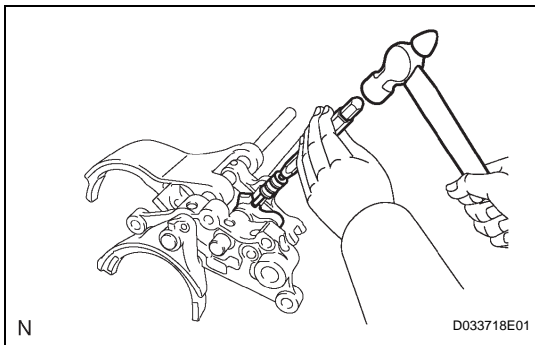
**35. REMOVE NO. 1 GEAR SHIFT HEAD**

- (a) Using a pin punch (5 mm (0.20 in.)) and hammer, tap out the slotted pin.

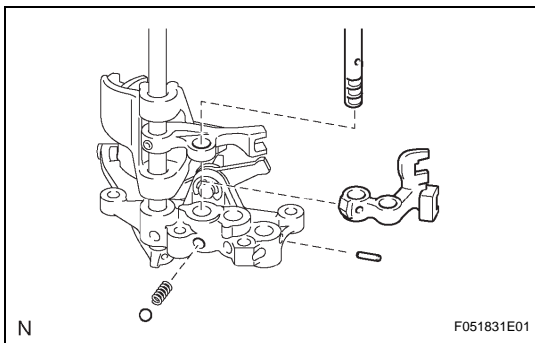
**36. REMOVE NO. 1 GEAR SHIFT FORK SHAFT**

- (a) Remove the shift fork shaft No. 1, ball, spring, shift head No. 1 and interlock pin No. 1.

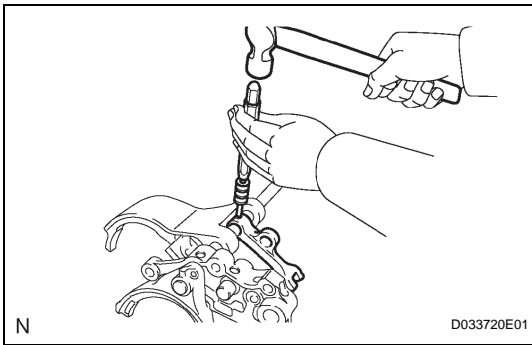
**37. REMOVE NO. 1 GEAR SHIFT FORK**

- (a) Using a pin punch (5 mm (0.20 in.)) and hammer, tap out the slotted pin.

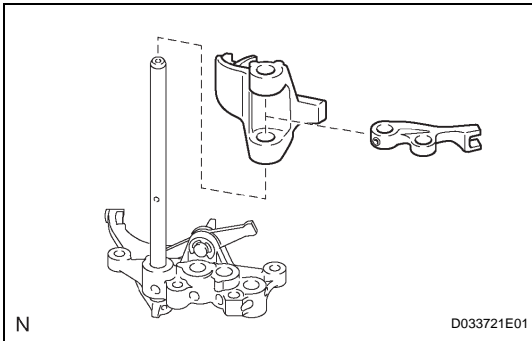

- (b) Remove the shift head No. 2 and shift fork No. 1.

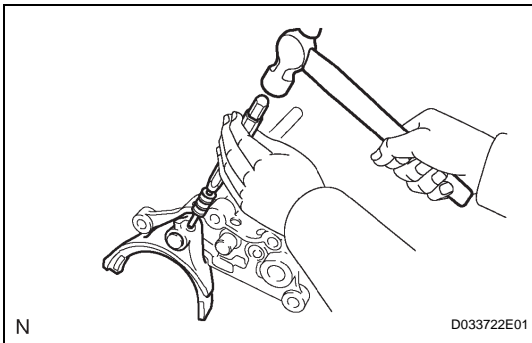
**38. REMOVE NO. 4 GEAR SHIFT FORK**

- (a) Using a pin punch (5 mm (0.20 in.)) and hammer, tap out the slotted pin.
- (b) Remove the shift fork No. 4.

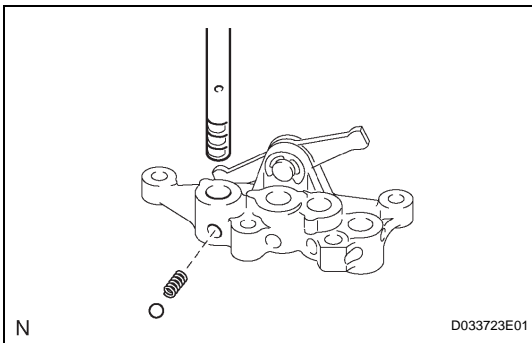
**39. REMOVE NO. 4 GEAR SHIFT FORK SHAFT**

- (a) Remove the shift fork shaft No. 4, ball and spring.

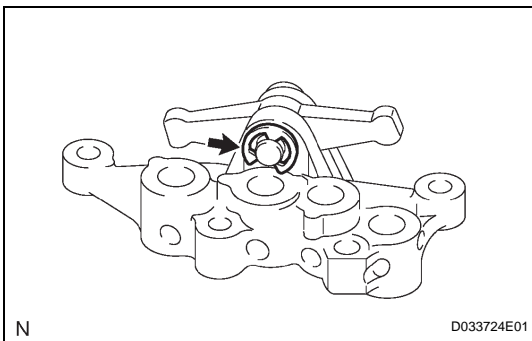
**40. REMOVE 1ST AND REVERSE SHIFT ARM**

- (a) Using a screwdriver, remove the E-ring.

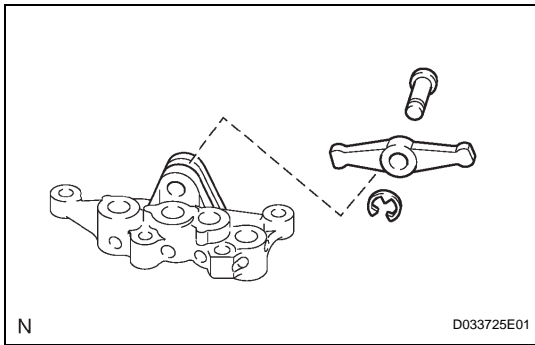

(b) Remove the shift arm pivot and shift arm.

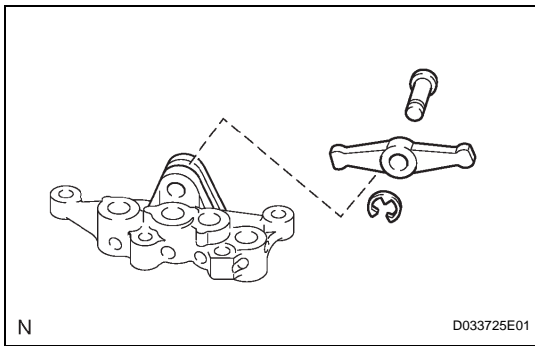

REASSEMBLY

1. INSTALL 1ST AND REVERSE SHIFT ARM

(a) Install the shift arm and shift arm pivot onto the interlock bracket.

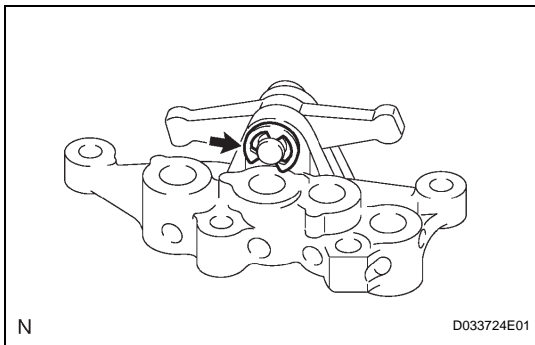

(b) Install a new E-ring onto the shift arm pivot.

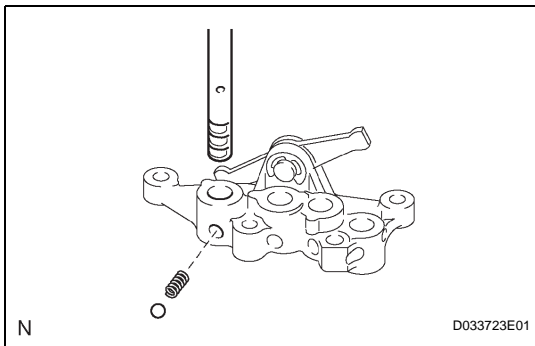

2. INSTALL NO. 4 GEAR SHIFT FORK SHAFT

(a) Install the spring and ball onto the interlock bracket.
 (b) Install the shift fork shaft No. 4.

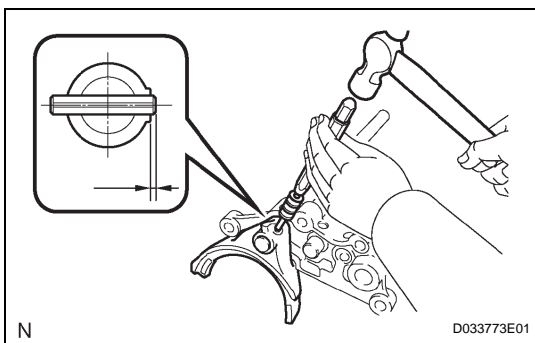

3. INSTALL NO. 4 GEAR SHIFT FORK

(a) Install the shift fork No. 4 onto the shift fork shaft No. 4.
 (b) Using a pin punch (5 mm (0.20 in.)) and hammer, tap the new slotted pin into the shaft fork No. 4 and shift fork No. 4.

Drive in depth:

0 to 0.5 mm (0 to 0.050 in.)