

# PROPELLER SHAFT ASSEMBLY (for Regular Cab 2WD)

## COMPONENTS

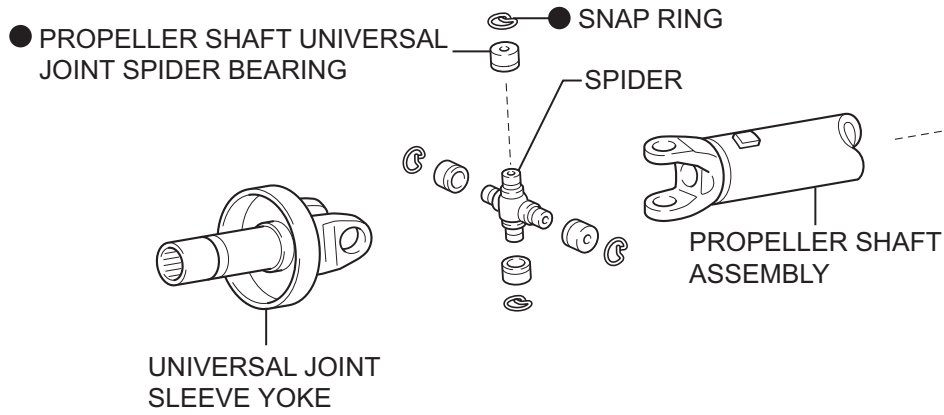

PR

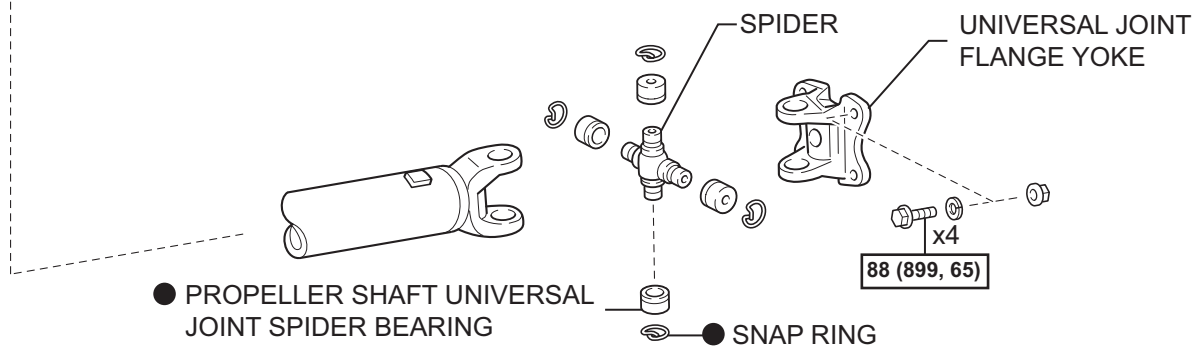

N\*m (kgf\*cm, ft\*lbf) : Specified torque

● Non-reusable part

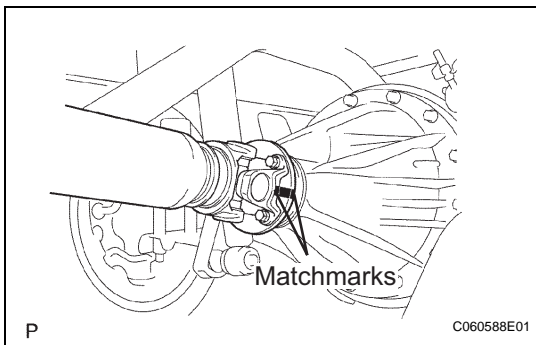

## REMOVAL

### 1. REMOVE PROPELLER SHAFT ASSEMBLY

- (a) Place matchmarks on the propeller shaft flange and differential flange.
- (b) Remove the 4 nuts, 4 bolts, 4 washers and front propeller shaft.

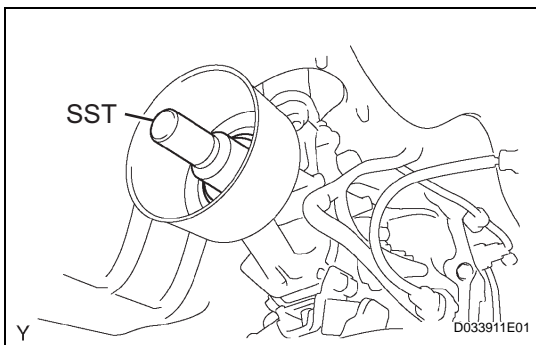

- (c) Remove the propeller shaft.
- (d) Insert SST into the transmission to prevent oil leakage.

**SST 09325-40010**